



# dJI 3D Series High Performance Drone User Guide

[Home](#) » [DJI](#) » dJI 3D Series High Performance Drone User Guide 

## Contents

- 1 dJI 3D Series High Performance Drone
- 2 Product Usage Instructions
- 3 Disclaimer and Warning
- 4 Introduction
- 5 Overview
- 6 Preparing the Aircraft
- 7 Installing the DJI Cellular Dongle 2
- 8 Linking and Activation
- 9 Usage
- 10 Specifications
- 11 Compliance Information
- 12 EU & UK Compliance Notice
- 13 FAQs
- 14 Documents / Resources
  - 14.1 References
- 15 Related Posts



**dJI 3D Series High Performance Drone**



## Specifications

- **Model:** DJI Matrice 3TD
- **Camera:** Different cameras available (Refer to actual product purchased)
- **Propellers:** CCW Propellers included
- **Additional Features:** Vision System, Auxiliary Light, Infrared Sensing System, Internal Charging Module, Front LEDs, Aircraft Status Indicators, Motors, Frame Arms with Internal Antennas, USB-C Assistant Port (E-Port Lite), Intelligent Flight Battery (sold separately), Beacon, GNSS/RTK Antenna, E-Port, Dongle Compartment

## Product Usage Instructions

### Preparing the Aircraft:

- **Inserting the Battery:**

Open the battery locking arm and insert the Intelligent Flight Battery into the battery compartment of the aircraft until a click is heard. Close the battery locking arm until the orange mark completely disappears, indicating the battery locking arm is in the lock position.

- **Powering On/Off:**

Press the power button once to power on the aircraft, then press and hold to power off. To check the battery level, press the power button once

### Installing the DJI Cellular Dongle 2 (Optional):

Users can install the DJI Cellular Dongle 2 (sold separately) to access a 4G wireless network and enable enhanced transmission. Insert a nano-SIM card into the DJI Cellular Dongle 2.

### Aircraft [1]

with a microSD card inserted

DJI Matrice 3D and DJI Matrice 3TD are equipped with different cameras. Refer to the actual product purchased. This guide uses the Matrice 3TD aircraft as an example.

x1

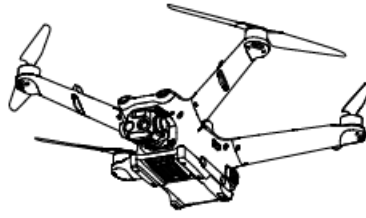

1. CW Propellers (Pair)
2. CCW Propellers (Pair)
3. Screws and Washers

x1



x1



x1



## Disclaimer and Warning

By using this product, you signify that you have read, understood, and accepted the terms and conditions of the guidelines and all instructions at <https://enterprise.dji.com/dock-2>. EXCEPT AS EXPRESSLY PROVIDED IN AFTER-SALES SERVICE POLICIES AVAILABLE AT [HTTPS://WWW.DJI.COM/SERVICE/POLICY](https://www.dji.com/service/policy), THE PRODUCT AND ALL MATERIALS AND CONTENT AVAILABLE THROUGH THE PRODUCT ARE PROVIDED “AS IS” AND ON “AS AVAILABLE BASIS” WITHOUT WARRANTY OR CONDITION OF ANY KIND. This product is not intended for children.

## Introduction

DJI Matrice 3D Series features both an infrared sensing system and a six-directional vision system and comes with a high-performance multi-camera payload. The RTK module facilitates centimeter-level positioning, meeting the needs of high-precision operations and improving flight safety. The aircraft has a protection rating of IP54 (IEC 60529). The aircraft can be used with DJI Dock 2. Together with DJI FLIGHTHUB™ 2, automated operations can be achieved, and real-time camera views can be obtained, meeting the needs for different scenes such as security, patrol inspection, and mapping.

## Overview

1. Gimbal and Camera
2. Vision System
3. Auxiliary Light
4. Infrared Sensing System
5. Internal Charging Module
6. Front LEDs
7. Aircraft Status Indicators
8. Motors
9. Propellers
10. Frame Arms (incl. Internal Antennas)
11. USB-C Assistant Port (E-Port Lite)

12. Intelligent Flight Battery (sold separately)

13. Power Button

14. Battery Level LEDs

15. Battery Buckle

16. Battery Locking Arm

17. microSD Card Slot

18. Beacon

19. GNSS/RTK Antenna

20. E-Port

21. Dongle Compartment

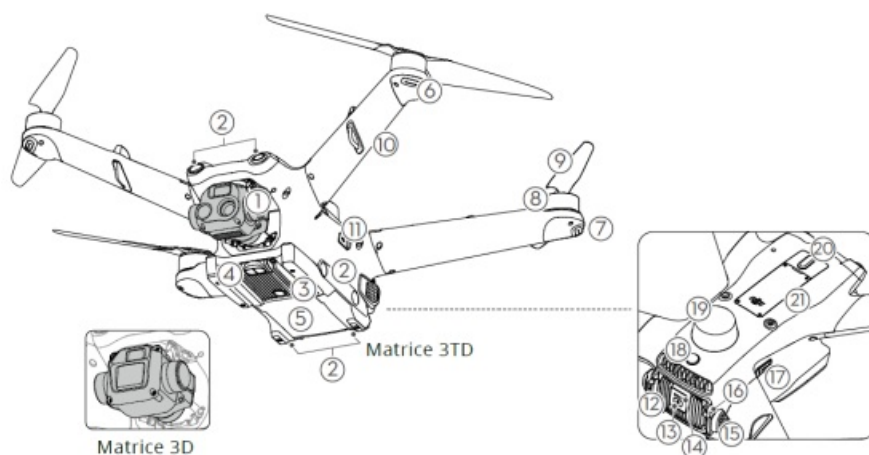

## Preparing the Aircraft

- Make sure the propellers are securely mounted and not damaged or deformed and that there is no foreign matter in or on the motors or propellers.
- Make sure the lenses of the vision system, the gimbal cameras, the glass of the infrared sensors, and the auxiliary lights are clean and not blocked in any way.
- Make sure the covers of the microSD card slot, the USB-C assistant port (E-Port Lite), and the E-Port are firmly closed.

### 1. Inserting the Battery:

Open the battery locking arm and insert the Intelligent Flight Battery into the battery compartment of the aircraft until a click is heard. Close the battery locking arm until the orange mark completely disappears, which indicates the battery locking arm is in the lock position.

2.

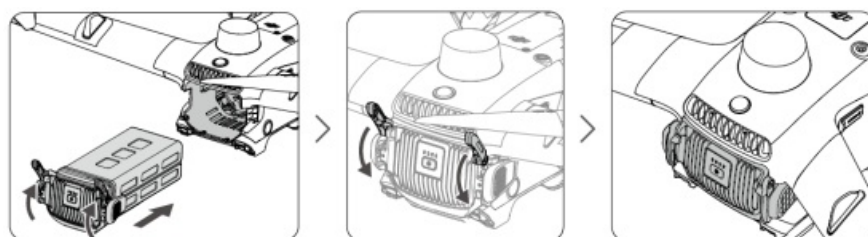

**Powering On/Off:** Press, then press and hold.

**Checking the Battery Level:** Press once.

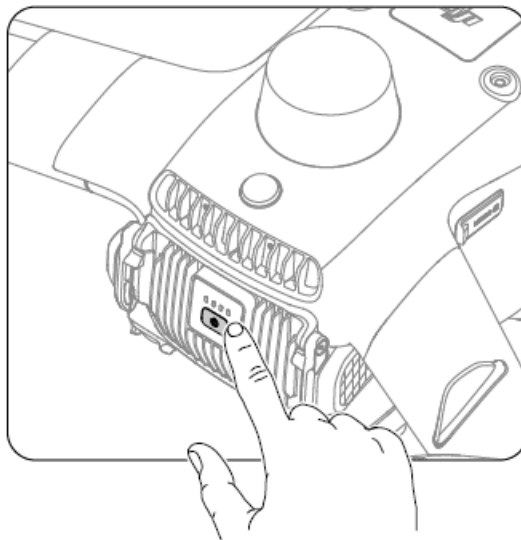

- To remove the battery, open the battery locking arms, then press the battery buckles and remove the battery.
- When transporting an unpacked dock, make sure to remove the aircraft from the dock for separate transportation.
- If the battery level is too low, charge the aircraft battery by placing the aircraft on the dock or using a charging kit (sold separately).

## Installing the DJI Cellular Dongle 2

### (Optional)

Users can install the DJI Cellular Dongle 2 (sold separately) to the aircraft to access a 4G wireless network and enable enhanced transmission.

1. Insert a nano-SIM card into the DJI Cellular Dongle 2.

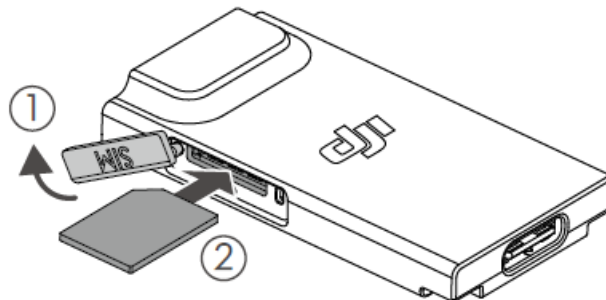



2. Make sure to power off the aircraft when installing or removing the dongle.
3. Use the 1.5mm hex key included in the dock package to remove the screws of the dongle compartment. Store the screws in a safe place and remove the dongle compartment cover.
4. Make sure the dongle's surface is clean. Connect the antenna connectors to the dongle with the DJI logo facing up, and place the dongle into the compartment.
5. Align the USB-C port to the USB-C connector in the compartment, then push to insert the dongle. DO NOT press down on the dongle when inserting.
6. Reinstall the compartment cover and press the cover down to close it firmly. Make sure the cover is not raised. Align the screw holes on the cover with holes on the aircraft and tighten the screws.

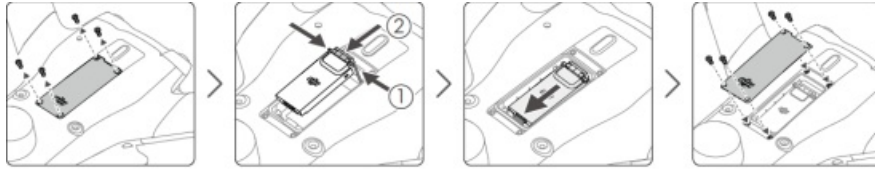

- The antennas in the dongle compartment are already secured with cable clips.

-  DO NOT pull the antennas by force. Otherwise, the antennas may be damaged.



-  Refer to the DJI Dock 2 User Manual for more information on how to enable enhanced transmission.

## Linking and Activation

- DJI Matrice 3D Series aircraft should be linked with DJI Dock 2 for automated flight operations. Power on DJI RC Pro Enterprise, run DJI PILOT™ 2, and follow the instructions to complete linking, activation, and dock configuration.
- The DJI RC Pro Enterprise remote controller can also be linked to the aircraft and used as controller B for manual control. During on-site flight tests, Controller B can take control and manually control the flight. Refer to the DJI Dock 2 Quick Installation Guide for the linking process.

-  The aircraft requires activation before first-time use. An internet connection is required for the remote controller during activation.

## Usage

Scan the QR code or go to the address to watch the tutorial videos and read the related manuals, such as the Safety Guidelines, User Manual, and Installation and Setup Manual. Make sure to understand the safety precautions and learn more about aircraft information.



<https://enterprise.dji.com/dock-2/video>



<https://enterprise.dji.com/dock-2/downloads>

- <https://enterprise.dji.com/dock-2/video>
- <https://enterprise.dji.com/dock-2/downloads>

## Specifications

Model	M3D/M3TD
Operating Temperature	-20° to 45° C (-4° to 113° F)
Video Transmission System	O3 Enterprise
Operating Frequency [1]	2.4000-2.4835 GHz 5.150-5.250 GHz (CE: 5.170-5.250 GHz) 5.725-5.850 GHz
Transmitter Power (EIRP)	2.4 GHz: <33 dBm (FCC), <20 dBm (CE/SRRC/MIC) 5.1 GHz: <23 dBm (CE) 5.8 GHz: <33 dBm (FCC/SRRC), <14 dBm (CE)
Max Transmission Distance	15 km (FCC), 8 km (CE/SRRC/MIC)

In some countries and regions, the 5.1GHz and 5.8GHz frequency bands are prohibited, or the 5.1GHz frequency band is only allowed for indoor use. Please refer to local laws and regulations for more information.

## Compliance Information

### FCC Compliance Notice

#### Supplier's Declaration of Conformity

- **Product name:** DJI Matrice 3TD/DJI Matrice 3D
- **Model Number:** M3TD/M3D
- **Responsible Party:** DJI Research LLC
- **Responsible Party Address:** 17301 Edwards Road, Cerritos, CA 90703
- **Website:** [www.dji.com](http://www.dji.com)
- We, DJI Research LLC, being the responsible party, declare that the above-mentioned model was tested to demonstrate compliance with all applicable FCC rules and regulations. This device complies with Part 15 of the FCC Rules. Operation is subject to the following two conditions:
  1. This device may not cause harmful interference, and
  2. This device must accept any interference received, including interference that may cause undesired operation.
- Any changes or modifications not expressly approved by the party responsible for compliance could void the user's authority to operate the equipment.
- This equipment has been tested and found to comply with the limits for a Class A digital device, under part 15 of the FCC Rules. These limits are designed to provide reasonable protection against harmful interference in a residential installation. This equipment generates, uses, and can radiate radio frequency energy and, if not installed and used according to the instructions, may cause harmful interference to radio communications.
- However, there is no guarantee that interference will not occur in a particular installation. If this equipment does cause harmful interference to radio or television reception, which can be determined by turning the equipment off and on, the user is encouraged to try to correct the interference by one or more of the following measures:

- Reorient or relocate the receiving antenna.
- Increase the separation between the equipment and receiver.
- Connect the equipment into an outlet on a circuit different from that to which the receiver is connected.
- Consult the dealer or an experienced radio/TV technician for help.

### **RF Exposure Information**

The equipment complies with FCC radiation exposure limits set forth for an uncontrolled environment. To avoid the possibility of exceeding the FCC radio frequency exposure limits, human proximity to the antenna shall not be less than 20cm during normal operation. This transmitter must not be co-located or operating in conjunction with any other antenna or transmitter.

### **ISED Compliance Notice**

- CAN ICES-003 (A) / NMB-003(A)
- This device contains licence-exempt transmitter(s)/receiver(s) that comply with Innovation, Science and Economic Development Canada's licence-exempt RSS(s). Operation is subject to the following two conditions:
  1. This device may not cause interference.
  2. This device must accept any interference, including interference that may cause undesired operation of the device.
- The equipment complies with the RSS-102 radiation exposure limits set forth for an uncontrolled environment.
- This equipment should be installed and operated with a minimum distance of 20cm between the radiator and your body.
- This transmitter must not be co-located or operating in conjunction with any other antenna or transmitter.

### **EU & UK Compliance Notice**

#### **EU Compliance Statement:**

SZ DJI TECHNOLOGY CO., LTD. hereby declares that this device (DJI MATRICE 3TD/DJI MATRICE 3D) complies with the essential requirements and other relevant provisions of the Directive 2014/53/EU. A copy of the EU Declaration of Conformity is available online at [www.dji.com/euro-compliance](http://www.dji.com/euro-compliance)

#### **EU contact address:**

DJI GmbH, Industriestrasse 12, 97618, Niederlauer, Germany

#### **GB Compliance Statement:**

SZ DJI TECHNOLOGY CO., LTD. hereby declares that this device (DJI MATRICE 3TD/DJI MATRICE 3D) complies with the essential requirements and other relevant provisions of Radio Equipment Regulations 2017. A copy of the GB Declaration of Conformity is available online at [www.dji.com/euro-compliance](http://www.dji.com/euro-compliance)

#### **CAUTION:**

RISK OF EXPLOSION IF BATTERY IS REPLACED WITH AN INCORRECT TYPE. DISPOSE OF USED BATTERIES ACCORDING TO THE INSTRUCTIONS.



<https://enterprise.dji.com/dock-2/downloads>

FAQs

- Q: Can I use the DJI Matrice 3TD without a microSD card?**  
A: Yes, you can use the DJI Matrice 3TD without a microSD card, but certain features that require storage may not be available.
- Q: How do I know if the battery is fully inserted?**  
A: When inserting the Intelligent Flight Battery, listen for a click sound. Also, ensure that the orange mark on the battery locking arm completely disappears.

Documents / Resources

	<p><a href="#">dJI 3D Series High Performance Drone</a> [pdf] User Guide</p> <p>3D Series High Performance Drone, 3D Series, High Performance Drone, Performance Drone, Drone</p>
---	---

References

- [User Manual](#)