



Divoom WT-07W Wifi Dual Water Timer User Manual

[Home](#) » [Divoom](#) » Divoom WT-07W Wifi Dual Water Timer User Manual 

Contents

- [1 Divoom WT-07W Wifi Dual Water Timer](#)
- [2 Product Information](#)
- [3 Product Usage Instructions](#)
- [4 Product Appearance](#)
- [5 Packing List](#)
- [6 Product Specifications](#)
- [7 Mode Of Operation](#)
- [8 FAQ](#)
- [9 Documents / Resources](#)
 - [9.1 References](#)
- [10 Related Posts](#)

Divoom[®]

Divoom WT-07W Wifi Dual Water Timer



Product Information

Specifications

- Wifi Water Timer Model: WT-09W
- Email: support@diivoosmart.com
- Hose Faucet Connection: 3/4 inch inlet adapter
- LED Light ON/OFF Button
- Filter
- Outlet Fitting: 3/4 inch
- Control Button LED Light
- WiFi hub: WG03
- Wi-Fi Band: 2.4 GHz only
- WiFi hub Range: up to 196 feet (60m)
- Input Voltage: 110V-220V
- Frequency: 433.92MHZ

Product Usage Instructions

Installation

1. Connect the hose faucet to the water timer using the provided 3/4 inch inlet adapter.
2. Ensure the LED light ON/OFF button is turned off before proceeding.
3. Insert a filter into the water timer to prevent debris from clogging the system.
4. Attach the outlet fitting to the water timer, ensuring it is securely connected.

Connecting to WiFi

1. Download and install the HOMGAR app on your iOS or Android device.
2. Open the app and register your account.
3. Follow the in-app instructions to pair the water timer with your WiFi network.
4. If the network pairing fails within 120 seconds, check the settings and retry, or switch to AP pairing method.

Watering Schedule

Use the HOMGAR app to set up watering schedules for your garden.
You can set up to 6 watering schedules at the same time.

Start Watering Immediately

Tap on the “Start watering immediately” option in the app to start watering your garden immediately.

Watering Schedule

Set specific watering schedules by selecting the “Watering schedule” option in the app. The screen will display the remaining watering hours and the next run time.

Rain Delay

To delay watering due to rain, select the “Rain delay” option in the app. Choose the duration of the delay (24H, 48H, 72H). The remaining watering time will be displayed. The rain delay will automatically stop when the time is up or can be manually shut down.

Manual Watering

If you want to manually water your garden, select the “Manual Watering” option in the app. Set the duration of manual watering (1 min – 12h). The remaining watering time will be displayed, and it will stop automatically when the time is up or can be manually shut down.

Note on Rain Delay and Manual Watering

After turning on rain delay or manual watering, the automatic watering program will stop. When manual watering is stopped, the program will resume, but the remaining watering duration for the relapse period of the program will not be executed.

Settings

Customize your water timer settings using the HOMGAR app.

Zone Setting

Click on “Zone1” in the app to change the zone name and default watering time.

Custom Interface

Change the background picture and font of the app interface according to your preference.

Integration with Voice Assistants

The water timer is compatible with Amazon Alexa and Google Assistant, allowing you to control it using voice commands.

FAQ

Q1: Why doesn't the water timer open/close within the preset time?

A1: There could be several reasons for this issue:

- Check if the valve is properly connected and functioning.
- Ensure that you have set the correct start times in the app.
- If necessary, use an appropriate adapter or PTFE tape for a secure connection.
- Make sure the water pressure meets the standard requirement for the water valve.

Product Appearance

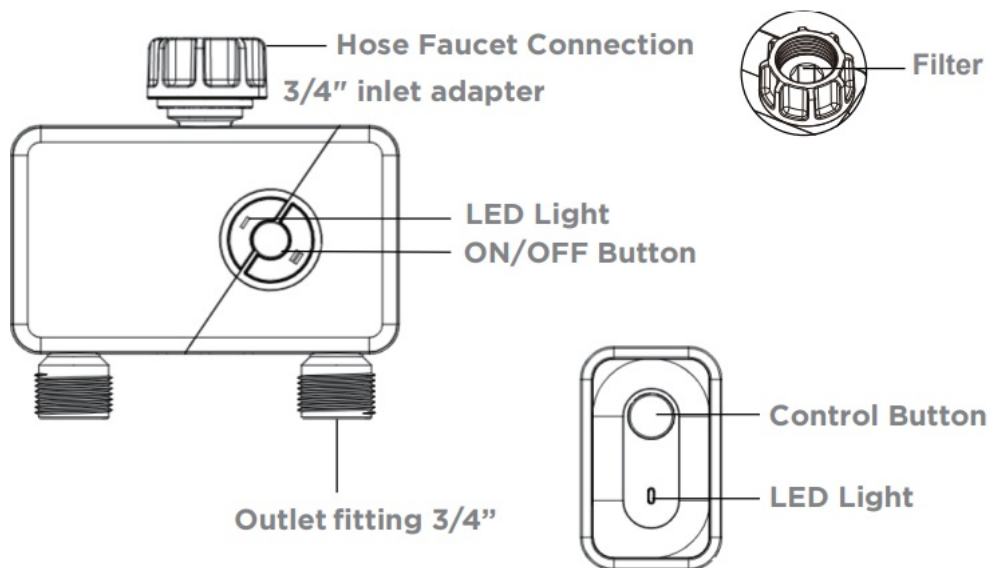

Packing List

1. Water Timer,*1
2. 1/2" inlet adapter*1
3. Threaded connector*2
4. Thread Seal Tape*1
5. Instruction*1

Product Specifications

Water Timer: WT-09W

1. Working Water Pressure: 0.5bar-8bar (7.25 psi-116.03 psi)
2. Working Temperature: 3°C-50°C (37°F-122°F)
3. Waterproof Level: IP54
4. Power Supply: 4 x AA batteries

WiFi hub: WGO3

1. Wi-Fi Band: 2.4 GHz only.
2. WiFi hub: up to 196 feet(60m).
3. Input voltage 110V-220V, frequency: 433.92MHZ

Important Tips

1. Please do not use Carbon-zinc or rechargeable batteries.
2. Do not use your timer when the air temperature is below 3°C(37°F), the timers should be removed from the hose faucet and stored indoors to avoid potential frozen damage.
3. When replacing the power unit, please make sure that the water timer is dry.
4. Filter can trap dirt particles, please clean filter regularly and replace if worn to prevent blockage.
5. The valve will shut down automatically when the voltage is lower than 4.3V.

6. The range of connection and control is within 60m of the open area.
7. Do not put the water valve in underground water valve box or in the place where the signal may be blocked.
8. Make sure the device is connected to 2.4GHz Wifi frequency.

Mode Of Operation

1. Download"HOMGAR" app and register.



IOS



Android

2. Pairing hub

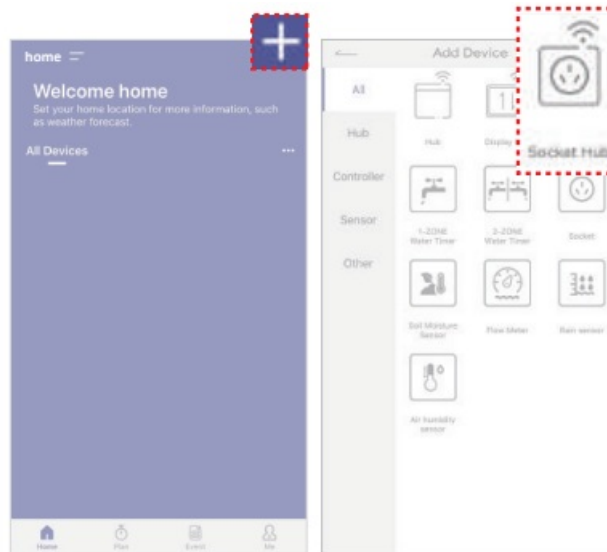

1. Connect hub to powersource, press and hold for 5-10 sec until blue light flashes to enter pairing mode.
2. Hub matching method 1: Smart pairing
Matching order: "+" (Home) → "socket hub" → set WIFI information with correct WIFI password → make sure the hub is powered on, press and hold the hub button until the light flashes quickly → set the device name.
Note: If the network pairing fails within 120 seconds, check the settings and retry, or switch the pairing method into the AP pairing.
3. Hub matching method 2: AP networking

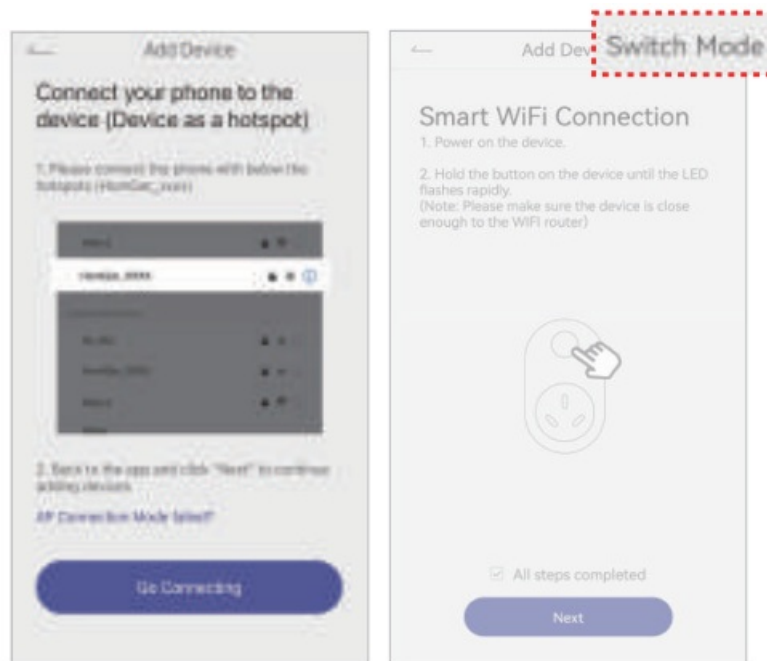

Matching order: “+” (Home) → “socket hub”→ Set WIFI information with correct WIFI password → When the device is in smart pairing mode, press the button to enter AP pairing → Switch the pairing mode → Connect the phone to HomGar_xxx Hotspot → Set the device name.

3. Adding a valve

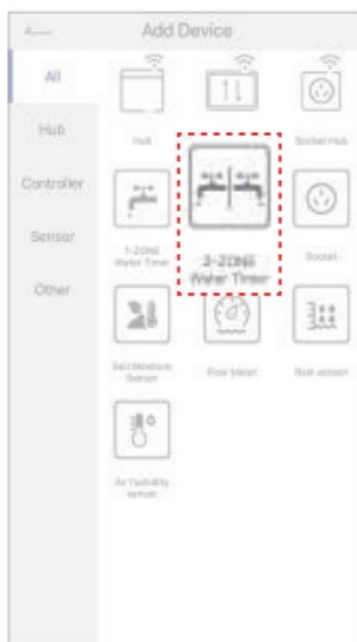

1. Put batteries in the valve and connect it to water pipe, press and hold the button on the valve for 5-10 sec until red light flashes to enter pairing mode.

Note: make sure the water value is closed

2. Pairing steps: “+”to enter main page > select “2-zone water timer””Next” Pair your device complete.

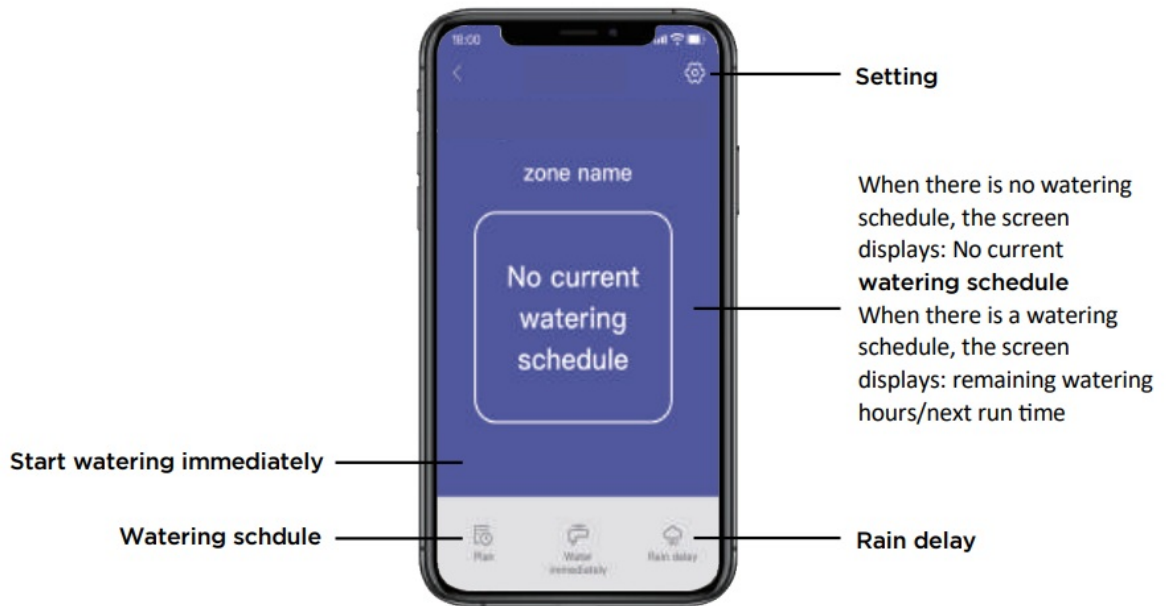

4. Operating Interface

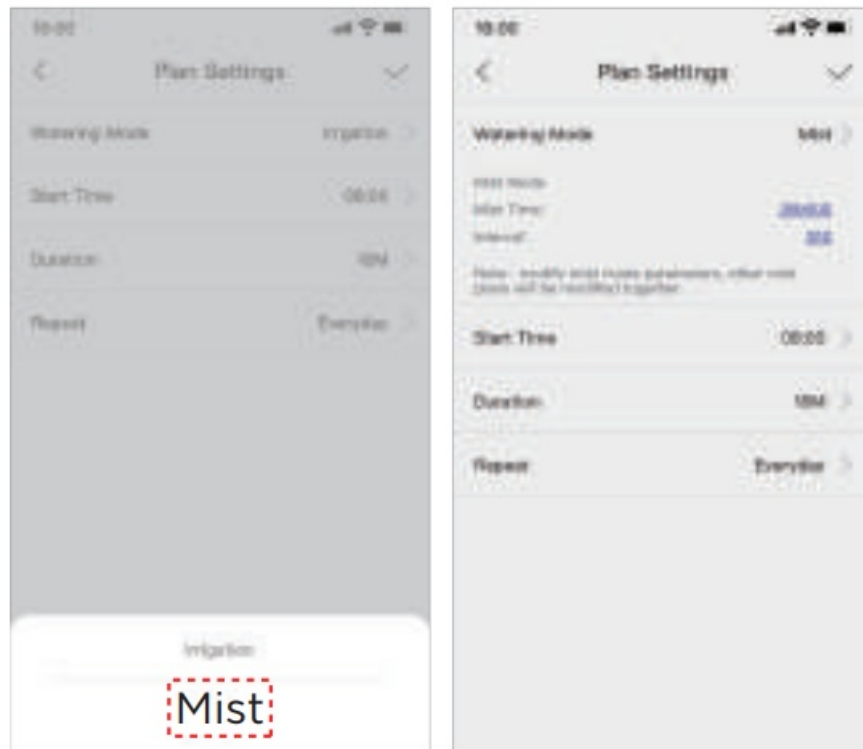

1. Watering schedule

1. Misting mode

- Set start time(00: 00-23: 59) Total misting length(1min-12h) Misting duration(5s-60min) Misting interval(5s-60min) Watering program frequency(Everyday, Odd days, Even days, Custom)

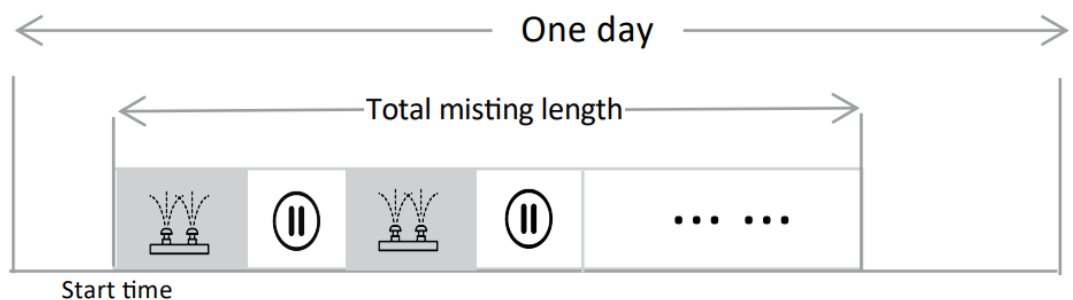

2. Irrigation mode

- Set start time (00: 00-23: 59) → Total irrigation length (1min-12h) → Irrigation frequency

(Everyday, Odd days, Even days, Custom)

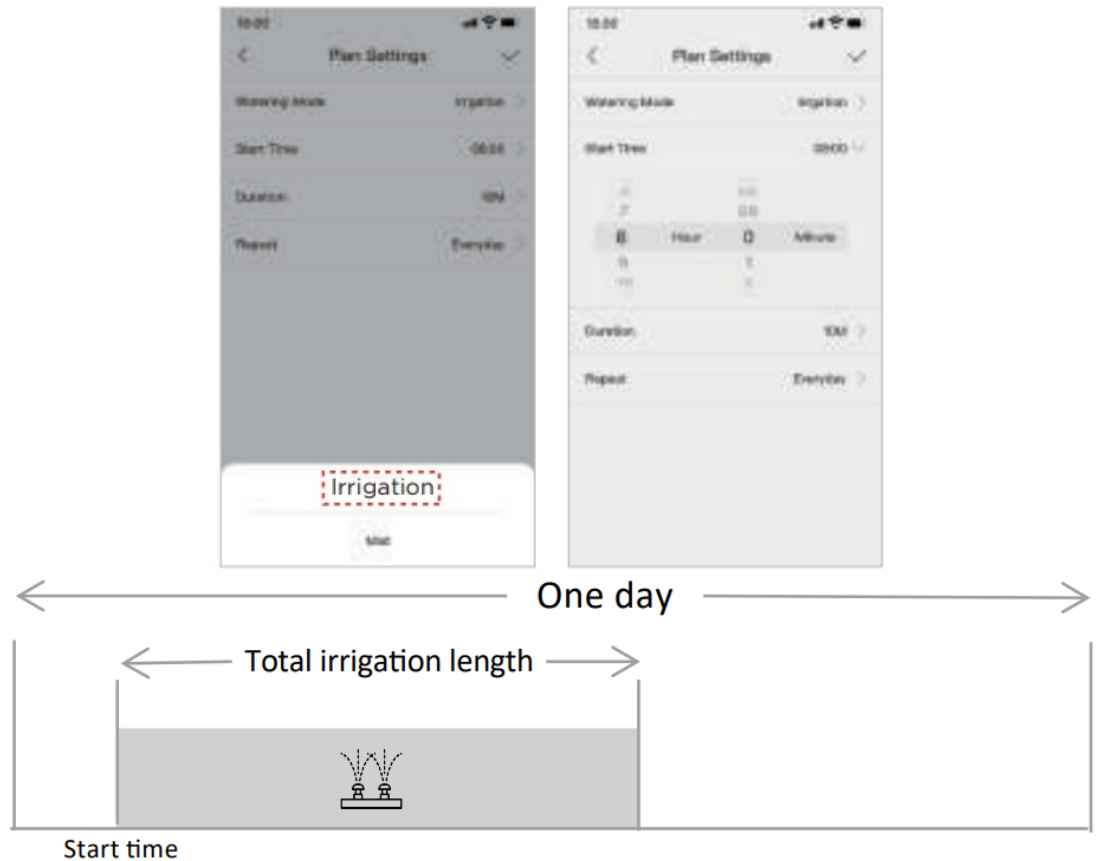

3. Schedule Calendar Able to check watering schedule for current month, the little dot under the date represents watering times for current date.

Note: Up to 6 watering schedules can be set at the same time. when preset program is in conflict with other zones, turning on water valve will lower water flow.

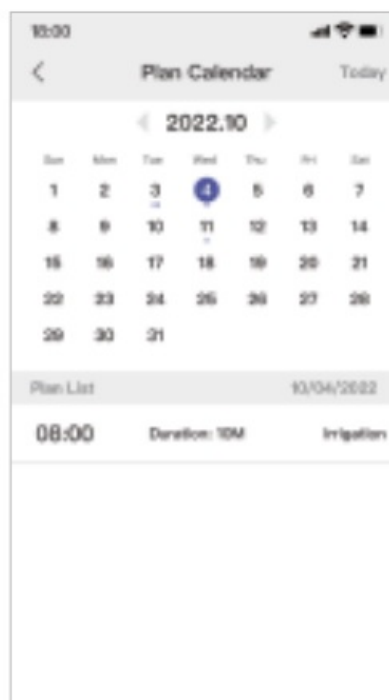

2. Rain delay Set up Rain delay duration (24H, 48H, 72H), remaining watering time will be displayed, it will stop automatically when time's up, or shut down manually before time's up.

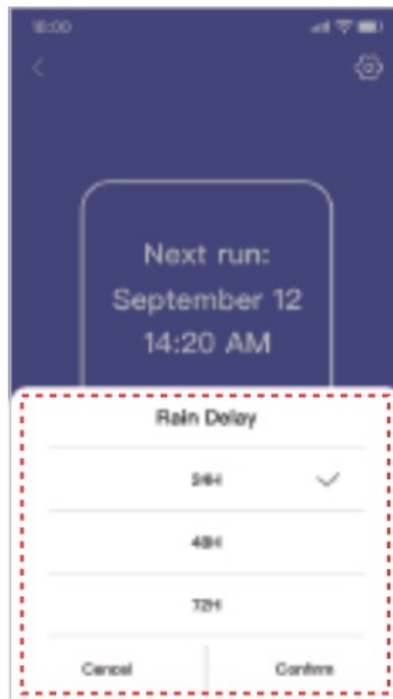

3. Manual Watering Set up manual watering duration (1 min- 12h), remaining watering time will be displayed, it will stop automatically when time's up, or shut down manually before time's up.



Note: After turning on “rain delay” or “Manuel watering”, the Auto watering program will stop, after stopping manual watering, the program will resume but the remain watering duration for the relap period of the program will not be executed.

4. Setting

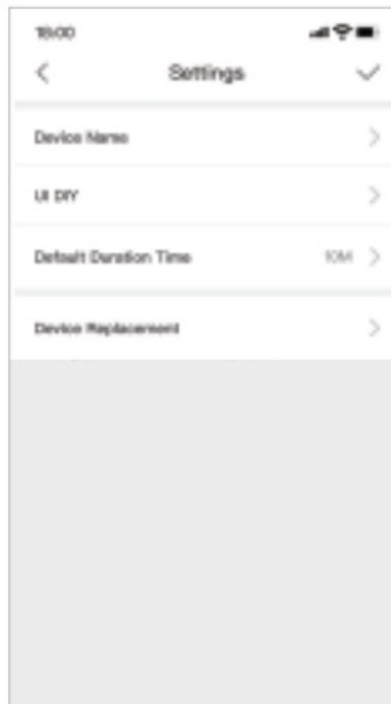

1. Zone Setting Click Zonel to change Zone name and default watering time.
2. Custom interface Change into your preferable background picture and font.

Amazon Alexa

Open the Alexa app on your phone, log in successfully and select “Skills&Games” on the “MORE” page.

- Search for “Homgar Intelligence” and select it.
- Click “Enable to use” to enable the skill.
- Enter your HOMGAR APP account & password, then click “Sign In” to bind your HOMGAR APP account and activate your device.

Voice commands.

- Alexa open “zone name “
- Alexa close “zone name “

Google Assistant

Open the Google Home app on your phone, sign in, click the “+” symbol in the upper left corner, then click the “Set up device” option, and select “Use Google” . Enter your account password via “HomgarSmart” to bind your app account and allow it to access your Google account Voice commands.

- OkGoogle open “zone name “
- OkGoogle ›close “zone name “

FAQ

Q1: Why doesn't the water timer opened/closed within the preset time?

- The program is incorrect.
- The water pressure is too low.

- There are particles of dirt or debris inside the valve.
- There are overlapped plan in the multiple set start times.
- Manual watering is turned on.
- Valve fails.
- The battery is low.
- The faucet is turned off.
- Rain delay is activated.

Q2: Why does the network connection fail?

- Please check if the icon is selected correctly in the app.
- If the device is already connected to another cell phone, please disconnect first.
- Turn off the WLAN connection of your phone and turn it on again.
- Make sure there is sufficient battery power and place the water valve as close as possible to the gateway.
- There are too many devices connected to the router and the WLAN signal is unstable.
- Pairing is only to be performed on 2.4G WLAN networks.
- It is not possible to connect the gateway and water valve on the tablet.

Q3: The hose tap connection/outlet leaks.?

- The O-ring is connected correctly to the hose tap.
- The connection outlet or water pipe is broken.
- The faucet and water pipe has a different thread.

If necessary, please use an appropriate adapter or PTFE tape.

Q4: Is it compatible with water bucket or drip system?

- No, because the water pressure of water bucket and drip system does not meet the pressure standard for water valve.

FCC Caution.

1. § 15.19 Labelling requirements.

This device complies with part 15 of the FCC Rules. Operation is subject to the following two conditions: (1) This device may not cause harmful interference, and (2) this device must accept any interference received, including interference that may cause undesired operation.

§ 15.21 Changes or modification warning

Any Changes or modifications not expressly approved by the party responsible for compliance could void the user's authority to operate the equipment.

§ 15.105 Information to the user.

Note: This equipment has been tested and found to comply with the limits for a Class B digital device, pursuant to

part 15 of the FCC Rules. These limits are designed to provide reasonable protection against harmful interference in a residential installation. This equipment generates uses and can radiate radio frequency energy and, if not installed and used in accordance with the instructions, may cause harmful interference to radio communications. However, there is no guarantee that interference will not occur in a particular installation. If this equipment does cause harmful interference to radio or television reception, which can be determined by turning the equipment off and on, the user is encouraged to try to correct the interference by one or more of the following measures:

- Reorient or relocate the receiving antenna.
- Increase the separation between the equipment and receiver.
- Connect the equipment into an outlet on a circuit different from that to which the receiver is connected.
- Consult the dealer or an experienced radio/TV technician for help.

RF warning for Mobile device:

This equipment complies with FCC radiation exposure limits set forth for an uncontrolled environment. This equipment should be installed and operated with minimum distance 20cm between the radiator & your body.

support@diivoosmart.com

Documents / Resources

	<p>Divoom WT-07W Wifi Dual Water Timer [pdf] User Manual</p> <p>WT-07W, WT-09W, WT-07W Wifi Dual Water Timer, Wifi Dual Water Timer, Dual Water Timer, Water Timer, Timer</p>
---	---

References

- [User Manual](#)