



DIVERSITECH Smart Door Sensor WiFi Wireless Door Window Detector User Manual

[Home](#) » [DIVERSITECH](#) » DIVERSITECH Smart Door Sensor WiFi Wireless Door Window Detector User Manual



Contents

- [1 DIVERSITECH Smart Door Sensor WiFi Wireless Door Window Detector](#)
- [2 Product Information](#)
- [3 Product Usage Instructions](#)
- [4 Operating Instructions](#)
- [5 Installation & Notice](#)
- [6 Documents / Resources](#)



DIVERSITECH Smart Door Sensor WiFi Wireless Door Window Detector



Product Information

The Wireless Contact Sensor is an accessory of the smart alarm system. It features a fashion design, RF supervision, anti-tamper protection, energy saving, and low battery warning support. The sensor is easy to set up and works well with most doors and windows. When the transmitter and magnet are apart, the sensor triggers an alarm. The LED indicator lights up every 15 seconds to indicate low battery, and the system will notify users through the app when battery replacement is needed.

Parameters:

- Appearance
 - LED Indicator and Test Button
 - Screw Mounting Hole
 - Tamper
 - Screw Mounting Hole
 - Magnet and Bracket
 - Battery Insulative Strip
 - Screw Mounting Hole

- Corresponding the triangle of the magnetic stripe to the transmitters to get the best detection effect.

FCC Statement: DWCH1 V1.3

Features:

- Fashion design
- RF supervision
- Anti-tamper protection
- Energy saving
- Low battery warning support
- Easy setup
- Compatible with most doors and windows
- Triggers alarm when transmitter and magnet are apart

Product Usage Instructions

Battery Replacement Instructions:

1. Insert the flat blade of a small screwdriver into the pry-off slot of the transmitter and pry up to open the back cover.
2. Replace the old battery with a new CR123A 3V battery.

Operating Instructions:

1. **Working principle:** The transmitter sends a trigger signal to the main panel when the magnet is moved apart.
2. **Pairing with the main panel:**
 - Scan the QR Code on this accessory for pairing.
 - To trigger the pairing process, remove the battery insulative strip and move the magnet around the transmitter until the green LED indicator lights up.

Installation & Notice:

Ensure that the distance between the transmitter and magnet is less than 1cm for optimal detection effect.

Entry Delay, Home Arm, and Ready to Arm

This sensor supports Entry Delay, Home Arm, and Ready Arm features. Which can be adjusted in the App.

- **Entry Delay feature:** When the sensor is triggered while the system is in Arm/Home Arm status, the system will wait for the preset time until the alarm goes off.
- **Home Arm feature:** When the sensor with this feature enabled is triggered while the system is in Home Arm status, the alarm will go off.
- **Ready to Arm feature :**
 1. The system will check and show the status of doors and windows in real-time in the App.
 2. The App will pop up and remind you of all the unclosed doors and windows when you Arm/Home Arm the system.

3. The system will be forced to Arm/Home Arm if you are using a remote controller, keypad, or RFID to operate the system, and you'll also get a push notification of unclosed doors and windows.

Battery replacement instructions

1. Insert the flat blade of a small screw-driver into the pry-off slot of the transmitter, and pry up to open the back cover.

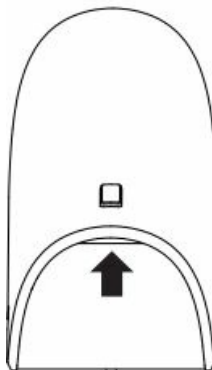

2. Replace with 1x CR123A battery.

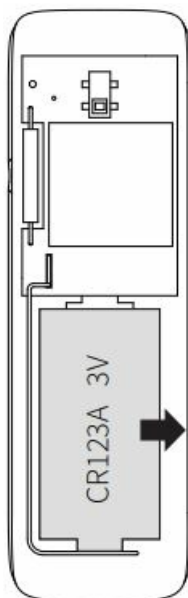

FCC Statement

This equipment has been tested and found to comply with the limits for a Class B digital device, under Part 15 of the FCC Rules. These limits are designed to provide reasonable protection against harmful interference in a residential installation. This equipment generates uses and can radiate radio frequency energy and, if not installed and used by the instructions, may cause harmful interference to radio communications. However, there is no guarantee that interference will not occur in a particular installation. If this equipment does cause harmful interference to radio or television reception, which can be determined by turning the equipment off and on, the user is encouraged to try to correct the interference by one or more of the following measures:

- Reorient or relocate the receiving antenna.
- Increase the separation between the equipment and the receiver.
- Connect the equipment to an outlet on a circuit different from that to which the receiver is connected.
- Consult the dealer or an experienced radio/TV technician for help.

This device complies with part 15 of the FCC Rules. Operation is subject to the following two conditions:

1. This device may not cause harmful interference.
2. This device must accept any interference received, including interference that may cause undesired operation.

Changes or modifications not expressly approved by the party responsible for compliance could void the user's authority to operate the equipment.

Features

1. The wireless contact sensor is an accessory of a smart alarm system.
2. Its fashion design, RF supervision, anti-tamper protection energy saving, and low battery warning are supported. The system will inform users to replace the battery in the App when needed.
3. It's easy to set up and works well with most doors and windows. When the transmitter and magnet are apart, the sensor triggers an alarm

Parameters

• Working Voltage	DC 3V
• Battery	1 × CR123A battery (3V)
• Working Current	≤100mA
• Standby Current	≤15μA
• Transmission Distance	Up to 1000m without obstacle
• Transmission Frequency	433.92MHz / 868.35MHz °C °C
• Working Temperature	-10 ~50
• Humidity	≤90%rh (non-condensing)
• Weight	23g(battery not included) 39g(battery included)
• Dimension	Transmitter: 84x26x22.5mm Magnet: 34x11x9.5mm (LxWxH)(±0.1mm)

Appearance

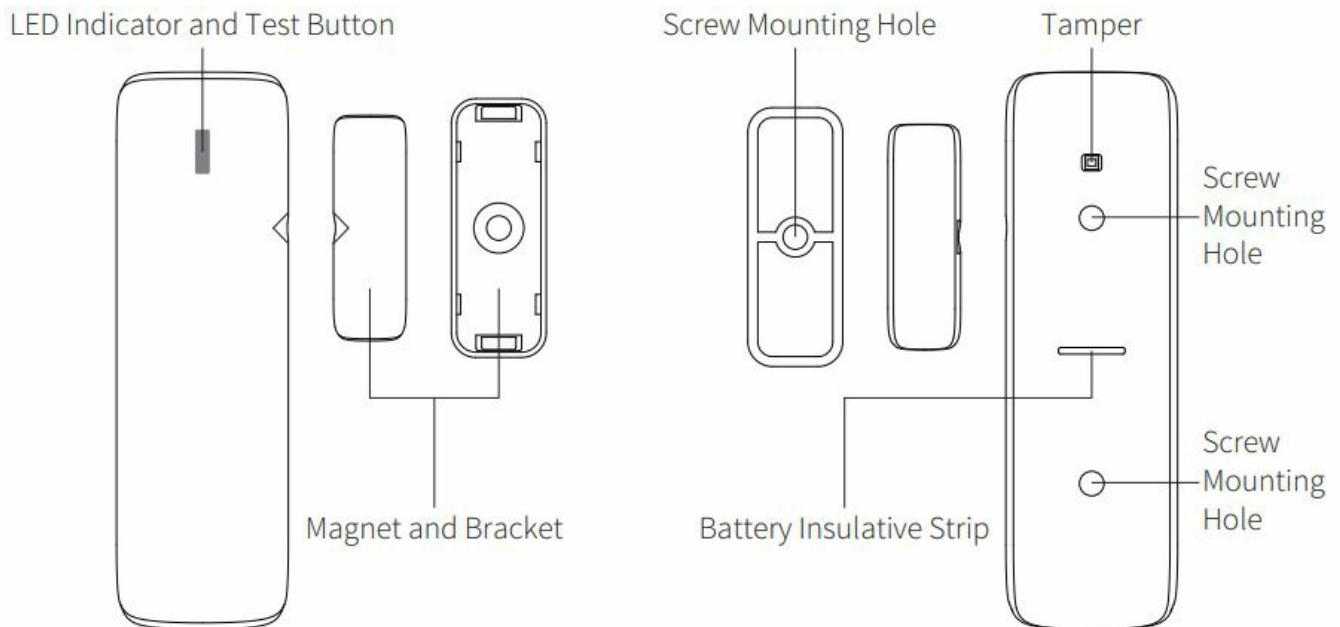

Corresponding the triangle of the magnetic stripe to the transmitter to get the best detection effect.

LED Indication

LED flashes once the door/window is opened and the transmitter sends a signal to the main panel. The LED indicator will light up once in 15 seconds in case of a low battery. Please replace the battery in time Push notification will be sent to your APP.

Operating Instructions

1. Working principle

The transmitter sends a trigger signal to the main panel paired when the magnet is moved apart.

2. Pairing with the main panel

Scanning the QR Code for Pairing.

1. Scan the QR code on this accessory.
2. The pairing result can be confirmed on the App.

Hint: How to trigger

- Remove the battery insulative strip.
- Move the magnet around the transmitter until the green LED indicator lights up.

Installation & Notice

- Pull out the battery insulative strip.
- Pairing to the main panel by the App before installing.
- Attach the transmitter and magnet separately on the door/window and its frame with double-sided sticky tape or fix it with screws. The transmitter can be put on either of the magnet's left or right sides.
- Make sure the distance between the transmitter and the magnet is less than 1cm and align horizontally.
- Avoid installing the sensors in areas with a large amount of metal or electric wire.
- Corresponding the triangle of the magnetic stripe to the transmitter to get the best detection effect.

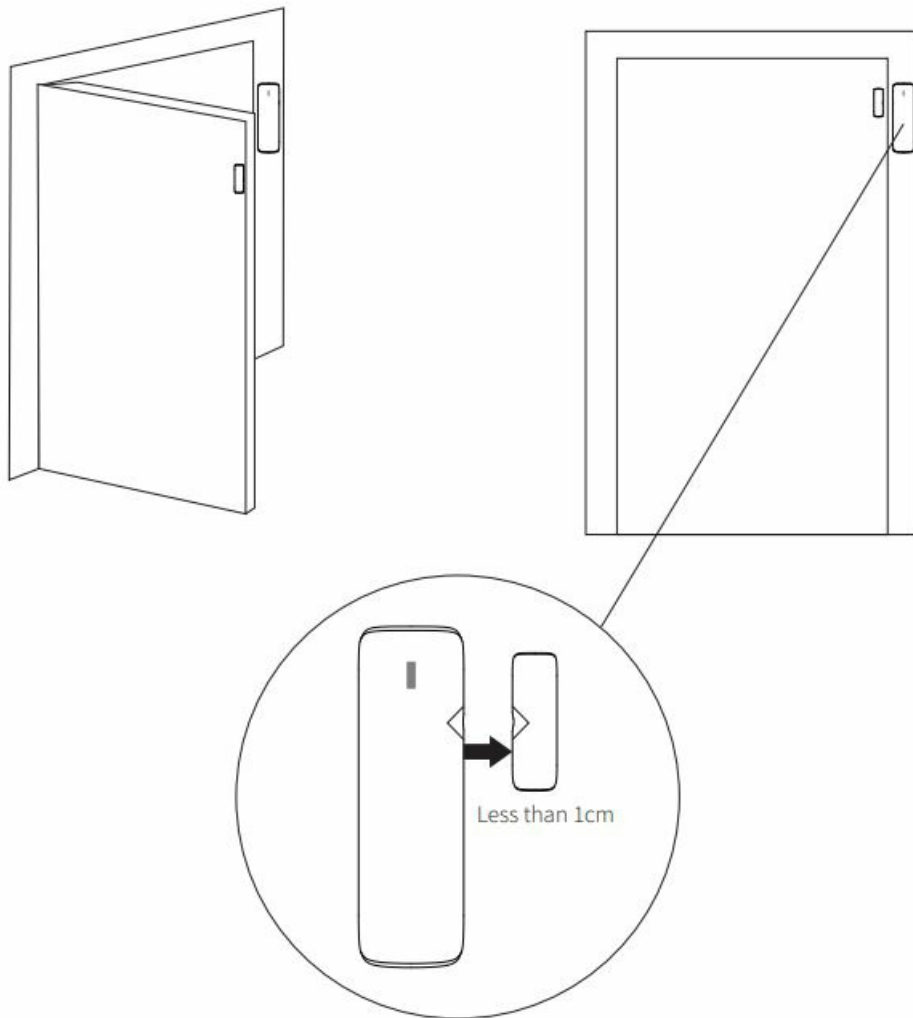

MADE IN CHINA

Documents / Resources



[DIVERSITECH Smart Door Sensor WiFi Wireless Door Window Detector](#) [pdf] User Manual
Smart Door Sensor WiFi Wireless Door Window Detector, Smart, Door Sensor WiFi Wireless Door Window Detector, WiFi Wireless Door Window Detector, Wireless Door Window Detector, Door Window Detector, Window Detector, Detector