



Ditec IP2269 Entrematic ZEN 2C Remote Control User Manual

[Home](#) » [Ditec](#) » Ditec IP2269 Entrematic ZEN 2C Remote Control User Manual 

Ditec IP2269 Entrematic ZEN 2C Remote Control



Contents

- 1 Factory default channel configuration
- 2 Manual configuration
- 3 Specification
- 4 All models
 - 4.1 [A] Direct programming
 - 4.2 [B] Battery save function enable-disable
 - 4.3 [C] Encoding type check
 - 4.4 [D] Battery replacement
- 5 Only models ZEN2C-ZEN4C
 - 5.1 [E] Factory RESET
 - 5.2 [F] Existing TX full duplication
 - 5.3 [G] manual code setting
 - 5.4 [H] Generic TX single-button duplication
- 6 Only models ZEN
(2/2B/2G/2R/2W/2Y/2MT/4/4W/4MT)
 - 6.1 [I] Add NEW TX by existing TX
 - 6.2 [J] Enable-disable AES encryption
- 7 EC and UK Declaration of Conformity
- 8 Documents / Resources
- 9 Related Posts

Factory default channel configuration

Manual configuration

Configuration with PC

Refer to Ditec ZEN Manager system documentation.

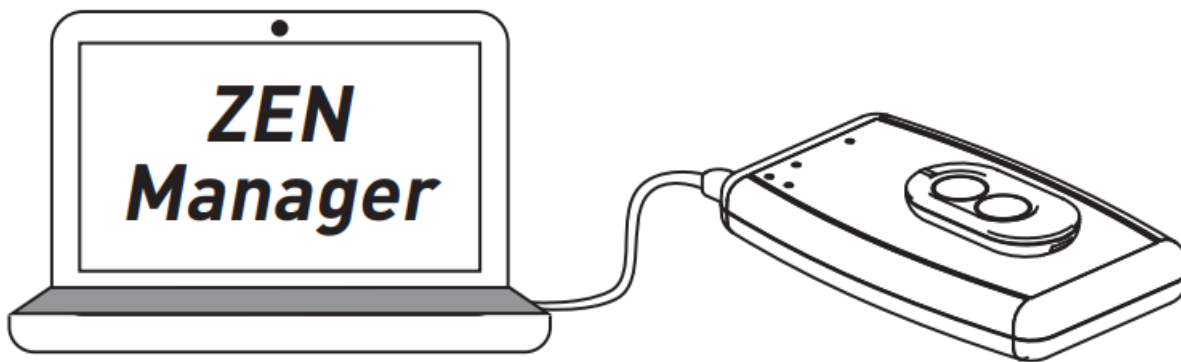

- Last version of this manual



Specification

Transmitters	Frequency	Radiated power	Type	Power supply	Channels	Range
ZEN2**	433,92MHz	< 1mW	Rolling code	Battery type CR2032	2	50-150m
ZEN4***					4	
ZEN2C			Fixed code		2	
ZEN4C					4	
ZENP2 / ZEN P2MT	868,35MHz	< 1mW	AES-128 rolling code	 Use batteries of indicated type.	2	
ZENP4 / ZEN P4MT					4	

[**] Models ZEN2, ZEN2B, ZEN2G, ZEN2R, ZEN2W, ZEN2Y, ZEN2MT

[***] Models ZEN4, ZEN4W, ZEN4MT

WARNING: Product contains coin/button cell battery



- Keep product and batteries away from children
- Battery can cause severe or fatal injuries in 2 hours or less if swallowed or placed inside any part of the body
- Seek immediate medical attention if it is suspected that a coin/button cell battery has been swallowed or placed inside any part of the body.

All models

[A] Direct programming

1. Activate Receiver Learning mode (refer to specific product manual)

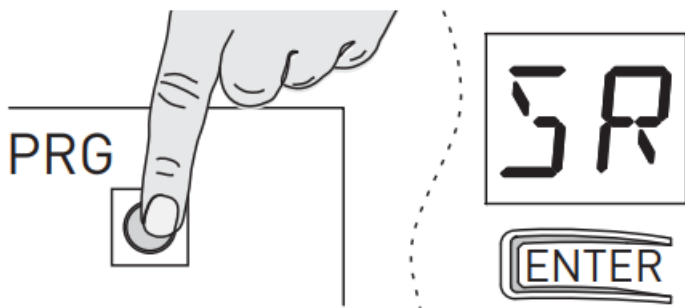

2. Press button on NEW TX

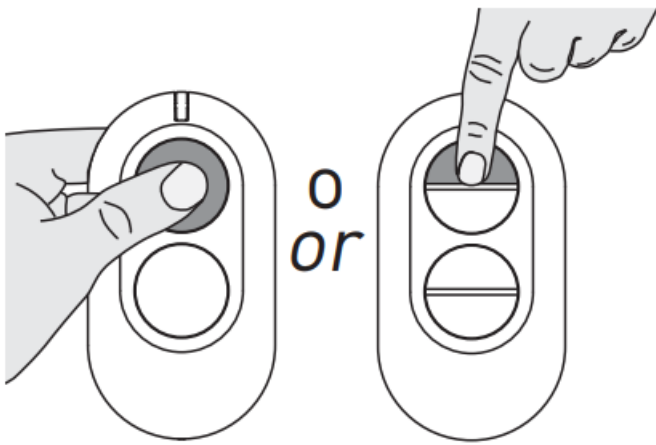

3. Wait

10s



[B] Battery save function enable-disable

1. Press simultaneously

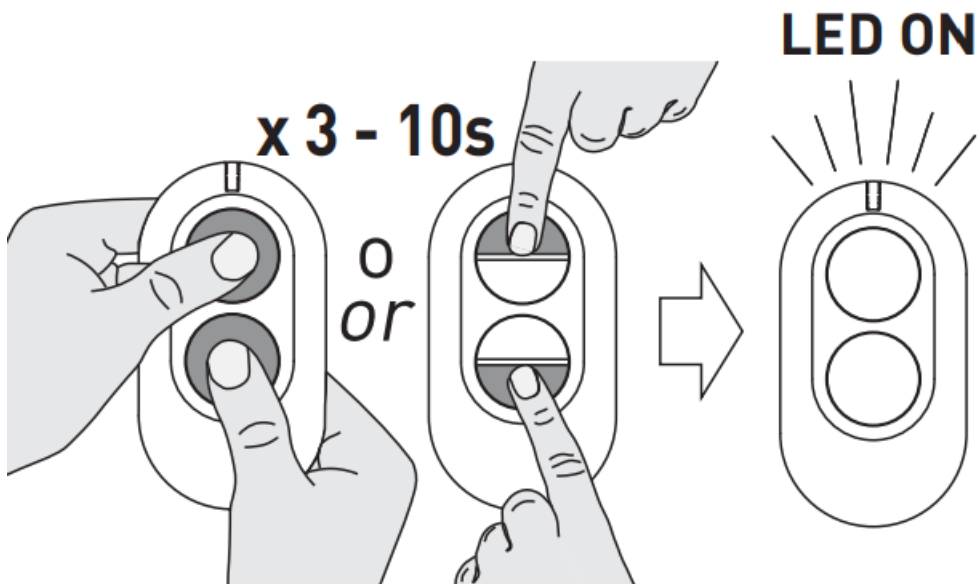

Factory enabled in all models



Do not use remote controls to perform hold-to-run operations

2. Enable

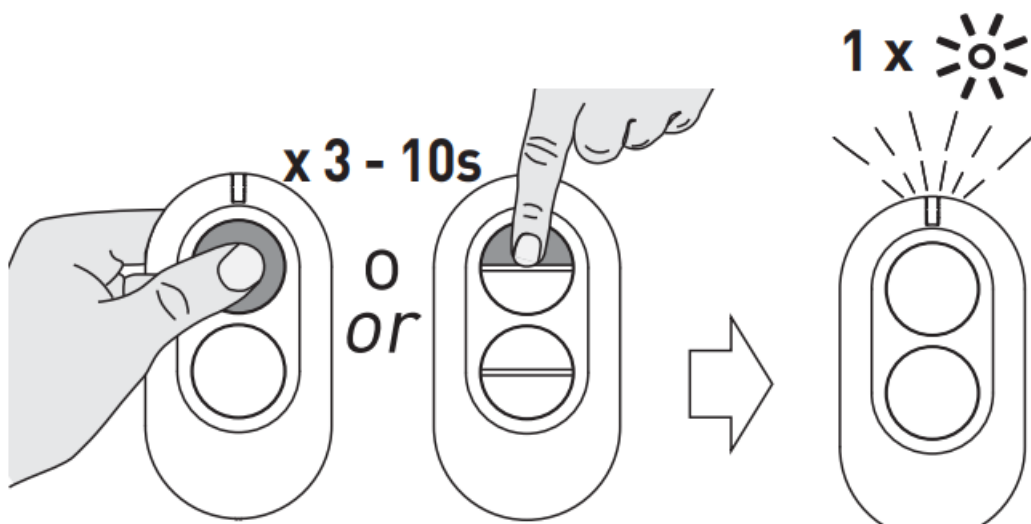

Disable

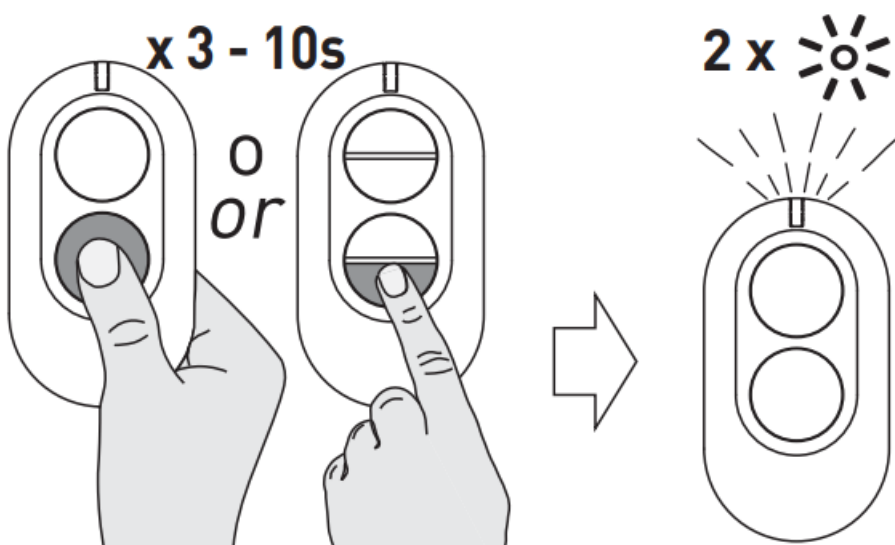

[C] Encoding type check

1. Keep pressed button to be checked

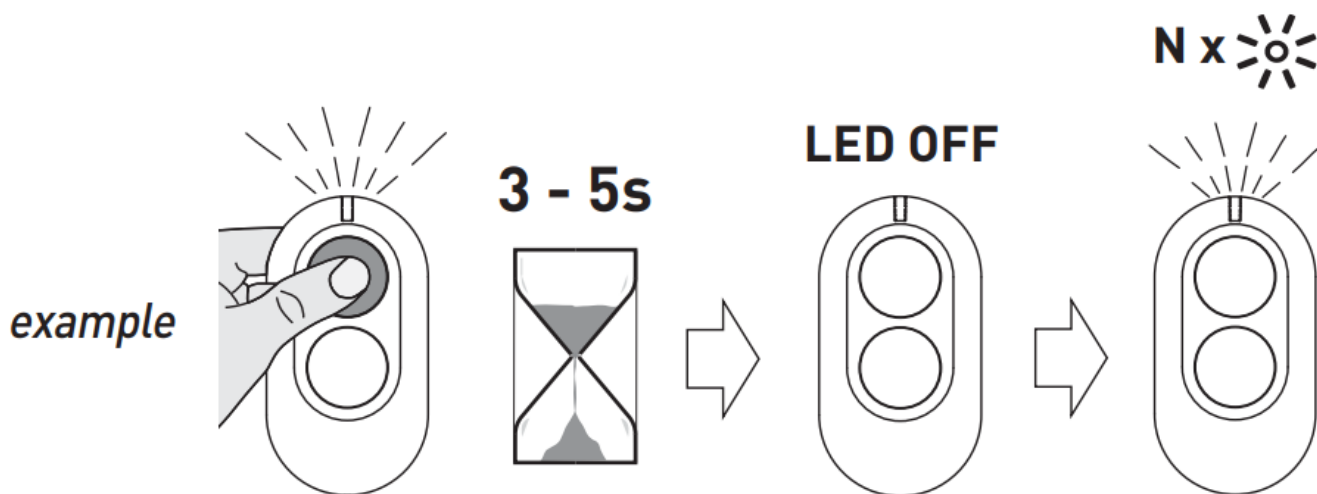

N	Encoding
0	Fixed code
1	“Dip-switch”
2	Rolling code
3	“MM53200” clone
4	AES
5	Protected

Battery save function must be enabled

[D] Battery replacement

1. Open housing

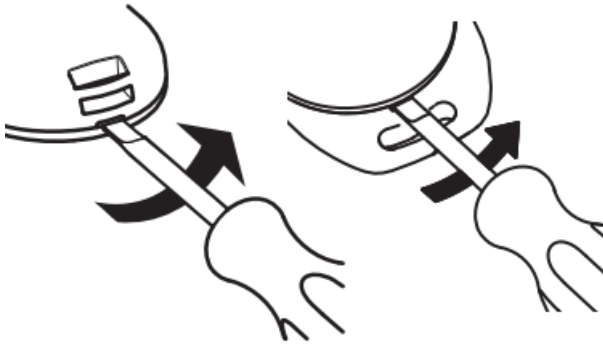

2. Take out battery

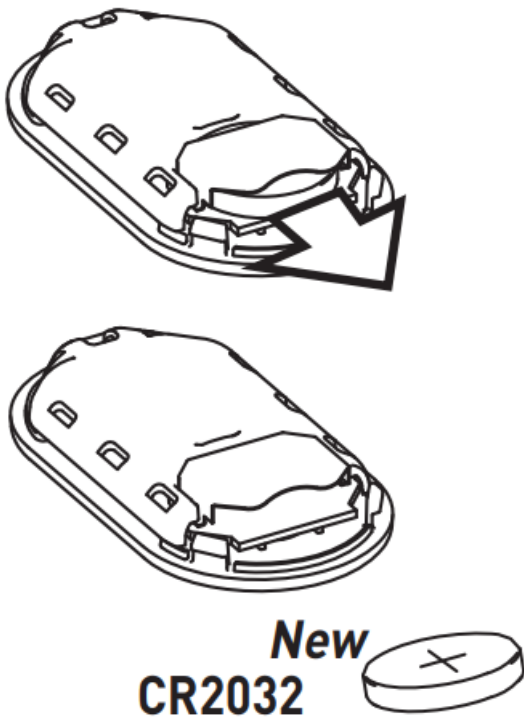

3. Insert new battery

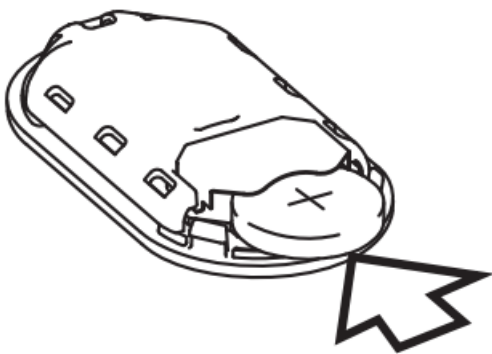

Only models ZEN2C-ZEN4C

[E] Factory RESET

1. Take out battery

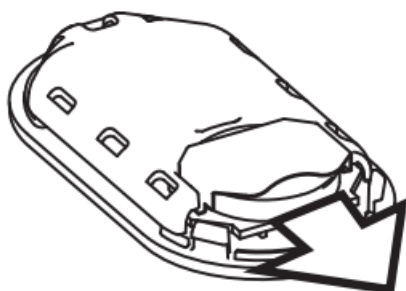

2. Keep pressed buttons as shown

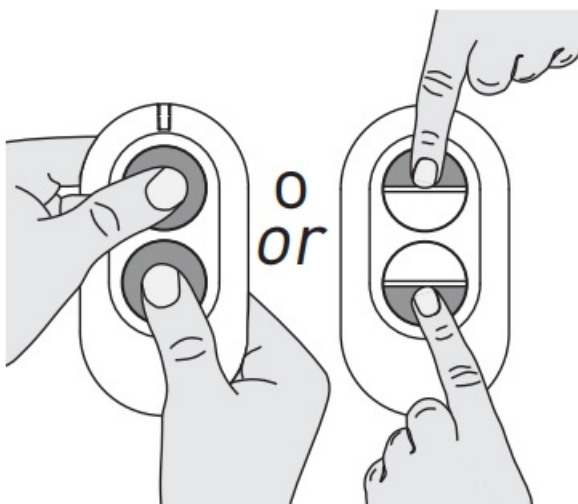

3. Keeping buttons pressed re-insert battery

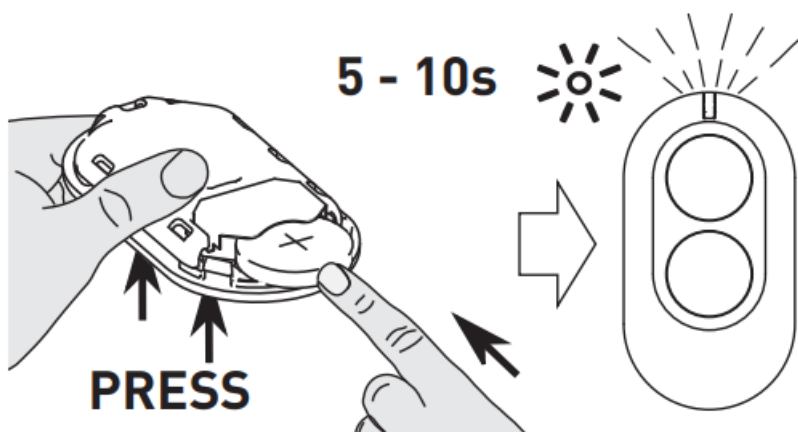

[F] Existing TX full duplication

1. With NEW TX

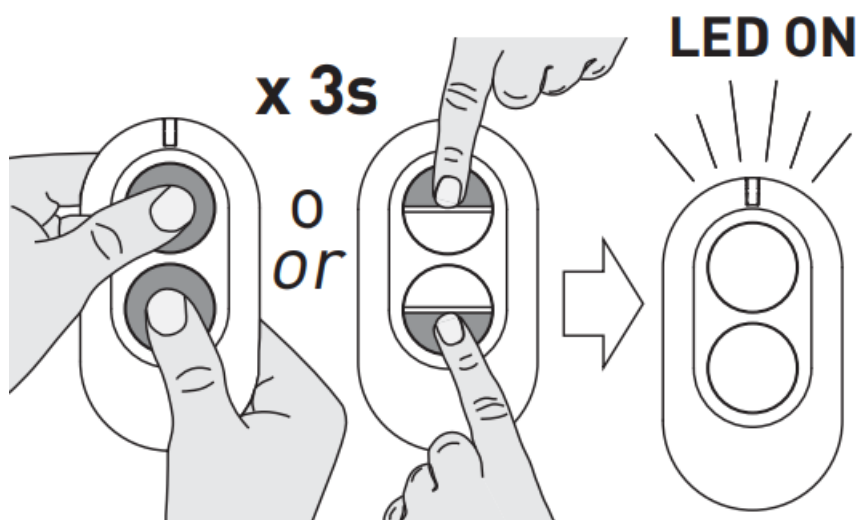

Also compatible with: BIXLS2

2. With EXISTING TX, within 10s

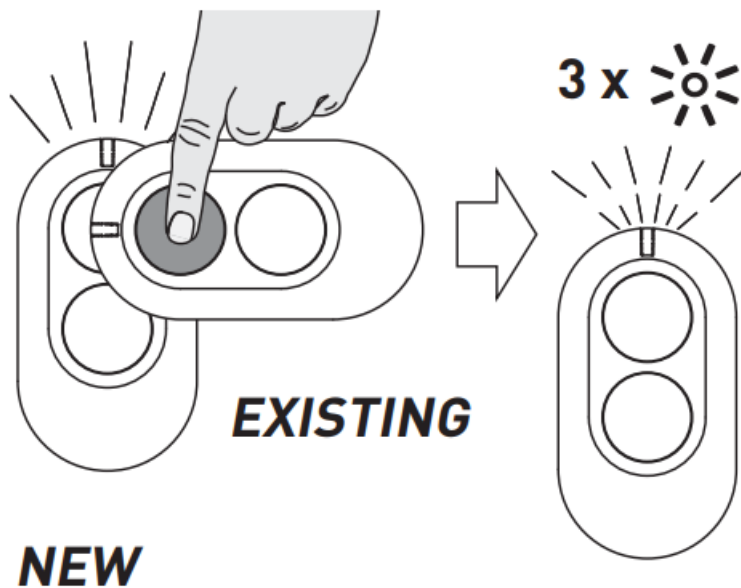

[G] manual code setting

1. With NEW TX

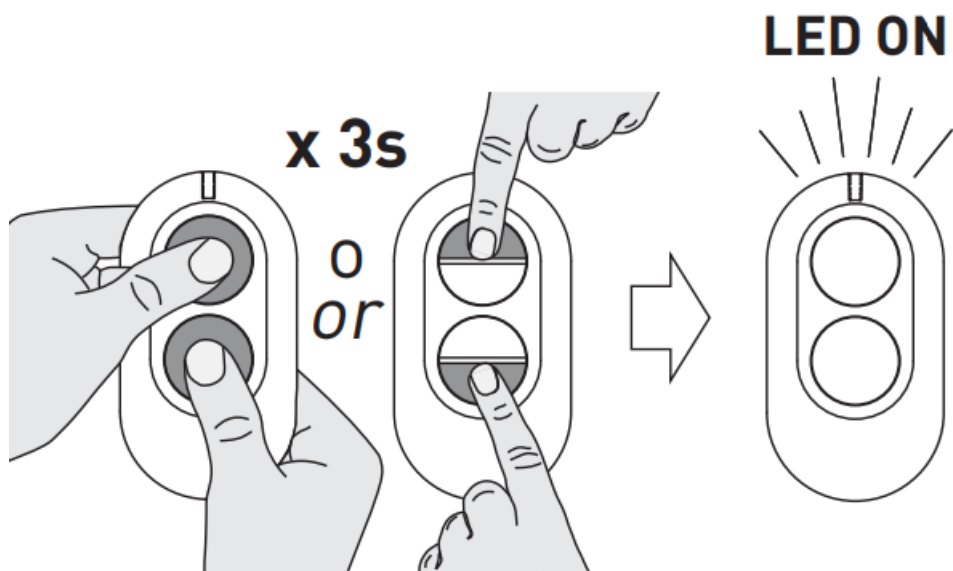

Example:

Code 0 1 0 0 1 0 0 1 0 0

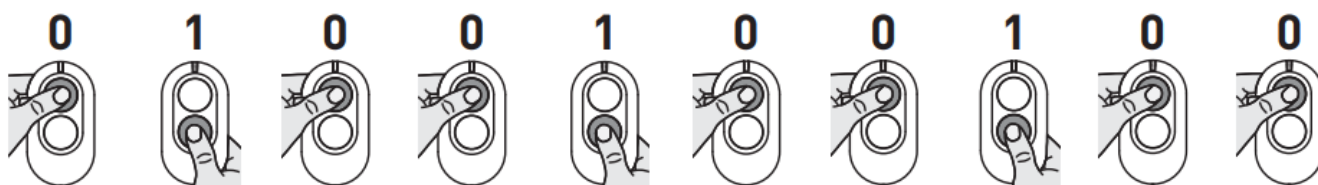

2. Insert sequence of ten "0" or "1" Confirmation blinks:

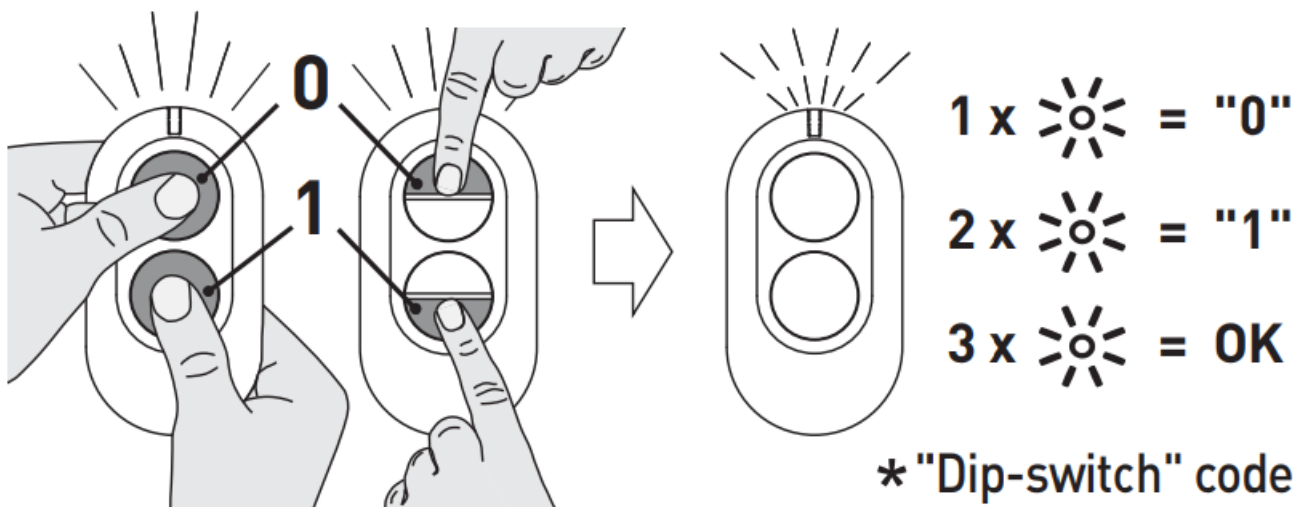

[H] Generic TX single-button duplication

1. With NEW TX

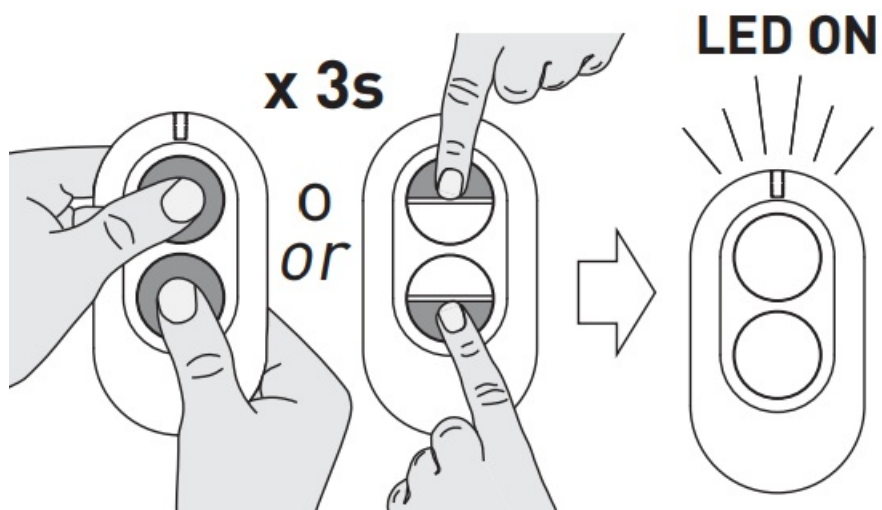

2. Again with NEW TX, within 10s

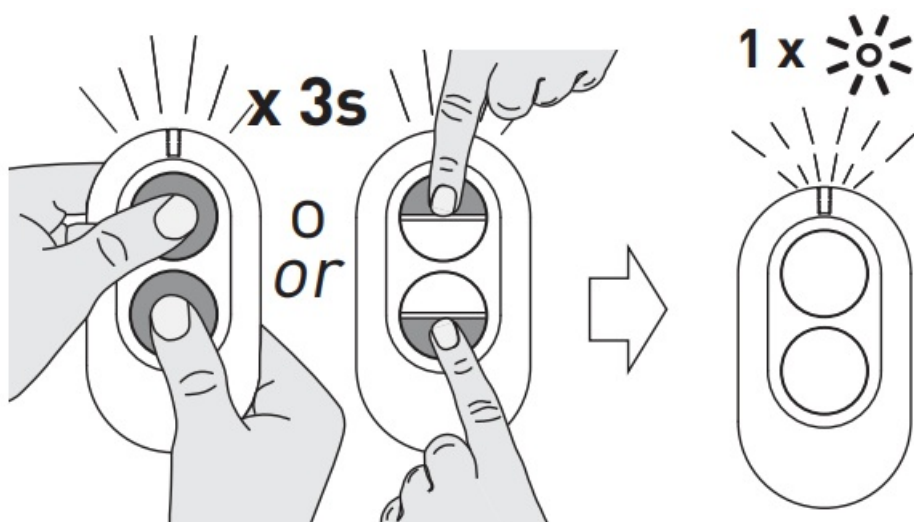

3. Press and release button on NEW T on which duplicate generic TX (example)

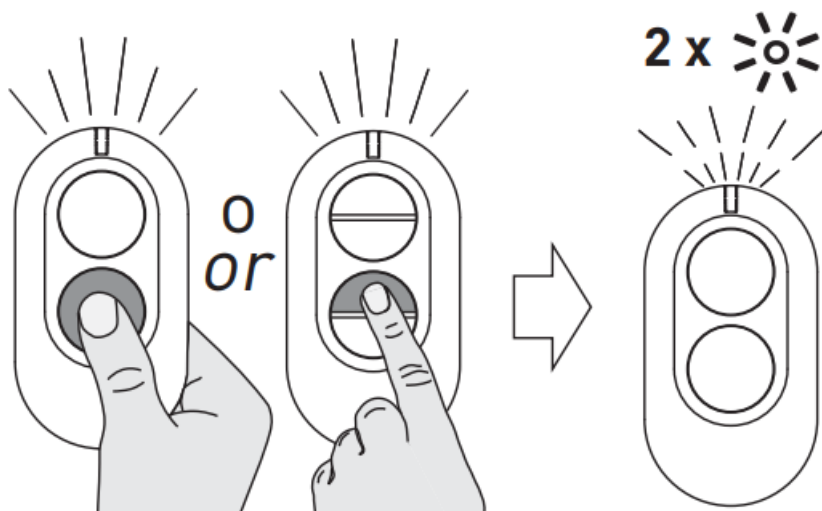

4. Within 10s press desired button on generic TX

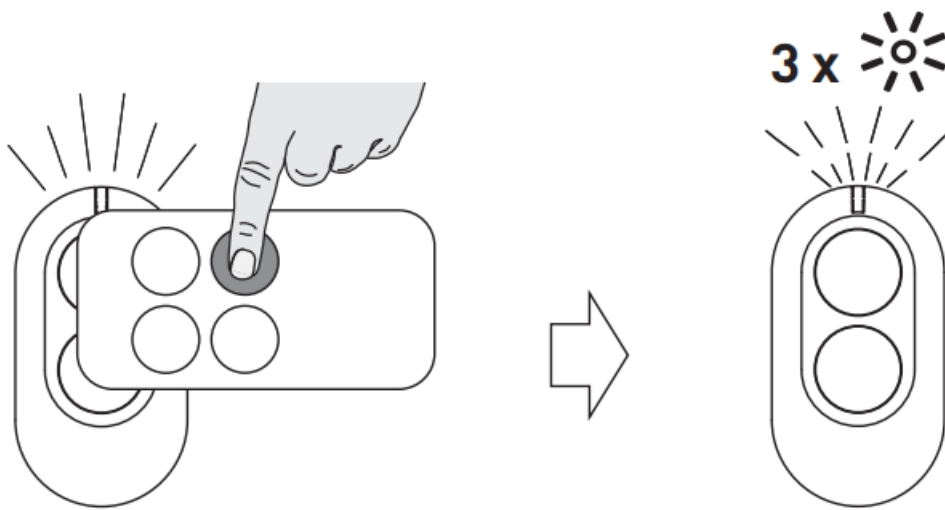

Compatible with 433MHz products with "MM53200" encoding or similar

Only models ZEN (2/2B/2G/2R/2W/2Y/2MT/4/4W/4MT)

[I] Add NEW TX by existing TX

1. Go near the gate

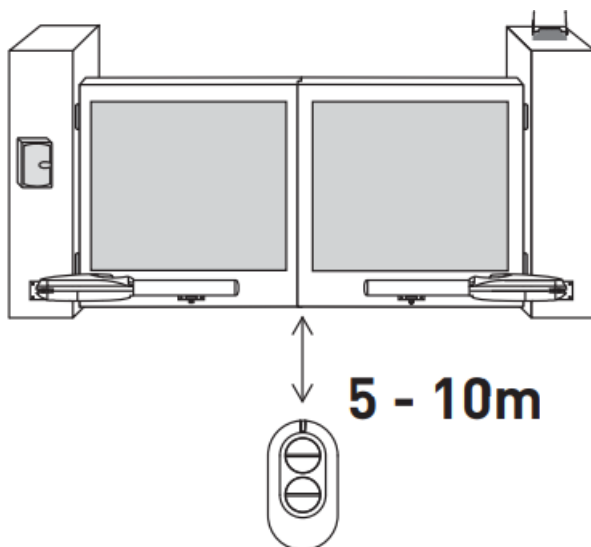

2. With EXISTING (programmed) TX

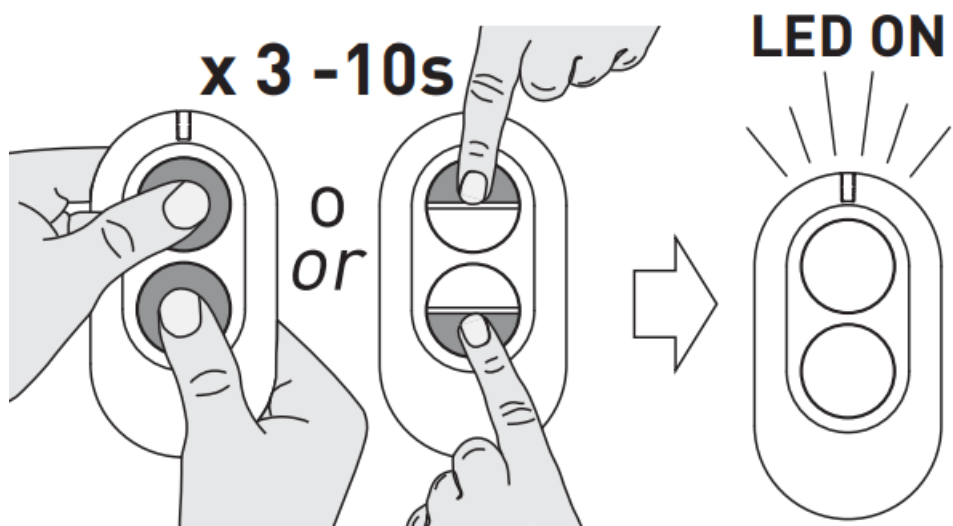

3. Again with EXISTING TX

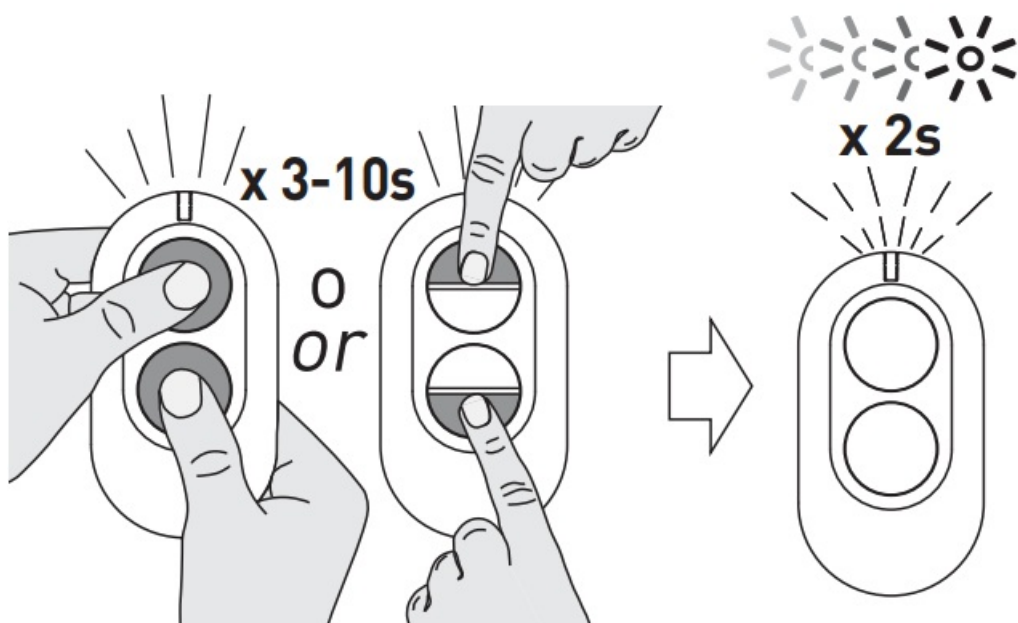

4. With NEW TX, within 10s

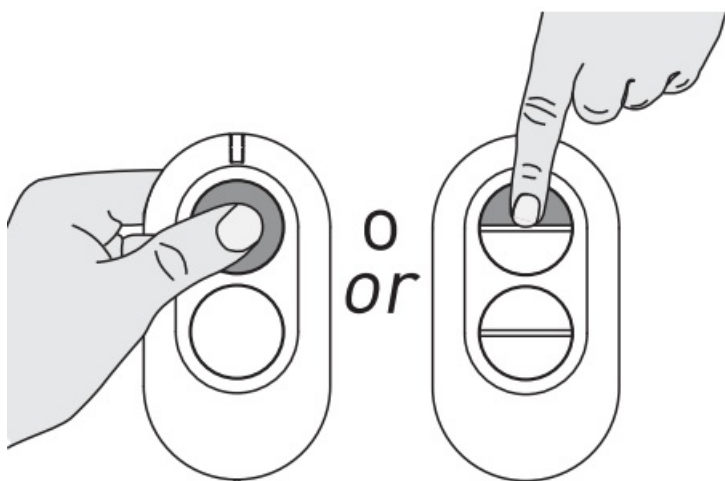

5. Wait

10s



[J] Enable-disable AES encryption

1. Take out battery

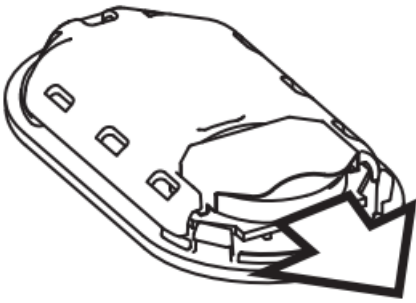

2. Keep pressed button as shown

Case a) buttons 1 / 1-2

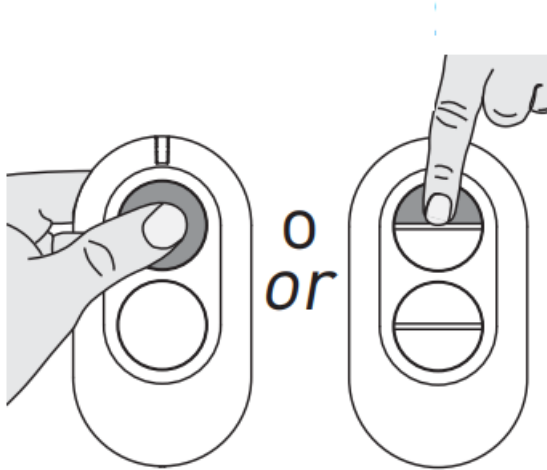

Case b) buttons 2 / 3-4

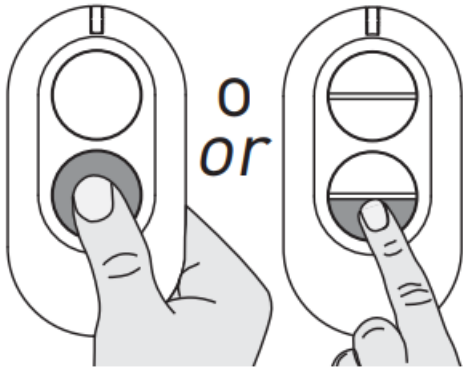

3. With button pressed re-insert battery

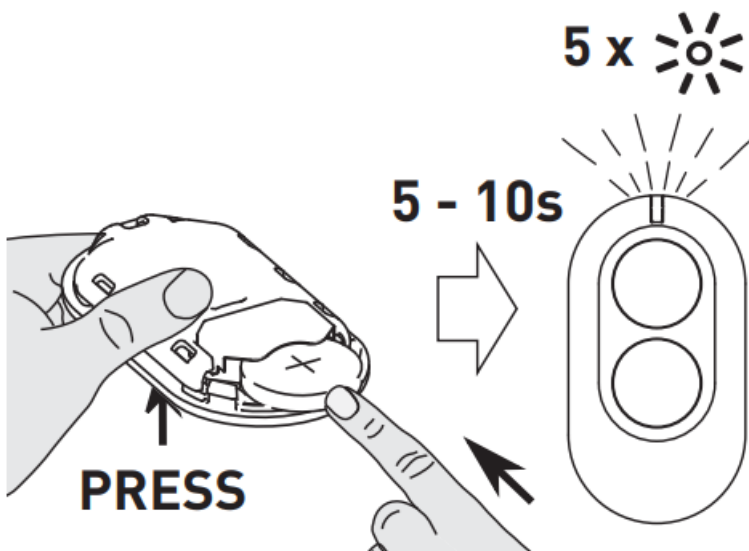

AES enabled-disabled on the indicated buttons

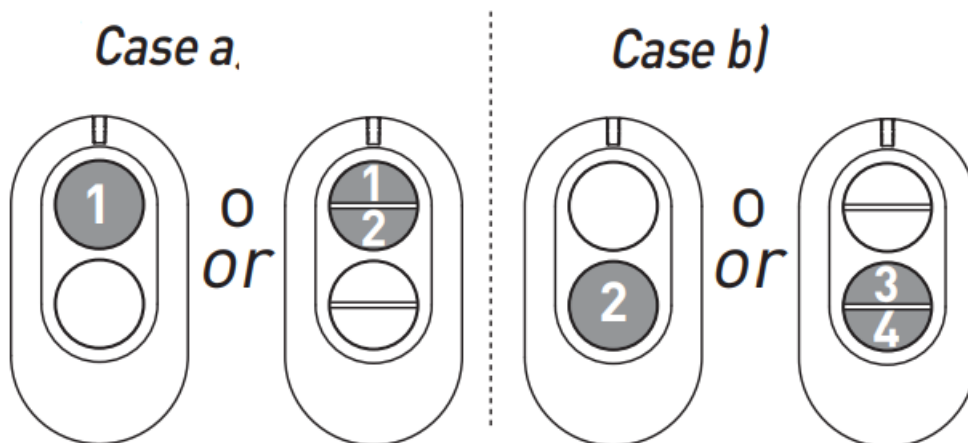

Mode verification

LED ON



The procedure toggles AES mode (ON-OFF-ON-OFF...). AES decoder available only on new generation receivers or control units – refer to specific product manual

EC and UK Declaration of Conformity

The manufacturer, ASSA ABLOY Entrance Systems AB, with registered office at Lodjursgatan 10, SE-261 44 Landskrona, Sweden declares that the type of radio equipment ZEN2/ZEN2B/ZEN2C/ZEN2G/ZEN2R/ZEN2W/ZEN2Y/ZEN2MT/ZEN4/ZEN4C/ZEN4W/ZEN4MT/ZENP2/ZENP2MT/ZENP4/ZENP4MT complies with:

EC Directive

RED Directive 2014/53/UE

UK Regulations

Radio Equipment Regulations 2017



The crossed-out wheeled bin symbol indicates that the product should be disposed of separately from

household waste. The product should be handed in for recycling in accordance with local environmental regulations for waste disposal.

By separating a marked item from household waste, you will help reduce the volume of waste sent to incinerators or landfill and minimize any potential negative impact on human health and the environment.

Technical data subject to change without notice



ASSA ABLOY Entrance Systems AB

Lodjursgatan 10
SE-261 44, Landskrona
Sweden
© ASSA ABLOY



Documents / Resources

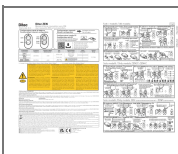

[Ditec IP2269 Entrematic ZEN 2C Remote Control](#) [pdf] User Manual
IP2269, Entrematic ZEN 2C Remote Control, ZEN 2C Remote Control, Entrematic Remote Control, Remote Control, Entrematic ZEN 2C, Control