



**INT121 A-LT Droid
Custom Astromech
Unit**



Disney INT121 A-LT Droid Custom Astromech Unit Instructions

[Home](#) » [DISNEY](#) » Disney INT121 A-LT Droid Custom Astromech Unit Instructions 

Contents

- [1 Disney INT121 A-LT Droid Custom Astromech Unit](#)
- [2 Product Specifications](#)
- [3 Product Usage Instructions](#)
- [4 FAQ](#)
- [5 CUSTOM ASTROMECH UNIT A-LT UNIT](#)
- [6 INSTRUCTIONS](#)
- [7 FCC STATEMENT](#)
- [8 CONTACT](#)
- [9 Documents / Resources](#)
 - [9.1 References](#)
- [10 Related Posts](#)



Disney INT121 A-LT Droid Custom Astromech Unit



Product Specifications

- **Main Device:** Droid
- **Main Device Power:** 6 AA 1.5V Batteries (included)
- **Remote Control:** Included
- **Remote Control Power:** 2 AAA 1.5V Batteries (included)
- **RF Exposure Requirement:** General
- **Portable Use:** Yes, without restriction

Product Usage Instructions

Main Device (Droid)

1. Insert 6 AA 1.5V batteries into the battery compartment as per the battery diagram.
2. Ensure the batteries are properly aligned according to the polarity markings.
3. Turn on the main device using the designated power button.
4. Follow the user manual for specific instructions on operating the Droid.

Remote Control

1. Insert 2 AAA 1.5V batteries into the battery compartment following the battery diagram.
2. Make sure the batteries are inserted correctly based on the polarity indicators.
3. Use the remote control to interact with the main device and navigate its functions.

FAQ

- **Q:** Can I use rechargeable batteries with the device?
- **A:** It is recommended to use non-rechargeable batteries as specified in the user manual for optimal

performance.

- **Q:** What should I do if the device does not power on?
- **A:** Check the battery compartment for correct battery insertion and polarity. Replace with new batteries if needed.
- **Q:** Is it safe to use the device in close proximity to people?
- **A:** The device meets general RF exposure requirements and can be used in portable conditions without restrictions, ensuring safety during operation.

CUSTOM ASTROMECH UNIT A-LT UNIT

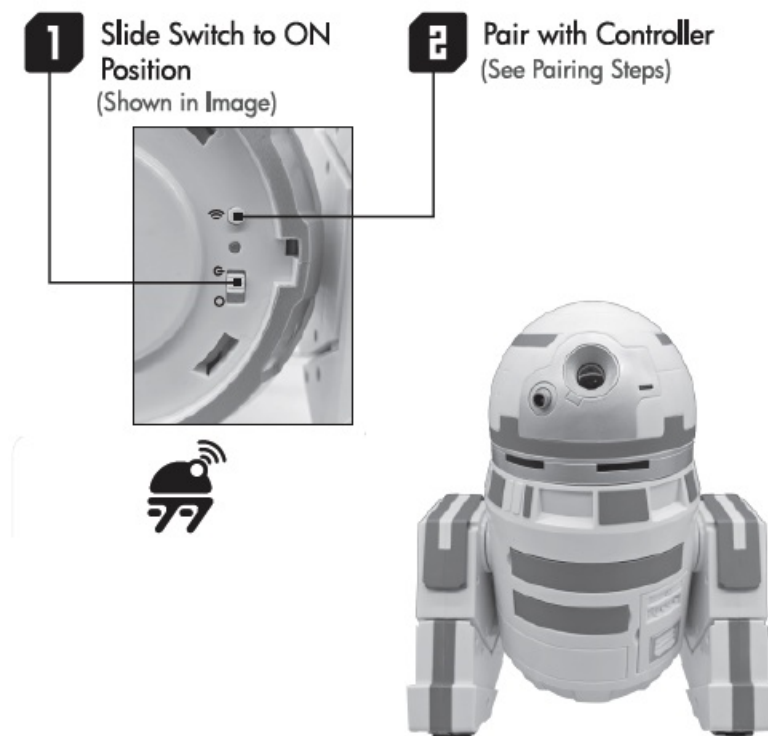

THIS DROID USES BLUETOOTH™ TECHNOLOGY TO COMMUNICATE WITH OTHER ASTROMECH DROID UNITS, THE DROID DEPOT MOBILE APP, AND CERTAIN OTHER ELEMENTS AND OBJECTS ON BATUU AND DISNEY PARKS AND RESORTS. TO LEARN MORE, VISIT:

<https://DISNEYLAND.DISNEY.GO.COM/FAQ/STAR-WARS-GALAXYS-EDGE/> OR

<https://DISNEYWORLD.DISNEY.GO.COM/FAQ/STAR-WARS-GALAXYS-EDGE/>

INSTRUCTIONS

Pairing Steps

1. Hold down the pairing button on the underside of the Droid body (as shown in the image). Release the button after the LED starts blinking.
2. Make sure the Remote Control is in the “OFF” position. While holding down the “Forward” and “Accessory” buttons together at the same time (as shown in the image), slide switch to the “ON” position. The LED on the Remote Control should start blinking.
3. When paired successfully, both the LED on the Droid and the Remote Control will turn off.

Hold Down Both Buttons Together To Pair

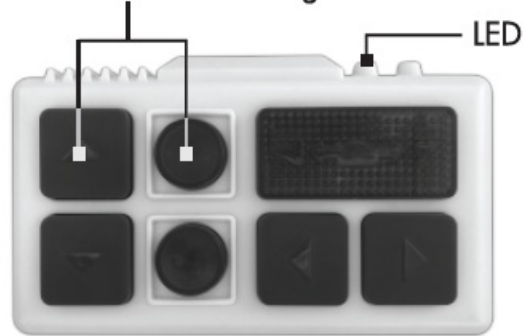

Controller

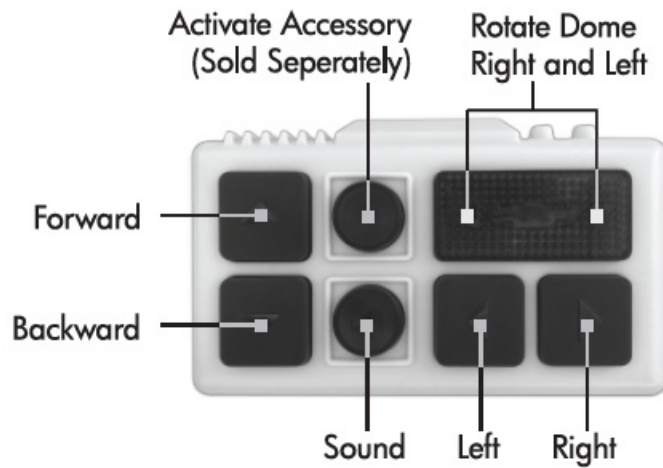

Sleep Mode



Note: Droid will go to sleep if not active on Batu or at home after 5 minutes. To wake up the droid, slide the power switch off and then back to on.

WARNING

CHOKING HAZARD-Small parts. Not for children under 3 years.

DROID BATTERY DIAGRAM

- Requires 6 AA 1.5V Batteries, Included.

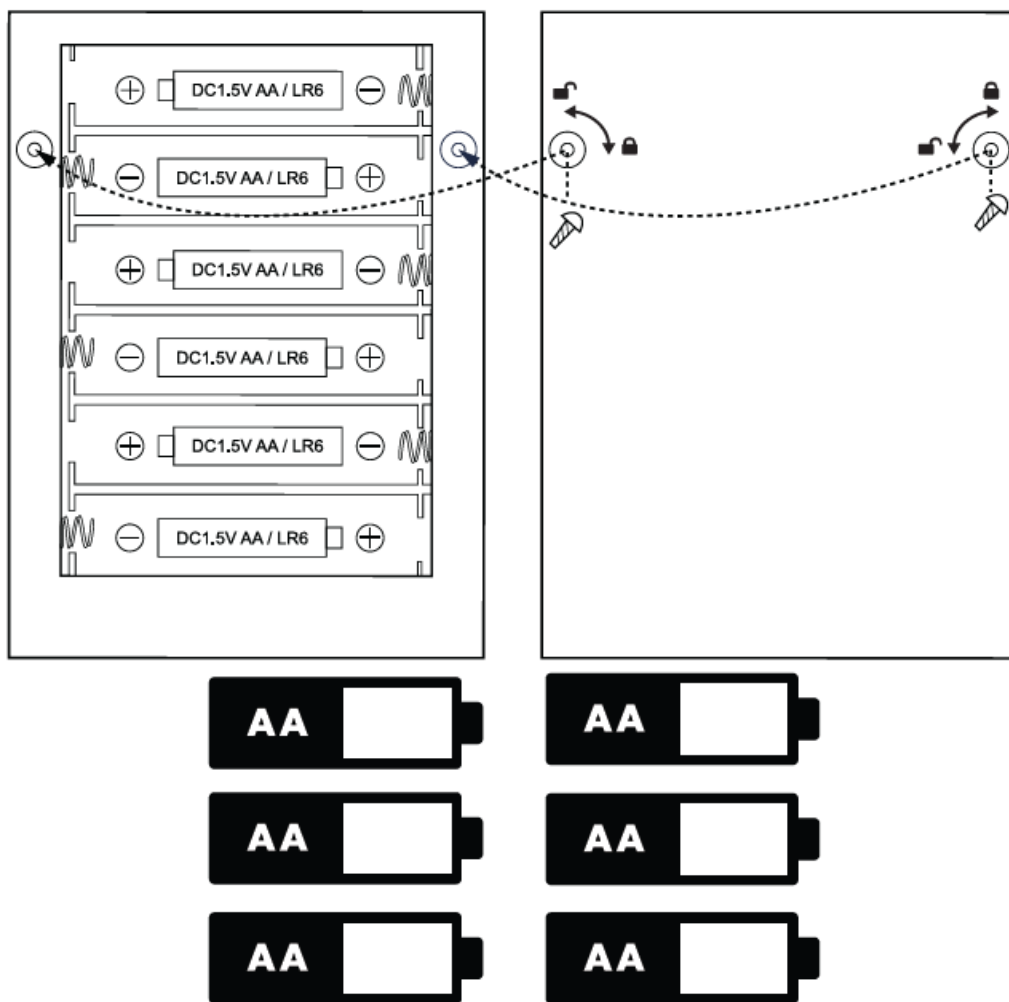

REMOTE BATTERY DIAGRAM

- Requires 2 AAA 1.5V Batteries, Included

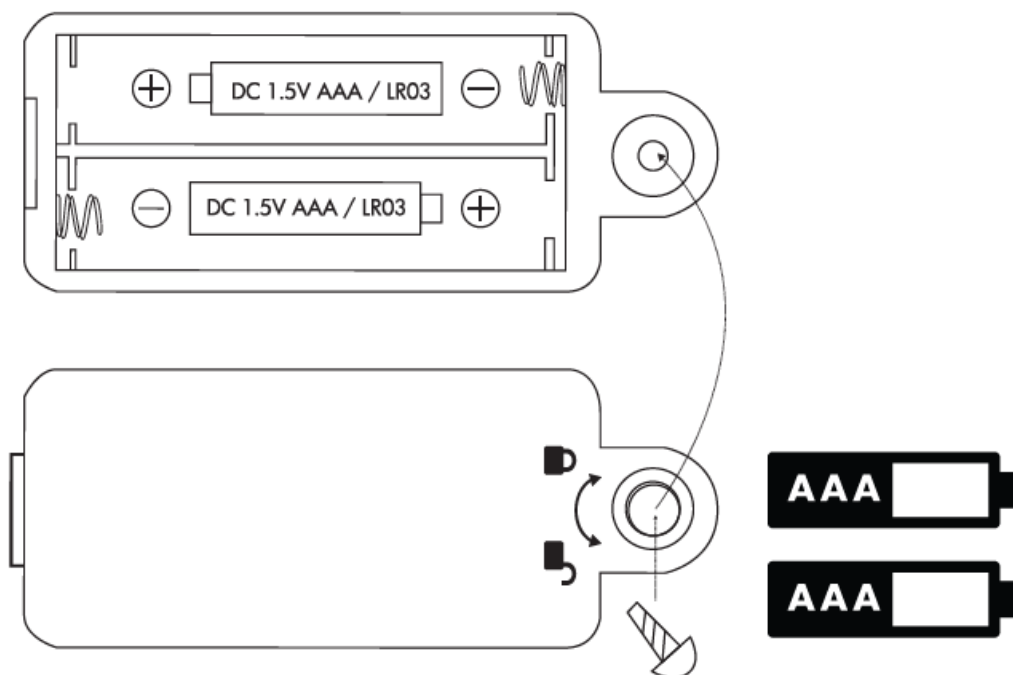

FCC STATEMENT

This device complies with part 15 of the FCC rules.

Operation is subject to the following two conditions:

1. This device may not cause harmful interference, and
2. this device must accept any interference received, including interference that may cause undesired operation.

CAUTION: Changes or modifications not expressly approved by the party responsible for compliance could void the user's authority to operate the equipment.

This is why we designed berthed decorate rection gins harmit interfere in rendered instalation. This guitar entertains, uses, and can rodiate radio regency energy and if no insole and used under the instructions, may cause harmful interference to radio communications However, there is no guarantee that interference will not occur in a particular installation.

If this equipment does cause harmful interference to radio or television reception, which can be determined by turning the equipment off and on, the user is encouraged to try to correct the interference by one or more of the following measures:

- Reorient or relocate the receiving antenna.
- Increase the separation between the equipment and the receiver.
- Connect the equipment to an outlet on a circuit different from that to which the receiver is connected.
- Consult the dealer or experienced radio / TV technician for help.

Disney hereby declares that this RC car complies with the essential requirements and other relevant provisions of directive 1999/5/EC.

CONTACT

Distributed by

- Disney Theme Park Merchandise
- Lake Buena Vista, FL 32830
- www.Disney.com
- © Disney © & TM Lucasfilm Ltd.
- Made in China

Documents / Resources

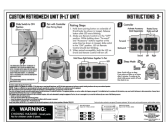

[Disney INT121 A-LT Droid Custom Astromech Unit](#) [pdf] Instructions
INT121, INT121 A-LT Droid Custom Astromech Unit, A-LT Droid Custom Astromech Unit, Droid Custom Astromech Unit, Astromech Unit, Unit

References

- [User Manual](#)

[Manuals+](#). [Privacy Policy](#)

This website is an independent publication and is neither affiliated with nor endorsed by any of the trademark owners. The "Bluetooth®" word mark and logos are registered trademarks owned by Bluetooth SIG, Inc. The "Wi-Fi®" word mark and logos are registered trademarks owned by the Wi-Fi Alliance. Any use of these marks on this website does not imply any affiliation with or endorsement.