



DISCOVERY CH43 Multi Purpose Headlamp User Guide

[Home](#) » [Discovery](#) » DISCOVERY CH43 Multi Purpose Headlamp User Guide 

Contents

- 1 DISCOVERY CH43 Multi-Purpose Headlamp
- 2 Product Usage Instructions
- 3 OVERVIEW
- 4 BATTERY
- 5 ON OFF
- 6 INSTALLATION
- 7 SPECIFICATION
- 8 Documents / Resources
 - 8.1 References
- 9 Related Posts

DISCOVERY

DISCOVERY CH43 Multi-Purpose Headlamp



CH43 Multi-Purpose HeadlampProduct Information

The CH43 Multi-Purpose Headlamp is a versatile and reliable lighting solution designed for various activities and environments. It features multiple light modes and a compact design for ease of use.

- **Red Light:** The headlamp includes a red light mode, which is useful for preserving night vision or signaling.
- **Flood Light and Spot Light:** The headlamp offers both flood light and spotlight modes, allowing you to adjust the beam according to your needs.
- **NiMH Compatible:** The CH43 Multi-Purpose Headlamp is compatible with NiMH batteries, providing an energy-efficient option for extended use.
- **High, Medium, and Low Modes:** The headlamp offers three brightness levels – High, Medium, and Low, allowing you to choose the appropriate level of illumination for your activity.
- **Red Flashing Mode:** In addition to a steady red light, the headlamp also features a red flashing mode for emergency situations or increased visibility.
- **Water Resistant:** With an IPX4 rating, the headlamp is resistant to splashes of water from any direction, making it suitable for outdoor use.
- **Shock Proof:** The CH43 Multi-Purpose Headlamp is built to withstand shocks and impacts, ensuring durability during rugged activities.
- **ANSI FL1 Standard:** The headlamp's performance specifications adhere to the ANSI FL1 Standard, providing reliable and consistent measurements.
- **Lumens, Beam Distance, and Run Time:** The headlamp produces up to 150 lumens of light with a beam distance of 45 meters.
- **The run time varies depending on the selected mode:** High (8 hours), Medium (20 hours), and Low (36 hours).

Product Usage Instructions

1. Open the battery compartment by sliding the cover in the direction indicated.
2. Insert two X1 batteries or one X2 battery into the compartment, ensuring correct polarity.
3. Close the battery compartment securely.
4. To turn on the headlamp, locate the ON/OFF switch labeled A. Slide the switch to the ON position.
5. To cycle through the different light modes, press the switch labeled B. Each press will switch between Flood Light, Spot Light, and Red Light modes.
6. To adjust the brightness level, press and hold the switch labeled B. Release the switch when the desired level (High, Medium, or Low) is reached.
7. To activate the red flashing mode, press and hold the switch labeled B while in Red Light mode. Release the switch to revert to steady red light.
8. To turn off the headlamp, slide the ON/OFF switch labeled A to the OFF position.
9. When not in use, it is recommended to store the headlamp in a cool and dry place to prolong its lifespan.

For more information and support, visit gpbatteries.com.

OVERVIEW

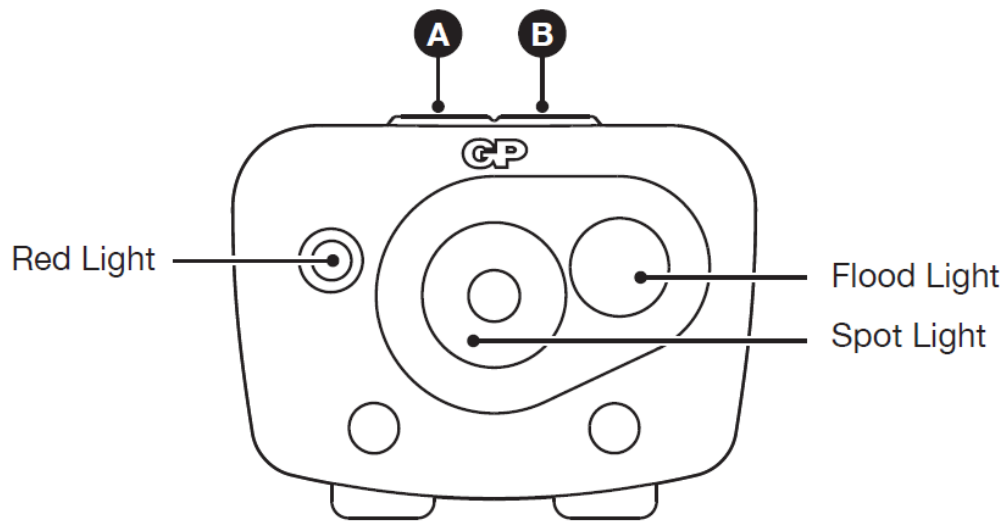

BATTERY

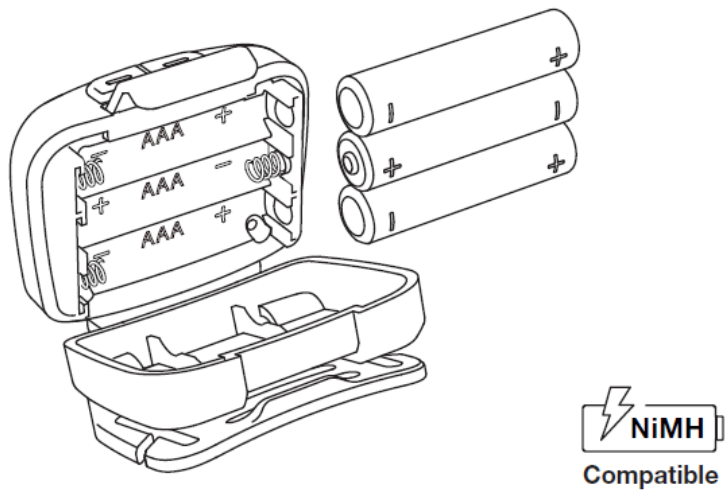

ON OFF

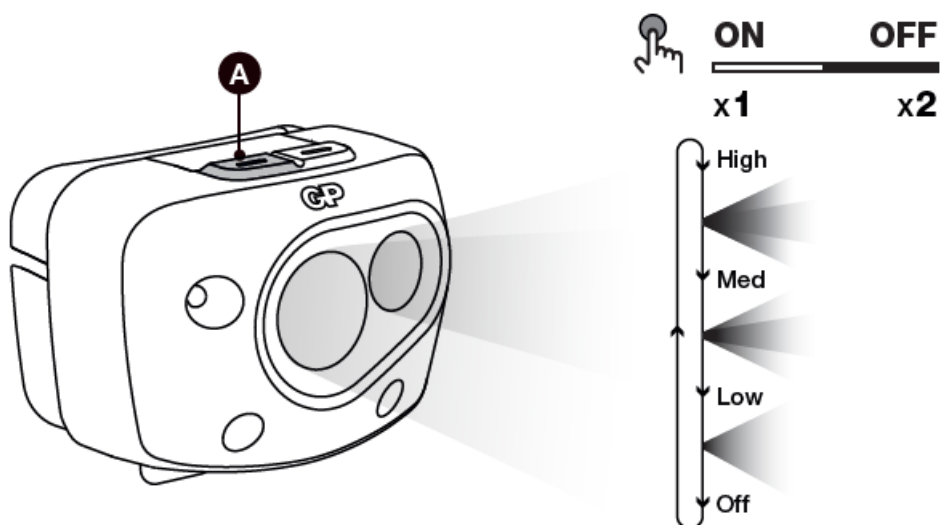

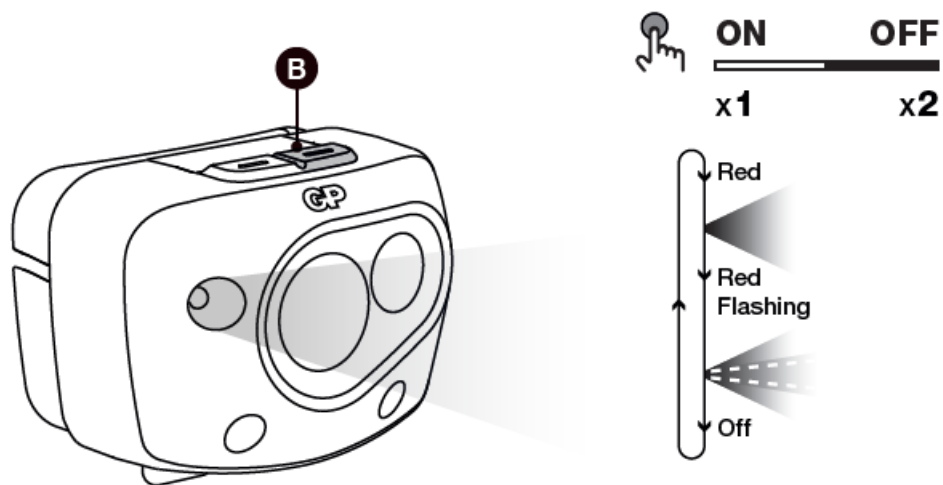



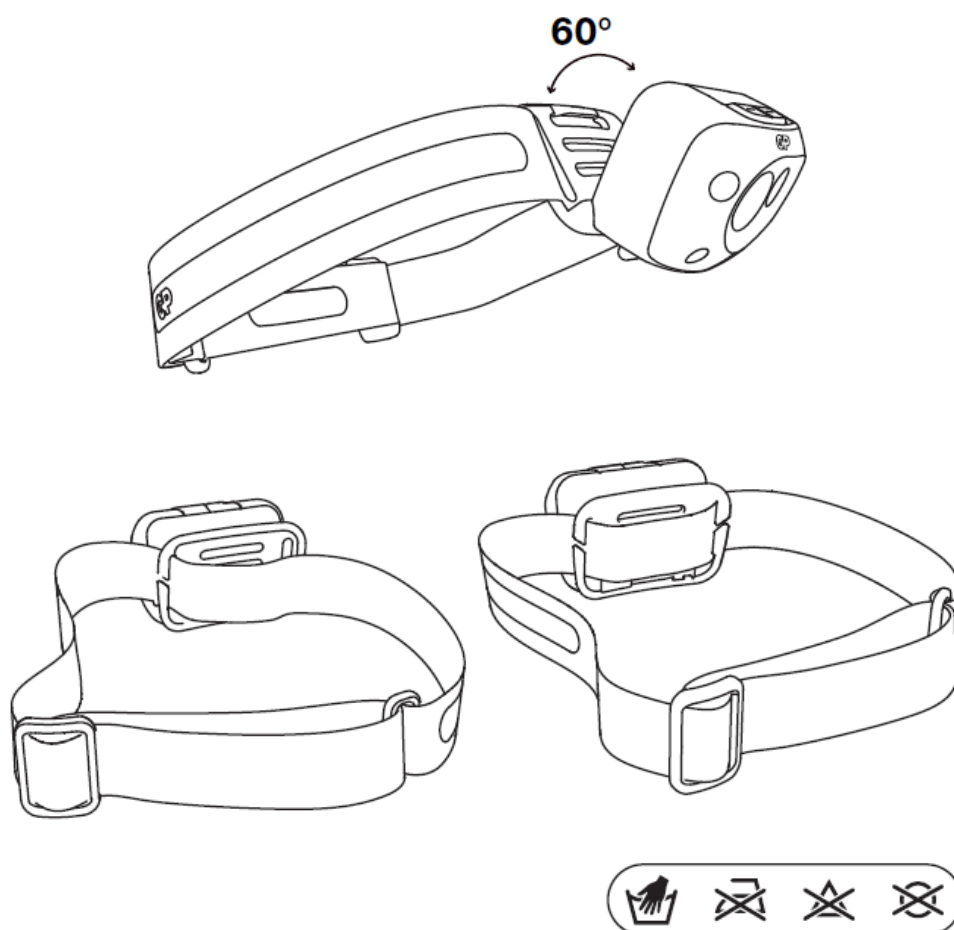

INSTALLATION



SPECIFICATION



gpbatteries.com

ANSI FL1 Standard	High	Med	Low
 Lumens (lm)	150	65	35
 Beam Distance (m)	45	30	20
 Run Time (h)	8	20	36
 Water Resistant	IPX4		
 Shock Proof	1m		

CAUTION!



Documents / Resources

	DISCOVERY CH43 Multi Purpose Headlamp [pdf] User Guide CH43, CH43 Multi Purpose Headlamp, Multi Purpose Headlamp, Purpose Headlamp, Headlam p
---	--

References

-  [GP Batteries International](#) | [GP Batteries International](#)