



Dirt Devil DDS04-E01 Multi Function Steam Cleaner User Guide

[Home](#) » [Dirt Devil](#) » Dirt Devil DDS04-E01 Multi Function Steam Cleaner User Guide 

Dirt Devil DDS04-E01 Multi Function Steam Cleaner



Contents

- [1 Important Information](#)
- [2 Overview](#)
- [3 BEFORE USE](#)
- [4 ASSEMBLY](#)
- [5 HOW TO USE](#)
- [6 CARE & MAINTENANCE](#)
- [7 TROUBLESHOOTING](#)
- [8 GUARANTEE](#)
- [9 Customer Support](#)
- [10 Documents / Resources](#)
 - [10.1 References](#)
- [11 Related Posts](#)

Important Information



Warning



BASIC SAFETY PRECAUTIONS

This steamer is intended for household use only and NOT for commercial or industrial use.

- Only use the steamer indoors and keep the area you're cleaning well lit.
- Keep fingers, hair and loose clothing away from moving parts and openings whilst using the steamer.
- This steamer can be used by persons with reduced physical, sensory or mental capabilities or lack of experience and knowledge if they have been given supervision or instruction concerning use of the appliance in a safe way and understand the hazards involved.
- Children shall not play with the steamer. Cleaning and user maintenance shall not be performed by children without supervision.
- Please refer to floor manufacturer's care recommendations before use, and test your flooring/carpet/rugs by running the steamer over a small hidden area, if no pile distortion or no damage occurs continue cleaning. Not suitable for use on wax polished floors or furniture, acrylic surfaces and synthetic, velvet or steam/water sensitive materials
- This steamer should not be used to clean electrical appliances such as microwaves, televisions and electrical heating systems etc.
- Only Dirt Devil recommended cloths and accessories should be used with this steamer. This steamer is a water only product, using detergents will invalidate the guarantee.

DON'TS

- Don't touch any hot areas/ accessories on your steamer.
It's normal for the steamer and accessories to heat up during use, always allow them to cool down before handling.
- Don't leave the steamer turned on when unattended.
- Don't use the steamer if it has been dropped, damaged, immersed in water or left outdoors.
- Don't run over the power cord or use steamer if the power cord or plug is damaged. Please contact our Customer Care Line.
- Don't handle the plug or use the steamer with wet hands. Don't pull or carry the steamer by the power cord.
- Don't use the power cord as a handle, don't pull the power cord around corners or sharp edges or close a door over the power cord.



- Don't unplug the steamer by pulling on the power cord.
- Don't attempt to remove blockages
with sharp objects as this may cause damage to the steamer, remove blockages only as instructed in this guide.
- Don't aim the steamer at people, animals, plants and electrical components or wires. Never touch the steam jet (there is a risk of scalding).
- Don't use the steamer with incorrect voltage as this may result in damage or injury to the user. The correct voltage is listed on the ratings label.
- Don't use the steamer to clean or refresh any items of clothing that are still being worn on the body.

DO'S

- Always fill the water tank with water only. Never add perfume, stain remover or products containing alcohol. Filling the water tank with hot or boiling water will damage the steamer and invalidate the guarantee.
- Always vacuum your carpets thoroughly and ensure hard floor areas are free from grit and debris before using your steamer.
- Always unplug the steamer and allow to cool before carrying out any maintenance.
- Turn off all controls on the steamer before disconnecting or connecting the power cord, after use always wrap the power cord around the cord clips.
- Take extra care when cleaning on the stairs.
- Always replace the fuse in the plug with a British 13amp fuse. Always protect the power cord from heated surfaces and open flames.
- Use only CE approved 13amp extension cords, non-approved extension cords can overheat. Care should be taken to arrange the extension cord as it could be a trip hazard.
- Store the steamer in a cool, dry area away from children. Before storing the steamer please make sure the water tank is thoroughly clean and empty.

Hi. Welcome.

Congrats on purchasing your new MULTI FUNCTION STEAM CLEANER. Inside, you'll find everything you want to know from tools to how to. So what are you waiting for? LET'S GO.™



Product Registration

Guarantee Registration

Be sure to register your product online at www.DirtDevil.co.uk

Hint: Attach your sales receipt to this User Guide. Verification of date of purchase may be required for warranty service of your Dirt Devil® product

For quick reference, please record your product information below.

Model #:

Serial number:

(serial number located on the back or bottom of product)

Overview

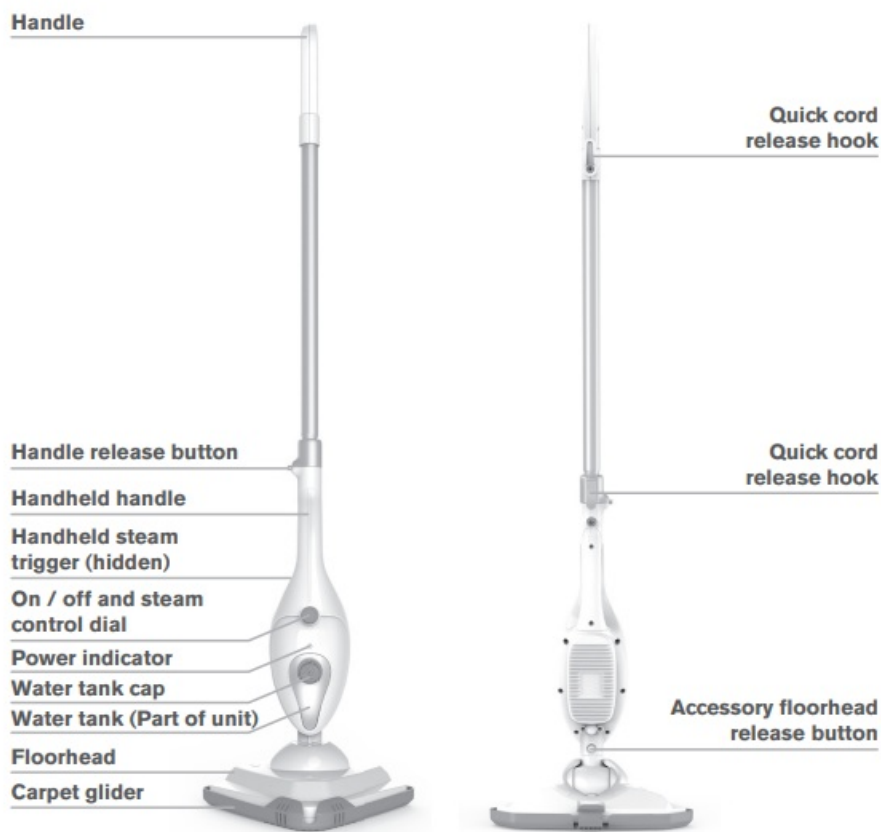

TECHNICAL OVERVIEW DATA

Type of appliance:

Multi function steam cleaner

Model name:

5-in-1 / 11-in-1

Model number:

DDS04-E01 / DDS04-P01

Voltage:

220-240V ~, 50 Hz

Power:

1500W

Water capacity:

330ml

Power cord length:

5m

Heat up time:

30secs

Steam time:

15mins

Weight:

2.1kg



We reserve the right to make changes to technical and design specifications in the interest of continuous product improvement.

© Dirt Devil.

INCLUDED WITH YOUR MACHINE

5-in-1

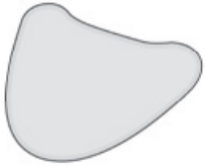

x1 Micro fiber Pad



x1 Carpet Glider / Cooling Tray



x1 Concentration Nozzle



x1 Small round brush



x1 Grout brush

11-in-1

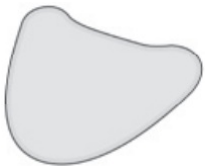

x2 Micro fiber Pad



x1 Carpet Glider / Cooling Tray



x1 Concentration Nozzle



x1 Small round brush



x1 Grout brush



x1 Utility Head



x1 Utility Head Pad

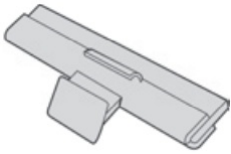

x1 Window Squeegee



x1 Measuring Cup



x1 Hose



x1 Metal Brush

BEFORE USE

before you begin cleaning

1. Test for colour fastness in a small hidden area of upholstery/fabric to check for colour removal before use.
2. When using the steamer, basic safety precautions should always be observed.
3. Don't aim the steamer at people, animals, plants and electrical components or wires. Never touch the steam jet or floorhead from a short distance (there is a risk of scalding).
4. The steamer is equipped with a thermostat and a thermal cut-out. If for any reason the steamer overheats it will switch off. If this happens turn off and unplug the steamer, allow to cool for at least 2 to 4 hours and re-try.
5. Don't use hot or boiling water to fill or clean water tank.



IMPORTANT: Please refer to floor manufacturer's care recommendations before use and test the steamer on a hidden area of flooring/surface to begin with.



caution

The steamer head gets very hot during use. Always switch off the steamer before emptying the water tank or changing the cleaning pads/accessories

ASSEMBLY

ASSEMBLING YOUR STEAMER

1. Push the main body down into the floorhead until it clicks into place.

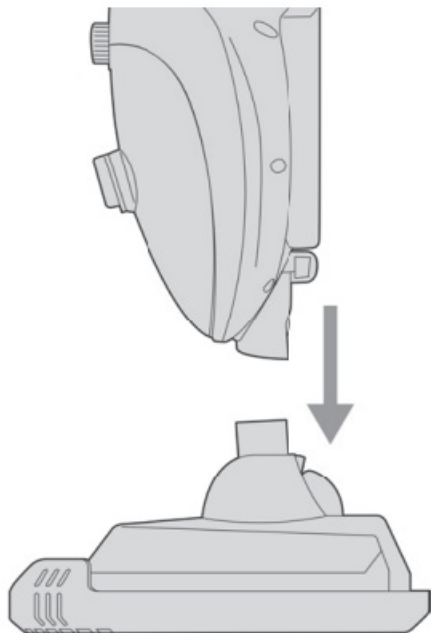

2. Push the handle into main body until it clicks into place.

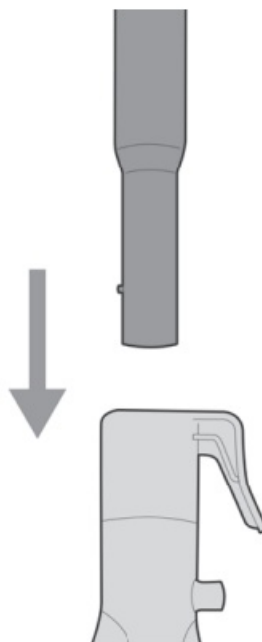

3. Stand the steamer upright by pushing the main body forward to lock into position.

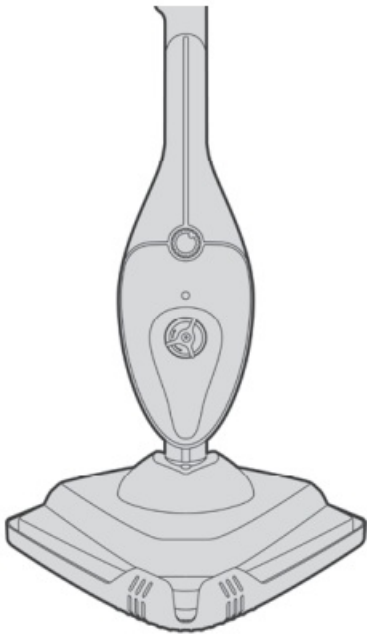

YOUR MULTI FUNCTION STEAM CLEANER IS READY TO CLEAN!



NEED HELP?

Go to www.DirtDevil.co.uk or
contact our Customer Service
Department at 0330 026 2626
(Mon-Fri 9:00am to 5:00pm)

HOW TO USE

FILL THE WATER TANK

1. Remove floorhead and handle and place steamer on flat surface. Twist water tank cap anti clockwise and lift to remove.

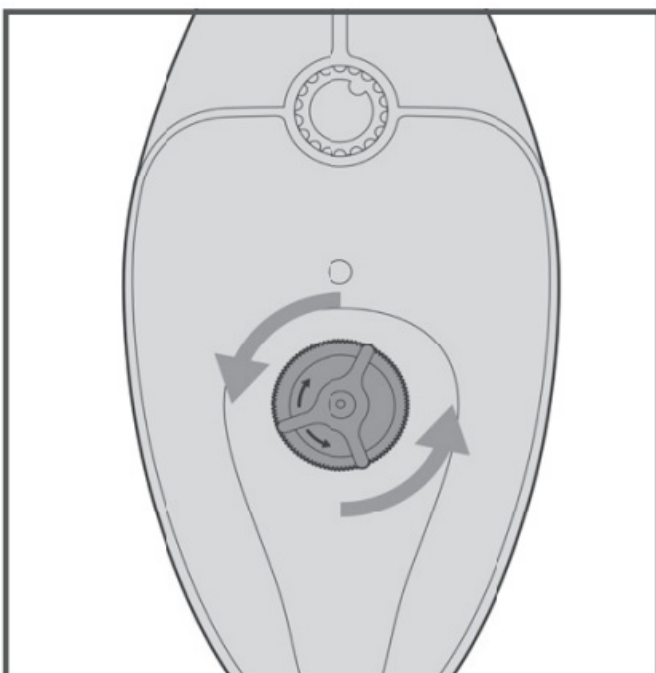

2. Do not fill directly from tap or over sink. Keep steamer on flat surface. Use the measuring jug and fill the tank with 330ml (2)

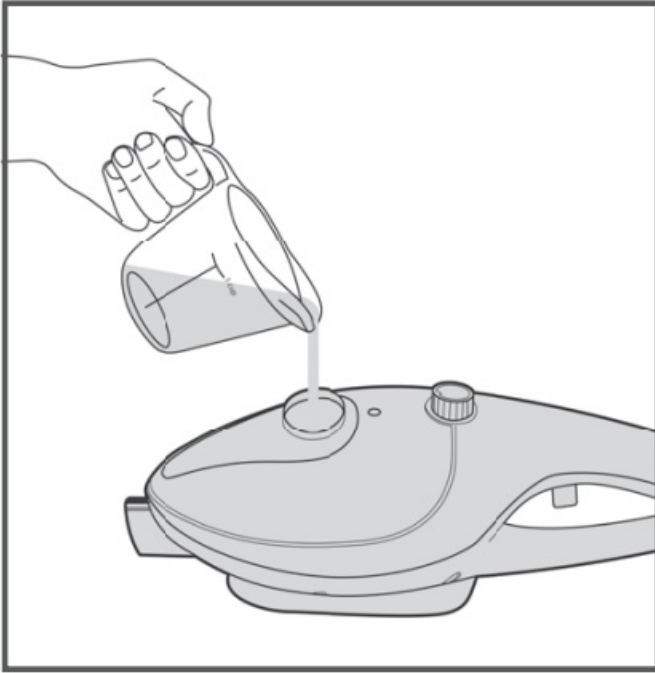

3. Replace cap, align tabs and twist clockwise to tighten.

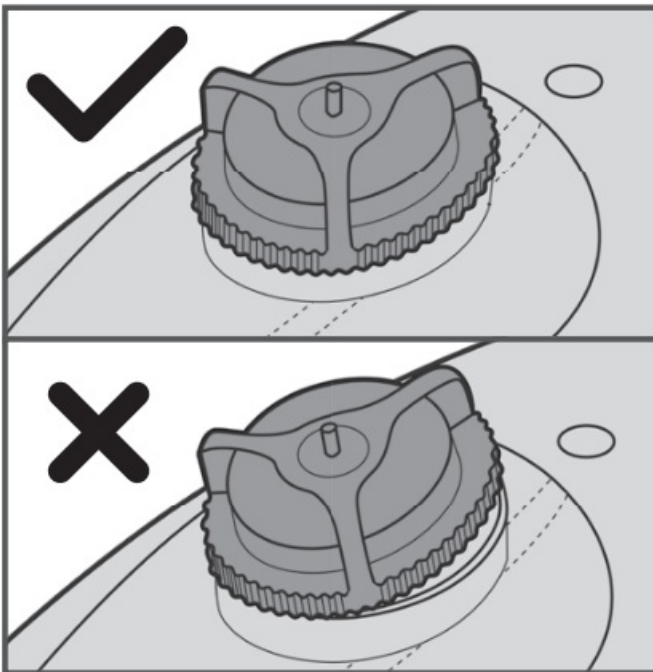

CLEAN HARD FLOORS

1. . Place the micro fiber pad on the floor white side facing up. Place the floorhead onto micro fiber pad making sure the micro fiber pad covers the entire floorhead.

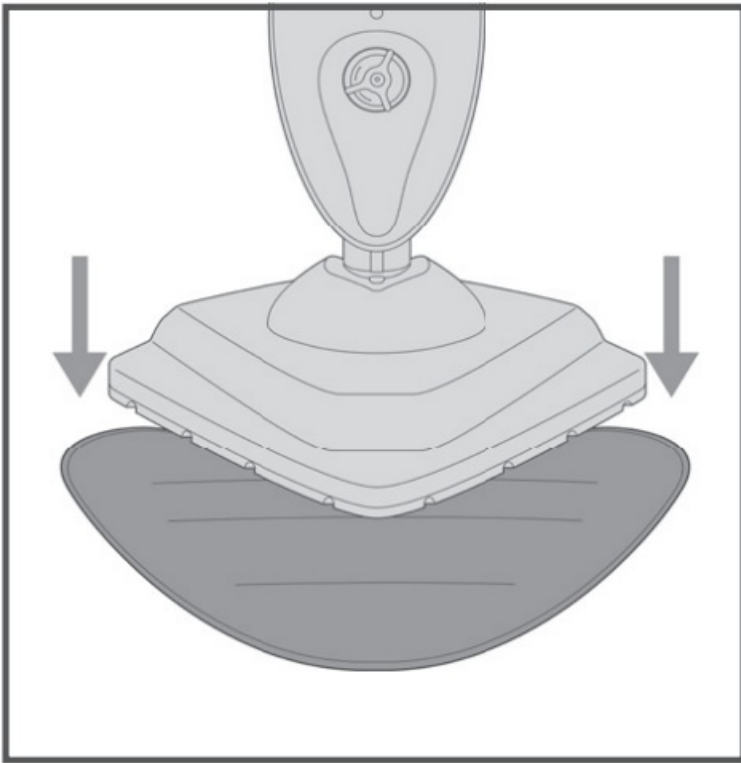

2. Plug into mains, turn dial to 'ON'; the amber light will illuminate to indicate power on. The steamer will be ready after approximately 30 seconds.

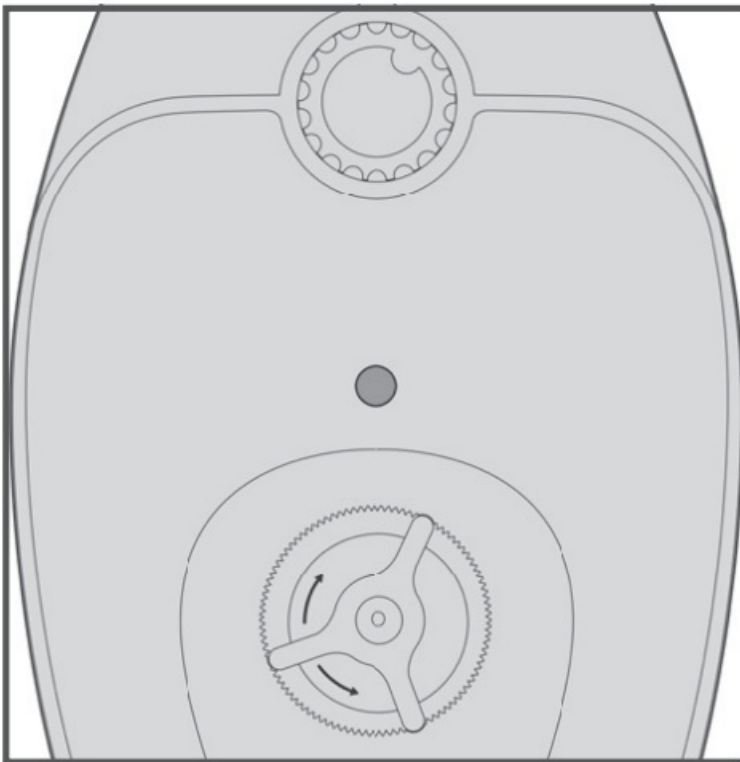

3. To steam your floors twist the steam control dial to desired setting. Steam is activated automatically. Take care when changing settings during cleaning.

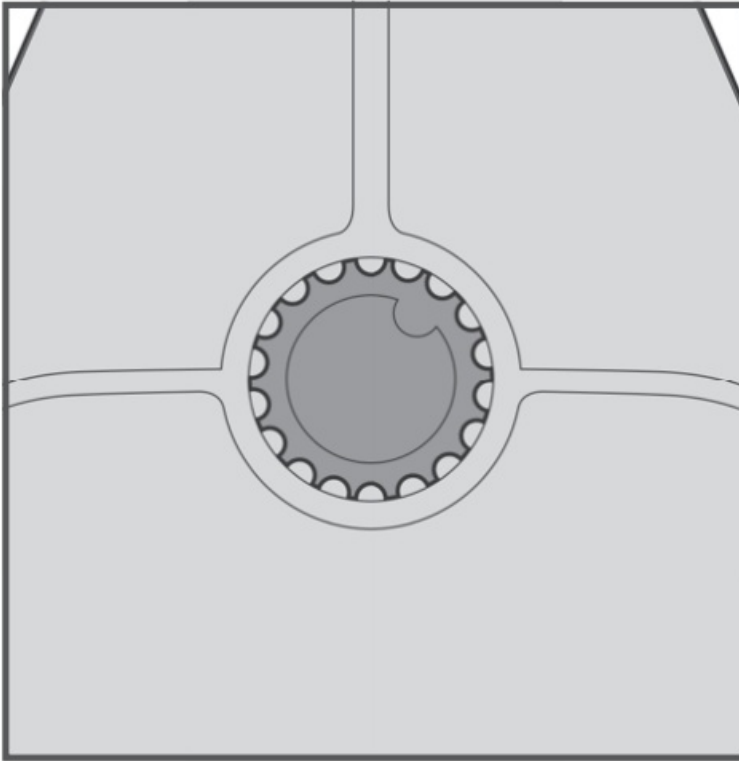

TIP: Product needs to be assembled after filling the tank.

Attach the floorhead and handle before cleaning floors.

4. Place foot onto the floorhead and pull handle backwards to recline.



5. Move the steamer slowly backwards and forwards across the floor paying particular attention to high traffic areas.

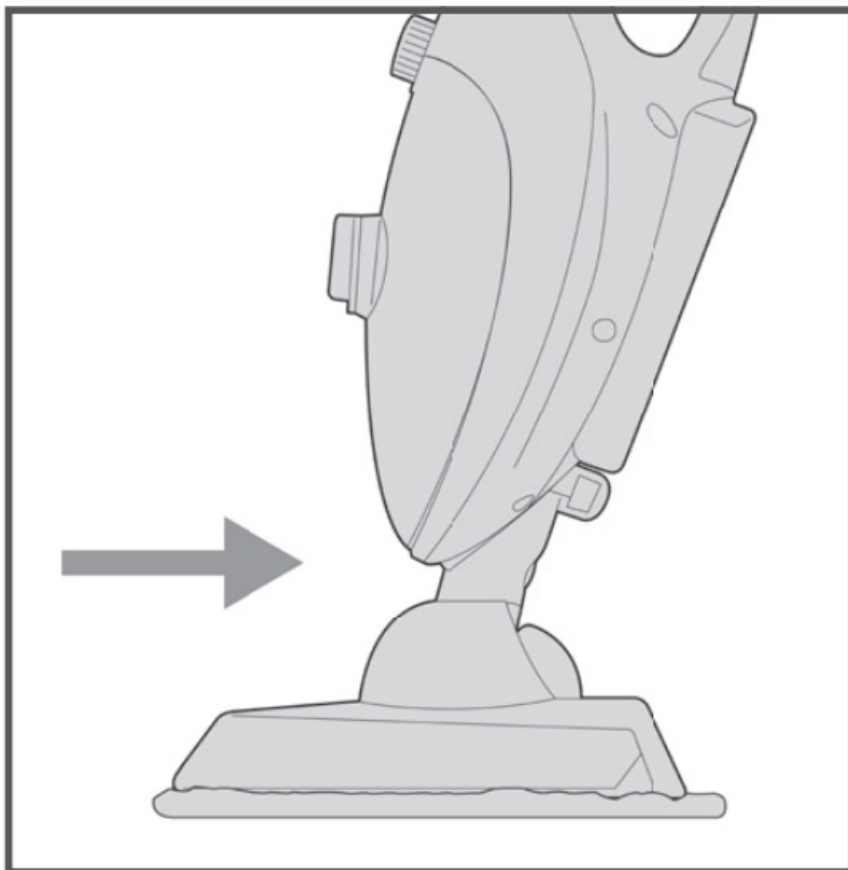

6. Turn dial to 'OFF' position and allow steamer to cool, the amber light will switch off.
Hold corner of pad down with your foot and lift steamer to peel away

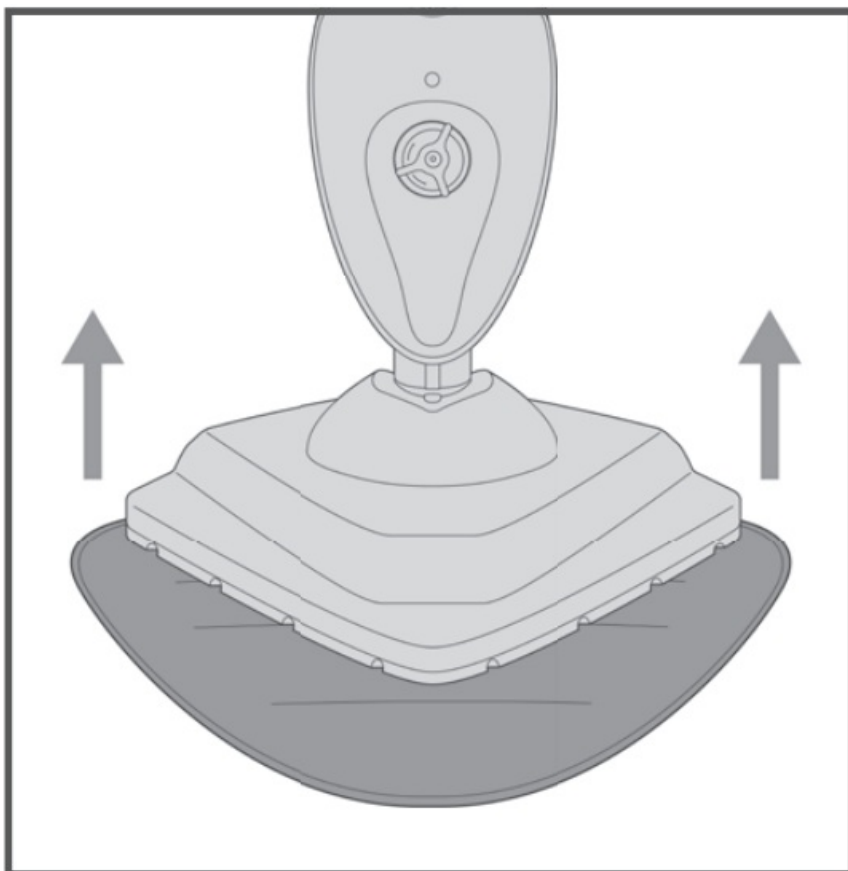

IMPORTANT: Never use the steamer without a cleaning pad attached to the floorhead.



IMPORTANT: Never leave the steamer on one spot for an extended period of time or with a damp or wet

micro fiber pad attached as this may damage the floor surface.

USE THE MACHINE AS A HANDHELD

1. Push handle release button and lift handle to remove.

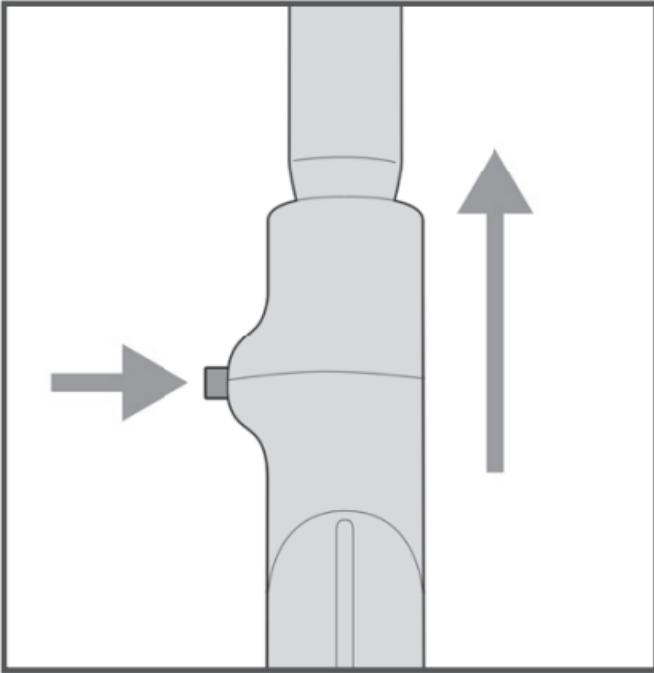

2. Press accessory release button and lift steamer to release floorhead.

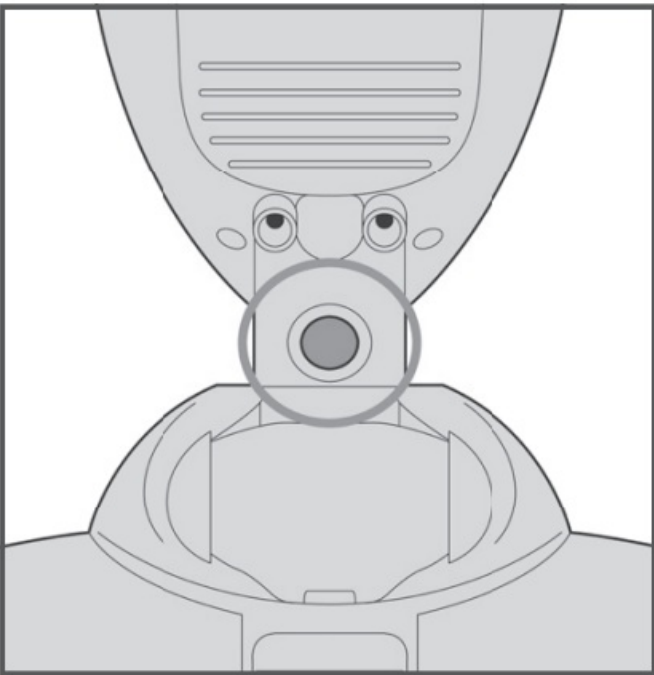

3. Push concentration nozzle into steamer until it clicks into place.

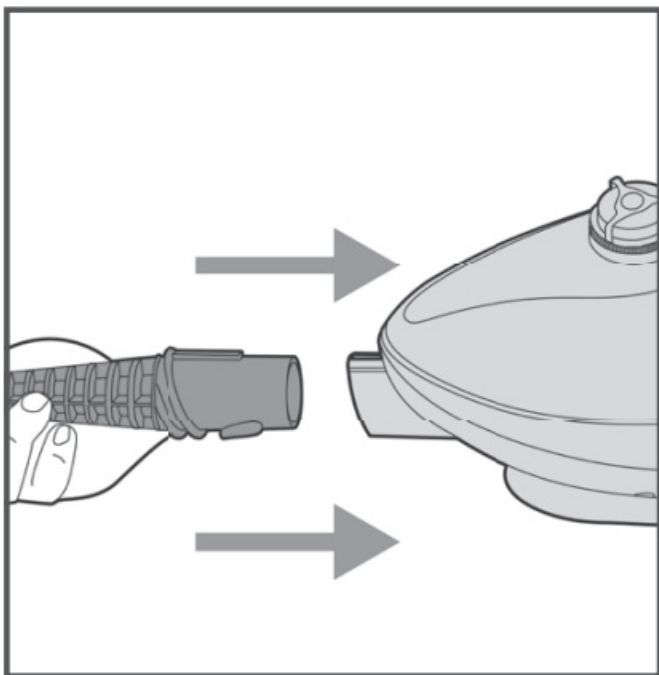

4. Plug into mains, turn the dial to 'ON' position. The amber light will illuminate to indicate power on. The steamer will be ready after approximately 30 seconds.

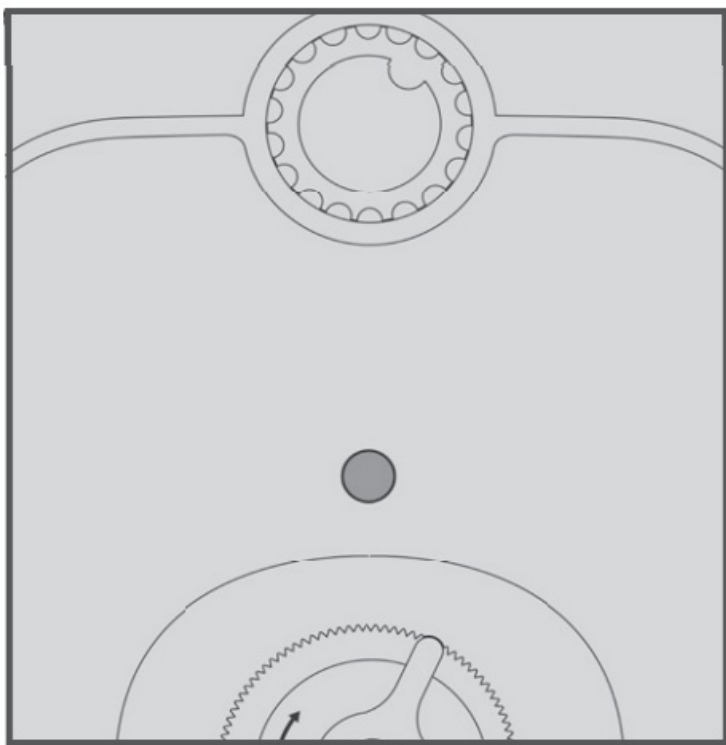

5. Twist the steam control dial to desired setting.

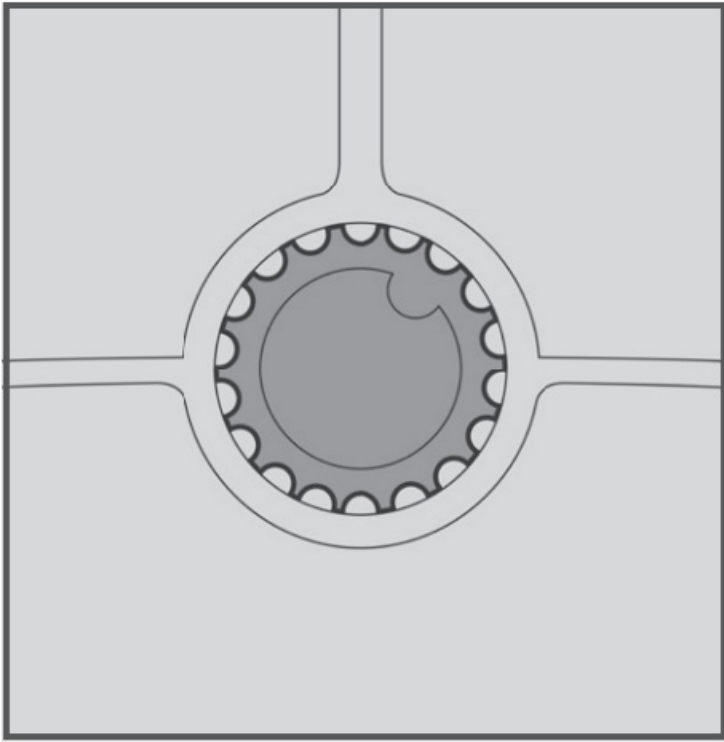

6. To produce steam squeeze the trigger in short bursts.
Don't hold the trigger continuously to prevent over wetting.

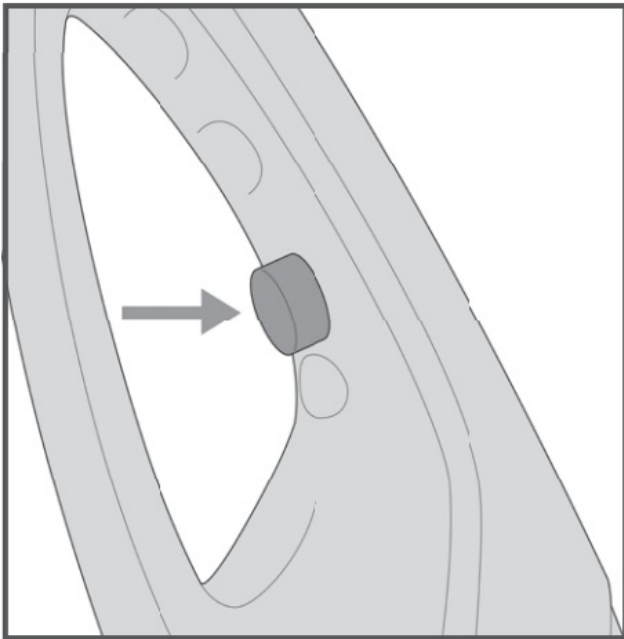

ATTACH THE ACCESSORIES

ATTACH THE BRUSHES

1. Small tools can be attached via the concentration nozzle. Push together to click into position and secure.

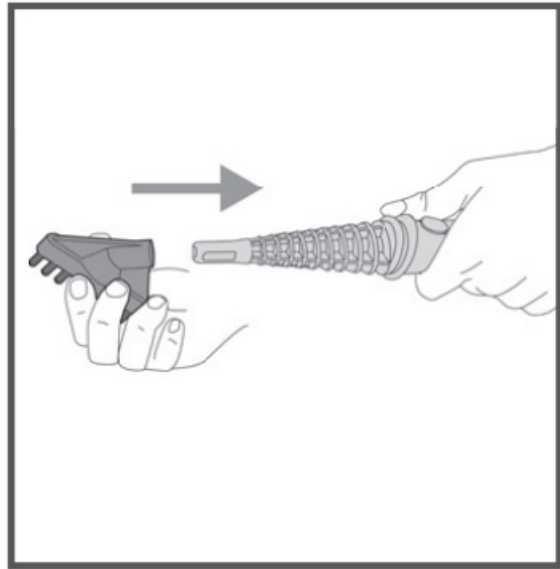
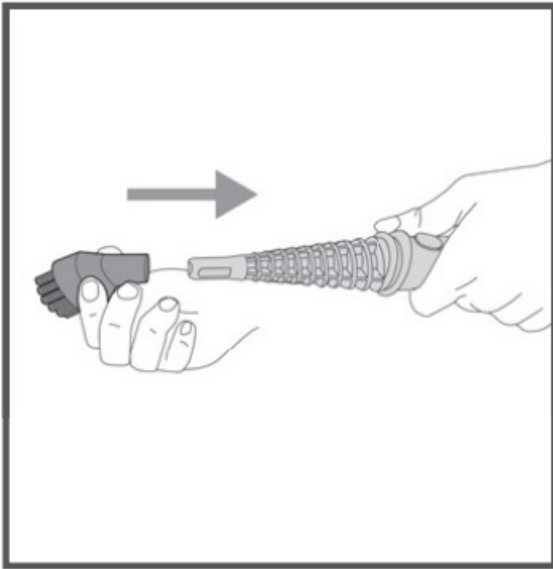

ATTACH THE Accessory HOSE

1. Push the accessory connector onto the steamer nozzle until it clicks into place.



2. Line up hose with the accessory connector, twist and push to lock into place.

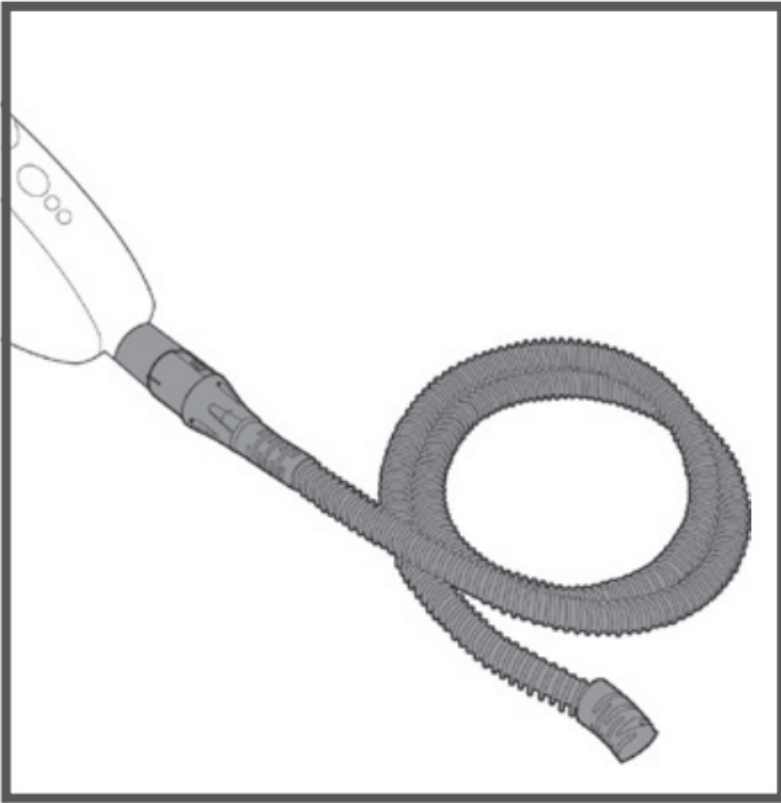

3. Line up concentration nozzle with the hose, twist and push to lock into place.

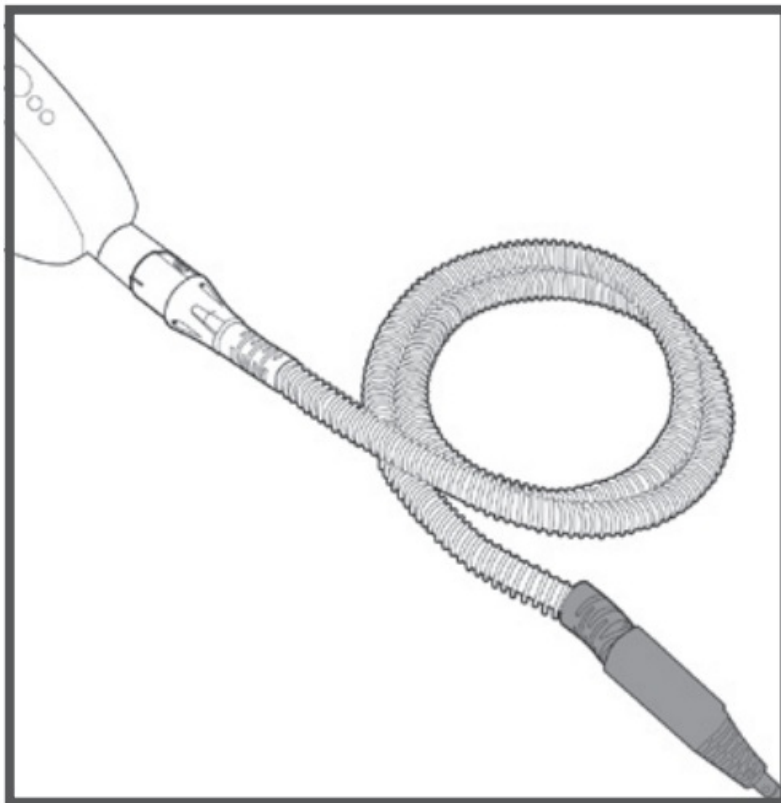

4. Choose an accessory.

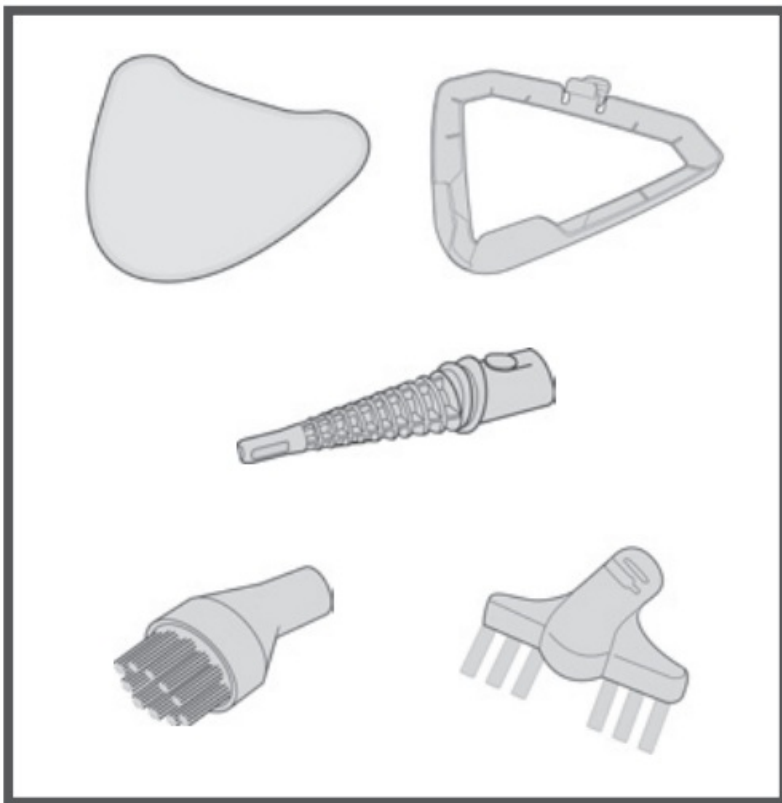

5. Line up accessory with concentration nozzle, twist and push to lock into place.

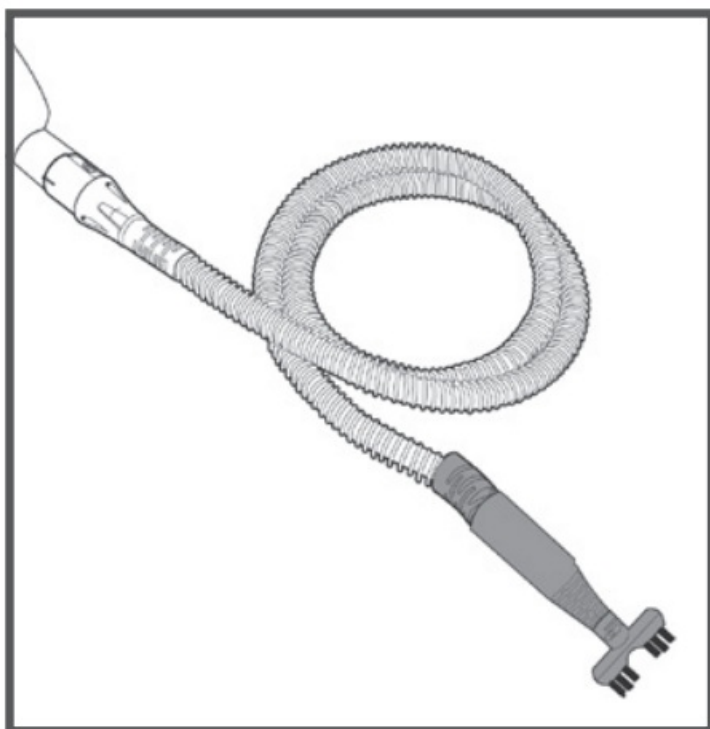

6. Adjust the steam control dial to switch On/Off and for adjusting steam control.

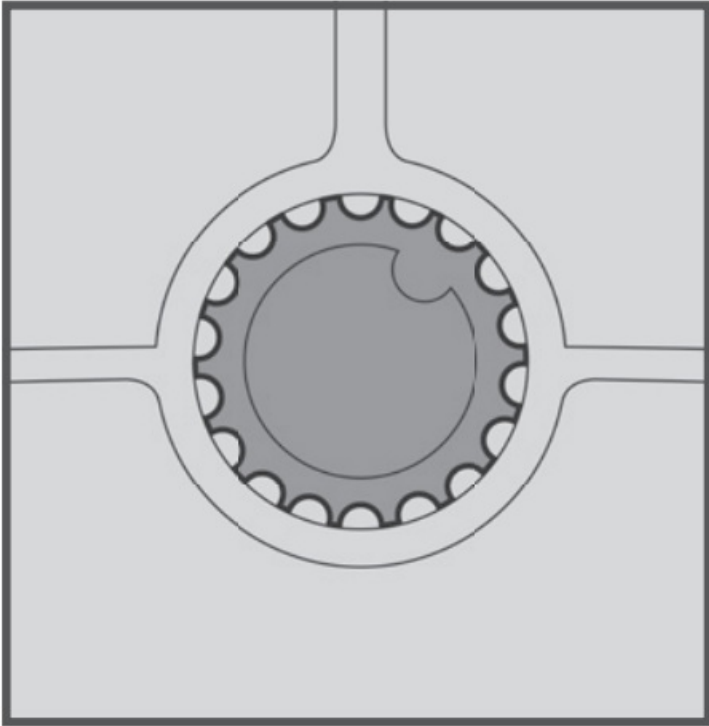

7. To produce steam, squeeze the steam trigger.

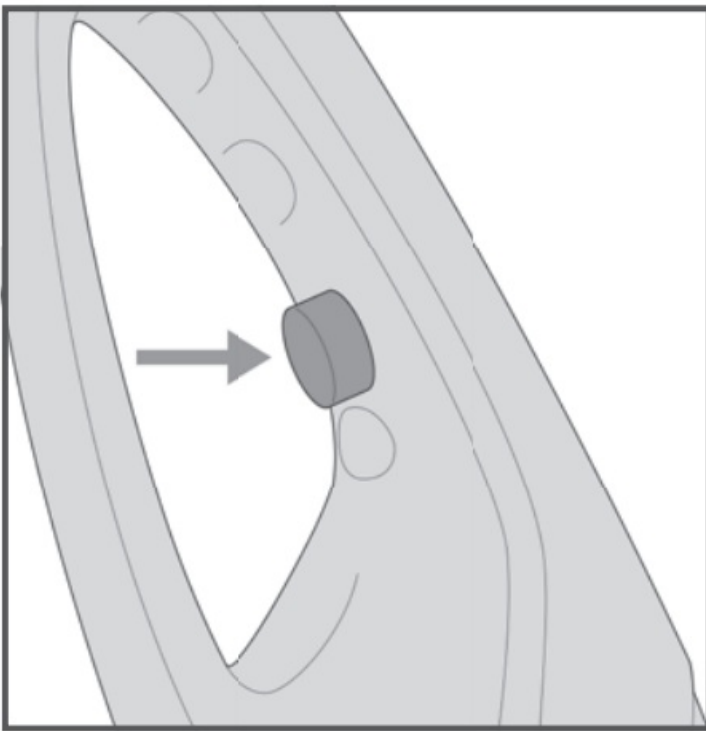

USE THE ACCESSORIES

CONCENTRATION NOZZLE

Use to remove soap scum in baths and shower enclosures and to clean heavily soiled areas in kitchens.

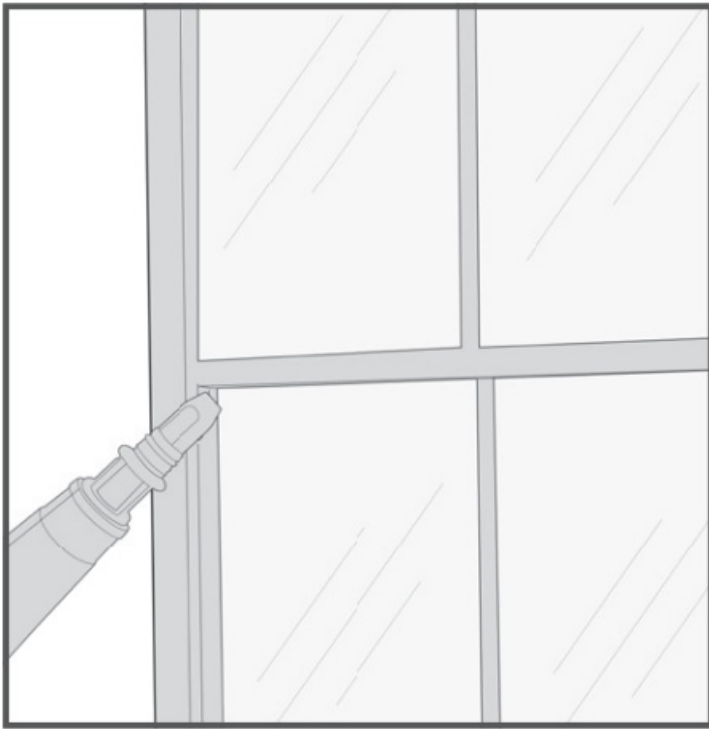

SMALL BRUSH

Ideal for any surface from tiles, sinks, toilets and oven tops.

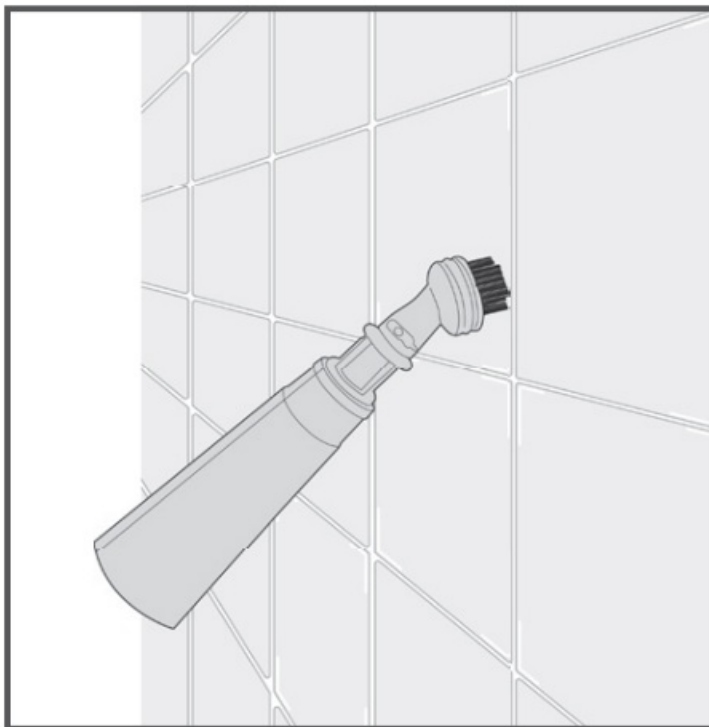

GROUT BRUSH

Lifts embedded dirt from in between tiles.

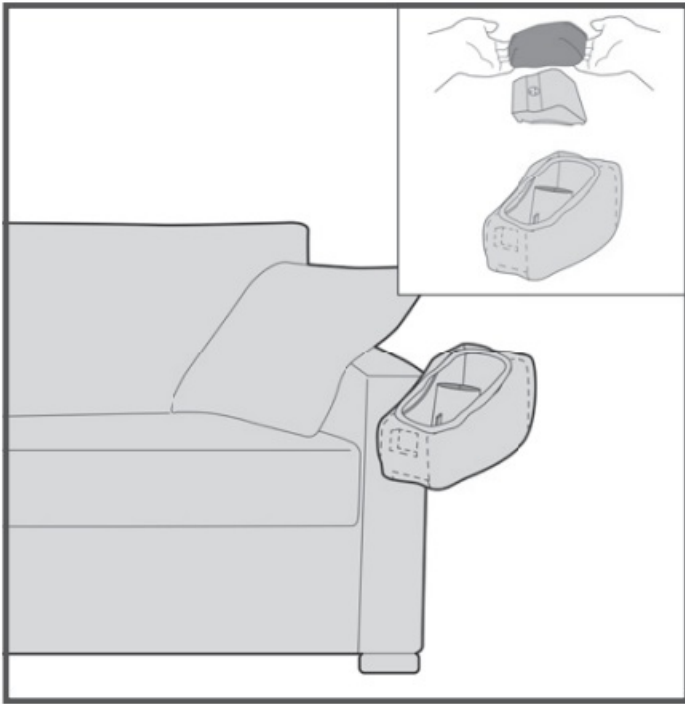

UTILITY HEAD AND PAD

Attach utility pad to utility head for use on upholstery and clothes. Do not use detergent on fabrics and upholstery.

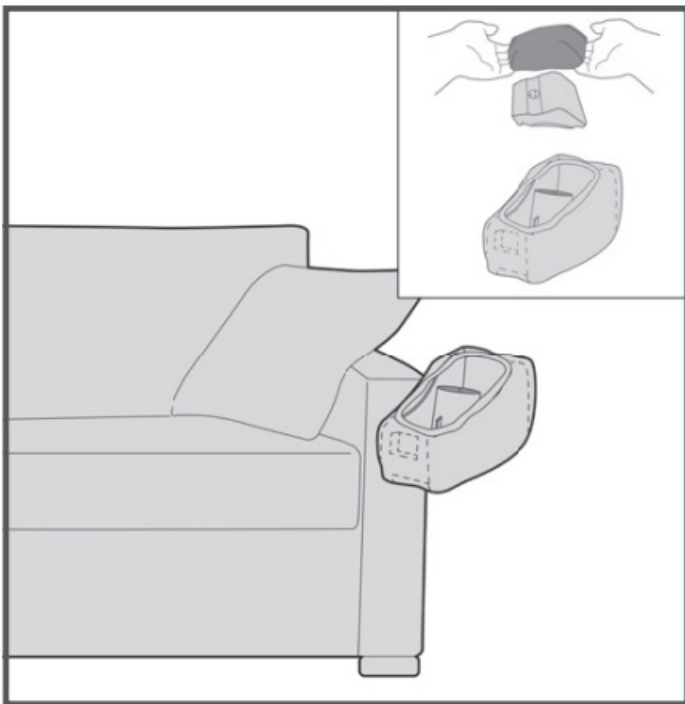

SQUEEGEE

Great for leaving your windows, tiles and mirrors gleaming.

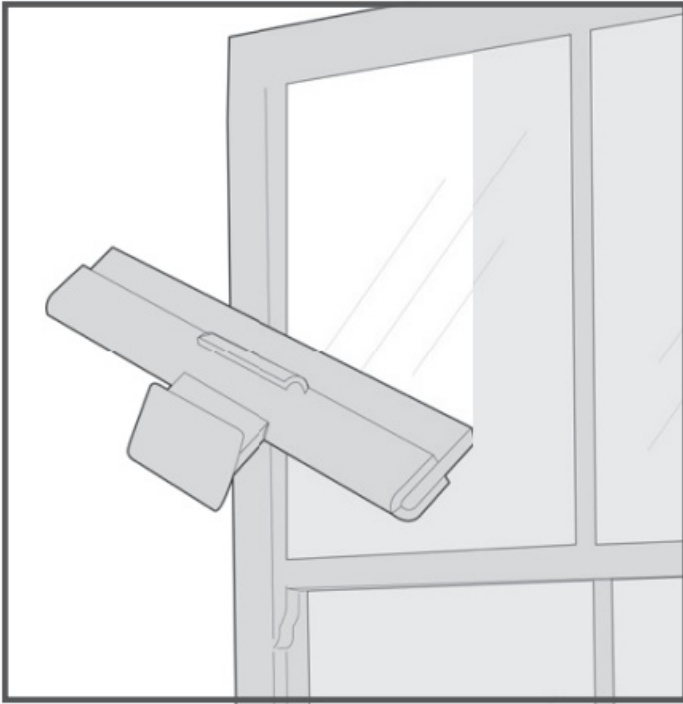

METAL BRUSH

Strong metal bristles to lift resilient grime from tough surfaces. Use when deep cleaning your oven, wire racks or BBQ to make light work of difficult cleaning tasks. Not for use on soft or delicate surfaces or material/ upholstery.

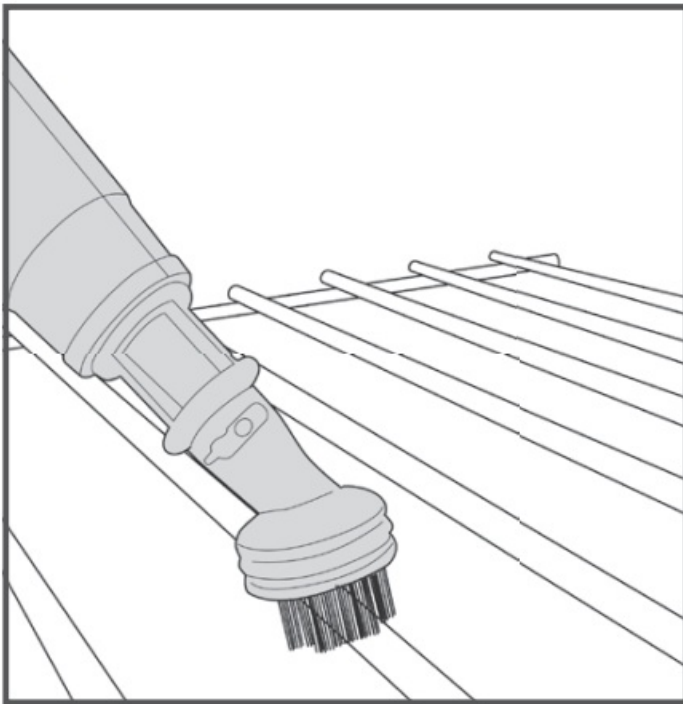

USE ON CARPETS

REFRESHING CARPETS

1. Place the micro fiber pad on the floor white side facing up.
Place steamer onto pad making sure the entire pad covers the floorhead.

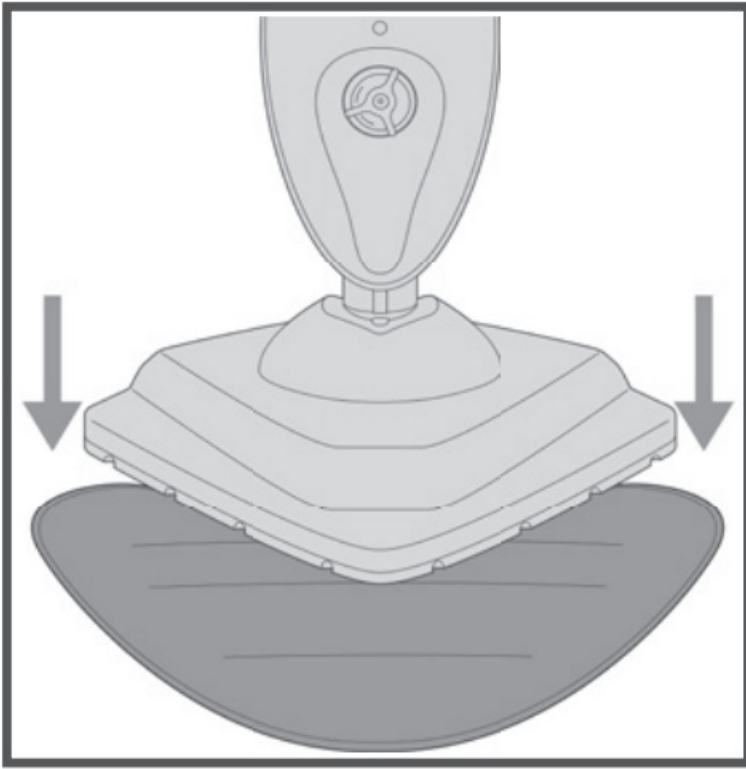

2. With micro fiber pad attached, push steamer into front of the carpet glider, then place back of the floorhead into the clip. The carpet glider should only be used when refreshing carpets.

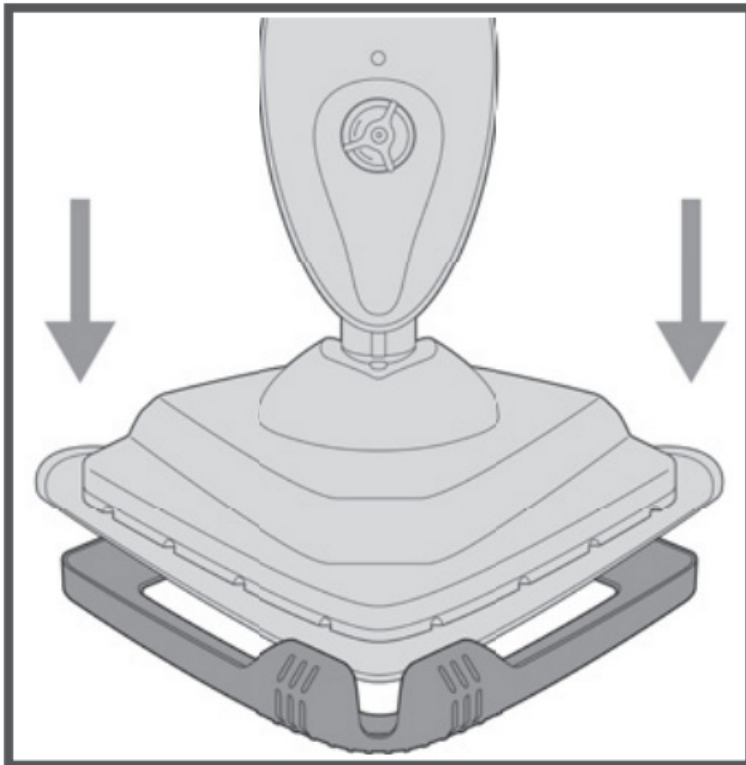

3. Plug into mains, turn dial to 'ON' position, the amber light will illuminate to indicate power on.

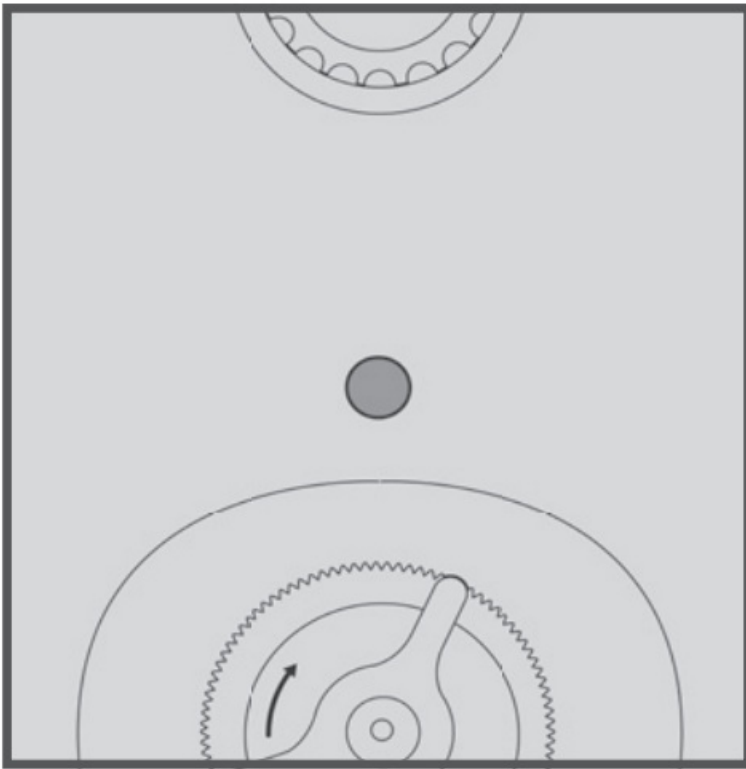

4. Twist the steam control dial to desired setting.

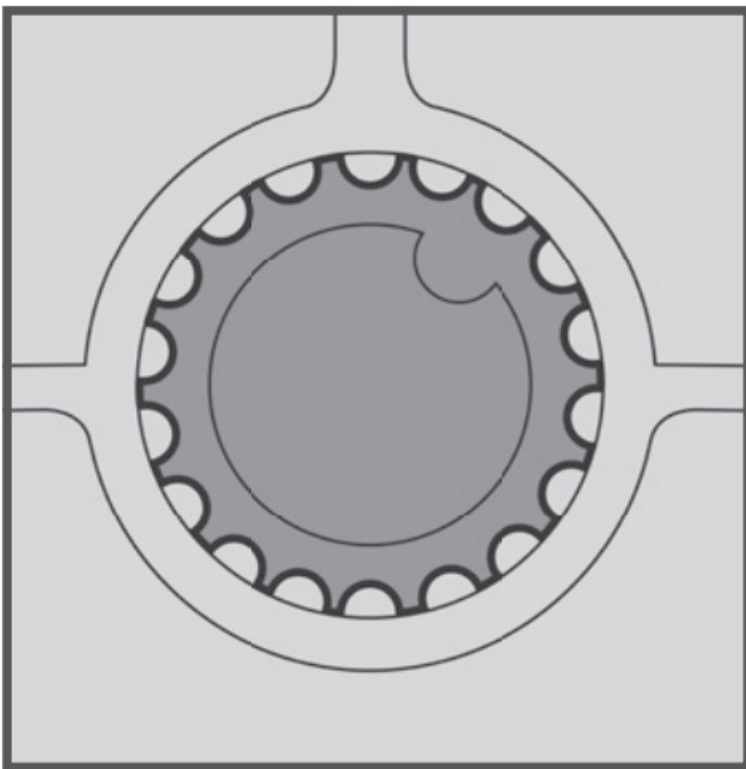

Steam is activated automatically. Take care when changing settings during cleaning.

5. Place your foot on floorhead and pull handle backwards to recline.

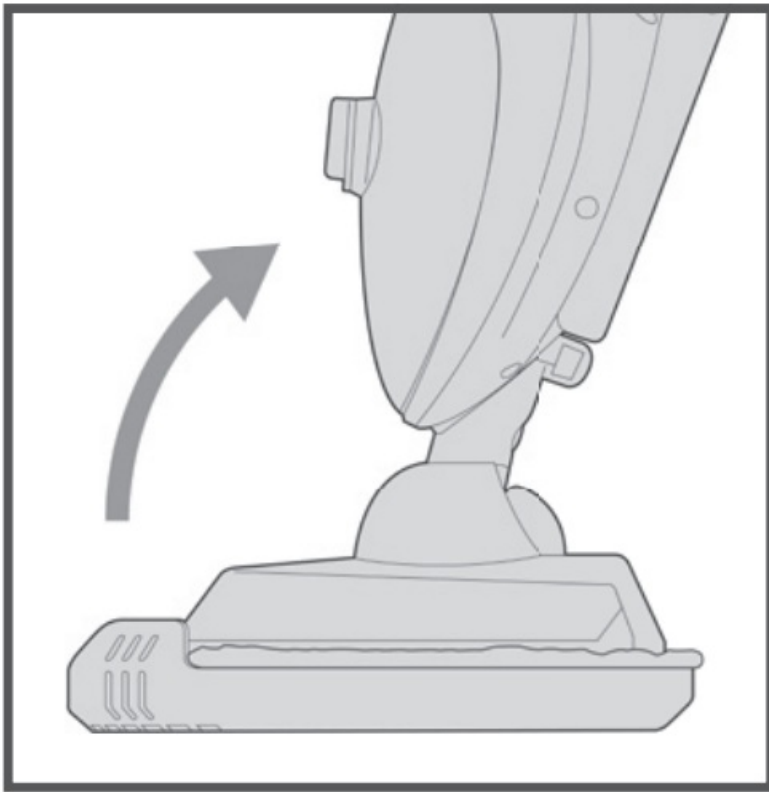

6. Move the steamer slowly backwards and forwards across the carpet paying particular attention to high traffic areas.

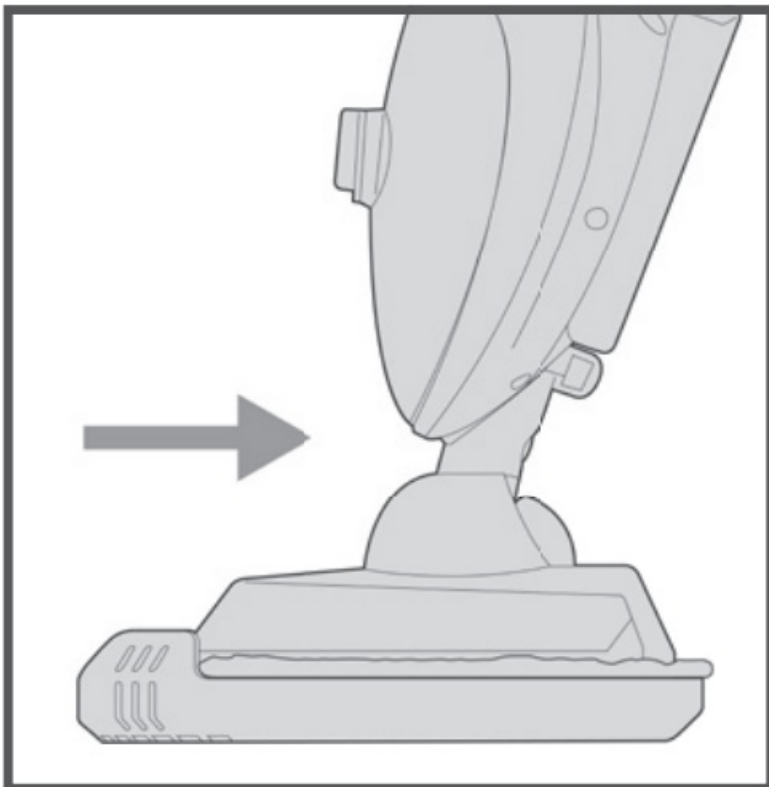

7. To release the carpet glider, place your foot on clip and push down. Lift steamer to remove.

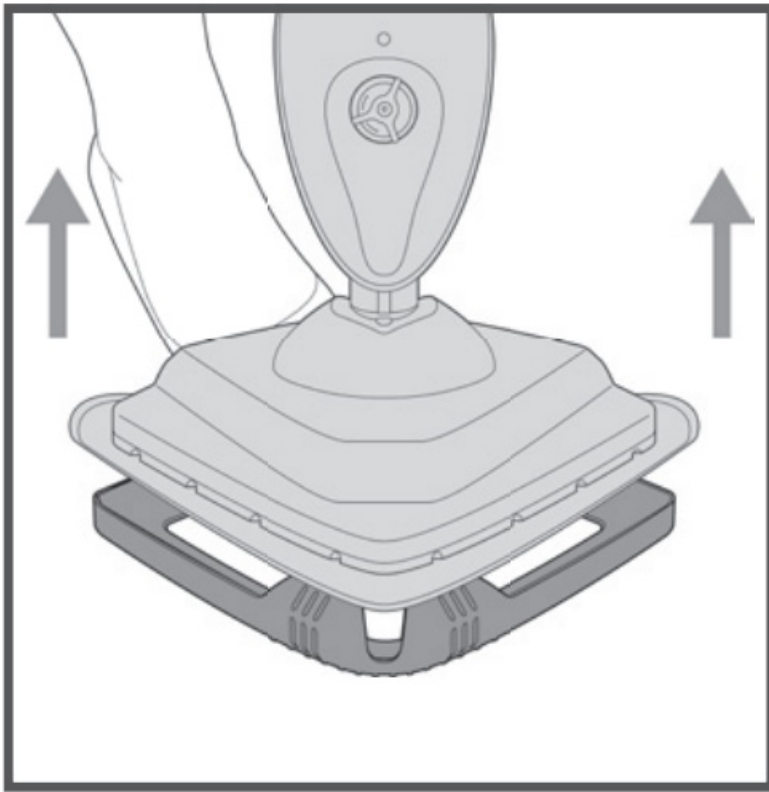

! **IMPORTANT:** Take care removing carpet glider with foot. Make sure steamer is OFF and has cooled down.

! **IMPORTANT:** Always allow the steamer to fully cool down before removing the micro fiber cleaning pad.

CARE & MAINTENANCE

EMPTYING THE WATER TANK

1. Remove floorhead and handle and place steamer on flat surface. Twist water tank cap anti clockwise and lift to remove.

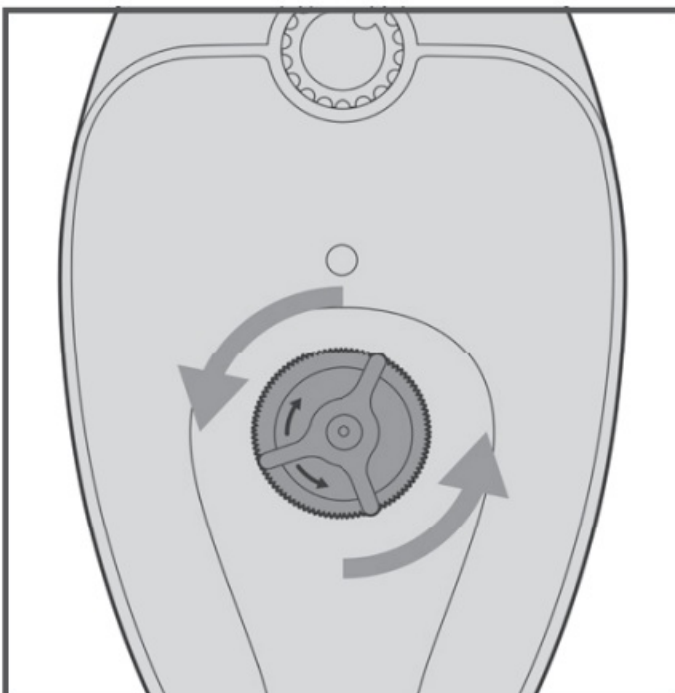

2. Empty any excess water over the sink.

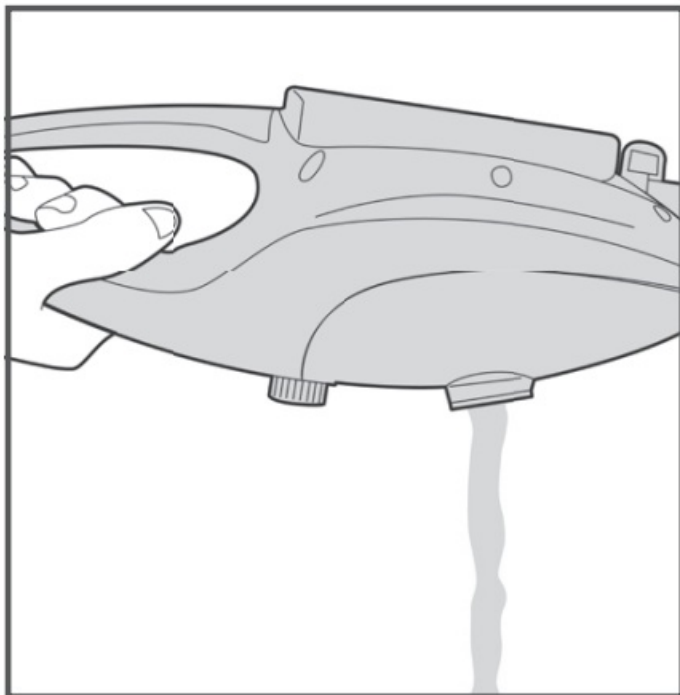

IMPORTANT: Don't use bleach or fabric softener when washing the micro fiber cleaning pad.



IMPORTANT: Never remove the water tank cap with the product upright as water could leak out – always remove the floorhead and handle and place handheld on a flat surface before removing the water tank cap.

CLEANING THE MICROFIBRE/ UTILITY CLEANING PAD

The micro fiber/utility cleaning pads are machine washable (Max 40°C) allow to fully dry before use.

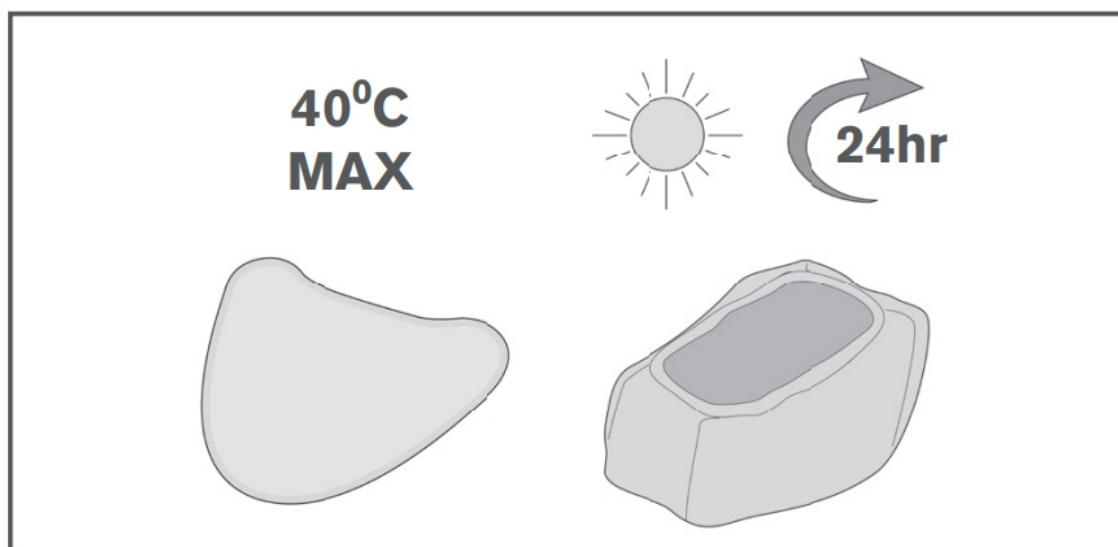

CLEARING BLOCKAGES



IMPORTANT: Turn dial on steamer to 'OFF' position, switch off at mains and unplug safely. Allow to fully cool down before performing maintenance or troubleshooting checks.

1. Push the floorhead release button and lift the main body from the floorhead to remove. Also remove the handle.

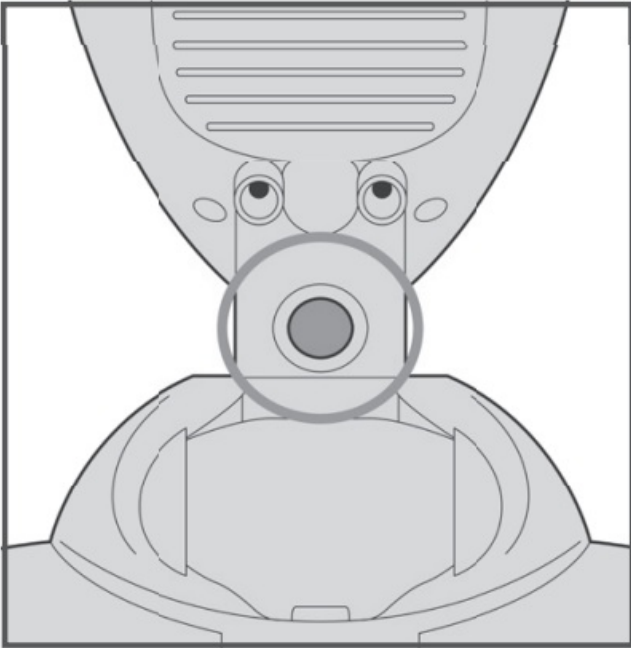

2. Use a small thin object such as a paper clip to insert into the nozzle and clear any blockage.

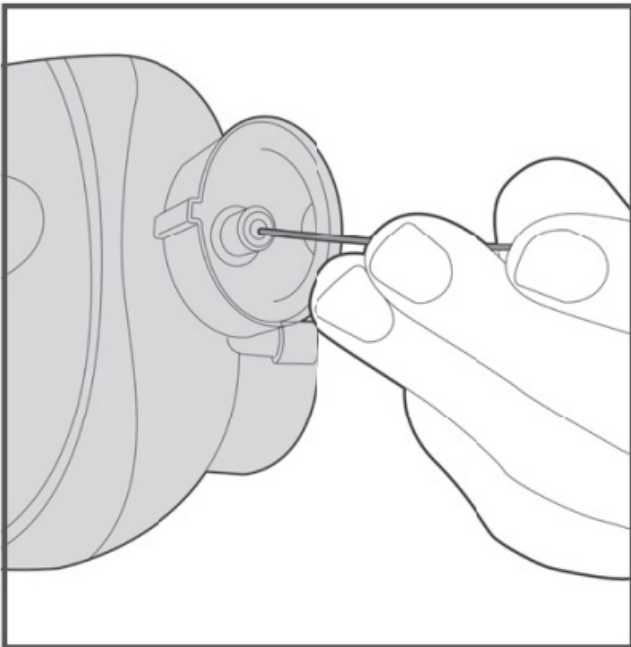

3. To clear a blockage in the floorhead, remove the micro fiber pad from the floorhead, insert a small thin object, such as a paper clip, into the steam holes to remove any blockage.

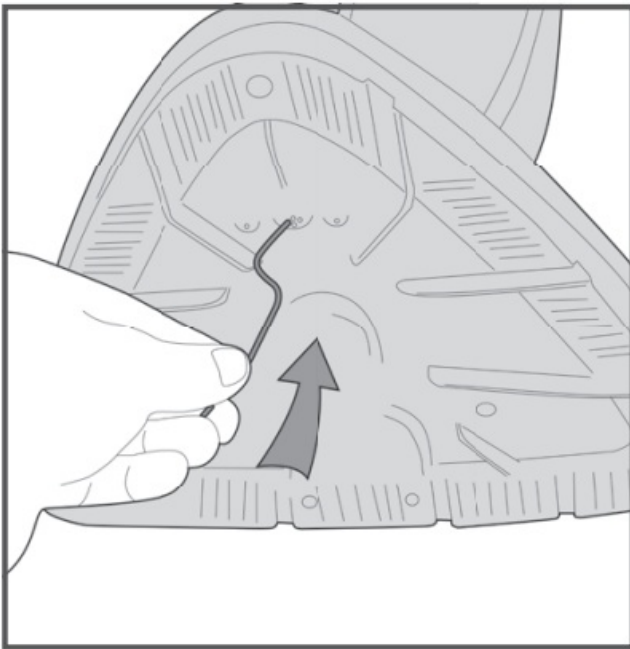

TROUBLESHOOTING

Problem	Solution
Is there an accessory missing?	Check the 'This pack contains' panel on the box to make sure the part is included with your steamer.
Why does my steamer have no power?	Check the on/off control dial position.
	Check the amber light is illuminated.
	The plug may not be fully pushed into the electrical socket.
	Check the fuse in the plug if this needs replacing, always replace with a British 13amp fuse.
Why is the steamer not producing steam?	There may be no water in water tank, check the water tank has water.
	Check the water tank cap is securely fitted onto the water tank.
	The water may not yet be at temperature. The steamer will take approximately 30 seconds to heat up.
	Steam path may be blocked. Go to 'Let's talk technical'.
	Check steam control dial has been turned to 'on'.
	Water tank level may be low, refill with water.
Why won't the micro fibre pad pick up dirt?	The micro fiber pad may already be saturated or dirty.
	Wash the micro fiber cleaning pad, go to 'Taking care of your machine'.

GUARANTEE



LIMITED GUARANTEE

It's quick and easy to register for your free 1 year guarantee online at www.DirtDevil.co.uk
Please retain your original receipt for proof of purchase.

Please make a note of the serial number and model number of the product before calling.

Customer Support



**Call our Customer
Service Department at
0330 026 2626
Monday-Friday 9:00am to 5:00pm.
www.DirtDevil.co.uk**

Dirt Devil. 2 Colmore Square, 38 Colmore Circus, Queensway, Birmingham, B4 6BN.

CE EEC Statement of Compliance: Manufacturer/EEC importer: Vax Ltd trading as Dirt Devil, hereby on our own responsibility, declare that the DDS04-E01/DDS04-P01 series is manufactured in compliance with the following Directives: Safety: 2006/95/EC Low Voltage Directive. **EMC:** 2004/108/EC Electromagnetic Compatibility Directive.



Waste electrical products should not be disposed of with household waste. Please recycle where facilities exist.

Check with your Local Authority or retailer for recycling advice.



Documents / Resources

	<p>Dirt Devil DDS04-E01 Multi Function Steam Cleaner [pdf] User Guide</p> <p>DDS04-E01 Multi Function Steam Cleaner, DDS04-E01, Multi Function Steam Cleaner, Function Steam Cleaner, Steam Cleaner</p>
---	---

References

-  [Dirt Devil](#)
-  [Manual-Hub.com - Free PDF manuals!](#)
- [User Manual](#)

[Manuals+.](#) [Privacy Policy](#)

This website is an independent publication and is neither affiliated with nor endorsed by any of the trademark owners. The "Bluetooth®" word mark and logos are registered trademarks owned by Bluetooth SIG, Inc. The "Wi-Fi®" word mark and logos are registered trademarks owned by the Wi-Fi Alliance. Any use of these marks on this website does not imply any affiliation with or endorsement.