



DIRECTED 091824 Direct Loader Programming Tool Instruction Manual

[Home](#) » [DIRECTED](#) » DIRECTED 091824 Direct Loader Programming Tool Instruction Manual 

Contents

- [1 DIRECTED 091824 Direct Loader Programming Tool](#)
- [2 Product Description](#)
- [3 DLOADER4 Kit Contents](#)
- [4 Getting Started](#)
- [5 Documents / Resources](#)
 - [5.1 References](#)
- [6 Related Posts](#)

DIRECTED®

DIRECTED 091824 Direct Loader Programming Tool



Product Description

The DLOADER4 programming tool is an all-in-one flashing tool for DIRECTED by VOXX Analog & Digital Systems with the following support:

PC Flashing

- In-Vehicle Flashing (Wired)
- In-Vehicle Flashing (Wireless)
- Bitwriter Programming (Hybrid)

DLOADER4 Kit Contents

- DLOADER4 Programming Tool
- USB-A to USB-C Cable
- OBDII Extension Cable
- DirectLoader Harness Kit, which includes:
 - D2D Digital Flashing/ D2D Logging Y-Cable
 - Bitwriter Programming Cable
 - PRG Cable 2-wire Cable
 - CAN Logging Harness (for future use)

Getting Started

Flashing from PC: Via USB

To get started using your DLOADER4 to flash modules from your PC, follow the steps below:

NOTE – XKLoader2 cannot be connected to PC at the same time as DLOADER4.

1. Go to www.directechs.com to download and install the latest version of the DirectLinkDT application (2.23 or higher required).
2. Connect your DLOADER4 to your PC by plugging in the USB-A side of the cable to the PC and the USB-C side to the DLOADER4.
3. Connect your module (example: D54) to the DLOADER4 with a standard D2D harness or the provided D2D Y-cable. If using Y- cable, connect the Blue plug to DLOADER4 and the White plug to the module you are flashing.
4. Go to www.directechs.com on the DirectLinkDT application and

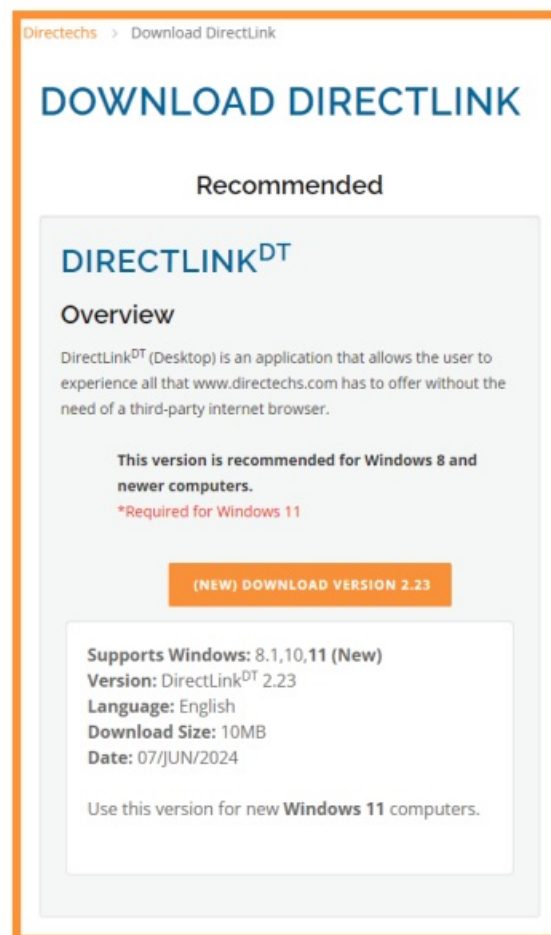

Flashing In-Vehicle (Wired): Via Bluetooth

To get started using your DLOADER4 to flash modules with the Directloader APP on your mobile device, follow the steps below:

1. For Android devices: Go to the Google Play Store to download and install the latest version of the Directloader application.

For iOS devices: Go to the Apple App Store to download and install the latest version of the Directloader

application.

2. Connect your DLOADER4 to the OBDII port in the vehicle for power (if the OBDII port is in a location that prevents the DLOADER4 from connecting directly to it, use the provided OBDII extension cable).
3. Connect your module (example: DB3) to the DLOADER4 with a standard D2D harness or the provided D2D Y-cable. If using Y-cable connect the Blue plug to DLOADER4 and the White plug to the module you are flashing.
NOTE – Module (ex. D83) must be disconnected from power to flash.
4. Open the Directloader App and select DLOADER4 in the Flash Digital section to proceed with module flashing.

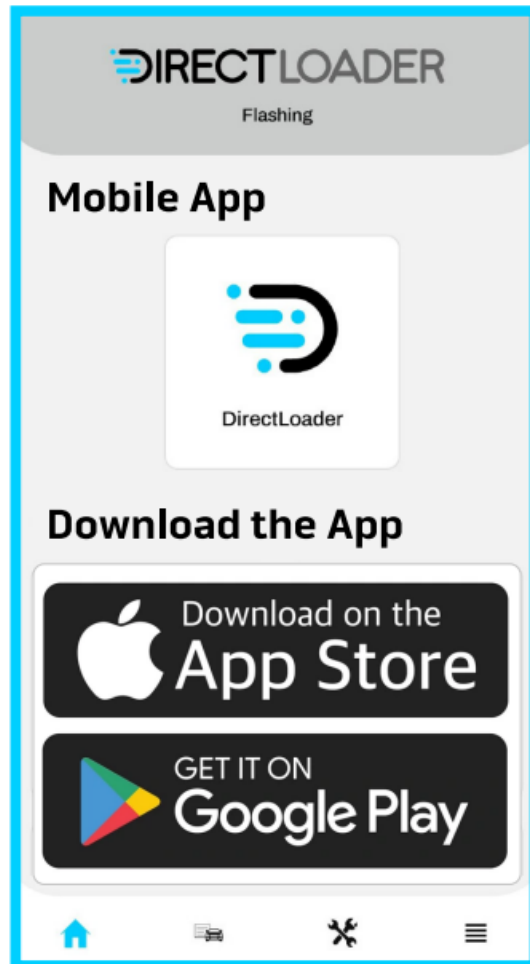



Flashing In-Vehicle (Bluetooth Direct): DS4/DS4+ Only

To get started flashing your DS4 wirelessly via BLE from the Directloader App on your mobile device, follow the steps below:

1. For Android devices: Go to the Google Play Store to download and install the latest version of the Directloader application.
For iOS devices: Go to the Apple App Store to download and install the latest version of the Directloader application.
2. Brand New Module: DS4 must have power. Brand new units out-of-the-box will automatically allow BLE connection from the DIRECTLOADER App.
Hard Reset Module: DS4 must have power. Hard-resetting the DS4 will automatically allow BLE connection from the DIRECTLOADER App. Installed and Programmed Module: Put the DS4 system into pairing mode by turning the Ignition ON, then press and release the Control Center Button 1 time and then press and hold the button until the Control Center LED begins to flash (confirming that the device is in pairing mode).
3. Open the Directloader App, select Bluetooth Systems in the Flash Digital section, and select the module ID to proceed with flashing.

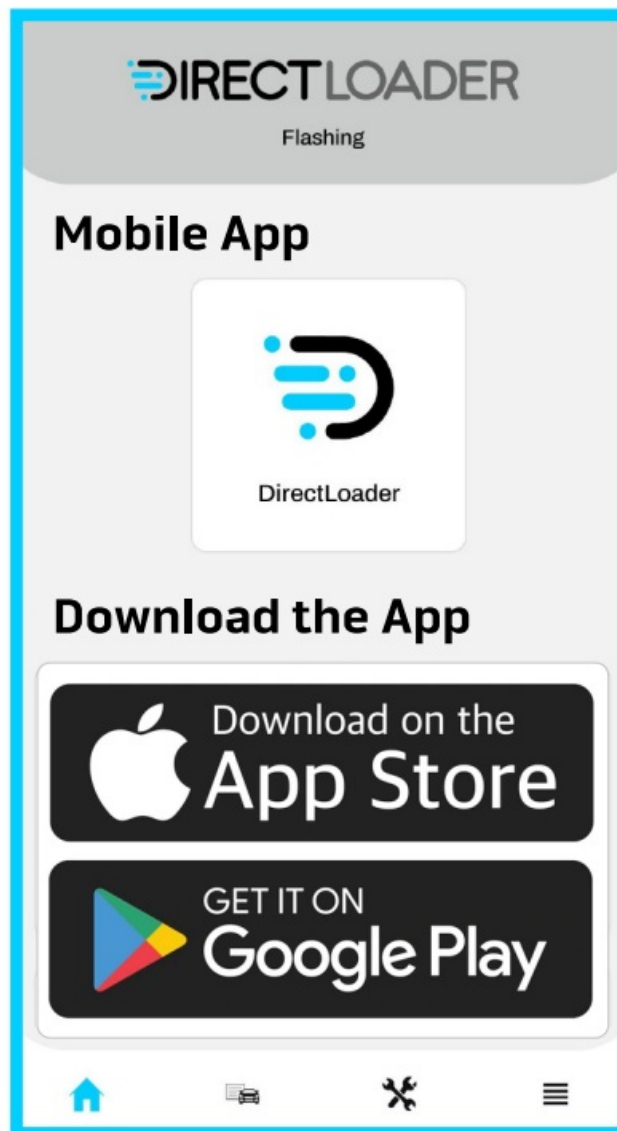

Bitwriter Programming in-vehicle

To get started using your DLOADER4 to program Analog systems from the Directloader app on your mobile device, follow the steps below:

1. For Android devices: Go to the Google Play Store to download and install the latest version of the Directloader application.
For iOS devices: Go to the Apple App Store to download and install the latest version of the Directloader application.
2. Connect your DLOADER4 to the OBDII port in the vehicle for power. If the OBDII port is in a location that prevents the DLOADER4 from connecting directly to it, use the provided OBDII extension cable.
3. Connect your module (example: 51 OS) to the DLOADER4 with the Bitwriter Programming cable (Blue 4pin, 3wire to Black 3pin) NOTE- Module (Ex. 5105) must be powered up to program.
4. Open the Directloader App and select Bitwriter in the Utilities & Resources section to proceed with system programming.

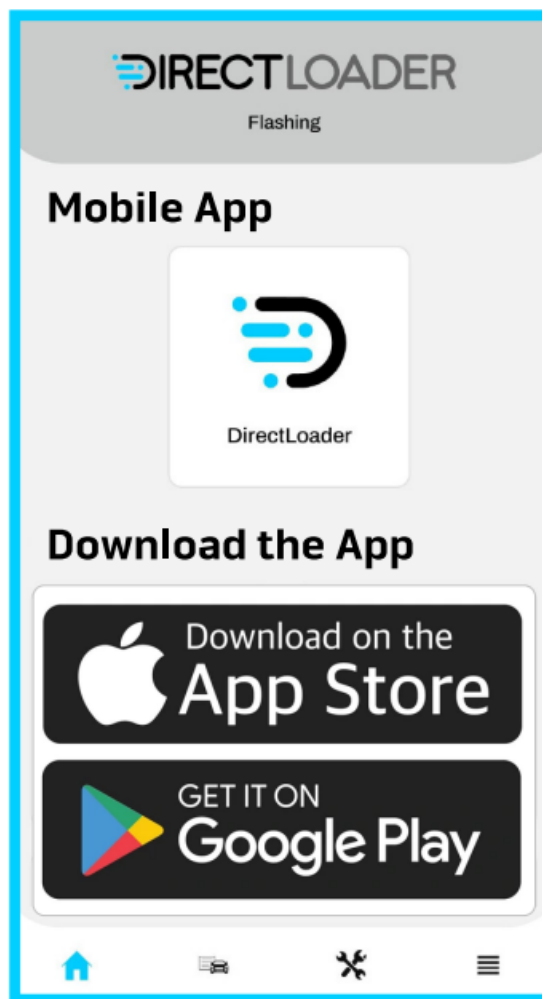



Updating the DLOADER4

Periodically the firmware on the DLOADER4 will need to be updated. If there is an update pending you will see a red "1" next to the "i" icon



(info) at the top of your screen while you are paired to it. NOTE-You will need to be connected to a module (Ex. DB3/DS3) to access the DLOADER INFO page.



1. Tap on the icon to access the DLAODER4 INFO page.
2. On this page it will display the Device ID, the Device Name (which is updateable, so that you can name it something easily recognizable), the current Firmware on the DLOADER4, if New Firmware is available, and current RSSI signal strength.

To install the New Firmware tap on "Update" next to the New Firmware Number.

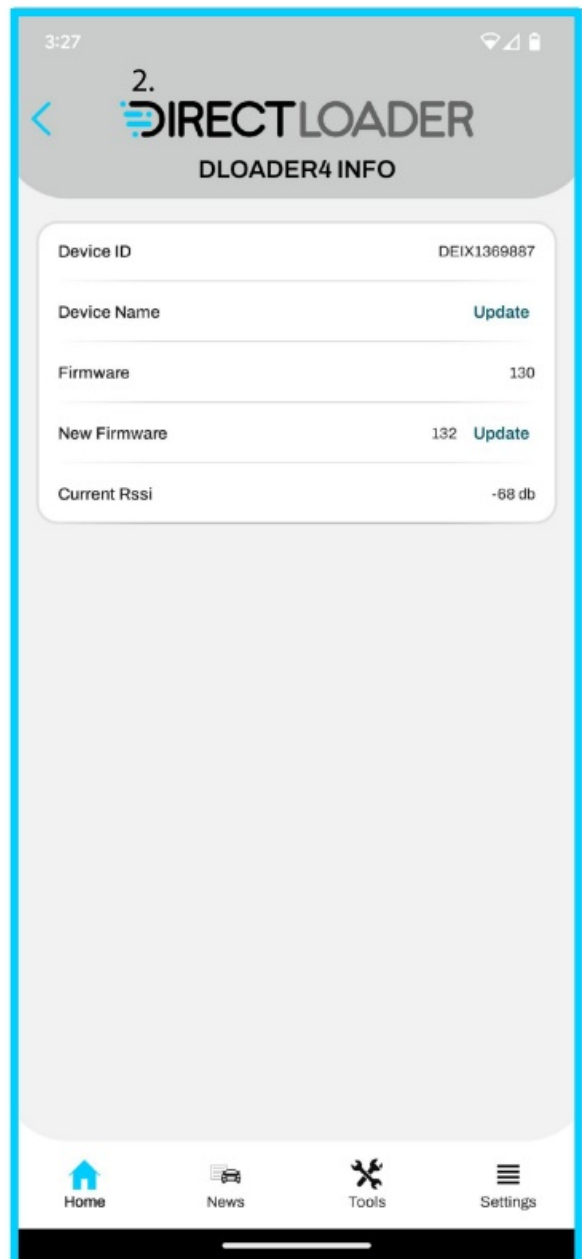
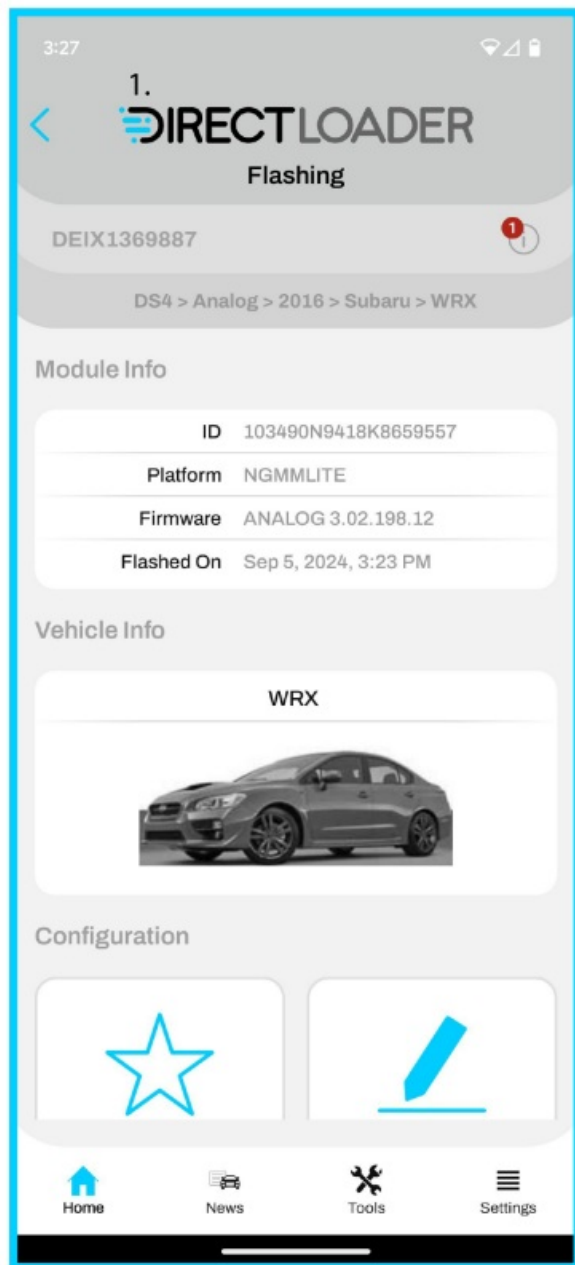

Updating the DLOADER4

3. Upon tapping the “Update” option for the New Firmware, it will bring you to the Update Firmware page. Simply Tap “Update Firmware” button to proceed.
4. The firmware update will download and install onto the DLOADER4.
NOTE– It is important that you DO NOT leave the app or turn the screen off while the update is in process.
5. The app will confirm Success upon completion of the new firmware installation. Simply tap “OK” to exit.
 - The device will no longer show New Firmware available option on the DLOADER4 INFO page until another update is released.

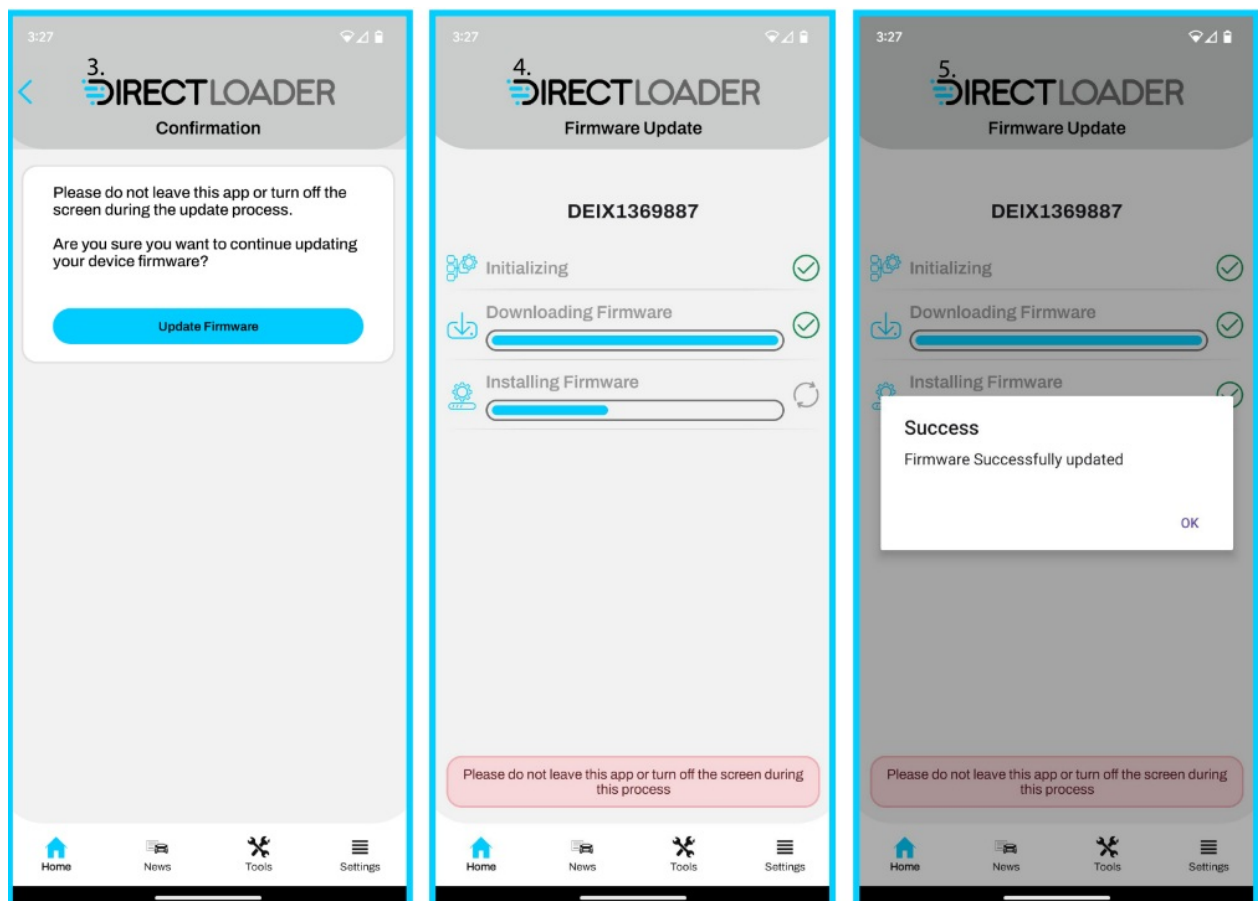

Stay Tuned for Future Updates Coming to the Directloader App & the DLOADER4 ...

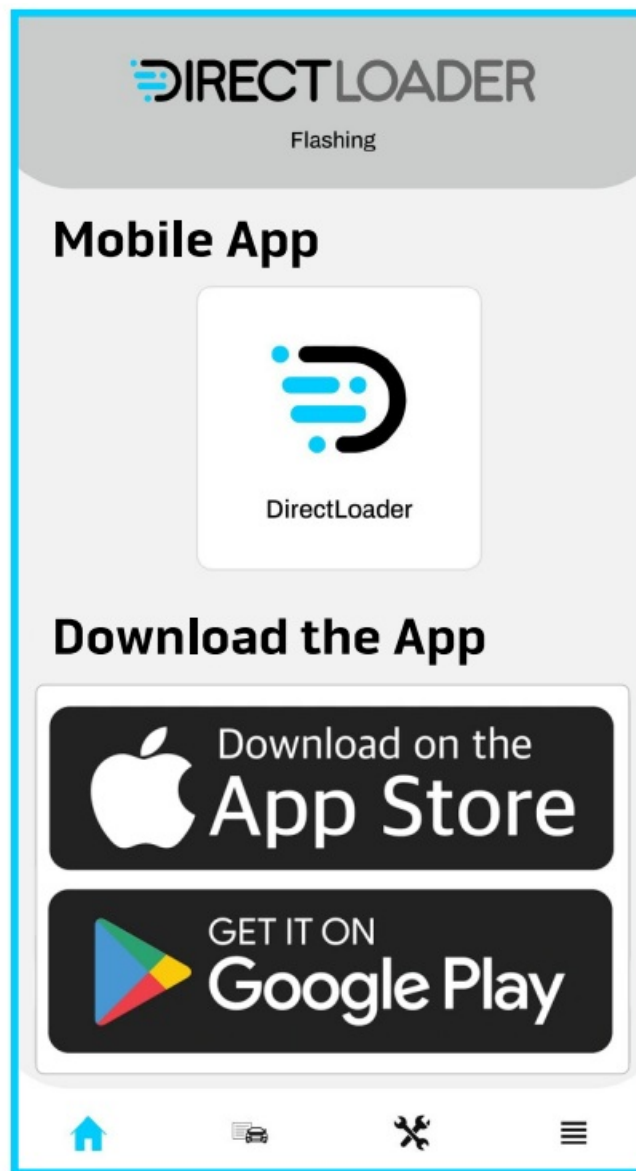

©2024 DIRECTED by VOXX LLC • Orlando, FL 23824 • Main Toll Free: [800-876-0800](tel:800-876-0800) • Authorized Dealer
Support: www.directechs.com

Documents / Resources

	DIRECTED 091824 Direct Loader Programming Tool [pdf] Instruction Manual 091824 Direct Loader Programming Tool, 091824, Direct Loader Programming Tool, Loader Programming Tool, Programming Tool, Tool
---	---

References

- [User Manual](#)

[Manuals+](#), [Privacy Policy](#)

This website is an independent publication and is neither affiliated with nor endorsed by any of the trademark owners. The "Bluetooth®" word mark and logos are registered trademarks owned by Bluetooth SIG, Inc. The "Wi-Fi®" word mark and logos are registered trademarks owned by the Wi-Fi Alliance. Any use of these marks on this website does not imply any affiliation with or endorsement.