



## DIO Rev-Light WiFi Light Switch User Manual

[Home](#) » [DiO](#) » DIO Rev-Light WiFi Light Switch User Manual 

**DIO Rev-Light WiFi Light Switch User Manual**



## Contents

- 1 Register your warranty
- 2 Video tutorial
- 3 Install the light switch
- 4 Linking the Switch with a control Dio 1.0
- 5 Deleting the link with DiO control device
- 6 Add the switch into the application
- 7 Disable Wi-Fi from the switch
- 8 Switch light status
- 9 Connect with your vocal assistant
- 10 Reset the switch
- 11 Use
- 12 Problem solving
- 13 Technical specifications
- 14 Supplementing your installation
- 15 Documents / Resources
- 16 Related Posts

## Register your warranty

To register your warranty, fill in the online form at [www.chacon.com/warranty](http://www.chacon.com/warranty)

## Video tutorial

We have produced a series of video tutorials to make it easier to understand and install our solutions. You can see them on our [Youtube.com/c/dio-connected-home](https://www.youtube.com/c/dio-connected-home) channel, under Playlists.

## Install the light switch

This product must be installed in accordance with the installation rules and preferably by a qualified electrician. Incorrect installation and / or incorrect use may cause risk of electric shock or fire. Cut the power supply before any intervention. Strip around 8mm cables to have a good contact surface.

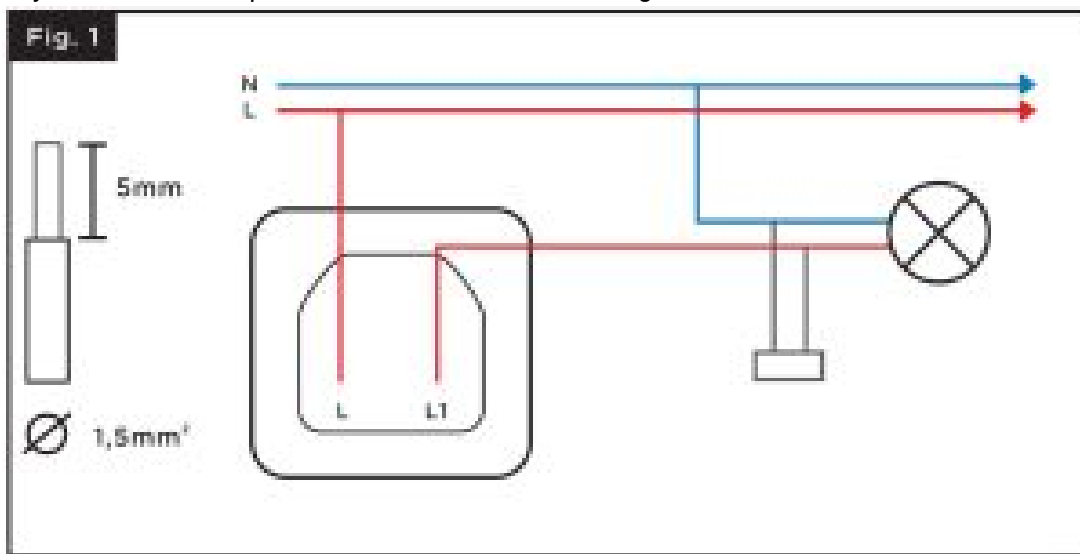

1. Connect L (brown or red) to terminal L of the module
2. Connect the cable coming from the bulb (brown or red) to the L1 terminal of the module
3. Connect the capacitor in parallel with the bulb for optimal operation

## Linking the Switch with a control Dio 1.0

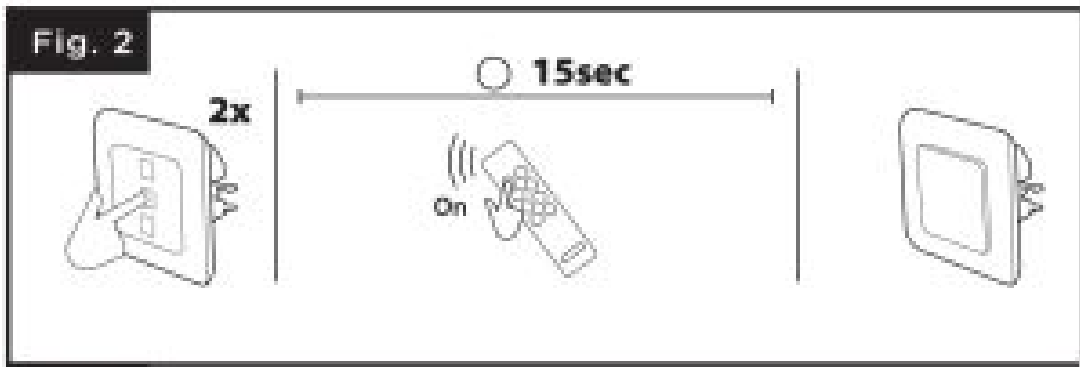

This product is compatible with all Dio 1.0 devices: remote control, switches and wireless detectors. Press the central button twice quickly, the LED starts to flash slowly in light green.

Within 15 seconds, press the 'ON' button on the remote control, the switch LED flashes light green quickly to confirm association.

**Warning:** If you do not press the 'ON' button on your control within 15 seconds, the switch will exit learning mode; you must start from point 1 for the association.

The switch can be linked up to 6 different DiO commands. If the memory is full, you will not be able to install a 7th command, see paragraph 2.1 to delete a command.

## Deleting the link with DiO control device

If you want to delete a control device from the switch :

- Press the central button of the switch twice quickly, the LED will start to flash slowly in light green.
- Press the 'OFF' button of the DiO control to be deleted, the LED flashes light green rapidly to confirm the deletion.

To delete all registered DiO control devices :

- Press during 7 seconds the pairing button of the switch, until the LED indicator turns purple, then release.

## Add the switch into the application

### Create your DiO One account Fig.3

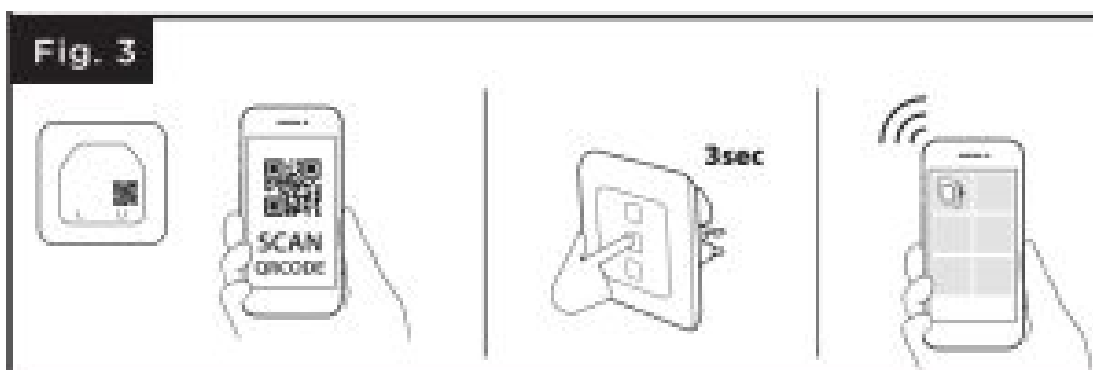

- Scan the QR code to download the free DiO One application, available on the iOS App Store or on Android Google Play.
- Create your account following the instructions in the application.

### **Connect the switch into the Wi-Fi network**

- In the application, select “My devices”; click “+” and then “Install the Connect Wi-Fi device”:
- Select the “DiO Connect Light switch”:
- Power up the DiO switch and press the switch central button during 3 seconds, the LED indicator flashes quickly red.
- Within 3 minutes, click “Install the Connect Wi-Fi device” in the app.
- Follow the installation wizard in the application.

**Warning :** In case the Wi-Fi network or password changed, press the pairing button 3 seconds and in the app press long in the device icon. Then follow the instruction in the application to update the Wi-Fi.

### **Disable Wi-Fi from the switch**

- Press 3 secs on the central button, release and click twice to disable the switch Wi-Fi.
- When Wi-Fi is off, the switch’s LED will appear purple. Press again 3 seconds, release and double click to turn on the Wi-Fi and to control your light with your smartphone

**Note:** The timer created through your smartphone will still be active.

### **Switch light status**

- Steady red: switch is not connected to the Wi-Fi network
- Flashing blue: switch is connected to the Wi-Fi
- Steady blue: switch is connected into the Cloud, turns to white after few seconds
- Steady white: switch on (it can be switch off through the app—discreet mode)
- Steady purple: Wi-Fi disabled
- Flashing green: update download

### **Connect with your vocal assistant**

- Activate the service or the “One 4 All” skill in your voice assistant.
- Enter your DiO One account information.
- Your devices will automatically appear in your assistant app.

### **Reset the switch**

Press during 12 seconds the pairing button of the switch, until the LED flashes light blue, then release. The LED will blink red twice to confirm the reset.

### **Use**

**With the remote control / DiO switch :**

Press the "ON" ("OFF") button on your DiO control to turn the light on (off).

**On the switch :**

Turn on / off the light by pressing the corresponding button once.

**With your smartphone, via DiO One:**

- Switch On/Off from anywhere
- Create a programmable timer: set to the nearest minute with a precise with a switch-off or switch-on, select the day (s) of the week, single or repeated timer.
- Create a countdown: the lights switch off automatically after the allotted time.
- Presence simulation: select the duration of absence and the switch-on periods, the switch will turn on and turn off randomly to protect your home.

**Problem solving**

- The light does not work with a DiO control or detector:
  - Check that your switch is properly connected to the electric current.
  - Check the polarity and / or the exhaustion of the batteries in your order.
  - Check that the memory of your switch is not full, the switch may be linked to maximum 6 DiO commands (remote control, switch and / or detector), see paragraph 2.1 to place an order. Make sure you are using a command using the DiO 1.0 protocol.
- The switch does not appear on the app interface:

Check the light state of the switch: Red LED :

check the status of the Wi-Fi router. Flashing blue LED:

check internet access. Ensure that the Wi-Fi and Internet connection is functional and that the network is within range of the switch.

Make sure the Wi-Fi is on a 2.4GHz band (does not work in 5GHz). During configuration, your smartphone must be on the same Wi-Fi network as the switch.

The switch can only be added to an account. A single DiO One account can be used by all members of the same household.

**Important :** A minimum distance of 1-2 m is necessary between two DiO receivers (module, plug and/or bulb).

The range between the switch and the DiO device may be reduced by the thickness of the walls or an existing wireless environment.

**Technical specifications**

**Protocol:** 433,92 MHz by DiO

**Wi-Fi frequency:** 2,4GHz

**EIRP:** max. 0,7 mW

**Transmission range with DiO devices :** 50m (in free field)

**Max.** 6 associated DiO transmitters

**Operating temperature:** 0 a 35°C

**Power supply:** 220 – 240 V – 50Hz

**Max.:** 200W

**Dimensions :** 85 x 85 x 37 mm



Indoor use (IP20). Do not use in a damp environment



Alternating current

## Supplementing your installation

Supplement your installation with DiO solutions to control your heating, lighting, roller shutters, or garden, or to use video surveillance to keep an eye on what is happening at home. Easy, high-quality, scalable and economical...learn about all of the DiO Connected Home solutions at [www.chacon.com](http://www.chacon.com)

## Recycling



■ In accordance with European WEEE directives (2002/96/EC) and directives concerning accumulators (2006/66/EC), any electrical or electronic device or accumulator must be collected separately by a local system specialising in the collection of such waste. Do not dispose of these products with ordinary waste. Check the regulations in force. The logo shaped like a waste bin indicates that this product must not be disposed of with household waste in any EU country. To prevent any risk to the environment or human health due to uncontrolled scrapping, recycle the product in a responsible manner. This will promote the sustainable use of material resources. To return your used device, use the return and collection systems, or contact the original dealer. The dealer will recycle it in accordance with regulatory provisions.

CE CHACON declares that device Rev-Light is conform with the requirements and provisions of Directive RED 2014/53/EU. The complete text of the EU declaration of conformity is available at the following Internet address: [www.chacon.com/en/conformity](http://www.chacon.com/en/conformity)



Support [www.chacon.com/support](http://www.chacon.com/support)

## Documents / Resources

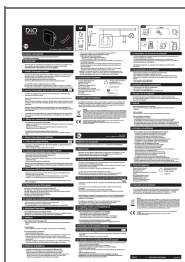

[DIO Rev-Light WiFi Light Switch](#) [pdf] User Manual  
DIO, Rev-Light, WiFi Light Switch