



DiO 54927 WiFi and 433MHz Plug + Remote Control User Manual

[Home](#) » [DiO](#) » DiO 54927 WiFi and 433MHz Plug + Remote Control User Manual 



**54927 WiFi and 433MHz
Plug + Remote Control
User Manual**



Contents

- [1 WiFi and 433MHz Plug + Remote Control](#)
- [2 Video tutorial](#)
- [3 Installing the smart plug](#)
- [4 Linking the plug with a DiO 1.0 control device](#)
- [5 Add the plug into the application](#)
- [6 Reset the plug](#)
- [7 Use](#)
- [8 Troubleshooting](#)
- [9 Technical specifications](#)
- [10 Supplementing your installation](#)
- [11 Documents / Resources](#)
- [12 Related Posts](#)

WiFi and 433MHz Plug + Remote Control

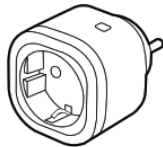

2x 54907



1x 54904



1x CR2032
3V



1x manual

Register your warranty

To register your warranty, fill in the online form at www.chacon.com/warranty

Video tutorial

We have produced a series of video tutorials to make it easier to understand and install our solutions. You can see them on our [Youtube.com/c/dio-connected-home](https://www.youtube.com/c/dio-connected-home) channel, under Playlists.

Installing the smart plug

Plug your lamp or device into the Dia plug, and the DiO plug into your wall socket. Turn on the power of your lamp or device.

Linking the plug with a DiO 1.0 control device

This product is compatible with all DiO 1.0 devices: remote control, switches, and wireless detectors.

2.1 Linking the plug with a DiO 1.0 remote control, switch, or detector

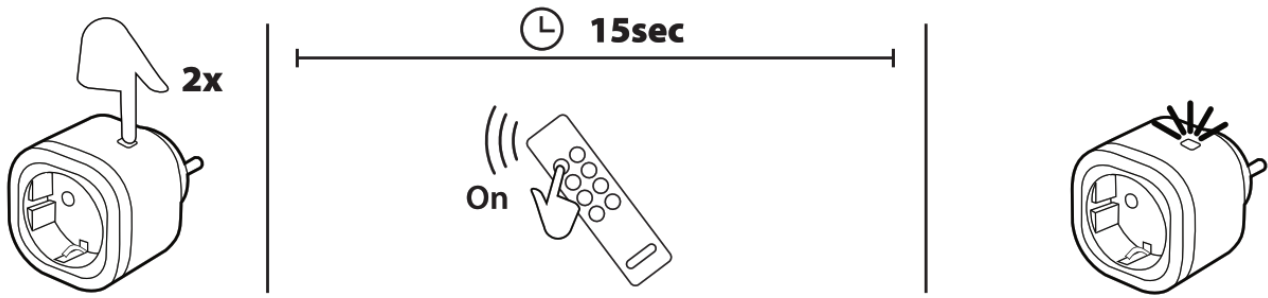

Connect the DiO plug into the wall socket.

- Press fast twice (double click) into the pairing button situated in the plug, the LED indicator starts to blink slowly yellow.
- Within 15 seconds, press the 'ON' button on the remote control, wall switch, or sensor, and the plug's LED flashes quickly yellow to confirm the association.

Warning: If you do not press the 'ON' button of the remote control within 15 seconds, the plug will exit the learning mode. You must restart the procedure in order to link the control device with the plug.

The plug can be linked with up to 6 different DIO control devices. When the plug's memory is full, you'll be unable to add a 7th remote, check paragraph 2.2 to remove one remote.

2.2 Deleting the link with the DiO control device

If you want to delete a control device from the plug:

- Press twice (double click) into the pairing button of the plug, the LED starts to blink slowly yellow.
- Within 15 seconds, press the VFF button of the desired channel or remote to delete, and the LED flashes quickly yellow to confirm the deletion.

To delete all registered DIO control devices:

- Press for 7 seconds the pairing button of the plug, until the LED indicator turns purple, then release.
- Press again the pairing button to confirm you want to remove all DiO control devices from the plug.

Add the plug into the application

3.1 Create your Smart Control account

- Download the free AwoX Smart Control application, available on the iOS App Store or on Android Google Play.
- Create your account following the instructions in the application.

3.2 Connect the plug to the Wi-Fi network

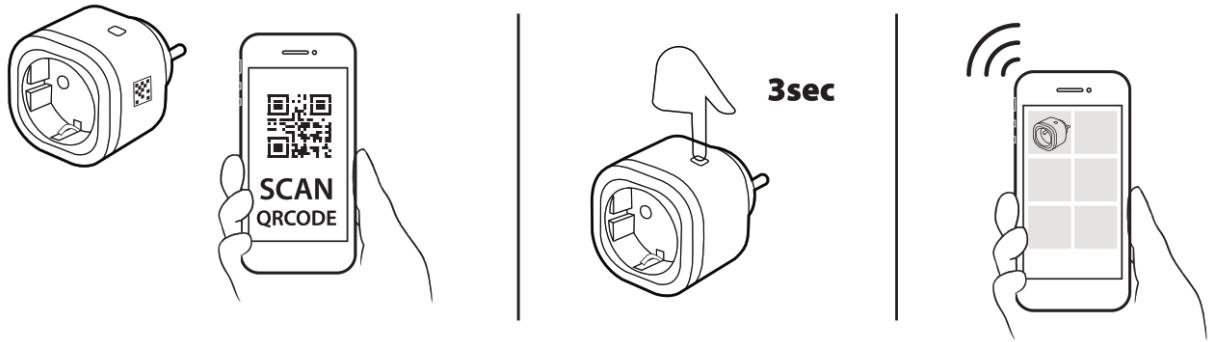

- In the application, select "My devices", click "+" and then "Install the Connect Wi-Fi device".
- Select the "Di0 Connect Plug" or scan the QR code on the plug's label.
- Plug in the Di0 plug into the main socket and press the plug pairing button for 3 seconds, the LED indicator flashes quickly red.
- Within 3 minutes, click "Install the Connect Wi-Fi device" in the app.
- Follow the installation wizard in the application.

Note:

- If the automatic Wi-Fi installation fails, please use the APP mode method to add the device to the application. Check your app for more info.
- In case the Wi-Fi network or password changes, press the pairing button for 3 seconds, and in the app press long in the device icon. Then follow the instruction in the application to update the Wi-Fi.
- If you want to use the device in another account, please perform a factory reset (see paragraph 4).

3.3 Disable Wi-Fi from the plug

- Press 3 secs on the pairing button, release, and click twice to disable the plug's Wi-Fi.
- When Wi-Fi is off, the plug's LED will appear purple. Press again 3 seconds, release and double click to turn on the Wi-Fi, and control your plug with your smartphone

Note: The timer created through your smartphone will still be active.

3.4 Plug's light status

- Steady red: plug is not connected to the Wi-Fi network
- Flashing blue: plug is connected to the Wi-Fi
- Steady blue: plug is connected into the Cloud, turns to white after a few seconds
- Steady white: plug on (it can be switched off through the app – discreet mode)
- Steady purple: Wi-Fi disabled
- Flashing green: update download

Reset the plug

- Press 12 seconds the pairing button of the plug, until the LED flashes light blue, then release.
- Press again the pairing button to confirm the plug reset.

Use

With a DiO remote control or wireless switch:

Press the 'ONTOFF' button once to switch on /off the lamp or electrical device.

On the plug:

Turn on / off the plug by pressing once the button situated in the plug.

With your smartphone, through the Smart Control app:

- Switch on / off from anywhere
- Create a personalized timer: set by the minute and select the day(s) of the week, one-time or repeated timer.
- Create a countdown: the plug will turn off automatically after the allocated time.
- Presence simulation function: select the absence timing and the working period, the plug will turn on/ off randomly to protect your home.

Troubleshooting**• The lighting/ device does not turn on when pressing the remote or switch:**

Check that the plug is correctly connected to the main socket.

Check the polarity of the battery and/or that they are not depleted.

Make sure that the lamp or electrical device is switched on.

Check that the memory of your plug is not full.

You can link a maximum of 6 DiO remote devices (remote control, switch, and/or sensor), check paragraph 2.2 to remove one remote device. Make sure to use a remote control or sensor using DiO 1.0 protocol.

• The plug doesn't appear in the APP interface:

Check the light status of the plug's LED. Steady red LED: check the status of the Wi-Fi router. Flashing blue LED: check the Internet access. Make sure the Wi-Fi and Internet connection is working properly and that the network is within range of the plug. Make sure the Wi-Fi router is working on 2,4GHz (doesn't work with GHz). During the setup, your smartphone should be on the same Wi-Fi network as the plug. The plug can only be added to one account. However, the same Smart Control account can be used by all family members.

• Important: A minimum distance of 1-2 m is necessary between two DiO receivers (module, plug, and/or bulb).

The range between the plug and the DiO device may be reduced by the thickness of the walls or an existing wireless environment.

Technical specifications

Protocol: 433,92 MHz by DiO

Wi-A frequency: 2,4GHz

EIRP: ..c 100mW

Transmission range with DO devices: 50m (in free field)

Max. 6 associated 010 transmitters Operating temperature: 0 a 35°C

Power supply: 220 – 240V – 50Hz

Max.: resistive load: 3000W / 13A

Dimensions: 55 x 55 x 78 mm



Indoor use (IP20). Do not use it in a damp environment

~ Alternating current



Protective earth

Supplementing your installation

Supplement your installation with DiO solutions to control your heating, lighting, roller shutters, or garden, or to use video surveillance to keep an eye on what is happening at home. Easy, high-quality, scalable, and economical... learn about all of the DiO Connected Home solutions at www.chacon.com



Recycling

In accordance with the European WEEE directive (2002/96/EC) and directives concerning accumulators (2006/66/ECL), any electrical or electronic device or accumulator must be collected separately by a local system specializing in the collection of such waste. Do not dispose of these products with ordinary waste. Check the regulations in force. The logo shaped like a waste bin indicates that this product must not be disposed of with household waste in any EU country. To prevent any risk to the environment or human health due to uncontrolled scrapping, recycle the Product in a responsible manner. This will promote the sustainable use of material resources. To return your used device, use the return and collection systems, or contact the original dealer. The dealer will recycle it in accordance with regulatory provisions.



CHACON declares that devices 54904 & 54907 conform with the requirements and provisions of Directive RED 2014/53/EU. The complete text of the EU declaration of conformity is available at the following Internet address: www.chaconconVen/conformity

Support



www.chacon.com/support

V1.0191118

Documents / Resources



[DiO 54927 WiFi and 433MHz Plug + Remote Control](#) [pdf] User Manual

54927, WiFi and 433MHz Plug Remote Control, 54927 WiFi and 433MHz Plug Remote Control