



WSCL30-S
FLUSH
MOUNT
CEILING
LIGHT



DINGLILIGHTING WSCL30-S Flush Mount Ceiling Light User Manual

[Home](#) » [DINGLILIGHTING](#) » DINGLILIGHTING WSCL30-S Flush Mount Ceiling Light User Manual 

Contents

- 1 DINGLILIGHTING WSCL30-S Flush Mount Ceiling Light
- 2 INTRODUCTION
- 3 SPECIFICATIONS
- 4 WHAT'S IN THE BOX
- 5 PRODUCT DETAIL
- 6 FEATURES
- 7 SETUP GUIDE
- 8 CARE & MAINTENANCE
- 9 TROUBLESHOOTING
- 10 PROS & CONS
- 11 WARRANTY
- 12 FREQUENTLY ASKED QUESTIONS
- 13 References
- 14 Related Posts



DINGLILIGHTING WSCL30-S Flush Mount Ceiling Light



INTRODUCTION

The sleek, contemporary style of the DINGLILIGHTING WSCL30-S Flush Mount Ceiling Light elevates the atmosphere of any space. With its E26 LED bulb, this 60-watt fixture offers enough illumination and is ideal for smaller areas like hallways, kitchens, and bedrooms. With a 120-volt power source, the energy-efficient light uses only 60 watts to provide the best possible brightness. It is simple to install and goes well with a range of home décor types because of its small 12.6 x 12.6 x 5.12-inch shape and 3.22-pound weight. This flush mount ceiling light, which retails for \$48.99, combines design and functionality. The fixture, which has been in production since August 15, 2019, is made by DINGLILIGHTING and provides a cost-effective and dependable lighting option for your house. This ceiling light is a great option for modern houses, whether you're building up a new area or updating your lighting.

SPECIFICATIONS

Brand	DINGLILIGHTING
Price	\$48.99
Light Source Type	E26 LED Bulb
Voltage	120 Volts
Wattage	60 watts
Product Dimensions	12.6 x 12.6 x 5.12 inches
Weight	3.22 Pounds
Item Model Number	WSCL30-S
Date First Available	August 15, 2019
Manufacturer	DINGLILIGHTING

WHAT'S IN THE BOX

- Flush Mount Ceiling Light
- User Manual

PRODUCT DETAIL

Product detail

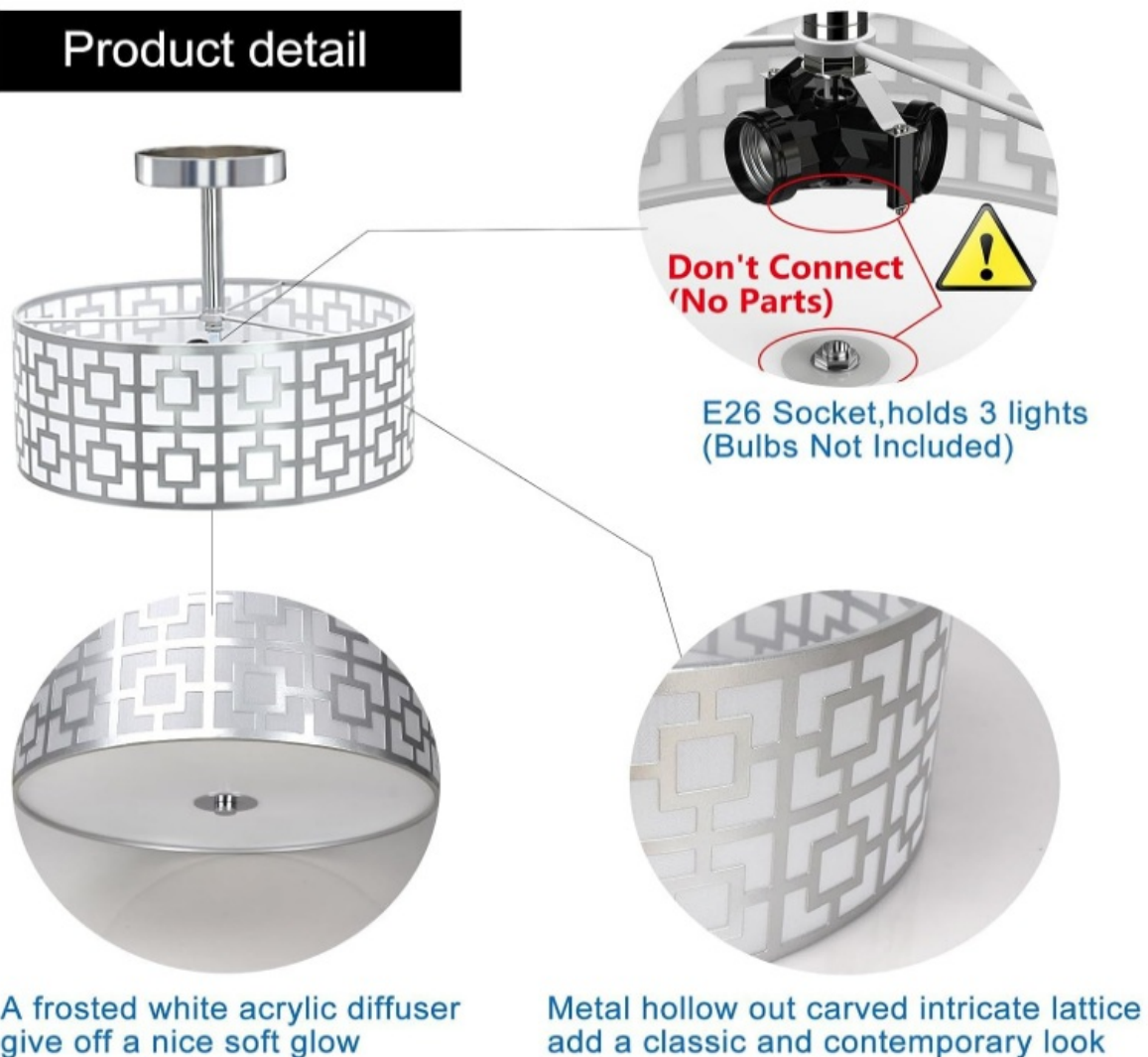

FEATURES

- **Magnificent Carved Art Lampshade:** The flush mount ceiling light enhances any environment with accuracy and elegance thanks to its elaborate geometric design and square grid pattern carved into the metal frame.
- **Soft Ambient Light:** Light may enter through the frosted cover thanks to the open spaces in the carved metal frame, producing a diffused, gentle glow that improves the room's ambiance.
- **Semi-Flush Mount Design:** Suitable for spaces with lower ceilings, the semi-flush mount design brings the light closer to the ceiling. Additionally, it has a sleek, contemporary look that goes well with many interior design themes.
- **Sturdy Design:** Constructed from a double-layered lampshade of acrylic and metal, this ceiling light is easy to maintain, long-lasting, and resistant to bending or deforming over time, guaranteeing a long-lasting, excellent lighting experience.
- **Three E26 Bulb Sockets:** The fixture comes with three E26 bulb sockets that can accommodate halogen, LED, CFL, and incandescent bulbs, giving your room a variety of lighting options.
- **Dimmable Functionality:** You may create the ideal atmosphere for any occasion by adjusting the brightness of the light fixture to suit your needs and preferences.
- **Ample Illumination:** This fixture is appropriate for living rooms, kitchens, corridors, and other spaces that need adequate lighting because of its three-light design, which guarantees bright and even illumination.
- **Ideal Size for a Variety of Spaces:** Measuring 12.6"L x 12.6"W x 10.2"H, the fixture is ideal for tiny spaces or rooms since it offers enough ambient light without taking up a lot of room.



- **Versatile Applications:** The flush mount lamp is a great addition to any home because it can be used in a variety of locations, including bedrooms, bathrooms, home offices, dining rooms, laundry rooms, entryway, study areas, and more.
- **Sleek Brushed Nickel Finish:** The fixture's contemporary brushed nickel finish adds a sophisticated appearance that goes well with both traditional and contemporary interior design themes.
- **Superior Acrylic Shade:** By improving light diffusion, the double-layered acrylic lampshade makes sure that the fixture creates a uniformly lighted area free of harsh shadows.
- **Simple Maintenance:** This fixture's metal and acrylic design makes it easier to clean and maintain than fabric shade ceiling lights. It looks clean and new with only a quick wipe.
- **Reasonably priced:** At \$48.99, this light fixture provides outstanding value for both its functionality and design, making it a reasonably priced yet fashionable lighting option.
- **Energy-Efficient Options:** You may enjoy bright, long-lasting illumination while saving money on energy bills by using the fixture with energy-efficient LED and CFL bulbs.

SETUP GUIDE

- **Assure Safety:** To prevent any electrical hazards, always switch off the power at the circuit breaker before installing the light fixture.
- **Assemble the required equipment:** such as a ladder, wire connectors, and a screwdriver, to guarantee a seamless installation procedure.

- **Verify the ceiling box** to make sure it is firmly in place and strong enough to hold the fixture. Verify that there are no debris or impediments.
- **Put the Fixture Together:** Gently unpack the light fixture and put it together according to the directions that came with it. Make sure everything is fastened securely before attaching the metal frame to the acrylic shade.
- **Mounting Bracket Installation:** Use screws to fasten the mounting bracket to the ceiling box. Verify that the bracket is correctly positioned and firmly fixed.
- **To connect the black and white wires,** connect the black and white wires from the fixture to the black and white ceiling wires, respectively. To make sure the connections are secure, use wire connectors.
- **Grounding the Fixture:** Attach the ground wire of the mounting bracket or ceiling box to the ground wire of your fixture, if it has one.
- **Fixture mounting** involves raising the fixture and lining it up with the mounting bracket. Use the included screws to fasten the fixture to the bracket.
- **Install Bulbs:** Insert the E26 bulbs, each with a maximum power of 60W, into the sockets. Make sure the bulbs are positioned correctly to avoid any illumination problems.
- **Adjust the Fixture:** Make sure the fixture is centered and level on the ceiling by making any required changes.
- **Test the Light:** To make sure everything is operating as it should, turn the power back on at the circuit breaker and test the light.
- **Verify Stability:** To make sure the fixture is firmly fixed and does not wobble, carefully inspect it for stability.
- **Verify Dimming Function:** Make sure the brightness can be adjusted to your liking by testing the dimming operation.
- **Final Touches:** Before using the new light fixture, make sure all the parts, wiring, and bulbs are safe and placed correctly.
- **Savor the Illumination:** After the lamp is fitted, switch it on and take in the gentle, uniform illumination it offers your room.



CARE & MAINTENANCE

- **switch Off Power:** Prior to cleaning or doing any maintenance on the fixture, always switch off the power at the circuit breaker.
- **Frequent Dusting:** To avoid dirt accumulation and preserve the fixture's look, dust the acrylic shade and metal frame on a frequent basis using a soft, dry cloth.
- **Steer Clear of Harsh Cleaners:** Avoid using harsh chemicals or abrasive cleaners as they may harm the acrylic shade or finish. It only takes a little wipe with a moist towel.
- **Clean the Acrylic Shade:** To get rid of any dust, smudges, or fingerprints, gently wipe the acrylic shade down with a clean cloth. Anything abrasive that might scratch the surface should be avoided.
- **Examine the Bulbs:** Make sure the bulbs are operating correctly by checking them on a regular basis. For steady illumination, replace any burned-out bulbs right away.
- **Tighten Loose Parts:** To avoid instability or possible damage, periodically inspect for any loose screws or parts and tighten them.
- **Examine Wiring Connections:** Look for any indications of fraying or wear on the wiring connections. Get in touch with a specialist for repair if you see any problems.
- **Avoid Overloading Bulb Wattage:** To prevent overheating and possible fixture damage, always use bulbs with the recommended wattage (60W per socket).
- **Avoid Direct Sun Exposure:** The acrylic shade may become discolored after extended exposure to direct sunlight. To keep the fixture looking nice, place it somewhere out of direct sunlight.

- **Clean the Ceiling Mount:** To get rid of any dust or grime that could have accumulated, wipe the ceiling mount down with a moist cloth.
- **Examine the metal parts** for indications of corrosion or rust, particularly if the fixture is exposed to dampness. If required, clean and apply a protective coating.
- **Lubricate Moving Parts:** To guarantee smooth functioning, lubricate any adjustable parts of the fixture with a tiny bit of oil.
- **Verify Fixture Alignment:** To preserve the fixture’s aesthetic appeal, make sure it is level and well-aligned, particularly after cleaning or maintenance.
- **Replace Worn Components:** To guarantee safe operation, replace any worn or broken fixture components as soon as possible, such as the mounting bracket or shade.
- **Professional check:** To make sure the fixture is in safe operating condition, arrange for a professional check if you experience any electrical problems or if it starts to become unstable.

TROUBLESHOOTING

Problem	Possible Solution
Light fixture not turning on	Check the power connection and verify the light switch is working. Ensure the bulb is correctly installed.
Light flickering	Ensure the bulb is securely installed and try replacing the bulb with a compatible one.
Light is dim	Use a higher-wattage compatible bulb or check for a faulty bulb. Ensure it’s securely connected.
Overheating	Ensure proper ventilation around the fixture. Turn off the light and let it cool.
Light not illuminating at all	Replace the bulb and ensure the fixture is properly connected to the power source.
The light turns on and off randomly	Check the wiring connections and bulb for any damage. Consider replacing the bulb.
Fixture makes a buzzing sound	Tighten the bulb, or try a different type to see if the buzzing persists.
Poor light distribution	Ensure the fixture is correctly positioned and is not blocked by any obstructions.
Issues with installation	Follow the manufacturer’s manual carefully for proper setup or seek professional help.
App control not working (if applicable)	Ensure the app is connected to your device and Bluetooth is enabled. Restart the app or reconnect the light.

PROS & CONS

Pros:

1. Energy-efficient E26 LED bulb saves power and lasts longer.
2. Compact design that fits most ceiling spaces without overwhelming the room.
3. Affordable pricing of \$48.99 for a stylish and functional light fixture.
4. Easy installation, making it perfect for DIY enthusiasts.

5. Provides bright and consistent light with a 60-watt output.

Cons:

1. Limited compatibility with certain dimmer switches due to LED technology.
2. May not provide sufficient light for very large rooms.
3. Non-adjustable brightness limits customization.
4. Plastic construction may not be as durable as metal alternatives.
5. May require professional installation for some users due to its flush mount design.

WARRANTY

The DINGLILIGHTING WSCL30-S Flush Mount Ceiling Light comes with a **1-year limited warranty**. This warranty covers defects in materials or workmanship under normal use. If you encounter any issues with the product within this period, the manufacturer will provide either a repair or replacement. The warranty does not cover damage caused by misuse, improper installation, or external factors. Ensure that the installation is carried out as per the manufacturer's guidelines to maintain the validity of the warranty.

FREQUENTLY ASKED QUESTIONS

What is the DINGLILIGHTING WSCL30-S Flush Mount Ceiling Light?

The DINGLILIGHTING WSCL30-S Flush Mount Ceiling Light is a modern and sleek lighting fixture designed to provide bright, efficient illumination while saving space. It uses an E26 LED bulb for long-lasting brightness.

What is the price of the DINGLILIGHTING WSCL30-S Flush Mount Ceiling Light?

The DINGLILIGHTING WSCL30-S Flush Mount Ceiling Light is priced at \$48.99, making it an affordable and stylish lighting solution for various indoor spaces.

What type of light source does the DINGLILIGHTING WSCL30-S Flush Mount Ceiling Light use?

The DINGLILIGHTING WSCL30-S Flush Mount Ceiling Light uses an E26 LED bulb, known for its energy efficiency and long lifespan, helping to reduce power consumption.

What is the voltage of the DINGLILIGHTING WSCL30-S Flush Mount Ceiling Light?

The DINGLILIGHTING WSCL30-S Flush Mount Ceiling Light operates at 120 volts, which is compatible with most household electrical systems in North America.

What is the wattage of the DINGLILIGHTING WSCL30-S Flush Mount Ceiling Light?

The DINGLILIGHTING WSCL30-S Flush Mount Ceiling Light has a wattage of 60 watts, providing efficient illumination while helping to conserve energy.

What are the dimensions of the DINGLILIGHTING WSCL30-S Flush Mount Ceiling Light?

The DINGLILIGHTING WSCL30-S Flush Mount Ceiling Light has product dimensions of 12.6 x 12.6 x 5.12 inches, making it a compact yet powerful lighting option for smaller to medium-sized rooms.

How much does the DINGLILIGHTING WSCL30-S Flush Mount Ceiling Light weigh?

The DINGLILIGHTING WSCL30-S Flush Mount Ceiling Light weighs 3.22 pounds, providing a solid, durable structure that is still light enough for easy installation.

When was the DINGLILIGHTING WSCL30-S Flush Mount Ceiling Light first made available?

The DINGLILIGHTING WSCL30-S Flush Mount Ceiling Light was first made available on August 15, 2019, offering modern lighting solutions for over five years.

References

- [User Manual](#)

[Manuals+](#), [Privacy Policy](#)

This website is an independent publication and is neither affiliated with nor endorsed by any of the trademark owners. The "Bluetooth®" word mark and logos are registered trademarks owned by Bluetooth SIG, Inc. The "Wi-Fi®" word mark and logos are registered trademarks owned by the Wi-Fi Alliance. Any use of these marks on this website does not imply any affiliation with or endorsement.