

Dimplex DCFF40C High Velocity Oscillating Floor Fan Instruction Manual

[Home](#) » [Dimplex](#) » Dimplex DCFF40C High Velocity Oscillating Floor Fan Instruction Manual 

Dimplex DCFF40C High Velocity Oscillating Floor Fan

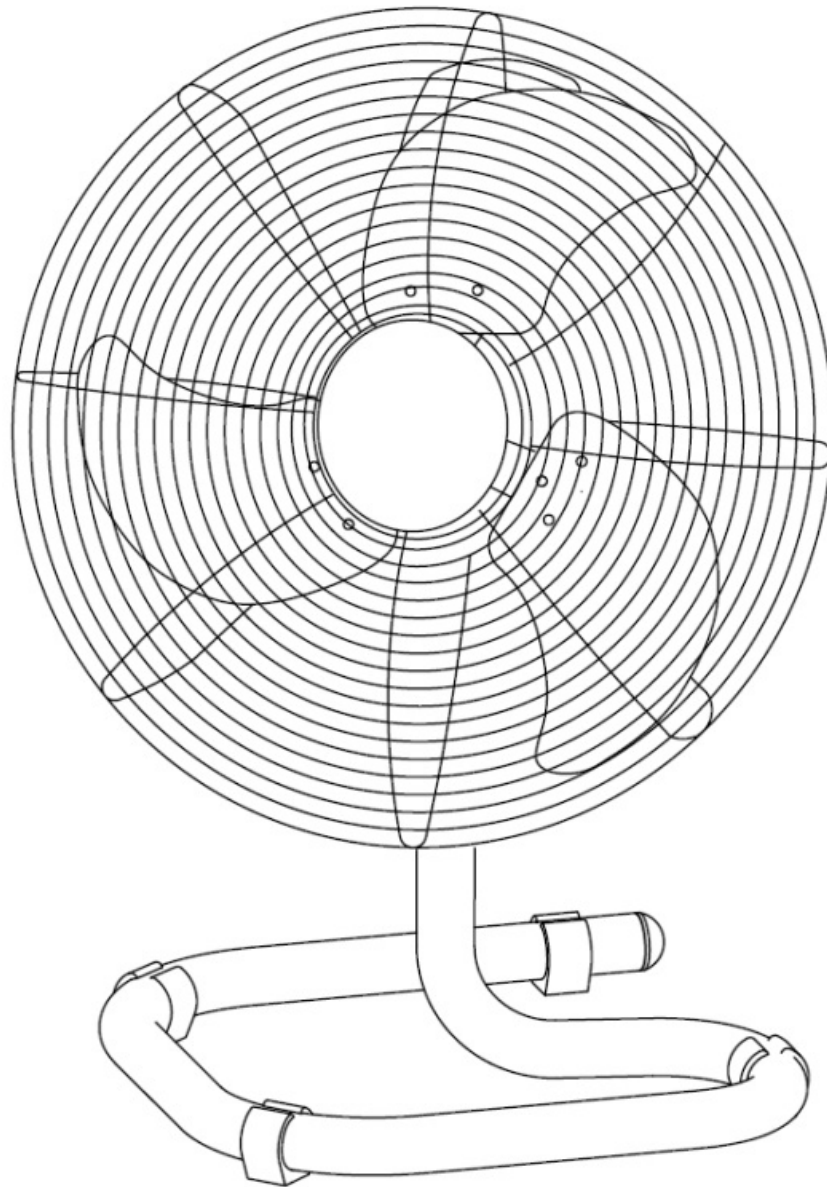

Contents

- [1 WARNINGS AND PRECAUTIONS](#)
- [2 STRUCTURE](#)
- [3 OPERATION](#)
- [4 CLEANING AND MAINTENANCE](#)
- [5 TECHNICAL REFERENCE DATA](#)
- [6 Documents / Resources](#)
 - [6.1 References](#)
- [7 Related Posts](#)

WARNINGS AND PRECAUTIONS

Warnings

- Never place the unit near gas appliances, flames or flammable liquids.
- Never hit or shake the unit. Doing so may cause damage.
- Never cover or obstruct the air inlet or outlet. Doing so may cause overheating.
- Never spray water on or place the unit near water. Doing so may cause electric shock.

- Never connect other appliances to the same power outlet.
- Never connect or disconnect the power plug with wet hands. Doing so may cause electric shock.
- Never insert fingers or objects through the guards when the unit is operating.
- Never use an extension cord.
- Always have a professional technician, manufacturer or service agent replace a damaged power cord.

Precautions

- This appliance is for indoor use only.
- Do not use the unit near windows or where water collects. Rain and water collection may lead to a risk of fire or electric shock.
- Do not place the unit in a damp place or where humidity is high (such as a bathroom).
- Do not leave the unit operating while unattended.
- Do not place the unit in direct sunlight to avoid surface discoloration.
- This appliance is not intended for use by persons (including children) with reduced physical, sensory or mental capabilities, or lack of experience and knowledge, unless they have been given supervision or instruction concerning use of the appliance by a person responsible for their safety.
- Children should be supervised to ensure they do not play with the appliance.
- Avoid electromagnetic interference. Keep the unit at least 1 metre away from electric appliances such as televisions and radios.
- Avoid scratching and damaging the surface. Do not use chemical solvents (i.e. Benzene, alcohol) to clean the surface.
- Place the unit on a stable surface when operating.
- Unplug the unit before cleaning, servicing or maintenance.
- Electrical connections must be in accordance with National or Local Codes.
- The rear of the unit must be at least 50cm away from the wall and clear of any surroundings.
- If the supply cord is damaged, it must be replaced by the manufacturer, its service agent or similarly qualified persons in order to avoid a hazard.

STRUCTURE

1. Front guard
2. Fixing screw #1
3. Fan blade
4. Rear guard securing nut
5. Rear guard
6. Motor shaft
7. Motor
8. Speed switch
9. Oscillation knob
10. Power cord
11. Fixing screw #2
12. Metal stand

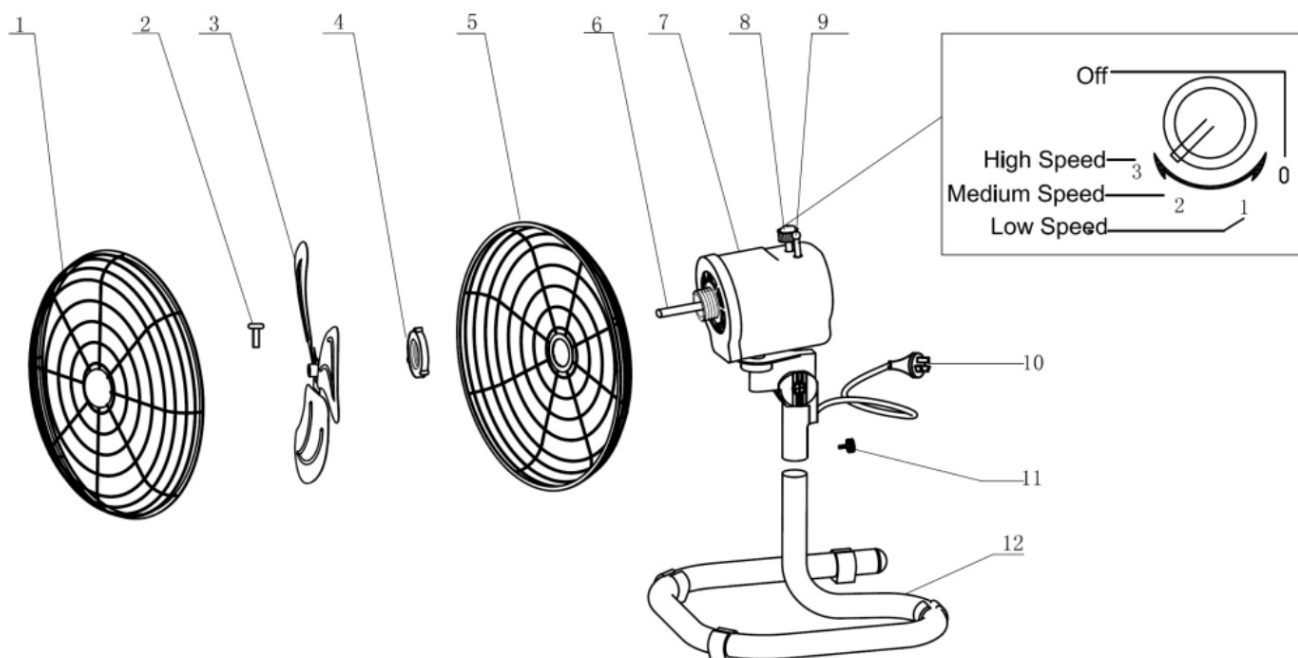

OPERATION

BEFORE FIRST USE

- Please read these instructions carefully before use and keep them for future reference.
- Check your local main voltage whether it is the same as stated on the appliance.
- Before using for the first time, remove any protective films or stickers from the appliance and ensure the power switch is in the “OFF” position.

ASSEMBLY

1. Lift the stand upright. Assemble the motor shaft (6 & 10) onto the metal stand (12) by fastening the fixing screw #2 (11).
2. Unscrew the rear guard securing nut (4) from the motor shaft (6) by turning the nut anti-clockwise.
3. Mount the rear guard (5) to the motor unit (7) as aligned with the three positioning pins on the motor shaft. Secure the rear guard with securing nut (4) by turning it in a clockwise direction.
4. Assemble the fan blade (3) to the motor shaft (6) and tighten the fixing screw #1 (2). **IMPORTANT:** Make sure the fixing screw (2) is tightened on the surface of the motor shaft (6).
5. Attach the front guard (1) to the rear guard (5) and close all clips and lock the safety screw at the bottom of the guard.

OPERATION

1. Connect the plug to a power supply and switch on the power.
2. **On/Off**
 - Switch the fan on by rotating the speed switch (8) at the rear in clockwise direction. The switch is also used to adjust the fan speed from HIGH “3” – **MEDIUM** “2” – **LOW** “1” in sequence.
 - The airflow direction can be adjusted upward/downward by simply lift up or down the motor unit or rear guard. **NOTE:** Only adjust the fan head when the unit is OFF. Be careful not to insert your fingers through the guard.
 - Turn the switch anti-clockwise to turn the fan OFF.

3. Speed

- Turn speed control switch (8) repeatedly to adjust the fan speed from HIGH "3"- **MEDIUM "2"**- **LOW "1"** in sequence. Turn the switch in anti-clockwise to turn OFF.

4. Oscillation

- To activate the oscillation function, push down the oscillation knob (9). Pull up the oscillation knob (9) to stop oscillation at the desired direction of airflow.

CLEANING AND MAINTENANCE

CLEANING

Over time, dust can accumulate on the fan blades, which can affect the fans performance. It is recommended to clean the fan at least once a month.

1. Turn the unit OFF and disconnect the appliance from the main power supply.
2. Remove any dust build up with a soft brush.
3. Wipe the surface of the unit with a soft damp cloth. Mild detergent can be used for any stubborn marks.
4. Do not allow the motor or other electrical parts to come in contact with water.
5. Do not use abrasive sponges, scouring pads, or a stiff brush to clean the appliance.
6. When the fan is not being used for long periods, it's recommended to store the fan in its original box in a low humidity environment.

IMPORTANT

The control panel and other parts must not come into contact with water or any other liquids.



- Do not dispose of electrical appliances as unsorted municipal waste. Use separate collection facilities.
- Contact your local government for information regarding the collection systems available.
- If electrical appliances are disposed of in landfills or dumps, hazardous substances can leak into the ground water, polluting the food chain and damaging health and well-being.

MAINTENANCE

If the unit fails to operate efficiently, is broken or other problems arise, unplug and do not operate.

Ask for advice by calling your local after sales service agent or the Customer Care Centre on 1300 556 816 (AU) / 0800 666 2824 (NZ).

TECHNICAL REFERENCE DATA

Model		DCFF40C / DCFF40GBLK
Rated Power		60W
Voltage/Frequency		220-240V/50Hz
Net Weight		4kg
Dimensions HxWxD	Body (mm)	450x550x320
	Package (mm)	250x460x460
		

WARRANTY

The warranty period is 12 months from the date of purchase. For service advice, please contact the Customer Care Centre on 1300 556 816 (AU) /

0800 666 2824 (NZ). Glen Dimplex Australia Pty Ltd Glen Dimplex Australasia Ltd 1340 Ferntree Gully Road, 38 Harris Road, East Tamaki, Scoresby 3179, Victoria Auckland 2013 Australia New Zealand
Ph: 1300 556 816 Ph: 0800 666 2824

Documents / Resources

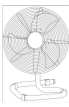
 <p>INSTRUCTION MANUAL</p>	<p>Dimplex DCFF40C High Velocity Oscillating Floor Fan [pdf] Instruction Manual DCFF40C High Velocity Oscillating Floor Fan, DCFF40C, High Velocity Oscillating Floor Fan, Velocity Oscillating Floor Fan, Oscillating Floor Fan, Floor Fan</p>
--	--

References

-  [Manual-Hub.com](https://www.manual-hub.com) - Free PDF manuals!
- [User Manual](#)

Manuals+. Privacy Policy

This website is an independent publication and is neither affiliated with nor endorsed by any of the trademark owners. The "Bluetooth®" word mark and logos are registered trademarks owned by Bluetooth SIG, Inc. The "Wi-Fi®" word mark and logos are registered trademarks owned by the Wi-Fi Alliance. Any use of these marks on this website does not imply any affiliation with or endorsement.