



Digitek DAC-001 Action Camera Instruction Manual

[Home](#) » [DigiTek](#) » Digitek DAC-001 Action Camera Instruction Manual 



Action Camera
DAC-001
Instruction Manual



Contents

- 1 CAUTIONS
- 2 THE BASIC
- 3 GETTING STARTED
- 4 OVERVIEW OF MODES
- 5 CUSTOMIZING YOUR CAMERA
- 6 Video Settings:
- 7 VIDEO MODE
- 8 PHOTO MODE
- 9 ADJUSTING THE ZOOM LEVEL
- 10 PLAYBACK
- 11 BATTERY
- 12 Wi-Fi APP
- 13 WATERPROOF CASE
- 14 EXTERNAL MIC
- 15 Mounting Your Camera
- 16 Documents / Resources
 - 16.1 References
- 17 Related Posts

CAUTIONS

- Digitek 4K Action Camera DAC-001, normal for the housing to exert heat under use.
- Don't expose the product directly to high temperatures over 40°C.
- Please peel off transparent protective films on lens and screen of camera before using.
- Please properly protect well the lens and screen of camera after using.
- Keep it safe from falling and dropping.
- Keep it distance from any strong magnetic interference objects like electrical machine to avoid strong radio waves that might be damaging the product and affect the sound or image quality.
- In case of overheating, unwanted smoke from the device, unplug it immediately from the power outlet to prevent hazardous fire.
- Keep it safety from children while on charging.
- Stored the device in a cool, dry and dust free location.
- Do not modify the camera it in any way, if the camera has been detached, the warranty will be void.

THE BASIC

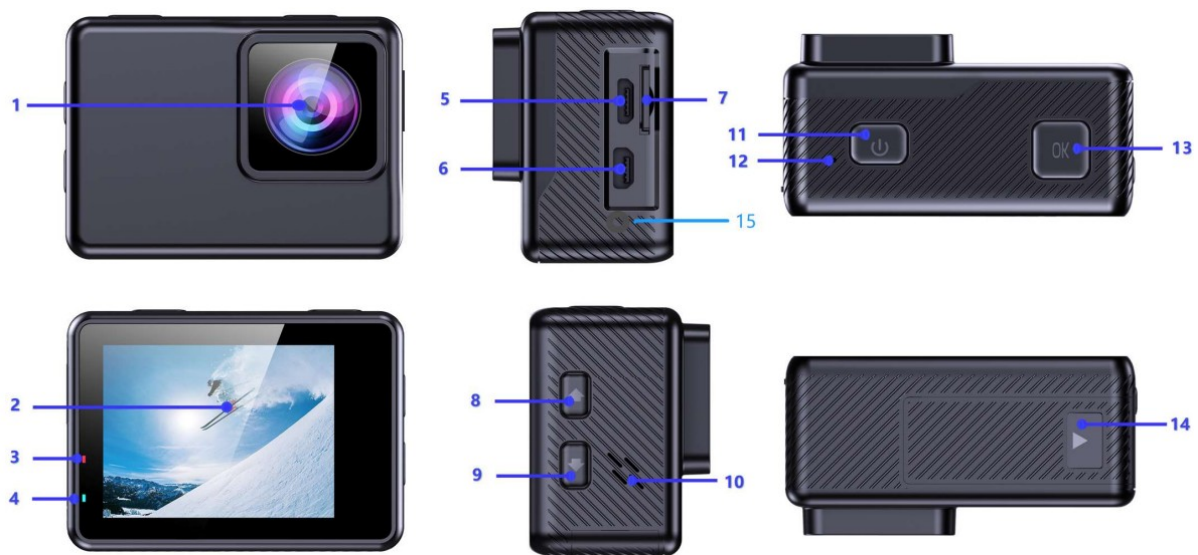

1. Lens
2. Screen
3. Charging Indicator
4. Working Indicator
5. Micro USB Port
6. HD Output Port
7. Micro SD Card Slot
8. UP / Wi-Fi /Zoom in Button
9. Down / Remote /Zoom out /Beauty Button
10. Speaker
11. Mode / Power Button
12. Working Indicator
13. Shutter / Select Button
14. Battery Door
15. DC 2.5 External Microphone

Tips

- Verify the camera is in Video Mode, Press and hold the Up Button to turn on/off Wi-Fi.
- Verify the camera is in Photo Mode, Press and hold the Up Button or Down Button to Zoom in/out photo.
- Verify the camera is in Photo Mode, Press quickly the Up Button to turn on/off Beauty Photo.

GETTING STARTED

HELLO

Welcome to your new Digitek 4K Action Camera DAC-001 camera. To capture video and photos, you need a micro SD card (not included).

We strongly recommend using the branded memory cards purchased from regular channels for maximum reliability and stability during recording and in high vibration activities.

STORAGE/MICRO CARDS

Use brand name memory cards that meet following requirements, we strongly recommend using the branded memory cards purchased from regular channels for maximum reliability and stability during recording and in high vibration activities.

- Micro SD, Micro SDHC, or Micro SDXC
- UHS-III rating at least for 4K Video resolution
- Capacity up to 128GB (FAT32)

NOTES:

- Please format the micro SD, micro SDHC and micro SDXC memory card on the camera before using.
- Please insert the memory card in correct way . if not , the card slot maybe damage by the wrong way.
- To keep your micro SD card in good condition, reformat it on a regular basis.
- Micro SD card stops recording when the storage of each file is over 4GB and starts to record again on a new file.
- Reformatting erases all of your content, so be sure to offload your photos and videos first.
- Don't place your Micro SD card near strong magnetic objects to avoid data error or loss.

POWERING ON + OFF

To Power On:

Press and hold the Power button for seconds. The camera beeps while the camera status light is on. When information appears on the LCD display your camera is on.=

To Power Off:

Press and hold the Power button for seconds. The camera beeps while the camera status light is off.

OVERVIEW OF MODES

There are 3 modes: Video Mode, Photo Mode, and Playback & Setting Mode. The modes will appear in following order:

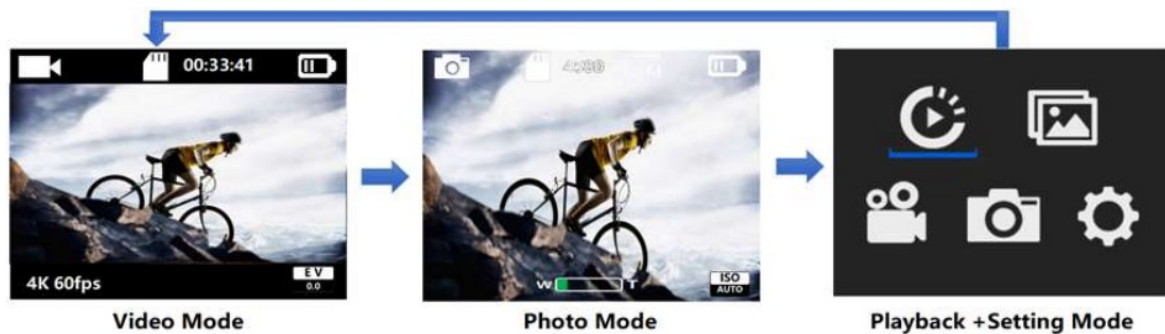

SWITCHING MODE

Button Operation:

Turn on the camera; press the Power button to cycle through camera modes and settings.

CUSTOMIZING YOUR CAMERA

Playback & Setting Mode will cycle in following order:

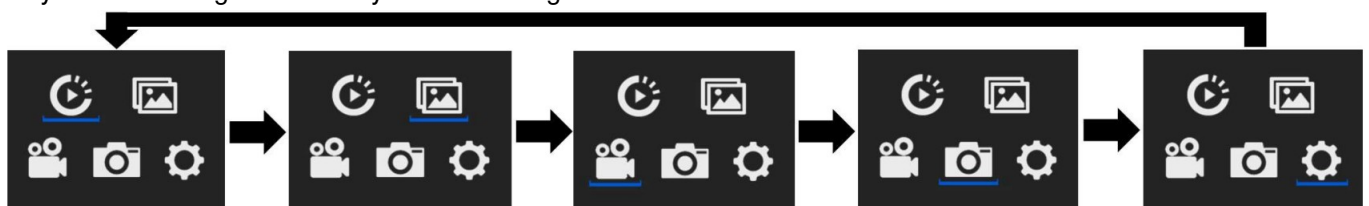

VIDEO SETTING

Button Operation:

Verify the camera is in Video Setting Mode; press the Shutter button to enter the Video Settings menu. Then press the UP or Down button repeatedly to cycle through the options, and press the Shutter button to select the desired option. To exit, press the Mode button again.

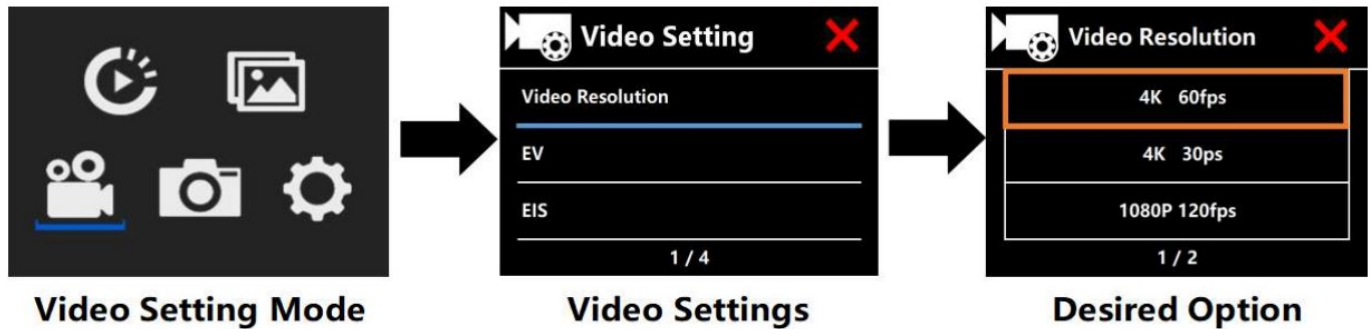

Video Settings:

Video Resolution: 4K 60fps / 4K30fps / 2.7K 60FPS/2.7K 30FPS/ 1080P 120fps / 1080P 60fps / 1080P 30fps / 720P 240fps

Default setting is 4K 60fps.

Note:

- When capturing video at high resolution or high frame rates such as 4K 60fps, the camera may become hot and consume more power, which is normal.
- FAT32 format Micro SD card stops recording when the storage of each file is over 4GB and starts to record again on a new file

■ EV(Exposure Value): -3 ~ +3

By default, your camera uses the entire image to determine the appropriate exposure level. However, EV lets you select an area that you want the camera to prioritize when determining exposure. This setting is particularly useful in shots where an important region might otherwise be over- or underexposed.

When you change this setting, the LCD display immediately shows you the effect on your image. If you change modes, the camera returns to using the entire scene to determine the correct level of exposure.

■ 6 Axis Gyros EIS Stabilization – EIS (Electronic Image Stabilization) : ON/OFF

This camera is equipped EIS function with 6-axis gyroscope to detect motion changes. When the camera tilts, moves, shakes, the sensor use image cross-border compensation algorithm to compensate the change and produce stable videos, especially in activities with relatively small angle (about 6 degrees) but fast motion including cycling, motorcycling, and hand-held uses.

Note:

- EIS does not support 720P 120fps video resolution.
- If you turn on EIS, Loop Video, Time Lapse Video, TL Duration, Slow Motion and Auto Low Light will not be available automatically.

■ Loop Video : Off / 1min /3min/ 5min

When the micro SD card is full, the new files will cover the old one if loop recording is on.

Note:

- FAT32 format Micro SD card stops recording when the storage of each file is over 4GB and starts to record again on anew file.
- If you select Loop Video, EIS, Time-Lapse Video, TL Duration, Slow Motion and Auto Low Light will not be

available automatically.

■ Time-Lapse Video: Off / 1Sec / 3Secs / 5Secs / 10Secs / 30Secs / 1min

Default setting is off.

Time Lapse Video creates video from frames captured at specific intervals. This option lets you capture a time lapse event and immediately view or share it as a video.

Select 3 seconds means recording 3 seconds to get one frame per second.

For example: If you select 4K/30FPS and 3 secs, you need to record 90secs, then you can get 1 sec video for 4K/30FPS.

Note:

- Time Lapse Video is captured without audio.
- If you select Time-Lapse Video, the camera cannot record the video over 30fps.
- If you select Time-Lapse Video, EIS, Loop Video, Slow Motion, Fast Motion and Auto Low Light will not be available automatically.

■ TL Duration: Unlimited/5Mins / 10Mins / 15Mins / 20Mins/ 30Mins / 60Mins

Continuously creates Time Lapse Video at specific duration.

Note: If you want to set Time Lapse Duration, please turn on Time Lapse Video first.

■ Slow Motion: On / Off

Slow motion is an effect in film-making whereby time appears to be slowed down.

Note:

- If you select Slow Motion, please turn off EIS, Time-Lapse Video and Fast Motion first, then choose 1080P 60fps/720P120fps Video Resolution.
- If you select Slow Motion, EIS, Time-Lapse Video and Fast Motion will not be available automatically.

■ Fast Motion: Off / 2x / 4x / 6x / 10x / 15x

Action that appears to move faster than normal on the screen, accomplished by filming the action at less than normal speed in the camera and then projecting it at normal speed.

Note:

- If you select Fast Motion, please turn off EIS, Time-Lapse Video and Slow Motion first.
- If you select Fast Motion, Time-Lapse Video and Slow Motion will not be available automatically.

■ FOV (Field of View): Wide/Medium/Narrow

Default setting is wide.

FOV refers to how much of the scene (measured in degrees) can be captured through the camera lens.

■ Auto Low Light: On / Off

Default setting is off.

Auto Low Light mode will automatically adjust the brightness in low light conditions to achieve the best low light performance.

■ Date Stamp: Off / Date / Date & Time

If you turn on Date Stamp, this camera adds date/time stamp to the videos you record.

If you turn off Date Stamp, this camera will not add date/time stamp to the videos you record.

PHOTO SETTING

Button Operation:

Verify the camera is in Photo Setting Mode; press the Shutter button to enter the Photo Settings menu. Then press the UP or Down button repeatedly to cycle through the options, and press the Shutter button to select the desired option. To exit, press the Mode button again.

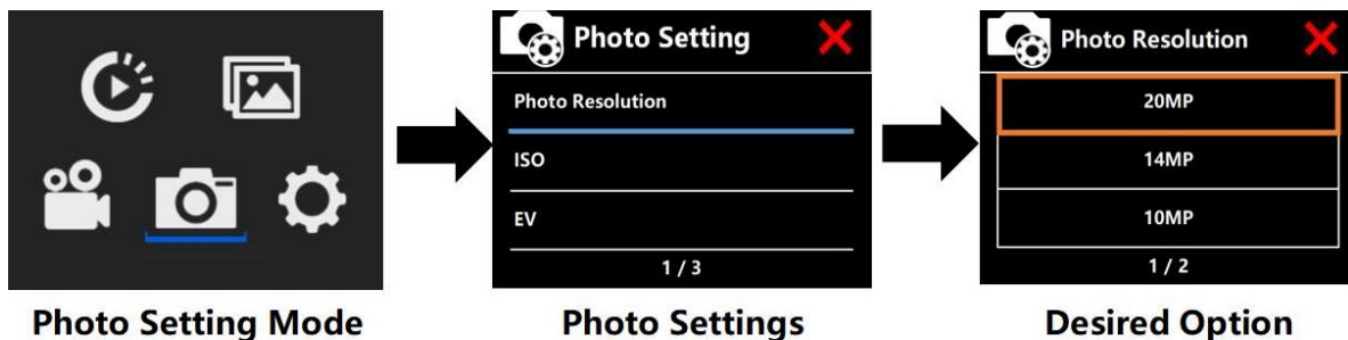

Photo Settings:

■ **Photo Resolution: 48M/24M/ 20M/16M/14M/12M/10M/8M**

Default setting is 12M

■ **ISO: Auto / 100 / 200 / 400 / 800 / 1600 / 3200**

Default setting is Autoing

ISO determines the camera's sensitivity to light, and creates a trade-off between brightness and resulting image noise. Image noise refers to the degree of graininess in the image. In low light, higher ISO values result in brighter images, but with greater image noise. Lower values result in lower image noise, but darker images. When you change this setting, the display immediately shows you the effect on your image.

■ **EV(Exposure Value): -3 ~ +3**

By default, your camera uses the entire image to determine the appropriate exposure level. However, EV lets you select an area that you want the camera to prioritize when determining exposure. This setting is particularly useful in shots where an important region might otherwise be over- or underexposed.

When you change this setting, the LCD display immediately shows you the effect on your image. If you change modes, the camera returns to using the entire scene to determine the correct level of exposure.

■ **Time Lapse Photo: Off / 3Sec / 5Sec / 10Sec / 30Sec / 1min**

Time Lapse Photo captures a series of photos at specified intervals. Use this mode to capture photos of any activity, and then choose the best ones later.

Note: If you select Time Lapse Photo, Burst Photo, Delay Timer and Long Exposure will not be available automatically.

■ **TL Duration: Unlimited /5Mins / 10Mins /15Mins / 20Mins/ 30Mins / 60Mins**

Default setting is Unlimited.

Note: If you want to select TL Duration, please turn on Time Lapse Photo first.

■ **Burst Photo: Off / 3photos / 5photos / 15Photos / 30Photos**

Default setting is off.

Continuous shooting can take up to 30 photos in a certain amount of time, making it ideal for fast-moving events.

- If you select Burst Photo function, Time Lapse Photo, TL Duration and Long Exposure will not be available automatically.

■ **Self-Timer: 2sec / 10sec**

A Delay Timer gives a delay between pressing the shutter release and the shutter's firing. It is most commonly used to let photographers to take a photo of themselves (often with family).

Note:

If use Delay Timer function, Time Lapse Photo, TL Duration and Long Exposure will not be available automatically.

■ **Long Exposure Off / 1sec / 3sec / 5sec / 8sec / 30sec / 60sec**

Default setting is off.

Long Exposure is an exposure method that selects a slow shutter speed. Long exposures can make dark scenes clearer and get fantastic effects. Especially in night vision scenes such as starry sky or city night traffic, the camera can also take fantastic photos at night.

Note:

- If you select Long Exposure function, Time Lapse Photo, TL Duration, Burst Photo and Delay Timer will not be

available automatically.

■ **Date Stamp: Off / Date / Date & Time**

If you turn on Stamp, this camera adds stamp to the photos you take.

If you turn off Stamp, this camera will not add stamp to the photos you take.

SYSTEM SETTING

Button Operation:

Verify the camera is in System Setting Mode; press the Shutter button to enter the System Settings menu. Then press the UP or Down button repeatedly to cycle through the options, and press the Shutter button to select the desired option.

To exit, press the Mode button again.

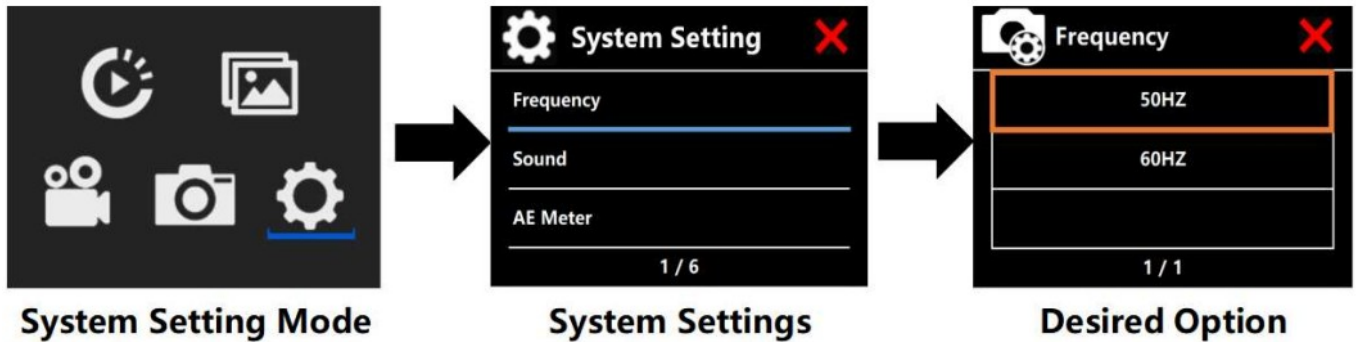

System Settings:

■ **Frequency: 50Hz/60Hz**

Default setting is 50 Hz.

■ **Sound: Shutter / Boot-up / Beep / Volume**

- **Shutter: On / Off**
Sets the Camera's Shutter Sound.
- **Boot-up: On / Off**
Sets your camera's Power on Sound.
- **Beep: On/Off**
Sets the Camera's Operation Sound.
- **Volume: 0 / 1 / 2 / 3**
Sets the volume of your camera's record sound.

■ **AE Meter: Center / Multi / Spot**

Default setting is Center

In photography, the metering mode refers to the way in which a camera determines exposure. Cameras generally allow the user to select between center, average or spot metering modes. The different metering modes allow the user to select the most appropriate one for use in a variety of lighting conditions

■ **AWB: Auto / daylight / cloudy / Incandescent / Fluorescent / Snorkeling / Snow Mode**

AWB (Auto White Balance) lets you adjust the color temperature of videos and photos to optimize for cool or warm lighting conditions. When you change this setting, the LCD display immediately shows you the effect on your image.

Note:

- Snorkeling mode provides color correction while capturing footage in blue water or clear freshwater at depths of 5 to 33ft (1.5 to 10m)
- Snow mode can suppress overexposure in high-brightness environments such as snow field or beach.

■ **Effect: Standard / Black & White / Natural / Negative / Retro / Brightness Contrast**

Default setting is Normal.

■ **LDC Lens Distortion Correction : On / Off**

Default setting is off.

Turn on Distortion Correction; it can correct the image distortion.

■ **Date & Time: YYMMDD 00:00:00**

The date and time are automatically updated when you connect your camera to the i-Smart DV app. However, you can manually change these settings, if needed.

Note:

- If the battery is removed from the camera for an extended period of time, the date and time will be reset automatically.

■ **Screen Saver: Off / 1min / 3min / 5min**

Turns off the LCD display after a period of inactivity to save battery life. To turn on the LCD display again, press any button on the camera.

■ **Upside Down: On/Off**

This setting determines the orientation of setting menu.

■ **Power Off: Off / 1min / 3min / 5min**

Powers off your camera after a period of inactivity to save battery life.

■ **Wi-Fi: On/Off**

Default setting is off.

■ **RF Remote: On/Off**

Default setting is off.

■ **Driving Mode: Off/On**

If you turn on car mode and connect camera with car charger, the camera will turn on automatically and start recording if you start your car's engine. And the camera will turn off and stop recording if you turn off the car's engine.

Note:

- Must use 5V 1A output car charger.
- Using as a dash cam, we suggest to turn on the Loop Video, Driving Mode and Screen Saver at same time.

■ **Reset Wi-Fi : Yes / No**

This option can erase the camera's WiFi data .

■ **Language:**

Sets the language that appears on the camera.

■ **Format: Yes/No**

■ To keep your micro SD card in good condition, reformat it on a regular basis. Reformatting erases all of your content, so be sure to offload your photos and videos first. To reformat your card, press the mode button to enter system setting, then press down button several times to enter Format > Format Card? > YES.

■ **Reset: Yes/No**

This option resets all settings to their default values.

■ **Version : Model / Version / Number / Dated**

You can check the model, software version and updated time of your camera.

NOTE:

- Software version is the main information of firmware upgrade, troubleshooting and after-sales. If necessary, please provide the software version information to our after-sales team so that we can serve you in time.

■ **Memory Card: Capacity / Free Space**

Card Info option let you check the capacity and free space of your micro SD card.

■ **Recommended Micro SD:**

The card in the list meets the required card speed for 4K video recording, it is highly recommended to use it first.

Note:

If the camera's battery is removed, all settings will be restored to the factory default settings.

VIDEO MODE

VIDEO

To record video, verify the camera is in desired Video Setting option and set the desired video resolution, if the Video icon in your camera's LCD is not showing, press the Mode Button repeatedly to the Video Setting menu and select the desired option, such as Loop Video/Time-lapse Video/Slow Motion/Fast Motion etc.

- **To Start Recording:**

To press the Shutter Button. The camera's blue Working Indicator will flash and a Red Dot will show on the screen while recording.

- **To Stop Recording:**

To press the Shutter Button. The camera Working Indicator stop flashing and the Red Dot disappear on the screen to indicate recording has stopped

Notes

- FAT32 format Micro SD card stops recording when the storage of each file is over 4 GB and starts to record again on a new file
- This camera automatically stops recording when the battery is out of power. Your video will saved before the camera powers off. The video will not be saved, and even the video will be damaged, if the batter is took out or loss power during recording.
- Due to the battery's characteristics and environmental temperature requirements, such as high temperatures can cause the battery to expand. In high temperature environments, especially in the summer, when you use this camera as a dash camera, we strongly recommend that you remove the battery and use the car power directly, but when the car's engine is turned off, the camera will immediately turn off, the date time set and last video recorded will not be saved
- This camera automatically stops recording when the SD card is full, if the looping record function is turn off.

PHOTO MODE

PHOTO

To capture photo, verify the camera is in desired Photo Setting option and set the desired photo resolution, if the photo icon in your camera's LCD is not showing, press the Mode Button repeatedly to the Photo Setting menu and select the desired option such as Time-lapse Photo/Burst Photo/Self Timer/Long Exposure etc.

- **To capture a photo:**

In the Photo mode, Press the Shutter Button. The camera will emit the camera shutter sound.

- **To capture Time-Lapse Photo series**

Verify the camera is selected desired Time Lapse Photo mode, Press the Shutter Button, The camera will trigger continuous shooting at the set interval and TL duration, and the camera will emit shutter sound each time a photo is taken.

To stop Time Lapse Photo, Press the Shutter Button again.

- **To capture a Burst Photo series:**

Verify the camera is selected desired Burst Photo option; Press the Shutter Button, the camera will emit shutter sound each time a photo is taken.

- **To capture a Self-Timer Photo:**

Verify the camera is selected desired Self Timer option, Press the Shutter Button, the camera initiates countdown and emit shutter sound each time a photo is taken.

- **To capture a Long Exposure Photo:**

Verify the camera is selected desired Long Exposure option, Press the Shutter Button, the camera initiates BEEP and emit a shutter sound as soon as the photo is taken.

1. Verify the camera is in the Photo mode, press and hold the screen for 3 seconds to wake up “Lock AE”, the camera emits an indicate sound and the screen will display the selection icon.
2. Touch the target area on the screen, the selection icon will move to the target area and the LCD display immediately shows you the effect.
3. Press the shutter button to take photo
4. Repeat the above steps if you want to capture more photos with touch AE

NOTE:

Time Lapse Photo, Burst Photo, Self-Timer and Long Exposure cannot be selected at the same time, if you select any one of them, the other three will automatically close. **NG THE ZOOM LEVEL**

ADJUSTING THE ZOOM LEVEL

The Zoom function lets you adjust how close or far away the subject appears in your photo. The default is no zoom. Zoom function is available in Photo Mode.

1. Turn on your camera.
2. Enter Photo Mode.
3. Press and hold Up/Down button or touch the ZOOM IN/OUT Icon on the screen for touch screen version) to adjust the zoom level.

PLAYBACK

■ PLAYING BACK ON CAMERA

1. Enter Video or Photo playback mode. If the SD card contains a lot of content, it might take a minute for it to load.
2. Press the Up / Down Button to scroll through the video or photo files.
3. Press Shutter Button to open video or photo in full-screen view.
4. To return to the file list, press Mode Button.
5. To exit the Playback mode, press Mode Button again.

■ PLAYING BACK ON TV

1. Turn on the TV
2. Connect the Mini HDMI end to the port on camera and HDMI end to HDMI port on the TV

3. Select the right input source on the TV
4. Turn on the camera after a while, you can preview the camera from TV
5. Setting your camera into the video/photo playback mode
6. Select the desired content to playback

Note:

- If the camera is connected TV with HDMI cable, the camera do not support to take videos or photo, only for Playback.
- HDMI cable is not included in the standard package, you will need buy an extra HDMI cable.

■ PLAYING BACK ON COMPUTER

To play back your video and photos on a computer, you must first transfer these files to a computer. Transferring also frees up space on your micro SD card for new content. To offload files to a computer using a card reader (sold separately) and your computer's file explorer, connect the card reader to the computer, then insert the micro SD card. You can then transfer files to your computer or delete selected files on your card. Note that you must use a card reader to offload photos or audio files. With this method, playback resolution depends on the resolution of the device and its ability to play back that resolution.

NOTE:

- 4K requires a high data transmission stream. If you playback 4K video file through a card reader, you may not be able to obtain sound playback. In order to get better playback results, it is strongly recommended to copy the 4K video directly to the computer to playback.
- This camera might not be compatible with the files from different solution camera or other device.
- The quick time player is a good compatibility with MOV format video files. We strongly recommend using the Quick Time Player to play back video files on your computer.

■ DELETE FILE ON CAMERA

1. Verify the camera is in Video or Photo Playback menu, If your micro SD card contains a lot of content, it might take a minute for it to load.
2. Press the Up or Down Button to locate the file you want to delete.
3. Press and hold the Up Button for seconds. The screen shows "Delete File".
4. Press the Up or Down Button to locate the desired option: "Single File "or "All Files", then Press Shutter Button to select the desired option.
5. Press the Up or Down Button to locate the desired option: "Yes / No".
6. If you select "Yes", then Press Shutter Button to deleted the file you want.
If you select "No", then Press Shutter Button to back the playback mode.

BATTERY

The camera contains sensitive components, including the battery.

■BATTERY STORAGE AND HANDLING

- Do not store in temperature above 140°F/60°C.

- Avoid exposing your camera to very cold or very hot temperatures. Low or high temperature conditions may temporarily shorten the battery life or cause the camera to temporarily stop working properly. Avoid dramatic changes in temperature or humidity when using the camera, as condensation may form on or within the camera.
- Do not dry the camera or battery with an external heat source such as a microwave oven or hair dryer.
- Damage to the camera or battery caused by contact with liquid inside the camera is not covered under the warranty.
- Do not store your battery with metal objects, such as coins, keys or necklaces. If the battery terminals come in contact with metal objects, this may cause a fire.
- Do not make any unauthorized alterations to the camera. Doing so may compromise safety, regulatory compliance, performance, and may void the warranty.
- Please do not throw the camera or its battery to the garbage, find a specific recycling point for it.

WARNING:

- Do not drop, disassemble, open, crush, bend, deform, puncture, shred, microwave, incinerate or paint the camera or battery.
- Do not insert foreign objects into the battery opening on the camera.
- Do not use the camera or the battery if it has been damaged – for example, if cracked, punctured or harmed by water.

Disassembling or puncturing the battery can cause an explosion or fire.

■ CHARGING THE BATTERY

1. Connect the camera to USB power supply (5V/1A commended).
2. The charging status light remains ON while the battery is charging.
3. The charging status light will turn OFF when the battery is fully charged.

Notes:

- Charging time: 4-hours for 5V 1A power supply
- Please make sure the camera is shuttled down while charging.
- Remove the battery before using as a dash camera and use 5V/1A brand-name car charger.

■ MAXIMIZING BATTERY LIFE

If the battery reaches 0% while recording, the camera saves the file and powers off.

To maximize battery life, follow these guidelines when possible:

- Turn off Wireless Connections
- Capture video at lower frame rates and resolutions
- Use Screen Saver setting.

Wi-Fi APP

The Wi-Fi App lets you control your camera remotely using a smart phone or tablet. Features include full camera

colive preview, playback and sharing of selected content and more.

CONNECT TO THE iSmart DV2 APP

1. Download iSmart DV2 app to your mobile device from the Apple App Store or Google Play;
2. Turn on the camera, then press Up Button for seconds to turn on Wi-Fi;
3. Turn on Wi-Fi Setting of your mobile device, connect to the Wi-Fi SSID “iSmart DV2”;
4. Enter the password: “1234567890”;
5. Open the app “iSmart DV2” on your smart phone or tablet.
6. Tap “Add new camera”;
7. Tap “Wi-Fi Connect”;

Note: Press Up Button for seconds again if you want to turn off Wi-Fi.

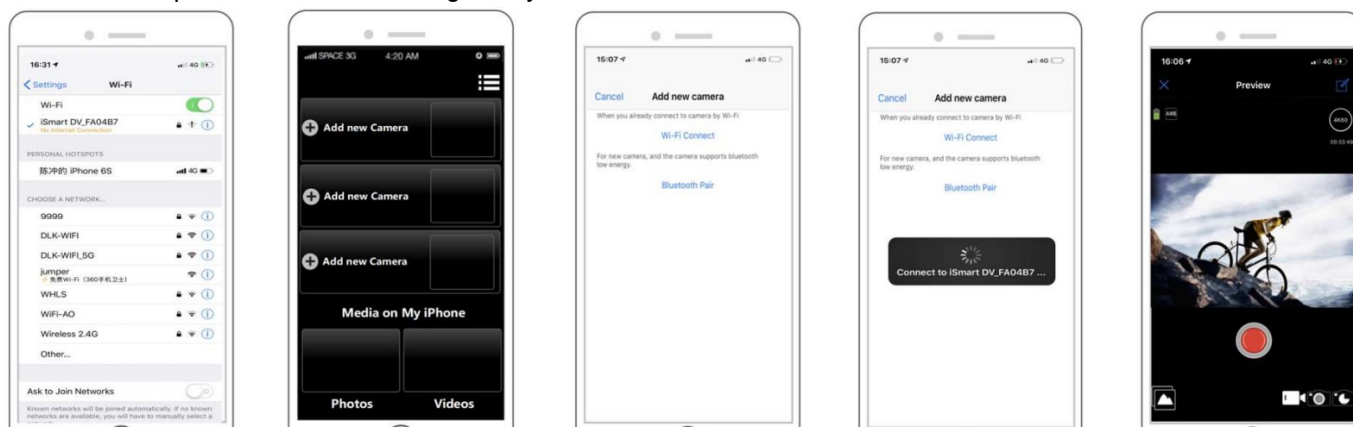

DOWNLOADING AND SHARE YOUR CONTENT

1. Open the “iSmart DV2” app.
2. Tap “Albums icon” at the left corner of the bottom screen.
3. Select files in “Photos” or “Videos” at the top of the screen.
4. Tap “Download icon” at the right corner of the bottom screen to download
5. Save or Share your content.

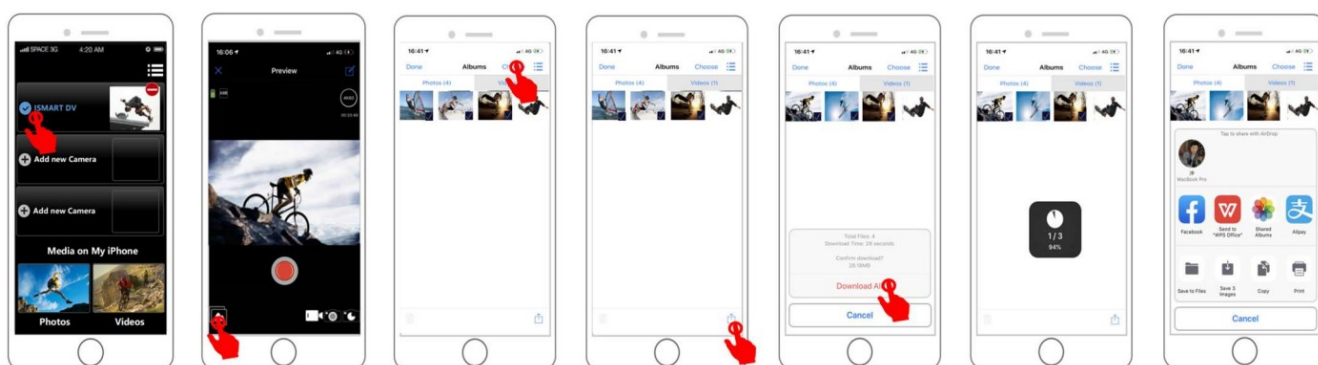

The iSmart DV App is compatible with smart phone and tablet listed below:

For Apple IOS

- iPhone6(plus),6s(plus),7 (above IOS12)
- iPhone Air & Mini (above IOS12)

App available on:

 <p>For Andriod Device</p>	
https://play.google.com/store/apps/details?id=com.icatchtek.app.ismartdv2	https://apps.apple.com

- The camera Wi-Fi is a point to point signal source, which supports only one telephone connection at one time and does not support two or more phones. If two phones turn on Wi-Fi at the same time, one phone is successfully connected to the camera's Wi-Fi, and the other will no longer connect to the camera, or even interfere with the transmission of the signal.
- The camera Wi-Fi bandwidth is relatively narrow, and its signal will be affected by distance, other signals,

For Android

*Android 4x Quad-Core devices (above Android 7.0) electromagnetic waves, obstacles and other factors. 2 to 5 seconds signal delay is normal. Wi-Fi distance is about 5~10 meters.

- When the phone and camera connect through Wi-Fi, the power of the camera will increase. The camera's temperature will rise rapidly, and the consumption of camera batteries will also increase. This is a normal phenomenon.
- Since many kinds of phones in the market, and the phone system is constantly updated, iSmart DV2 app needs time to synchronize timely updates, if iSmart DV2 app cannot be compatible to your phone, please tell us your phone's model and system version information, we will in the first time synchronize your phone.
- If you find your phone can not connect the camera's WIFI, please confirm that your connection is correct, if yes, and still cannot connect. Please delete the Wi-Fi SSID of the camera in your phone Wi-Fi setting and reconnect. If necessary, you can also delete the iSmart DV2 app from your phone and re-download and re-install it.

WATERPROOF CASE

Specially designed for diving, surfing, snorkeling and other water sports activities. The waterproof case does not only offer greater waterproof protection to your camera, it also offers extra protection against dust, scratches and shocks. Light and easy to carry, excellent PMMA material endows it with high quality. With the use of the waterproof case, you can record activities even 30M under water and it won't damage the shooting effect, clear and vivid. Your movement and photographic effect won't be affected by anti-surf pressure. Convenient to link camera with other accessories mount through this waterproof case.

NOTES:

- In order to capture a clear video or photo, please tear off the lens protection film of the waterproof shell before use, and protect well the lens window from scratch after use.
- Before sealing the waterproof case, keep the camera housing's White Silicone Seal Ring clean, a single hair or grain of sand cause a leak. You can test by closing the case without inserting the camera. Submerge the case

completely in the water for about a minute. Remove the case from the water, dry off its exterior with a towel, and then open the case. If the interior is dry, the case is safe for use under water.

■ Before sealing the waterproof case, make sure the waterproof case is sealed well before use. If the white silicone sealing ring is found to be hardened, deformed or damaged, please stop using this water tank and replace the new waterproof shell in time

■ Please dry it in time after use, otherwise the waterproof shell metal button will dust and reduce the waterproof performance. After use in in seawater or seaside, you will need to rinse the outside of the housing with fresh water and then dry. This will prevent corrosion of the hinge pin and salt buildup in the seal, which can cause failure. Do not flush the interior with water

■ When use the camera with the waterproof in low temperature, such as winter, Rainy Day, Underwater and so on, please do the anti-fogging treatment so as to avoid the blurred video. It is recommended to add anti-fog film; insert the anti-fog film into the waterproof case to prevent the lens from fogging in low temperature or humid environment;

■ Keep it safe from falling and dropping and high temperature above 80°C.

■ Waterproof shell is vulnerable product, we strongly recommend, according to the usage of the environment and frequency, to replace the waterproof shell in time.

EXTERNAL MIC

This camera can be compatible with the external Wired Omani-directional Mono Microphone 2.5mm.

Insert the external MIC to DC2.5 MIC port, the camera will automatically switch to record the sound from the external MIC. This will help to reduce the noise and get better video sound. Please use the picture's microphone Specifications:



1. Positive pole
2. Negative pole
3. GND

Specifitions

Plugging:	2.5mm
SNR:	>60dB
Wire Length:	approx. 1M/3.28 ft
Communication:	Wired
Operation temperature range(C):	-10~ +55

Mounting Your Camera

Attach your camera to helmets, gear and equipment.
The following assembly methods are for reference only!

Notes:

- Our standard accessories are the basic version. If you need different types of accessories, you need to purchase them separately.
- With different types of accessories, the camera can be used in different occasions. Please purchase different types of accessories kit according to actual needs.
- Our cameras can be partially compatible with accessories from other brands such as Go-pro. We recommend purchasing the corresponding accessories separately from Amazon.



For any query please contact:

IMS Mercantiles Pvt. Ltd.

#704, Ring Road Mall, Outer Ring Road, Near Deepali Chowk,
Sector-3, Rohini, Delhi-110085 Toll Free: 1800-123-544-444

Email: support@digitek.net.in Website: www.digitek.net.in

Documents / Resources

	<p>Digitek DAC-001 Action Camera [pdf] Instruction Manual DAC-001 Action Camera, DAC-001, Action Camera, Camera</p>
---	---

References

- [Digitek - India's Leading Camera & Mobile Accessories Online Store](#)
- [User Manual](#)