



## digitech GE4106 Shoebox Cassette Player and Recorder Instruction Manual

[Home](#) » [Digitech](#) » digitech GE4106 Shoebox Cassette Player and Recorder Instruction Manual 

**digitech GE4106 Shoebox Cassette Player and Recorder**



## Contents

- 1 **PRODUCT DESCRIPTION**
  - 1.1 **FRONT VIEW**
  - 1.2 **LEFT SIDE VIEW**
- 2 **POWER & BATTERY INSTALLATION**
  - 2.1 **BATTERY INSTALLATION**
- 3 **INSERTING TAPE**
- 4 **OPERATION**
  - 4.1 **USB OPERATION**
  - 4.2 **RECORDING OPERATIONS**
- 5 **IMPORTANT SAFETY GUIDELINES**
- 6 **CLEANING AND MAINTENANCE**
- 7 **WARNING ON BATTERIES**
- 8 **CUSTOMER SUPPORT**
- 9 **Documents / Resources**
  - 9.1 **References**
- 10 **Related Posts**

## PRODUCT DESCRIPTION

### FRONT VIEW

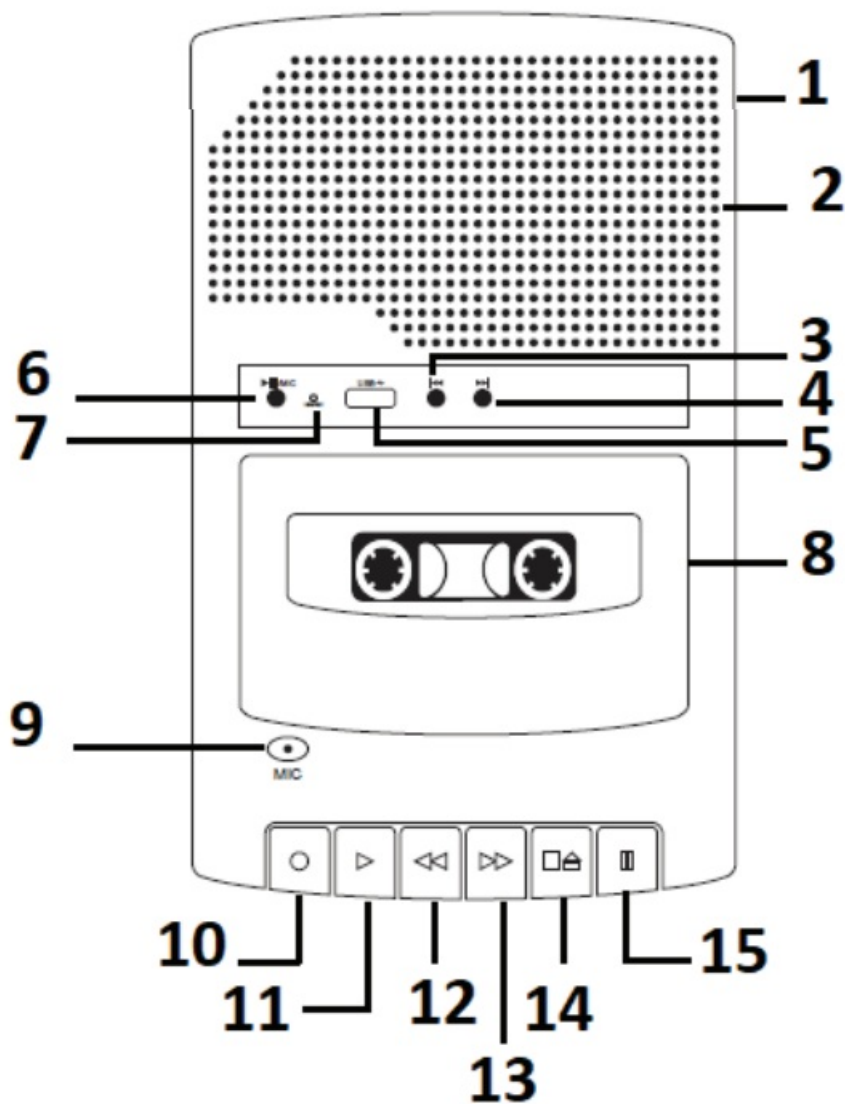

#### LEFT SIDE VIEW

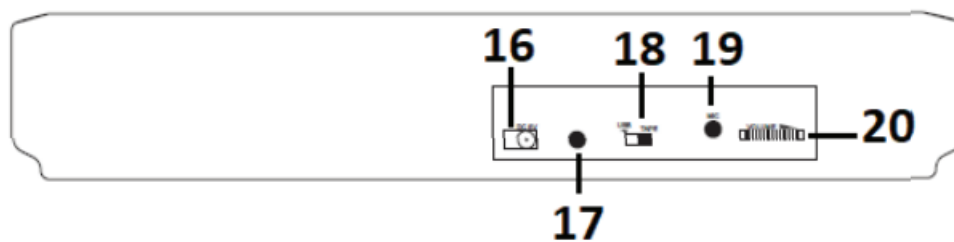

1. Battery compartment (at the back)
2. Speaker
3. Rewind
4. Fast forward
5. USB slot
6. Play/ pause/ REC
7. USB/ REC indicator
8. Cassette compartment
9. Built-in microphone
10. Recording key when pressed with Play key simultaneously

11. Play
12. Rewind
13. Fast forward
14. Stop
15. Pause
16. 5VDC USB-C Power Socket
17. Headphone/earphone jack
18. USB/ TAPE selector
19. Microphone port
20. Volume control knob

## POWER & BATTERY INSTALLATION

The cassette player/ recorder can be operated by 2 means of power as per your choice:

1. 5VDC USB Type-C Power Cable

**Note:** When using the USB Type-C power cable while the batteries are installed, will automatically stop using battery power.

Power: 5VDC, 1A

2. 4 x 1.5V C batteries (not included)

### BATTERY INSTALLATION

First install the batteries at the bottom.

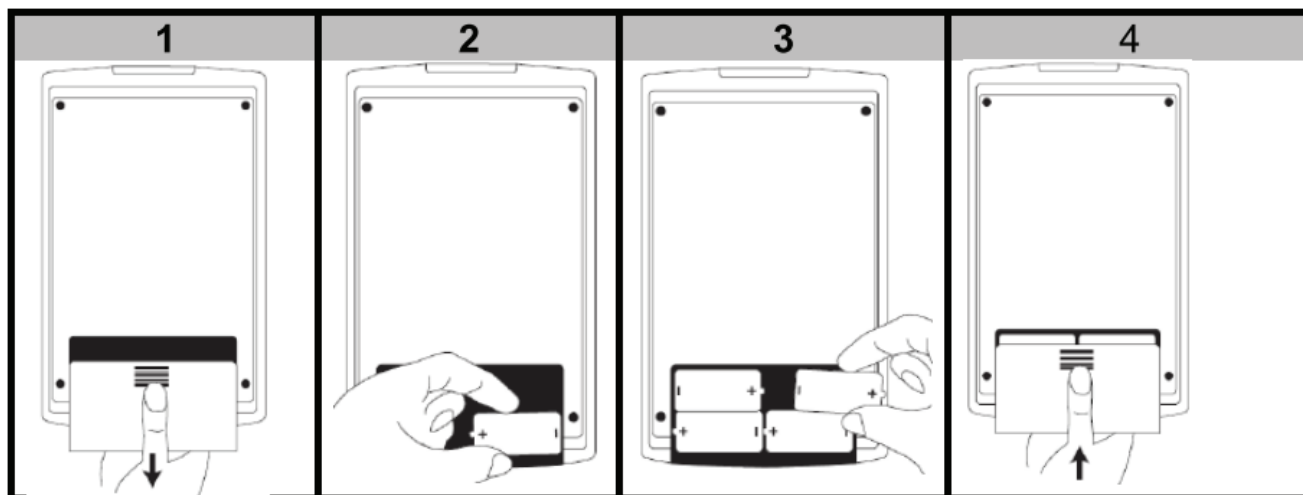

## INSERTING TAPE

Press  key.

**Note :** If a button is already The open edge of cassette tape should face towards you. depressed, press

 twice.

The open edge of cassette tape should face towards you.

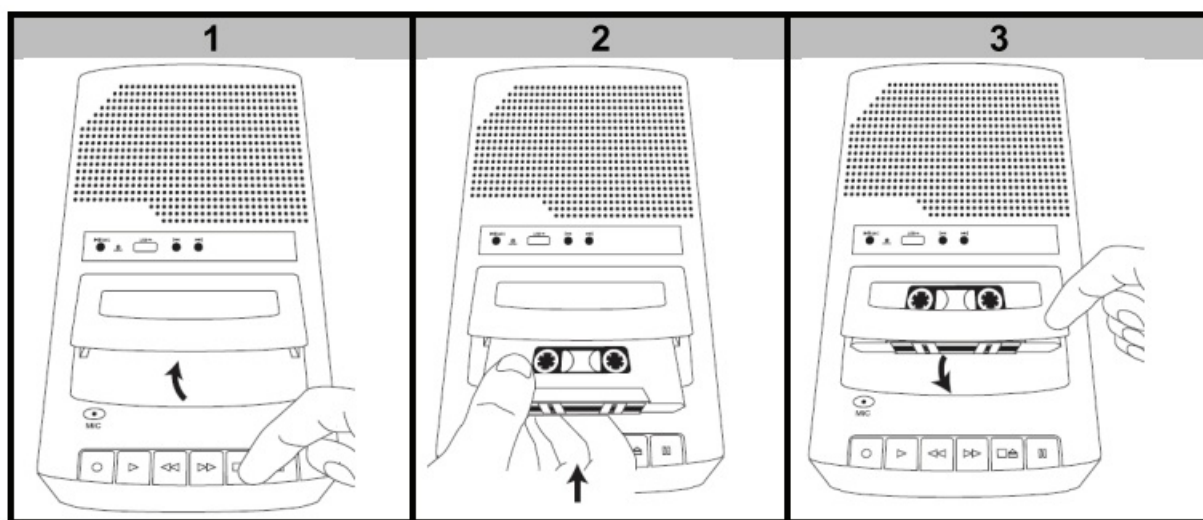

## OPERATION

### A. KEY DESCRIPTION





PLAYBACK	REWIND	FAST FORWARD	STOP	PAUSE	RECORDING

### B. CASSETTE PLAYBACK

1. Place “USB/TAPE” selector (18) to TAPE position.

2. Press  key (11) to start playback.

3. Use volume knob to adjust volume output (20).

4. Press  to rewind (12) or  to fast forward (13) while cassette is playing. Press stop key  (14) after you have reached the desired point on the tape. Then press  (11) to resume playback.

5. Press  (15) to pause. Press again to resume.

6. Press  (14) to stop playback. Press  again to eject.



#### Notes:

Make sure that there is no slack in the tapes of your cassettes otherwise it can cause scratches on the tapes, or worse, they could break. If you notice some slack in the tape, use a pencil to tighten it up before you insert it. See figure in the opposite.



### C. TAPE RECORDING FROM BUILT-IN MICROPHONE

1. Place "USB tape" selector (18) to Tape position.
2. Insert a cassette.

3. Press and hold  (10) and  (11) keys simultaneously.

**NOTE:** If these buttons do not depress, see the notes in part "Tape erasure".

4. Start recording your message: Talk in to the in-built microphone port.

5. Press  (14) to stop recording.

### D. RECORDING WITH EXTERNAL MICROPHONE (not included)

Plug the microphone into the PHONE jack and follow the steps 1, 2, 3, 4 and 5 as indicated in Tape recording from built-in microphone.

**Notes:** When the external microphone is used, the built-in microphone is automatically disconnected.

### E. CASSETTE ERASING

To erase a tape, simply re-record over the unwanted recording.

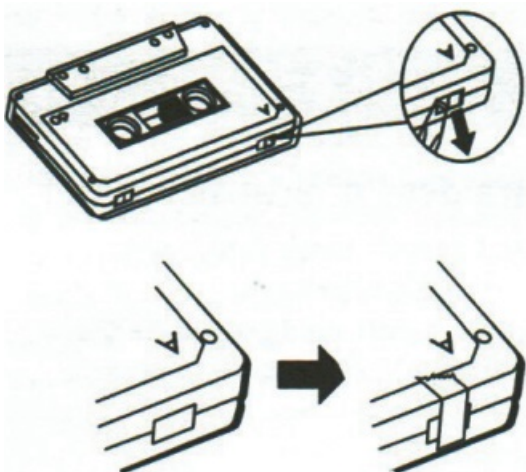

**Notes:** To prevent accidental erasure over a recording you want to keep permanently, snap out the rear left tab of the side: A or B you want to save (See illustration in opposite). Then, recording will be impossible; the RECORD key could not be depressed. If you want to re-record, put a cellophane tape where the tab is missing.







### USB OPERATION

## A. KEY DESCRIPTION

### USB

	PLAYBACK/ PA USE/ RECORD		REWIND		FAST FORWARD
---	-----------------------------	---	--------	---	--------------

## B. USB PLAYBACK OF AUDIO FILES *Compatible audio files : MP3 & WAV only.*

1. Insert USB device into USB slot.
2. Place “USB tape” selector to USB position. If audio files or messages have been already recorded, the red indicator “USB/ REC” is on, blinking, 3/4 seconds later and music/ sounds or messages playback starts.
3. Short press  (3) or  (4) to playback previous or next file.
4. Long press  (3) or  (4) to rewind or fast forward.
5. Press (6) to pause/ stop playback. The red LED indicator is still.

-  (6) Press (6) again to resume playback.

-  (6) Press (6) to pause/ stop playback.

## RECORDING OPERATIONS

### USB Recording from built-in MIC

1. Insert USB device into USB slot.
2. Place “USB/ TAPE” selector to USB position. Wait until the USB / REC indicator is on and playback starts.  
Press USB / REC to stop playback.

-  (6) Press and hold (6) till the red indicator blinks rapidly. Then release the button and start recording your message/ sounds from the built-in MIC.

-  (6) Press (6) to stop.





5. Press and hold 9 (6) to listen to what you've just recorded from USB device.

-  (6) Press (6) to stop.

### Recording from Tape to USB

1. Place the “USB/T APE” selector to TAPE position.
2. Press [g (11) to start playback from the tape.
3. Insert USB device to USB slot.

-  (6) Press and hold (6) to record from the tape. The red USB/ REC is on, blinking rapidly. Release the key.

5. Press  (6) to stop recording.
6. Press  to stop the play.
7. Place the “USB/TAPE” selector to USB position. Wait for the playback to start. Press  (3) to check that it is the recording that you’ve just done or press again until you hear your recording.
8. Press  (6) again to stop.

## IMPORTANT SAFETY GUIDELINES

1. Before connecting the appliance to the mains, make sure the voltage of your appliance indicated on the rating plate corresponds to the local voltage.
2. Do not move or unplug the appliance by pulling on the cord.
3. In order to disconnect the device power supply, pull on the plug, NOT the cable.
4. Only use the appliance on a stable surface.
5. Do not place the device close or on top of other stereo equipment that radiate too much heat.
6. Protect this device from water and all other liquids; no object containing water, such as a vase, should be placed on this device.
7. Do not insert any objects into the device openings as they could come into contact with live electrical components or cause a short circuit and there would be a risk of electrocution or fire.
8. Do not subject it to strong impacts and do not throw it.
9. Do not drop, short-circuit, modify, disassemble or puncture it.
10. Unplug the device from the wall and hire a qualified professional to carry out the repair in the following cases:
  - a. If the power cord or plug becomes damaged.
  - b. If any liquid or objects fall into the device.
  - c. If the device has been exposed to the rain or has come into contact with water.
  - d. If the device is not functioning properly.
  - e. If the device has fallen or suffered any damage and no longer functions as before.
11. If a part needs to be replaced, ensure that the technician uses the replacement part specified by the manufacturer or a part with the same characteristics as the original part. The replacement of any parts with unauthorized parts can result in fire, electrocution or other dangers.
12. All repairs should be done by a qualified technician.
13. Keep it away from heat sources, direct sunlight, humidity, water or other liquids.
14. Do not operate it under high temperature.



### **WARNING**

To reduce risk of fire or electrocution, do not expose this device to rain or humidity.

### **CAUTION**

#### **DANGER OF ELECTROCUTION – DO NOT OPEN!**

To reduce the risk of electrocution, do not remove the elements from housing. Internal parts must not be manipulated by the user. Refer to qualified, professional assistance in the event of needing to carry out repairs.



The symbol representing a lightning bolt with an arrow head inside an equilateral triangle is a warning light for “dangerous voltage” that could lead to electrocution.



The exclamation mark inside the equilateral triangle indicates important operating or maintenance (repair) instructions in the documentation accompanying the device.

## **CLEANING AND MAINTENANCE**

- DO NOT immerse in water.
- Do not use abrasives or cleansers.
- Unplug the device from the wall outlet before cleaning.
- Wipe clean external housing using a dry cloth only.

### **Tape care**

Cassette tapes can be erased by magnetic fields produced by magnets. Keep tapes away from magnets and magnetic fields.

## **WARNING ON BATTERIES**

- If the the device will not be used for an extended period of time, remove the batteries from it.
- If the sound becomes dim or the tape reels turn very slowly or not at all, please replace with new batteries.
- Never mix alkaline, standard (carbon-zinc) and rechargeable (nickel hydride).
- Don't mix new and used batteries.
- Don't attempt to recharge non-rechargeable batteries.
- Remove rechargeable batteries from the device (if possible) before charging them.
- Rechargeable batteries must always be recharged under adult supervision.
- Remove used batteries.
- Never short the power supply terminals.
- Always use the recommended or equivalent battery types.
- Always pay attention to battery polarity.

**Output Power:** 1 x 0.5WRMS (2W Power)

**Output:** 1 x 3.5mm Aux

**Audio Sources:** Cassette, USB

**Bit Rate:** 128kbps  
**USB Capacity:** Up to 128GB  
**Playback Time:** 5-10 Hours  
**Batteries:** 4 x C (Not Included)  
**Power:** 5VDC, 1A (USB-C)  
**Dimensions:** 258(L) x 144(W) x 48(H)mm

## CUSTOMER SUPPORT

Distributed by:  
Electus Distribution Pty Ltd  
46 Eastern Creek Dr,  
Eastern Creek NSW 2766 Australia  
**Ph** 1300 738 555  
**Int'l** +61 2 8832 3200  
**Fax** 1300 738 500

[www.electusdistribution.com.au](http://www.electusdistribution.com.au)



## Documents / Resources

 <p>digitech Shoobox Cassette Player &amp; Recorder GE4106 Instruction Manual</p>	<p><a href="#">digitech GE4106 Shoobox Cassette Player and Recorder</a> [pdf] Instruction Manual GE4106 Shoobox Cassette Player and Recorder, GE4106, Shoobox Cassette Player and Recorder, Cassette Player and Recorder, Player and Recorder, Recorder</p>
--	---

## References

- [E Electus Distribution - Home](#)