



DIGITALas F22 Biometriline Terminal Instructions

[Home](#) » [DIGITALas](#) » DIGITALas F22 Biometriline Terminal Instructions

DIGITALas

F22 Biometriline Terminal Instructions



Contents [[hide](#)

[1 F22 Biomeetriline](#)

[Terminal](#)

[2 Features](#)

[3 Specifications](#)

[4 Documents / Resources](#)

[5 Related Posts](#)

F22 Biomeetriline Terminal

Ultra thin fingerprint time attendance and access control terminal

F22 is an ultra-thin fingerprint time attendance and access control terminal with BioID sensor and Wi-Fi, which offers unparalleled performance with advanced algorithm for reliability, precision and excellent matching speed. F22 features the fastest commercial-based fingerprint matching algorithm and ZK high-performance, high-image quality infrared detection fingerprint sensor.

F22 provides a superior touching experience with touch keypad, and offers flexibility for standalone installation or with any third-party access control panel that supports standard wiegand signal. TCP/IP, RS485 and Wi-Fi are also available that the device can be used in different networks.

Features

- 2.4-inch TFT color screen and Touch keys
- Ultra thin and elegant design
- Full Access Control Features:
- Anti-passback, access control interface for 3rd party electric lock, door sensor, exit button, alarm
- Standard Wi-Fi
- Network interface by TCP/IP or RS485
- Built-in auxiliary input with enhanced flexibility to link with wired detector or emergency switch
- Multiple Verification Modes: Multi- verification methods (card is optional) providing user various choices

Specifications

Display	2.4-inch TFT LCD Color Screen
Fingerprint Capacity	3000
Card Capacity	5000 (Optional) ID or Mifare card
Transaction Capacity	30,000
Sensor	BioID Sensor/ SilkID Sensor (optional)
Algorithm Version	ZKFinger VX10.0

Communication	RS232/485, TCP/IP, USB-host,Wi-Fi
Access Control Interface	3rd Party Electric Lock, Door Sensor, Exit Button, Alarm
Wiegand Signal	Input, Output
Aux. Input	1ea for linkage function
Functions	DST, Automatic Status Switch, Record query, T9 input, 14 digit user ID, Anti-passback, Scheduled-Bell, Printer(Optional) , ADMS (Optional)
Power Supply	12V DC,3A
Operating Temperature	0 °C- 45 °C
Operating Humidity	20%-80%
Dimension (LxWxH)	158.5×78.0x19.4mm
SDK and software	Standalone SDK, ZKAccess 3.5 software

Optional Accessories



RS485 Fingerprint Reader



RFID Reader



Exit Button



Electric Lock



Alarm



Sensor

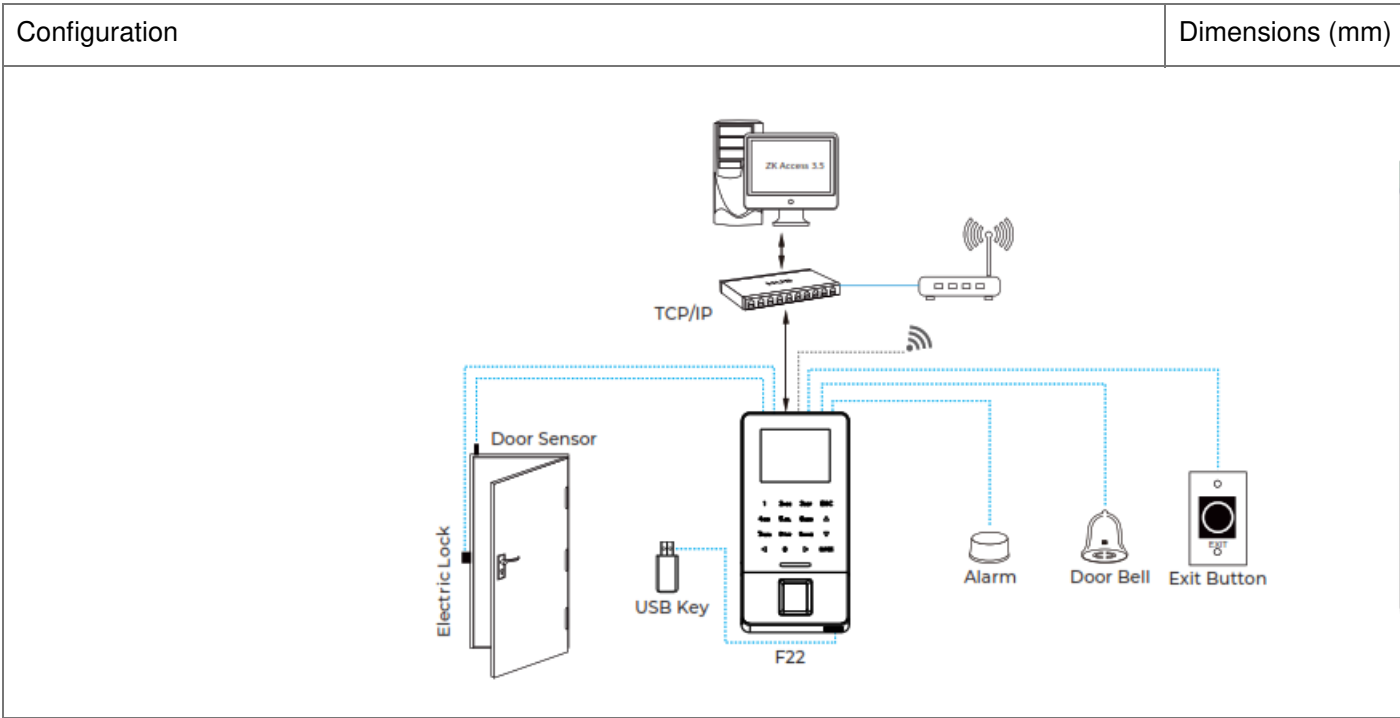

DIGITALas

Documents / Resources

<p>F22 Ultra thin fingerprint time attendance and access control terminal</p> <p>F22 is an ultra thin fingerprint time attendance and access control terminal with 8000mAh battery and 4.3" color LCD screen. It features a high-speed fingerprint sensor with advanced algorithm for stability, precision and speed. It supports multiple authentication methods: fingerprint, password, ID card, and remote control. It also has a built-in speaker and a display for user information.</p> <p>Features:</p> <ul style="list-style-type: none">Ultra thin design (12mm thickness)8000mAh battery4.3" color LCD screenHigh-speed fingerprint sensorSupports multiple authentication methodsBuilt-in speakerDisplay for user information <p>DIGITALas</p>	<p>DIGITALas F22 Biomeetrline Terminal [pdf] Instructions</p> <p>F22 Biomeetrline Terminal, F22, Biomeetrline Terminal, Terminal</p>
---	--