



## **DIGITAL WATCHDOG DWC-P220CMW Ceiling Mounting Bracket User Guide**

[Home](#) » [DIGITAL WATCHDOG](#) » **DIGITAL WATCHDOG DWC-P220CMW Ceiling Mounting Bracket User Guide**



*Complete Surveillance Solutions*

**Quick Start Guide**

**Ceiling mounting bracket for white analog PTZ cameras  
DWC-P220CMW**



#### Contents [ [hide](#) ]

##### [1 WHAT'S IN THE BOX](#)

##### [2 INSTALLING THE MOUNTING ACCESSORY](#)

##### [3 CABLING THE CAMERA](#)

##### [4 Documents / Resources](#)

##### [4.1 References](#)

##### [5 Related Posts](#)

## WHAT'S IN THE BOX

1x Teflon tape	1x Teflon tape
4x O-ring	4x O-ring
1x hex Allen wrench (2.5)	1x hex Allen wrench (2.5)
3x plastic anchors (6pi)	3x plastic anchors (6pi)
3x tapping screws, PH (6×35)	3x tapping screws, PH (6×35)

**NOTE:** Download all your support materials and tools in one place.

1. Go to: <http://www.digital-watchdog.com/resources>
2. Search your product by entering the part number in the 'Search by Product' search bar. Results for applicable part numbers will populate automatically based on the part number you enter.

3. Click 'Search'. All supporting materials, including manuals and quick start guide (QSGs) will appear in the results.

Tel: +1 (866) 446-3595 / (813) 888-9555

[digital-watchdog.com](http://digital-watchdog.com)

Technical Support Hours: 9:00 AM – 8:00 PM EST, Monday through Friday

## INSTALLING THE MOUNTING ACCESSORY

- A. Attach the mount base ( 1 ) and plate ( 2 ) to the mounting surface using the supplied M6 tapping screws ( 3 ) and plastic bushings ( 4 ).
- B. Wind Teflon tape around both threaded ends of the pipe (about 20 times) for sealing. If necessary, use a silicone rubber sealant to seal the area where the mount base and the pipe meet.
- C. Fit the pipe (of which threads are covered by Teflon tape) into the mount base ( 1 ) and turn until it is securely fastened.
- D. Pull all the required cables through the mount base ( 1 ) and pipe ( 5 ).
- E. Align the dome adaptor ( 6 ) with the pipe and turn until it is securely fastened.
- F. Fasten the mount base ( 1 ), dome adaptor ( 6 ) using the set screw.
- G. Fasten the vandal-proof dome housing to the dome adaptor ( 6 ) using an M6 x 12 machine screw.

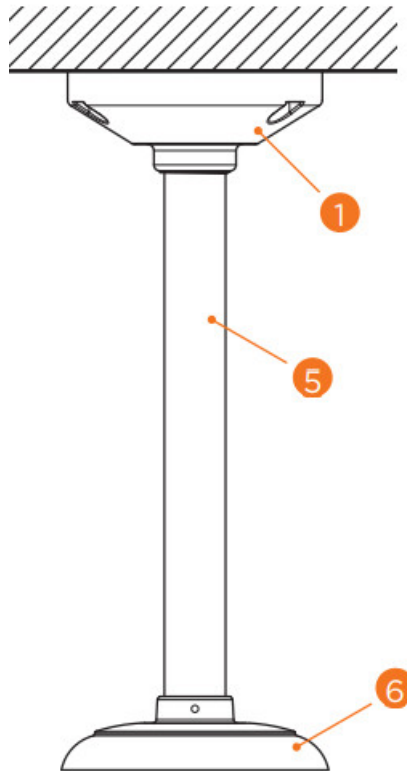

## MOUNTING THE CAMERA TO THE MOUNTING ACCESSORY USING A JUNCTION BOX OR MOUNTING PLATE

Installation with a junction box

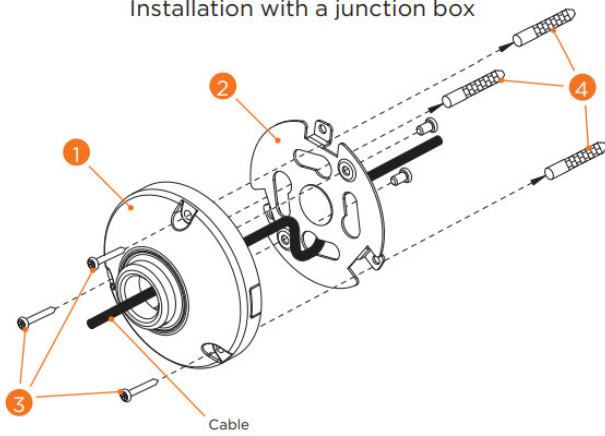

Installation without a junction box

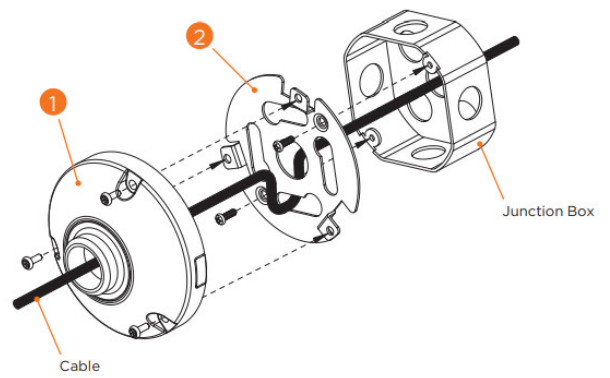

## CABLING THE CAMERA

### 1. Cable passing through the wall

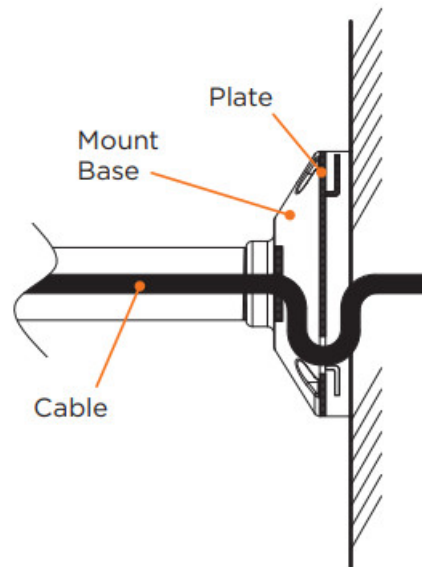

### 2. Cable on the wall (Remove the conduit knockout for cable passing through)

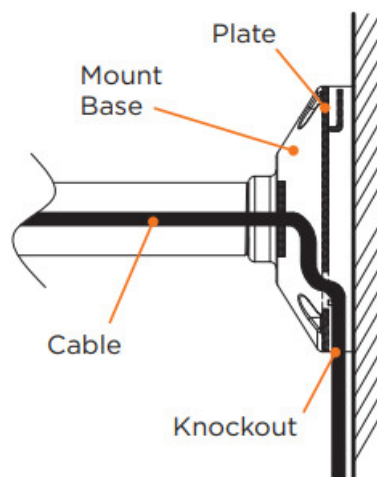

### 3. Cable passing through the wall with the junction box (Attention to the plate side)

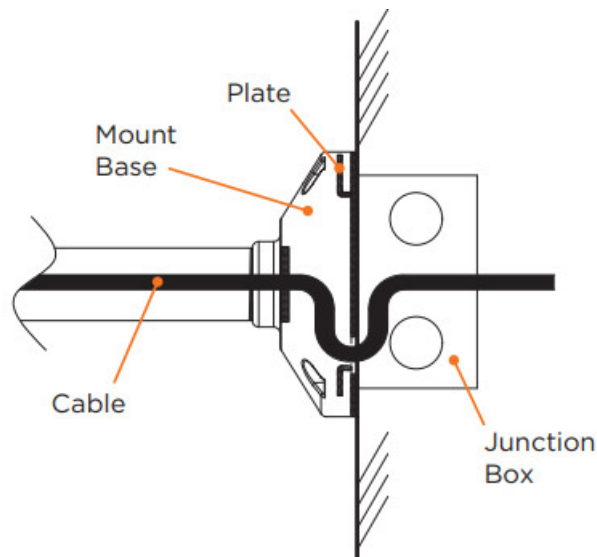

## Dimensions Inches (mm)

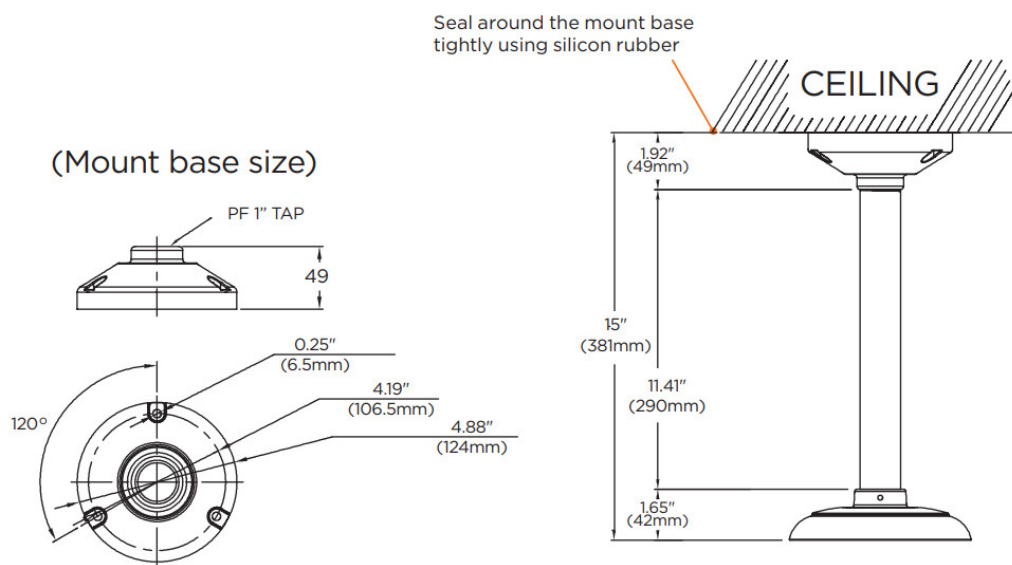

Copyright © Digital Watchdog. All rights reserved.  
Specifications and pricing are subject to change without notice.

## Documents / Resources

	<p><a href="#">DIGITAL WATCHDOG DWC-P220CMW Ceiling Mounting Bracket [pdf] User Guide</a> DWC-P220CMW, Ceiling mounting bracket For White Analog PTZ Cameras, White Analog PTZ Cameras</p>
-------------------------------------------------------------------------------------	------------------------------------------------------------------------------------------------------------------------------------------------------------------------------------------------

## References

- [DW Digital Watchdog I Welcome](#)
- [DW Resources](#)

