



DIGITAL WATCHDOG DWC-MB62DiVT Outdoor Bullet IP Camera User Guide

[Home](#) » [DIGITAL WATCHDOG](#) » DIGITAL WATCHDOG DWC-MB62DiVT Outdoor Bullet IP Camera User Guide 



Complete Surveillance Solutions

**WATCHDOG DWC-MB62DiVT Outdoor Bullet IP Camera
User Guide**



Default Login Information: admin | admin

When logging into the camera for the first time, you will be prompted to set up a new password. You can set the new password using the DW® IP Finder™ software or directly from the camera's browser menu.

Contents

1 WHAT'S IN THE BOX

2 STEP 1 – PREPARING TO MOUNT THE CAMERA

3 STEP 2 – POWERING THE CAMERA

4 STEP 3 – INSTALLING THE CAMERA

5 STEP 4 – DW® IP FINDER™

6 STEP 5 – WEB VIEWER

7 Documents / Resources

7.1 References

8 Related Posts

WHAT'S IN THE BOX

Star Wrench (T-20)		1	Quick Setup and Installation Guide		1 set
Screws and Plastic Anchors-4pcs		1 set	Moisture Absorber and Absorber Guide		1 set
Mounting Template		1	Sun-shield cover and Adjusting Screws		1 set
Waterproof Cap and Rubber Rings(Black: ø0.15" (ø4mm), White: ø0.19" (ø5mm))		1 set			

NOTE: Download all your support materials and tools in one place

1. Go to: <http://www.digital-watchdog.com/resources>
2. Search your product by entering the part number in the 'Search by Product' search bar. Results for applicable part numbers will populate automatically based on the part number you enter.
3. Click '**Search**'. All supporting materials, including manuals and quick start guides (QSGs), will appear in the results.



http://bit.ly/resources_qr

Attention: This document is intended to serve as a quick reference for the initial setup. It is recommended that the user read the entire instruction manual for complete and proper installation and usage.

STEP 1 – PREPARING TO MOUNT THE CAMERA

1. The mounting surface must withstand five times the camera weight.
2. Do not let the cables get caught in improper places or the electric line cover can be damaged. This may cause a short fire.
3. **CAUTION:** These servicing instructions are for use by qualified service personnel only. To reduce the risk of electric shock do not perform any servicing other than that contained in the operating instructions unless you are qualified to do so.
4. This product is intended to be supplied by a UL Listed Power Supply Unit marked “Class 2” or “LPS” or “PS2” and rated 12 Vdc, 0.43A min.
5. The wired LAN hub providing power over the Ethernet (PoE) in accordance with IEEE 802-3af shall be a UL Listed device with the output evaluated as a Limited Power Source as defined in UL60950-1 or PS2 as defined in UL62368-1.
6. Unit is intended for installation in a Network Environment 0 as defined in IEC TR 62102. As such, associated Ethernet wiring shall be limited to inside the building.
7. Install the moisture packet in the base of the camera's lens.
 - a. Remove the moisture absorber from the packaging.
 - b. Cut the card and folder along the dotted line.
 - c. Place the moisture absorber behind the camera's lens module.See the drawing for more information.
8. Using the mounting template sheet or the camera itself, mark and drill the necessary holes in the wall or ceiling.

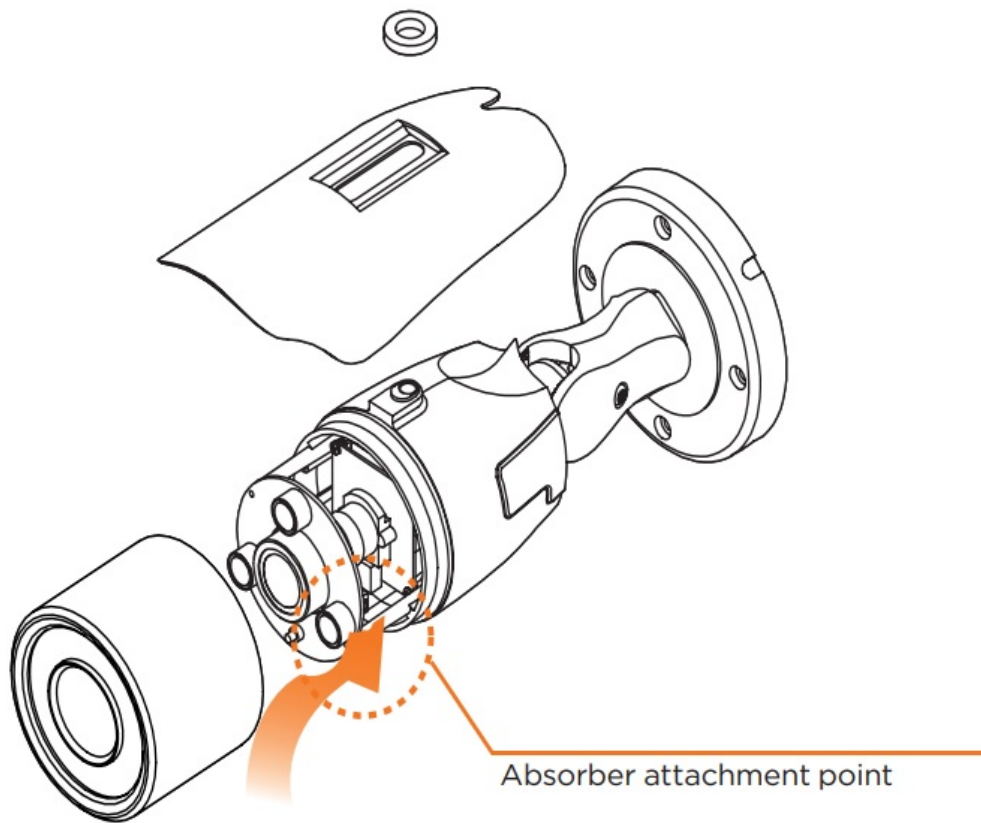

STEP 2 – POWERING THE CAMERA

Pass the wires through the mount bracket and make all necessary connections.

1. If you are using a PoE Switch, connect the camera using an Ethernet cable for both data and power.
2. If you are using a non-PoE switch, connect the camera to the switch using an Ethernet cable for data transmission and use a power adapter to power the camera.

Power requirements	Power consumption
DC 12V, PoE (IEEE 802.3af Class 3). (Adapter not included)	DC12V: max 5.2W PoE: max 7.0W

STEP 3 – INSTALLING THE CAMERA

1. The waterproof cap set comes with two rubber rings with different diameters. The black rubber ring has an internal diameter of $\varnothing 0.15''$ ($\varnothing 4\text{mm}$). The white rubber ring has an internal diameter of $\varnothing 0.19''$ ($\varnothing 5\text{mm}$). When using the waterproof cap, use the rubber ring best suited for your network cable's diameter.
 - a. Pass the LAN cable through the waterproof cap, gasket, and rubber **a** ring.
 - b. Connect the LAN cable to the camera's network port **b**.
 - c. **c** will be affixed to **b** with a $\frac{1}{4}$ turn counter-clockwise.
 - d. Thread and twist **b** tightly to **c**.

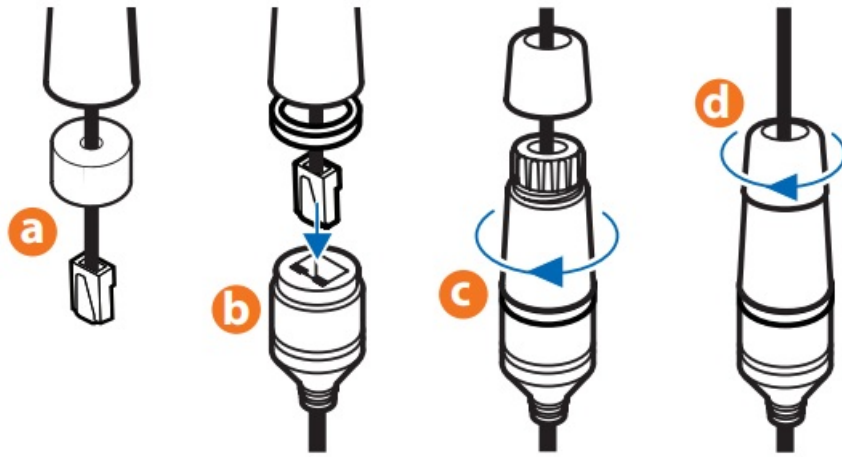

NOTE: To ensure moisture seal, make sure the o-ring is in place between **a** and **b**. In extreme environments use of an outdoor-rated sealer is recommended.

NOTE: Cables with $\varnothing 4.5\text{mm}$ to $\varnothing 5.5\text{mm}$ thickness should use the black rubber ring. Cables over $\varnothing 5.5\text{mm}$ in thickness should use the white rubber ring.

2. Mount the camera to the mounting surface and secure using the screws and wall anchors included with the camera.

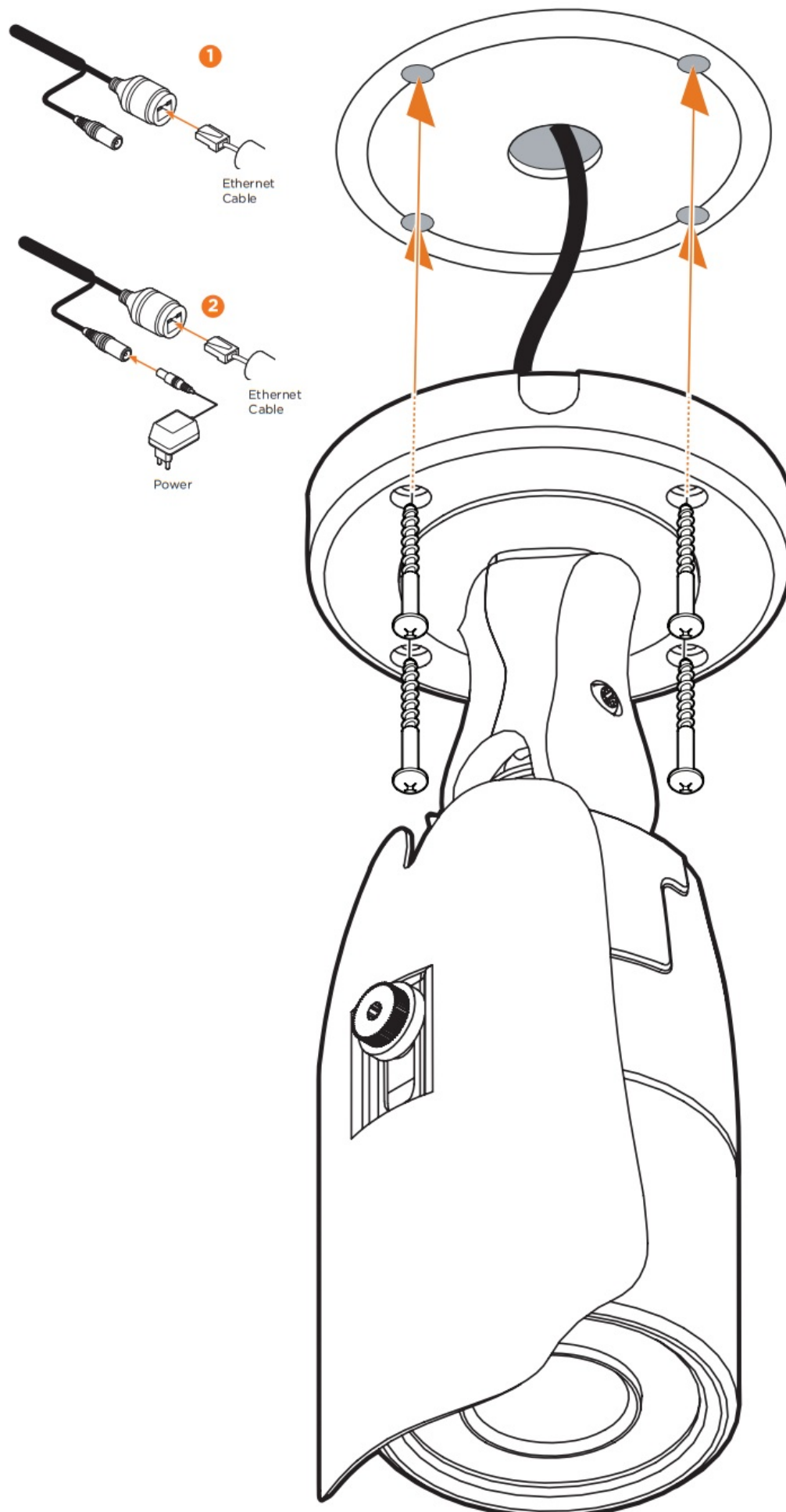

3. Adjust the camera's pan, tilt and position to achieve the desired view. The cameras' max angles are:

Pan: $0^{\circ} \sim 360^{\circ}$

Tilt: $0^{\circ} \sim 90^{\circ}$

Rotation: 0° ~ 360°

4. To adjust the camera's focus and zoom:

- Remove the sun-shield and front case from the camera by rotating it counterclockwise.
- Unlock the zoom or focus screws by rotating them counter-clockwise.
- Adjust the zoom and focus screws at the base of the camera module to achieve a clear image.
- Tighten the screws and close the front case by rotating it clockwise.

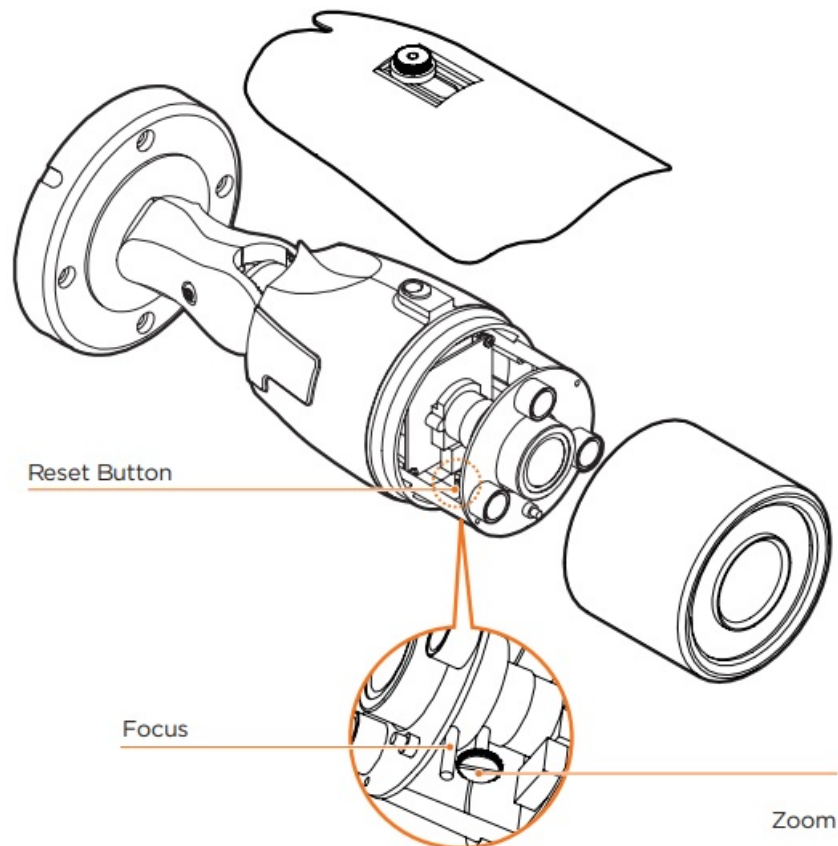

Resetting the camera: To reset the camera, use the tip of a paper clip or a pencil and press the reset button. Pressing the button for five (5) seconds will initiate a camera-wide reset of all the settings, including network settings.

STEP 4 – DW® IP FINDER™

Use the DW IP Finder software to scan the network and detect all MEGApix® cameras, set the camera's network settings or access the camera's web client.

Thumbnail view

Select network to scan: Local Area Connection (192.168.0.100)

Filter results: All

Scan network

Show/hide thumbnail view: ☐ Thumbnail

Refresh thumbnail view: ☐ Refresh Thumbnail

Bulk IP assignment: ☐ Bulk IP Assignment

Bulk password assignment: ☐ Bulk Password Assignment

Firmware upgrade: ☐ Firmware Upgrade

Selected camera's username and password: Username: Password:

Name	IP Address	Model	MAC Address	Netmask	Gateway	Port	DHCP	Version	Ping Test	IP Conf.	Uptime
DWC-MPTZ30K	192.168.130.29	DWC-MPTZ30K	00:07:0B:19:10:1A	255.255.255.0	192.168.130.1	80	Disabled	1.9.94-X2_release	Ping	Click	28day 14hrs 17mins
DWC-MV440WA	192.168.130.41	DWC-MV440WA	00:0D:F1:21:53:8F	255.255.255.0	192.168.130.1	80	Disabled	A2.01.02_20180619	Ping	Click	35day 15hrs 54mins
DWC-P221M99T	192.168.130.41	DWC-P221M99T	00:0D:F1:21:29:21	255.255.255.0	192.168.130.1	80	Disabled	A5.01.03_20180403	Ping	Click	56day 16hrs 46mins
DWC-PVX160V4	192.168.130.41	DWC-PVX160V4	00:0D:F1:21:5C:AD	255.255.255.0	192.168.130.1	80	Disabled	S2.01.03_20180309	Ping	Click	28day 14hrs 0mins
DWC-PF9M1TR	192.168.130.61	DWC-PF9M1TR	00:0A:61:1A:00:14	255.255.255.0	192.168.130.1	80	Disabled	-	Ping	Click	28day 14hrs 0mins
DWC-PV9M2TR	192.168.130.62	DWC-PV9M2TR	00:0A:61:1A:26:E7	255.255.255.0	192.168.130.1	80	Disabled	-	Ping	Click	28day 14hrs 0mins
DWC-MF40M	192.168.130.63	DWC-MF40M	00:0D:F1:20:F8:60	255.255.255.0	192.168.130.1	80	Disabled	A2.01.02_20180619	Ping	Click	28day 14hrs 0mins

Firmware version

Camera's uptime

Open IP configuration settings

Ping camera

Camera's network information

Camera's name, IP and MAC addresses

Network Setup

1. To install the DW IP Finder, go to: <http://www.digital-watchdog.com>
2. Enter "DW IP Finder" on the search box at the top of the page.
3. Go to the "Software" tab on the DW IP Finder page to download the installation file.
4. Follow the installation to install the DW IP Finder. Open the DW IP Finder and click 'Scan Devices'. It will scan the selected network for all supported devices and list the results in the table. During the scan, the DW® logo will turn gray.
5. When connecting to the camera for the first time, a password must be set. To set up a password for your camera:
 - a. Check the box next to the camera in the IP Finder's search results.
You can select multiple cameras.
 - b. Click "Bulk Password Assign" on the left.
 - c. Enter admin/admin for the current username and password. Enter a new username and password to the right.
Passwords must have a minimum of 8 characters with at least 4 combinations of uppercase letters, lowercase letters, numbers, and special characters. Passwords cannot contain the user ID.
 - d. Click "change" to apply all changes.
6. Select a camera from the list by double-clicking on the camera's image or clicking on the 'Click' button under the IP Conf. column. The pop-up window will show the camera's current network settings, allowing admin users to adjust the settings as needed.

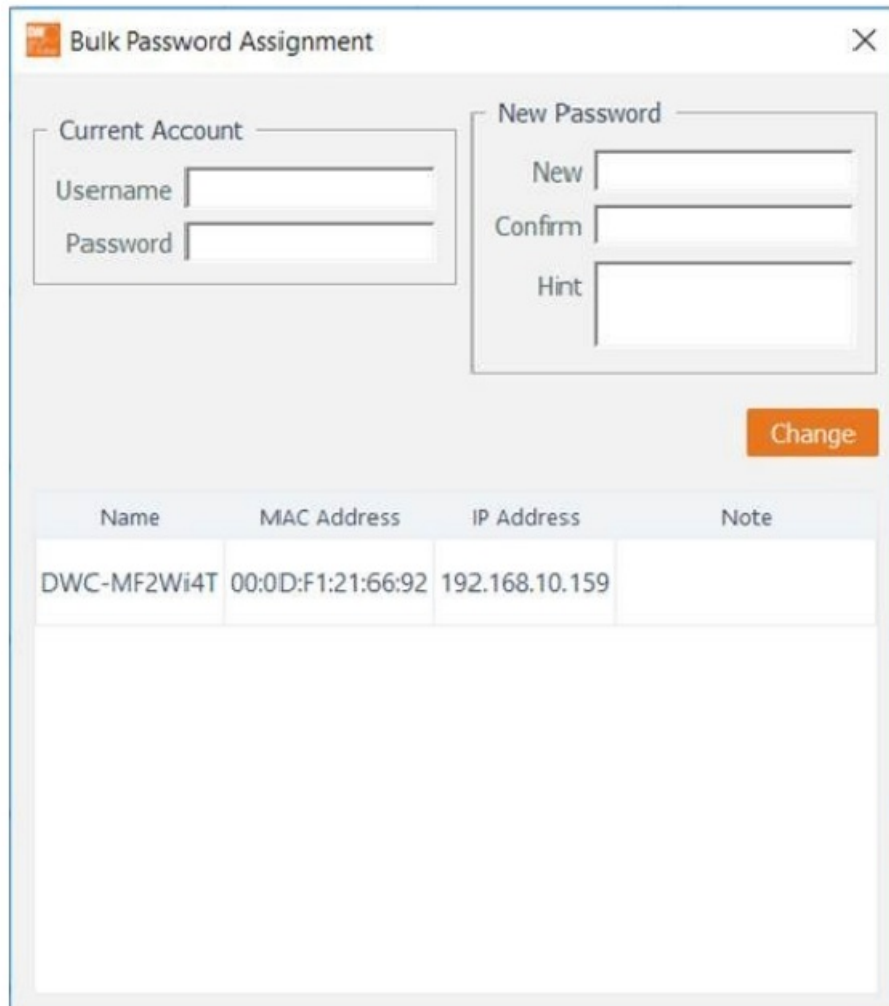

The image shows a "Bulk Password Assignment" window. It has a title bar with a close button (X). The window is divided into two main sections. The left section is titled "Current Account" and contains two input fields: "Username" and "Password". The right section is titled "New Password" and contains three input fields: "New", "Confirm", and "Hint". Below these sections is an orange "Change" button. At the bottom of the window is a table with four columns: "Name", "MAC Address", "IP Address", and "Note". The table contains one row of data: "DWC-MF2Wi4T", "00:0D:F1:21:66:92", "192.168.10.159", and an empty "Note" cell.

Name	MAC Address	IP Address	Note
DWC-MF2Wi4T	00:0D:F1:21:66:92	192.168.10.159	

7. To access the camera's web page, click on the 'View Camera Website' from the IP Config window.
8. To save changes made to the camera's setting, enter the username and password of the camera's admin account and click 'Apply'.



Select DHCP to allow the camera to receive its IP address automatically from the DHCP server.



Select "Static" to manually enter the camera's IP address, (Sub)Netmask, Gateway, and DNS information.



The camera's IP must be set to static if connecting to Spectrum® IPVMS.

Contact your network administrator for more information.



Default TCP/IP information: DHCP.



Port forwarding must be set in your network's router to access the camera from an external network.

DW Camera Settings

?

×

Camera Name

DWC-MD421TIR

MAC Address

00:0D:F1:20:A4:9E

IP Configuration Mode

☒ DHCP

☐ Static IP

IP Address

192.168.1 .101

Netmask

255.255.255.0

Gateway

192.168.1 .1

DNS

192.168.40 .1

Ports

Web Port

80

Control Port

0

Video Port

0

Audiio Transmit

0

Audio Receive

0

Username

admin

Password

•••••

Restore default camera configuration

View Camera Website

Apply

Reboot

Cancel

STEP 5 – WEB VIEWER

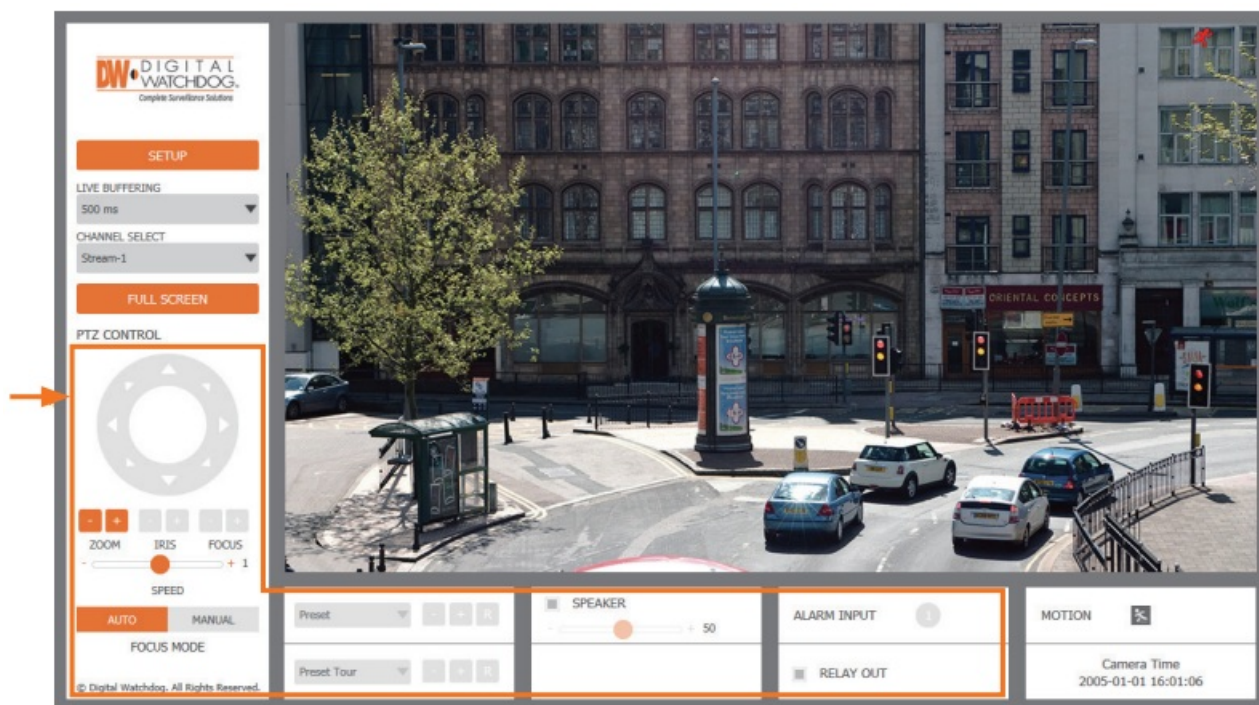

The GUI display may differ by camera model.

Once the camera's network settings have been set up properly, you can access the camera's web viewer using the DW IP Finder.

To open the camera's web viewer:

1. Find the camera using the DW IP Finder.
2. Double-click on the camera's view in the results table.
3. Press the 'View Camera Website'. The camera's web viewer will open up in your default web browser.
4. Enter the camera's username and password you set up in the DW IP Finder. If you did not set up a new username and password via the DW IP Finder, you will not be able to view the video from the camera.

A message will direct you to set up a new password for the camera to view video.

5. When accessing the camera for the first time, install the VLC player for web files to view video from the camera.

NOTE: 32bit version of the VLC player must be installed. If you are using a 64bit system, uninstall the previous 64bit version and reinstall using the 32bit version.

NOTE: Some menu options may not be available based on the camera model. See the full manual for more

information.



Complete Surveillance Solutions

digital-watchdog.com

Tel: +1 (866) 446-3595/(813) 888-9555

Technical Support Hours: 9:00 AM – 8:00 PM EST,
Monday through Friday



Documents / Resources

	DIGITAL WATCHDOG DWC-MB62DiVT Outdoor Bullet IP Camera [pdf] User Guide DWC-MB62DiVT Outdoor Bullet IP Camera, DWC-MB62DiVT, Outdoor Bullet IP Camera, Bullet IP Camera, IP Camera, Camera
---	---

References

- [DW Digital Watchdog I Welcome](#)
- [DW Digital Watchdog I Welcome](#)
- [DW Resources](#)

Manuals+.