



# Digifast CMD 77 Commander Wireless Controller User Manual

[Home](#) » [Digifast](#) » Digifast CMD 77 Commander Wireless Controller User Manual 



**DIGIFAST**

WIRELESS CONTROLLER  
USER MANUAL  
MODEL CMD 77

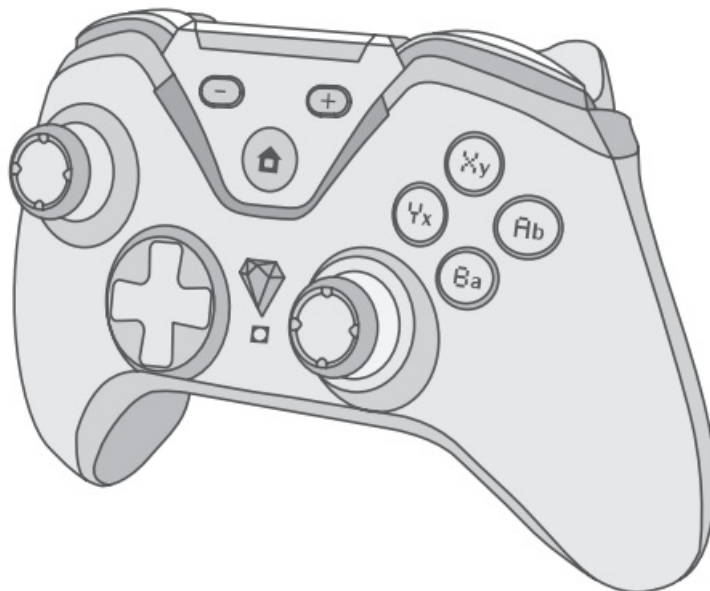

## Contents

- [1 Product Structure](#)
- [2 Guide for Operation and Connection](#)
- [3 Product Functions](#)
- [4 Documents / Resources](#)
- [5 Related Posts](#)

## Product Structure



1. LT Button
2. LB Button
3. Home Button
4. Left Stick
5. D-pad
6. Screenshot Button
7. -/back
8. Detachable Bracket
9. +/start
10. RT Button
11. RB Button
12. Action Button
13. Right Stick
14. Replaceable U-shape D-pad

## Guide for Operation and Connection

### Switch Mode



### Screen Printing of Action Button

#### 1. Connecting Methods

- 1.1 Enter the homepage of a switch. Select “Controller” first, and then select “Change Grip/Order”.

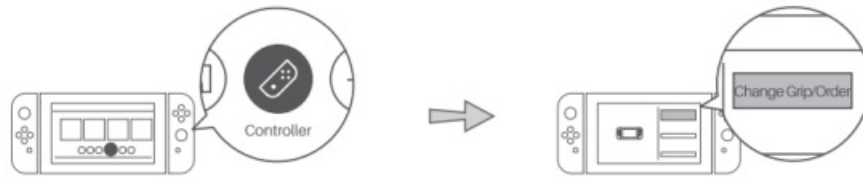

1.2 Long press the Home button of the gaming controller for 3-5s and the LED light will flash quickly with red color. Release the button after the gaming controller vibrates, and it's in a Bluetooth pairing state then.



1.3 The LED light will stay on with red color for 10s later, and a gaming controller icon will appear on the switch screen after that, which indicates that the gaming controller is connected to the switch successfully.

## 2. Reconnection Mode

The gaming controller will be disconnected once the switch enters hibernation.

2.1 Firstly, wake up the switch by pressing the Home button on itself.

2.2 Secondly, short press the Home button of the gaming controller for 1-2s, and the LED light will flash slowly. The gaming controller will vibrate about 10s later, which indicates that it's reconnected successfully, and you can use the product after that.

**Note: The Home button of the gaming controller can't be used to wake up the switch from hibernation. The switch needs to be activated by the Home button on its own.**

## Android Mode

Screen Printing of Buttons (Correspond to the lowercase letters of buttons)

### 1. Connecting Methods

1.1 Turn on the Bluetooth on the phone.

1.2 Long press "A"+"Home" buttons and the LED light will flash quickly with green color, and it's in a Bluetooth pairing state then.

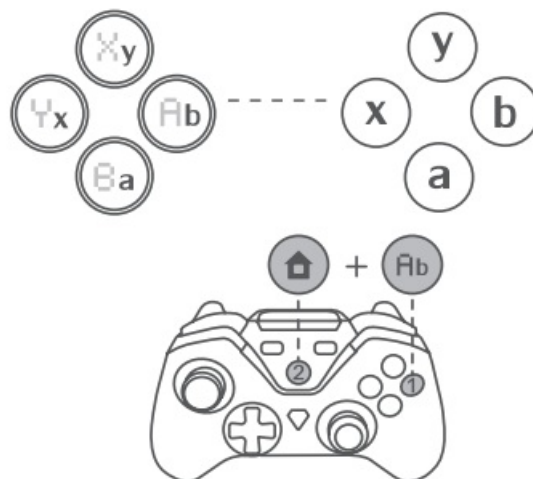

1.3 Search "PC249 Controller" in the Bluetooth of your phone and connect it. The gaming controller will be

connected successfully in 3-5s, and you can use it after that.

## PC Mode

Screen Printing of Buttons (Correspond to the lowercase letters of buttons)



1. Connecting Methods Connect the gaming controller to the computer with a Type-C cable, and its drive will be recognized automatically within 10s. It indicates the successful connection if the LED light stays on with blue color.

## Product Functions

### 1. Detachable Bracket

It can integrate your phone with the gaming controller and make them a perfect gaming unit when it's assembled on the gaming controller, and it can also be used as an independent phone holder when it's disassembled from the gaming controller.

### 2. Replaceable U-shape D-pad

When playing FTG, you can replace the D-pad with the exclusive U-shape D-pad to play fatal strikes.

### 3. Cool Button Light

The light around the buttons looks cool and can illuminate the gaming controller at night, which can help you avoid pressing the wrong buttons in the dark. Simultaneously press “-/ and /B” to turn it off.

### 4. Super Long Standby Time

With a 1300mAh rechargeable lithium battery, it features extra-long standby time and doesn't need to be changed frequently.

### 5. Support Xinput and DirectInput in the PC Mode

In the PC mode, the default is Xinput (LED light stays on with blue color), and it can be switched into DirectInput (LED light stays on with red color) if you press “-” and “+” simultaneously.

## Federal Communications Commission Notice

This device complies with part 15 of the FCC Rules. Operation is subject to the following two conditions: (1) This device may not cause harmful interference, and (2) this device must accept any interference received, including interference that may cause undesired operation.

Any changes or modifications not expressly approved by the party responsible for compliance could void the user's authority to operate the equipment.

Note: This equipment has been tested and found to comply with the limits for a Class B digital device, pursuant to part 15 of the FCC Rules. These limits are designed to provide reasonable protection against harmful interference in a residential installation. This equipment generates uses and can radiate radio frequency energy and, if not installed and used in accordance with the instructions, may cause harmful interference to radio communications. However, there is no guarantee that interference will not occur in a particular installation. If this equipment does cause harmful interference to radio or television reception, which can be determined by turning the equipment off and on, the user is encouraged to try to correct the interference by one or more of the following measures:

Reorient or relocate the receiving antenna. ,

Increase the separation between the equipment and receiver. ,

Connect the equipment into an outlet on a circuit different from that to which the receiver is connected.  
, Consult the dealer or an experienced radio/TV technician for help.  
The device has been evaluated to meet general RF exposure requirements. The device can be used in portable exposure conditions without restriction.  
THANKS

**Documents / Resources**

	<p><a href="#">Digifast CMD 77 Commander Wireless Controller</a> [pdf] User Manual CMD77, 2AXX3-CMD77, 2AXX3CMD77, CMD 77, Commander Wireless Controller</p>
---	--