

**di-soric**  
IRSD-25-G3-B4  
Inductive Ring  
Sensor



## di-soric IRSD-25-G3-B4 Inductive Ring Sensor Owner's Manual

[Home](#) » [di-soric](#) » di-soric IRSD-25-G3-B4 Inductive Ring Sensor Owner's Manual 

### Contents

- [1 di-soric IRSD-25-G3-B4 Inductive Ring Sensor](#)
- [2 Product Usage Instructions](#)
- [3 Ring Diameter](#)
- [4 Safety instructions](#)
- [5 Technical data](#)
- [6 Documents / Resources](#)
  - [6.1 References](#)
- [7 Related Posts](#)



### di-soric IRSD-25-G3-B4 Inductive Ring Sensor



### Specifications:

- Product Model: IRSD-25-G3-B4
- Enclosure Type: 4X (indoor use only), 12, 13
- Supply Class: 2 NFPA 79 Applications only

- Service Voltage: 10 – 30 V DC
- Switching Output: Gegentakt/PNP/NPN, 100 mA, NO/NC
- No-load Current: 30 mA
- Speed of Parts (min.): 0.1 m/s
- Speed of Parts (max.): 35 m/s
- Protection Type: IP 67

## **Product Usage Instructions**

### **Installation:**

1. Ensure the product is suitable for indoor use only.
2. Connect the sensor to a power source within the specified voltage range (10 – 30 V DC).
3. Follow the wiring instructions provided in the product manual or seek customer support if adapters are needed.
4. Position the sensor with the internal diameter aligned as required for your application.

### **Operation:**

1. Ensure the sensor is powered and functioning correctly.
2. Monitor the switching output to detect changes in parts speed within the specified range.
3. Observe the protection type (IP 67) to ensure proper operation in the intended environment.

### **Maintenance:**

1. Regularly check the sensor for any physical damage or wear.
2. Clean the sensor as needed to maintain optimal performance.

## **Ring Diameter**

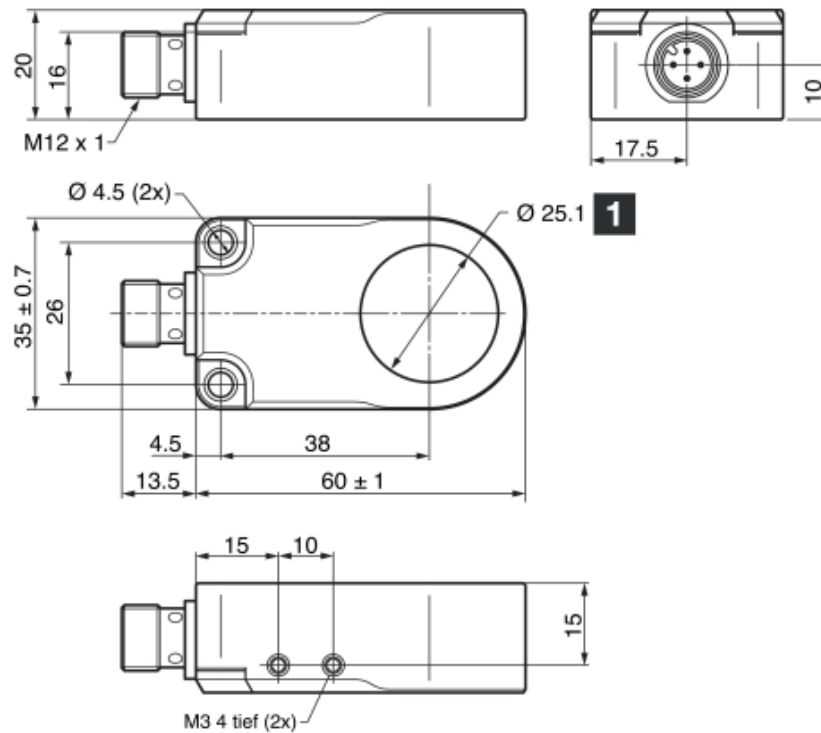

- **BK:** black
- **BN:** brown
- **BU:** blue
- **WH:** white

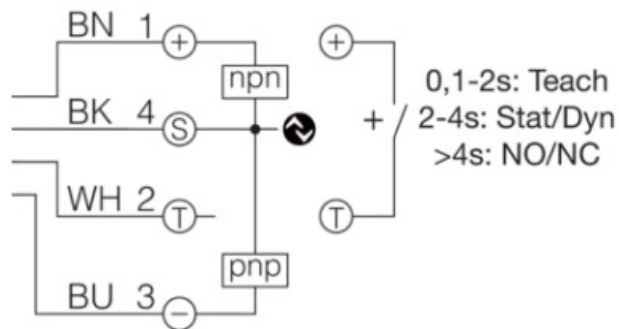

## Safety instructions

### General safety notice

**WARNING!** Not a safety component pursuant to 2006/42/EG and EN 61496-1/-2! May not be used for personal protection! Non-compliance can lead to death or serious injuries! Only use as directed!

### Technical data

- **Technical data** +20°C, 24 V DC
- **Internal diameter** 25,1 mm / 25.1 mm / 25,1 mm
- **Service voltage** 10 ... 30 V DC
- **Switching output** Gegentakt/PNP/NPN, 100 mA, NO/NC / Push-pull/PNP/NPN, 100 mA, NO/NC / Push-pull/PNP/NPN, 100 mA, NO/NC
- **No-load current (max.)** 30 mA

- **Speed of parts (min.)** 0,1 m/s / 0.1 m/s / 0,1 m/s
- **Speed of parts (max.)** 35 m/s
- **Protection type** IP 67
- **Ambient temperature during operation** -25 ... +70 °C

As of 05/17/24, subject to change

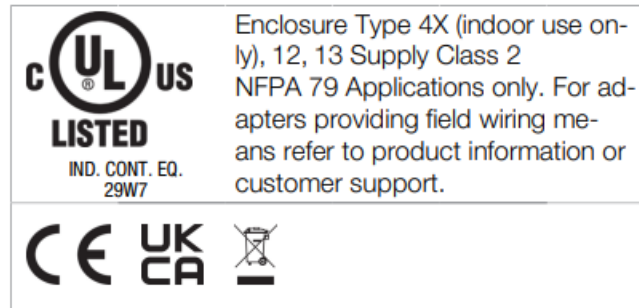

### Frequently Asked Questions (FAQ):

**Q: Can this sensor be used outdoors?**

**A:** No, this sensor is designed for indoor use only.

**Q: What is the maximum speed of parts that this sensor can detect?**

**A:** The sensor can detect parts moving at speeds up to 35 m/s.

**Q: Is this sensor suitable for personal protection applications?**

**A:** No, this sensor is not a safety component for personal protection purposes.

di-soric GmbH & Co. KG  
Steinbeisstraße 6  
DE-73660 Urbach

### Germany

Tel: +49 (0) 7181/9879-0  
[info@di-soric.com](mailto:info@di-soric.com) · [www.di-soric.com](http://www.di-soric.com)



### Documents / Resources

	<p><a href="#">di-soric IRSD-25-G3-B4 Inductive Ring Sensor</a> [pdf] Owner's Manual 213670, IRSD-25-G3-B4 Inductive Ring Sensor, IRSD-25-G3-B4, Inductive Ring Sensor, Ring Sensor, Sensor</p>
--	---

### References

- [!\[\]\(83eb2aa26b610eb6a9dca7cf4702d681\_img.jpg\) \*\*soric.com\*\*](https://www.di-soric.com)
- [!\[\]\(94dfacbf937cdd7da4837a6fcd8fc785\_img.jpg\) \*\*di-soric – Solutions. Clever. Practical.\*\*](#)
- [\*\*User Manual\*\*](#)

[Manuals+](#), [Privacy Policy](#)

This website is an independent publication and is neither affiliated with nor endorsed by any of the trademark owners. The "Bluetooth®" word mark and logos are registered trademarks owned by Bluetooth SIG, Inc. The "Wi-Fi®" word mark and logos are registered trademarks owned by the Wi-Fi Alliance. Any use of these marks on this website does not imply any affiliation with or endorsement.