



DGO RGB Color Changing LED String Light Installation Guide

[Home](#) » [DGO](#) » DGO RGB Color Changing LED String Light Installation Guide 



RGB Color Changing LED String Light Installation Guide

Contents

- [1 Before You Begin](#)
- [2 Important Considerations](#)
- [3 How to install:](#)
- [4 Easy to Connections:](#)
- [5 Specification:](#)
- [6 INSTALLATION](#)
- [7 FCC Warning](#)
- [8 Troubleshooting:](#)
- [9 Documents / Resources](#)
- [10 Related Posts](#)

Before You Begin

We know how boring it can be to read instructions, so we' LI keep this installation guide as short and sweet as possible. Before you begin with your installation, be sure to fully read these instructions. They contain many useful tips and pointers that will help to ensure a perfect installation, save you time, and ensure your safety. It is important that you install this product (and all other electrical products) in accordance with the National Electric Code (NEC) and all applicable local building and electrical codes for your area. If you are unfamiliar with the NEC, your local building/electrical codes, and/or the proper installation methods for electrical devices, you should hire a qualified and licensed electrician to do the work for you.

WARNING: Before doing any electrical work, always disconnect power at the fuse or circuit breaker. Before doing any electrical work, always disconnect power at the fuse or circuit breaker.

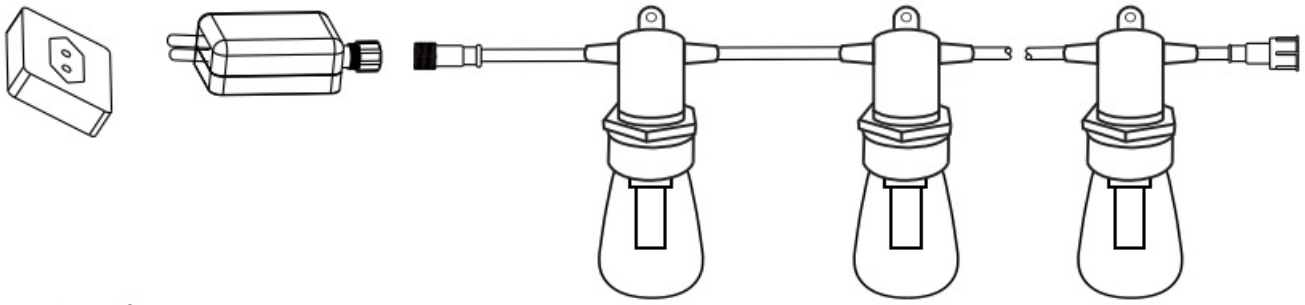

Important Considerations

LED strip lights must be powered by a compatible DGO LED control box, Not compatible with other universal programming protocols such as WS2818 or WS2801. Always consult a wire gauge chart to determine the correct size wire for your application. Wire gauge is dependent on voltage drop, amperage rating, and environment. Incorrect wire selection could overheat systems and cause a fire. This product is suitable for environments of ambient temperatures between -30°C to 50°C. It is important that LED String lights are not installed outside this range. The product can connect up to three strings at the same time.

How to install:

Our entire set of RGB smart light strings have been assembled, thereby reducing unnecessary and tedious steps for each customer. You only need to hang it in the desired position after receiving the product, then connect the power supply, and then control it with the remote control.

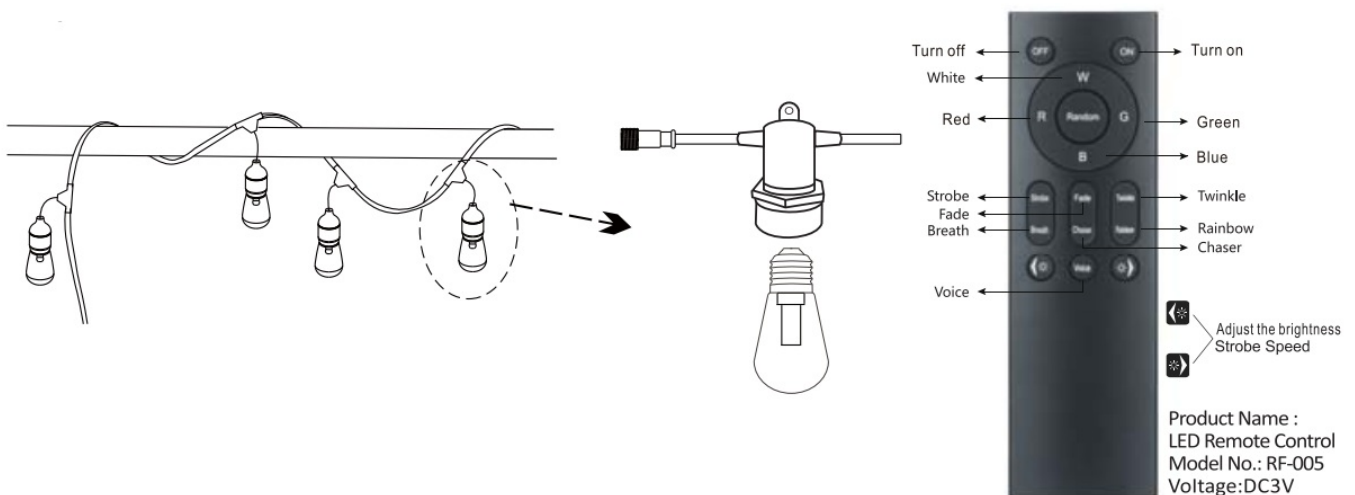

Easy to Connections:

A warm reminder, the light string control box and the rubber wire can be separated for easy connection. Up to three strings can be connected simultaneously. If you need to connect multiple light strings, please separate the control box of the second or more light strings from the rubber wire; Connect them in series through the joints of the rubber wires, and then plug in the power supply to use.

Specification:

Model:S14RGB
 Input voltage: AC 100-130V 50/60HZ
 Output Voltage: 5V/2.4A
 Socket: 1 x 15 sockets
 Bulb spacing: 3.2ft
 Length: 1 x 48ft (48ft in total)
 Certification: UL listed

Material: Acrylic Plastic, Brass, Rubber

Package Included:

1xRGB String Lights
15x S14 LED Bulbs
1 x Remote Controllers
1 x Controllers
1 x User Manual
1 x Spare light bulb

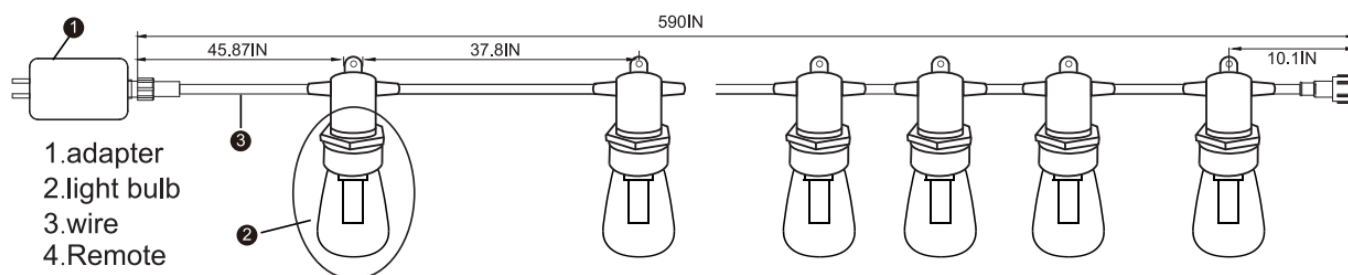

Power on your string lights, feel free select 8 single favorite colors from red, green, blue, WARM WHITE, yellow, cyan, purple, orange; adjust 3 modes from JUMP, FADE, FLASH; control the speed of color changing or dim the brightness of the bulb just by a simple press on the remote. Easily choose warm white for daily decor or vibrant colors for specific occasions. Select the voice control function, let the light dance with the rhythm of the music Advanced Dimming Pattern A dimmer switch could increase the festive atmosphere that you don't need to spend a big extra cost to buy. You can adjust the brightness level of the bulbs, and they will remain the last brightness level when you turn on it again.

INSTALLATION

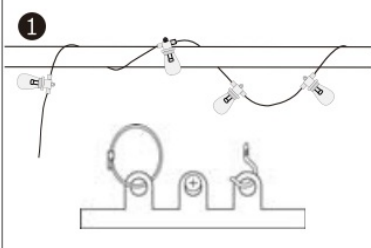
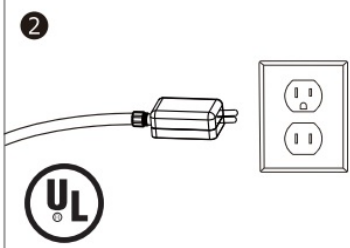
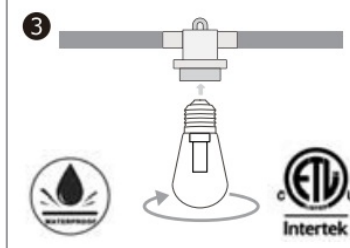
		
<p>Easy to install the cable in different ways</p>	<p>Connect the AC plug cable in different ways</p>	<p>If you change the led bulb. Please disconnect power of the string light. Rotate the bulb housing and pull out the Led bulb, then Replace it with the new bulb. Plug cable in different ways</p>

FCC Warning

This device complies with part 15 of the FCC Rules. Operation is subject to the following two conditions: (1) This device may not cause harmful interference, and (2) this device must accept any interference received, including interference that may cause undesired operation.

NOTE 1: This equipment has been tested and found to comply with the limits for a Class B digital device, pursuant to part 15 of the FCC Rules. These limits are designed to provide reasonable protection against harmful interference in a residential installation. This equipment generates, uses and can radiate radio frequency energy and, if not installed and used in accordance with the instructions, may cause harmful interference to radio communications. However, there is no guarantee that interference will not occur in a particular installation. If this equipment does cause harmful interference to radio or television reception, which can be determined by turning the equipment off and on, the user is encouraged to try to correct the interference by one or more of the following measures:

- Reorient or relocate the receiving antenna.
- Increase the separation between the equipment and receiver.
- Connect the equipment into an outlet on a circuit different from that to which the receiver is connected.
- Consult the dealer or an experienced radio/TV technician for help.

NOTE 2: Any changes or modifications to this unit not expressly approved by the party responsible for compliance could void the user's authority to operate the equipment. **RF exposure statement**

This equipment complies with the FCC radiation exposure limits set forth for an uncontrolled environment. This transmitter must not be co-located or operating in conjunction with any other antenna or transmitter.

Troubleshooting:

1. Some lights are not functional, Missing one part?

– Just email us for the replacement bulb in the fastest and most convenient way.

2. How many strand lights can be connected together?

– The max is 3 of the 48FT strands can be linked together.

3. The shift in brightness and/or temperature?

– Make sure you did not exceed the maximum series run limit. This will cause an excessive voltage drop, resulting in decreased brightness and/or temperature as the run is extended.

4. Lights are flickering?

– Check for loose connections and that string light connectors are attached correctly. Strips vary in width so it is important that compatible models are used and consistent polarity is maintained.

– If you have any questions that please feel free to contact us.

Quick customer contact information: peterleelty@gmail.com

Documents / Resources

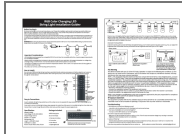

[DGO RGB Color Changing LED String Light](#) [pdf] Installation Guide

RF-005, RF005, 2A8BC-RF-005, 2A8BCRF005, RGB Color Changing LED String Light, RGB Color Changing LED, String Light, RGB Light, Color Changing Light

[Manuals+](#)