



Dexcom G7 Sensor Box Instruction Manual

[Home](#) » [Dexcom](#) » Dexcom G7 Sensor Box Instruction Manual 

Contents

- [1 Dexcom G7 Sensor Box](#)
- [2 Product Usage Instructions](#)
- [3 What's in the Sensor Box](#)
- [4 Which Display Device are you Setting Up?](#)
- [5 Use up to 3 Display Devices](#)
- [6 Setting Up Phone App](#)
- [7 Setting Up Receiver](#)
- [8 FAQ](#)
- [9 Documents / Resources](#)
 - [9.1 References](#)

dexcom

Dexcom G7 Sensor Box



Specifications:

- **Product Name:** Dexcom G7
- **Manufacturer:** Dexcom, Inc.
- **Display Devices:** Phone, Smartwatch, Dexcom Receiver
- **Operating Systems:** Compatible with supported smartphones

Product Usage Instructions

Setting Up Phone App:

1. **Get Started:** Download the Dexcom G7 app from the App Store or Google Play Store.
2. **Set Up:** Follow the sensor insertion instructions in the sensor box or in the app.
3. **Sensor Warmup:** Wait for the sensor warmup timer to complete before getting readings and alerts.
4. **Your Sensor Session:** Refer to the G7 User Guide for more information.

Setting Up Receiver:

1. **Insert Sensor:** Insert the sensor before pairing it with the receiver.
2. **Set up Receiver:** Follow the instructions provided in the sensor box for inserting the sensor.
3. **Sensor Warmup:** Wait for the sensor warmup timer to complete before receiving readings and alerts.
4. **Your Sensor Session:** Refer to the G7 User Guide for more details.

What's in the Sensor Box

Sensor and Applicator

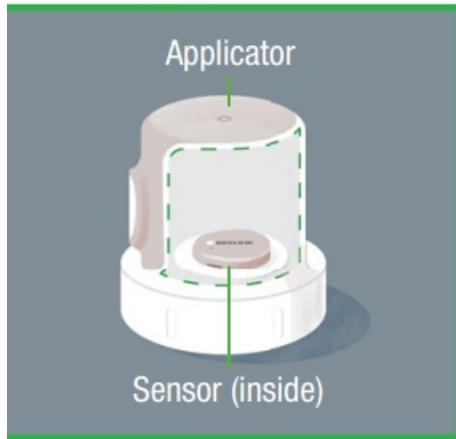

Overpatch

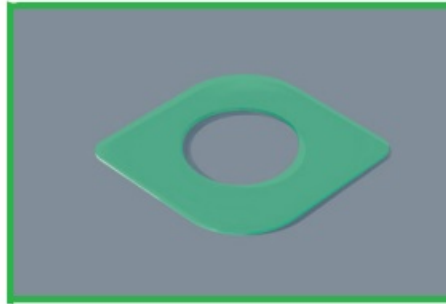

Sensor and Applicator

- During setup, we'll show you how to use the applicator to insert the built-in sensor under your skin.
- The sensor sends a glucose reading to your display device(s) every 5 minutes.
- The sensor lasts up to 10 days with a 12-hour grace period.

Overpatch

After you insert the sensor, you can use the overpatch to help keep the sensor on your skin.

Instructions

During setup, use the sensor insertion instructions found in the app or in the bundle with the overpatch.

Which Display Device are you Setting Up?

- **App**

Go to the section: Setting Up App

- **Receiver**

Go to the section: Setting Up Receiver

Use up to 3 Display Devices

Get your glucose information on your phone, smartwatch, and the Dexcom receiver. You can set up the phone app, the receiver, or both, in either order. App or receiver may not be available in all regions. For supported smartphones and operating systems go to: [dexcom.com/compatibility](https://www.dexcom.com/compatibility)

Setting Up Phone App

1. Get Started

Must have secure internet access during setup.

- Go to the App Store or Google Play Store to download the Dexcom G7 app.



Dexcom G7

★★★★☆ 4.3 K

- Open the phone app.
- Login or create an account.

2. Set-Up

- Follow phone app instructions to set up phone app.
- For instructions on inserting the sensor, follow phone app instructions or go to Inserting Sensor instructions in sensor box.
- After inserting and pairing, follow local guidelines for throwing out the applicator and recycling the Dexcom packaging.

3. Sensor Warmup

Sensor warmup timer tells you when you'll start getting readings and alerts.

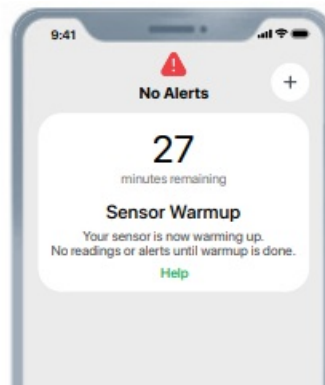

4. Your Sensor Session

Go to the G7 User Guide to find out more.

Setting Up Receiver

1. Insert sensor

- You must insert your sensor before pairing to the receiver.



- For instructions go to Inserting Sensor in the sensor box.

2. Set up receiver

- Press the Select button for 3–5 seconds to turn on receiver.
- Follow receiver instructions to set up the receiver. Insert sensor before pairing.
- After inserting and pairing, follow local guidelines for throwing out the applicator and recycling the Dexcom packaging

3. Sensor Warmup

Sensor warmup timer tells you when you'll start getting readings and alerts.



4. Your Sensor Session

Go to the G7 User Guide to find out more.

Receiver Navigation

The receiver screen tells you which button to use.

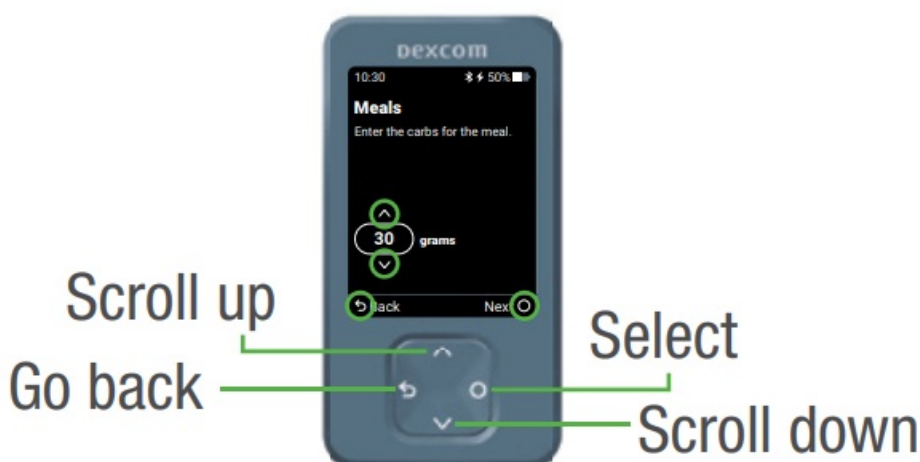

- To scroll faster hold down the Scroll button
- To move to the next field use the Select button

© 2024 Dexcom, Inc. All rights reserved.

Covered by patents [dexcom.com/patents](https://www.dexcom.com/patents).

Dexcom, Dexcom Clarity, Dexcom Follow, Dexcom One, Dexcom Share, and any related logos and design marks are either registered trademarks or trademarks of Dexcom, Inc. in the United States and/or other countries. App Store is a trademark of Apple Inc., registered in the U.S. and other countries and regions. Google Play is a trademark of Google LLC. All other marks are the property of their respective owners.

Dexcom, Inc.

- 6340 Sequence Drive San Diego, CA 92121 USA
- +1-[858-200-0200](tel:858-200-0200)
- [dexcom.com](https://www.dexcom.com)
- **Outside US:** Contact your local

Dexcom representative

AW00047-05 Rev 004 MT00047-05 Rev Date 2024/02

MDSS GmbH

Schiffgraben 41 30175 Hannover, Germany

MDSS-UK RP Ltd.

6 Wilmslow Road, Rusholme Manchester M14 5TP United Kingdom

FAQ

Q: How many display devices can I use with Dexcom G7?

A: You can use up to 3 display devices including your phone, smartwatch, and the Dexcom Receiver.



Q: Where can I find information about compatible smartphones and operating systems?

A: For supported smartphones and operating systems, visit dexcom.com/compatibility.

Documents / Resources

	Dexcom G7 Sensor Box [pdf] Instruction Manual AW00047-05, G7 Sensor Box, G7, Sensor Box, Box
---	---

References

-  [Dexcom Continuous Glucose Monitoring | Dexcom](#)
-  [Phones that work with Dexcom apps | Dexcom](#)
-  [Dexcom Patents](#)
- [User Manual](#)

[Manuals+](#), [Privacy Policy](#)

This website is an independent publication and is neither affiliated with nor endorsed by any of the trademark owners. The "Bluetooth®" word mark and logos are registered trademarks owned by Bluetooth SIG, Inc. The "Wi-Fi®" word mark and logos are registered trademarks owned by the Wi-Fi Alliance. Any use of these marks on this website does not imply any affiliation with or endorsement.