



## **Contents** [ [hide](#) ]

- [1 DEWALT DCPS7154 Powershift Plate Compactor](#)
- [2 Technical Data](#)
- [3 EC-Declaration of Conformity](#)
- [4 Battery Tool Use and Care](#)
- [5 Safety Instructions for Plate Compactors](#)
- [6 Markings on Tool](#)
- [7 Battery Type](#)
- [8 Package Contents](#)
- [9 Description \(Fig. A\)](#)
- [10 ASSEMBLY AND ADJUSTMENTS](#)
- [11 Dual Action ON Switch/OFF Switch \(Fig. A, C\)](#)
- [12 OPERATION](#)
- [13 Removing the Handle \(Fig. N\)](#)
- [14 After Using the Machine](#)
- [15 MAINTENANCE](#)
- [16 Storage](#)
- [17 V-belt](#)
- [18 Frequently Asked Questions](#)
- [19 Documents / Resources](#)
  - [19.1 References](#)



## **DEWALT DCPS7154 Powershift Plate Compactor**



**WARNING:** Read all safety warnings, instructions, illustrations, and specifications in this manual, including the battery and charger sections provided in an original tool manual or the separate Batteries and Chargers manual. Manuals can be obtained by contacting Customer Service (refer to the back page of this manual).

## Technical Data

		DCPS7154
Type		1
Battery type		Li-Ion
Dimensions		
Width	mm	400
Length (handle in operating position)	mm	1160
Length (handle in storage position)	mm	1010
Length (plate compactor without handle)	mm	860
Height (handle in operating position)	mm	940

Height (handle in storage position)	mm	770
Height (plate compactor without handle)	mm	670
Maximum incline angle before machine can tip to the side		20°
Maximum climbing capability		30%
Rate of advance	28 m/min   1.04 mph   91.8 fpm	
Impact force	kN	15
Impact frequency	hz	100
Specified contact pressure	N/cm <sup>2</sup>	10.7
Water tank capacity	l	11
Bluetooth® Transmitter		
Frequency Band Max. Power (EIRP)	MHz mW	2400 0.28
Weight		
Without battery and without water tank	kg	91
Without battery and empty water tank	kg	94
Without battery and half-filled water tank	kg	100
Without battery and full water tank	kg	105

Noise values and/or vibration values (triax vector sum) according to EN500-4:		
L <sub>PA</sub> (Sound pressure level at the workplace)	dB(A)	88
L <sub>WA</sub> (Measured sound power level)	dB(A)	99
Uncertainty K =	dB(A)	3
Vibration emission value a <sub>h</sub> =	m/s <sup>2</sup>	1.5
Uncertainty K =	m/s <sup>2</sup>	1.5

The vibration and/or noise emission level given in this information sheet has been measured in accordance with a standardised test given in EN 500-4 and may be used to compare one tool with another. It may be used for a preliminary assessment of exposure.

**WARNING:** The declared vibration and/or noise emission level represents the main applications of the tool. However, if the tool is used for different applications, with different accessories or is poorly maintained, the vibration and/or noise emission may differ. This may significantly increase the exposure level over the total working period. An estimation of the level of exposure to vibration and/or noise should also take into account the times when the tool is switched off or when it is running but not actually doing the job. This may significantly reduce the exposure level over the total working period.

Identify additional safety measures to protect the operator from the effects of vibration and/or noise such as: maintain the tool and the accessories, keep the hands warm (relevant for vibration), organisation of work patterns.

## EC-Declaration of Conformity

### Machinery Directive and Radio Equipment Directive

#### Vibratory Plate

DCPS7154

DEWALT declares that these products described under Technical Data are in compliance with 2006/42/EC and EN62841-1:2015+A11:2022, EN 500-1:2006 + A1:2009, EN 500-4:2011.

These products also comply with Directive 2014/53/EU, 2011/65/EU and 2000/14/EC Annex VIII with TÜV Rheinland LGA Products GmbH, Tillystraße 2, 90431 Nürnberg, Germany, Notified Body number: 0197 Category Annex I: item 8

- LWA (measured sound power level) 99 dB
- LWA (guaranteed sound power level) 105 dB

The full text of the EU declaration of conformity can be requested at below address or is available at the following internet address: [www.2helpu.com](http://www.2helpu.com) (search by the Product and Type Number indicated on the nameplate). For more information, please contact DEWALT at the following address or refer to the back of the manual.



The undersigned is responsible for compilation of the technical file and makes this declaration on behalf of DEWALT.



- Markus Rompel
  - Vice-President Engineering, PTE-Europe DEWALT, Richard-Klinger-Straße 11, 65510, Idstein, Germany
- 31.12.2024

**WARNING:** To reduce the risk of injury, read the instruction manual.

### **Definitions: Safety Guidelines**

The definitions below describe the level of severity for each signal word. Please read the manual and pay attention to these symbols.

-  **DANGER:** Indicates an imminently hazardous situation which, if not avoided, will result in death or serious injury.
-  **WARNING:** Indicates a potentially hazardous situation which, if not avoided, could result in death or serious injury.

-  **CAUTION:** Indicates a potentially hazardous situation which, if not avoided, may result in minor or moderate injury. **NOTICE:** Indicates a practice not related to personal injury which, if not avoided, may result in property damage.
-  Denotes risk of electric shock.
-  Denotes risk of fire.

## **GENERAL POWER TOOL SAFETY WARNINGS**

**WARNING:** Read all safety warnings, instructions, illustrations and specifications provided with this power tool. Failure to follow all instructions listed below may result in electric shock, fire and/or serious injury.

### **SAVE ALL WARNINGS AND INSTRUCTIONS FOR FUTURE REFERENCE**

The term “power tool” in the warnings refers to your mains-operated (corded) power tool or battery-operated (cordless) power tool.

### **Work Area Safety**

- Keep work area clean and well lit. Cluttered or dark areas invite accidents.
- Do not operate power tools in explosive atmospheres, such as in the presence of flammable liquids, gases or dust. Power tools create sparks which may ignite the dust or fumes.
- Keep children and bystanders away while operating a power tool. Distractions can cause you to lose control.

### **Electrical Safety**

- Power tool plugs must match the outlet. Never modify the plug in any way. Do not use any adapter plugs with earthed (grounded) power tools. Unmodified plugs and matching outlets will reduce risk of electric shock.
- Avoid body contact with earthed or grounded surfaces, such as pipes, radiators, ranges and refrigerators. There is an increased risk of electric shock if your body is

earthed or grounded.

- Do not expose power tools to rain or wet conditions. Water entering a power tool will increase the risk of electric shock.
- Do not abuse the cord. Never use the cord for carrying, pulling or unplugging the power tool. Keep cord away from heat, oil, sharp edges or moving parts. Damaged or entangled cords increase the risk of electric shock.
- When operating a power tool outdoors, use an extension cord suitable for outdoor use. Use of a cord suitable for outdoor use reduces the risk of electric shock.
- If operating a power tool in a damp location is unavoidable, use a residual current device (RCD) protected supply. Use of an RCD reduces the risk of electric shock.

## **Personal Safety**

- Stay alert, watch what you are doing and use common sense when operating a power tool. Do not use a power tool while you are tired or under the influence of drugs, alcohol or medication. A moment of inattention while operating power tools may result in serious personal injury.
- Use personal protective equipment. Always wear eye protection. Protective equipment such as a dust mask, non-skid safety shoes, hard hat or hearing protection used for appropriate conditions will reduce personal injuries.
- Prevent unintentional starting. Ensure the switch is in the off position before connecting to power source and/or battery pack, picking up or carrying the tool. Carrying power tools with your finger on the switch or energising power tools that have the switch on invites accidents.
- Remove any adjusting key or wrench before turning the power tool on. A wrench or a key left attached to a rotating part of the power tool may result in personal injury.
- Do not overreach. Keep proper footing and balance at all times. This enables better control of the power tool in unexpected situations.
- Dress properly. Do not wear loose clothing or jewellery. Keep your hair and clothing away from moving parts. Loose clothes, jewellery or long hair can be caught in moving parts.
- If devices are provided for the connection of dust extraction and collection facilities, ensure these are connected and properly used. Use of dust collection can reduce dust-related hazards.

- Do not let familiarity gained from frequent use of tools allow you to become complacent and ignore tool safety principles. A careless action can cause severe injury within a fraction of a second.

## **Power Tool Use and Care**

- Do not force the power tool. Use the correct power tool for your application. The correct power tool will do the job better and safer at the rate for which it was designed.
- Do not use the power tool if the switch does not turn it on and off. Any power tool that cannot be controlled with the switch is dangerous and must be repaired.
- Disconnect the plug from the power source and/or remove the battery pack, if detachable, from the power tool before making any adjustments, changing accessories, or storing power tools. Such preventive safety measures reduce the risk of starting the power tool accidentally.
- Store idle power tools out of the reach of children and do not allow persons unfamiliar with the power tool or these instructions to operate the power tool. Power tools are dangerous in the hands of untrained users.
- Maintain power tools and accessories. Check for misalignment or binding of moving parts, breakage of parts and any other condition that may affect the power tool's operation. If damaged, have the power tool repaired before use. Many accidents are caused by poorly maintained power tools.
- Keep cutting tools sharp and clean. Properly maintained cutting tools with sharp cutting edges are less likely to bind and are easier to control.
- Use the power tool, accessories and tool bits, etc. in accordance with these instructions, taking into account the working conditions and the work to be performed. Use of the power tool for operations different from those intended could result in a hazardous situation.
- Keep handles and grasping surfaces dry, clean and free from oil and grease. Slippery handles and grasping surfaces do not allow for safe handling and control of the tool in unexpected situations.

## **Battery Tool Use and Care**

- Recharge only with the charger specified by the manufacturer. A charger that is suitable for one type of battery pack may create a risk of fire when used with another



battery pack.

- Use power tools only with specifically designated battery packs. Use of any other battery packs may create a risk of injury and fire.
- When battery pack is not in use, keep it away from other metal objects, like paper clips, coins, keys, nails, screws or other small metal objects, that can make a connection from one terminal to another. Shorting the battery terminals together may cause burns or a fire.
- Under abusive conditions, liquid may be ejected from the battery; avoid contact. If contact accidentally occurs, flush with water. If liquid contacts eyes, additionally seek medical help. Liquid ejected from the battery may cause irritation or burns.
- Do not use a battery pack or tool that is damaged or modified. Damaged or modified batteries may exhibit unpredictable behaviour resulting in fire, explosion or risk of injury.
- Do not expose a battery pack or tool to fire or excessive temperature. Exposure to fire or temperature above 130 °C may cause explosion.
- Follow all charging instructions and do not charge the battery pack or tool outside the temperature range specified in the instructions. Charging improperly or at temperatures outside the specified range may damage the battery and increase the risk of fire.

## **Service**

- Have your power tool serviced by a qualified repair person using only identical replacement parts. This will ensure that the safety of the power tool is maintained.
- Never service damaged battery packs. Service of battery packs should only be performed by the manufacturer or authorised service providers.

## **Safety Instructions for Plate Compactors**

During the machine's operation, various residual hazards exist that are caused by the purpose of the machine's use and cannot be eliminated by design. Therefore, heed the following instructions:

**WARNING:** The exciter 10 of the plate compactor may become very hot during use. Do not touch hot surfaces with unprotected skin.

- Become familiar with the operation and control elements and the manner of working with the machine by requiring instructions from experienced users/trainers.
- Check that all of the safety devices are securely installed in place.
- Never start the machine with defective instruments or controls. This may cause injury!
- Examine your work environment and prepare it for the work. This includes, among other things:
  - Removing obstacles in the work area.
  - Checking the ground's load capacity.
  - Providing necessary safeguards.
- The points listed here are frequently occurring activities in relation to the machine's area of application. This list is not complete, and depends on the specific work environment. Always adapt it to your own work environment.
- Abide by the switching-on and switching-off procedures as per the instruction manual.

## **Conversions and Changes to the Machine**

Unauthorised changes to the machine are not permitted for safety reasons.

Original parts and accessories have been specially designed for the machine. It should be noted that parts and special equipment not supplied by DEWALT are not approved by DEWALT. The installation and/or the use of such products can also affect the active and/or passive safety.

The manufacturer disclaims all liability for any damage caused by using non-original parts or special equipment.

## **Markings on Tool**

The following pictograms are shown on the tool:



Read instruction manual before use.



Wear ear protection.



Wear eye protection.



Wear safety shoes



Do not place hand in this area



Lifting point.



Pinch hazard.



Do not spray with high pressure water.



Hot surfaces



DEWALT POWERSHIFT™ Battery

## Residual Risks

This DEWALT machine has been designed according to current state-of-the-art technology and the applicable technology regulations. Nevertheless, this machine can still endanger people and equipment if it is:

- not used as intended.
- not used by suitably trained personnel.
- is improperly modified or converted.
- the safety regulations were ignored.

Therefore, everyone involved in operating, maintaining or repairing the machine must read and abide by the instruction manual and especially the safety regulations. This must be confirmed by the operating company through signatures as necessary.

## Coin Cell Warnings

**WARNING**

- **Ingestion Hazard** : This product contains a button cell or coin battery.
- **Death** or serious injury can occur if ingested.
- A swallowed button cell or coin battery can cause **Internal chemical Burns** in as little as **2 hours**.
- **keep** new and used batteries **OUT OF Reach of children**.
- **seek immediate medical attention** if a battery is suspected to be swallowed or inserted inside any part of the body.



Remove and immediately recycle or dispose of used batteries according to local regulations and keep away from children. Do NOT dispose of batteries in household waste or incinerate. Even used batteries may cause severe injury or death. Seek professional medical attention for treatment information.

The tool uses a CR2450 type battery of nominal 3V voltage. Non-rechargeable batteries are not to be recharged. Do not force discharge, recharge, disassemble, heat above 60 ° C, or incinerate. Doing so may result in injury due to venting, leakage or explosion resulting in chemical burns. Ensure the batteries are installed correctly according to polarity (+ and -). Do not mix old and new batteries, different brands or types of batteries, such as alkaline, carbon-zinc, or rechargeable batteries. Remove and immediately recycle or dispose of batteries from equipment not used for an extended period of time according to local regulations. Always completely secure the battery compartment. If the battery compartment does not close securely, stop using the product, remove the batteries, and keep them away from children.

## Battery Type

These battery packs may be used:

Battery	(kg)
DCBPS0554	5.3

The DCAFVPS DeWALT FLEXVOLT® to DeWALT POWERSHIFT™ adapter\*\* can also

be used with the following battery packs:

Battery	(kg) Battery and adapter
DCB546	2.78
DCB547/G	3.16
DCB548	3.16
DCB549	3.90

\*\*DCAFVPS DEWALT FLEXVOLT® to DEWALT POWERSHIFT™ adapter is not for sale or use in Germany.

## Package Contents

The package contains:

- 1 Plate compactor
- 1 Instruction manual
- Check for damage to the tool, parts or accessories which may have occurred during transport.

## Date Code Position (Fig. B)

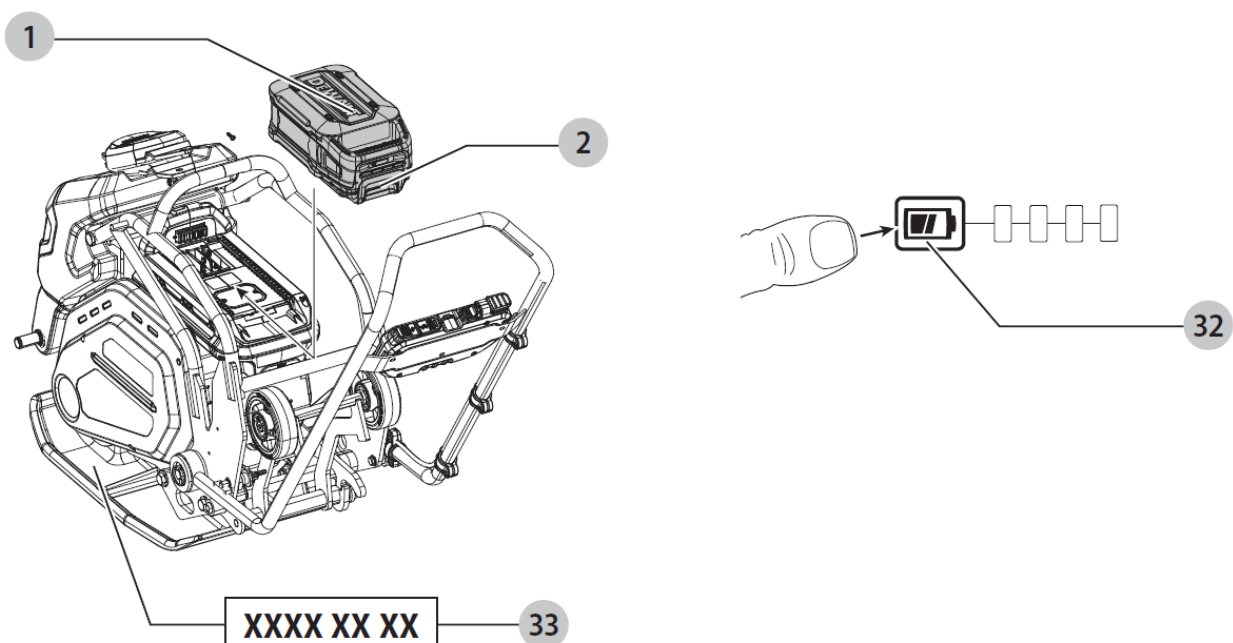

The production date code 33 consists of a 4-digit year followed by a 2-digit week and is extended by a 2-digit factory code.

## Description (Fig. A)

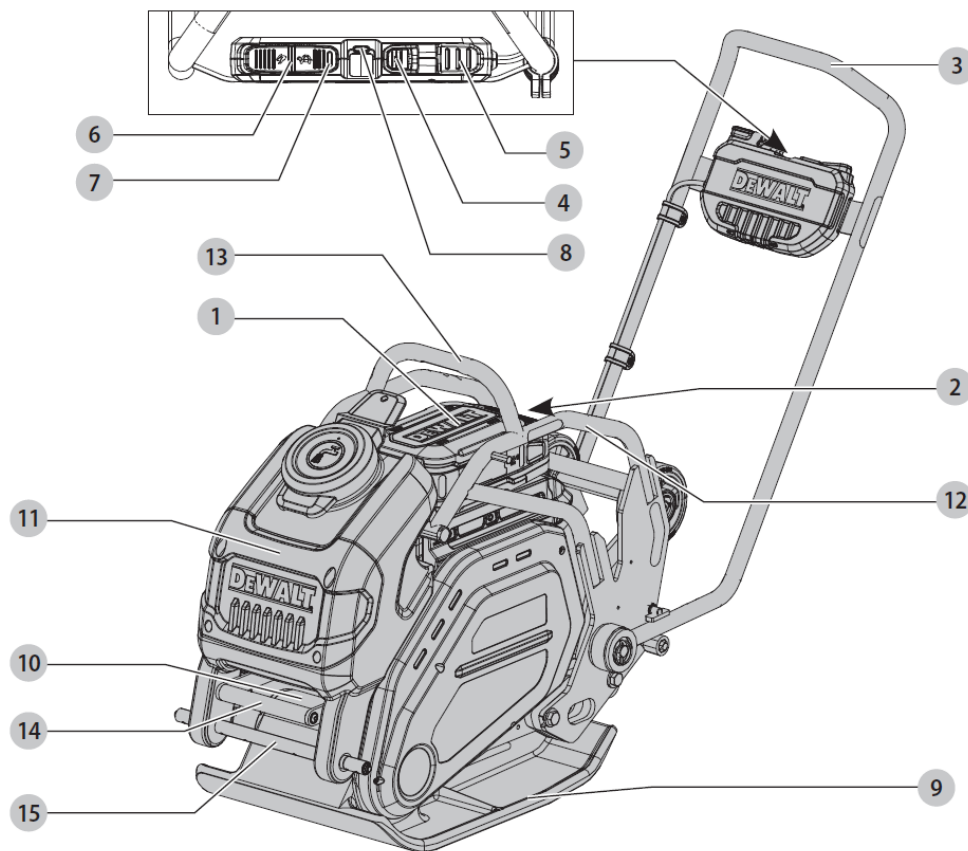

**WARNING:** Never modify the power tool or any part of it. Damage or personal injury could result.

1. Battery
2. Battery release button
3. Handle
4. Dual action ON switch
5. OFF switch
6. Speed control
7. Low speed indicator
8. Hot motor warning
9. Base plate
10. Exciter
11. Removable water tank
12. Frame

13. Dedicated lifting point
14. Front handle
15. Sprinkler tube

### **Intended use**

The DCPS7154 DEWALT POWERSHIFT™ plate compactor is a reliable professional compacting device thanks to its stable, robust design.

This machine is only to be used for:

- Compaction of bituminous material in street and path construction.
- Light compaction work in civil engineering and earthworks.
- Any other use is unintended and therefore improper. Improper use can threaten the safety of the personnel working with the machine. The manufacturer accepts no liability for resulting damages.
- Safe operation of the machine is ensured only by intended use. Intended use also includes compliance with all information in this instruction manual.
- DO NOT use under wet conditions or in the presence of flammable liquids or gases.
- This machine is a professional power tool.
- DO NOT let children come into contact with the tool. Supervision is required when inexperienced operators use this tool.
- Young children and the infirm. This appliance is not intended for use by young children or infirm persons without supervision.
- This product is not intended for use by persons (including children) suffering from diminished physical, sensory or mental abilities; lack of experience, knowledge or skills unless they are supervised by a person responsible for their safety. Children should never be left alone with this product.

### **ASSEMBLY AND ADJUSTMENTS**

**WARNING:** To reduce the risk of serious personal injury, turn tool off and disconnect battery pack before making any adjustments or removing/installing attachments or accessories. An accidental start-up can cause injury.

- **WARNING:** Use only DEWALT batteries and chargers.
- **DANGER:** Death or injury hazard from damaged cables or contacts on the machine. If

any cables or contacts are damaged in any way, have them replaced by technical personnel or the manufacturer.

- **WARNING:** Failure to use personal protective equipment (PPE) or using unsuitable equipment, may harm health or cause injury. Personal protective equipment includes:  
Eye protection.
- Hearing protection.
- Safety shoes.

Determine and prepare the right personal protective equipment for the job. Use only personal protective equipment that is in proper condition and offers effective protection. Adjust the personal protective equipment to the person, such as to body size.

**WARNING:** Use only DEWALT batteries.

### **Before using the machine, do as follows:**

1. Place the machine on a level floor.
2. Lift the transport wheels and lock them. Refer to Preparing the Machine for Transport.
3. Inspect:
  - Screw joints for firm seating.
  - Condition of the machine (visual inspection).
  - Check the battery and attachment of the battery for damage (visual inspection).
  - Check the battery rail and terminal block for dirt (visual inspection).

If necessary, clean with a clean, dry cloth. Dry any visible condensed water or any other water in battery rail and terminal block area.

If necessary, contact an authorised service center to repair any defects found.
4. Check the ON/OFF controls are in “OFF” position.
5. Unlock the handle. Refer to Preparing the Machine for Transport.
6. Check the battery charge status.

If necessary, replace with a fully charged battery.
7. Slide the battery into the machines battery rail and ensure it is firmly held in place. An audible click ensures it is installed correctly.
8. When used for hot asphalt, cold water should be used to help prevent the hot asphalt



from sticking to the cold base plate, so user should turn on sprinkler function.

9. Adjust the speed to the slow setting before starting.
10. Once these steps are finished, the machine can be started.
11. Adjust speed to desired level.

## Installing and Removing the Battery Pack (Fig. B)

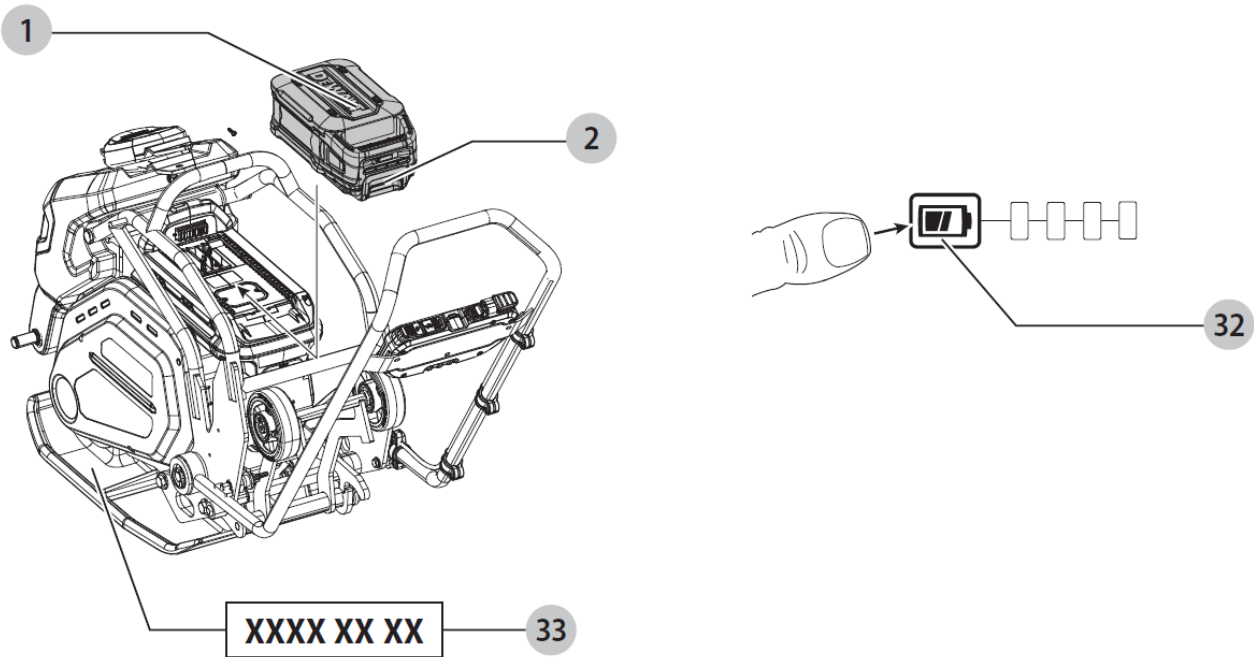

**WARNING:** Ensure the tool is in the off position before inserting the battery pack.

**NOTE:** For best results, make sure your battery pack 1 is fully charged.

### To Install the Battery Pack into the Tool

1. Align the battery pack with the rails.
2. Slide it in until the battery pack is firmly seated in the tool and ensure that you hear the lock snap into place.

### To Remove the Battery Pack from the Tool

1. Press the battery release button 2 and firmly pull the battery pack.
2. Insert battery pack into the charger as described in the battery/charger manual.

## Dual Action ON Switch/OFF Switch (Fig. A, C)

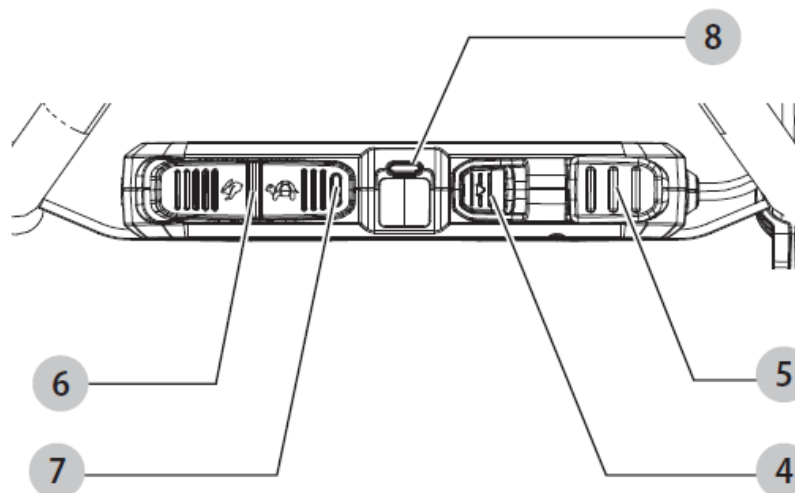
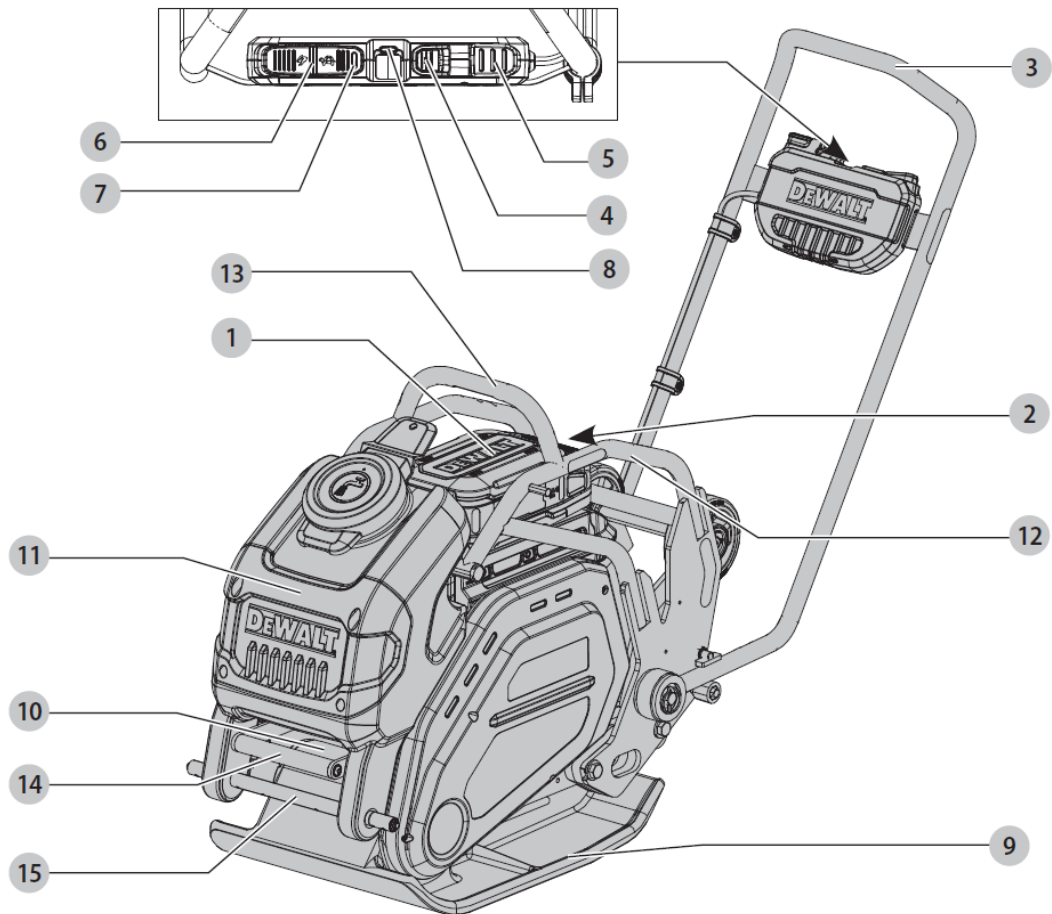

**WARNING:** Injury hazard from damage and defects on the machine. Damage and defects on the machine, especially the safety equipment, are hazard sources. Damaged machines can injure the machine operator or bystanders. Before every start-up, visually inspect for damage. If damage is located and identified, never operate the machine. Replace defective components.

**WARNING:** When the ON/OFF control is set to ON, the machine starts to move forward immediately. In cold conditions, or after a long time of not being used, the motor will start but the machine might not move forward, and white LED 7 will blink. As soon as

machine warms up, it will start to move forward automatically.

To start the machine, do as follows:

1. Slide the dual action ON switch 4 to the right and then push down.

The machine is ready to operate. Refer to Operation.

### **Shutting Off the Machine (Fig. A, C)**

**WARNING:** Injury hazard from unauthorised access. If the machine is left unsupervised, unauthorised people can use the machine and injure themselves and others.

Shut the machine off after finishing work.

During operation interruptions or after finishing work, remove the battery and protect the machine from unauthorised access. Refer to Parking the Machine.

### **To stop the machine, do as follows:**

1. Press down firmly on the red OFF switch 5 .
2. The machine shuts off.

### **Speed Controls (Fig. A, C)**

The speed of the machine can be controlled by the speed control button 6 . Pressing the speed control button on the left increases the speed of the machine. Pressing the speed control button on the right decreases the speed of the machine.

The interface/control panel has a red LED hot motor warning 8 in the center and a white LED low speed indicator 7 in the speed selection button.

<b>LED Function</b>	<b>Description</b>
<b>White</b> Low speed indicator 7 constantly illuminated	Low speed activated.
<b>White</b> Low speed indicator 7 blinking	The machine has not reached full forward speed yet.

<b>Red</b> Hot motor warning 8 constantly illuminated	The motor has reached its maximum operational temperature and automatically turned off. Allow the motor time to cool down.
---	--

LED Function	Description
<b>Red</b>  Hot motor warning 8  blinking	The machine is signalling a fault that could result in motor failure. Turn the machine off and take it to an authorised DeWALT repair agent.

### Rubber Mat (Fig. D)

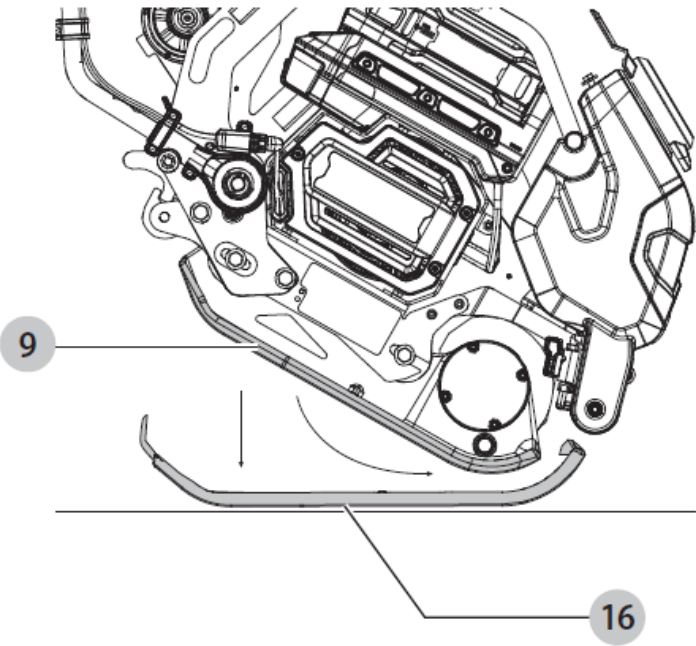

When compacting interlocking stone pavers, it is recommended that the rubber mat (available separately) 16 be used. This prevents damage to the machine and compaction material. The rubber mat can be installed without tools.

1. Lay the rubber mat 16 on a flat, level surface.
2. Place the machine on top of the rubber mat and slide the machine forward so that the front corners of the base plate 9 fit under the two tabs on each corner of the rubber mat.

3. Secure the two clips on the back of the rubber mat, by lifting each clip and placing them over the back edge of the base plate.

### Attaching and Removing the Water Tank (Fig. E, F) Installing the Water Tank (Fig. E)

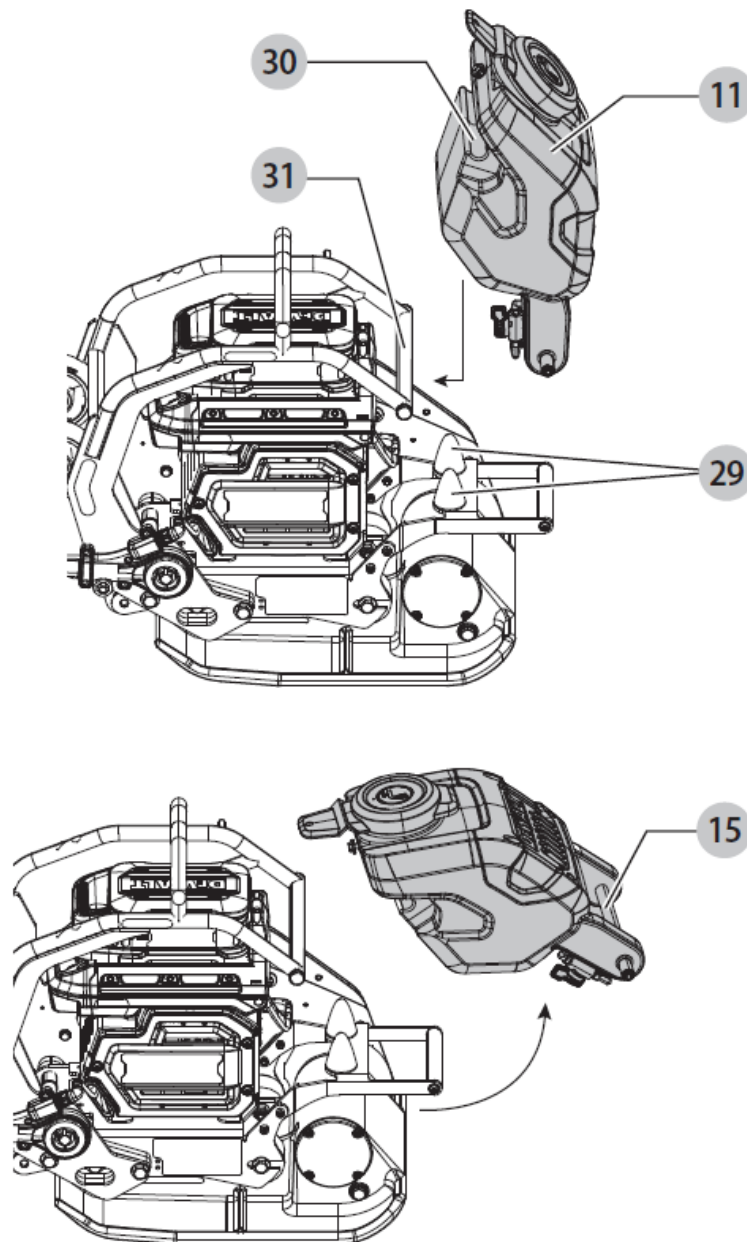

1. Before installing the water tank 11 , spray both buffer stops 29 with silicone spray.
2. Place the water tank on the buffer stops and with force push the water tank towards the machine, so that the groove 30 in the water tank fits under the bar 31 on the front of the machine.

### Removing the Water Tank (Fig. F)

To remove the water tank, pull the tank away from the machine from the area around the sprinkler tube 15 of the tank until it separates from the machine.

### Water Sprinkler (Fig. G, H)

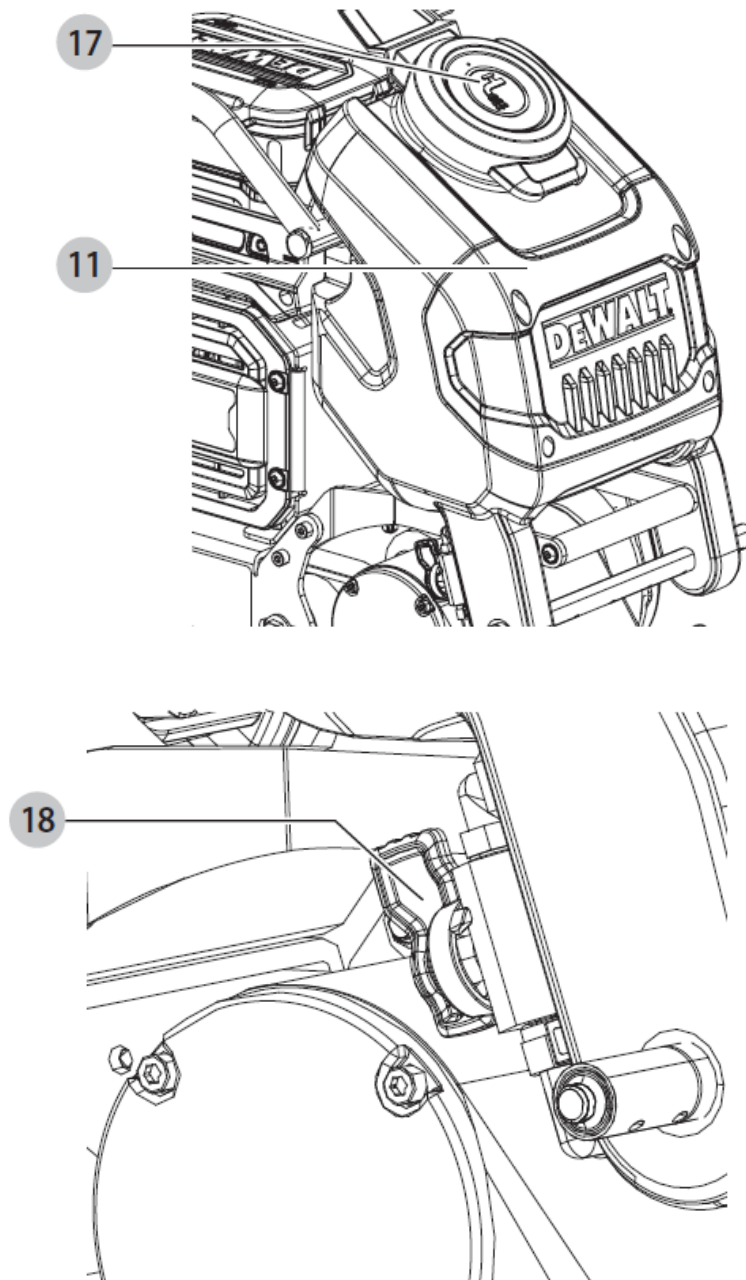

**WARNING:** Beware of property damage. Fill the water tank only with clean water or antifreeze mixture. If there is danger of freezing, empty the water tank and sprinkler system, or fill it with antifreeze mixture.

**WARNING:** DO NOT allow water to splash out/over the water tank to prevent the water contacting the battery rail and terminal block area.

1. Remove the battery.
2. Fill the water tank 11 through the tank opening 17 .

3. Inspect for wet areas in the battery interface area and thoroughly dry the area.
4. Insert the battery.
5. Turn the tap 18 .
  - Position “0” = OFF
  - Position “I” = ON

## OPERATION

**WARNING:** To reduce the risk of serious personal injury, turn tool off and disconnect battery pack before making any adjustments or removing/installing attachments or accessories. An accidental start-up can cause injury.

**DANGER:** Death hazard from tilting or sliding the machine. Unstable material, unstable edges and slippery surfaces can cause the machine to tip over. This can cause severe injury or death.

- Navigate slopes carefully, and always guide the machine upward in a straight direction, with the handle in the locked position.
- At ditch edges and terraces, and in front of obstacles, guide the machine so that the machine operator cannot be injured by falling or crushing (Fig. J).

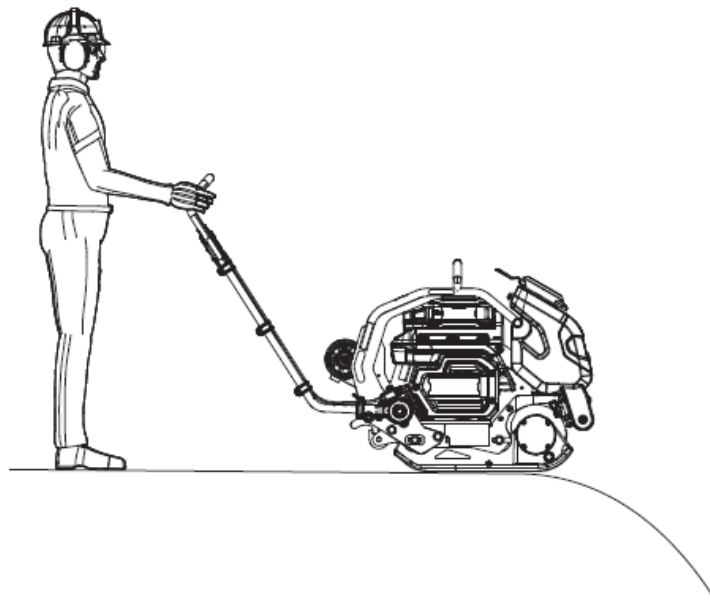

- The machine should not be used on any gradients that exceed the maximum climbing capability set out in Technical Data and the handle should be set to the locked position.
- Keep adequate distance from trench edges and embankments.
- Refrain from any manner of working that threatens the machine's stability.



- Make sure to position operator in a location during use so that if the machine were to tip over, the operator would be clear.
- Do not move over hard concrete, hardened bitumen surfaces, frozen ground or ground that does not have an adequate load capacity.
- CAUTION: Accident hazard. The machine drives off immediately after start-up. Keep a strong hold on the machine.
- CAUTION: Finger pinch hazard. When folding the handle up, fingers can get between the handle and the frame. When folding the handle, make sure that fingers are not between the handle and the frame.
- NOTICE: Beware of property damage. When compacting interlocking stone pavers, it is recommended that a rubber mat (available separately) be used to prevent damage to the machine and compaction materials.

### Proper Hand Position (Fig. I)

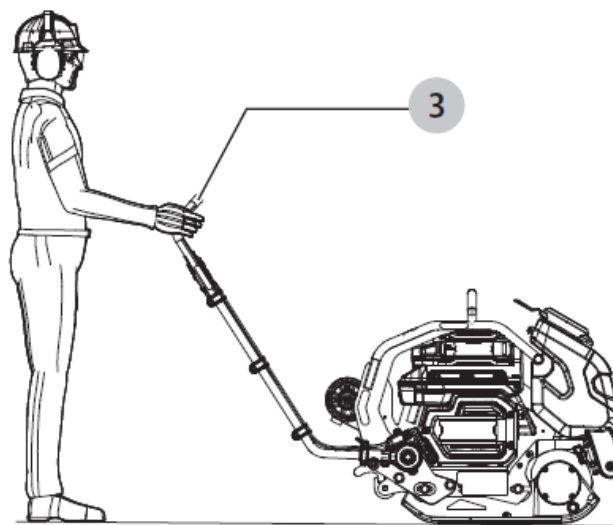

- WARNING: To reduce the risk of serious personal injury, ALWAYS use proper hand position as shown.
- WARNING: To reduce the risk of serious personal injury, ALWAYS hold securely in anticipation of a sudden reaction. Proper hand position requires both hands on the handle 3 .

### Preparing the Machine for Transport (Fig. A, K–M)



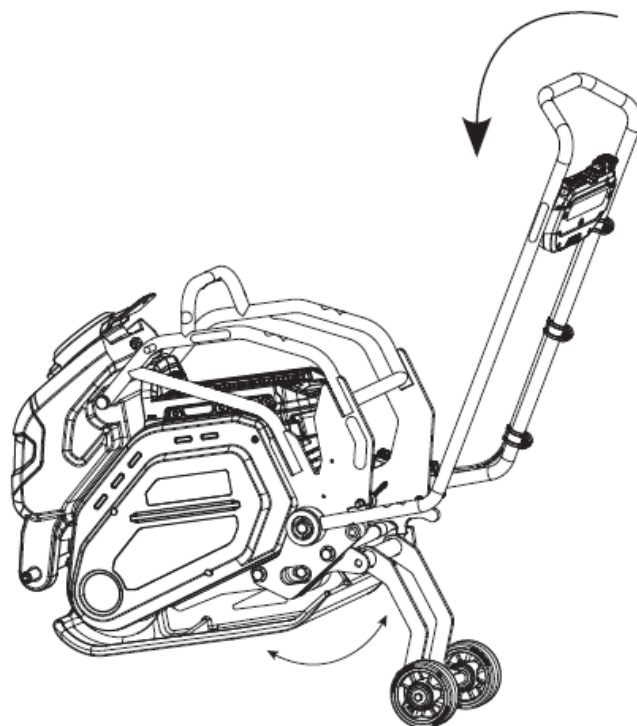
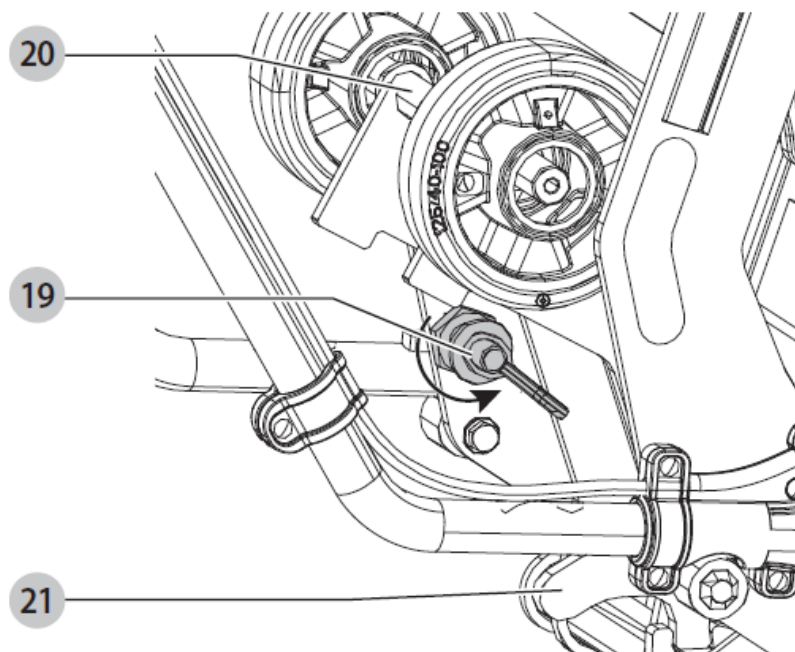

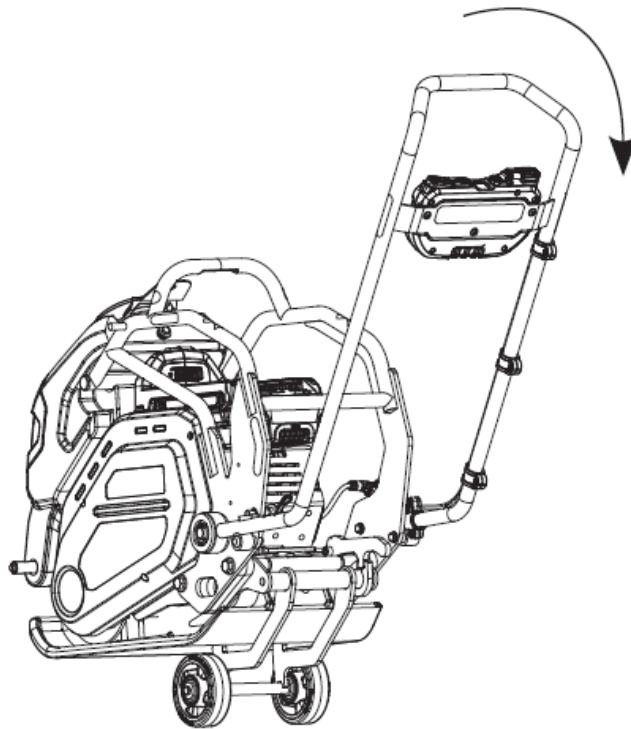

- **CAUTION:** Injury hazard from tilting the machine! Long downtimes on the transport vehicle and moving on uneven or sloped ground decreases the machine's stability. The machine can tilt or slide off. For long downtimes, do not park the machine on the transport wheels. Move the wheeled plate compactor carefully on uneven or sloped ground.
- **CAUTION:** Injury hazard from heavy load! Foot injuries may occur when lifting or lowering the machine. Do not place feet on or under the lifted base plate. Wear safety shoes.

When using the wheel kit, the machine can be transported short distances.

**To lower the transport wheels do as follows:**

1. Allow the handle to rest in its lowest position on the stops. Push the handle 3 down slightly against the rubber stops.
2. Rotate the locking pin 19 until it extends, preventing the handle from being lifted (Fig. K).
3. Release the transport wheels 20 using the transport wheels release lever 21 and allow the wheels to drop to the ground (Fig. K).
4. With the handle locked, tilt the machine onto the front edge. The transport wheels swivel under the plate (Fig. L).
5. Tilt the machine back until the plate lies horizontally on the transport wheels (Fig. M).

The device is ready to move.

6. After transport, follow the opposite sequence to stow and lock the transport wheels away.

## Removing the Handle (Fig. N)

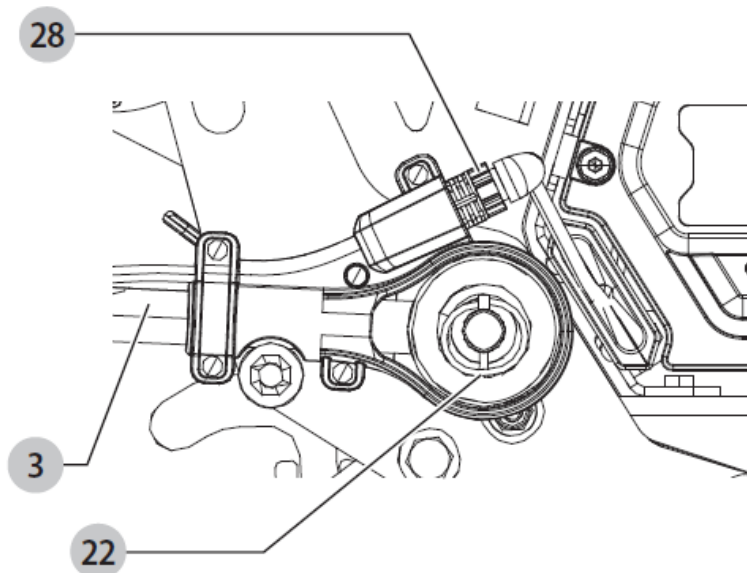

For easier transport, the handle can be removed.

**WARNING:** Injury hazard from improper handling of the machine! If the machine is operated without the handle, it cannot be controlled and can cause injury.

Do not operate the machine without the handle. After transport, properly install the handle again.

### To remove the handle, do as follows:

1. Disconnect the M19 cable connector 28 by unscrewing the grey nut on the connector. No tools are required.
2. Pull out the lynch pins 22 .
3. Pull the handle 3 gently out and remove it.
4. Insert the lynch pins back into the holes to secure them against loss.

## Parking the Machine (Fig. K, L, P)

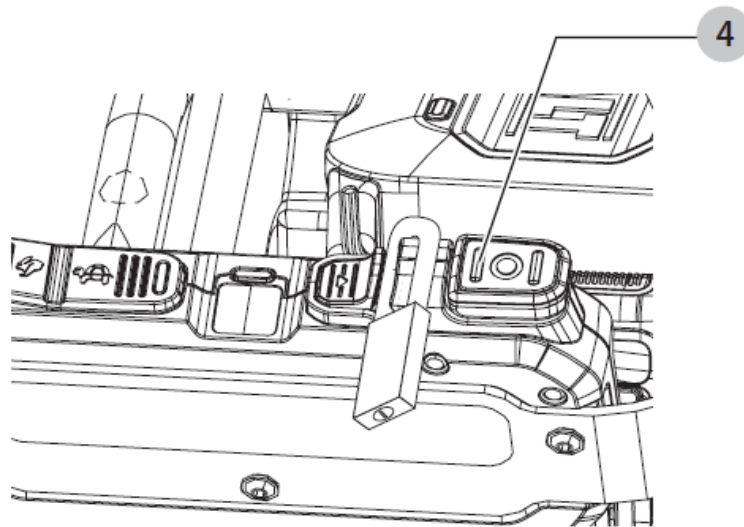

After work, park the machine on level ground, and in a dry environment.

Secure it against unintentional movement and unauthorised use. If the machine is left unattended, the machine shall be locked against unauthorised use by locking the dual action ON switch 4 (Fig. P). Remove the DEWALT POWERSHIFT™ battery from the tool or FLEXVOLT® adaptor from the tool and FLEXVOLT® battery from the adaptor.

NOTE: Do not place or store the machine on the transport wheels 20. Damage may occur. The transport wheels are designed only for transporting the unit short distances.

## After Using the Machine

### After using the machine, do as follows:

1. Turn off the machine.
2. Turn off the water sprinkler.
3. Place the machine on a level floor.
4. Remove the battery from the machine. Refer to Installing and Removing the Battery Pack.
5. Clean the battery with a clean, dry cloth.
6. Clean the battery rail and terminal block with a clean, dry cloth.
7. Visually check the battery for damage.
8. Charge the battery.
9. Lock by padlock (not supplied with the tool). Refer to Parking the Machine.

## Loading and Transporting the Machine (Fig. A, O)

Fig. 0

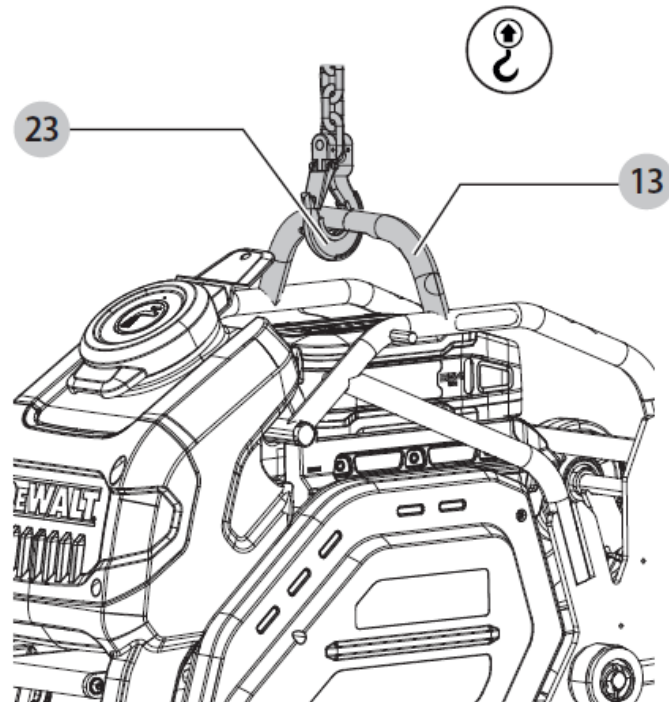

**WARNING:** The machine is heavy. Do not lift by hand.

**DANGER:** Death hazard from suspended load! The machine is heavy, 100 kg without battery and with a half-filled water tank. Improperly transporting the machine can cause it to fall and injure people.

- It is required to:
- Always shut off the motor and remove the battery when loading and transporting.
- Secure the machine to prevent it tilting or slipping.
- Persons may not go near hanging loads, stand under hanging loads, or ride on a hanging load.
- Ensure that no persons will be endangered.
- Only use sufficiently strong and secure loading ramps when loading.
- The machine may swing when suspended.
- Check the contact point (dedicated lifting point) before use for damage and wear. Immediately replace damaged parts.
- Secure the machine against rolling or slipping off and against tipping over.
- When lashing down the machine always use the provided dedicated point or frame.
- This machine includes a front handle 14 that the user can use to manipulate, or slide the machine to desired location.
- If the transport wheels are not in use, use the front handle to properly locate the machine to the exact area you want.

## **To transport the machine or lift it with a crane, do as follows:**

1. Always remove the battery before loading and transporting.
2. Make sure that the motor has cooled.
3. Lock the handle.
4. Attach the crane hooks 23 to the dedicated lifting point 13 .
5. Load the machine onto the transport vehicle.
6. Remove the crane hooks from the dedicated lifting point.
7. Secure the machine to the transport lugs with straps and load it correctly.
8. At the destination, remove the straps.
9. Attach the crane hooks to the dedicated lifting point.
10. Lift the machine off the transport vehicle.
11. Place the machine on a level floor and prepare it for operation.

## **MAINTENANCE**

Your power tool has been designed to operate over a long period of time with a minimum of maintenance. Continuous satisfactory operation depends upon proper tool care and regular cleaning.

**WARNING:** To reduce the risk of serious personal injury, turn tool off and disconnect battery pack before making any adjustments or removing/installing attachments or accessories. An accidental start-up can cause injury.

The charger and battery pack are not serviceable.

**DANGER:** Injury or death hazard due to malfunction. Improper machine maintenance or ignoring a problem before commissioning can cause severe malfunctions.

Proceed according to the maintenance recommendations and maintenance schedules in the operating manual.

- Heed the safety regulations!
- Perform maintenance only with the machine turned off and the battery removed.
- Clean the machine with a clean, dry cloth before starting maintenance.
- Place the machine on level ground and secure it against sliding or rolling away.
- Ensure that all replaced parts are recycled in a safe, environmentally friendly way.
- Prevent short circuits on machine's conductive cables.

- Never spray electrical components with a high-pressure water jet.
- After cleaning the machine with a clean, dry cloth, blow the components dry with compressed air to prevent leakage currents.

## **Maintenance and Repair Work**

Proper maintenance, inspection and adjustment are important parts of the machine's safety concept. If these tasks are not performed properly, there is great risk of injury due to nonfunctional safety equipment. Therefore, heed the following points:

- Adhere to the maintenance, inspection and adjustment tasks and intervals specified in the Maintenance Chart, located at the end of each language section.
- Maintenance is to be done only by qualified, authorised personnel.
- Use only original replacement parts.
- Only use suitable and technically faultless lifting equipment and load suspending devices with sufficient lifting capacities when replacing larger assemblies and specific parts. Attach and secure parts carefully to the lifting equipment! Falling parts may severely injure people.
- Please refer to the back page of this manual for service center contact information, or visit [www.2helpu.com](http://www.2helpu.com).

## **Storage**

When shutting down the machine for an extended time (longer than 6 weeks), it should be placed on even, firm stable ground on a pallet to prevent the bottom base of the machine from rusting.

- Remove the battery from the machine.
- The storage location should be dry, protected and have low air humidity.
- The ambient temperature should be between 0 °C and 30 °C and be subject to no strong temperature deviations.
- Clean thoroughly with a clean, dry cloth.
- Check for leaks and damage. Contact an authorised service center to repair any defects found.
- Cover with a protective tarp.

## Returning the Machine to Use

Before returning the machine to use, check the machine for:

- leaks,
- defects or,
- other damage.
  1. Contact an authorised service center to repair any defects found.
  2. Check and retighten all screws, nuts and bolts.

## Cleaning

- **WARNING:** Electrical shock and mechanical hazard. Remove the battery before cleaning.
- **WARNING:** To ensure safe and efficient operation, always keep the machine and the ventilation slots clean.
- **WARNING:** Never use solvents or other harsh chemicals for cleaning the non-metallic parts of the tool. These chemicals may weaken the materials used in these parts. Use a clean, dry cloth. Never let any liquid get inside the tool; never immerse any part of the tool into a liquid.
- **WARNING:** Never clean the machine with the motor running.
- **WARNING:** DO NOT allow water to splash onto the battery rail and terminal block area. Wipe all battery interface components dry.
- **WARNING:** When using a water hose, do not aim the water towards electrical parts and cover these in advance.
- **WARNING:** Risk of fire and explosion caused by inflammable substances. For cleaning, do not use any flammable or aggressive materials.
- **NOTICE:** Damage hazard to the machine from high pressure water.

Ventilation slots can be cleaned using a dry, soft non-metallic brush and/or a suitable vacuum cleaner. Do not use water or any cleaning solutions. Wear approved eye protection and an approved dust mask.

**IMPORTANT:** Clean the machine daily.

1. Remove the battery.



2. Install the transportation cap on the battery.
3. Protect the battery terminals from water.
4. Wipe the machine dry with a clean, dry cloth.
5. Dry any damp spots on the machine that may have occurred during cleaning.
6. After cleaning, check the cables, wires and screw joints for leaks, loose connections, chafe marks and other damage and for contamination of the battery terminals and M19 connector.

Eliminate any problems immediately.

### **Checking the Motor for Damage**

**WARNING:** Injury hazard from damage or defects on the motor. Damage and defects on the motor are hazard sources. A damaged machine motor can injure the machine operator or bystanders.

Before every start-up, visually inspect for damage. If damage is located and identified, never operate the machine.

Replace defective components.

#### **To check the motor for damage, do as follows:**

1. Inspect:
  - Motor cover.
  - All visible wires and cables.
2. Do a visual inspection. Contact an authorised service centre to repair any defects found.

### **Checking the Vents**

Check air vents and outlet openings for coarse contamination, such as leaves, heavy dust deposits, etc., and clean if necessary.

### **Checking the Connented Joints**

With vibrating devices it is always important to check the screws, nuts, and bolts for tightness at regular intervals.

For that, do as follows:

1. Check all screws, nuts, and bolts for firm seating.
2. Retighten the screws, nuts, and bolts, if necessary.

### Inspect the Rubber Bushes (Fig. Q)

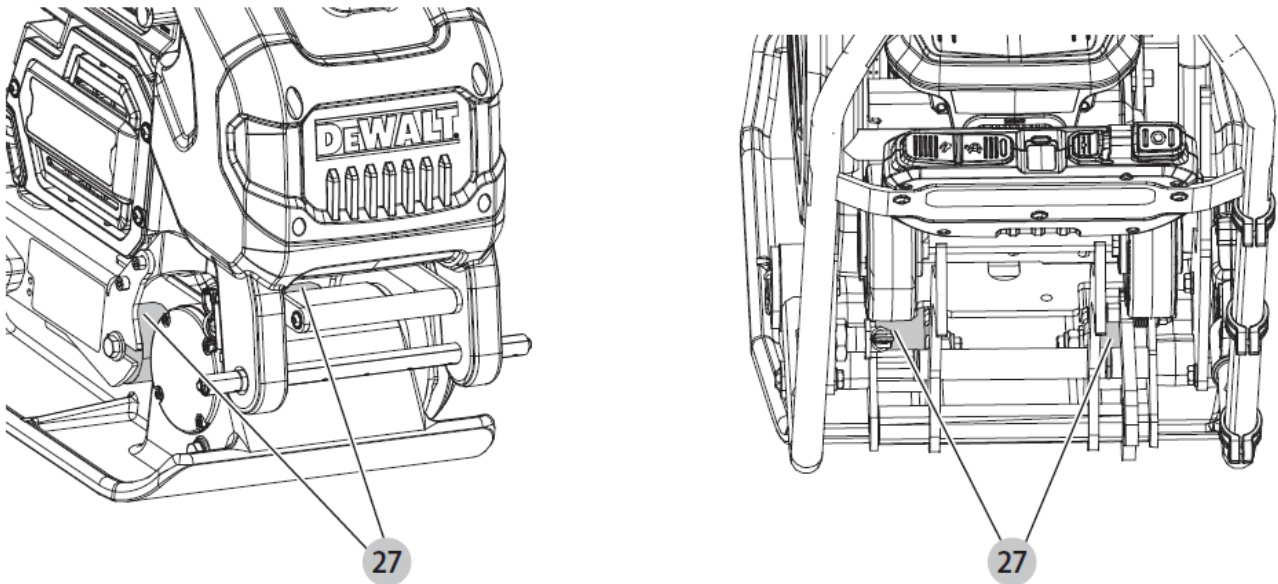

There are four rubber bushes 27 , two in the front, and two in the rear, between the chassis and the base plate that serve to dampen vibrations.

Check the rubber bushes, as follows.

1. Check the rubber bushes for:
  - Cracks and ruptures.
  - Firm seating.
2. Replace damaged rubber bushes immediately.

### V-belt

- **WARNING:** Injury hazard from rotating parts. Crushing injuries can occur with an open-running belt drive. Perform inspection and maintenance tasks only with the motor turned off. Do not operate the machine without the V-belt guard.
- **WARNING:** Injury hazard from hot surfaces (pulleys, fastenings and V-Belt). Allow the machine to cool down first before beginning any maintenance. Users must wear gloves to perform any required maintenance.

### Inspect the V-belt (Fig. R, S)

To check the V-belt, do as follows:

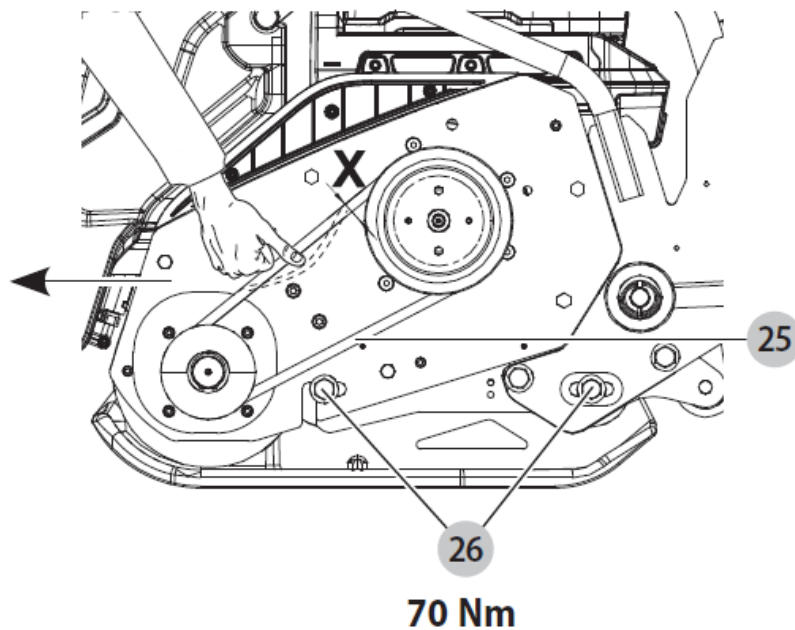
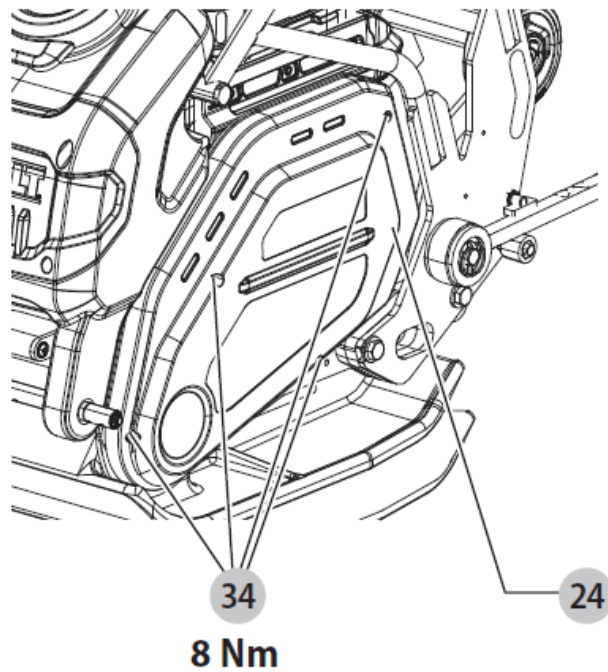

1. Shut off the motor and allow the machine to cool down.
2. Remove the battery.
3. Remove the V-belt guard 24 .
4. Check the condition of the V-belt 25 , and replace it if damage is visible.
5. Check the V-belt tension, and tighten if necessary.
6. Reinstall the V-belt guard.

### **Tightening the V-belt (Fig. R, S)**

1. Shut off the motor and allow the machine to cool down.
2. Remove the battery.
3. Remove the four V-belt guard screws 34 . Remove the V-belt guard.
4. Loosen the external fastening bolts 26 of the rubber buffers.
5. Tighten the V-belt by sliding the V-belt frame rearward.
6. Push-through dimension X = approx. 10 mm.
7. Make sure the buffers' pretension is even.
8. Tighten the external fastening bolts 26 of the rubber buffers.
9. Reinstall the belt guard.

**IMPORTANT:** Ensure all four V-belt guard screws 34 are firmly tightened. **DO NOT** use the machine if any of the four screws are missing. Contact an authorised service centre if one or more screws are missing, or it is not possible to firmly tighten them.

### **Maintenance Chart**

Maintenance	Every day	After 20 hours of use	After 100 hours of use
Clean the machine.	<b>X</b>		
Visually check the wire harness.	<b>X</b>		
Visually check the battery rail system and terminal block.	<b>X</b>		
Visually check all rubber elements.	<b>X</b>		
Visually check the V-belt tension and tighten if required.			<b>X</b>
Check all screw joints for firm seating.		<b>X</b>	<b>X</b>

### **Protecting the Environment**



Products/batteries are recyclable, but if marked with the crossed-out bin, they must not be disposed of with normal household waste.

Run the batteries down completely and separate them, and separate any light sources from the product if possible. It is the user's responsibility to delete personal data from the product. Then take the waste to an official waste collection center or a participating retailer who will often accept it free of charge. Packaging should be discarded based on the marked material code. Operating and safety instructions should only be discarded once the applicable product is no longer in use.

Please check with your local community/municipality for waste management guidance. For further information, visit [www.2helpU.com](http://www.2helpU.com) and scan the above QR code.

## United Kingdom

- DeWALT, Meadow field Avenue
- Spennymoor, DL16 6YJ, England
- Tel: 01753-567055
- Fax: 01753-572112
- [www.dewalt.co.uk](http://www.dewalt.co.uk)
- [emeaservice@sbdinc.com](mailto:emeaservice@sbdinc.com)
- [WWW.DEWALT.com](http://WWW.DEWALT.com)

## Frequently Asked Questions

- **Q: Can I use batteries other than DEWALT batteries with this product?**

A: No, it is recommended to only use DEWALT batteries for safety and performance reasons.

- **Q: How do I adjust the speed of the machine?**

A: You can control the speed of the machine by using the speed control button located on the device.

- **Q: What should I do in case of a safety warning?**

A: If a safety warning appears, stop using the machine immediately and refer to the

user manual for guidance.

## Documents / Resources

	<a href="#">DEWALT DCPS7154 Powershift Plate Compactor [pdf]</a> Instruction Manual DCPS7154, DCBPS0554, DCB546, DCB547-G, DCB548, DCB549, DCP S7154 Powershift Plate Compactor, DCPS7154, Powershift Plate Compa ctor, Plate Compactor, Compactor
---	---

## References

- [2helpU](#)
- [Power Tools | Storage | Landscaping | DEWALT](#)
- [Elektrowerkzeuge | Aufbewahrung | Landschaftsbau | DEWALT Deutschland](#)
- [Power Tools | Storage | Landscaping | DEWALT](#)
- [Power Tools | Storage | Landscaping | DEWALT](#)
- [Sähkötyökalut | Säilytys | Maisemointi | DEWALT SUOMI](#)
- [User Manual](#)

■ Dewalt

COMPACTOR, DCB546, DCB547-G, DCB548, DCB549, DCBPS0554, DCPS7154, DCPS7154 Powershift Plate Compactor, DEWALT, Plate Compactor, Powershift Plate Compactor

—Previous Post

**DEWALT D-CLIP Wire Component User Guide**

Next Post—

**DEWALT DWHT66719 Cordless Screwdriver Instruction Manual**

---

## Leave a comment

Your email address will not be published. Required fields are marked \*

Comment \*

Name

Email

Website

☐ Save my name, email, and website in this browser for the next time I comment.

Post Comment

Search:

e.g. whirlpool wrf535swhz

Search

[Manuals+](#) | [Upload](#) | [Deep Search](#) | [Privacy Policy](#) | [@manuals.plus](#) | [YouTube](#)

This website is an independent publication and is neither affiliated with nor endorsed by any of the trademark owners. The "Bluetooth®" word mark and logos are registered trademarks owned by Bluetooth SIG, Inc. The "Wi-Fi®" word mark and logos are registered trademarks owned by the Wi-Fi Alliance. Any use of these marks on this website does not imply any affiliation with or endorsement.