

DEWALT
DCPS7154
Forward
Plate
Compactor



DEWALT DCPS7154 Forward Plate Compactor Instruction Manual

[Home](#) » [Dewalt](#) » DEWALT DCPS7154 Forward Plate Compactor Instruction Manual 

Contents

- 1 DEWALT DCPS7154 Forward Plate Compactor
- 2 PRODUCT OVERVIEW
- 3 Intended Use
- 4 GENERAL POWER TOOL SAFETY WARNINGS
- 5 Operation
- 6 Additional Safety Information
- 7 Batteries and Chargers
- 8 READ ALL INSTRUCTIONS
- 9 Documents / Resources
 - 9.1 References



DEWALT DCPS7154 Forward Plate Compactor



PRODUCT OVERVIEW

Fig. A

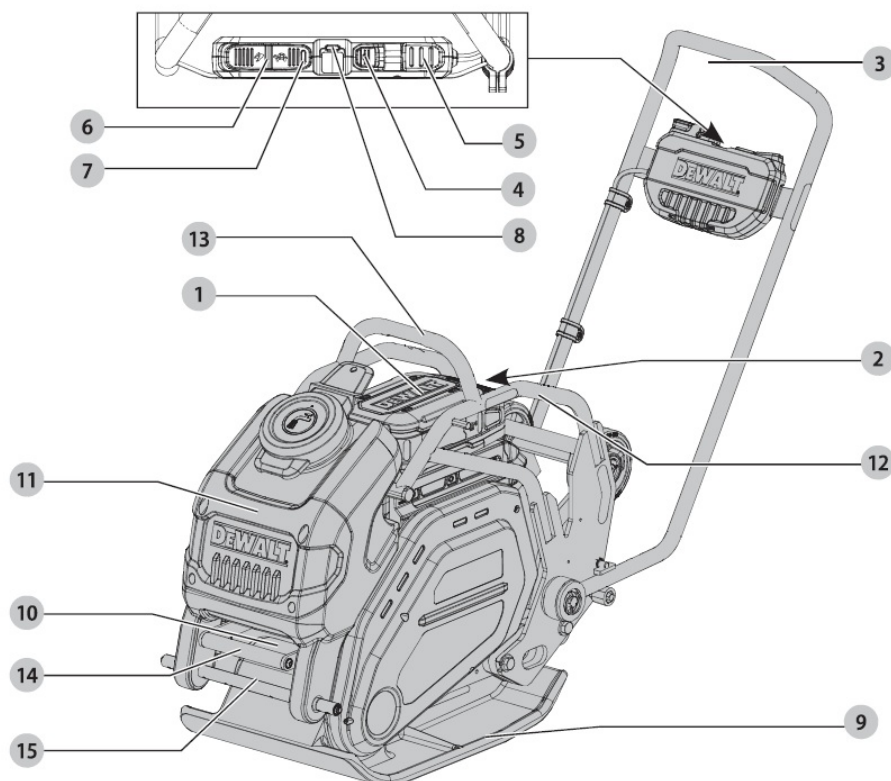

1. Battery
2. Battery release button
3. Handle
4. Dual action activation switch
5. Stop button
6. Speed control
7. Hot motor warning

8. Low-speed indicator
9. Base plate
10. Sealed eccentric
11. 3-gallon removable watertank
12. Durable steel roll cage
13. Central lifting point
14. Front handle
15. Sprinkler tube

WARNING: Read all safety warnings, instructions, illustrations, and specifications in this manual, including the battery and charger sections provided in an original tool manual or the separate Batteries and Chargers manual. Manuals can be obtained by contacting Customer Service as described elsewhere in this manual. Failure to follow the warnings and instructions may result in electric shock, fire and/or serious injury.

Definitions: Safety Alert Symbols and Words

This instruction manual uses the following safety alert symbols and words to alert you to hazardous situations and your risk of personal injury or property damage.

DANGER: Indicates an imminently hazardous situation which, if not avoided, will result in death or serious injury.

WARNING: Indicates a potentially hazardous situation which, if not avoided, could result in death or serious injury.

CAUTION: Indicates a potentially hazardous situation which, if not avoided, may result in minor or moderate injury.

(Used without word) Indicates a safety related message.

NOTICE: Indicates a practice not related to personal injury which, if not avoided, may result in property damage.

Intended Use

This machine is only to be used for:

- Light compaction of sand, gravel, mixed soil, and asphalt (with use of sprinkler system).
- Can also be used on pavers when equipped with the DCPS740 Vulcanized Rubber Mat (sold separately).
- Any other use is unintended and therefore improper. Improper use can threaten the safety of the personnel working with the machine. The manufacturer accepts no liability for resulting damages.

Safe operation of the machine is ensured only by intended use.

DO NOT let children come into contact with the machine. Supervision is required when inexperienced operators use the machine.

Intended use also includes compliance with all information in this manual.

Definitions: Safety Alert Symbols and Words

This instruction manual uses the following safety alert symbols and words to alert you to hazardous situations and your risk of personal injury or property damage.



DANGER: Indicates an imminently hazardous situation which, if not avoided, will result in death or serious injury. A **WARNING:** Indicates a potentially hazardous situation which, if not avoided, could result in death or

serious injury. A **CAUTION:** Indicates a potentially hazardous situation which, if not avoided, may result in minor or moderate injury.

(Used without word) Indicates a safety related message.



NOTICE: Indicates a practice not related to personal injury which, if not avoided, may result in property damage.

GENERAL POWER TOOL SAFETY WARNINGS

WARNING: Read all safety warnings, instructions, illustrations and specifications provided with this power tool. Failure to follow all instructions listed below may result in electric shock, fire and/or serious injury.

SAVE ALL WARNINGS AND INSTRUCTIONS FOR FUTURE REFERENCE.

The term "power tool" in the warnings refers to your mains-operated (corded) power tool or battery-operated (cordless) power tool.

Work Area Safety

- Keep work area clean and well lit. Cluttered or dark areas invite accidents.
- Do not operate power tools in explosive atmospheres, such as in the presence of flammable liquids, gases or dust. Power tools create sparks which may ignite the dust or fumes.
- Keep children and bystanders away while operating a power tool. Distractions can cause you to lose control.

Electrical Safety

- Power tool plugs must match the outlet. Never modify the plug in any way. Do not use any adapter plugs with earthed (grounded) power tools. Unmodified plugs and matching outlets will reduce risk of electric shock.
- Avoid body contact with earthed or grounded surfaces, such as pipes, radiators, ranges and refrigerators. There is an increased risk of electric shock if your body is earthed or grounded.
- Do not expose power tools to rain or wet conditions. Water entering a power tool will increase the risk of electric shock.
- Do not abuse the cord. Never use the cord for carrying, pulling or unplugging the power tool. Keep cord away from heat, oil, sharp edges or moving parts. Damaged or entangled cords increase the risk of electric shock.
- When operating a power tool outdoors, use an extension cord suitable for outdoor use. Use of a cord suitable for outdoor use reduces the risk of electric shock.
- If operating a power tool in a damp location is unavoidable, use a ground fault circuit interrupter (GFCI) protected supply. Use of a GFCI/ reduces the risk of electric shock.

Personal Safety

- Stay alert, watch what you are doing and use common sense when operating a power tool. Do not use a power tool while you are tired or under the influence of drugs, alcohol or medication. A moment of inattention while operating power tools may result in serious personal injury.
- Use personal protective equipment. Always wear eye protection. Protective equipment such as a dust mask, non-skid safety shoes, hard hat, or hearing protection used for appropriate conditions will reduce personal

injuries.

- Prevent unintentional starting. Ensure the switch is in the off position before connecting to power source and/ or battery pack, picking up or carrying the tool. Carrying power tools with your finger on the switch or energizing power tools that have the switch on invites accidents.
- Remove any adjusting key or wrench before turning the power tool on. A wrench or a key left attached to a rotating part of the power tool may result in personal injury.
- Do not overreach. Keep proper footing and balance at all times. This enables better control of the power tool in unexpected situations.
- Dress properly. Do not wear loose clothing or jewelry. Keep your hair, clothing and gloves away from moving parts. Loose clothes, jewelry or long hair can be caught in moving parts.
- If devices are provided for the connection of dust extraction and collection facilities, ensure these are connected and properly used. Use of dust collection can reduce dust-related hazards.
- Do not let familiarity gained from frequent use of tools allow you to become complacent and ignore tool safety principles. A careless action can cause severe injury within a fraction of a second.

Power Tool Use and Care

- Do not force the power tool. Use the correct power tool for your application. The correct power tool will do the job better and safer at the rate for which it was designed.
- Do not use the power tool if the switch does not turn it on and off. Any power tool that cannot be controlled with the switch is dangerous and must be repaired.
- Disconnect the plug from the power source and/or remove the battery pack, if detachable, from the power tool before making any adjustments, changing accessories, or storing power tools. Such preventive safety measures reduce the risk of starting the power tool accidentally.
- Store idle power tools out of the reach of children and do not allow persons unfamiliar with the power tool or these instructions to operate the power tool. Power tools are dangerous in the hands of untrained users.
- Maintain power tools and accessories. Check for misalignment or binding of moving parts, breakage of parts and any other condition that may affect the power tool's operation. If damaged, have the power tool repaired before use. Many accidents are caused by poorly maintained power tools.
- Keep cutting tools sharp and clean. Properly maintained cutting tools with sharp cutting edges are less likely to bind and are easier to control.
- Use the power tool, accessories and tool bits, etc. in accordance with these instructions, taking into account the working conditions and the work to be performed. Use of the power tool for operations different from those intended could result in a hazardous situation.
- Keep handles and grasping surfaces dry, clean and free from oil and grease. Slippery handles and grasping surfaces do not allow for safe handling and control of the tool in unexpected situations.

Battery Tool Use and Care

- Recharge only with the charger specified by the manufacturer. A charger that is suitable for one type of battery pack may create a risk of fire when used with another battery pack.
- Use power tools only with specifically designated battery packs. Use of any other battery packs may create a risk of injury and fire.
- When battery pack is not in use, keep it away from other metal objects, like paper clips, coins, keys, nails,

screws or other small metal objects, that can make a connection from one terminal to another. Shorting the battery terminals together may cause burns or a fire.

- Under abusive conditions, liquid may be ejected from the battery; avoid contact. If contact accidentally occurs, flush with water. If liquid contacts eyes, additionally seek medical help. Liquid ejected from the battery may cause irritation or burns.
- Do not use a battery pack or tool that is damaged or modified. Damaged or modified batteries may exhibit unpredictable behavior resulting in fire, explosion or risk of injury.
- Do not expose a battery pack or tool to fire or excessive temperature. Exposure to fire or temperature above 265 °F (130 °C) may cause explosion.
- Follow all charging instructions and do not charge the battery pack or tool outside the temperature range specified in the instructions. Charging improperly or at temperatures outside the specified range may damage the battery and increase the risk of fire.

Service

- Have your power tool serviced by a qualified repair person using only identical replacement parts. This will ensure that the safety of the power tool is maintained.
- Never service damaged battery packs. Service of battery packs should only be performed by the manufacturer or authorized service providers.

Safety Rules for Plate Compactors Transport

During transport of the machine, there is a crushing hazard from the machine's own weight. Improper handling can crush or severely injure parts of people's body. Therefore, heed the following instructions:

- Always remove the battery before loading and transport.
- Follow the loading and transport instructions in this document.
- Use only suitable transport and lifting equipment with adequate load-bearing capacity!
- Attach suitable slinging equipment to the slinging points provided.
- Secure the machine against tipping over or slipping.
- Never walk or stand under suspended loads. This may pose a death hazard!
- Secure the machine on the transport vehicle against rolling, sliding or tipping over.
- Remove the battery before loading and stow it securely.

Operation

During the machine's operation, various residual hazards exist that are caused by the purpose of the machine's use and cannot be eliminated by design. Therefore, heed the following instructions:

Before Starting

- Wear personal safety equipment (eye protection, safety shoes, hearing protection, etc.).
- Become familiar with the operation and control elements and the manner of working with the machine.
- Check that all of the safety devices are securely installed in place.
- Never start the machine with defective instruments or controls. This may cause injury!
- Examine your work environment and prepare it for the work. This includes, among other things:

- Removing obstacles in the work area.
- Checking the ground's load capacity.
- Providing necessary safeguards.
- The points listed here are frequently occurring activities in relation to the machine's area of application. This list is not complete, and depends on the specific work environment. Always adapt it to your own work environment.

Starting

- It is forbidden to start and operate the machine in a potentially explosive environment! Power tools create sparks which may ignite dust or fumes.
- Abide by the switching-on and switching-off procedures and that the control displays are as per the operating manual.

Additional Safety Information

WARNING:

- Never modify the power tool or any part of it. Damage or personal injury could result.
- ALWAYS use safety glasses. Everyday eyeglasses are NOT safety glasses. Also use face or dust mask if operation is dusty.

ALWAYS WEAR CERTIFIED SAFETY EQUIPMENT:

- ANSI 187.1 eye protection (CAN/CSA 194.3),
- ANSI S/2.6 (SJ.19) hearing protection,
- NIOSH/OSHNMSHA respiratory protection.

WARNING: Some dust created by power sanding, sawing, grinding, drilling, and other construction activities contains chemicals known to the State of California to cause cancer, birth defects or other reproductive harm. Some examples of these chemicals are:

- lead from lead-based paints,
- crystalline silica from bricks and cement and other masonry products, and
- arsenic and chromium from chemically treated lumber. Your risk from these exposures varies, depending on how often you do this type of work. To reduce your exposure to these chemicals: work in a well ventilated area, and work with approved safety equipment, such as those dust masks that are specially designed to filter out microscopic particles.
- Wear protective clothing and wash exposed areas with soap and water. Allowing dust to get into your mouth, eyes, or lay on the skin may promote absorption of harmful chemicals. Direct particles away from face and body.

WARNING: Always wear proper personal hearing protection that conforms to ANSI S 7 2.6 (53. 7 9) during use. Under some conditions and duration of use, noise from this product may contribute to hearing loss.















- Air vents often cover moving parts and should be avoided. Loose clothes, Jewelry or long hair can be caught in

moving parts. Always avoid wearing Jewelry or loose fitting clothes that may snag on the controls or moving parts as this can cause serious injury.

CAUTION: When not in use, place the machine on on a stable surface where it will not cause a hazard. Refer to Parking the Machine.

- The machine is heavy. Transportation is allowed ONLY by crane. NEVER use a forklift, or try to lifft by hand
- Users are required to wear proper eye, hearing and foot protection.
- Use only with belt cover properly mounted.
- DO NOT use pressurized water to clean the machine.
- Store the machine indoors only.

The label on your tool may include the following symbols. The symbols and their definitions are as follows:

V	volts		Class II Construction (double insulated)
Hz	hertz		
min	minutes	n_0	no load speed
 or DC	direct current	n	rated speed
	Class I Construction (grounded)	PSI	pounds per square inch
.../min	per minute		earthing terminal
BPM	beats per minute		safety alert symbol
IPM	impacts per minute		visible radiation— do not stare into the light
OPM	oscillations per minute		wear respiratory protection
RPM	revolutions per minute		wear eye protection
sfp _m	surface feet per minute		wear hearing protection
SPM	strokes per minute		read all documentation
A	amperes		do not expose to rain
W	watts		pinching hazard
Wh	watt hours		lifting point
Ah	amp hours		
 or AC	alternating current		
 or AC/DC	alternating or direct current		

WARNING

- **INGESTION HAZARD:** This product contains a button cell or coin battery.
- **DEATH** or serious injury can occur if ingested.
- A swallowed button cell or coin battery can cause **Internal Chemical Burns** in as little as **2 hours**.
- **KEEP** new and used batteries **OUT OF REACH of CHILDREN**.
- **Seek immediate medical attention** if a battery is suspected to be swallowed or inserted inside any part of the body.



Remove and immediately recycle or dispose of used batteries according to local regulations and keep away from children.

Do NOT dispose of batteries in household trash or incinerate.

Even used batteries may cause severe injury or death. Call a local poison control center for treatment information.

Tool Connect™ uses a CR2450 type battery of nominal 3V voltage.

Non-rechargeable batteries are not to be recharged. Do not force discharge, recharge, disassemble, heat above 140 ° F (60 ° C), or incinerate. Doing so may result in injury due to venting, leakage or explosion resulting in chemical burns.

WARNING: Danger of explosion if battery is incorrectly replaced.

Product contains non-replaceable battery except by qualified service center. Do not attempt to replace the coin cell battery yourself.

Batteries and Chargers

The battery pack is not fully charged out of the carton.

Before using the battery pack and charger, read the safety instructions below and then follow charging procedures outlined. When ordering replacement battery packs, be sure to include the catalog number and voltage.

Fig. B

	76–100% charged Chargé de 76–100 % 76–100% cargada
	51–75% charged Chargé de 51–75 % 51–75% cargada
	26–50% charged Chargé de 26–50 % 26–50% cargada
	11–25% charged Chargé de 11–25 % 11–25% cargada
	0–10% charged Chargé de 0–10 % 0–10% cargada

Fig. C

Indicators/Témoin/Indicador			
	Stage 1 Charging Chargement de stade 1 Carga Etapa 1		
	Stage 2 Charging Chargement de stade 2 Carga Etapa 2		
	Fully Charged Bloc-piles Chargé Unidad Cargada		
	Hot/Cold Pack Delay Suspension de Charge Contre le Chaud/Froid Retraso por Unidad Caliente/Fría		

READ ALL INSTRUCTIONS

Important Safety Instructions for All Battery Packs

WARNING: Read all safety warnings, instructions, and cautionary markings for the battery pack, charger and product. Failure to follow the warnings and instructions may result in electric shock, fire and/or serious injury.

- Do not charge or use the battery pack in explosive atmospheres, such as in the presence of flammable liquids, gases or dust. Inserting or removing the battery pack from the charger may ignite the dust or fumes.
- NEVER force the battery pack into the charger. DO NOT modify the battery pack in any way to fit into a non-compatible charger as battery pack may rupture causing serious personal injury. Consult the chart at the end of this manual for compatibility of batteries and chargers.
- Charge the battery packs only in DEWALT chargers.
- DO NOT splash or immerse in water or other liquids.
- DO NOT allow water or any liquid to enter battery pack.
- Do not store or use the tool and battery pack in locations where the temperature may reach or exceed 104 °F (40 °C) (such as outside sheds or metal buildings in summer). For best life store battery packs in a cool,

Fig. D

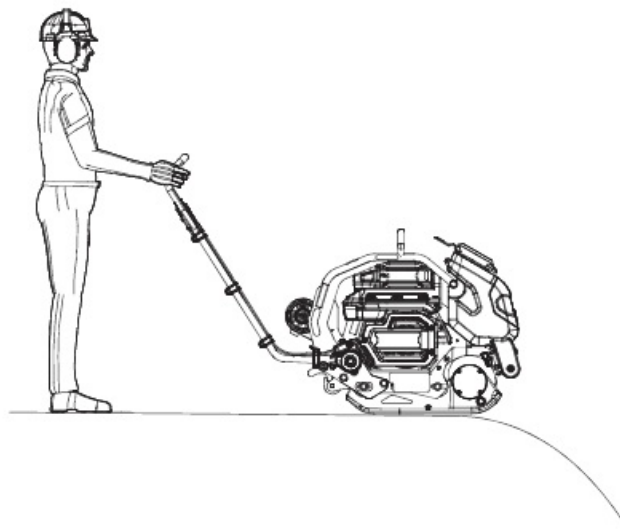

Fig. E

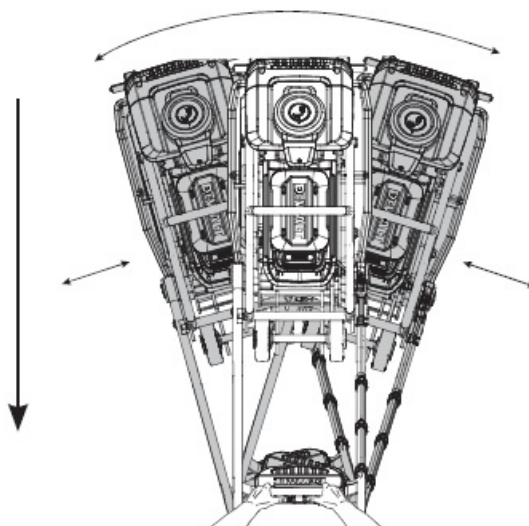

Fig. F

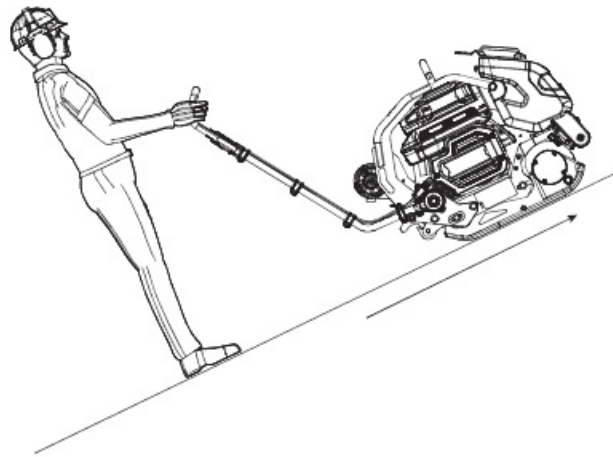

Fig. G

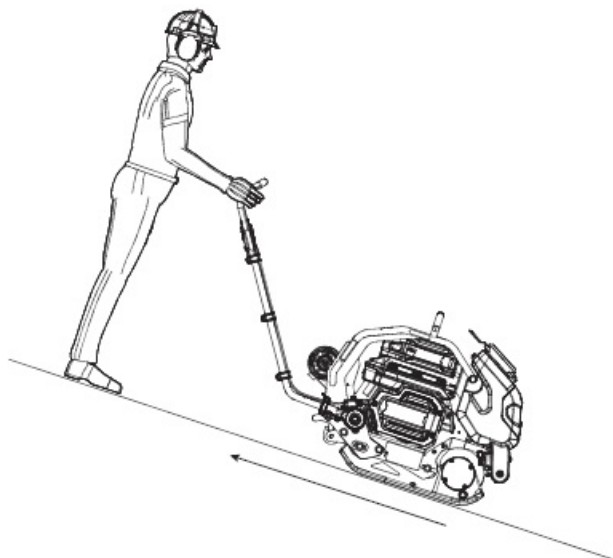

Fig. H

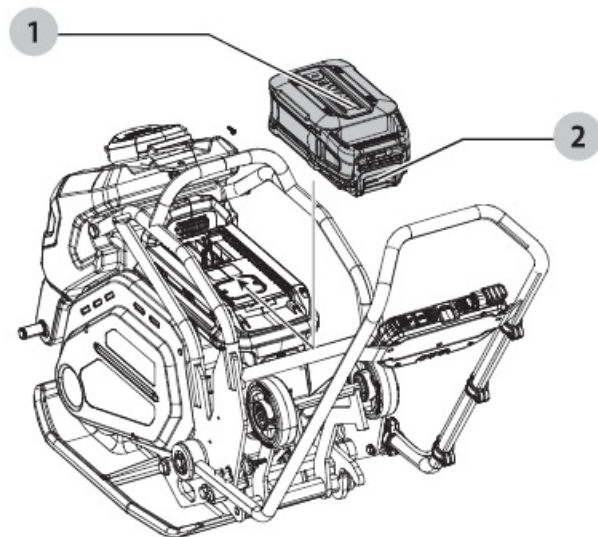

Fig. I

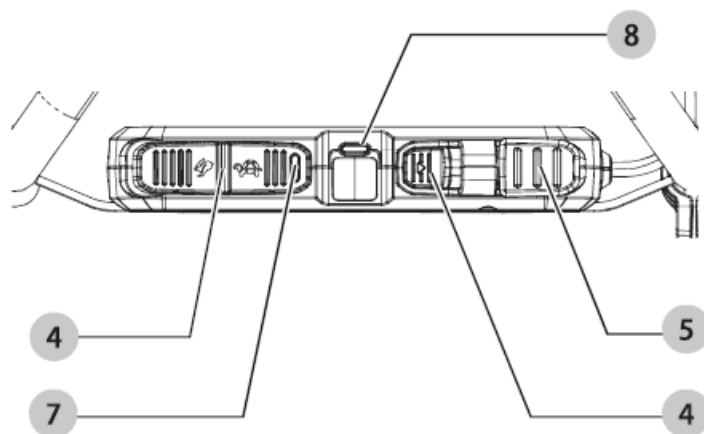

Fig. J

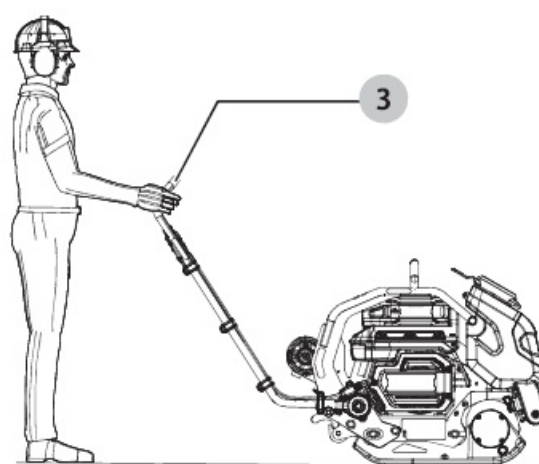

Fig. K

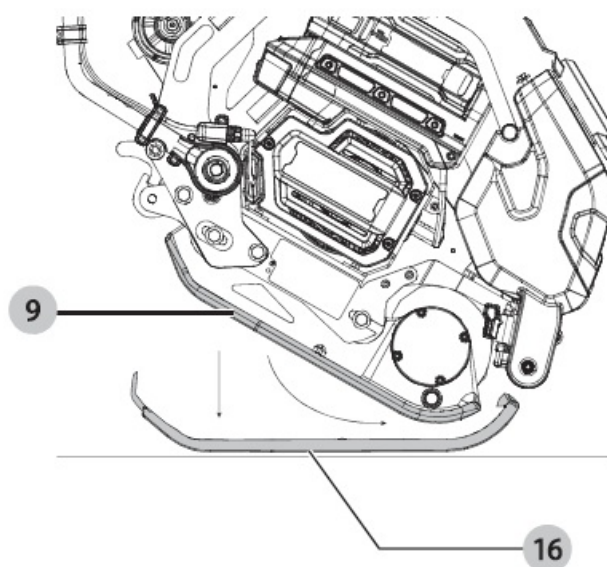

Fig. L

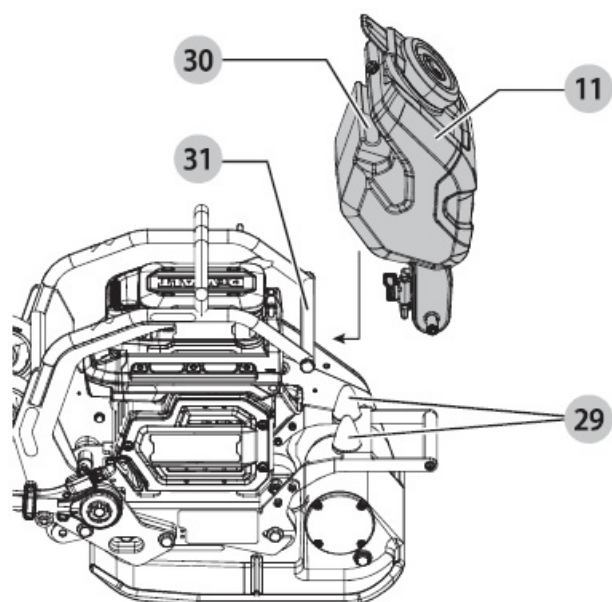

Fig. M

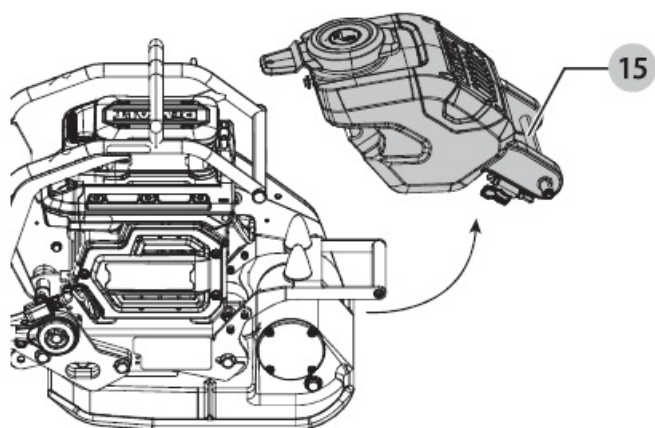

Fig. N

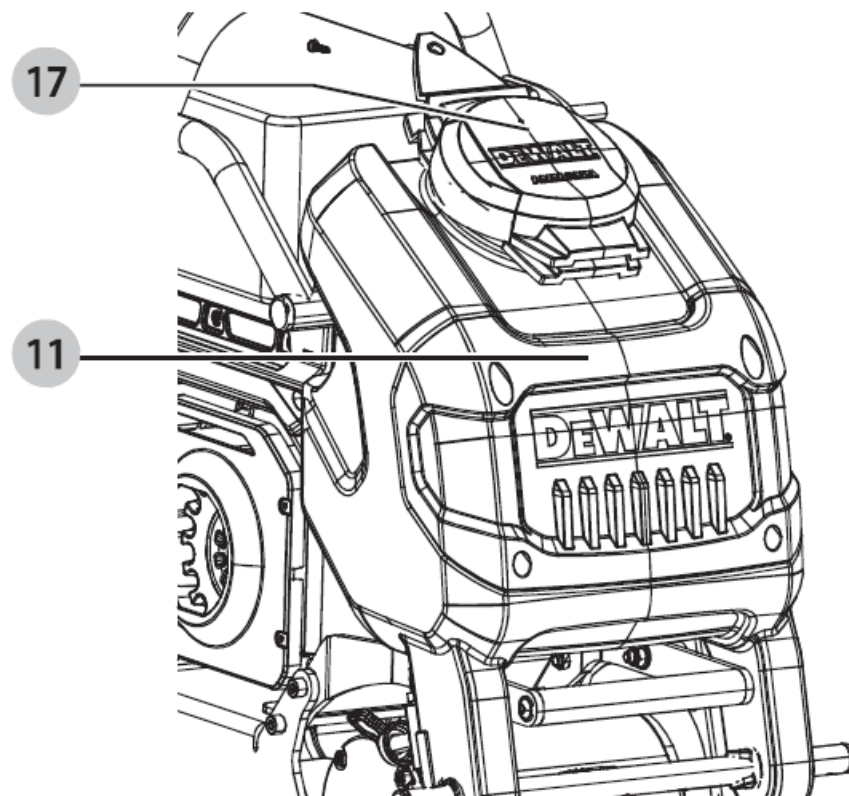

Fig. O

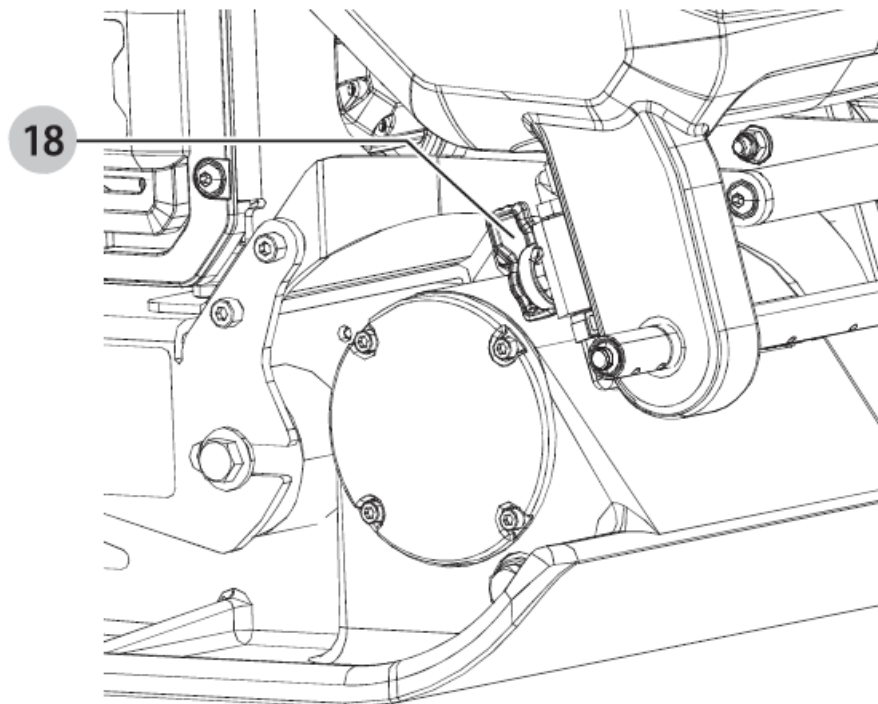

Fig. P

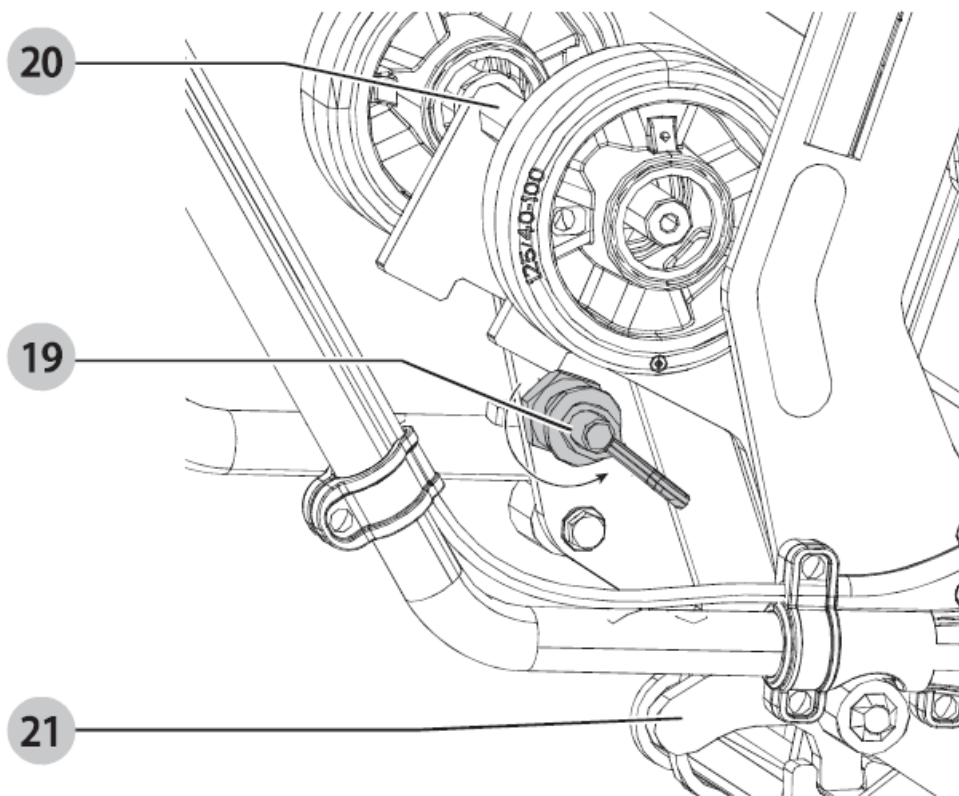

Fig. Q

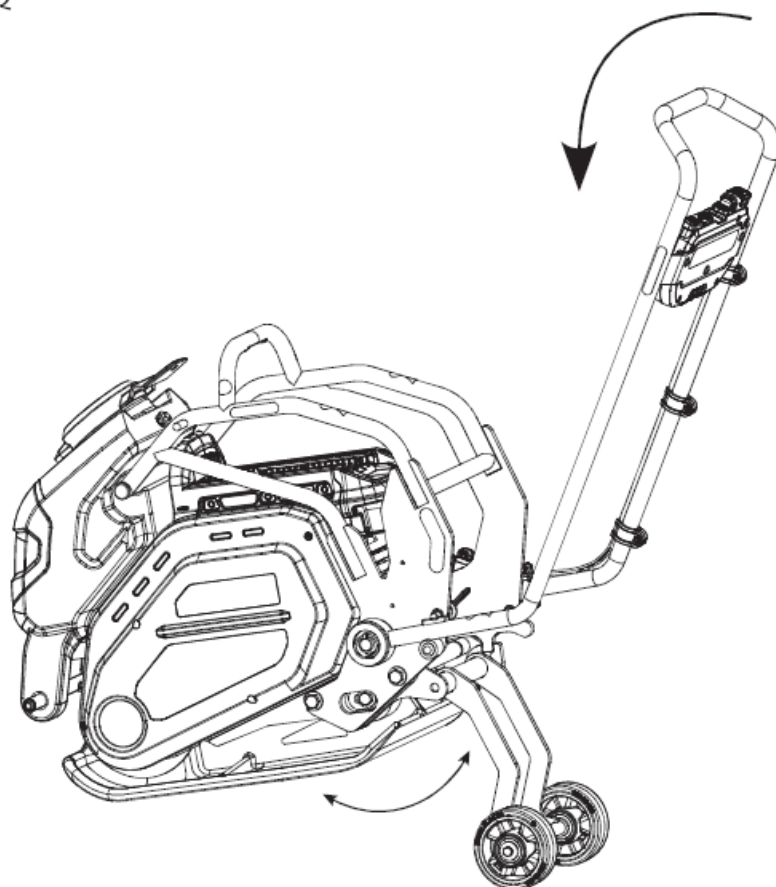

Fig. R

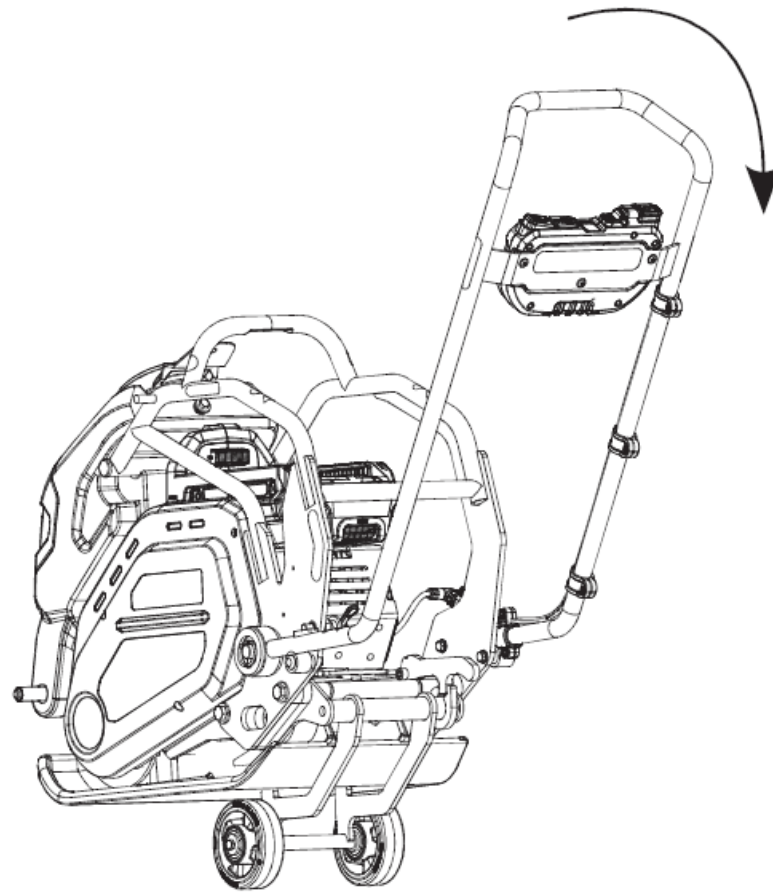

Fig. S

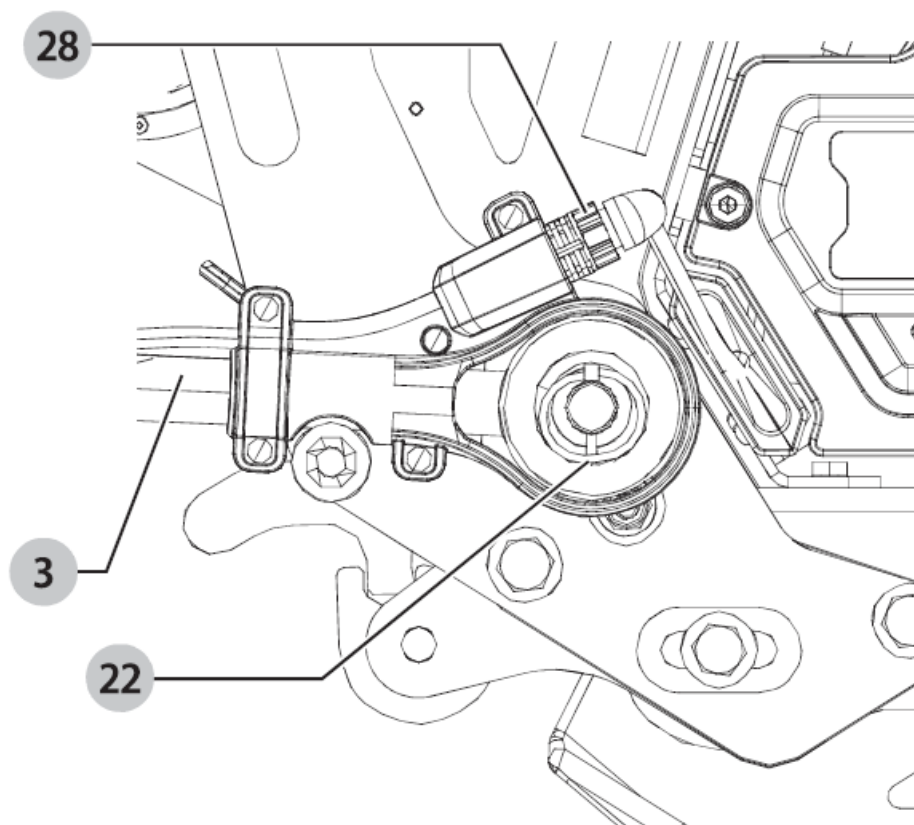

Fig. T

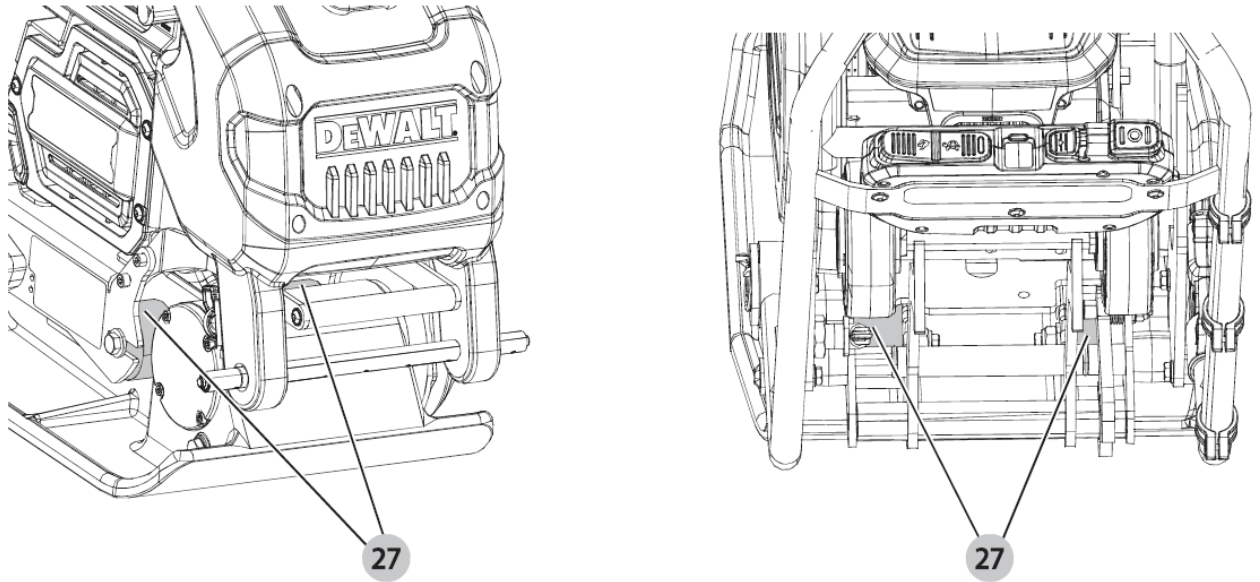

Fig. U

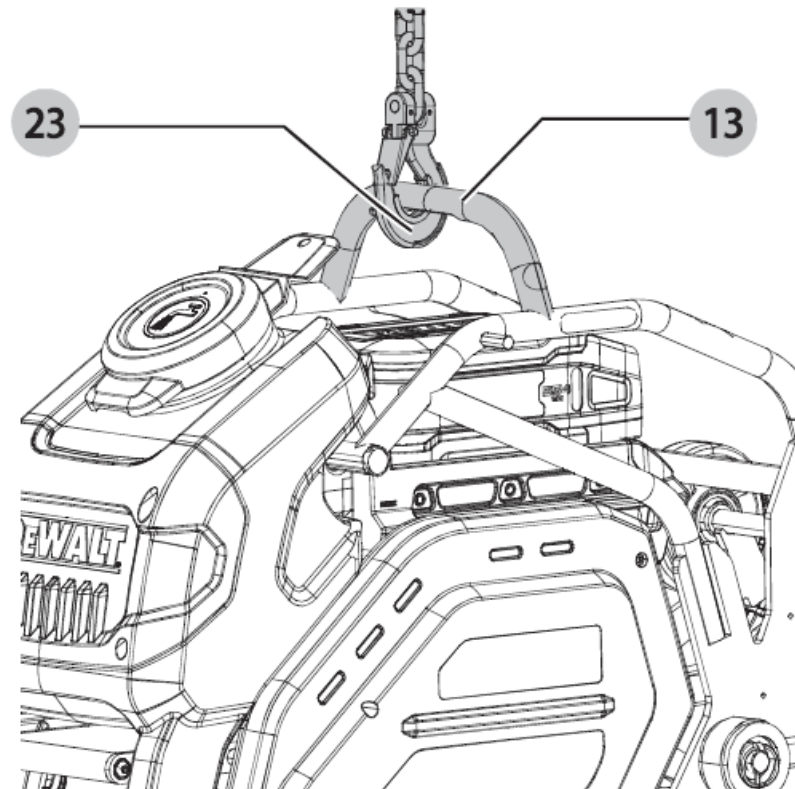

Fig. V

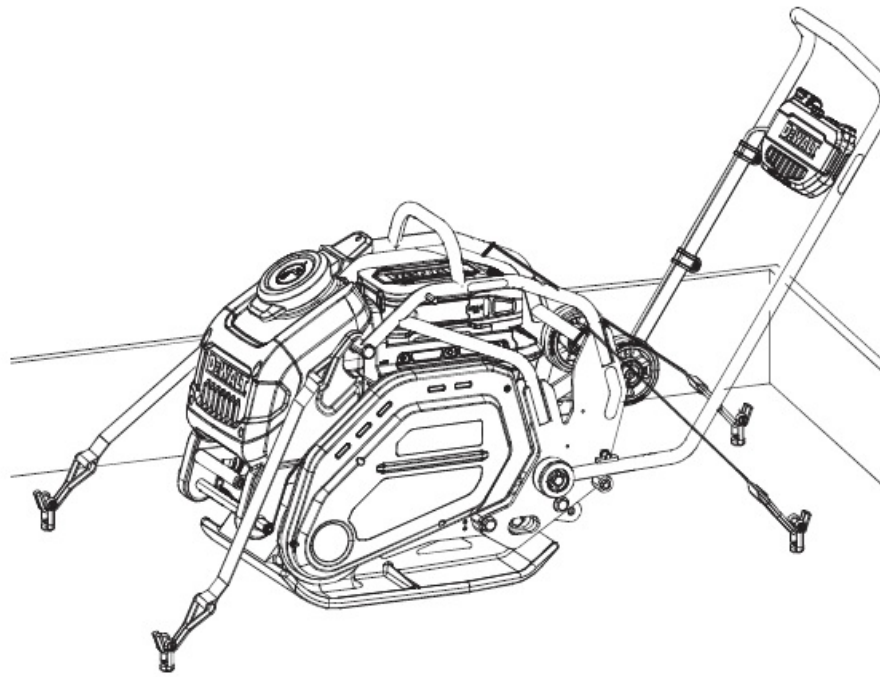

Fig. W

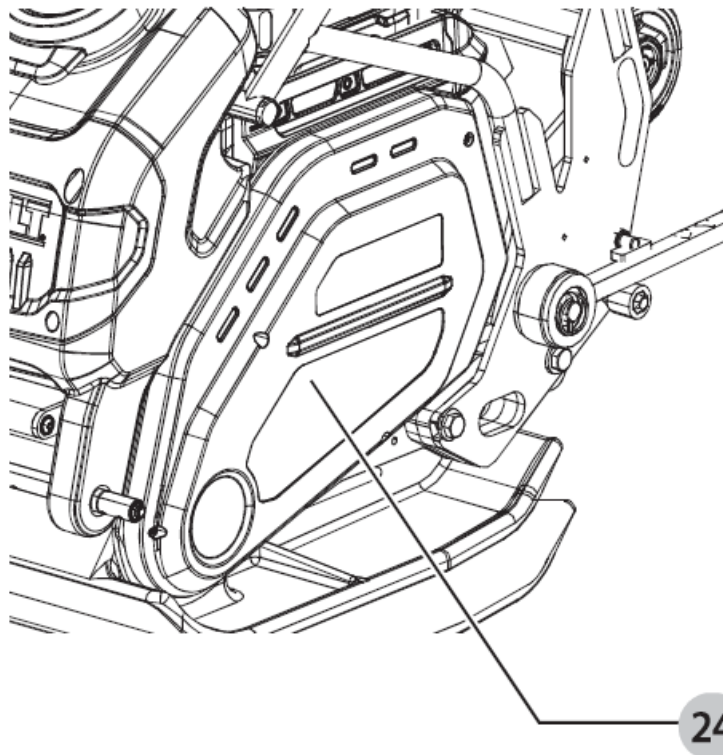
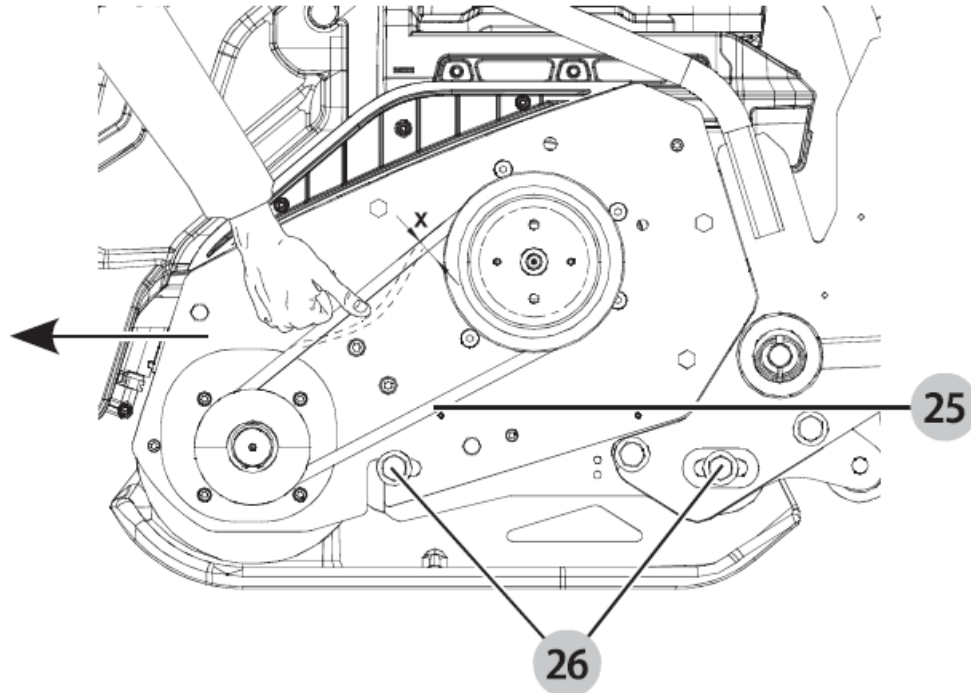

Fig. X



If you have questions or comments, contact us.

www.DEWALT.com

1-800-4-DEWALT

Documents / Resources

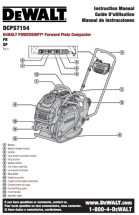
	<p>DEWALT DCPS7154 Forward Plate Compactor [pdf] Instruction Manual YJ7-NA230951, YJ7NA230951, na230951, DCPS7154 Forward Plate Compactor, DCPS7154, Forward Plate Compactor, Plate Compactor, Compactor</p>
---	---

References

- [User Manual](#)

[Manuals+](#), [Privacy Policy](#)

This website is an independent publication and is neither affiliated with nor endorsed by any of the trademark owners. The "Bluetooth®" word mark and logos are registered trademarks owned by Bluetooth SIG, Inc. The "Wi-Fi®" word mark and logos are registered trademarks owned by the Wi-Fi Alliance. Any use of these marks on this website does not imply any affiliation with or endorsement.