



devolo Giga Bridge Connecting ONT and Router Installation Guide

[Home](#) » [devolo](#) » devolo Giga Bridge Connecting ONT and Router Installation Guide 



Installation
devolo Giga Bridge
Connecting ONT and router



Contents

- 1 Giga Bridge Connecting ONT and Router
- 2 Pairing of devolo Giga Bridges
- 3 Telephone cabling
- 4 Support
- 5 Documents / Resources
- 6 Related Posts

Giga Bridge Connecting ONT and Router

Installation videos / Manual

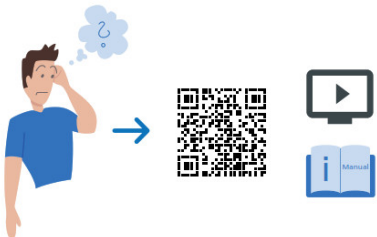
| | |
|---|---|
|  www.devolo.global/giga-bridge-install | <p>Videos with step-by-step installation of the devolo Giga Bridge.</p> <p>Manual for more detailed instructions.</p> |
|---|---|

i The devolo Giga Bridge is intended solely for use on cleared – exclusively available – telephone or coaxial cables. The free availability of the lines without third-party devices must be determined before connecting the devolo Giga Bridge.

Pairing of devolo Giga Bridges

Connect both devolo Giga Bridge adapters to an available power socket. The LEDs of both adapters flash white. Carry out the next installation step within 3 minutes.

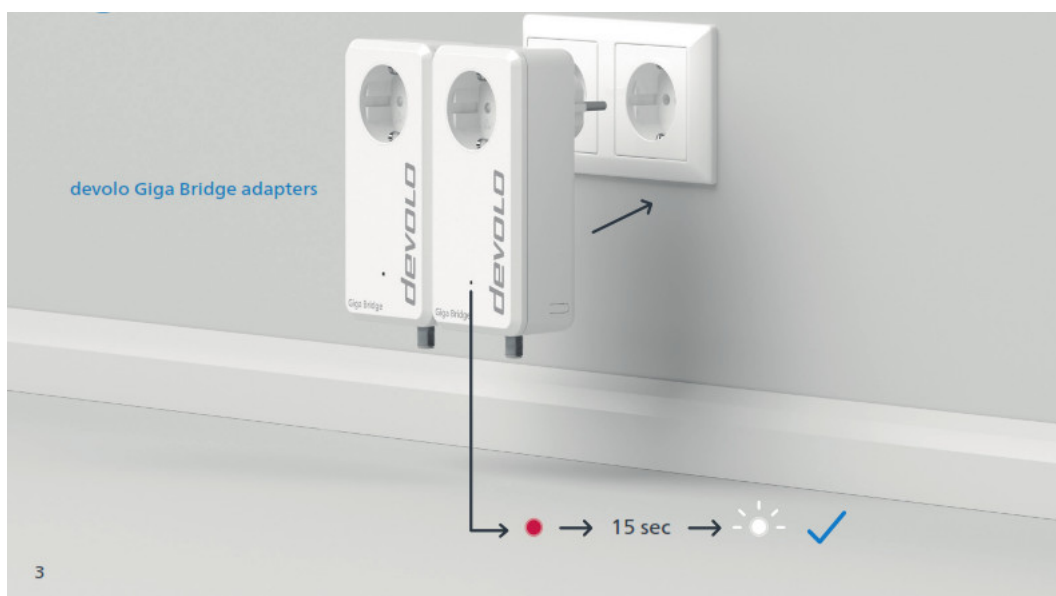

Connect the two devolo Giga Bridge adapters to the phone sockets using the network cable supplied.

A new devolo Giga Bridge network is automatically set up (pairing). When both LEDs light up white continuously, the process is complete and you can remove the network cable again.



The devolo Giga Bridge uses G.hn technology for the transmission of the Internet signal over coaxial (TV/SAT) or telephone line. In scenario “a” (as of p. 9), the G.hn signal is transmitted over two telephone wires or in scenario “b” (as of p. 15) via standard coaxial cable.

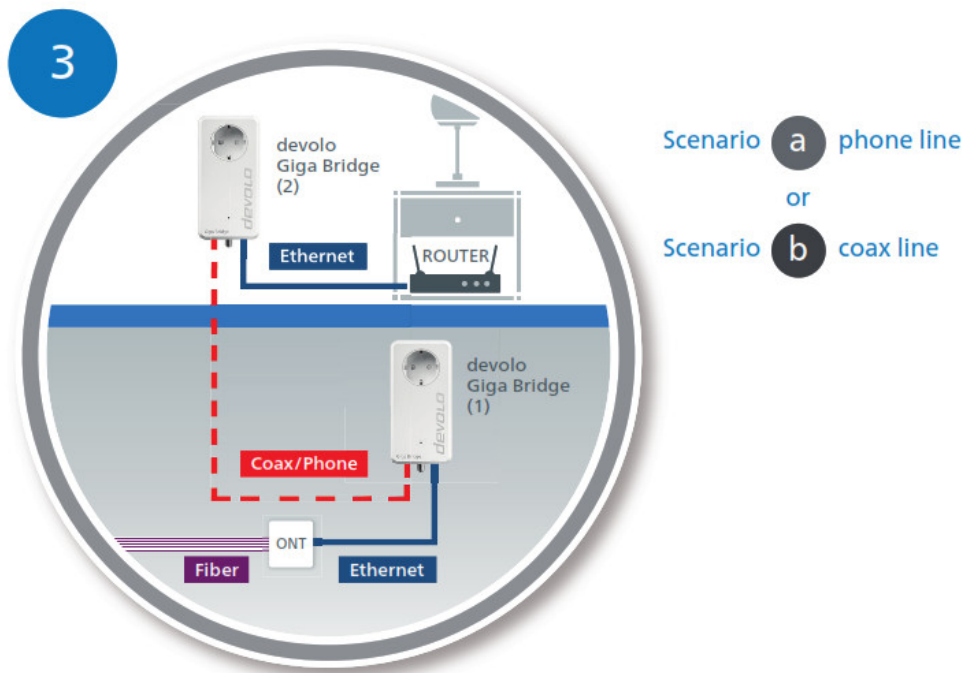

The telephone cable is removed from the demarcation point and then split and secured by means of connection technology involving wire stripping and soldering or screwing down. A standard network interface is created as a result. Note the correct pin assignment: Pin 4/5 for SISO.

3a

Toolless Cat RJ45 termination box

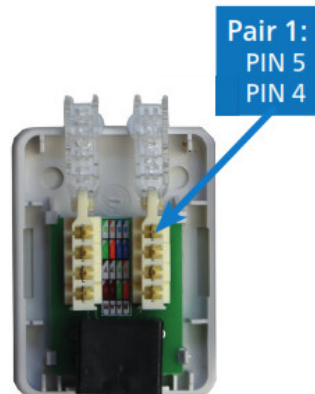

IDC/LSA Cat RJ45 termination box



Telephone cabling

Connect the devolo Giga Bridge adapter to the existing wall connection (CAT RJ 45 box) via the phone socket. Use the provided telephone cable for this purpose. Now connect the devolo Giga Bridge to the NT/ONT-Box using the provided network cable.



Connect the second devolo Giga Bridge adapter to the WAN (Wide Area Network) port of the router using the provided network cable. Now use the telephone cable to connect the devolo Giga Bridge (Phone socket) to the wall connection. Done!



Connect the devolo Giga Bridge adapter to the existing coaxial cabling. To do this, use the provided cable and connect it to the coaxial socket (Coax) of the Giga Bridge. Connect the devolo Giga Bridge to the NT/ONT-Box using the provided network cable.

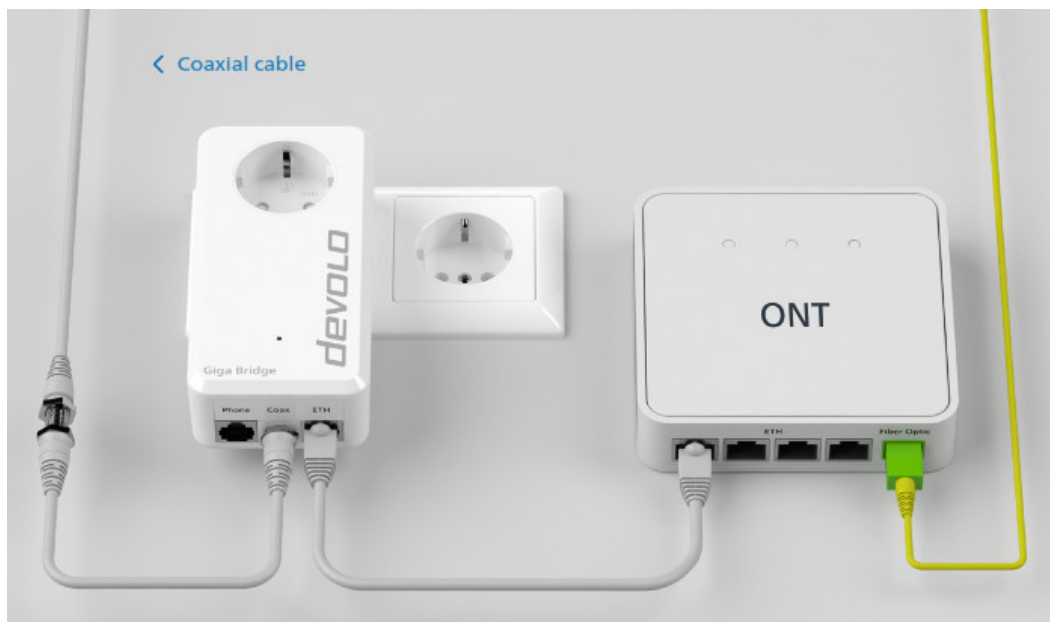

Connect the second devolo Giga Bridge adapter to the WAN (Wide Area Network) port of the router using the provided network cable. Connect the devolo Giga Bridge to an existing connection in the wall via the F-type socket (Coax). Done!

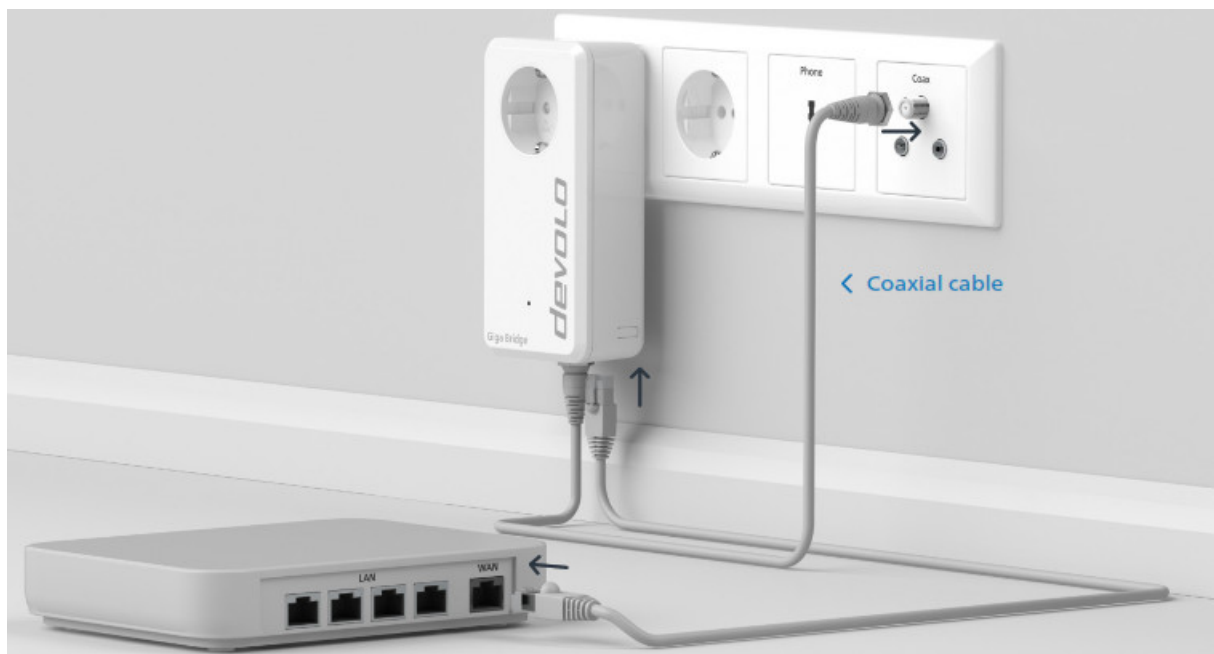

G.hn button

| Duration of the button press | Action | LED behaviour |
|------------------------------|--|---------------|
| 1 second | Start pairing with other devolo Giga Bridge adapters | Flashes white |
| > 10 seconds | Reset devolo adapter to factory settings | Lights up red |

| G.hn LED | The devolo Giga Bridge adapter ... | LED behaviour |
|----------|--|--|
| | ... is working perfectly. It is connected to other devolo Giga Bridge adapters. | Lights up white |
| | ... is currently establishing a pairing connection with another adapter. | Quickly flashes white |
| | ... is not connected to the network* | Slowly flashes white |
| | ... is in standby mode. | Alternately flashes white and red |
| | ... is currently undergoing a software update. | Flashes red |
| | ... has a poor G.hn connection. | Lights up white and then briefly flashes red |
| | ... is currently in the start-up process. ... cannot see any other devolo Giga Bridge adapters. | Lights up red |
| | ... no longer has any LED function since it was disabled by the user. | None |

Support



www.devolo.global/help

Warranty: 3 years

If your devolo device is found to be defective during initial installation or within the warranty period, please contact the vendor who sold you the product. The vendor will take care of the repair or warranty claim for you. The complete warranty conditions can be found at www.devolo.global/warranty.



Giga Bridge

Device 1 password

Device 2 password

devolo AG · Charlottenburger Allee 67 · 52068 Aachen · Germany

www.devolo.global

Documents / Resources



[devolo Giga Bridge Connecting ONT and Router](#) [pdf] Installation Guide

Giga Bridge Connecting ONT and Router, Giga Bridge Connecting ONT, Giga Bridge Router, Router, Connecting ONT Router, Giga Router