



devolo MAGIC 03218 2 Wi-Fi Next Powerline Add-On Installation Guide

[Home](#) » [devolo Magic](#) » devolo MAGIC 03218 2 Wi-Fi Next Powerline Add-On Installation Guide 

devolo MAGIC 03218 2 Wi-Fi Next Powerline Add-On



Contents

1 Download now!

1.1 Notice

2 Information

3 Help: Manual Pairing





4 Limited Warranty: 2 years

5 Support

6 Documents / Resources

7 Related Posts

Download now!

 <p>devoLo Home Network App</p> 	<p>GET IT ON</p>  <p>Google play</p> <hr/>  <p>Download on the App Store</p>	 <p>Available on kindle fire</p>
--	--	---

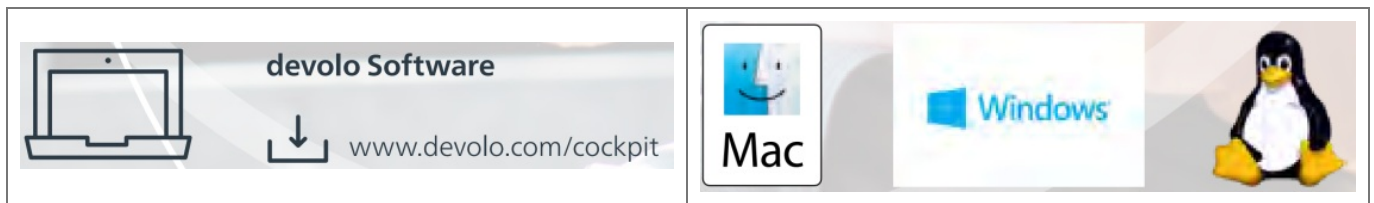

Notice

- Damage to the device from the environment. High temperature fluctuations and moisture can damage both the product and the power line. The device is for indoor use and in dry conditions only.
- Set up, change and monitor: the intuitive devolo Home Network App for controlling devolo Magic adapters.

Information



1

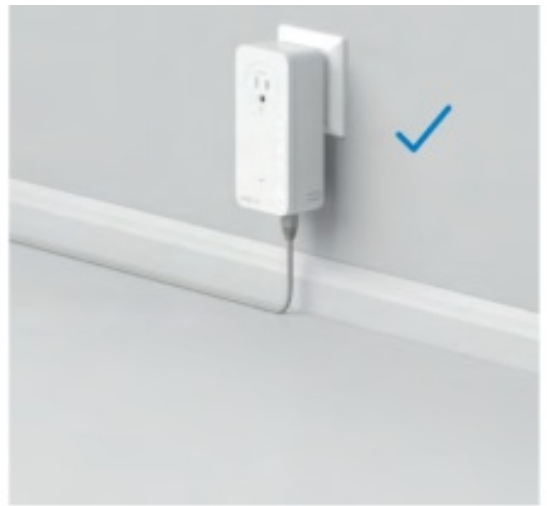
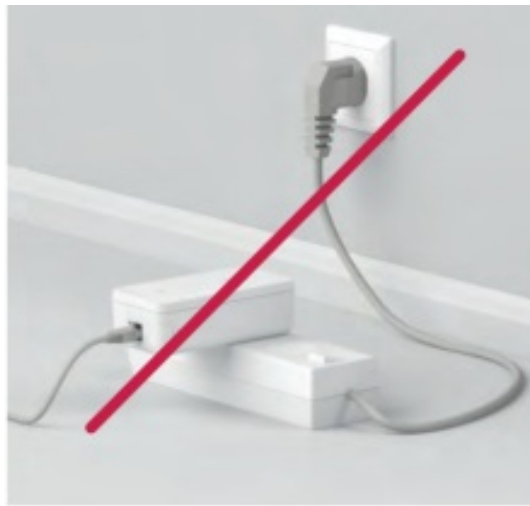

- 1.
2. Write down the Wi-Fi key provided on the back of the devolo Magic adapter.

2



3. Plug the devolo Magic WiFi adapter into an available wall outlet and wait until the LED quickly flashes white (approx. 1 minute).



Within 3 minutes, press the button on the side of your devolo Magic LAN adapter which is connected to the router.



4.

Caution

Tripping hazard from connected network cables. Tripping over the network cable can cause minor injuries and bruises. Lay the network cable with accessibility in mind. Ensure that the power outlet and all connected network devices are easily accessible. Ethernet cable (Cat.5e UTP) not for in-wall use.

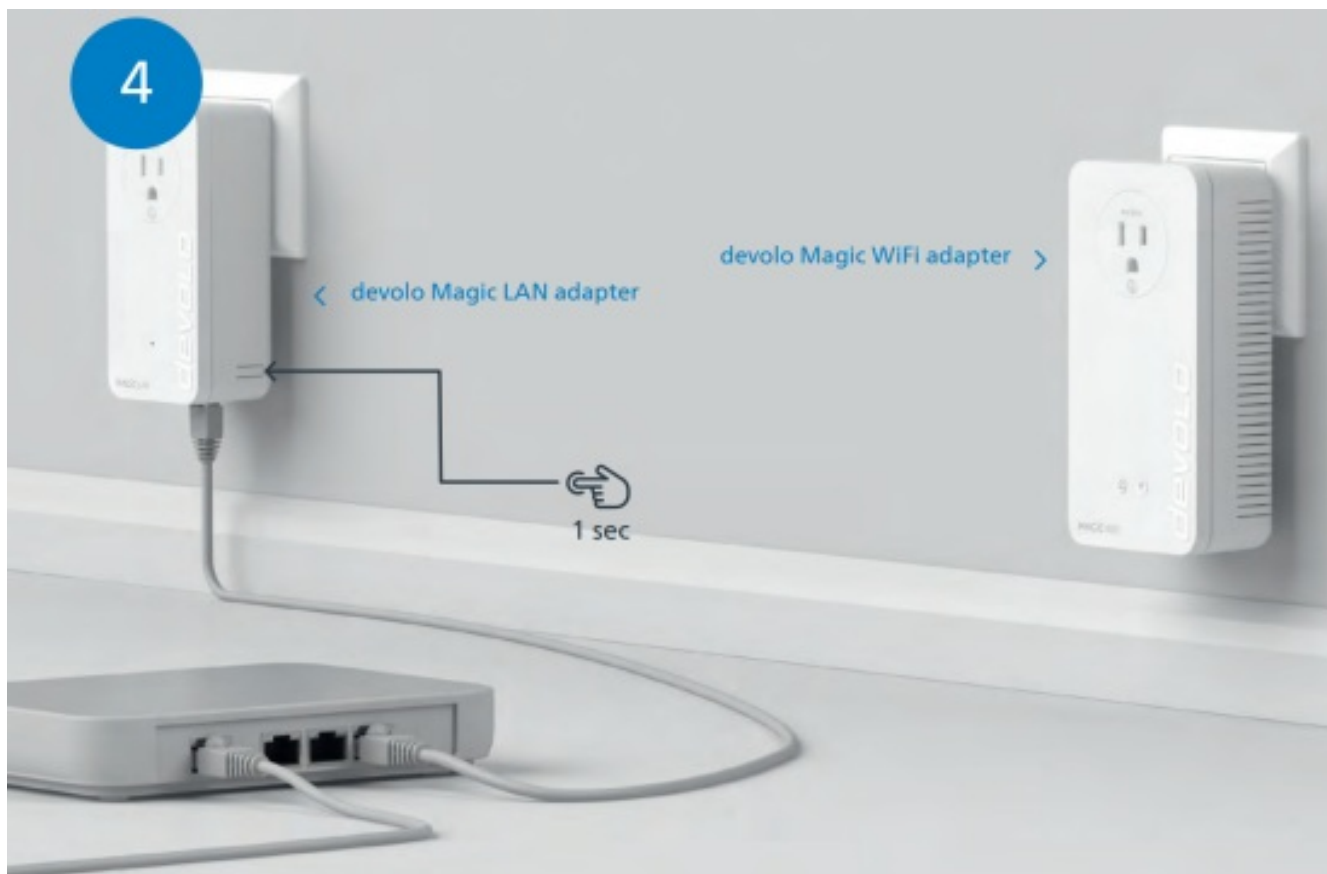

5. The encryption process happens automatically. During this time, the LEDs on both adapters flash white.

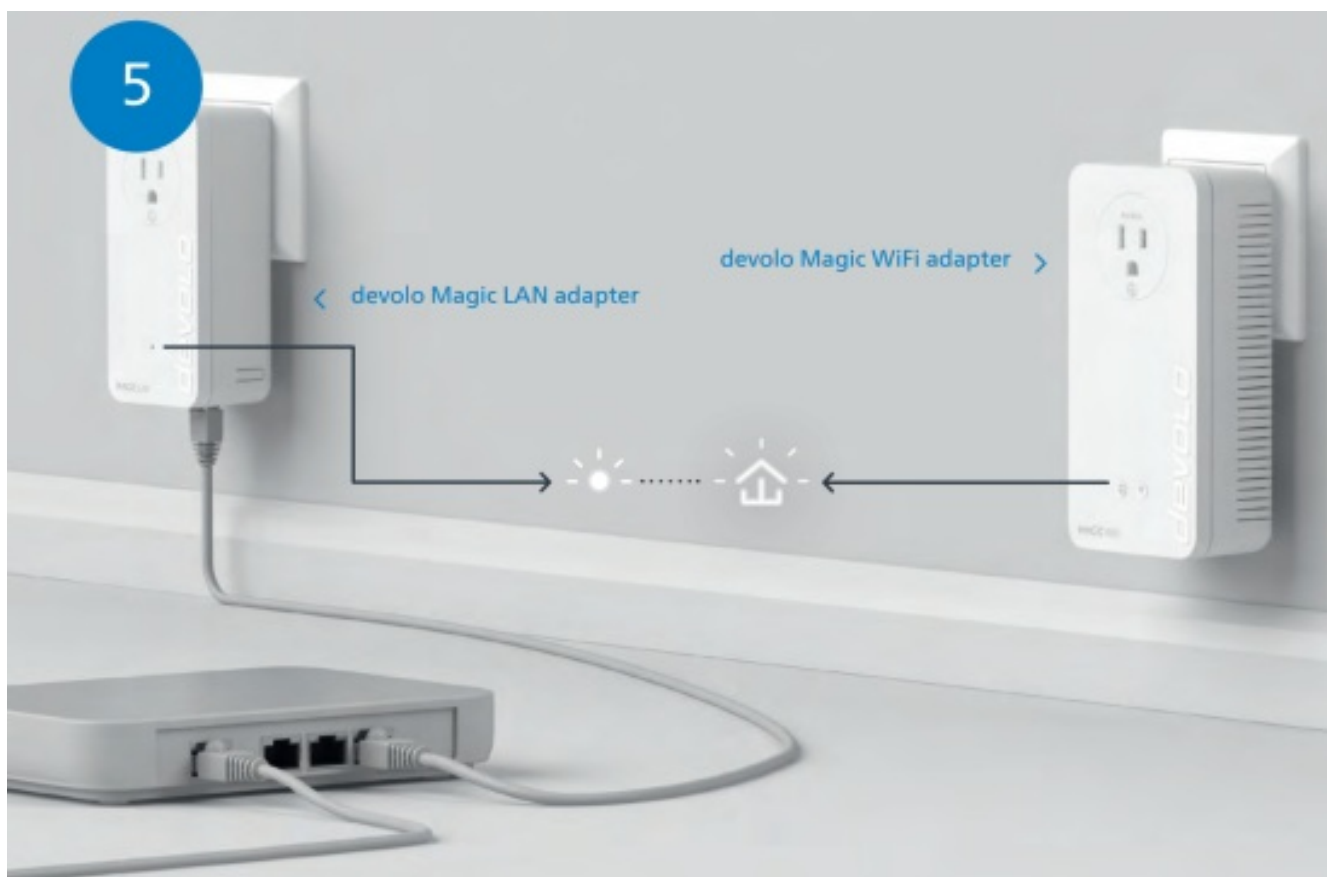

6. The process is finished when the LEDs on all the devices turn solid white. The process takes a maximum of 3 minutes.

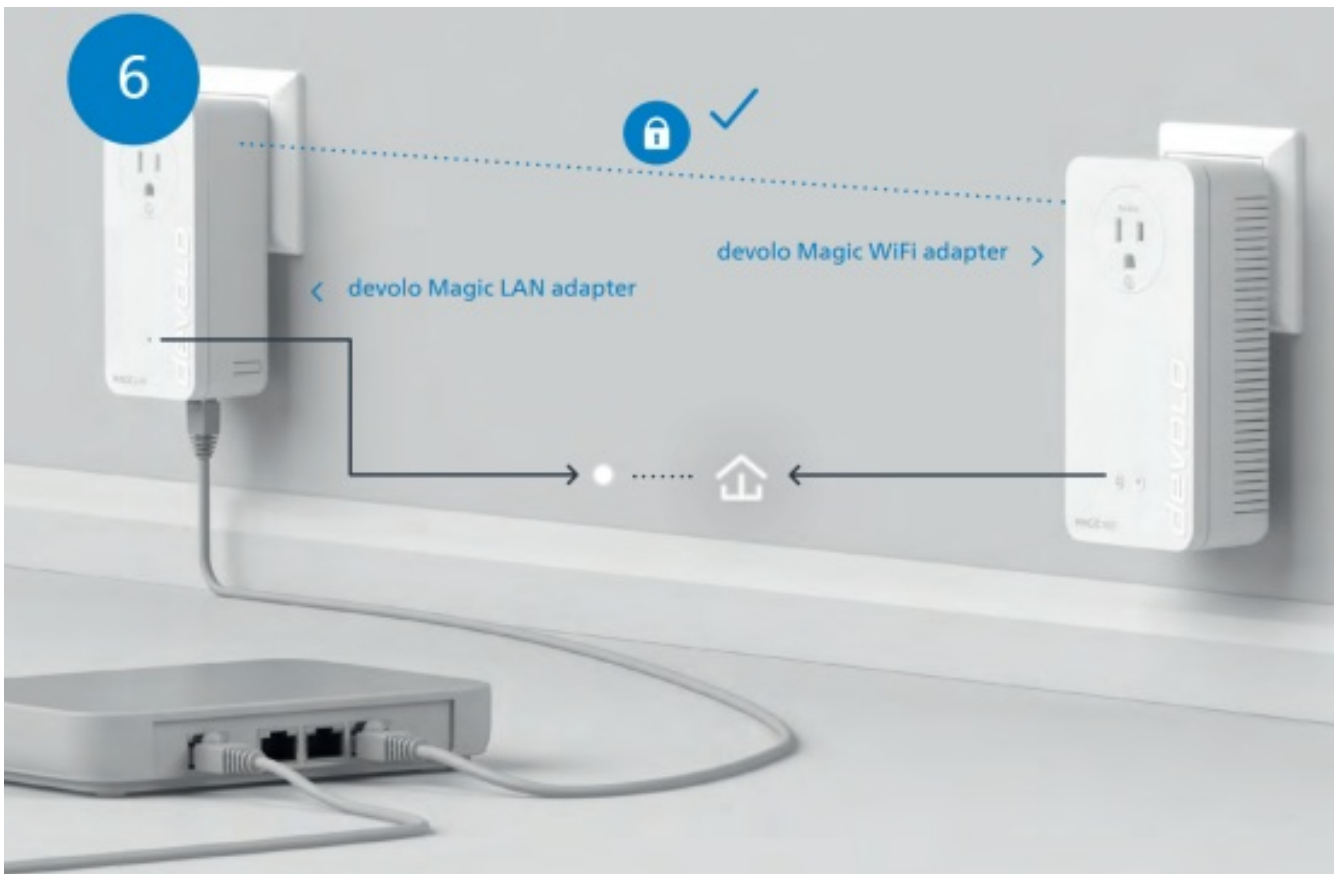

7. Set up the Wi-Fi connection on your smartphone or other smart device. The basic installation process is complete. If you have not so far had a Magic WiFi adapter on your network, you now have the **option** to subsequently set up Mesh Wi-Fi technology.



8. Optional Mesh Technology

To do this, the Wi-Fi access data is transferred once from the router to the devolo Magic WiFi adapter at the push of a button. This gives you Wi-Fi coverage where you need it.

8

Optional Mesh Technology

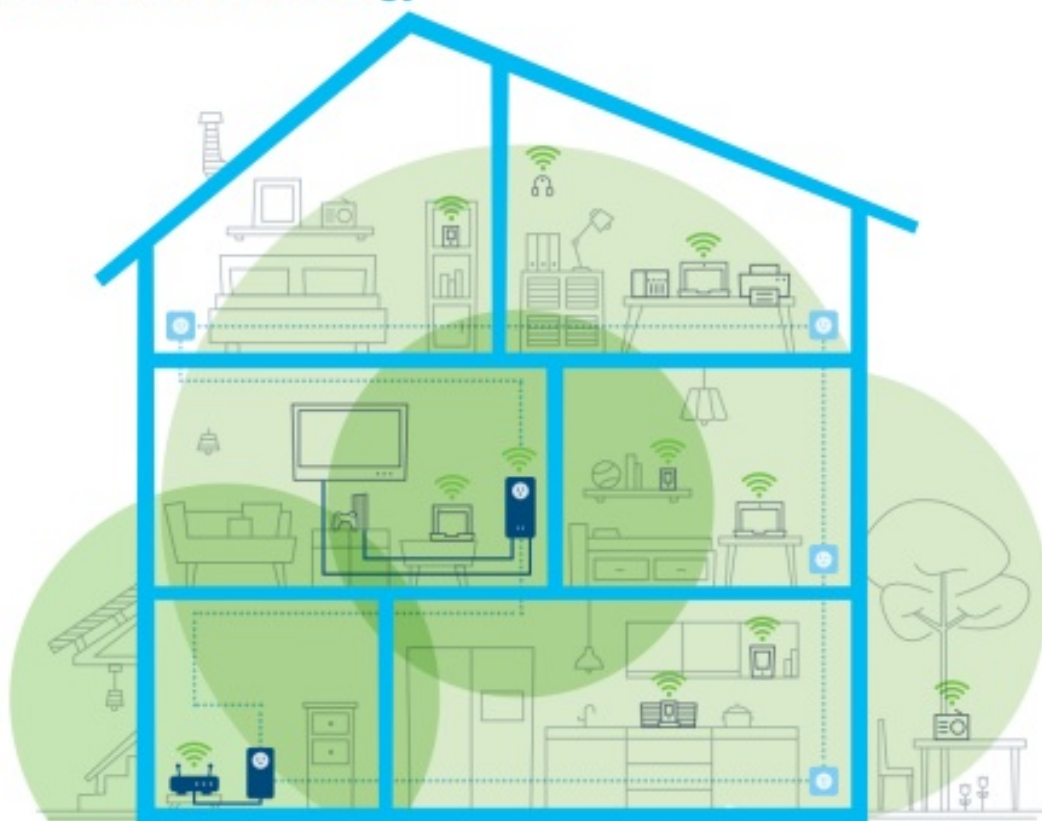

9. For the initial setup, plug the devolo Magic WiFi adapter into an available wall outlet near your router (no more than 33 ft away) and wait about 1 minute until the LED lights up white.

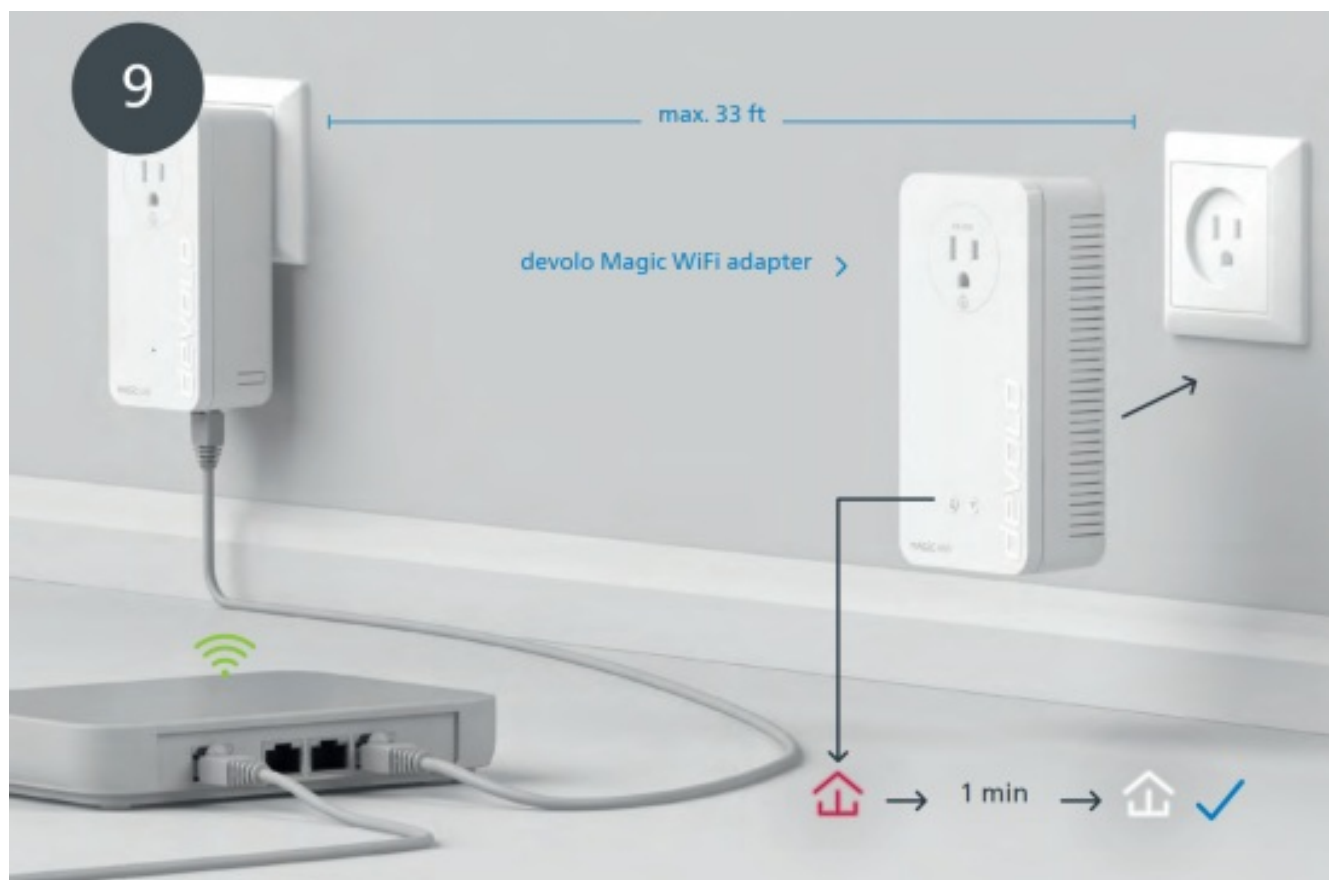

10. Briefly  press the button on your devolo Magic WiFi adapter. After the button is pressed, the LED flashes white. Press the WPS button on your router within 2 minutes. Please consult your router's manual to find out how long to press the button for.

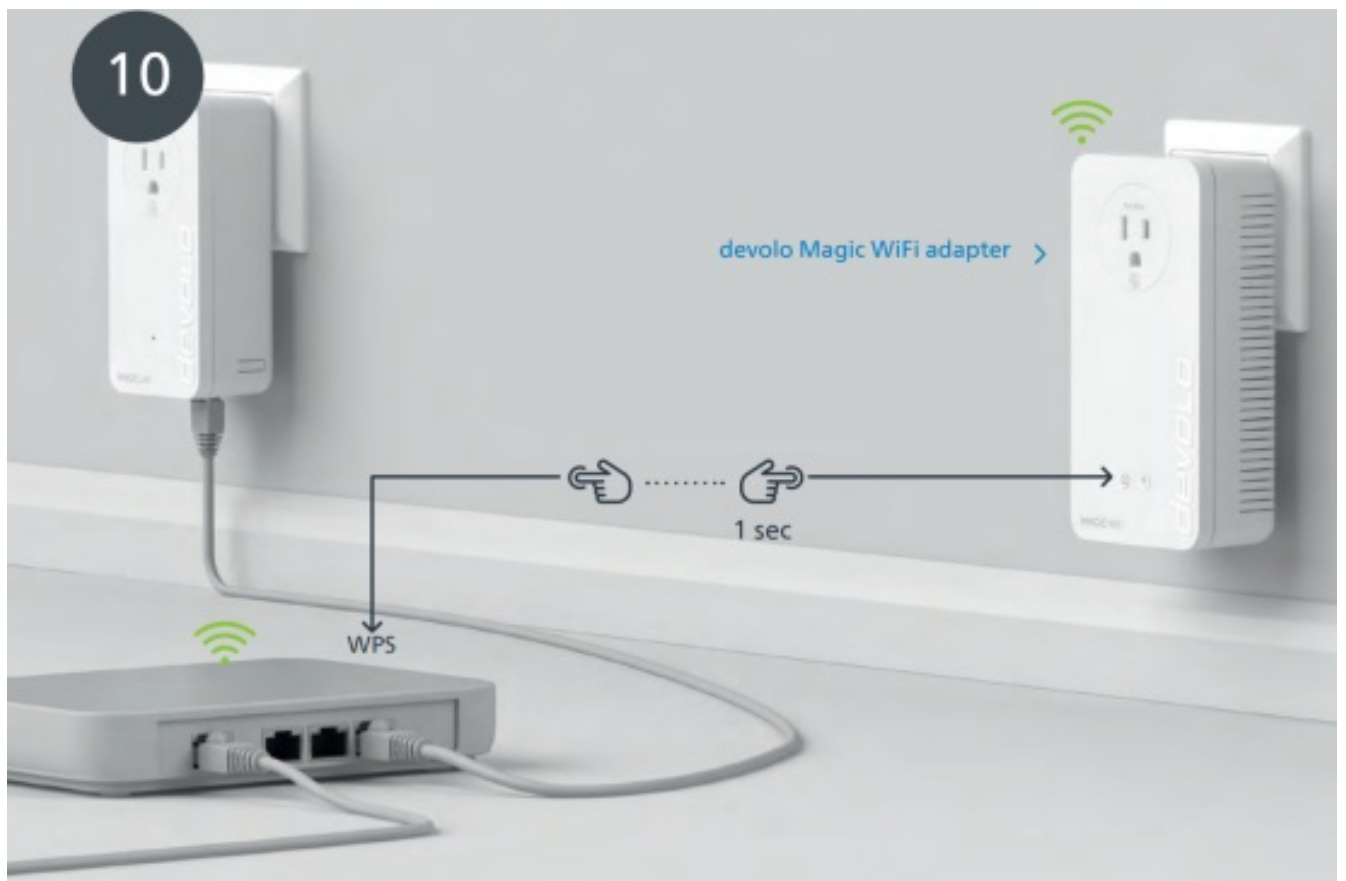

11. When the  LED lights up solid white, the process has completed successfully.



12. You can now disconnect your devolo Magic WiFi adapter and move it to another preferred location. Done! devolo Magic adapters get you seamlessly onto the Internet with a strong connection.

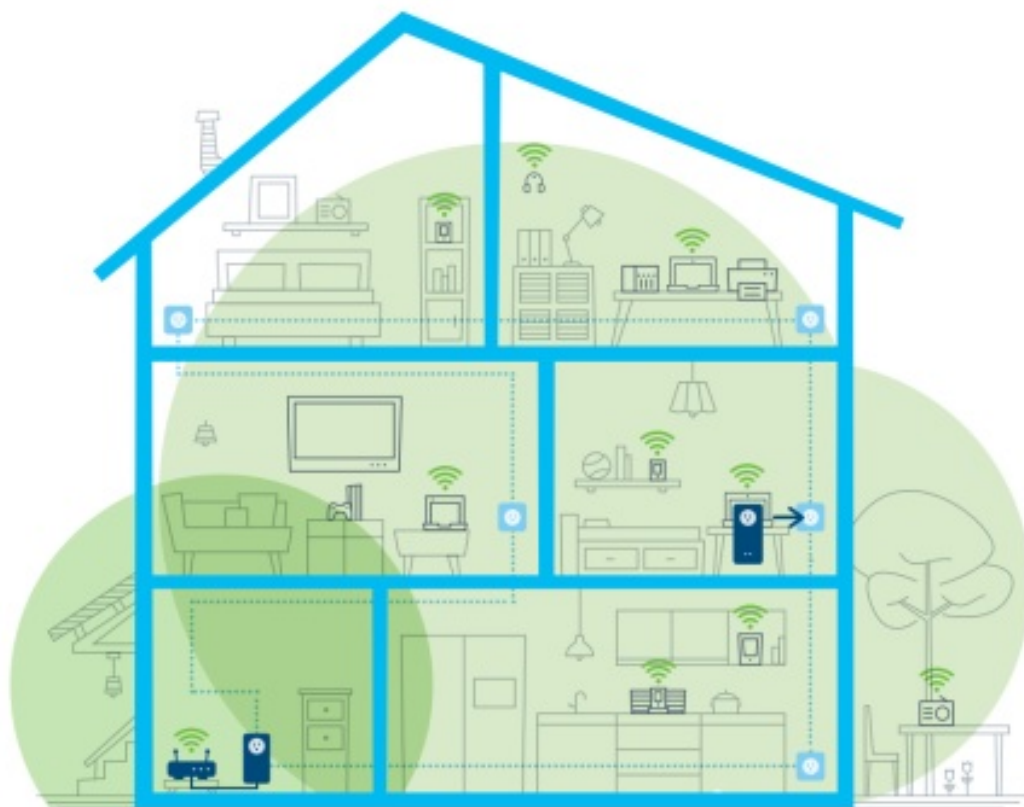

PLC button

<i>Time button is pressed</i>	<i>Action</i>	<i>LED behavior</i>
1 second	Start pairing with other devolo Magic adapters (on WiFi adapters: start ConfigSync)	Flashing white
> 10 second	Reset devolo adapter to factory settings	Solid red
PLC LED 	The devolo Magic WiFi adapter ...	LED behavior
	... is working perfectly. It is connected to other devolo Magic adapters.	Solid white

	... is currently establishing a pairing connection with another adapter.	Fast flashing white
	... is not connected to the network*	Flashing red
	... is in standby mode.	Slow flashing white
	... is currently undergoing a software update.	Alternating white and red
	... has a poor Powerline connection.	Solid white followed by short flashing red
	... is currently in the start-up process. ... cannot see any other devolo Magic adapters.	Solid red
	... no longer has any LED function since it was disabled by the user.	None

WiFi button

<i>Time button is pressed</i>	<i>Action</i>	<i>LED behavior</i>
1 second	WPS function is being carried out	Flashing white
> 3 seconds	Wi-Fi is being switched off	LED turns off

WiFi LED

The devolo Magic WiFi adapter ...

LED behavior

	The devolo Magic WiFi adapter ...	LED behavior
--	-----------------------------------	--------------

	.. has a error-free connection to the Internet	Solid white
	... is attempting to establish a connection via WP S.	Flashing white
	... no longer has any LED function since it was disabled by the user.	Off

* Go to page 33 for instruction on pairing manually.

Help: Manual Pairing

Help: If automatic pairing during initial installation was unsuccessful, you can pair the Magic adapters manually. Plug the devolo Magic WiFi adapter into an available wall outlet and wait until the  LED flashes white (approx. 1 minute).



Within 3 minutes, press the button on the side of your devolo Magic LAN adapter, which is connected to the router. Then press the  LED on your Magic WiFi adapter. When all of the LEDs light up white, pairing has been completed successfully.

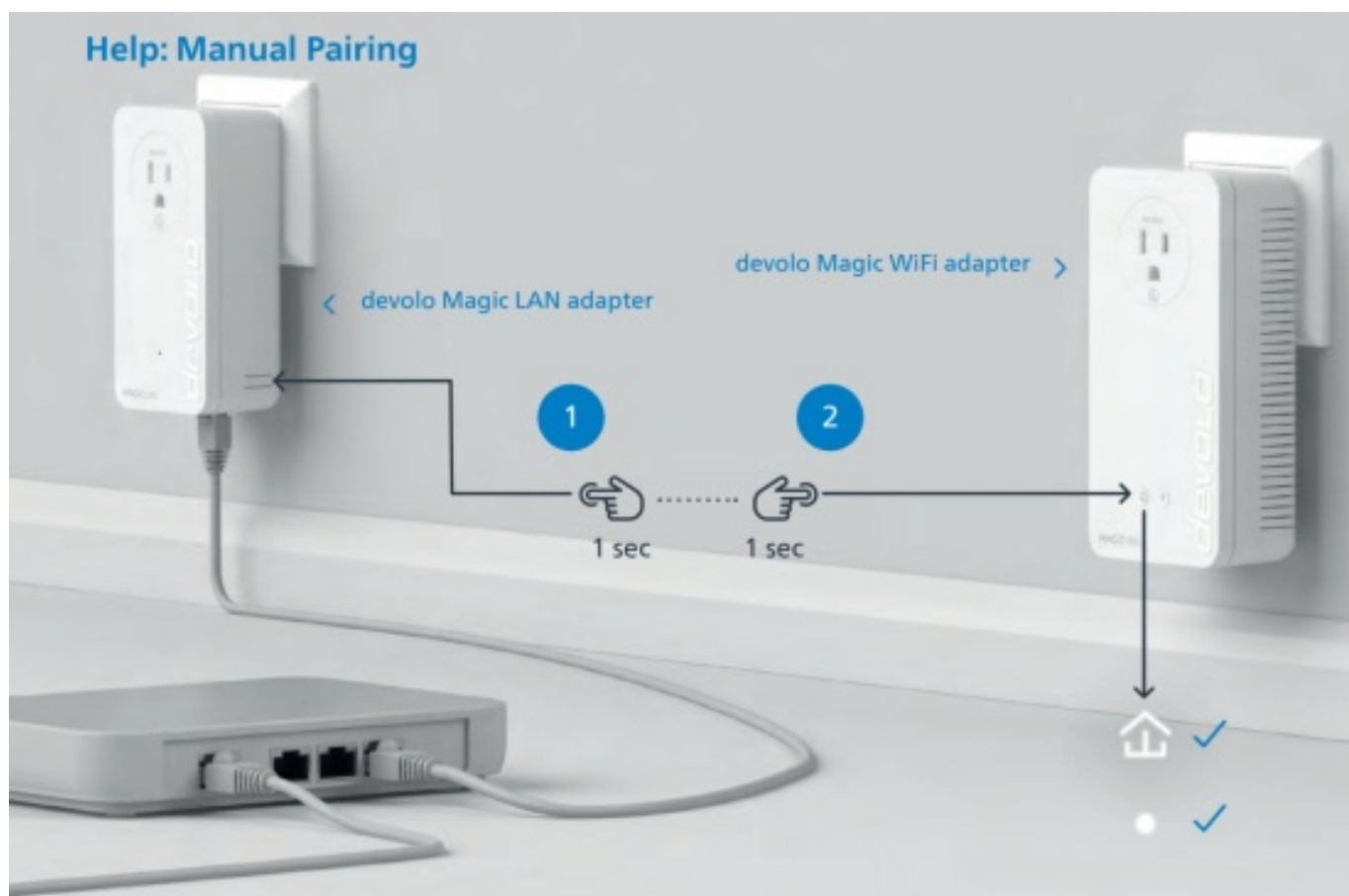

Limited Warranty: 2 years

If your devolo device is found to be defective during initial installation or within the warranty period, please contact the store where you purchased the product. The store will take care of the repair or warranty claim for you. The complete limited warranty conditions can be found at www.devolo.com/support/warranty.

Support

United States of America	www.devolo.com/support
Canada	www.devolo.com/support



devolo AG · Charlottenburger Allee 67 · 52068 Aachen · Germany
devolo.com

Documents / Resources



[devolo MAGIC 03218 2 Wi-Fi Next Powerline Add-On](#) [pdf] Installation Guide
03218, 2AXPF03218, 03218 2 Wi-Fi Next Powerline Add-On, 03218, 2 Wi-Fi Next Powerline Add-On