



DERUCE LUM DVCL-153PR Ultra Thin LED Recessed Ceiling Light Installation Guide

[Home](#) » [DERUCE LUM](#) » DERUCE LUM DVCL-153PR Ultra Thin LED Recessed Ceiling Light Installation Guide 



**DVCL-153PR Ultra Thin LED Recessed Ceiling Light
Installation Guide**

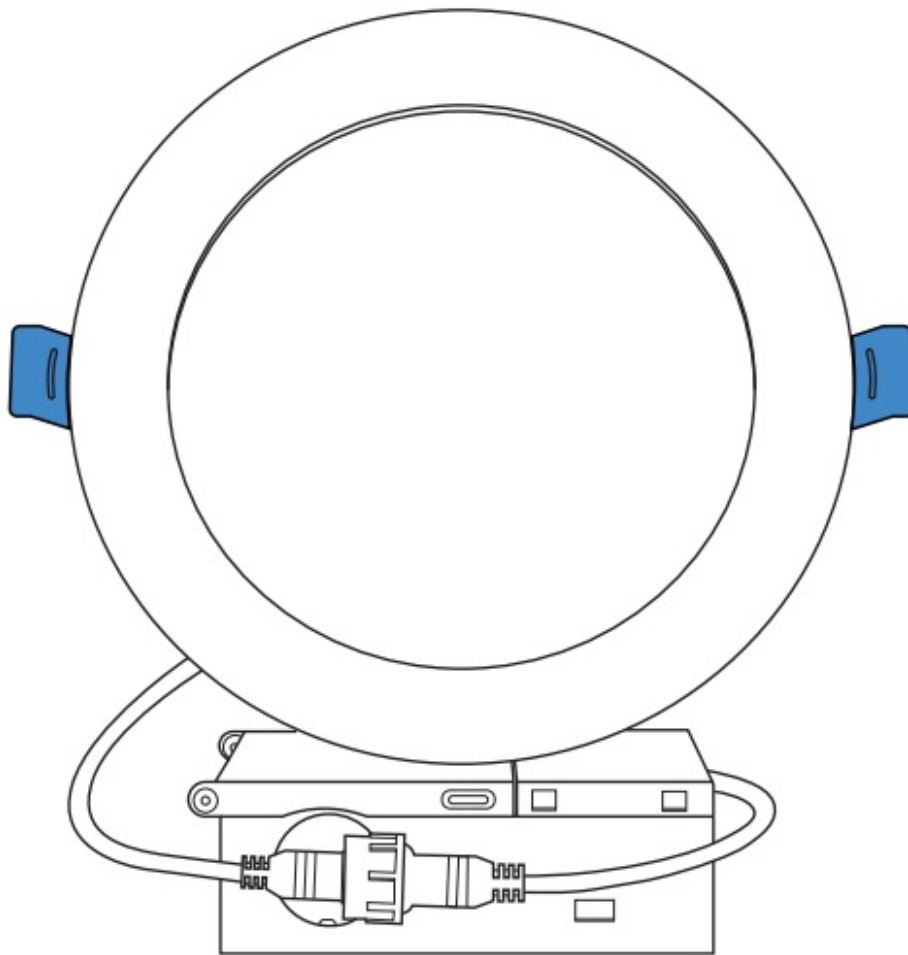

Ultra-Thin LED Recessed Ceiling Light

DERUCELUM@outlook.com

Contents

- [1 Friendly remind](#)
- [2 Installation Steps](#)
- [3 Documents / Resources](#)
- [4 Related Posts](#)

Friendly remind

For your safety, please to wear insulated gloves.
Before putting them on the ceiling, please test if they can work.

Installation Steps

1. Turn off the breaker switch for the electrical circuit to the ceiling light. This is very important to be sure of never work with circuits that are energized.
2. Mark out the location of each light. Put the template against the ceiling in the desired location and trace around it with a pencil.
3. Cut the openings for the lights.

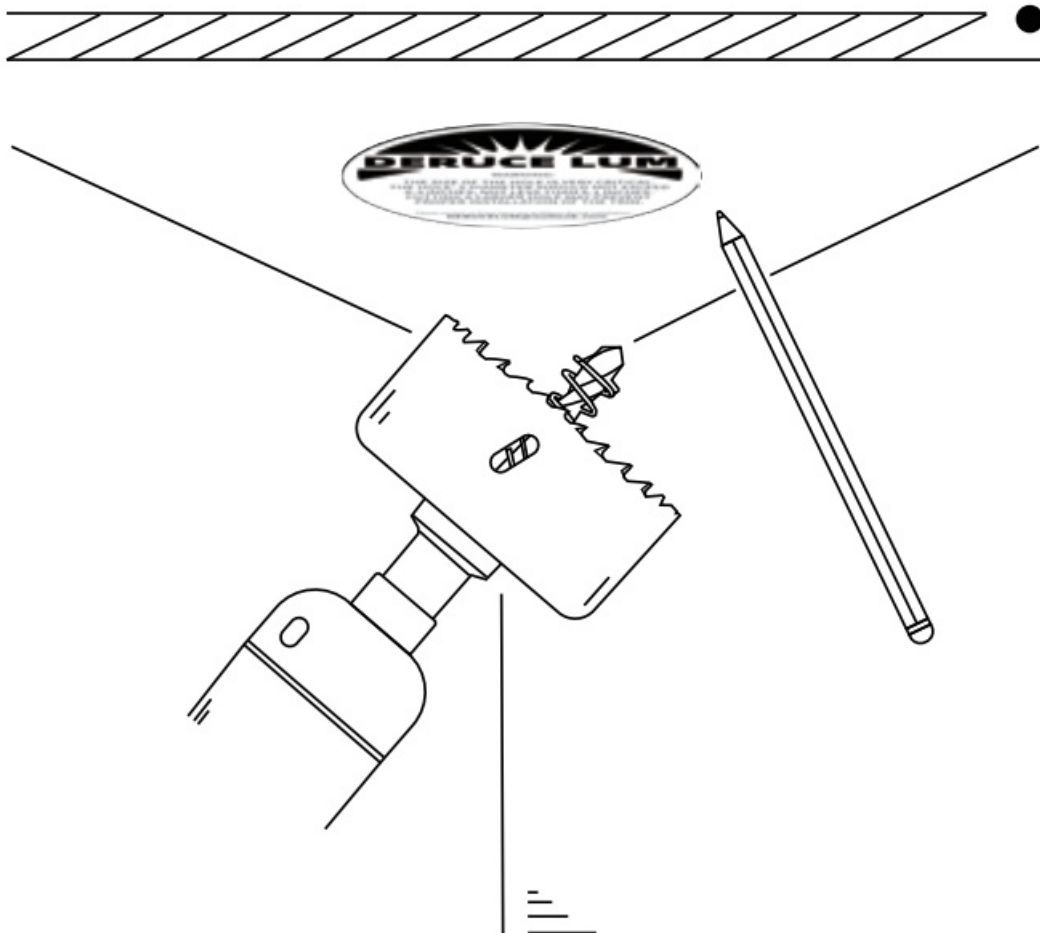

4. Run electrical wire from the power source through the mounting hole. Remove the right knockout and insert a connector(1/2 in) into it. Put the wire through the hole.

You can buy the connectors from local hardware store.

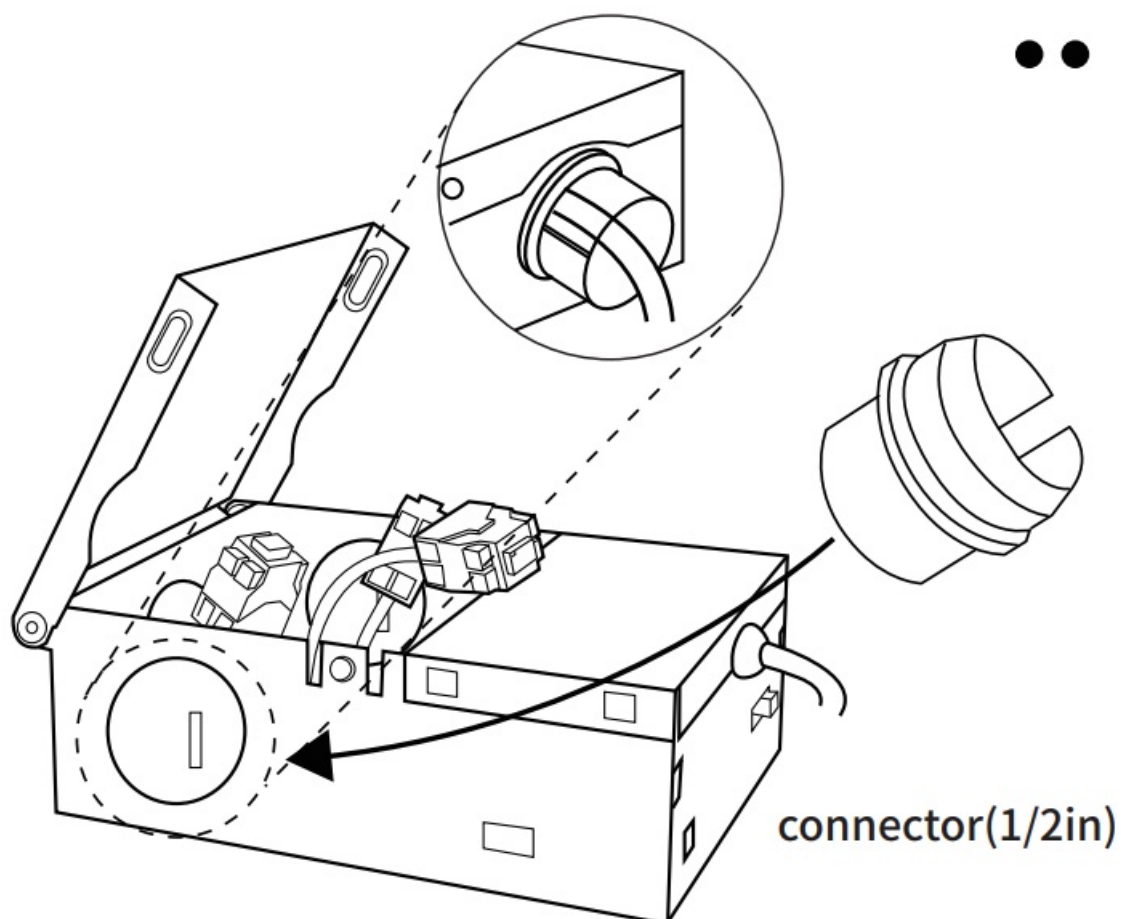

5. Connect the wire and the junction box, push the wire through the 4 head connectors.
6. Tuck the connected wire and close the cover.

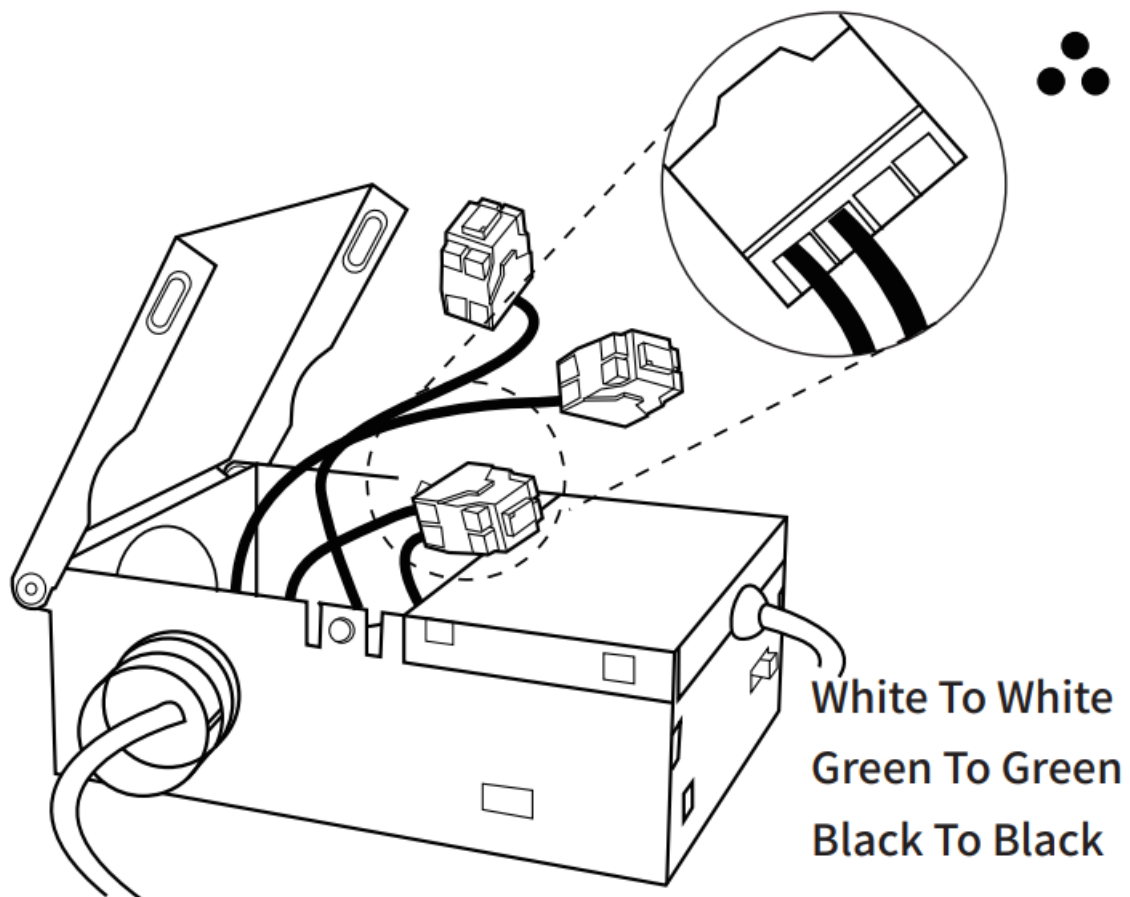

7. Connect the junction box and the light with the provided male/female connector. Do the connection with the arrow signs on the ends of cable aligned. Screw the cap to protect the connector.

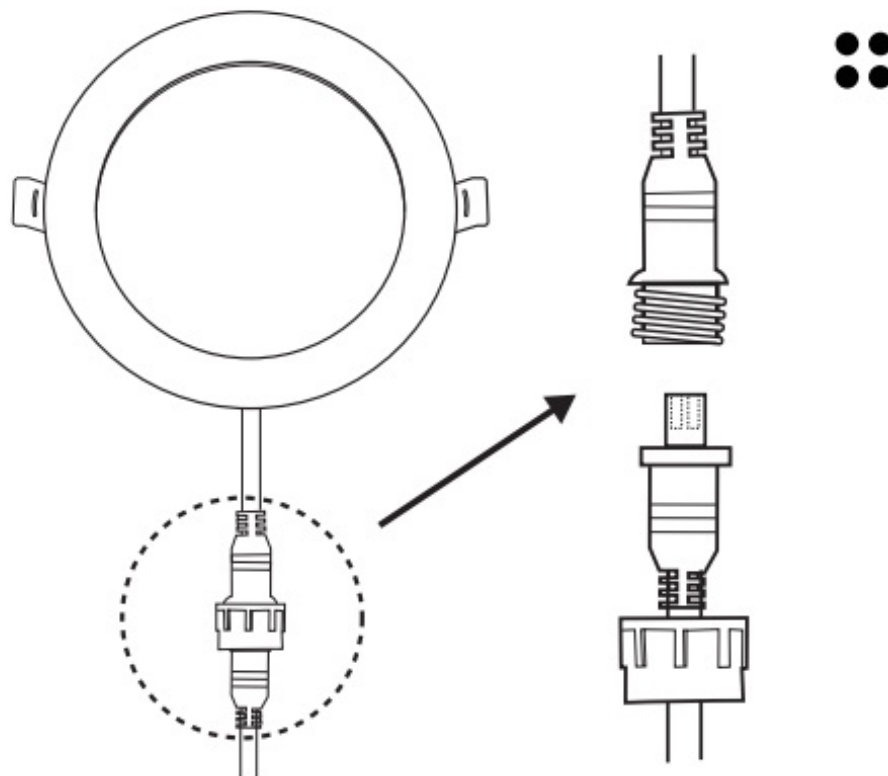

8. Insert the J-box through the cut hole in the ceiling.

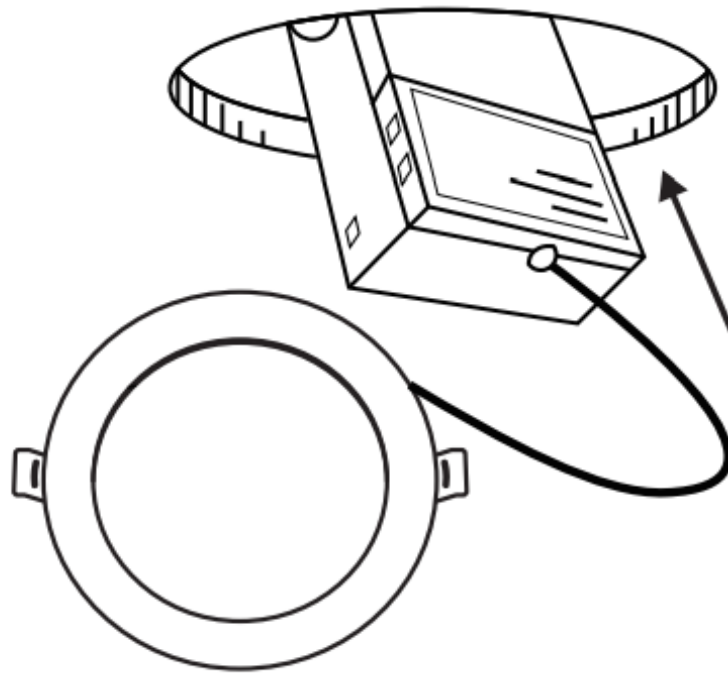

9. Snap the spring clip and mount the light in the opening.
10. Turn on the circuit and test the fixture.

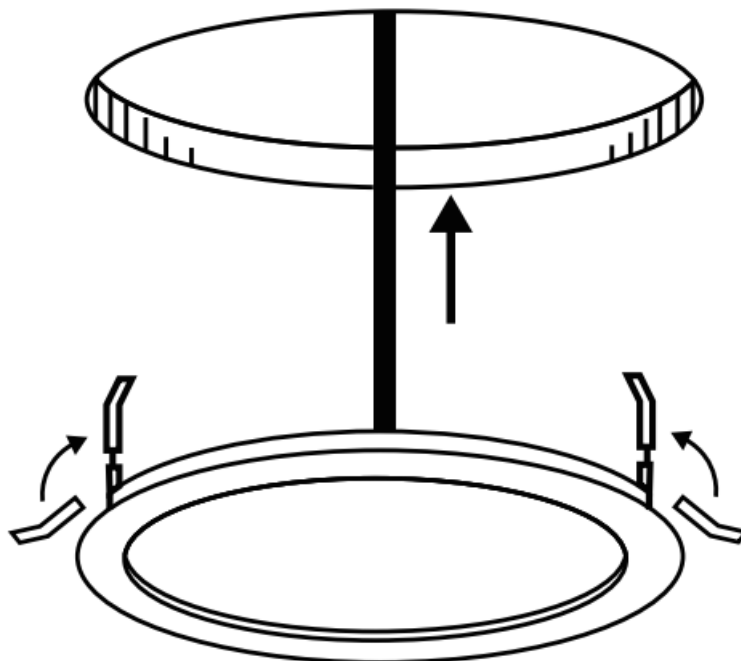

NOTICE

All electrical connections must be in accordance with local and National Electrical Code(N.E.C) standards. All work should be done by a qualified electrician.



1. Please be sure the power is shut off before process.
2. Keep away from environments where there is a risk of fire or electric shock.
3. Please don't alter, remove any wire and electrical component on the lighting kit. Otherwise, you are responsible for the consequences.

Please use a compatible LED dimmer switch as incompatible LED dimmers may cause lighting failures.

Brand Name	Model	
Lutron	DVCL-153PR	✓
	DVCL-153PH	✓
	DVCL-253PH	✓
	MACL-153M	✓
	MACL-153MLH	✓
	MACL-153MR	✓
	MACL-153MH	✓
	SCL-153P	✓
	SCL-153PH	✓
	SCL-153PR-BL	✓
	SCL-153PR-WH	✓
	CTCL-153P	✓
	CTELV-303P-WH	✓
Leviton	06674-722	✓
	06674-752	✓
	06674-726	✓
	06674-POW	✓
	DSE06-102ELV	✓
	DSL06-ILZ	✓



Documents / Resources



[DERUCE LUM DVCL-153PR Ultra Thin LED Recessed Ceiling Light](#) [pdf] Installation Guide
DVCL-153PR Ultra Thin LED Recessed Ceiling Light, DVCL-153PR, Ultra Thin LED Recessed Ceiling Light, LED Recessed Ceiling Light, Recessed Ceiling Light, Ceiling Light

Manuals+