



## DENTALEZ DL-01 LED Light User Guide

[Home](#) » [DENTALEZ](#) » DENTALEZ DL-01 LED Light User Guide 

### Contents

- [1 DENTALEZ DL-01 LED Light](#)
- [2 INTRODUCTION](#)
- [3 TECHNICAL DESCRIPTION/SPECIFICATIONS](#)
- [4 OPERATING LIGHT](#)
- [5 LIGHT COMMANDS](#)
- [6 VISUAL CONTROL OF PRESET PROGRAMS](#)
- [7 MAINTENANCE & CLEANING/DISINFECTION](#)
- [8 REMOVING & STERILIZING HANDLES](#)
- [9 MAINTENANCE & CLEANING/DISINFECTION](#)
- [10 TROUBLESHOOTING](#)
- [11 Documents / Resources](#)
  - [11.1 References](#)
- [12 Related Posts](#)

**Forest**  
DENTALEZ

**DENTALEZ DL-01 LED Light**



## INTRODUCTION

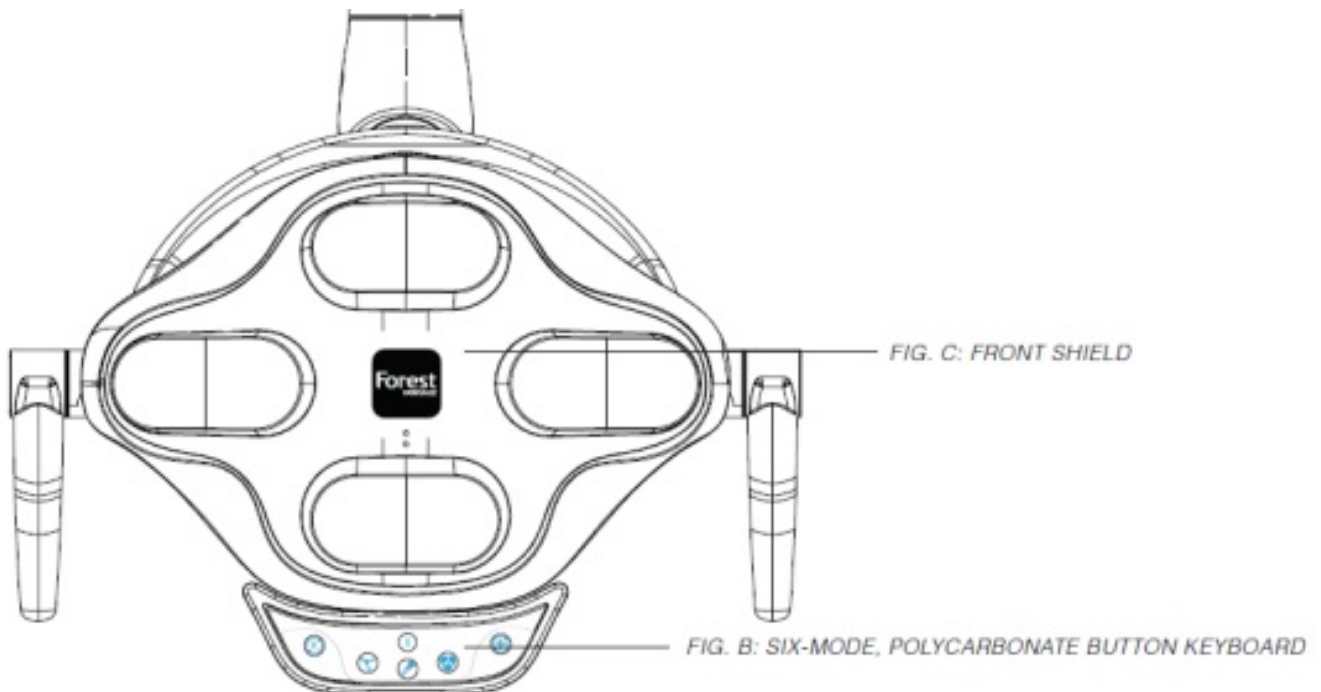

### UL CERTIFIED Product, SAFETY evaluated to ES60601-1

**INDICATIONS FOR USE/INTENDED USE** The dental operatory light is a light source intended to illuminate the oral cavity of dental patients for better visibility by a dental practitioner during diagnostic and therapeutic treatment in a clinical environment. There are no contraindications for this product.

**EXPECTED SERVICE LIFE** With proper maintenance and service, Forest products are designed for a defined “service life” under normal use (based on approximately 50 patients per week) of 5 years from the date of manufacture, with the exception of serviceable components. Some components may become obsolete due to changes in technology or due to product improvements and may necessitate product updates or upgrades. At the end of the defined service life, all products require examination by a trained service technician prior to continued use. Following this, additional examinations are required every 5 years.

**CAUTION:** Federal law restricts this device to sale by or on the order of a dental practitioner licensed by the law of the State in which he/she practices to use or order the use of the device.

**NOTE:** Refer to Service Manual and Installation Instructions for complete technical descriptions.

**REMARQUE:** Consulter le manuel d'entretien et les instructions d'installation pour obtenir la description technique complète.

## TECHNICAL DESCRIPTION/SPECIFICATIONS

- Input Voltage: 16/18 VAC
- Light Source: 8 LEDs (1 W Each)
- Spot Size: 3.2in – 7.8in (80mm X 200mm)
- Light Intensity, Lux (Adjustable): 8,000 – 45,000
- Color Temperature: 4,200 – 6,000K

Protection against electrical dangers Class 1 device, IPXO Power Supply/Transformer Continuous Duty

**WARNING:** Only the specified power supplies are to be used for the safe operation of the dental light.

**AVERTISSEMENT:** Seules les alimentations spécifiées doivent être utilisées pour un fonctionnement sécuritaire de la lampe dentaire.

Powertronix Power Supply AA-200000-ME (230/115 VAC, 300W, 50/60 Hz), AA-119298-ME (230/115 VAC, 244W, 50/60 Hz), AA119296-ME (230/115 VAC, 100W, 50/60 Hz) and Transformer AA-132400-ME (230/115 VAC, 100W, 50/60 Hz).

Refer to light installation instruction for locating power supply/ transformer away from the vicinity of water sources.

## OPERATING LIGHT

**WARNING:** Do not stare into the beam of light when light is on.

**AVERTISSEMENT:** Ne pas regarder directement le faisceau de lumière lorsque l'éclairage est en marche.

**NOTE:** Color temperature is subjective and varies between operators.

- Position light for oral cavity illumination using handles for focal length and direction.
- Turning On. Toggle switch left (FIG. A).
- Automatic On/Off. Lift light flex arm above and below 0°.(To deactivate contact your service technician.)
- Six-mode, polycarbonate button keyboard (FIG. B).

## LIGHT COMMANDS

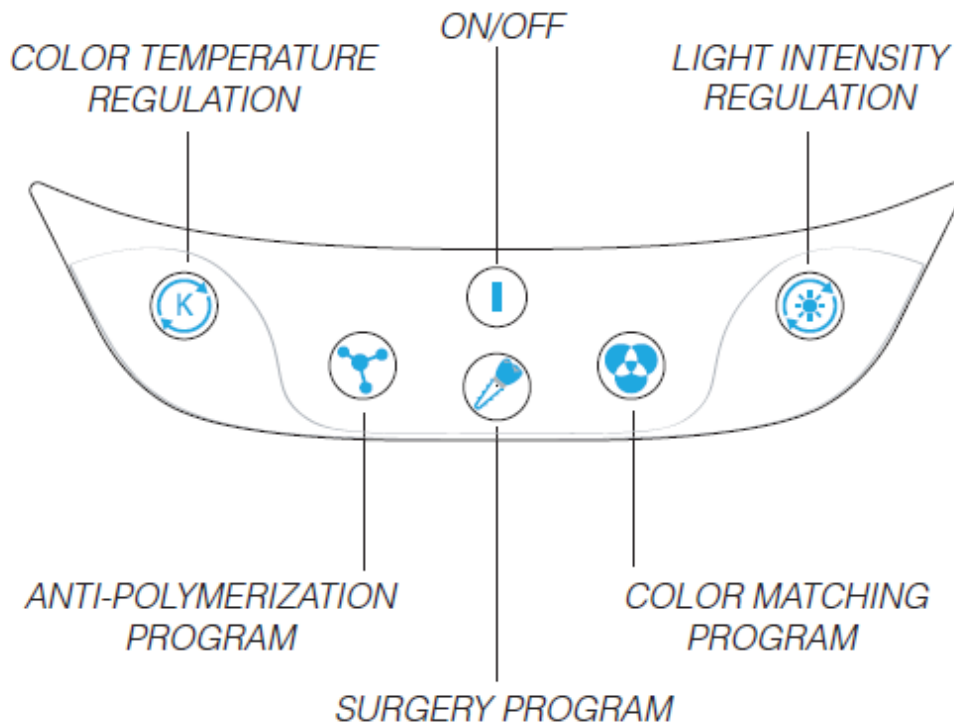

## ON/OFF & PROGRAM

The program and ON/OFF section includes the ON/OFF button for the LEDs and three preset programs:

**POLYMERIZATION:** 3000 K, minimizes the emission blue reducing the hardening speed of the composite.

**SURGERY:** 4500 K, optimizes the contrast of colors on soft tissues, better discriminating shades of gums, blood, and periodontal.

**COLOR MATCHING:** 5500 K, creates a combination of hot and cold LEDs that maximizes the yield index chromatic facilitating the choices of the dentist in tooth replacement surgery.

## VISUAL CONTROL OF PRESET PROGRAMS

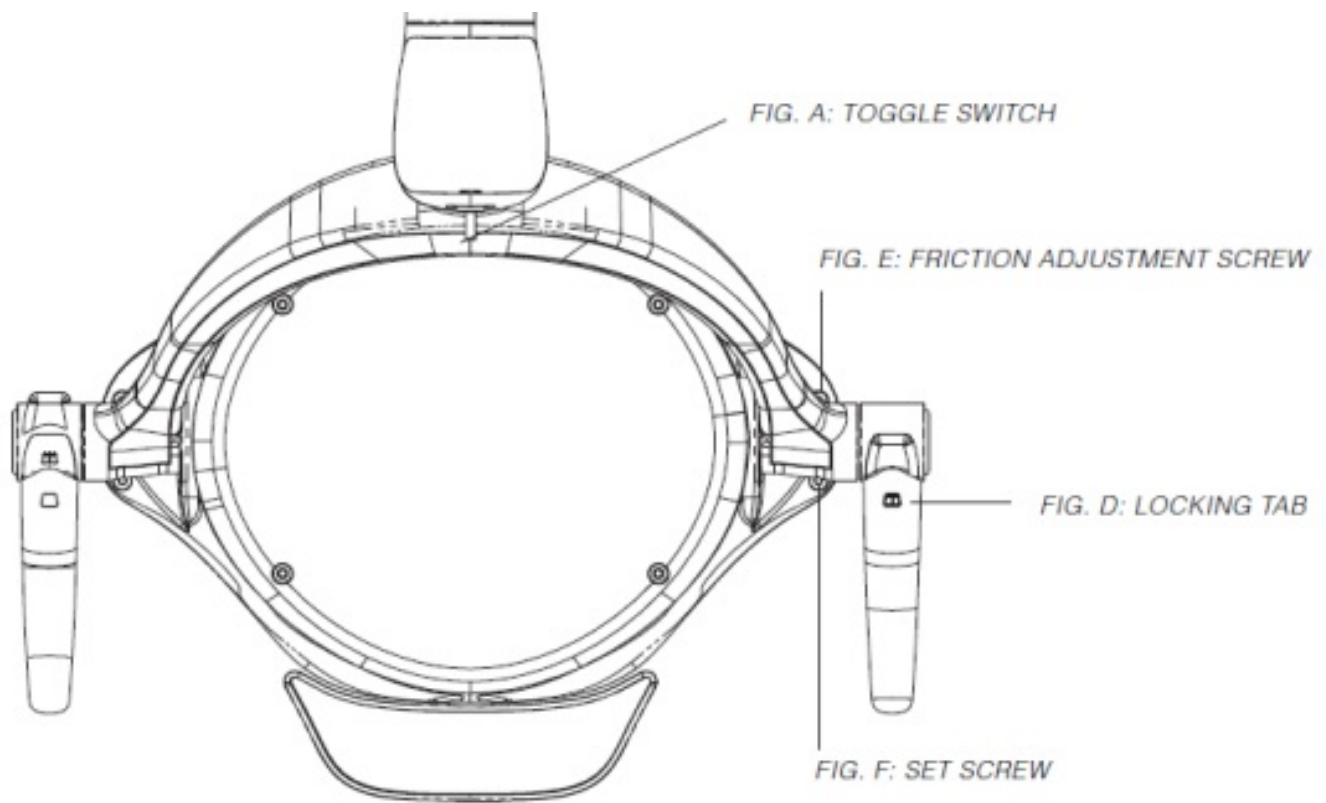

The operator can assess whether the program preset selected is actually what is desired, comparing the light emitted by the lamp with the relative conditions shown in the following.

- PROGRAM: LED Status
- POLYMERIZATION: ONLY the warm LEDs are on
- SURGERY: The light emitted by the warm LEDs has an intensity similar to that emitted by cold LEDs
- COLOR MATCHING: The light emitted by the cold LEDs has a greater intensity than that emitted by the hot LEDs

Turning on and off the LED is via the “4-state” ON/OFF key. Switching the lamp on again using the key ON/OFF, the LED will return to the last configuration used.

## MAINTENANCE & CLEANING/DISINFECTION

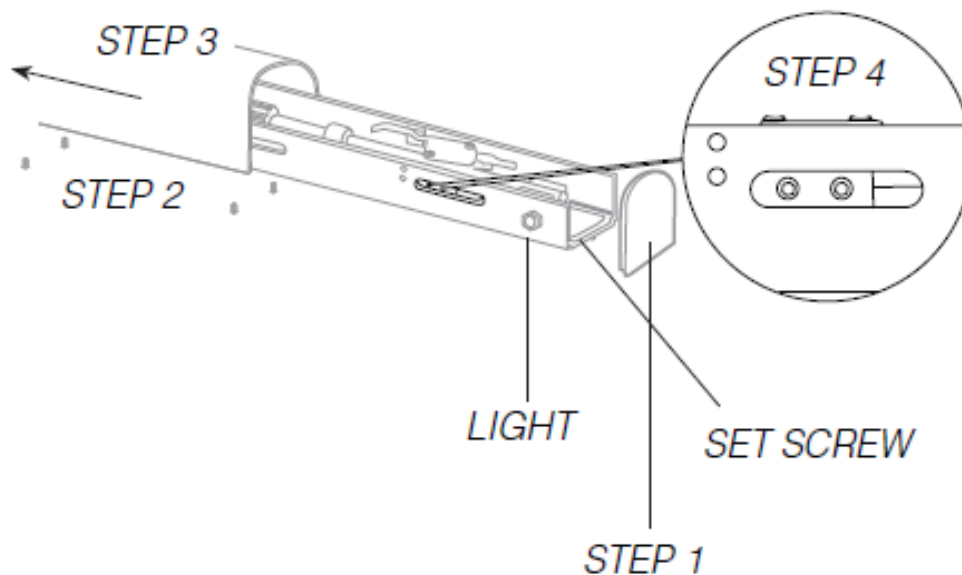

*FIG. H: DEACTIVATING AUTO ON/OFF*

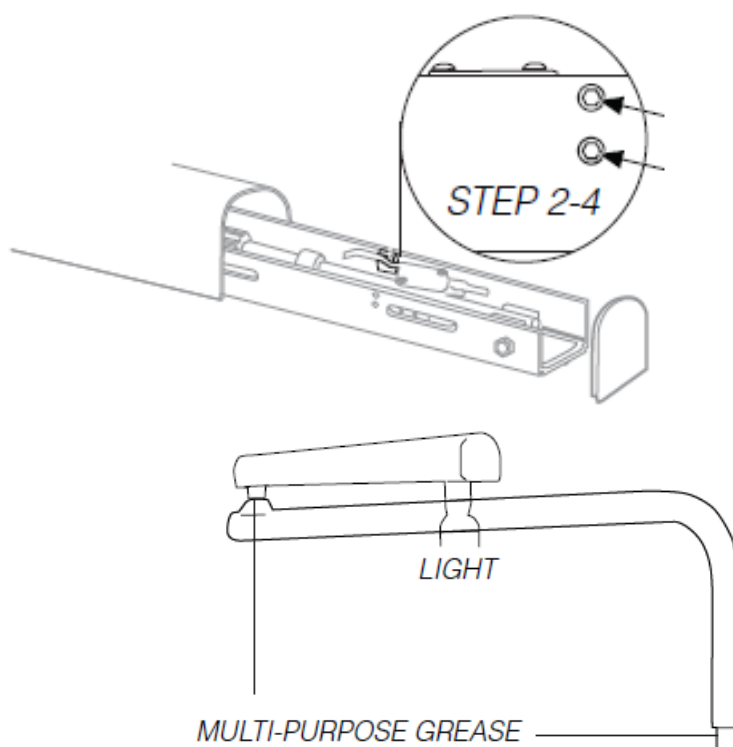

**WARNING:** To avoid personal injury, ensure the dental light is off before proceeding with the following steps.

Refer to Forest™ Operatory Equipment Asepsis Operator's Guide for infection control procedures.

### CLEANING FRONT SHIELD & REFLECTOR

**CAUTION:** Abrasive or detergent materials such as alcohol, gasoline (petrol), turpentine or the like should not be used on any part of the light.

**STEP 1:** Clean the front shield with a soft cloth moistened with mild soapy water. Using chemical disinfectants can damage components. The front shield is not autoclavable (FIG.C).

## **REMOVING & STERILIZING HANDLES**

- STEP 1: Press in the locking tab (FIG.D).
- STEP 2: To completely unhook, wiggle, and pull the handle outward while pressing in the locking tab.
- STEP 3: Autoclave @ 250° F (121° C) for 10 minutes or 273° F (134° C) for 4 minutes.
- STEP 4: Reverse steps 1 and 2 to reinstall.

## **ACCESSORIES & DETACHABLE/REPLACEMENT PARTS**

- Power Supply/Transformer
- Handles

## **LIGHT FRICTION ADJUSTMENT SCREW**

- STEP 1: Looking at the front of the light, remove the right side decorative trim from the back of the light by pulling it out with your finger. This will reveal the friction adjustment screw (FIG. E).
- STEP 2: Using a 1.5mm hex wrench adjust the set screw clockwise to create more tension for the light head and counterclockwise to loosen (FIG. F).

## **MAINTENANCE & CLEANING/DISINFECTION**

### **LIGHT AUTO ON/OFF ADJUSTMENT (FIG. G)**

(contact your service technician)

- STEP 1: Remove flex arm end caps screws (.05" Hex). Remove end caps.
- STEP 2: Remove the four screws securing the flex arm cover (1/16" Hex).
- STEP 3: Slide the cover down the flex arm.
- STEP 4: Loosen the two set screws securing the On/Off switch block (3/32" Hex).
- STEP 5: Slide block away from light for later on activation or toward light for sooner activation.
- STEP 6: Reverse steps to complete.

### **DEACTIVATING AUTO ON/OFF (FIG. H)**

(contact your service technician)

- STEP 1: Refer to steps 1 – 3 (light auto On/Off adjustment).
- STEP 2: Locate block next to auto On/Off switch inside arm.
- STEP 3: Loosen and remove (2) screws – 5/64" Hex.
- STEP 4: Remove block (automatic On/Off – deactivated).
- STEP 5: To reactivate the auto On/Off simply reinstall block.

**CAUTION:** Verify set screw is securely tightened to avoid end cap detachment.

## TROUBLESHOOTING

### THE LIGHT DOES NOT TURN ON

- STEP 1: Make sure the electric power cord for the power supply is correctly plugged in.
- STEP 2: If still inoperable, unplug the power cord and check the condition of fuse.
- STEP 3: If the problem is not solved, contact our Technical Service Department. (TF) 800.423.3555
- LIGHT INTENSITY IS CONSIDERABLY DIMMED
- STEP 1: Follow steps for “Cleaning Front Shield & Reflector”.
- STEP 2: If light remains dim, contact our Technical Service Department. (TF) 800.423.3555

### SQUEAKING LIGHT ARM

- STEP 1: Lubricate post socket with multi-purpose grease included with the light.

Refer to Forest™ General Information Operator’s Guide for Glossary of Symbols, Terms, EMC/Electrical Safety Declaration, and User Guidance.

## Documents / Resources

	<p><a href="#">DENTALEZ DL-01 LED Light</a> [pdf] User Guide DL-01 LED Light, DL-01, LED Light</p>
--	--

## References

- [DZ Professional Dental Equipment and Supplies | DENTALEZ](#)