



DENON RCD-N12DABE2 Network CD Receiver User Guide

[Home](#) » [Denon](#) » DENON RCD-N12DABE2 Network CD Receiver User Guide 

Contents

- [1 DENON RCD-N12DABE2 Network CD Receiver](#)
- [2 Product Information](#)
- [3 Product Usage Instructions](#)
- [4 Before you begin](#)
- [5 Connection](#)
- [6 Connect TV audio \(optional\)](#)
- [7 Connect to a wired network \(optional\)](#)
- [8 Use the HEOS app to complete CEOL setup](#)
- [9 Enjoy your music](#)
- [10 Contact Denon](#)
- [11 Owner's manual](#)
- [12 Trademark information](#)
- [13 Documents / Resources](#)
 - [13.1 References](#)

DENON®

DENON RCD-N12DABE2 Network CD Receiver



Product Information

The Network CD Receiver RCD-N12DAB is a versatile audio device that allows you to enjoy your music from various sources. It features built-in HEOS technology, which enables wireless streaming and multi-room audio

playback. The receiver also supports DAB and FM radio, Apple AirPlay, Bluetooth, and internet radio.

The package includes the following items:

- Network CD Receiver RCD-N12DAB
- Power cord
- Safety Instructions
- Remote control (RC-1255)
- DAB/FM indoor antenna
- Quick Start Guide

Product Usage Instructions

Setup

1. Connect the left and right speakers to the CEOL using speaker cables.
2. Connect the power cord from the CEOL to a power outlet.
3. (Optional) Connect TV audio:
 1. Connect one end of an HDMI cable to the TV port labeled ARC or eARC.
 2. Connect the other end of the HDMI cable to the HDMI ARC port on the back of the CEOL.
4. (Optional) Connect to a wired network:
 - If connecting to a wired network, use an Ethernet cable (not included) to connect the CEOL to your router.
 - If connecting to a wireless network, do not connect the Ethernet cable.

HEOS App Setup

To complete the setup using the HEOS app:

1. If you haven't already, download and install the HEOS app from the Apple App Store, Google Play, or Amazon App Store.
2. Launch the HEOS app and follow the instructions provided in the app.
3. If you have already set up at least one HEOS built-in device on your network:
 1. Select the Settings icon in the upper-left corner of the main Music menu to display the Settings menu.
 2. Select "Add Device" from the HEOS app's Settings menu and follow the instructions.

Enjoying Your Music

Internet Radio

1. Press the "INTERNET RADIO" button on the CEOL.
2. Select the desired station using the controls and press "ENTER" to play.
3. Select "Play Now" and press "ENTER" to start playback.

Apple AirPlay

1. On your Apple device, open Control Center and tap the AirPlay icon in the audio card.
2. Select “Denon CEOL” from the AirPlay device list.
3. Choose the music you want to play from your iPhone, iPod touch, iPad, or Mac.

Bluetooth

1. Press the “Bluetooth” button on the CEOL to select Bluetooth mode. The CEOL will enter pairing mode automatically if it is the first time using Bluetooth.
2. Activate Bluetooth on your mobile device.
3. Select “Denon CEOL” from the Bluetooth device list on your mobile device.
4. Play music using any app on your mobile device.

If you have any questions or need support, you can contact Denon via the free helpline or refer to the online manual for additional functions and operation details.

Denon Helpline: 00800-43674357









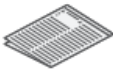

Online Manual: manuals.denon.com/RCDN12/EU/EN/

We hope you enjoy your Denon product for years to come!



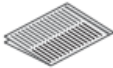

Before you begin

What's in the box



What's in the box

Quick Start Guide		Power cord	
Safety Instructions		HDMI® cable	
Cautions on Using Batteries		Remote control (RC-1255)	
Notes on radio		2× R03/AAA batteries	
CEOL		DAB/FM indoor antenna	

Required for setup

Speakers	
Speaker cables	
Mobile device	
Wi-Fi® Router and Internet connection	

Optional

TV	
Ethernet cable	

Connection

1. Connect the left and right speakers to the CEOL.

2. Connect the power cord from the CEOL to a power outlet.
3. Insert the batteries into the remote.

Batteries can be taken out in reversed order.

- 1** Connect the left and right speakers to the CEOL.

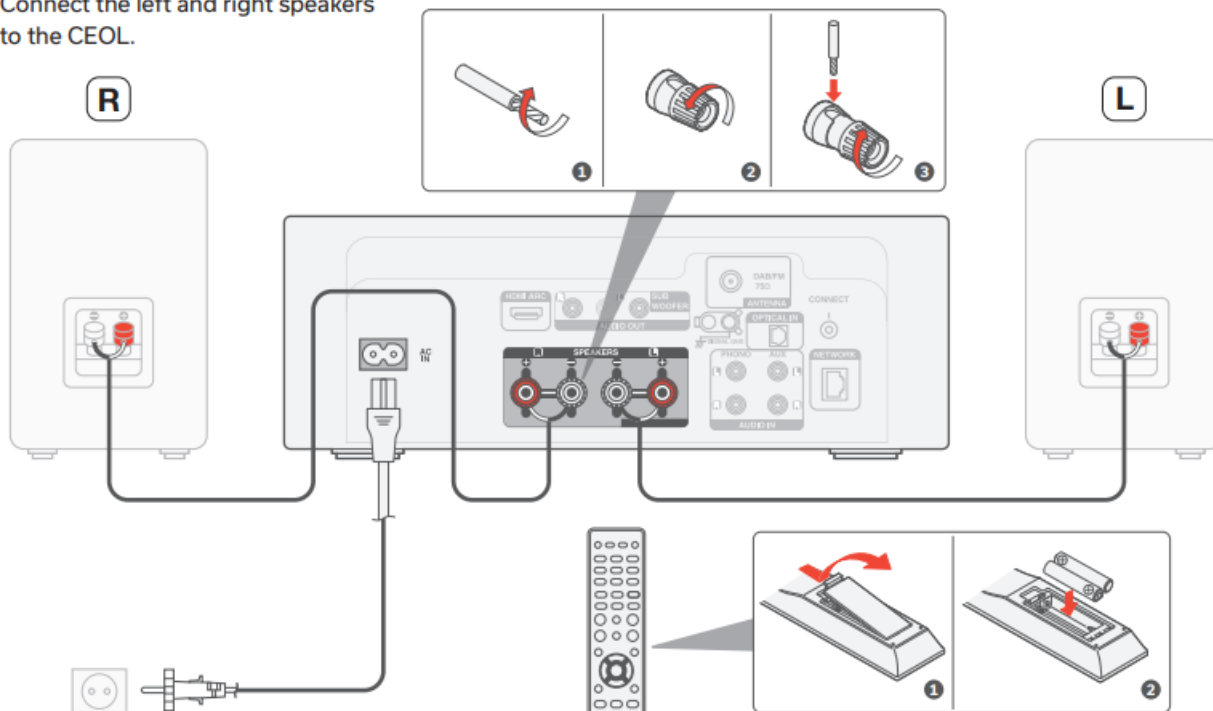

- 2** Connect the power cord from the CEOL to a power outlet.

- 3** Insert the batteries into the remote.
 - Batteries can be taken out in reversed order.

Connect TV audio (optional)

1. Connect one end of the HDMI cable to the TV port labeled “ARC” or “eARC”.
The CEOL does not support eARC functionality, however you can still connect it to an eARC port to use ARC functionality.
2. Connect the other end of the HDMI cable to the HDMI ARC port on the back of the CEOL.

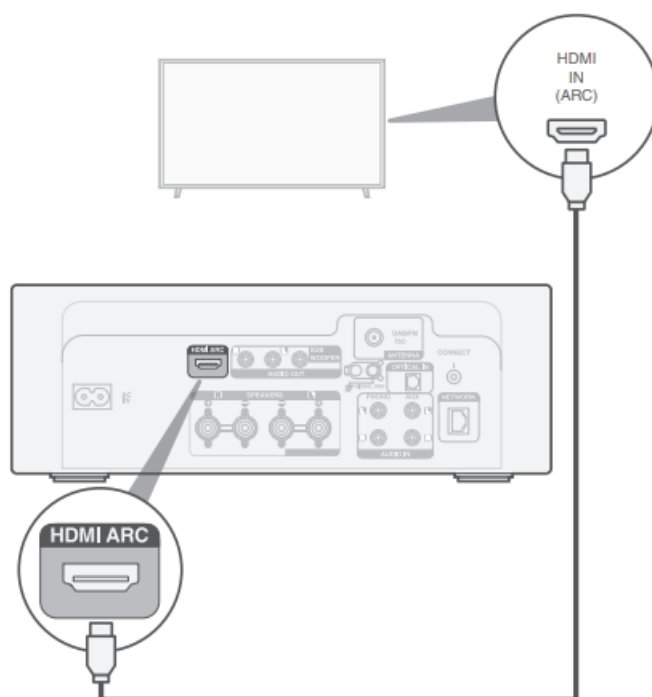

NOTE

- The TV connection is used to pass audio to the CEOL from your TV's built-in sources (tuner, smart TV apps, etc.) and HDMI devices connected to your TV. The CEOL does not generate any video output.
- Make sure the audio output section in your TV settings menu is set to output only 2ch PCM audio. Dolby Digital and DTS audio are not supported.

Connect to a wired network (optional)

If you are connecting CEOL to a wired network, connect an Ethernet cable (not included) between the CEOL and your router. Do not connect the Ethernet cable if you are connecting the CEOL to a wireless network.

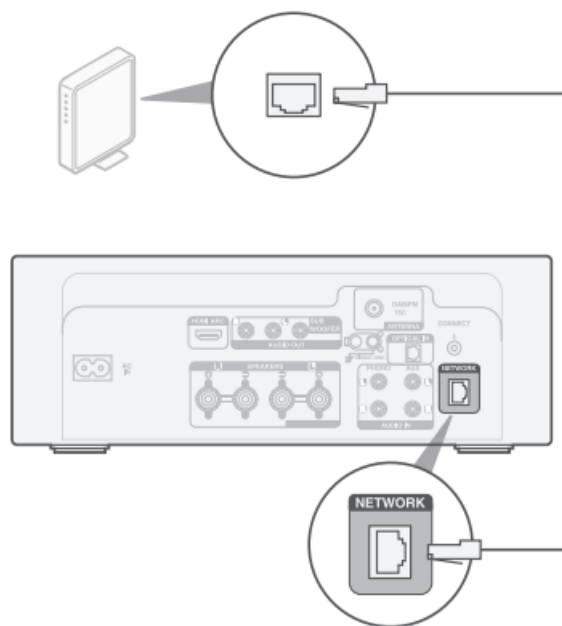

In step 4 we will guide you how to connect to a wireless network.

Use the HEOS app to complete CEOL setup

First time setting up HEOS Built-in device

1. Go to the Apple App Store, Google Play or Amazon App Store and search for “HEOS” to download and install.



2. Launch the HEOS app and follow the instructions in the app.



I have setup at least one HEOS built-in device on my network

If you already have the HEOS app and have setup at least one HEOS built-in device, please follow the steps below to add the CEOL to your wireless network.

1. Select the Settings  icon in the upper-left corner of the main “Music” menu to display the Settings menu.



2. Select “Add Device” from the HEOS app’s Settings menu and follow the instructions:



You will need to use the CONNECT button on the rear panel of this unit when connecting this unit to a wireless LAN network. Place this unit in a position where the CONNECT button is within reach until the network configuration is complete. If you cannot reach the CONNECT button, you can also use the HEOS button on the remote control. Instead of the CONNECT button, press and hold the HEOS button for at least 2 seconds.

Enjoy your music

Enjoy internet radio

1. Press INTERNET RADIO.
2. Select the station you want to play, then press ENTER.
3. Select “Play Now”, then press ENTER.



Using the HEOS app to control your device and select your favorite TuneIn radio station to play on your device.

Enjoy music using Apple AirPlay

1. Open Control Center then tap the AirPlay icon in the audio card.



2. Select “Denon CEOL” from the AirPlay device list.

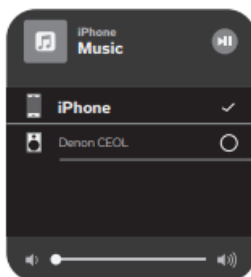

3. Choose music to play from your iPhone, iPod touch, iPad or Mac.

You can also AirPlay audio from an app you’re using on your iOS device. Just open the app, tap the AirPlay icon, then tap a speaker or tap multiple speakers.

Enjoy music using Bluetooth

1. Press Bluetooth to select Bluetooth.

When using for the first time, CEOL will go into the pairing mode automatically.

2. Activate Bluetooth on your mobile device.

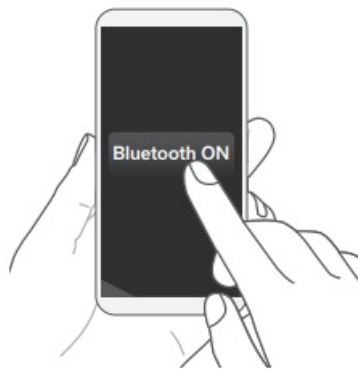

3. Select "Denon CEOL" from the Bluetooth device list on your mobile device.
4. Play music using any app on your mobile device.



To pair with other Bluetooth devices, press and hold Bluetooth on the remote control for at least 3 seconds.

Contact Denon

00800-43674357

We hope you will enjoy your Denon product for years to come. If you ever have any question or need any support, just get in touch via the free helpline. We are happy if you are happy.
In case you can't reach the helpline please check the support section on www.denon.com for more information.

Owner's manual

Refer to the online manual for other functions, information and operation procedure details.
manuals.denon.com/RCDN12/EU/EN/



Online manual



For more information, visit www.denon.com

Trademark information

- Apple, AirPlay, iPad, iPad Air, iPad Pro, iPhone and Mac are trademarks of Apple Inc., registered in the U.S. and other countries.

The trademark "iPhone" is used in Japan with a license from Aiphone K.K. Use of the Works with Apple badge means that an accessory has been designed to work specifically with the technology identified in the badge and has been certified by the developer to meet Apple performance standards.



- The Bluetooth® word mark and logos are registered trademarks owned by the Bluetooth SIG, Inc. and any use of such marks by DEI Sales, Inc. is under license. Other trademarks and trade names are those of their respective owners.



- The Wi-Fi CERTIFIED logo is a registered trademark of the Wi-Fi Alliance. Wi-Fi Certification provides

assurance that the device has passed the interoperability test conducted by the Wi-Fi Alliance, a group that certifies interoperability among wireless LAN devices.



- The terms HDMI, HDMI High-Definition Multimedia Interface, HDMI trade dress and the HDMI Logos are trademarks or registered trademarks of HDMI Licensing Administrator, Inc.



- App Store® is registered in the U.S. and other countries.



- Google Play and the Google Play logo are trademarks of Google LLC.



www.denon.com

Printed in China 5411 12061 00AS
© 2023 DEI Sales, Inc. All Rights Reserved.

Documents / Resources

A small icon showing a document with the text "Quick Start Guide" and the Denon logo.	DENON RCD-N12DABE2 Network CD Receiver [pdf] User Guide RCD-N12DABE2, RCD-N12DABE2 Network CD Receiver, Network CD Receiver, CD Receiver, Receiver
---	---

References

- [RCD-N12DAB](#)
- [Denon™ Home Theater | Enhance the Entertainment Experience](#)