



DENNERLE Scaper's Flow Hang On Filter Instruction Manual

[Home](#) » [DENNERLE](#) » DENNERLE Scaper's Flow Hang On Filter Instruction Manual 



DENNERLE

Scaper's Flow
Operating instructions

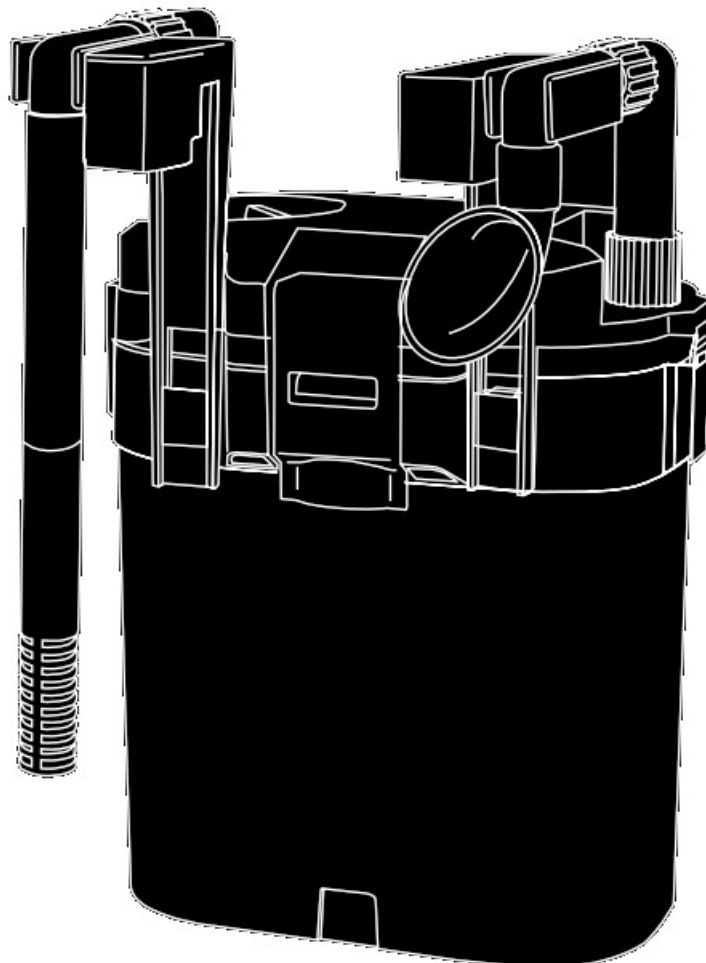

Contents

- 1 Scaper's Flow Hang On Filter
- 2 Safety instructions
- 3 Component names and components included
- 4 Installation
- 5 Startup
- 6 Filter and lily pipe hanging position
- 7 Cleaning and care
 - 7.1 Cleaning and replacing filter material
 - 7.2 Cleaning the pump
 - 7.3 Cleaning the filter surface
- 8 What if... – Troubleshooting
- 9 Replacement parts and accessories
- 10 Technical data
- 11 Disposal
- 12 Guarantee conditions
- 13 Documents / Resources
 - 13.1 References
- 14 Related Posts

Scaper's Flow Hang On Filter

Hang-on external filter for freshwater aquaria, 30 – 120 l

Please be sure to read the instructions for use carefully and in their entirety before using the aquarium for the first time.

Keep the instructions in a safe place.

Safety instructions

- For use with 230 V/50 Hz alternating current only.
- For indoor use only.
- Always disconnect all equipment in the water from the power supply before reaching into the aquarium.
- The mains plug must be permanently accessible once the device is in place.
- All cables leading from the aquarium, including the power cables for the equipment, must have a drip loop attached so that any water running down cannot reach the equipment and/or the mains outlet.
- The equipment must not be used if the power cord is damaged. Damaged power cords must not be replaced.
- This equipment is not intended to be used by persons (including children) with limited physical, sensory, or mental capacity, lack of experience, and/or lack of knowledge, unless said persons are supervised for their own safety by another responsible person or are given instructions by this person on how to use the equipment. Children must be supervised to ensure that they do not play with the equipment.
- Magnetic fields can cause electronic or mechanical defects and damage to the equipment. This also applies to cardiac pacemakers. For information about the requisite safe distances, please refer to the instruction manual for your medical device.
- To be used for the specified purpose only. The use of any additional parts not recommended by the equipment manufacturer can result in unstable operation, for which the manufacturer offers no warranty.
- Permitted water and room temperature range: 10 – 35 °C
- Maximum pump head: 60 cm. Please position filters accordingly.



- Please install the entire filter before switching on. Fill the filtration chamber with water before switching on to ensure that the pump can function correctly.
- Do not use the filter if the filter head gets hot or makes unusual noises.
- When you install the filter for the first time, leave it to run for 24 hours in a water circuit (e.g., a separate aquarium or bucket) before adding fish, to remove any residues potentially left over from the production process.

Component names and components included

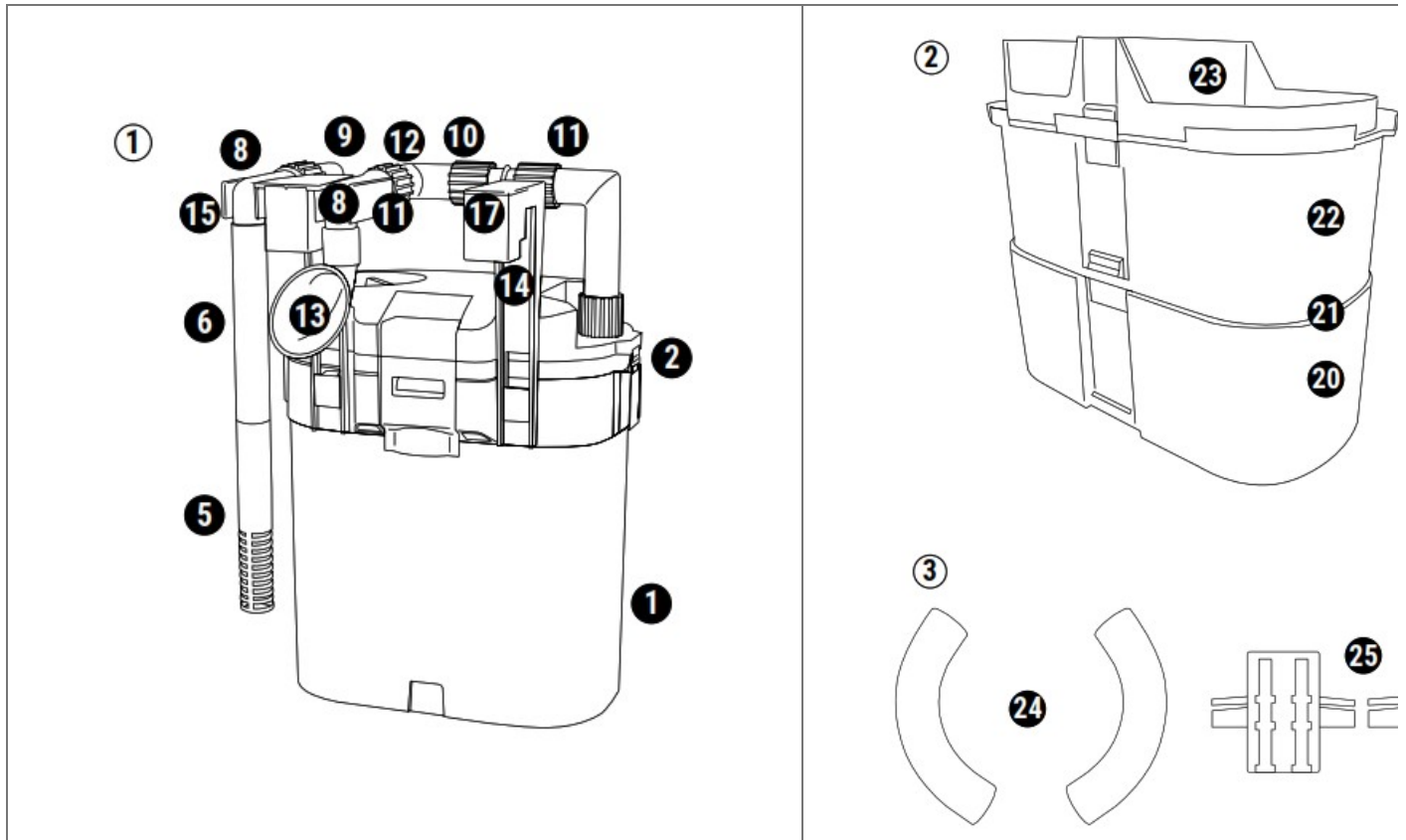

No.	Name	Quantity
Filter [1]		
1	Filter bowl	1
2	Filter head with pump and seal	1
3	Stoppers with seal for water filler opening	1
4	Power cord	1
Add-on components		
5	Suction pipe, split	1
6	Suction pipe, extension	1
7	Intake protection (filter sponge)	1
8	Corner piece with 2 O-rings	2
9	Corner piece, elastic, 55 x 30 mm	2
10	Suewcap	6
11	Tube connector	1
12	Corner piece, elastic, 22 x 30 mm	1
13	Lily Pipe	1
14	Filter holder	2
15	Pipe holder, left	1
16	Pipe holder, right	1
17	Cover plate for filter holder	2
18	Spacer incl. rubber	1
Filter basket and filter materials [2]		
19	Filter basket	2
20	Pre-filter sponge	1
21	Fine filter pad filled with active charcoal	1
22	Bio filter tubes	1
23	Cover for filter basket	1
Accessories for running a standing filter, with 12/16 mm tubes (not included) [3]		
24	90° tube guide	2
25	Tube holder (for 5 mm thick glass)	2

Installation

There are 4 ways to position the filter on your aquarium:

1. Hanging on the left of the aquarium [4]
2. Hanging in the middle of the aquarium [5]
3. Hanging on the right of the aquarium [6]
4. Standing next to the aquarium [7]

When you unpack the filter you will see that it has been prepared for use in position 1. To use it in a different position, adjust the filter as shown in Fig. 5 – 7. If you want to run a standing filter, do not place the filter lower than 60 cm below the aquarium since this exceeds the maximum head. For shrimp aquariums, add intake protection (filter sponge) to the suction pipe to avoid sucking up young shrimp.

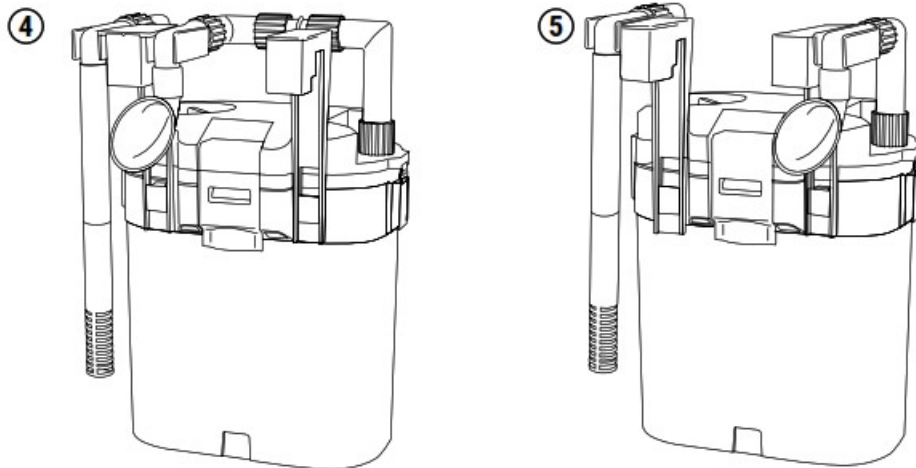

Startup

- Before switching on your filter, check all tube connections to ensure they are seated correctly, and (re)tighten the screwcaps where necessary. This ensures that the tubes are installed correctly:
 - Turn the screwcap clockwise as far as it will go.
 - Attach the elastic corner piece or insert the tube as far as it will go.
 - Turn the screwcap by hand anti-clockwise as far as it will go.
 - Be sure to hold on to the corner piece so that it is not pushed down by the tube connectors.
- Before sliding the Lily Pipe or the suction tube onto the angle pieces, the connections should always be moistened or greased with Vaseline to avoid damaging the O-rings. [8]
- Rotate the stoppers a quarter turn to the left and remove them. [9]
- Refill the filter completely with water. Replace and tighten the stoppers again. [10]
- Plug the power cord into the mains outlet to start the filter.

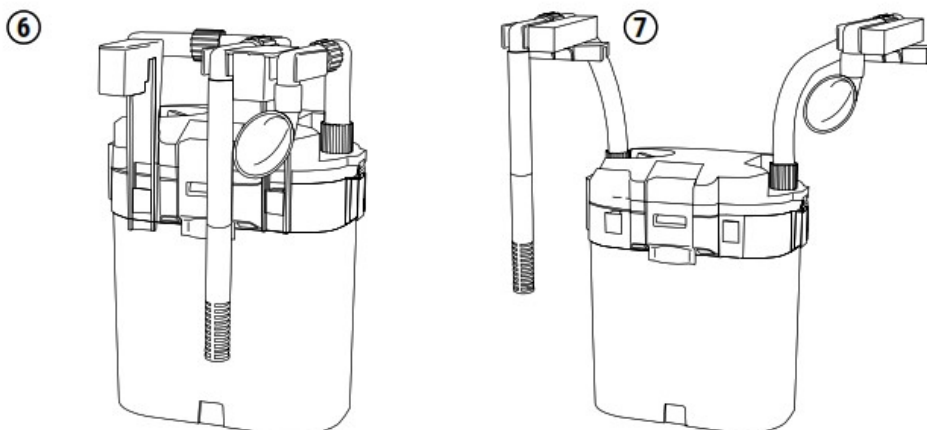

Filter and lily pipe hanging position

There are 2 possible positions for hanging the filter in an aquarium.

1. Lower position = lily pipe fully submerged [11]

In this position the lily pipe generates gentle, natural currents below the water's surface. Minimal surface movement prevents unnecessary CO₂ loss.

2. Upper position = lily pipe approximately $\frac{2}{3}$ submerged [12]

The "rippling" water return in this position delivers a rapid supply of oxygen. This is an important emergency measure if there is a lack of oxygen, as indicated by fish breathing faster. Vortices are formed that drag surface residues (film) under water, which are then filtered out.

Tip: Hang the filter in the lower position during the day, switching to the upper position at night. This saves you valuable CO₂ during the day. At night, when plants do not consume any CO₂ but instead require oxygen just like your fish, the water is enriched with oxygen.

Lily pipes can be adjusted up or down by around 10 mm in line with water levels, and they can also be rotated. Lily pipes should be positioned so as to generate even, gentle water currents throughout the entire aquarium – ideal for verdant plant growth.

⑧

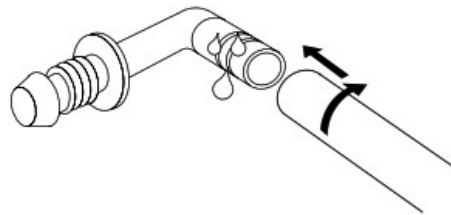
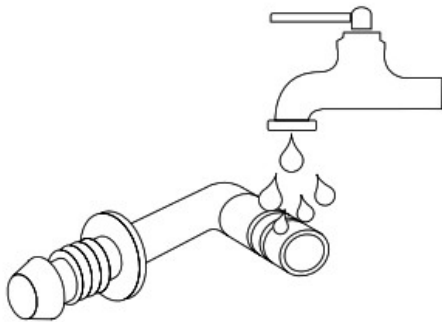

⑨

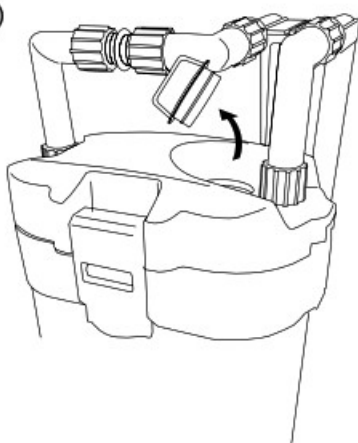

⑩

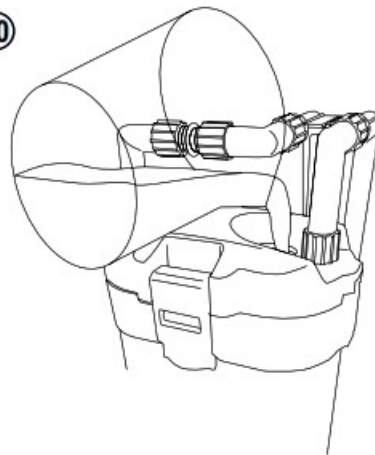

Cleaning and care

Cleaning and replacing filter material

- Clean filter media regularly to maintain optimum water flow.
- Remove the plug from the power outlet.
- You can remove the filter from the aquarium entirely.
- Open the 4 sealing clamps and remove the filter head.

- Remove the filter element. Separate the cover and filter baskets by pressing on the retaining clips. [13]

The pre-filter materials in the lower filter basket – filter sponge and fine filter pad – should be washed with aquarium water during each cleaning process, and should be replaced as necessary. You only need to clean the bio filter tubes responsible for biological cleaning in the upper filter basket if they are obviously silted up. We recommend washing the tubes in aquarium water so as not to affect the performance of the filter bacteria. Because the pores gradually close up over time and reduce performance, we recommend replacing half of the bio filter tubes around every 6 months with fresh filter material (item no. 5603).

- Reassemble the filter baskets in the correct order (sponge at the bottom, tubes at the top) and replace the cap. **CAUTION:** Make sure to replace the filter head so that the pump suction tubes fit into the cap opening! Close the 4 sealing clips and start the filter as described in point 4.

Cleaning the pump

- Remove the plug from the power outlet and open the filter as described in point 6.1.
- Loosen the two Phillips screws and carefully remove the pump cover. Carefully clean the impeller, shaft, and pump casing. The impeller (item no. 5605) and shaft (item no. 5609) are available as replacement parts.
- Reassemble the pump in reverse order. **CAUTION:** Do not over-tighten screws!

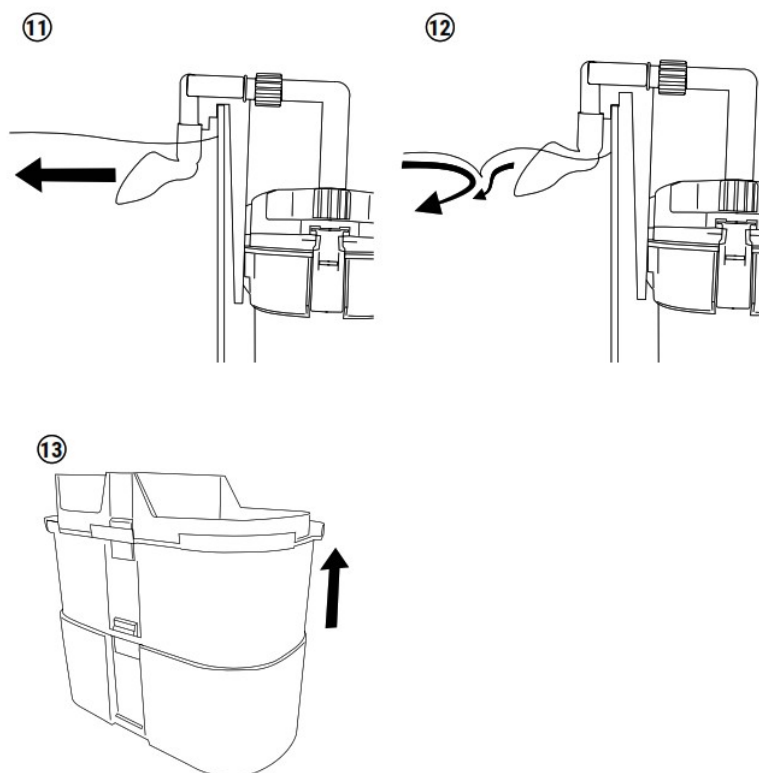

Cleaning the filter surface

Clean the filter with a soft cloth. Any limescale can be removed using a damp cloth. Dry the filter. Do not use detergents containing soap or solvents.

What if... – Troubleshooting

Faults	Cause	Remedy
Filter makes noise	Air in pump housing Vent hose (with internal spring) clogged on pump cover	Tilt the filter sideways several times so that the pump can eject the air Clean
Filter performance too weak	Filter material clogged Suction pipe or hose system clogged Pump clogged	Clean and renew Clean Clean
Filter is not running	Filter housing not completely filled with water Vent hose on pump cover clogged Pump clogged	Fill filter housing completely with water Clean Clean

Replacement parts and accessories

5605	Impeller
5609	Shaft for impeller
5606	Seal for filter head
5603	Bio filter tubes, 500 ml
5604	Filter sponge
5607	Nano FilterPad (fine filter pad filled with active charcoal)
5793	Lily pipe, transparent
1328	Lily pipe, black
5794	O-rings, set (for corner piece, 4 pieces)
5795	Suction pipe, set (split suction pipe + suction pipe extension)
1318	Holder, black, set (2x filter holders, pipe holder left, pipe holder right, 2x tube holder, 2x cover plate, spacer incl. rubber)
1319	Pipe installation, black, set (2x corner piece, elastic, 55 x 30 mm, corner piece, elastic, 22 x 30 mm, 2x corner pieces with tube screws, tube connectors, 6x screwcaps)

Technical data

Voltage/frequency: 230 V / 50 Hz

Power consumption: 5.6 W

Max. pump performance: 450 l/hour

Max. head 60 cm

Dimensions: 18 x 20.5 x 12 cm (W x H x D)

Filter volume: approximately 2 l

Power cord: 1.40 m



Disposal

Electrical equipment must not be disposed of along with the normal household waste. Please take the device to a suitable collection point for electrical equipment.

Guarantee conditions

Warranty

In the event of a defect, warranty claims apply vis-à-vis your dealer in accordance with the relevant legal provisions.

Notwithstanding the above, Dennerle is liable for damage to other property caused by a product defect as well as for any personal injury caused in accordance with the Product Liability Act.

Guarantee

Dennerle provides the purchaser with a 2-year guarantee from the date of purchase.

The guarantee covers production and material errors. Wearing parts are excluded from guarantee. During the guarantee period, Dennerle will replace and/or repair any defective parts free of charge, provided the device has been used normally in accordance with the instructions.

During the guarantee period the device may only be opened by Dennerle after-sales service, otherwise the guarantee will become null and void. If you wish to make a claim, please contact your dealer or send the device with a valid receipt and sufficient postage to Dennerle after-sales service.

Technical changes may be made without prior notice.

Sales and technical after-sales service: Dennerle GmbH • Industriestraße 4 • D-66981 Münchweiler •

www.dennerle.com

kundenservice@dennerle.com • Tel.: +49 (0)6395-9107-440

Documents / Resources

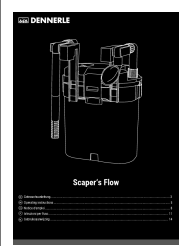
	<p>DENNERLE Scaper's Flow Hang On Filter [pdf] Instruction Manual Scaper s Flow Hang On Filter, Hang On Filter, Scaper s Flow Filter, Filter</p>
---	--

References

-  [Natur erleben - Mit den Dennerle Aquarium Systemen](#)