



DELTACO TB-135 Foldable Bluetooth Pocket Keyboard User Manual

[Home](#) » [DELTACO](#) » DELTACO TB-135 Foldable Bluetooth Pocket Keyboard User Manual 

Contents

- [1 DELTACO TB-135 Foldable Bluetooth Pocket Keyboard](#)
- [2 Product Information](#)
- [3 Product Usage Instructions](#)
- [4 Function keys used in combination with the FN key](#)
- [5 How to fold the keyboard case to a smartphone/tablet stand.](#)
- [6 Charging the battery](#)
- [7 Selecting operating system](#)
- [8 Support](#)
- [9 SIMPLIFIED EU DECLARATION OF CONFORMITY](#)
- [10 Documents / Resources](#)
 - [10.1 References](#)

DELTACO

DELTACO TB-135 Foldable Bluetooth Pocket Keyboard



Product Information

The TB-135 is a foldable Bluetooth pocket keyboard with function keys used in combination with the FN key. The keyboard is automatically powered on when unfolded and off when folded. The keyboard also has a sleep mode that activates after 10-15 minutes of inactivity. The product is manufactured by a Nordic brand and has a maximum RF output (EIRP).

Product Usage Instructions

- To fold the keyboard case into a smartphone/tablet stand, follow these steps:
 - Press CTRL + ALT + F11 for , F10 for }, F7 for {, F5 for ><, and = for |.
 - Put your smartphone or tablet on the stand.
- Wait until the GREEN LED light is turned off before folding the keyboard.
- To wake the keyboard from sleep mode, press any key. If you have any problems with the use or installation of your product, contact support by email at help@deltaco.eu. Provide your operating system and item number for better assistance.
- Dispose of the product properly by returning it to a collection point for recycling electric and electronic devices. Do not treat it as regular household waste.

Function keys used in combination with the FN key



+KEY	Android	iOS	Win
 Esc	HOME	HOME	ESC
 F1	SEARCH	SEARCH	F1
 F2	SELECT ALL	SELECT ALL	F2
 F3	COPY	COPY	F3
 F4	PASTE	PASTE	F4
 F5	CUT	CUT	F5
 F6	PREVIOUS TRACK	PREVIOUS TRACK	F6

+KEY	Android	iOS	Win
 F7	PLAY/PAUSE	PLAY/PAUSE	F7
 F8	NEXT TRACK	NEXT TRACK	F8
 F9	VOLUME -	VOLUME -	F9
 F10	VOLUME +	VOLUME +	F10
 F11	NONE	NONE	F11
 F12	NONE	NONE	F12

CTRL + ALT +
F11 = \ F10 = } F7 = { F5 = € >< = |

How to fold the keyboard case to a smartphone/tablet stand.

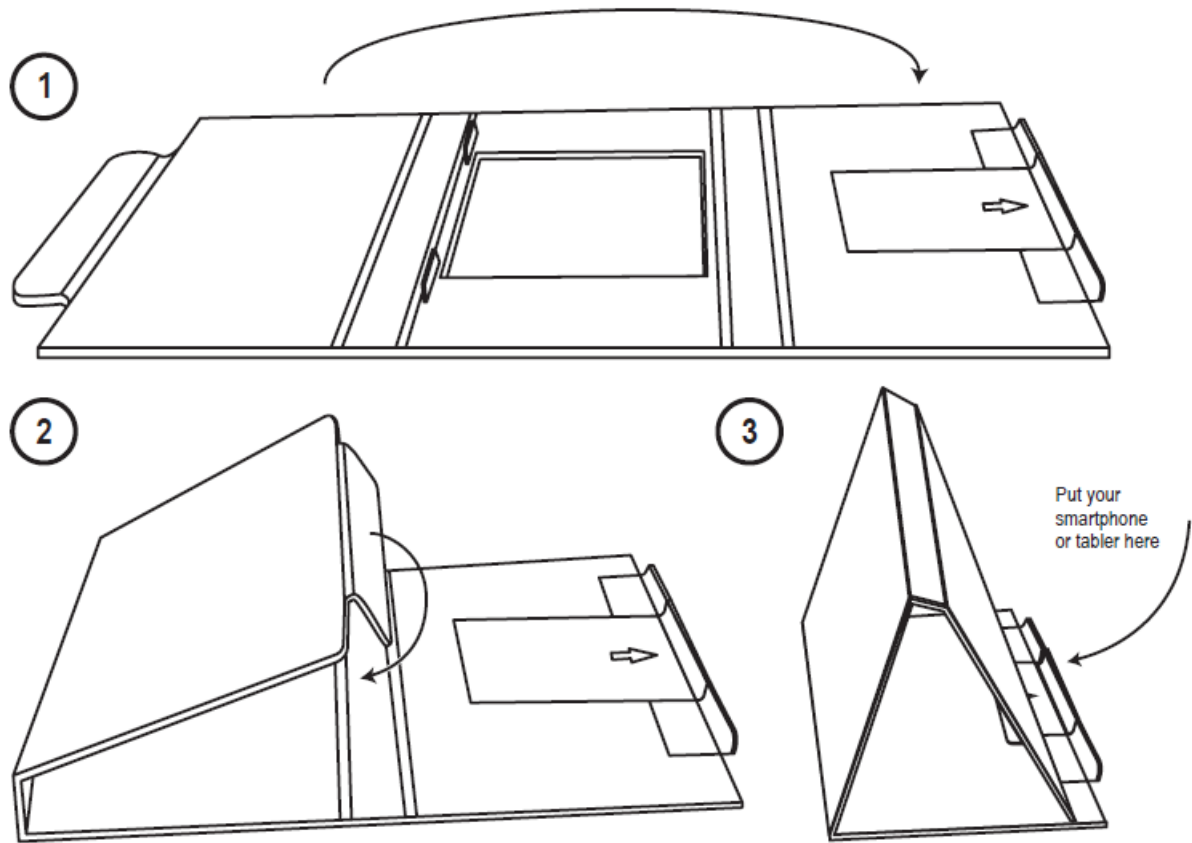

The keyboard is automatically powered on when unfolded and powered off when folded.

Charging the battery

- The battery needs to be recharged when the RED LED is lit.
- Connect the supplied charging cable to the CHARGE INPUT and a USB port on your computer or USB charger.
- The RED LED is lit during charging.
- When the battery is fully charged, the RED LED is turned off.
- An empty battery is fully charged in approximately 2 hours.

Pairing the keyboard with a Bluetooth device

- Power the keyboard on.
- Wait until the GREEN LED is turned off.
- Press and hold the FN key and then press the C key.
- The BLUE LED starts blinking.
- The keyboard is now detectable by other Bluetooth devices.
- On your tablet, search for Bluetooth devices.
- Refer to your tablet user manual if needed.
- On your tablet, select the Bluetooth device called
- "Bluetooth 3.0 Keyboard".
- Type in the numeric code that appears on the screen of your tablet.
- The BLUE LED stops blinking, indicating a successful pairing.

Selecting operating system

- Press and hold the FN key and then press the iOS, Android, or Windows keys.

Sleep mode

- The keyboard will go into sleep mode after 10-15 minutes.
- Press any key to wake from sleep.

Support

- Please contact us if you have any problems with the use or installation of your product.
- We appreciate you being prepared to provide us with some basic information such as your operating system and the item number so that we may better help you.
- Contact us by e-mail: help@deltaco.eu.
- More product and support information can be found at www.deltaco.eu.

SIMPLIFIED EU DECLARATION OF CONFORMITY

The simplified EU declaration of conformity referred to in Article 10(9) shall be provided as follows: Hereby, DistIT Services AB declares that the radio equipment type wireless device is in compliance with Directive 2014/53/EU. The full text of the EU Declaration of Conformity is available at the following internet address: www.aurdel.com/compliance/. DistIT Services AB, Suite 89, 95 Mortimer Street, London, W1W 7GB, England
DistIT Services AB, Glasfibergatan 8, 125 45 Älvsjö, Sweden.

Documents / Resources

	<p>DELTACO TB-135 Foldable Bluetooth Pocket Keyboard [pdf] User Manual TB-135 Foldable Bluetooth Pocket Keyboard, TB-135, Foldable Bluetooth Pocket Keyboard, Bluetooth Pocket Keyboard, Pocket Keyboard, Keyboard</p>
---	--

References

-  aurdel.com/compliance/
-  deltaco.eu