



# DELTACO SH-WS02 Smart Door and Window Sensor User Manual

[Home](#) » [DELTACO](#) » DELTACO SH-WS02 Smart Door and Window Sensor User Manual 

## Contents

- 1 [DELTACO SH-WS02 Smart Door and Window Sensor](#)
- 2 [Product Information: SMART HOME SH-WS02 SMART DOOR & WINDOW SENSOR](#)
- 3 [Placement](#)
- 4 [Product Usage Instructions](#)
- 5 [Mounting](#)
- 6 [Install and use](#)
- 7 [Cleaning and maintenance](#)
- 8 [Documents / Resources](#)
  - 8.1 [References](#)

# DELTACO

**DELTACO SH-WS02 Smart Door and Window Sensor**

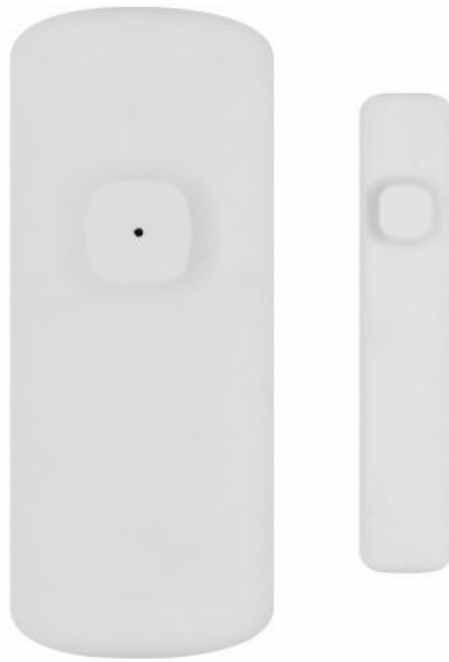

## **Product Information: SMART HOME SH-WS02 SMART DOOR & WINDOW SENSOR**

The SMART HOME SH-WS02 is a door and window sensor manufactured by a Nordic brand. It requires an application for proper functioning, and it is recommended to use the Deltaco Smart Home application. The product comes with 3M stickers for mounting, and it is advised to clean the surface before placing the stickers to ensure they adhere well. The product should not be disposed of as regular household waste, but instead returned to a collection point for recycling electric and electronic devices.

### **Placement**

Placement is your choice. Normally this product is placed on the door or window frames.

We recommend that you avoid placing the product too low, to prevent accidental damage to the product. We also recommend avoiding placing the product close to magnets or within magnetic fields. The gap between the sensor and receiver needs to be 15 mm or less. Less is better and prevents false alarms.

This device can be used to detect opening or closing of doors or windows or drawers.

### **Product Usage Instructions**

1. Download the Deltaco Smart Home application.
2. Place the product on the door or window frame using the provided 3M stickers.
3. Consider cleaning the surface before placing the stickers to ensure they adhere well.
4. Enter the device name in the application.
5. Do not use cleaning solvents or abrasives on the product.
6. Do not attempt to repair the device. If it is not working correctly, replace it with a new one.
7. Clean the outside of the device with a soft cloth.
8. If you need further assistance, contact us by email at [help@deltaco.eu](mailto:help@deltaco.eu).

### **Mounting**

Use the 3M stickers to place the product. Please consider cleaning the surface before placing the stickers to ensure they adhere well.

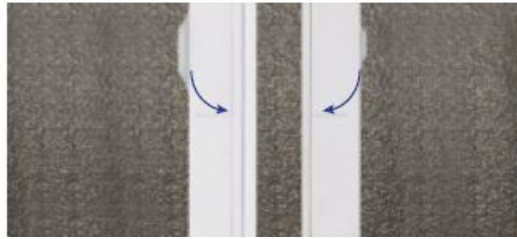

Align the line on the sensor with the line on the receiver.

### **Battery**

This product uses a built-in battery. When the battery is low, charge the sensor with a USB power adapter (5V/1A) via the USB Micro-B port.

### **Reset**

Press the reset button for 5 seconds until the LED starts flashing.

### **Alarm**

When the sensor detects a change, it activates an alarm. The LED will flash red one time. Data will be sent to the app.

### **Install and use**

1. Download and install the app “Deltaco smart home” from Apple App Store or Google Play Store on your mobile device.
2. Launch the app “Deltaco smart home”.
3. Create a new account or log in to your existing account.
4. Tap “+” to add the device.
5. Choose category and then the type of product from the list.
6. Connect the device to power.
7. If the LED/lamp does not flash: Reset the device. If the status indicator flashes: Confirm in the app.
8. Confirm the Wi-Fi network and password.
9. Enter the device name.

### **Cleaning and maintenance**

- Do not use cleaning solvents or abrasives.
- Do not clean the inside of the device.
- Do not attempt to repair the device. If the device does not operate correctly, replace it with a new device. Clean the outside of the device using a soft cloth. Support
- More product information can be found at [www.deltaco.eu](http://www.deltaco.eu).

### **Documents / Resources**

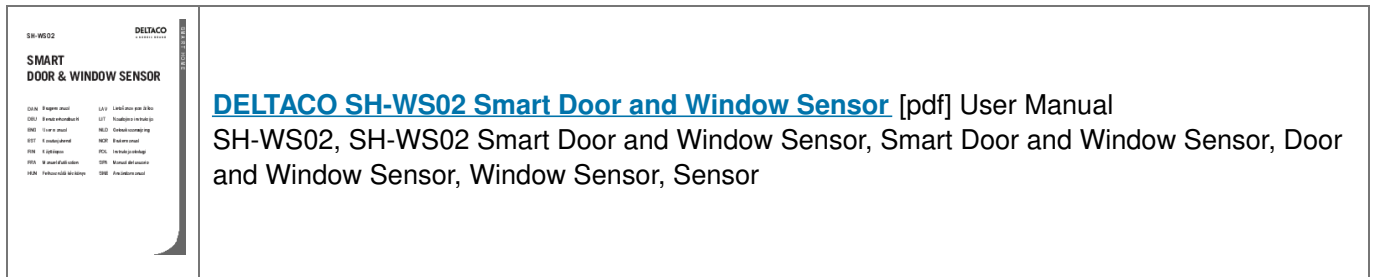

## [DELTACO SH-WS02 Smart Door and Window Sensor](#) [pdf] User Manual SH-WS02, SH-WS02 Smart Door and Window Sensor, Smart Door and Window Sensor, Door and Window Sensor, Window Sensor, Sensor

### References

- [deltaco.eu](#)
- [Aurdal - Distributør av den nyeste og beste teknologien](#)
- [Aurdal - Distributør av den nyeste og beste teknologien](#)
- [deltaco.se/](#)
- [Alla produkter](#)
- [STREETZ Trådlösa in-ear hörlurar med laddningsetui, BT 5, TWS, vit](#)
- [deltaco.se/produkter/xx](#)