



# DELTACO LDT26-C024 Counterbalance Monitor Arm User Manual

[Home](#) » [DELTACO](#) » DELTACO LDT26-C024 Counterbalance Monitor Arm User Manual 

## Contents

- [1 DELTACO LDT26-C024 Counterbalance Monitor Arm](#)
- [2 A Nordic Brand Counterbalance Monitor Arm](#)
- [3 Product Usage Instructions](#)
- [4 DIMENSION](#)
- [5 TOOLS](#)
- [6 INSTALLATION](#)
- [7 Adjustments](#)
- [8 Documents / Resources](#)
- [9 Related Posts](#)

# DELTACO

**DELTACO LDT26-C024 Counterbalance Monitor Arm**



## **A Nordic Brand Counterbalance Monitor Arm**

The OFFICE ARM-0351 is a monitor arm designed to provide a stable and adjustable mount for your computer monitor. It is a Nordic brand product that comes with assembly instructions and safety warnings. The monitor arm is designed to hold monitors up to a certain weight, and usage with heavier monitors may cause instability and possible injury.

### **Product Usage Instructions**

1. Read the entire instruction manual before installation and assembly. If you have any questions or concerns, contact your retailer for assistance.
2. Use caution when using the monitor arm with products heavier than the rated weight, as this may cause instability and potential injury.
3. Follow the assembly instructions carefully to ensure proper installation. Improper installation may result in serious injury.
4. Use safety gear and proper tools when installing the monitor arm. Only a qualified person should install the product.
5. Make sure that the supporting surface can safely support the weight of the monitor arm and monitor.
6. Hold the monitor arm horizontally to avoid damage to the monitors or monitor arm. If needed, ask for help from a second person.
7. If the monitor arm is falling, turn it counterclockwise until it stays in place. If the monitor arm is rising too much, turn it clockwise until it stays in place.
8. Adjust the monitor arm as needed for optimal viewing. Hold the monitor arm horizontally and carefully release pressure until it is fully extended.

By following these usage instructions, you can ensure safe and proper use of your OFFICE ARM-0351 Nordic Brand Counterbalance Monitor Arm.

DIMENSION

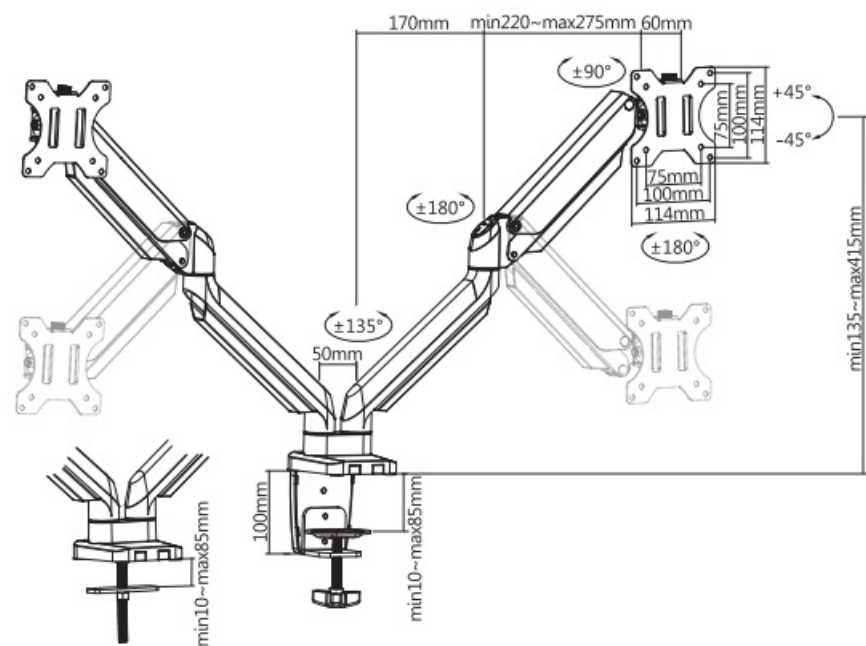

TOOLS

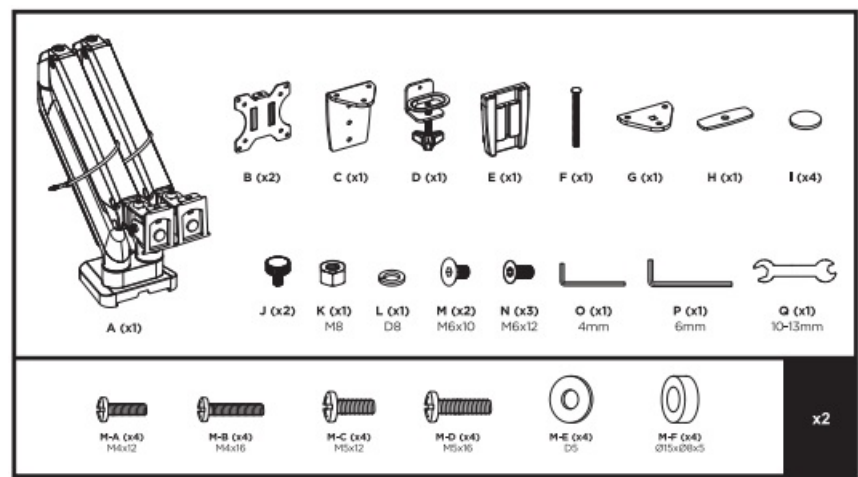

INSTALLATION

2a-1

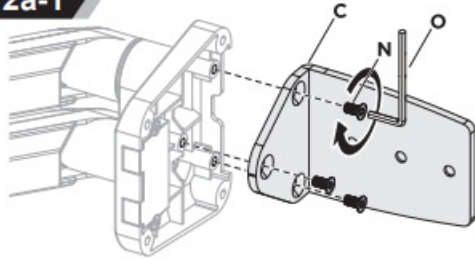

2a-2

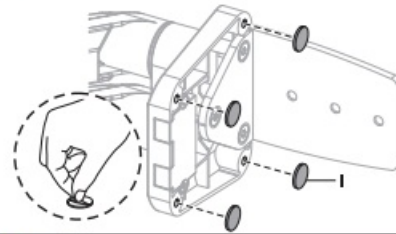

2a-3

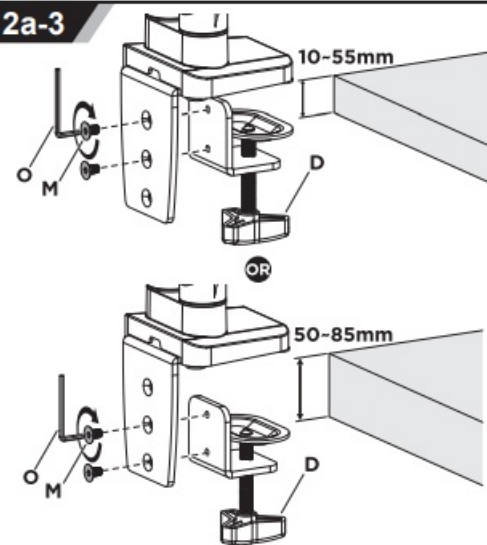

2a-4

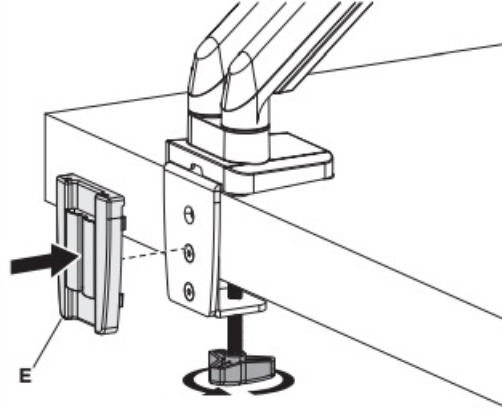

2b-1

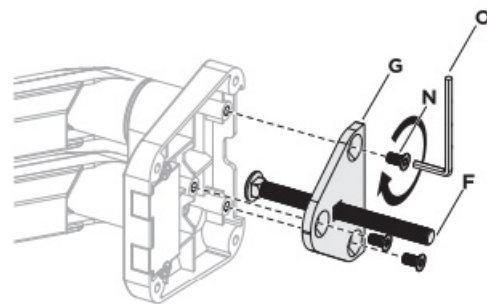

2b-2

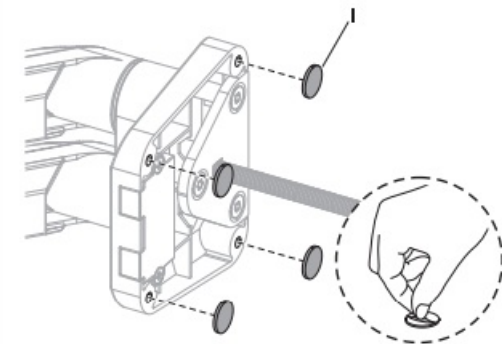

2b-3

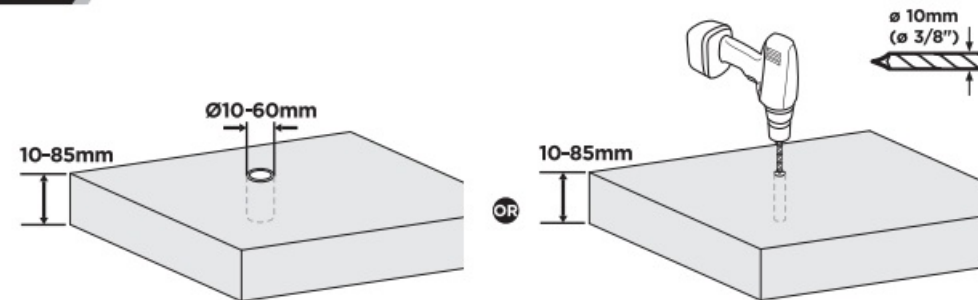

2b-4

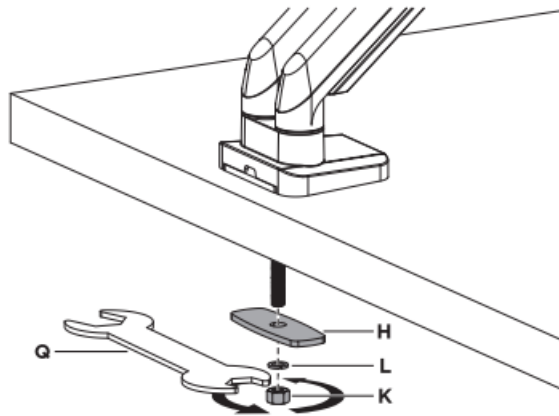

3

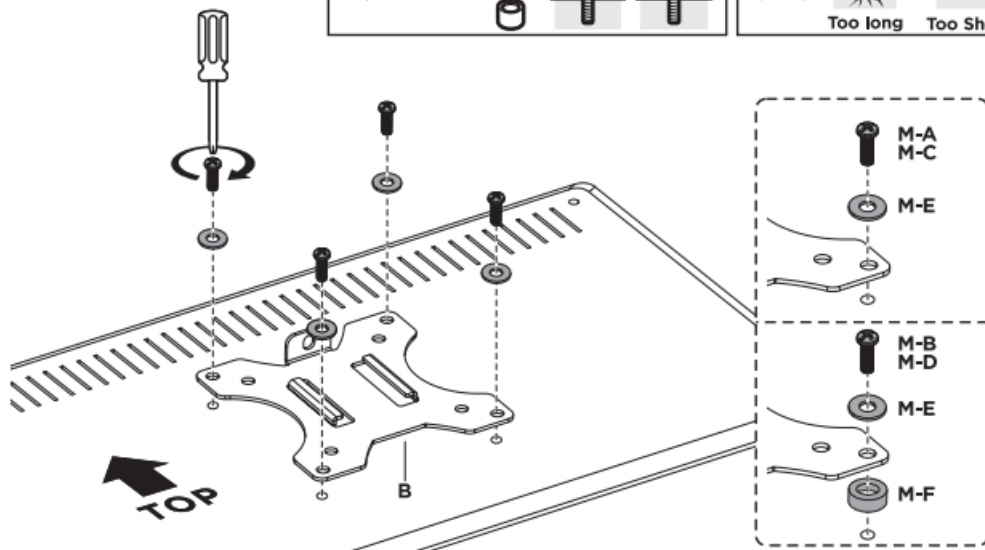

4

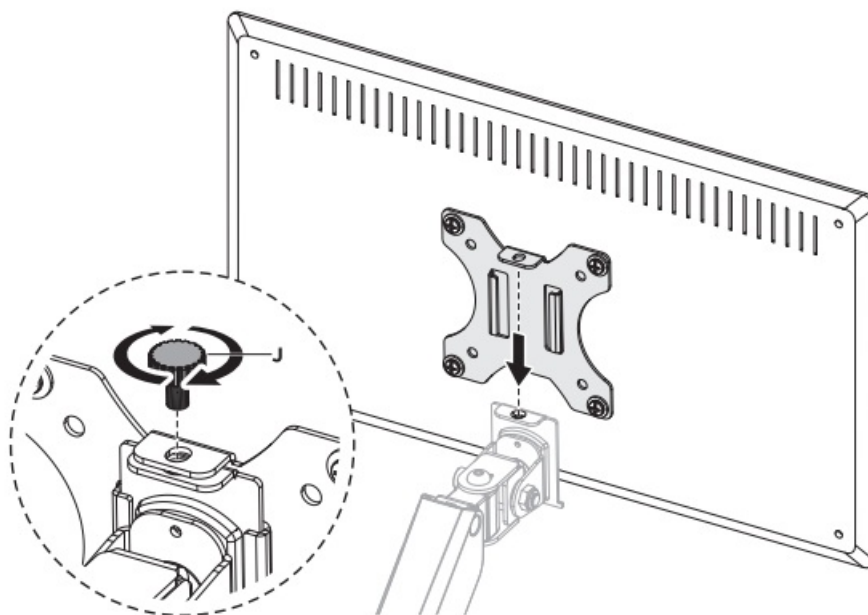

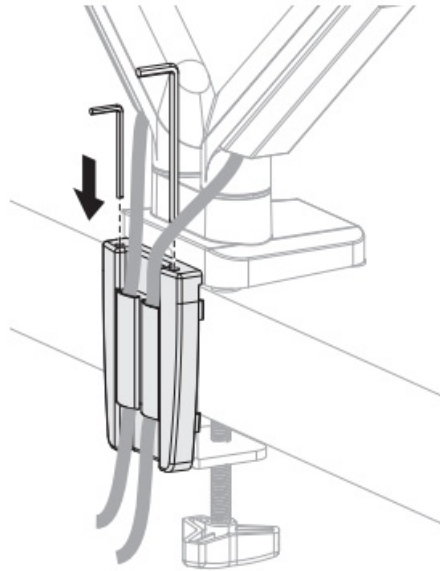

## WARNING

**STORED ENERGY:** Hold the monitor arm firmly with 1 hand on each opposite side. Ask another person to cut off the cable tie. Slowly release the pressure until it is fully extended.

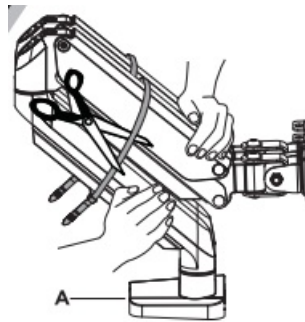

## Adjustments

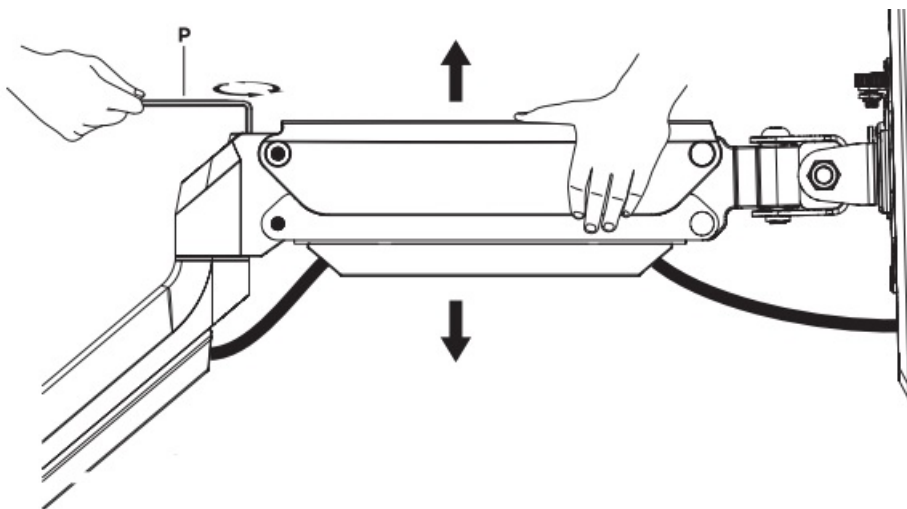

Hold the monitor arm horizontally to avoid damage to monitors or monitor arm. Ask for help from a 2nd person if needed.

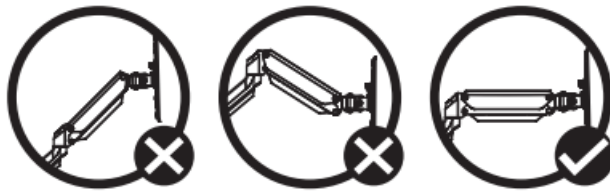

If the monitor arm is falling, turn it counterclockwise until it stays in place



If the monitor arm is rising too much, turn it clockwise until it stays in place.

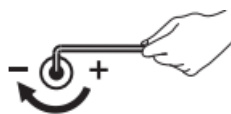

If the monitor does not stop at desired position, tighten the screws.

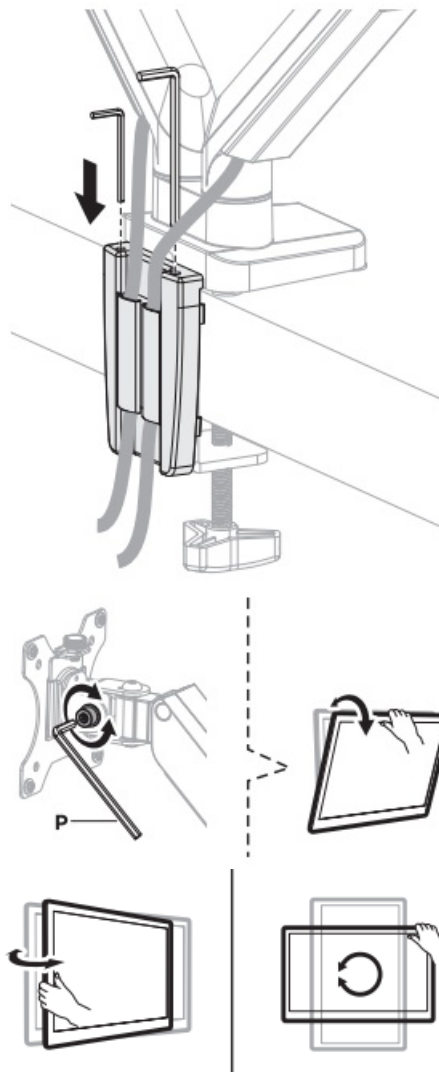

1. Read the entire instruction manual before you start installation and assembly. If you have any questions regarding any of the instructions or warnings, please contact your retailer for assistance.
2. **Caution:** Usage together with products heavier than the rated weight may result in instability which can cause possible injury.
3. The product must be attached as specified in assembly instructions. Improper installation may result in serious injury.
4. Safety gear and proper tools must be used. This product should only be installed by a qualified person.
5. Make sure that the supporting surface will safely support the combined weight of the equipment and all attached hardware and components.
6. Use the mounting screws provided and do not over tighten the mounting screws.
7. This product contains small items that could be a choking hazard if swallowed. Keep these items away from children.
8. This product is intended for indoor use only. Using this product outdoors could lead to product failure and personal injury.
9. Important: Ensure that you have received all parts according to the component checklist prior to installation. If any parts are missing or faulty, contact Deltaco or the retailer where you purchased the product.
10. Caution: Do not exceed the marked max weight. Serious injury or property damage may occur!
11. Check that the product is secure and safe to use, at regular intervals (at least every three months).

DistIT Services AB, Glasfibergatan 8, 125 45 Älvsjö, Sweden

1.

## Documents / Resources

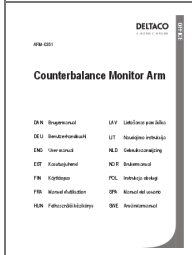
	<p><a href="#">DELTACO LDT26-C024 Counterbalance Monitor Arm [pdf] User Manual</a>  LDT26-C024 Counterbalance Monitor Arm, LDT26-C024, Counterbalance Monitor Arm, Monitor Arm, Arm</p>
---	---