



## DELTA UH4100 Multi Ball Holder Storage Net Instructions

[Home](#) » [Delta](#) » DELTA UH4100 Multi Ball Holder Storage Net Instructions 

### DELTA UH4100 Multi Ball Holder Storage Net Instructions



#### Contents

- 1 [Assembly instructions](#)
  - 1.1 [Parts](#)
  - 1.2 [BACK VIEW OF PLATES AND WIRE ENDS](#)
- 2 [Assembly video](#)
- 3 [Service](#)
- 4 [Documents / Resources](#)
- 5 [Related Posts](#)

#### Assembly instructions

## Parts

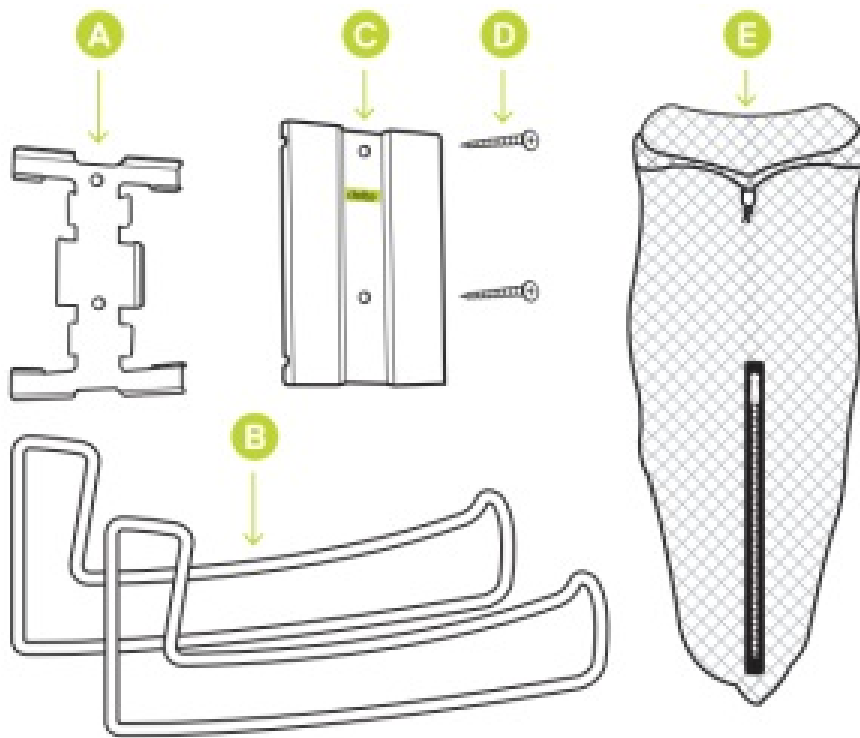

- A. x1 — Back Plate
- B. x2 — Wire Ends
- C. x1 — Front Plate
- D. x2 — Screws
- E. x1 — Net

## Tools Required

Hand Drill 1/8" (3mm)

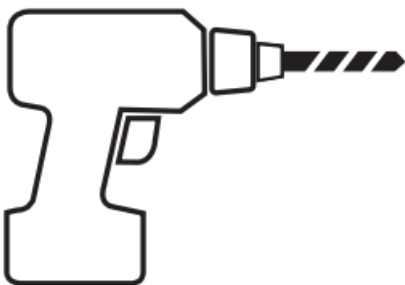

Way of locating studs within the wall (see hardware store for advice)

1. Identify where wooden stud lies within wall, drill pilot holes for wood screws.



**IMPORTANT SAFETY NOTE** Beware of drilling into electrical wire or pipes within wall!

Place front plate on the corner of a table/flat surface. Position wire ends face down into slots of front plate. Slide under small center plate. **(FIGURE 1).**

**NOTE:** Be sure front of wire ends are facing down. Insert back plate on top. Be sure wire ends are covered and

fit securely between back and front plates. **(FIGURE 2)**

#### BACK VIEW OF PLATES AND WIRE ENDS

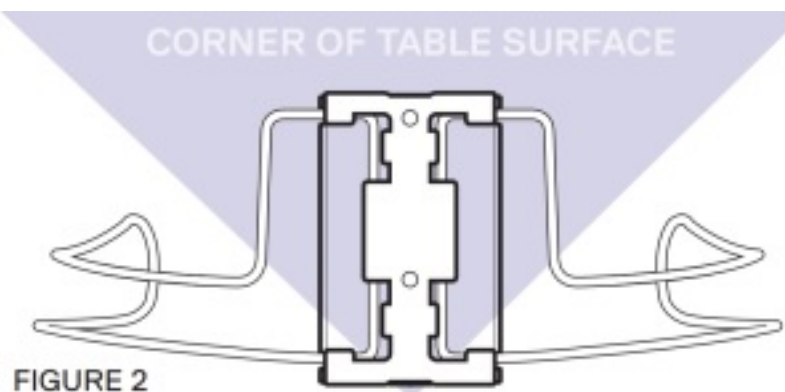
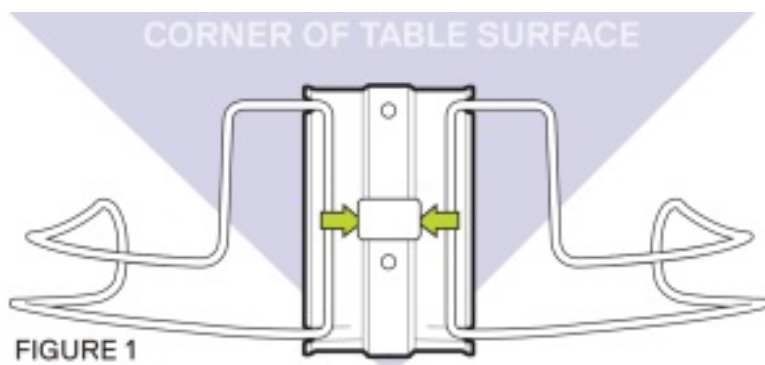

**WARNING:** Do not exceed maximum total weight limit of 4.5kg/10lbs. To avoid injury, Do not overload.

2. Once assembled, transport to pre-drilled wall location. Secure to wall with both screws.

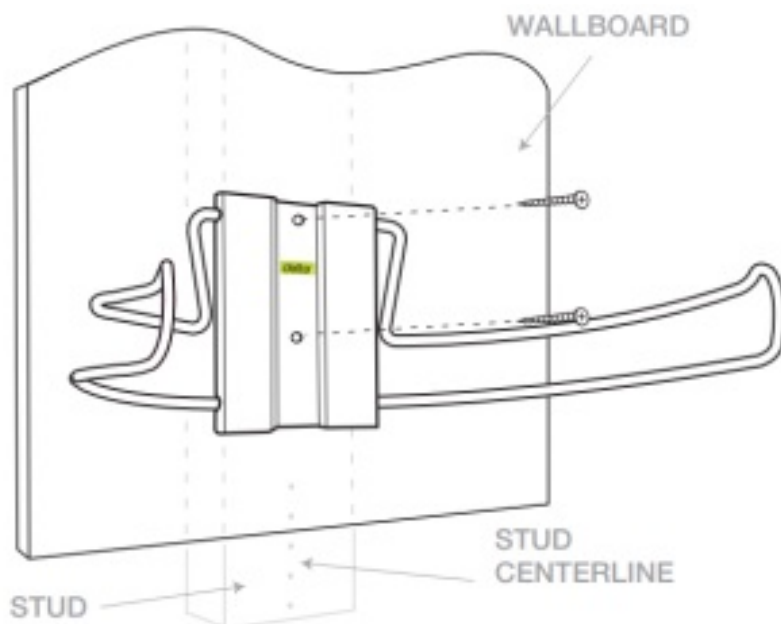

3. After wall installation, slide net onto each arm.

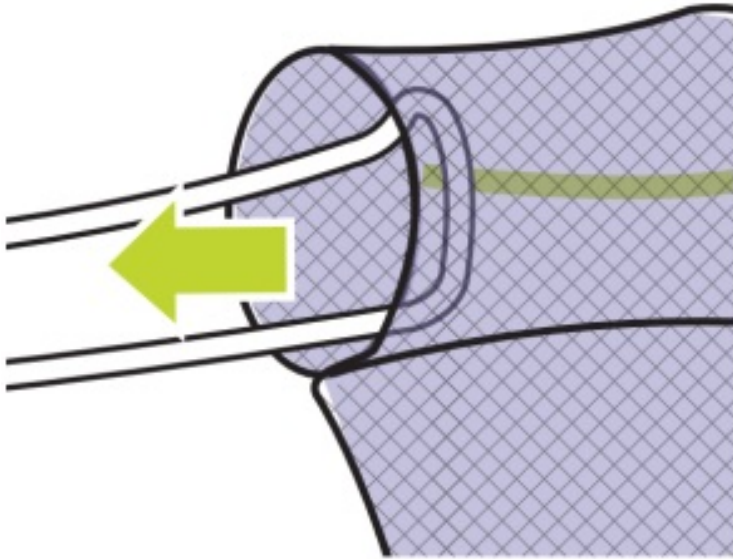

### Assembly video

Visit design by [delta.com/downloads](https://delta.com/downloads)



### Service

Please do not return to store; for immediate response email [service@designbydelta.com](mailto:service@designbydelta.com)



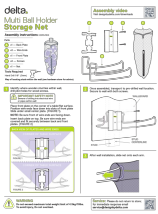

[DELTA UH4100 Multi Ball Holder Storage Net](#) [pdf] Instructions  
UH4100, Multi Ball Holder Storage Net