

delta PD5-NSW250 Ethernet Switch



delta PD5-NSW250 Ethernet Switch User Guide

[Home](#) » [Delta](#) » delta PD5-NSW250 Ethernet Switch User Guide 

Contents

- [1 delta PD5-NSW250 Ethernet Switch](#)
- [2 Product Specifications](#)
- [3 Product Specification](#)
- [4 DIMENSION](#)
- [5 Regulatory Compliance Information](#)
- [6 FCC](#)
- [7 Frequently Asked Questions](#)
- [8 Documents / Resources](#)
 - [8.1 References](#)
- [9 Related Posts](#)



delta PD5-NSW250 Ethernet Switch



Product Specifications

- **Product:** NSW250
- **Dimensions:** 425mm x 433mm x 44.3mm
- **Weight:** 9.12kg
- **Power Source:** 100-240V, 6 A, 50-60Hz
- **Mounting Mode:** Rackmount/Wall mount
- **Operation Temperature:** 0 ~ 45°C
- **Operation Humidity:** Sea Level

Product Specification

NSW250

- **Product dimensions:** 425mm x 433mm x 44.3mm
- **Product weights:** 9.12kg
- **Power source;** 100-240V, 6 A, 50-60Hz
- **Mounting mode:** Rackmount Wall mount
- **Operation temperature:** 0 ~ 45 C
- **Operation humidity:**
- **Altitude:** Sea Level

Remove the inner rail

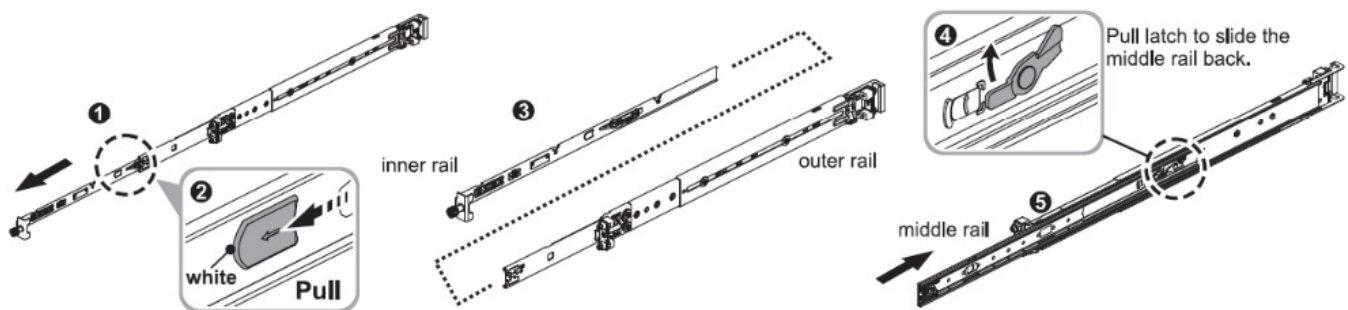

Install the inner rail onto the chassis

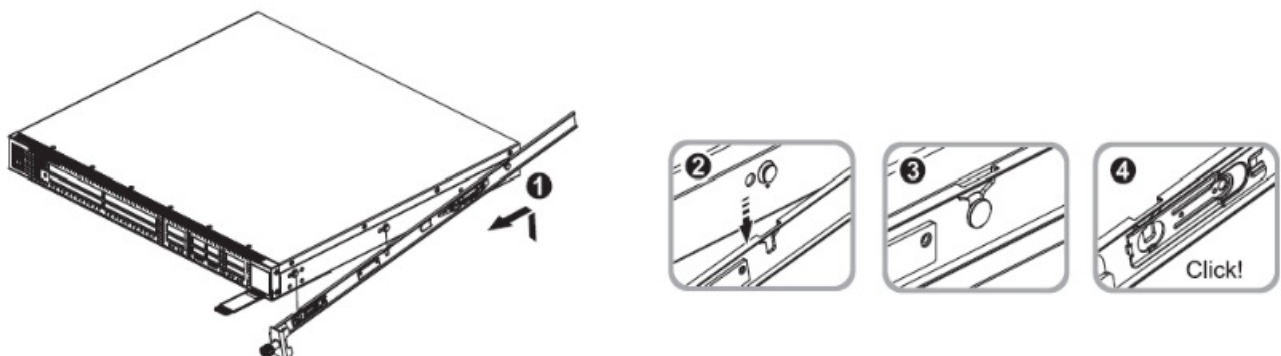

Installing the rail on the rack(For 4 post rack)

1. Press the latch of the rear bracket and install it on the rear rack post.

2. Press the latch of the front bracket and install it on the front rack post.

Detach Bracket from Rack Post

1. Press the latch of the front bracket and install it on the front rack post.
2. Press the latch of the rear bracket and install it on the rear rack post.

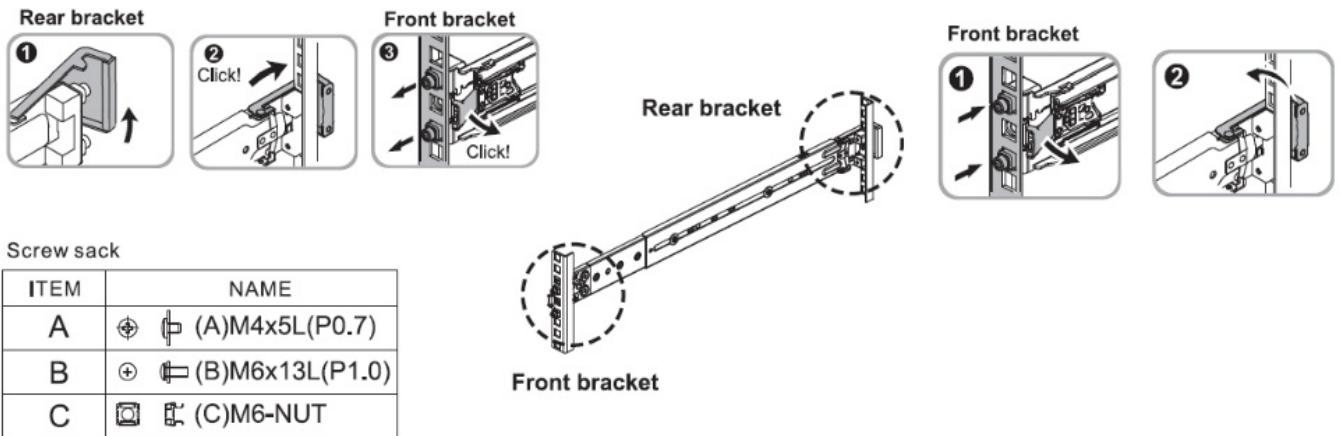

- For 2-post rack(center position)
- For 2-post rack(Flush position)

1. Remove the front and rear brackets of the rail first.
2. 3 Installed front and rear brackets based on the position demand. (center position and flush position)

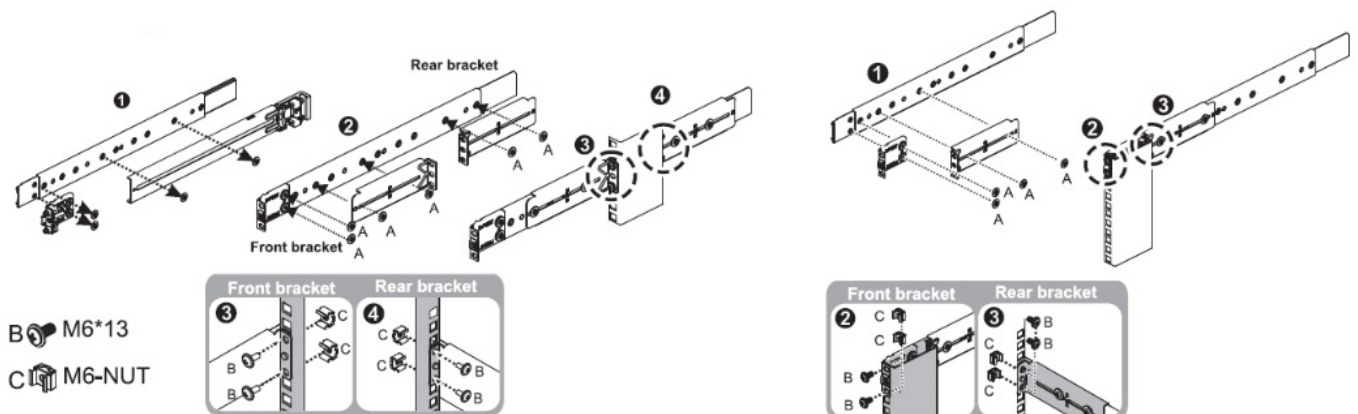

Installing the system into the rail(Stab In)

1. Pull the middle rail fully extended in the lock position, and ensure the ball-bearing retainer is located at the front of the middle rail.
2. Insert the chassis into the middle-outer rail.
3. When hit a stop, please pull/push the blue release tab on the inner rail.
4. Tighten the chassis with a thumb screw.

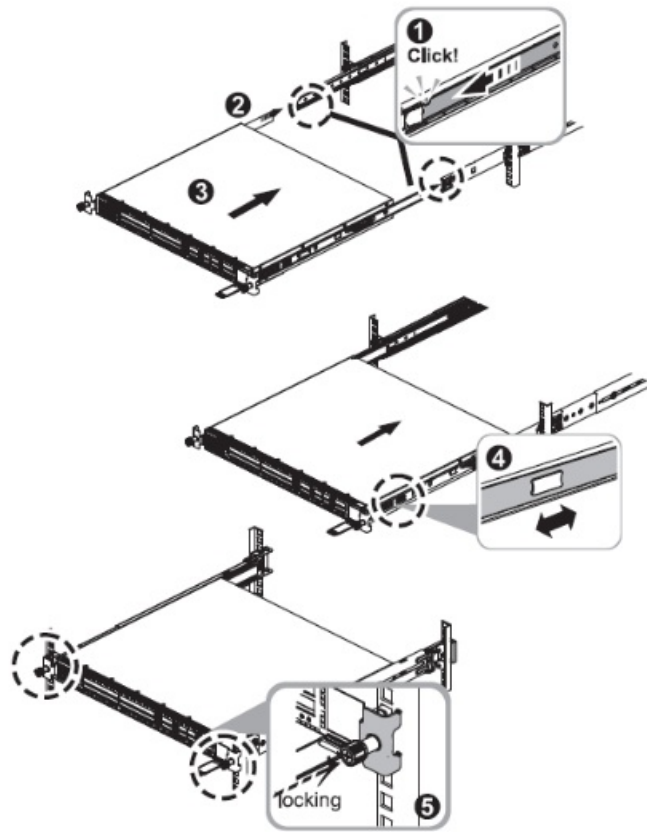

Remove the chassis from rack

1. Loosen the thumb screw to pull out the chassis
2. Pull the disconnect tab
3. Remove the chassis from the rail.
4. Pull the tab to retract the middle rail back.

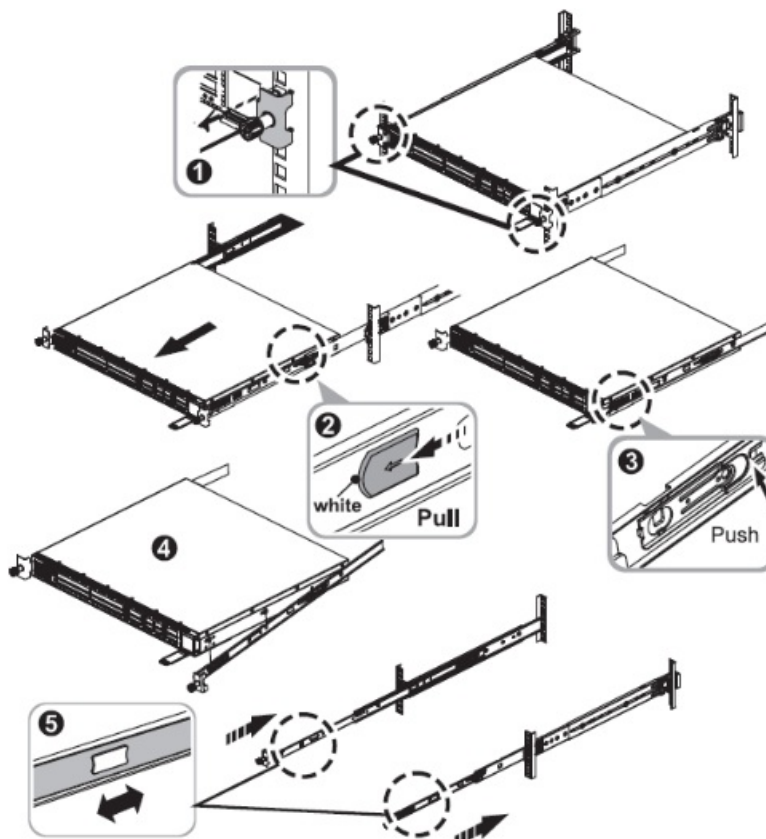

Installing the system into the rail(Drop-In)

1. Pull the inner rail out.
2. Install the chassis
3. Pull the released latch to retract the chassis.
4. Fasten the thumb screw.

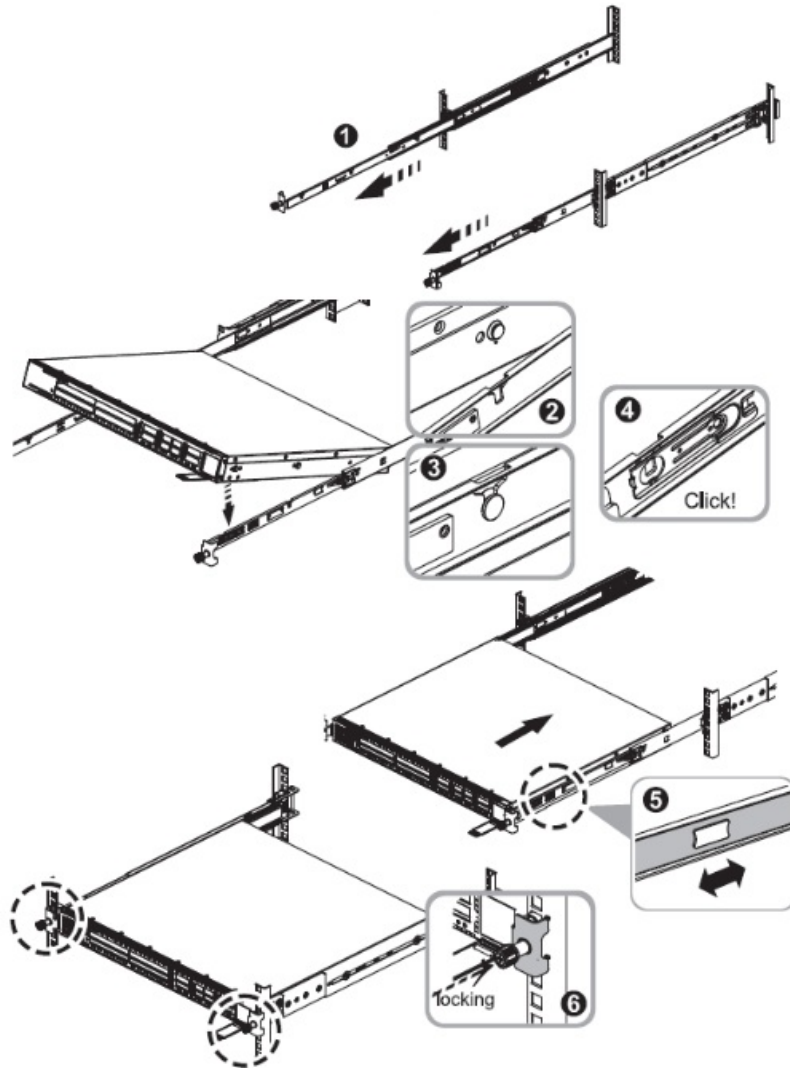

Remove the chassis from the rack(Drop In)

1. Loosen the thumb screw.
2. Pull out the chassis.
3. Press the keyhole spring plate to remove the inner rail.
4. Press the released tab to retract the inner rail.

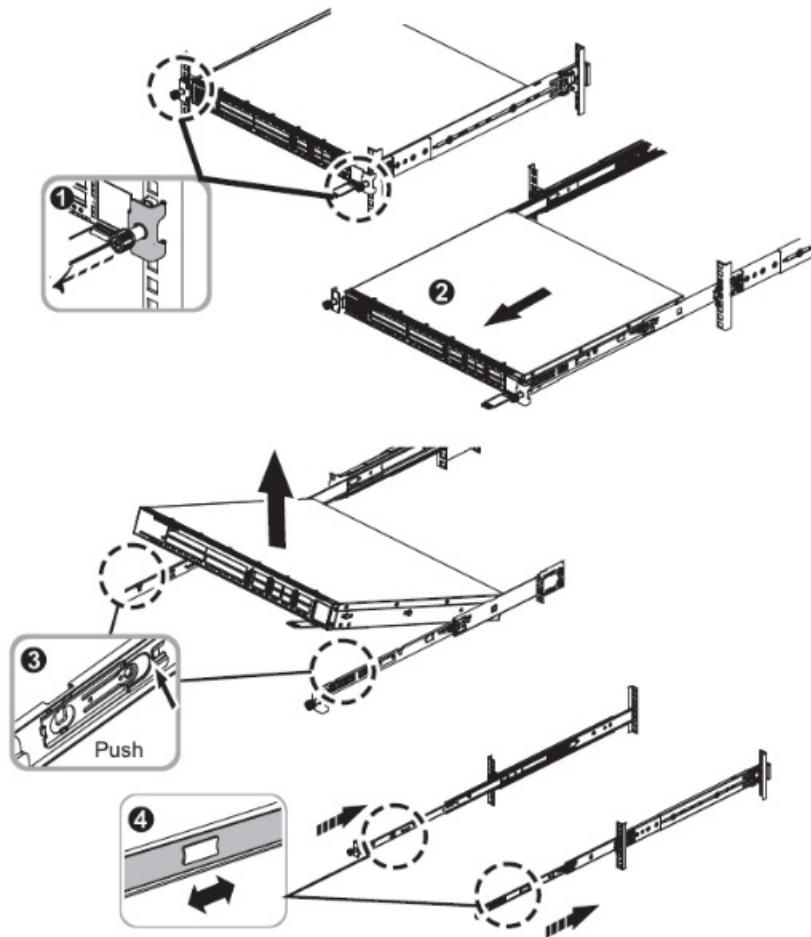

Rack & Stack NSW 250 on a 4-Post Rack

- Mount the rails first to the rack

L & R is mentioned on the rails for easy understanding L= Left, R = Right

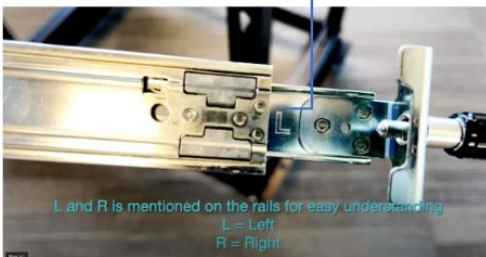

Back

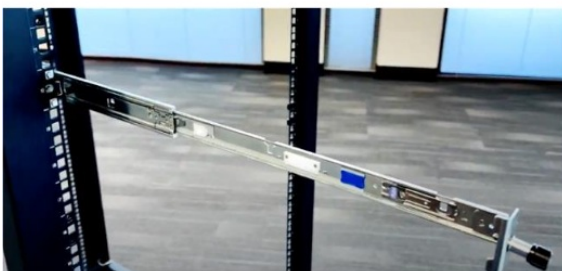

- Verify the direction of the notches and slide the device into the grooves so that the pins on the switch will align with the grooves on the rail.

Please ensure these notches are facing downwards

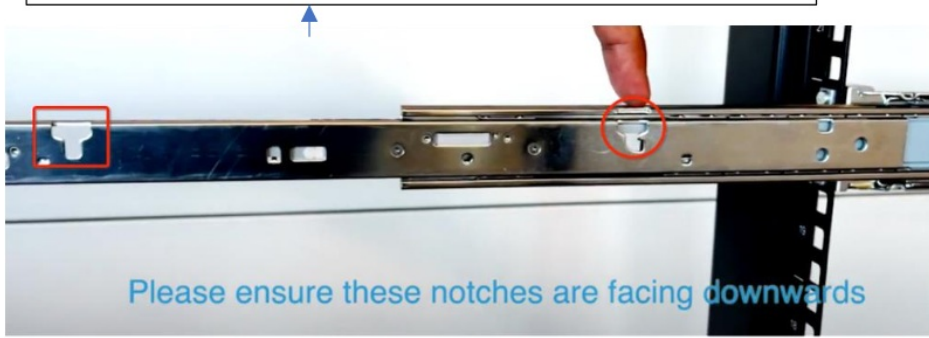

- After verifying that all the pins are sitting in the grooves, pull the blue pin on the side towards the front of the rail so that it releases the lock to push the switch into place. Twist the screws to tighten it in place

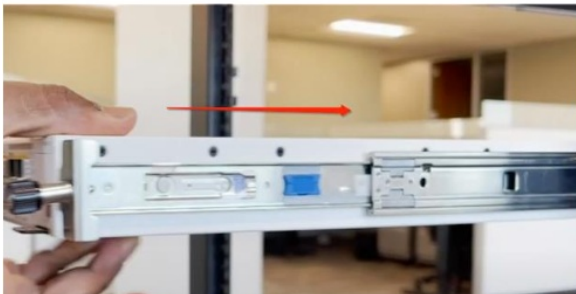

Rack & Stack NSW250 on a 2-Post Rack

- Unpack the rails from the box and verify the L and R sides >> Remove the screws to remove the back plate off the rail.

L & R is mentioned on the rails for easy understanding L= Left, R = Right

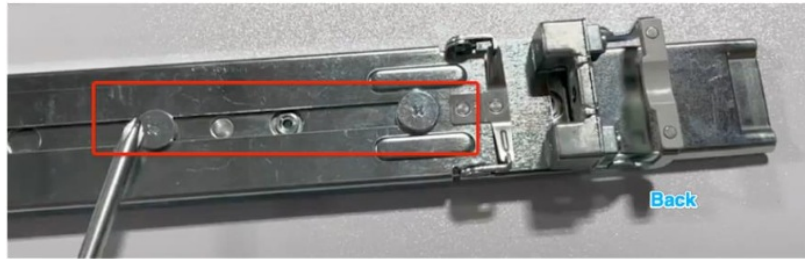

Remove the two screws

Remove the back

- Find a small rail named "Rail B" in the box and let's install that onto the main rail as below:

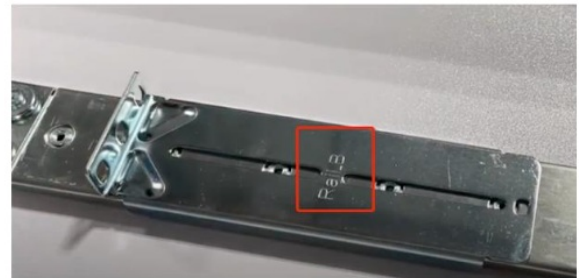

We will mount the other plate now



Use the new screws

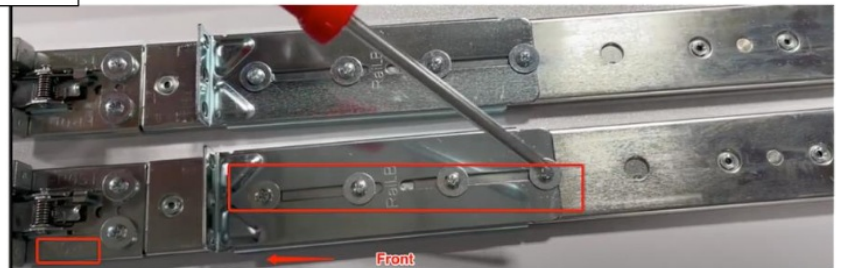

- Verify the direction of the rails and attach them to the rails using the 12-24 screws to the rack. Tighten them using a screwdriver.

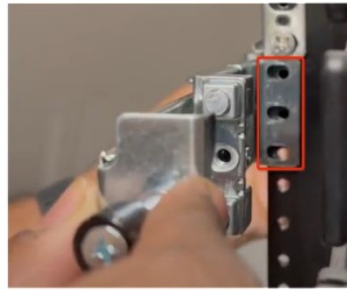
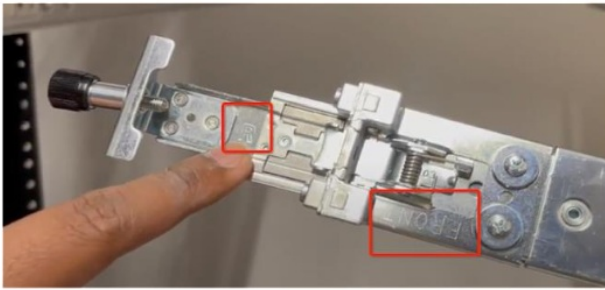

Please ensure these notches are facing downwards

- Once the switch fits in the grooves, pull the blue tab on the side of the rail towards the front of the rail and secure the switch to the rail by tightening the screw.



NSW250 dry wall mount.

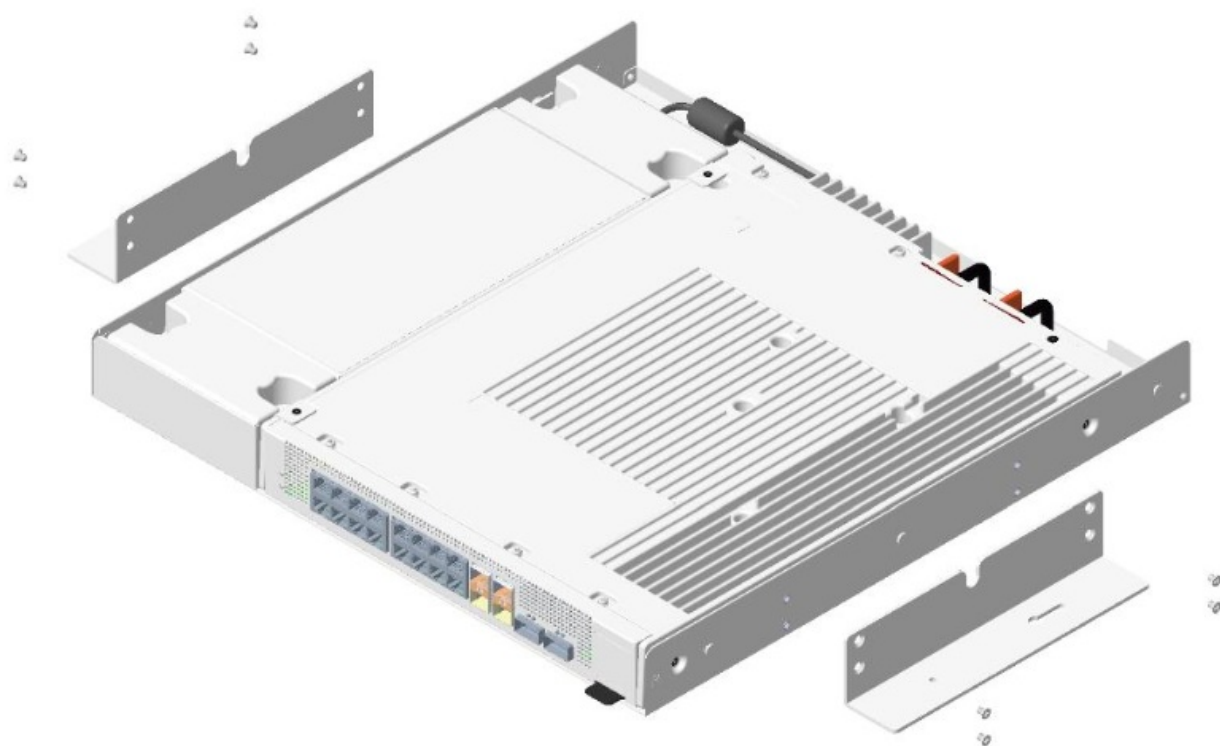

DIMENSION

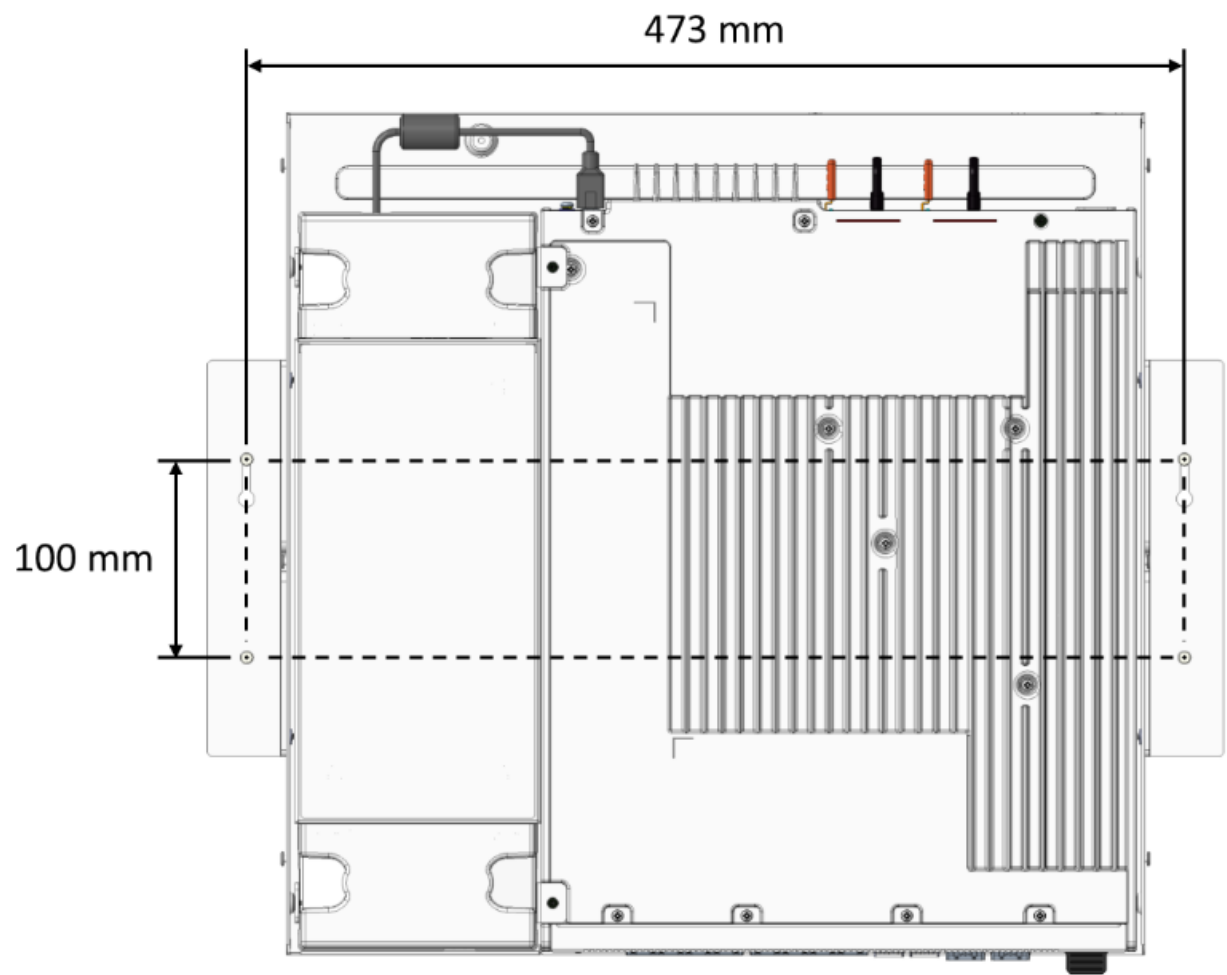

NSW250 dry wall mount without bottom tray

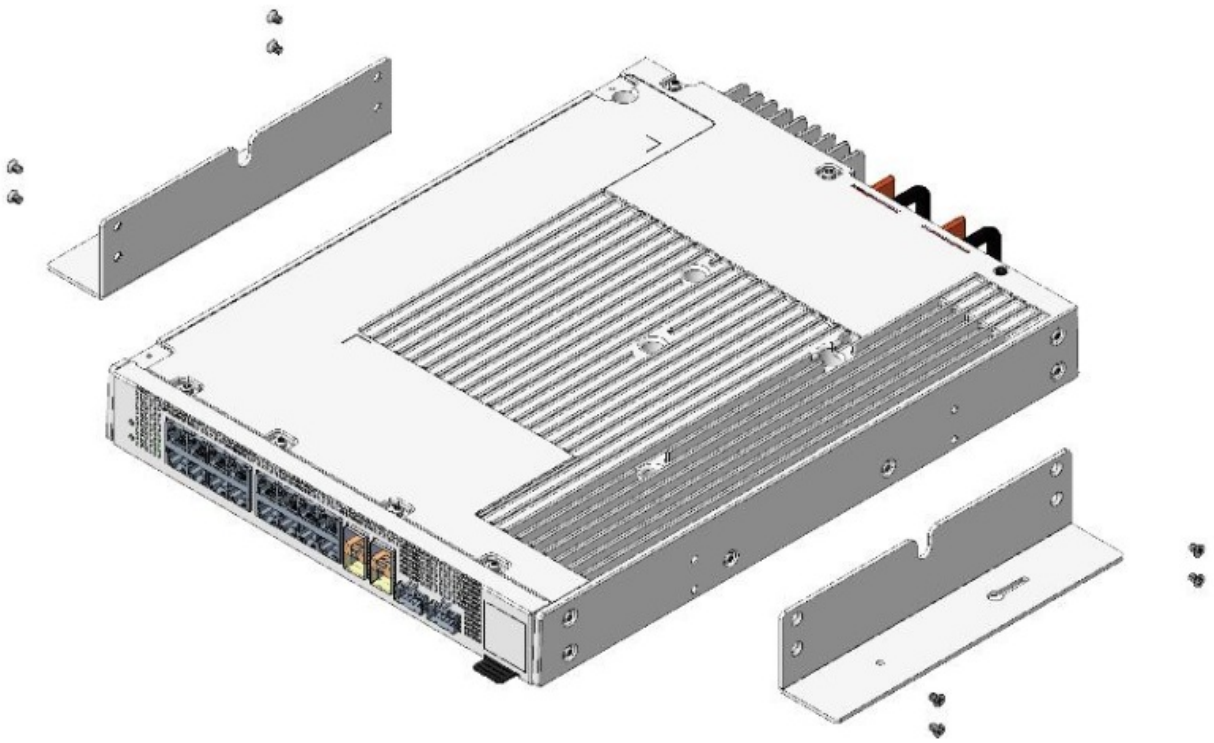

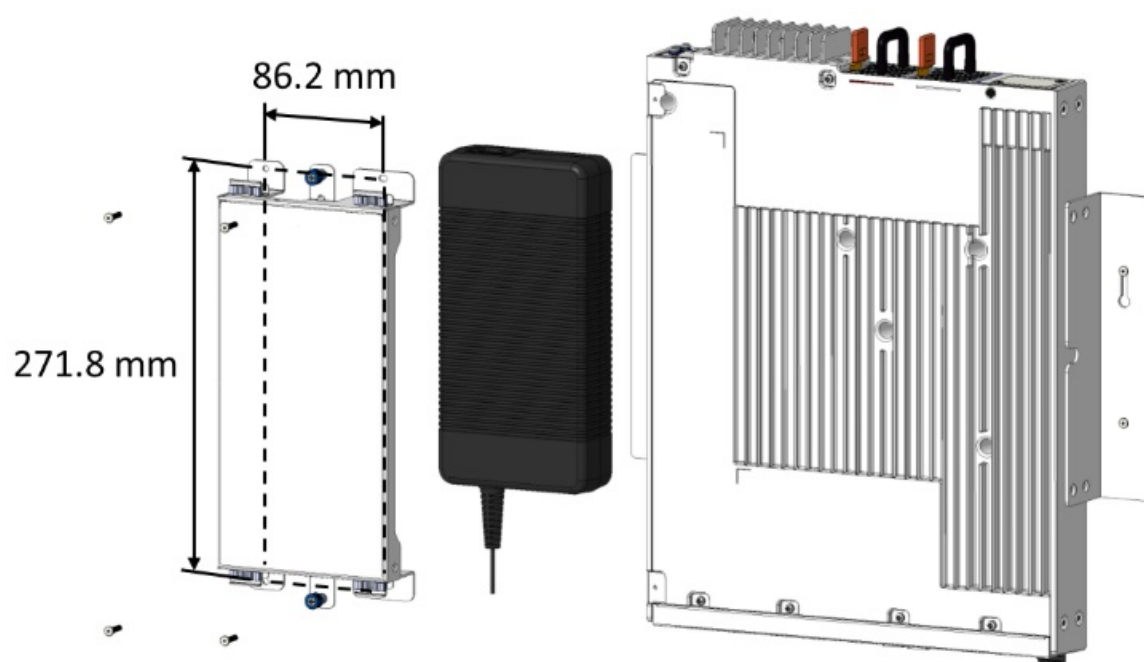
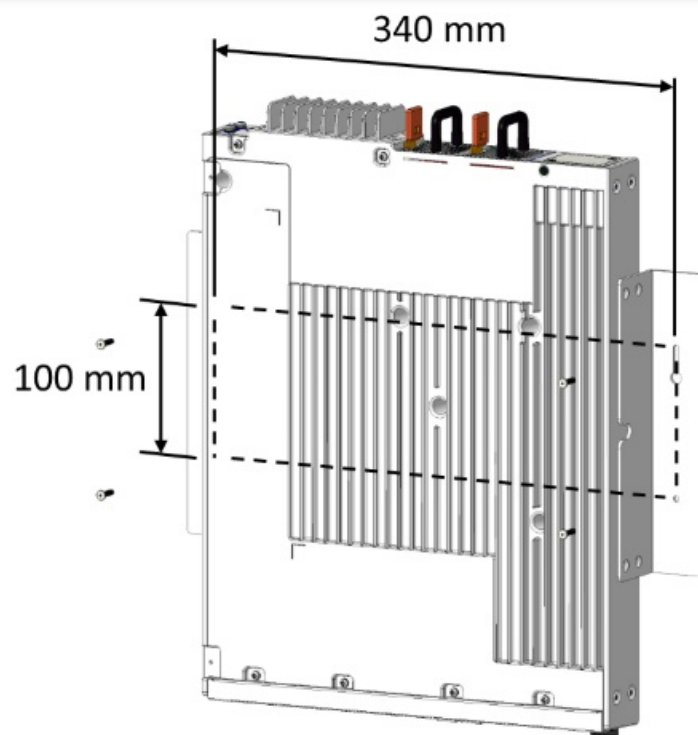

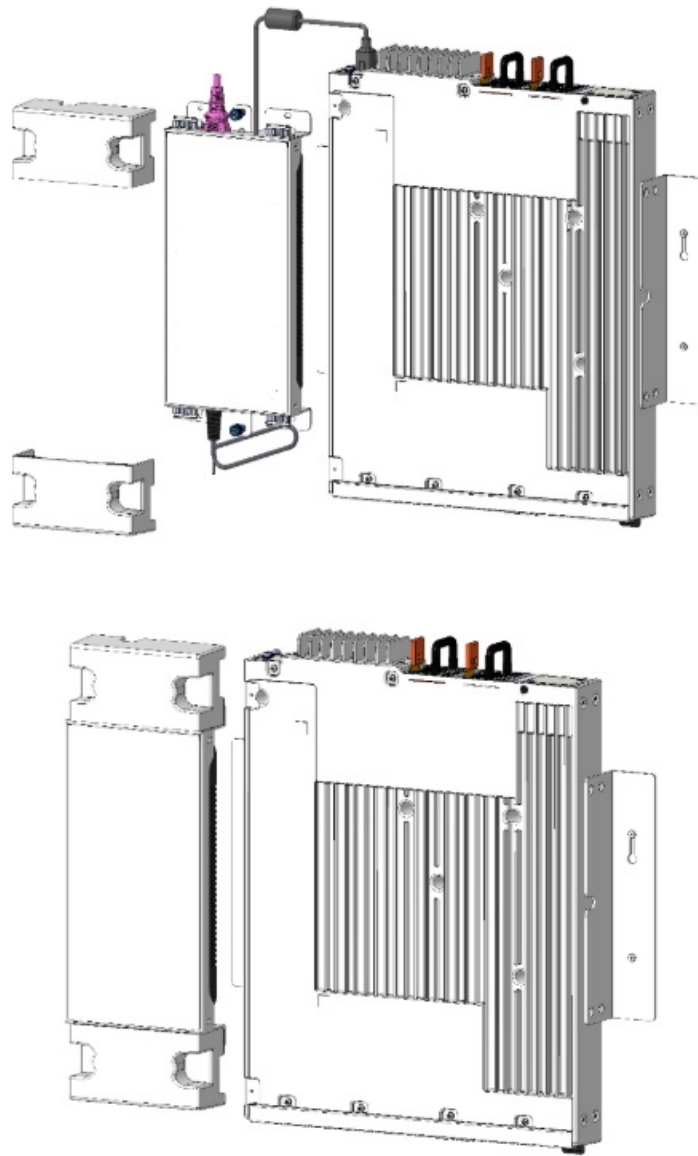

Regulatory Compliance Information

Safety Notice

- Please use CSA/UL Certification Approval Power Supplier.
- There is a risk of fire if the battery is replaced with an incorrect type.
 - Before extending the rack to the installation position, read the installation instructions.
 - Do not put any load on the slide-rail-mounted equipment in the installation position.
 - Do not leave the slide-rail-mounted equipment in the installation position.

Grounding Caution

This equipment must be grounded and the power cord for the product should be connected to a socket-outlet with an earthing connection.

FCC

FCC Warning

This device complies with Part 15 of the FCC Rules.

Operation is subject to the following two conditions:

1. This device may not cause harmful interference, a
2. This device must accept any interference received, including interference that may cause undesired operation.

NOTE: This equipment has been tested and found to comply with the limits for a Class A digital device, under part 15 of the FCC Rules. These limits are designed to provide reasonable protection against harmful interference when the equipment is operated in a commercial environment. This equipment generates, uses, and can radiate radio frequency energy and, if not installed and used under the instruction manual, may cause harmful interference to radio communications. Operation of this equipment in a residential area is likely to cause harmful interference in which case the user will be required to correct the interference at his own expense.

FCC Caution

- Any changes or modifications not expressly approved by the party responsible for compliance could void the user's authority to operate this equipment.
- This transmitter must not be co-located or operating in conjunction with any other antenna or transmitter.

Radiation Exposure Statement

This equipment complies with FCC radiation exposure limits set forth for an uncontrolled environment. This equipment should be installed and operated with a minimum distance of 20cm between the radiator & your body.

IC Warning

This device complies with ISED's license-exempt RSSs. Operation is subject to the following two conditions:

1. this device may not cause harmful interference,
2. this device must accept any interference received, including interference that may cause undesired operation.

Radiation Exposure Statement

This equipment complies with ISED radiation exposure limits set forth for an uncontrolled environment
This equipment should be installed and operated with greater than 20cm between the radiator & your body.

Frequently Asked Questions

- **Q: Can I mount the NSW250 on any type of wall?**
 - A: It is recommended to follow the specified drywall mounting instructions provided in the manual to ensure proper installation and safety.
- **Q: What should I do if I encounter interference issues with the device?**
 - A: Ensure that the device is operated within the specified FCC guidelines to minimize interference. Contact customer support for further assistance if needed.

Documents / Resources

[delta PD5-NSW250 Ethernet Switch](#) [pdf] User Guide
PD5-NSW250 Ethernet Switch, PD5-NSW250, Ethernet Switch, Switch

This website is an independent publication and is neither affiliated with nor endorsed by any of the trademark owners. The "Bluetooth®" word mark and logos are registered trademarks owned by Bluetooth SIG, Inc. The "Wi-Fi®" word mark and logos are registered trademarks owned by the Wi-Fi Alliance. Any use of these marks on this website does not imply any affiliation with or endorsement.