

DELTA Q Quick 3 Espresso Coffee Machine



DELTA Q Quick 3 Espresso Coffee Machine Instruction Manual

[Home](#) » [DELTA Q](#) » DELTA Q Quick 3 Espresso Coffee Machine Instruction Manual 

Contents

- 1 DELTA Q Quick 3 Espresso Coffee Machine
- 2 Product Information
- 3 Product Usage Instructions
- 4 IMPORTANT SAFETY PRECAUTIONS
- 5 GETTING TO KNOW YOUR COFFEE MACHINE
- 6 TECHNICAL INFORMATION
- 7 FIRST USE
- 8 EXTRACT COFFEE/LONG DRINKS
- 9 PROGRAM VOLUME
- 10 ORIGINAL SETTINGS
- 11 CLEANING AND MAINTENANCE
- 12 LONG PERIOD OF NON-USE
- 13 ENERGY AND ENVIRONMENT
- 14 CUSTOMER SERVICE AND SUPPORT
- 15 Documents / Resources
 - 15.1 References



DELTA Q Quick 3 Espresso Coffee Machine



Product Information

Specifications

- Model: Quick
- Consumables: Delta Q capsules
- Ejection: Automatic ejection of used capsules
- Dimensions: W: 116 mm, H: 257 mm, L: 350 mm
- Approximate weight: 3 kg
- Water tank capacity: 800ml
- Used capsule tank capacity: 10 capsules
- Power: 1200 W
- Voltage: 220-240 V
- Frequency: 50 Hz

Product Usage Instructions

Important Safety Precautions

Read all instructions carefully and keep them for future reference. The manual contains essential safety information for installing and using the appliance.

Getting to Know Your Coffee Machine

- Espresso button / On/Off general button

- Long drinks button / On/Off general button
- Equipment body
- Water tank
- Lever
- Capsule-holder
- Deposit for used capsules
- Deposit for liquids
- Cup tray
- Extraction nozzle
- LED
- Electrical cable
- Electrical plug* (*Except in the UK)

Technical Information

- Model: Quick
- Consumables: Delta Q capsules
- Ejection: Automatic ejection of used capsules
- Dimensions: W: 116 mm, H: 257 mm, L: 350 mm
- Approximate weight: 3 kg
- Water tank capacity: 800ml
- Used capsule tank capacity: 10 capsules
- Power: 1200 W
- Voltage: 220-240 V
- Frequency: 50 Hz

Frequently Asked Questions (FAQ)

• Where can I find the manual in PDF format?

The manual is available in PDF format on mydeltaq.com.

• What should I do in case of long periods of non-use?

Refer to the “Long Period of Non-Use” section in the manual for instructions on how to handle extended periods without using the coffee machine.

• How do I contact customer service?

You can contact customer service by visiting mydeltaq.com or calling 00 800 20 50 20 50 (toll-free).

QUICK ESPRESSO COFFEE MACHINE INSTRUCTIONS MANUAL

The safety precautions are part of the appliance.
Read this manual carefully before using the equipment.
Keep it for future reference.

IMPORTANT SAFETY PRECAUTIONS

- This manual is also available in PDF format in mydeltaq.com
- Read carefully all the instructions and save these recommendations for future reference.
- This manual provides important safety informations regarding the installation and use of the appliance.

Note: Keep this manual in an appropriate place for future reference.

- The manufacturer reserves the right to change the manual without any obligation to update previous editions, except in exceptional circumstances. After removing the machine from its packaging, place it base downwards in a safe, flat horizontal place, where there is no other equipment or articles which may impair use, or allow the machine to be knocked or damaged.
- Check that the support surface has heating sources and that it is properly clean and dry.
- Also confirm whether there is an earthed electrical socket near the installation site.
- Before using your equipment for the first time, make sure the machine and all its accessories are present and in a good state of repair.
- Where in doubt, do not use the appliance and contact the Customer Service and Support (00 800 20 50 20 50).
- Confirm whether the output voltage of the electrical socket corresponds to the voltage stated on the classification label of your coffee machine. Connect the appliance only to grounded electrical outlets.
- Do not turn the equipment on if the cable or socket are damaged or malfunctioning. Contact Customer Service and Support (00 800 20 50 20 50).
- If the supply cord is damaged, it must be replaced by the manufacturer, its service agent or similarly qualified persons in order to avoid a hazard.
- In case of emergency: immediately remove the plug from the outlet. Do not let the cord hanging over a table or counter.
- Do not let the cord get in direct contact with hot surfaces.
- To switch off, remove the power plug from the respective outlet. Always hold the plug. Never apply pressure on the cord.
- Remove the plug from the respective outlet when the appliance is not being used or before cleaning it.
- In order to protect people from fire, electrical shocks and personal injuries, do not immerse the cord, plug or appliance in water or other liquid.
- In case an extension cord is needed, use only a grounded one.
- Do not touch the cord when your hands are wet or moist.
- Fill the water tank only with cold drinking water. Never fill the water tank with milk, oil/olive oil or other similar liquids.
- Empty the water tank when the machine is not used for an extended period of time.
- Do not use the appliance outdoors, or exposed to weathering agents (rain, sun and others).
- This appliance is used indoor only.
- This appliance is considered to be suitable for use in countries having a warm damp equable climate. It may also be used in other countries.
- The appliance is to be supplied through a residual current device (RCD) having a rated residual operating current not exceeding 30 mA.
- This appliance is intended for household use and similar applications, such as:
 - staff kitchen areas in shops, offices and other working environments;
 - farm houses;
 - by guests in hotels, motels and other residential type environments;

- in bed-and-breakfast type environments.
- Do not use the appliance for other than the intended purposes.
- Do not place the appliance near or over an electric or gas hot stove or in a heated oven.
- Do not leave appliance on while unattended.
- Do not put your fingers into the coffee outlet, as this can cause burns.
- Do not put your fingers into the capsule holder, as this can cause burns.
- Clean all the detachable parts with water. The exterior surfaces of the appliance must be cleaned with a damp cloth.
- The appliance must not be immersed in water for cleaning.
- Close supervision is required when the appliance is used by or near children.
- This appliance can be used by children aged from 8 years and above if they have been given supervision or instruction concerning use of the appliance in a safe way and if they understand the hazards involved. Cleaning and user maintenance shall not be made by children unless they are older than 8 and supervised.
- Keep the appliance and its cord out of reach of children aged less than 8 years. Appliances can be used by persons with reduced physical, sensory or mental capabilities or lack of experience and knowledge if they have been given supervision or instruction concerning use of the appliance in a safe way and understand the hazards involved.
- Children shall not play with the appliance.
- The use of accessories not recommended by the appliance manufacturer may result in fire, electric shock and personal injuries.
- Misusing the appliance can lead to potential injury.
- The coffee-maker shall not be placed in a cabinet when in use.
- In case of failure and/or malfunction of the appliance, unplug it from the power outlet and do not try to repair it yourself.
- Contact the Customer Service and Supporte (00 800 20 50 20 50).

Note: The failure to comply with these safeguards may compromise the appliance and the user security.

- The first time you use the appliance, it is possible that some odour may be released, caused by the insulating materials and the appliance's parts subjected to heating. This inconvenience disappears in a few minutes.
- The installation must be performed in accordance with the manufacturer's instructions. An incorrect installation may cause damage to the appliance's parts, which the manufacturer cannot be held responsible for.
- The manufacturer cannot be held responsible for any damage resulting from the improper, erroneous and irrational use of the appliance.
- In case of misuse or failure to comply with the instructions, the manufacturer declines any responsibility and will void the respective warranty.
- This appliance was developed to extract beverages through the use of Delta Q capsules. Delta Q capsules quality is guaranteed when Delta Q capsules are used in Delta Q appliances.

GETTING TO KNOW YOUR COFFEE MACHINE

1. Espresso button / On/Off general button
2. Long drinks button / On/Off general button
3. Equipment body

4. Water tank
5. Lever
6. Capsule-holder
7. Deposit for used capsules
8. Deposit for liquids
9. Cup tray
10. Extraction nozzle
11. LED
12. Electrical cable
13. Electrical plug*

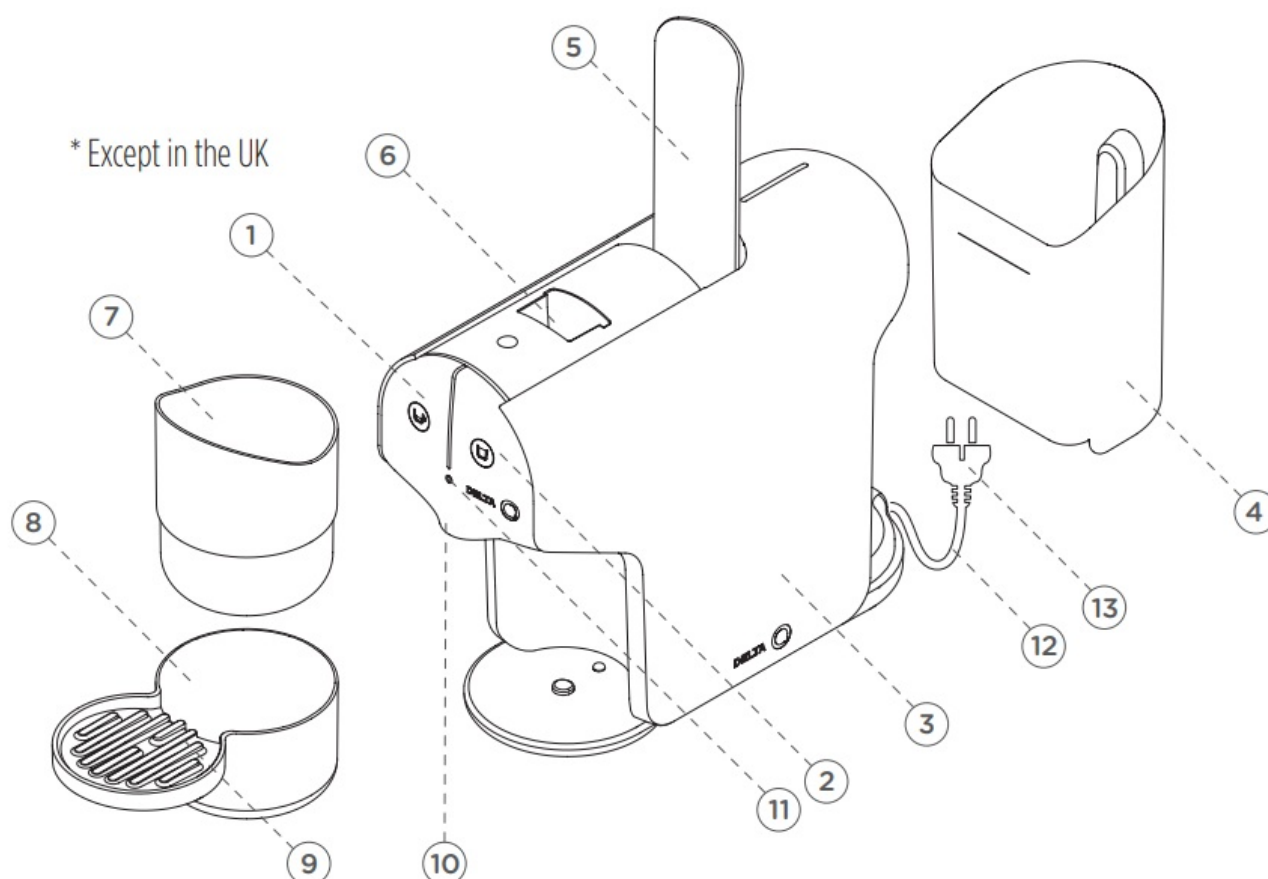

TECHNICAL INFORMATION

- Model: Quick
- Consumables: Delta Q capsules
- Ejection: Automatic ejection of used capsules
- Dimensions: W: 116 mm H: 257 mm L: 350 mm
- Approximate weight: 3 kg
- Water tank capacity: 800ml
- Used capsule tank capacity: 10 capsules Power: 1200 W
- Voltage: 220-240 V
- Frequency: 50 Hz

CUSTOMER SERVICE mydeltaq.com

00 800 20 50 20 50 (toll free)

NOVADELTA, LDA

Av. Infante D. Henrique 151 A 1950-041 Lisboa

Portugal

FIRST USE

First Use is used just once. The machine may make a noise due to the water circuit being empty.

NOTE: DO NOT INSERT A CAPSULE



- Remove the water tank.

Fill the water tank with mineral water up to the maximum limit mark. Place it back in its initial position. Make sure that it is properly inserted.

•

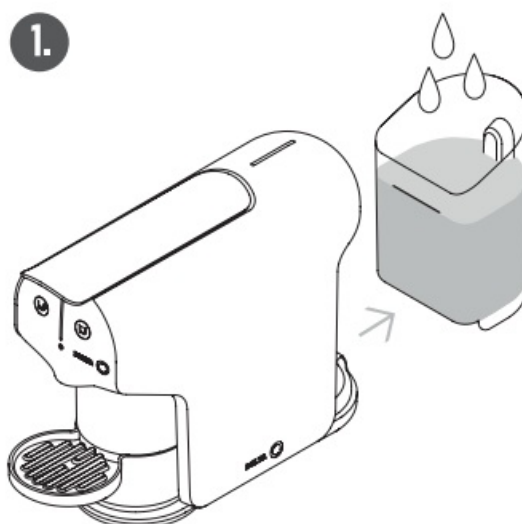

Place a container (min. 250ml) on the cup tray under the extraction nozzle. To put a tall glass, turn the cup tray to one side.

•



Plug the lead into the socket.

THE LED STAYS STEADY.

- Pressing the espresso button and the long drinks button until the machine begins the Cleaning process, which may last up to 3 minutes.

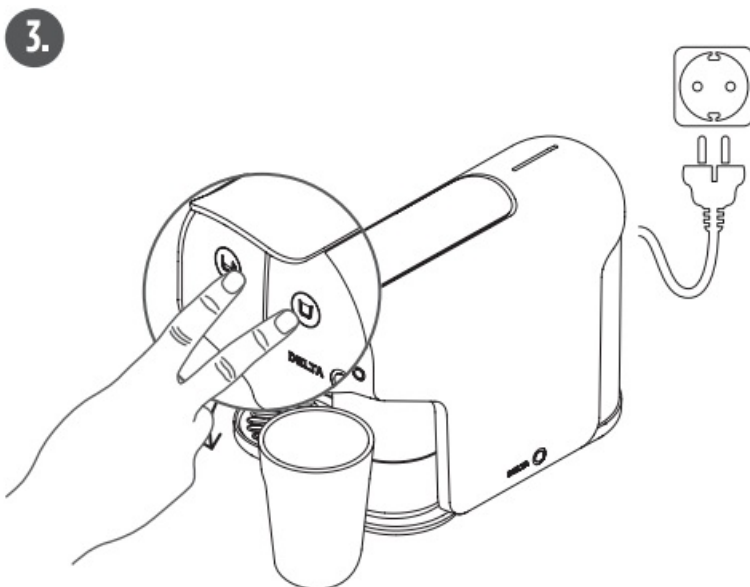

HEATING

When the Cleaning process ends, the machine starts heating up, when the LED stops blinking (approximately 35 seconds) the machine is ready to use.

EXTRACT COFFEE/LONG DRINKS

Note: Whenever the type of drink to be extracted is altered (coffee, long drinks) a purge action must be carried out (see: page 31).

- Connect the plug to the grounded outlet.
- To switch the machine on, press espresso button or the long drinks button.
- When the LED stops blinking (approximately 35 seconds) the machine is ready to use.

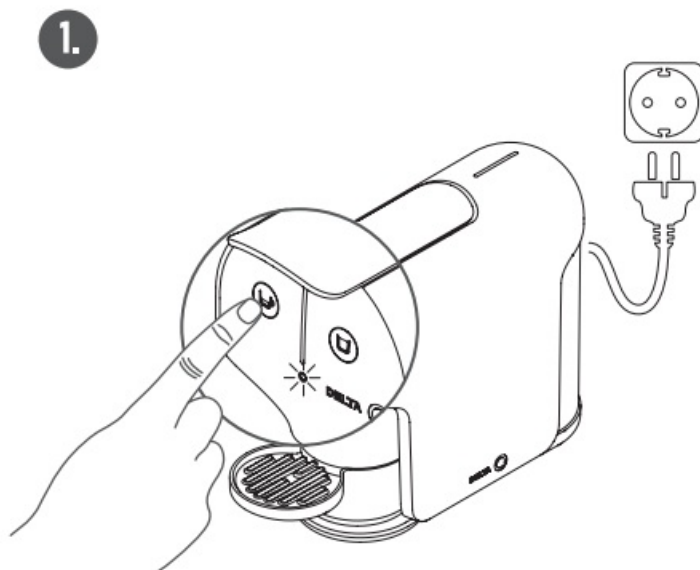

- Raise the lever and insert a Delta Q coffee capsule in the capsule housing hole.

2.

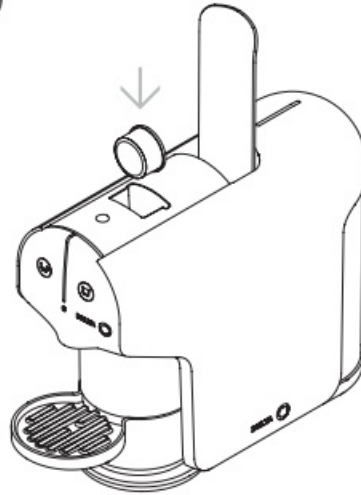

- Lower the lever and place a coffee cup under the extraction nozzle.
- To put a tall glass, turn the cup tray to one side.

3.



- Press the espresso button or the long drinks button to start the beverage extraction. The extraction stops automatically.
- Lift the lever fully to release the capsule to the used capsule deposit (maximum capacity of 10 capsules).
- Remove the cup.

4.

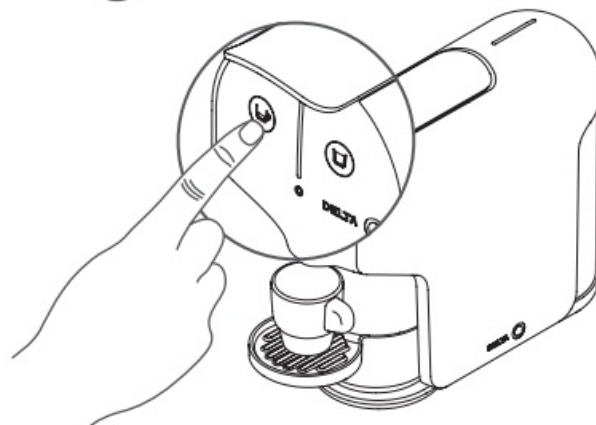

PROGRAM VOLUME

Note: The default volume: Espresso: around 30cc and Long drinks: around 180cc.

- To switch the machine on, press espresso button or the long drinks button. When the LED stops blinking (approximately 35 seconds) the machine is ready to use.

1.

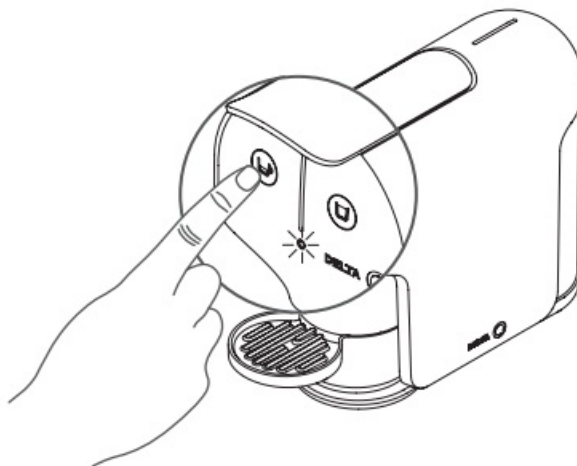

- Raise the lever and insert a Delta Q coffee capsule in the capsule housing hole.

2.

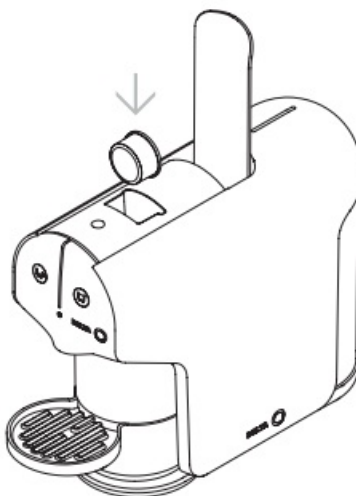

- Place a coffee cup or put a tall glass under the extraction nozzle.
- Pressing the espresso button and the long drinks button until the LED blinks (Programming mode).

3.

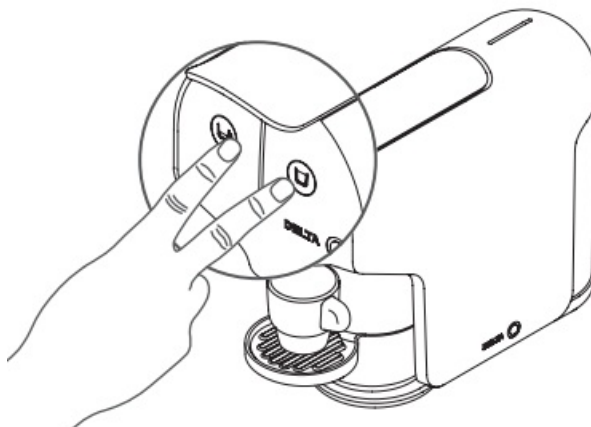

- Pressing the espresso button or the long drinks button to start the extraction.
- Press any button when the extraction reaches the desired quantity.
- The LED will blink 3 times in confirmation.

The machine memorises the volume and will start extracting it until a new programme is set.

Note: If the user does not press any button to finish the operation, the equipment will automatically assume the maximum volume around of 70cc (Espresso) and 200cc (Long drinks).

ORIGINAL SETTINGS

- Pressing the espresso button and the long drinks button until the LED blinks (Programming mode).
- Pressing again the espresso button and the long drinks button until the LED blinks 3 times in confirmation.

The appliance switches off automatically. The machine returns to First Use (page 28).

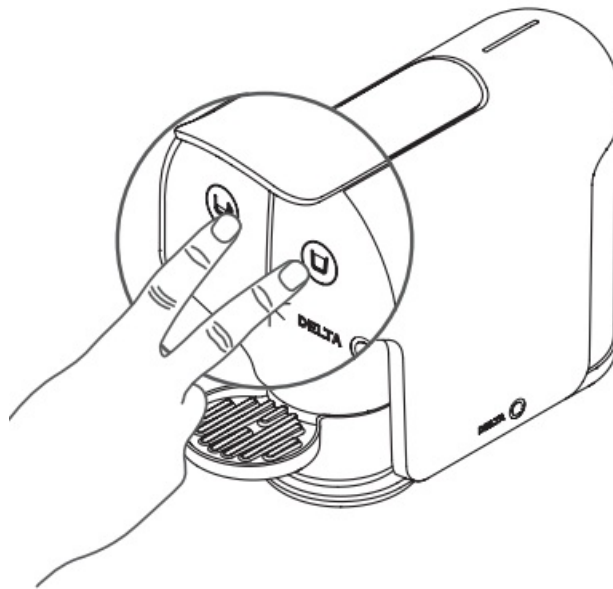

STAND BY MODE

The machine switches off automatically after 3 minutes of inactivity, the LED turns off. If you wish, you can always switch the machine off by pressing the espresso button until the LED turns off.

PURGE

Frequent use of the “Purge” operation ensures improved beverage quality and proper equipment maintenance.

- Place a coffee cup and without inserting a capsule, the espresso button to pump the water through the machine.
- The appliance switches off automatically. When the LED stops blinking the machine is ready to use.

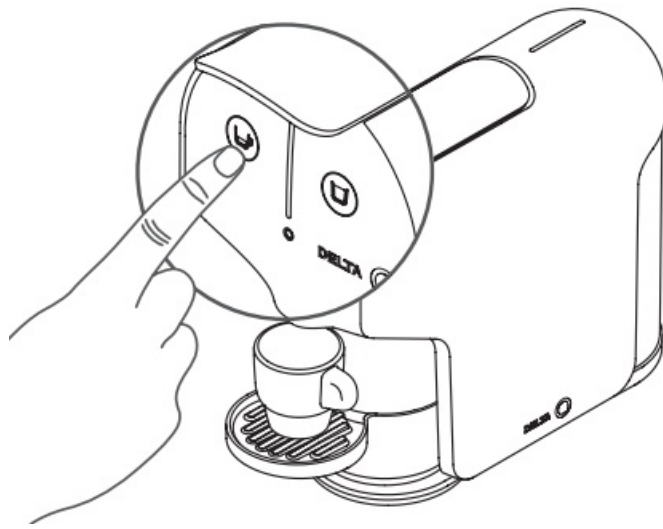

CLEANING AND MAINTENANCE

Warning: Check if you unplugged the appliance from the power outlet before you clean it. To prevent electrical shocks, do not immerse the cord, plug or appliance in water or any other liquid. Do not use any abrasive or solvent-composed cleaning agent.

- Empty the deposit for used capsules and the deposit for liquids frequently.
- Use a dry cloth to clean the water tank.
- The used capsules collection tank, the cup tray and the drip basin may be washed in water and dried with a soft cloth.
- Clean the outer surfaces of the equipment with a damp cloth.
- You must never immerse the equipment in water or any other liquid.

LONG PERIOD OF NON-USE

- Pull out the water tank.
- Fill the water tank up to the maximum capacity mark. Place it in its initial position. Make sure that the water tank is inserted correctly.
- Connect the plug to the grounded outlet.
- To switch the machine on, press espresso button or the long drinks button.
- When the LED stops blinking (approximately 35 seconds) the machine is ready to use.

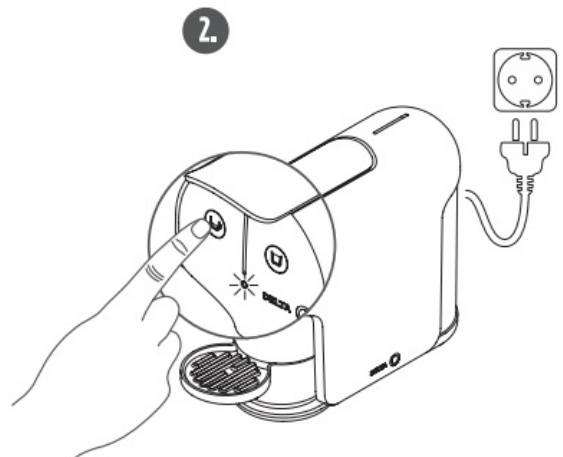
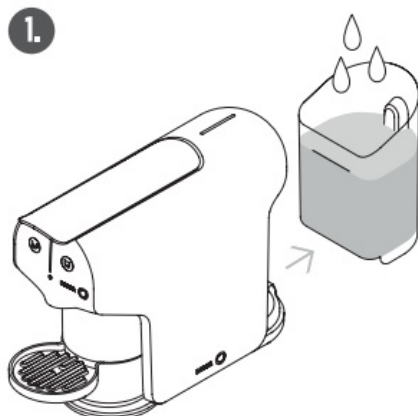

- Place a container (min. 250ml) on the cup tray under the extraction nozzle. To put a tall glass, turn the cup tray to one side. Press the long drinks button to rinse the machine, repeat this step 2 times.

Note: If there is no water, remove the water tank and put it back into the initial position, during the extraction of long drinks.

- Repeat this step until the machine expel continuous flow of water.

3.



4.



DESCALING

It is recommended to perform the appliance's descaling every three months or after 300 Delta Q capsules extractions, approximately.

Follow the safety instructions shown on the Delta Q descaling kit packaging.

Avoid contact of the descaling solution with eyes, skin, machine and surrounding surfaces.

- The appliance does not switch on > Check if the plug is connected properly to the power outlet. Check if you pressed the espresso button to switch the appliance on.
- The capsule got jammed in the capsule-holder. > Check if the used capsules deposit is full. If necessary, empty the content and place the empty deposit in its original position.
- Coffee or water does not come out. > Check if the water tank is empty or if it is well placed.
- The LED blinks quickly without stopping. > Please, remove the plug of the machine from the outlet and switch it on after 2 minutes. If the problem persists, contact Customer Service (00 800 20 50 20 50).
- To any other doubt or additional information, you must contact Customer Service (00 800 20 50 20 50).

ENERGY AND ENVIRONMENT

- Delta Q is committed in designing and producing innovative, high performance machines that are easy to use.
- To improve the energy performance of the machine, improvements and functions were introduced that aim at reducing the power consumption.
- This machine is in compliance with the European Directive 2012/19/EU.
- The packaging and the machine were partially made of recyclable materials.



- Do not dispose of electrical appliances as unsorted municipal waste, use separate collection facilities. Contact your local government for information regarding the collection systems available. If electrical appliances are

disposed of in landfills or dumps, hazardous substances can leak into the groundwater and get into the food chain, damaging your health and well-being.

- Delta Q is concerned with the recycling of the used capsules.
- Check our Website: mydeltaq.com for more information on how to recycle Delta Q used capsule or contact the Customer Service (00 800 20 50 20 50).

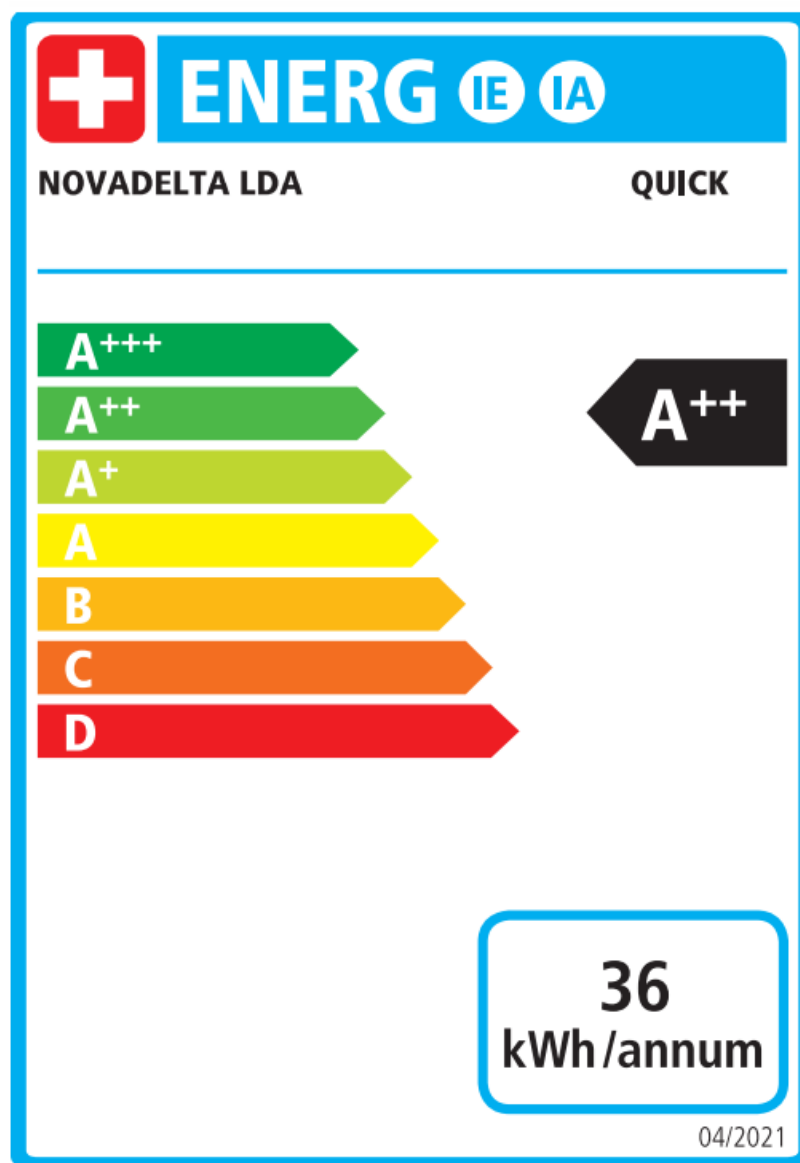

CUSTOMER SERVICE AND SUPPORT

DISTRIBUTED BY

PT .ES .FR .LU .CH 00 800 20 50 20 50

AO 00 244 226431175/6

PL

info.pl@deltacafes.com

mydeltaq.com

Documents / Resources

	DELTA Q Quick 3 Espresso Coffee Machine [pdf] Instruction Manual Quick 3 Espresso Coffee Machine, Quick 3, Espresso Coffee Machine, Coffee Machine, Machin e
---	--

References

- [Delta Q Online Store](#)
- [User Manual](#)

[Manuals+](#), [Privacy Policy](#)

This website is an independent publication and is neither affiliated with nor endorsed by any of the trademark owners. The "Bluetooth®" word mark and logos are registered trademarks owned by Bluetooth SIG, Inc. The "Wi-Fi®" word mark and logos are registered trademarks owned by the Wi-Fi Alliance. Any use of these marks on this website does not imply any affiliation with or endorsement.