



delimano RS2010W3 Multicooker Prime User Manual

[Home](#) » [delimano](#) » delimano RS2010W3 Multicooker Prime User Manual 

Contents

- [1 delimano RS2010W3 Multicooker Prime](#)
- [2 DIAGRAM](#)
- [3 SPECIFICATION](#)
- [4 Manual button](#)
- [5 CLEANING AND MAINTENANCE](#)
- [6 TROUBLESHOOTING](#)
- [7 Documents / Resources](#)
 - [7.1 References](#)
- [8 Related Posts](#)



delimano RS2010W3 Multicooker Prime



DIAGRAM

PIC 1

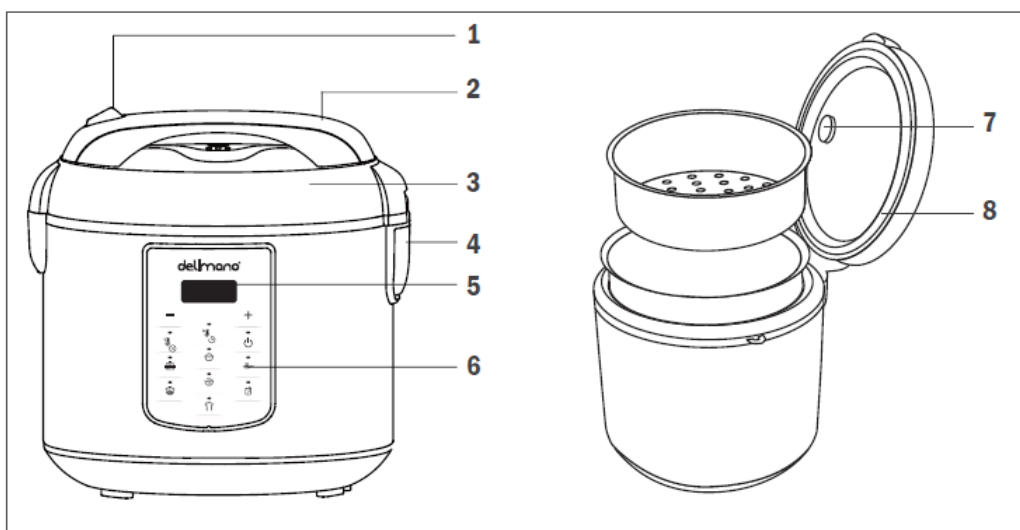

PIC 2

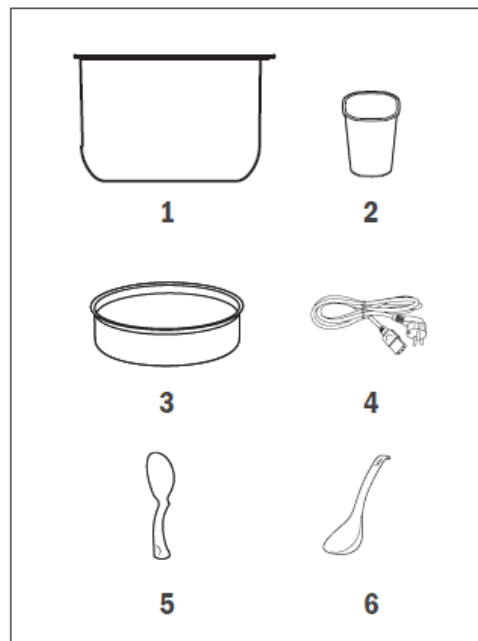

PIC 3



WARNINGS

1. This device can be used by children aged from 8 years and above as well as by persons with reduced physical, sensory or mental capabilities or lack of experience and knowledge if they have been given supervision or instruction concerning use of the device in a safe way and understand the hazards involved. Children shall not play with the appliance. Cleaning and user maintenance should not be done by children unless they are older than 8 and supervised.
2. Keep the device and its cord out of reach of children less than 8 years old.
3. This device is intended to be used for household, indoor and dry use only.
4. Before use, place the product on hard, flat, stable and dry surface.
5. Slight odors are possible at beginning of usage until device reaches its thermal stability.
6. If the device is not working as it should, has received a sharp blow, has been dropped, damaged, left outdoors

or dropped into water, do not use it.

7. This device should never be switched on or stay plugged in power supply when not in use, while replacing accessories or during cleaning.
8. This device should never operate empty/unloaded, because such action could result in appliance failure and/or injuries to the user.
9. Plug in power supply that corresponds to the rated one on device/charger only. In case of misuse power supply or device failure may occur.
10. This device is equipped with a grounded plug. Please ensure the wall outlet in your house is well earthed.
11. Do not attempt any modification or repair by yourself and ensure that any repair is conducted only by appropriately qualified technician.
12. If the power cable is damaged, it must be replaced immediately by authorized and qualified person only.
13. Clean and dry thoroughly before first use.
14. The use of attachments or accessories not recommended or sold by the product distributor may cause personal or property hazards or injuries.
15. The heating element surface is subject to residual heat after use, do not touch.
16. The appliance is not intended to be operated by means of an external timer or a separate remote-control system.
17. Keep the appliance away from combustibles. During operation, stay away from curtains, drapes, curtain or in similar articles to avoid the risk of fire.
18. Do not use the appliance for food that may cause vent clogging: food in sheets, food in bands, food in large pieces, to avoid accident and damage to the appliance.
19. During operation, do not place your hands or face close to the steam vent to avoid burns.
20. During operation, do not cover the steam vent with cloth or other articles to avoid accident and damage to the appliance.
21. The appliance can only use the original cooking pot to avoid overheating and anomaly.
22. Do not drop the cooking pot to avoid deformation.
23. Do not impact the cooking pot with hard materials to avoid deformation.
24. When operation is being performed or just finished, do not directly touch the inner cooking pot to avoid burns.
25. Any discrepancy between the picture and the product is subject to the real object.
26. During use, it is normal that the appliance slightly ticks or fizzes. Please do not panic.
27. Please refer to below paragraphs about details on cleaning, operating times and speed settings for accessories.
28. Although the product has been checked its usage and consequences are strictly user responsibility.

SPECIFICATION

1. PARTS

The Delimano Multicooker Prime contains the following parts for following functions:

<u>Pic. 1 (see: PICTURES, Pic. 1)</u>		
1. Lid Release button 2. Handle 3. Lid	4. Condensation collector 5. Display 6. Control panel	7. Safety valve 8. Seal

<u>Pic. 2 (see: PICTURES, Pic. 2)</u>		
1. Inner cooking pot 2. Measurement cup	3. Steamer 4. Power cable	5. Rice spoon 6. Hanging soup spoon

<u>Pic. 3 (see: PICTURES, Pic. 3)</u>			
1. Temp / Timer 2. Keep warm / Cancel	3. Steam mode 4. Rice mode	5. Fry mode 6. Stew mode	7. Manual mode 8. power

2. BEFORE USE

1. Clean the inner pot and accessories with damp cloth before drying them thoroughly.
2. Make sure safety valve and seal are correctly installed.
3. Place the device on flat, stable, dry and heat resistant surface.

3. USAGE

1. Rotate the cooking pot 2-3 times to ensure good contact between its bottom and heating plate; press the lid down until you hear a click.

NOTE: Do not place the cooking pot on other stoves for heating to avoid deformation due to high temperature; do not replace the cooking pot with other containers and operate on the heating plate.

2. Plug the power cable in device and power supply.
3. Press the power button (its indicator starts blinking and display shows – -). The device is in standby mode.

NOTES:

1. Do not place the cooking pot on other stoves for pre/heating. Do not replace the cooking pot with other containers and operate the device on the cooking hobs.
2. Do not boil rice with hot water to avoid affecting the temperature control and avoid poor results.

3. Regularly clean the safety valve.

4. **BUTTONS:**

Power

1. Press once to turn on the device and put it in standby state. Press once more to turn off the device.
2. In standby state press one of the mode buttons and press power button again to start the cooking (running circle will turn on display).

NOTES:

You can turn off/reset any mode/program with the press of keep warm/cancel button.

If the device is not used in standby state for more than 2 minutes it will turn off automatically.

5. **Keep warm/Cancel**

1. While in standby state, press “Keep Warm/Cancel” button to start the “keep warm” (temperature preservation) mode.
2. While in any working mode press “Keep Warm/Cancel” button to “cancel” the running program and return it to standby state.
3. Temperature preservation mode will automatically start when cooking is completed, the timer displays from 0 to 12 hours. The LED displays “ — — “ after 12 hours and returns to the “standby state after that.
4. During operation (Steam, Rice, Stew, and manual mode), press the power button for two seconds to turn off heat preservation function (its light turns off).

NOTES: Keep warm function is not possible in Fry mode. Food is best to be consumed within 5 hours after cooking.

Manual button

IN standby state, press the “manual” button to manually set the cooking program's time and temperature.

1. **TEMP/TIMER button**

1. After selecting the manual mode press temp/timer button to enter in cooking time setting (pre-set cooking time – 30 minutes – starts to flash on display). By pressing + or – buttons cooking time in increments of 5 minutes can be set between 1 and 90 minutes.
2. Press temp/timer button again to enter temperature setting (pre-set temperature – 100 °C (10) – starts to flash on display). By pressing + or – buttons cooking temperatures in increments of 10 °C can be set between 30 (03) and 150 °C (15).
3. Press power button to start the manual mode.*If no delay start of cooking is needed.

3. **DELAY setting**

1. Press temp/timer button again to enter in delay start setting (pre-set – 1 hour delay – starts to flash on display). By pressing + or – buttons cooking delay time in increments of 1 hour can be set between 1 and 24 hours.
2. Press power button to start the manual mode with delay (temp/timer indicator stays turned on). Display will reduce the number of hours before switching to last 59 minutes before starting manual mode automatically.

NOTE:

When the manual set temperature is higher than 70 °C, the temperature saving function will automatically turn on after cooking time has elapsed. If the set temperature is lower than 70 °C the

device will enter the standby state after cooking time has elapsed.

4. STEAM

1. In standby state press the “steam” button (30 minutes default cooking time starts to flash on display).
2. Press the + or – button to set the cooking time between 5 and 60 minutes in one minute increments.
3. Press the power button to start the steam mode. * If no delay start of steaming is needed.
4. Press temp/timer button to set the delay start (1 hour default delay starts to flash on display).
5. Press the + or – button to set the delay start between 1 and 24 hours with one hour increments.
6. Press power button to start the steam mode with delay (temp/timer indicator stays turned on). Display will reduce the number of hours before switching to last 59 minutes before starting manual mode automatically.
7. After elapsed cooking time the device will automatically switch to temperature preservation time.

5. RICE

1. In standby state press the “rice” button (60 minutes default cooking time starts to flash on display).
2. Press the + or – button to set the cooking time between 5 and 90 minutes in five minute increments.
3. Press the power button to start the steam mode. After approximately 32 seconds the display will start the countdown.
4. After elapsed cooking time the device will automatically switch to temperature preservation time.

6. FRY

1. In standby state press the “fry” button (15 minutes default cooking time starts to flash on display).
2. Press the + or – button to set the cooking time between 1 and 90 minutes in five minute increments.
3. Press the power button to start the steam mode. After approximately 32 seconds the display will start the countdown.
4. After elapsed cooking time the device will automatically switch to standby state.

NOTES: The amount of oil should not exceed 10 mm. Do not close the lid during frying.

7. STEW

1. In standby state press the “stew” button (2 hours default cooking time starts to flash on display).
2. Press the + or – button to set the cooking time between 2 and 10 hours in one hour increments.
3. Press the power button to start the stew mode. After approximately 32 seconds the display will start the countdown. * If no delay start of steaming is needed.
4. Press temp/timer button to set the delay start (1 hour default delay starts to flash on display).
5. Press the + or – button to set the delay start between 1 and 24 hours with one hour increments.
6. Press power button to start the steam mode with delay (temp/timer indicator stays turned on). Display will reduce the number of hours before switching to last 59 minutes before starting manual mode automatically.
7. After elapsed cooking time the device will automatically switch to temperature preservation time.

CLEANING AND MAINTENANCE

Always turn off and unplug the device from power supply before allowing it to cool down. Wash the inner pot and accessories before drying them thoroughly. Wipe the main unit with damp cloth and dry thoroughly. Store in dry place without direct sunlight.

TROUBLESHOOTING

If device is not working as supposed to, please contact your nearest dealer.

	<p>delimano RS2010W3 Multicooker Prime [pdf] User Manual RS2010W3, Multicooker Prime</p>
-----------------------------------------------------------------------------------	--------------------------------------------------------------------------------------------------------------

References

- [Refaccionaria Moderna ®](#)
- [Studio Moderna, multi-brand and direct-to-consumer electronic retailer](#)
- [Svorio Ir LieknÄ—jimÄ...](#)
- [Д҃Д³⁄₄Д¹⁄₄Д³⁄₄Ñ%ÑЄ.Д҃Д³⁄₄Д´ÑЄД³⁄₄Д±Д¹⁄₂Д³⁄₄ÑÑ.Д. Д´Д³⁄₄ÑÑ.Д°Д²Д°Д. Д³⁄₄Д¿Д»Д°Ñ.Ñ¿. Д. Д¹⁄₂Ñ. Д³⁄₄ÑЄД¹⁄₄Д°Ñ†Д.Ñ Д³⁄₄ Д¹⁄₄Д°Д³Д°Д-Д. Д¹⁄₂Дµ ДсД³⁄₄Д¿. Д`Д³⁄₄Д¿.](#)
- [Топ Шоп - онлайн магазин Top Shop | Topshop](#)
- [TopShop.It | Topshop](#)