



delimano MB-RS5010W3 Multi Cooker Select User Manual

[Home](#) » [delimano](#) » delimano MB-RS5010W3 Multi Cooker Select User Manual

Contents [[hide](#)]

- [1 delimano MB-RS5010W3 Multi Cooker Select](#)
- [2 WARNINGS](#)
- [3 PARTS](#)
- [4 BEFORE USE](#)
- [5 USAGE](#)
- [6 BUTTONS](#)
- [7 CLEANING AND MAINTENANCE](#)
- [8 TROUBLESHOOTING](#)
- [9 Documents / Resources](#)
 - [9.1 References](#)
- [10 Related Posts](#)



delimano MB-RS5010W3 Multi Cooker Select



Thank you for selecting Delimano products!

Delimano brand brings innovative range of great quality kitchenware that is designed to provide healthy, tasty and enjoyable cooking experience (preparation, cooking and consumption of food), encouraging passion for cooking and entertaining no matter the level of cooking skills. Cook. Celebrate. Every day.

All Delimano products are perceived very valuable, so counterfeiters really like to copy us and thus abuse customers by worse quality with no warranty and service. Please, report any copied, counterfeit, similar product or unauthorised distributor to brand protection@studio-moderna.com in order to help us fight against illegal counterfeits.

Please read this manual thoroughly before using and save it for future reference.

WARNINGS

1. This device can be used by children aged from 8 years and above as well as by persons with reduced physical, sensory or mental capabilities or lack of experience and knowledge if they have been given supervision or instruction concerning use of the device in a safe way and understand the hazards involved. Children shall not play with the appliance. Cleaning and user maintenance should not be done by children unless they are older than 8 and supervised.

2. Keep the device and its cord out of reach of children less than 8 years old.
3. This device is intended to be used for household, indoor and dry use only.
4. Before use, place the product on hard, flat, stable and dry surface.
5. Slight odors are possible at beginning of usage until device reaches its thermal stability.
6. If the device is not working as it should, has received a sharp blow, has been dropped, damaged, left outdoors or dropped into water, do not use it.
7. This device should never be switched on or stay plugged in power supply when not in use, while replacing accessories or during cleaning.
8. This device should never operate empty/unloaded, because such action could result in appliance failure and/or injuries to the user.
9. Plug in power supply that corresponds to the rated one on device/charger only. In case of misuse power supply or device failure may occur.
10. This device is equipped with a grounded plug. Please ensure the wall outlet in your house is well earthed.
11. Do not attempt any modification or repair by yourself and ensure that any repair is conducted only by appropriately qualified technician.
12. If the power cable is damaged, it must be replaced immediately by authorized and qualified person only.
13. Clean and dry thoroughly before first use.
14. The use of attachments or accessories not recommended or sold by the product distributor may cause personal or property hazards or injuries.
15. The heating element surface is subject to residual heat after use, do not touch.
16. The appliance is not intended to be operated by means of an external timer or a separate remote-control system.
17. Keep the appliance away from combustibles. During operation, stay away from curtains, drapes, curtain or in similar articles to avoid the risk of fire.
18. Do not use the appliance for food that may cause vent clogging: food in sheets, food in bands, food in large pieces, to avoid accident and damage to the appliance.
19. During operation, do not place your hands or face close to the steam vent to avoid burns.
20. During operation, do not cover the steam vent with cloth or other articles to avoid accident and damage to the appliance.
21. The appliance can only use the original cooking pot to avoid overheating and anomaly.
22. Do not drop the cooking pot to avoid deformation.
23. Do not impact the cooking pot with hard materials to avoid deformation.
24. When operation is being performed or just finished, do not directly touch the inner cooking pot to avoid burns.
25. Any discrepancy between the picture and the product is subject to the real object.
26. During use, it is normal that the appliance slightly ticks or fizzes. Please do not panic.
27. Please refer to below paragraphs about details on cleaning, operating times and speed settings for accessories.
28. Although the product has been checked its usage and consequences are strictly user responsibility.

PARTS

The Delimano Multicooker Select contains the following parts for following functions:

Pic. 1 (see: **PICTURES**, Pic. 1)

1. Lid Release button	4. Condensation collector	7. Safety valve
2. Handle	5. Display	8. Seal
3. Lid	6. Control panel	

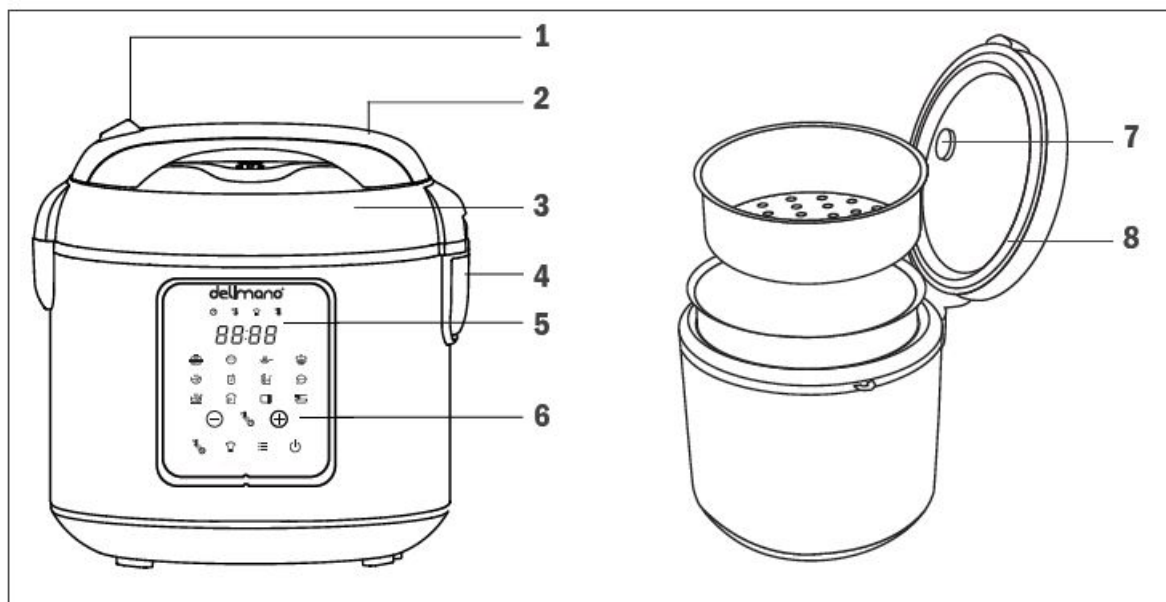

Pic. 2 (see: **PICTURES**, Pic. 2)

1. Inner cooking pot	3. Hanging soup spoon	5. Steamer
2. Standing rice spoon	4. Measurement cup	6. Power cable

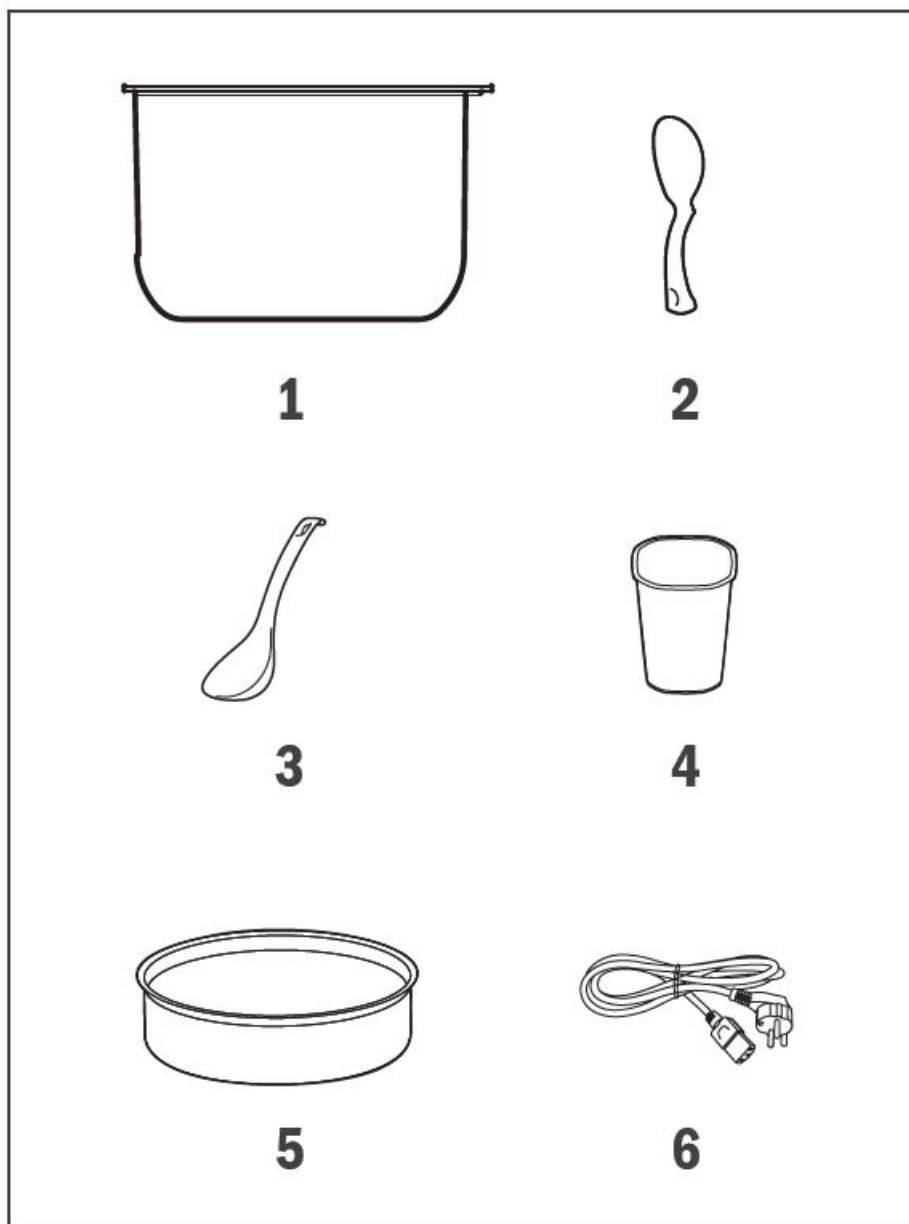

Pic. 3 (see: **PICTURES**, *Pic. 3*)

1. Timer indicator	8. Stew mode	15. Baking mode	22. Menu 23. Power button
2. Temperature indicator	9. Porridge mode	16. Pasta mode	
3. Manual indicator	10. Yoghurt mode	17. Minus	
4. Keep warm indicator	11. Sous vide mode	18. Temperature/timer	
5. Steam mode	12. Whole grain mode	19. Plus	
6. Rice mode	13. Soup mode	20. Keep warm / Cancel	
7. Fry mode	14. Bread mode	21. Manual mode	

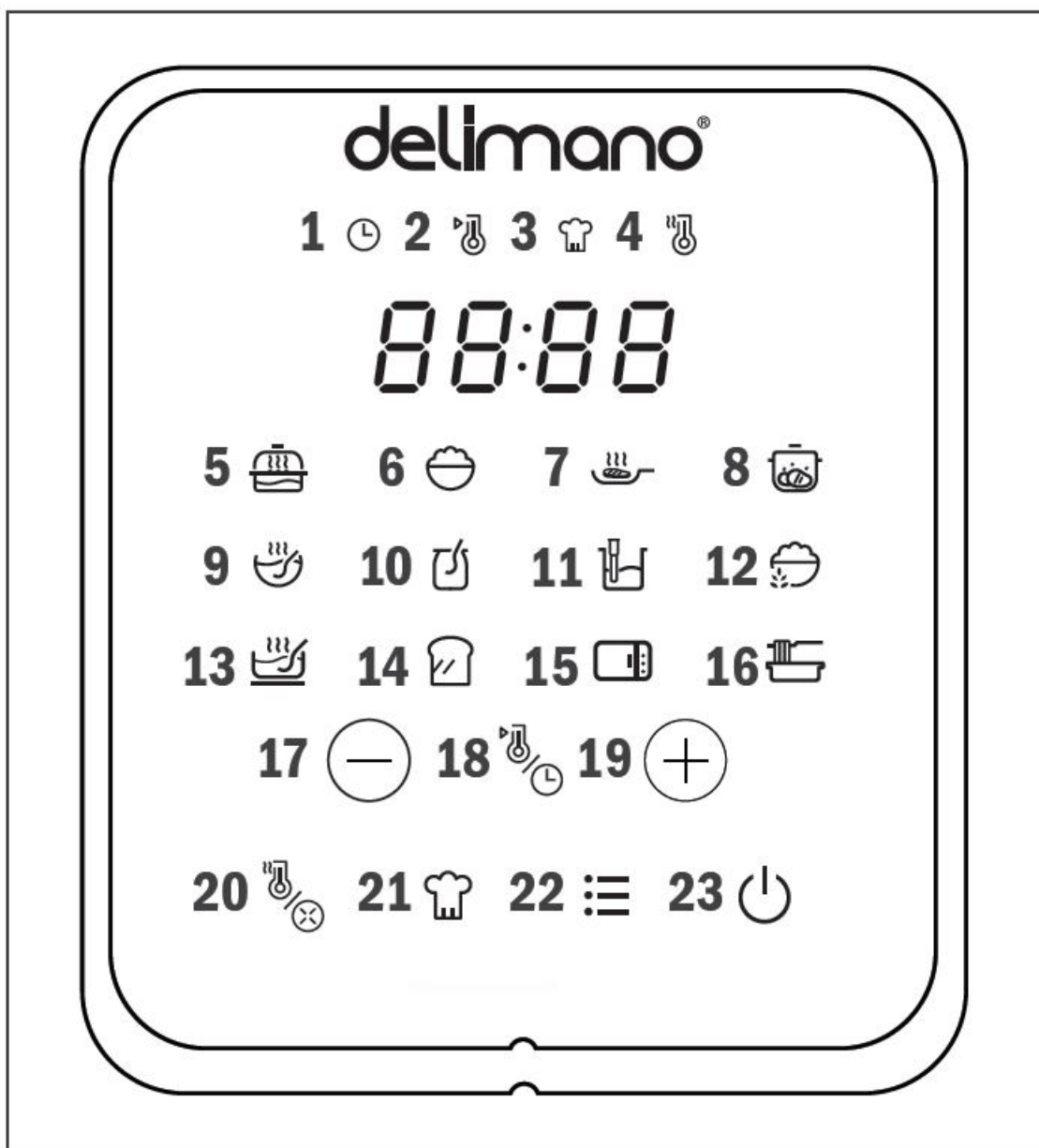

BEFORE USE

1. Clean and dry the inner pot and utensils thoroughly. Wipe the device with damp cloth.
2. Make sure safety valve and seal are positioned correctly.
3. Place the device on flat, stable, dry and heat resistant surface.

USAGE

1. Rotate the pot around for 2-3 times to ensure close attachment between the pot bottom and heating plate; press the lid until you hear a click.
2. Plug the power cable in device and corresponding power supply (power symbol starts blinking).
3. Press power button to turn on the control panel and put the device in standby mode (display shows ---).

NOTES:

- If no other action is made the device will automatically shut off after 120 seconds.
- Do not place the cooking pot on other stoves for pre/heating. Do not replace the cooking pot with other

containers and operate the device on the cooking hobs.

- Do not boil rice with hot water to avoid affecting the temperature control and avoid poor results.
- Regularly clean the safety valve.

BUTTONS

• Power

1. Press once in standby state to turn the device (and rest of control) on. Display shows “- - - -”.
2. Always press ones to confirm and start the chosen mode. Running circle turn on display. NOTES:
If the device is not used in standby state for more than 2 minutes it will turn off automatically

• Keep Warm/Cancel

1. While in standby state, press “Keep Warm/Cancel” button to start the “keep warm” (temperature preservation) mode.
2. While in any working mode press “Keep Warm/Cancel” button to “cancel” the running program and return it to standby state.
3. Temperature preservation mode will automatically start when cooking is completed, the timer displays from 0 to 12 hours. The LED displays “— — — —” after 12 hours and returns to the “standby state” after that.
4. During operation (Steam, Rice, Stew, Porridge, Whole grain, Soup, Bread, Baking and manual mode), press the power button for two seconds to turn off heat preservation function (its indicator turns off).

NOTES:

- FRY, Yoghurt and Pasta mode can not keep warm function.
- You can turn off/reset any mode/program with the press of keep warm/cancel button.

• Menu button

In standby state, press the “Menu” button to select various modes. By pressing the “MENU” button alternate between modes. The functions cycle as follow: Steam-Rice-Fry-Stew-Porridge-Yogurt-Sous vide-Whole grain-Soup-Bread-Baking-Pasta.

• Manual button

In standby state, press the “Manual” button to select this mode.

• TEMP/TIMER button

After selecting the manual mode, temperature and timer must be set.

1. After selecting the manual mode cooking time setting (pre-set cooking time is 15 minutes) starts to flash on display.
2. By pressing + or – buttons cooking time in increments of 1 minute can be set between 1 minute and 12 hours.
3. Press temp/timer button to enter temperature setting (pre-set temperature – 100 °C– starts to flash on display).
4. By pressing + or – buttons cooking temperatures in increments of 10 °C can be set between 30 and 150 °C
5. Press power button to start the manual mode. *If no delay start of cooking is needed.

• DELAY setting

1. *Press temp/timer button again to enter in delay start setting (pre-set – 1 hour delay – starts to flash on display).
2. By pressing + or – buttons cooking delay time in increments of 1 hour can be set between 1 and 24

hours.

3. Press power button to start the manual mode with delay (temp/timer indicator stays turned on). Display will reduce the number of hours before switching to last 59 minutes before starting manual mode automatically.

• STEAM

1. While in standby state, press the “Menu” button (steam mode is selected first), steam mode symbol starts to blink (10 minutes default cooking time is blinking on display).
2. Press the + or – button to set the cooking time between 5 minutes and 2 hours in one minute increments.
3. Press the power button to start the steam mode. * If no delay start of steaming is needed.
 - a. *Press temp/timer button to set the delay start (1 hour default delay starts to flash on display).
 - b. Press the + or – button to set the delay start between 1 and 24 hours with one hour increments.
 - c. Press power button to start the steam mode with delay (temp/timer indicator stays turned on). Display will reduce the number of hours before switching to last 59 minutes before starting manual mode automatically.
4. After elapsed cooking time the device will automatically switch to temperature preservation time.

• RICE

1. While in standby state, select the rice mode by pressing “Menu” button – rice symbol starts to blink (15 minutes default cooking time is blinking on display).
2. Press the + or – button to set the cooking time between 10 minutes and 2 hours in one minute increments.
3. Press the power button to start the rice mode.
4. After elapsed cooking time the device will automatically switch to temperature preservation time.

• FRY

1. While in standby state, select the fry mode by pressing “Menu” button – fry symbol starts to blink (15 minutes default cooking time is blinking on display).
2. Press the + or – button to set the cooking time between 5 minutes and 1 hour in one minute increments.
3. Press the power button to start the fry mode. The device enters in standby state automatically after elapsed cooking time.

NOTES:

- Amount of oil should not exceed 10 mm.
- Do not close the lid during frying.

• STEW

1. While in standby state, press the “Menu” button to select stew mode; stew mode symbol starts to blink (30 minutes default cooking time is blinking on display).
2. Press the + or – button to set the cooking time between 10 minutes and 12 hours in one minute increments.
3. Press the power button to start the stew mode. * If no delay start of steaming is needed.
 - a. *Press temp/timer button to set the delay start (1 hour default delay starts to flash on display).
 - b. Press the + or – button to set the delay start between 1 and 24 hours with one hour increments.
 - c. Press power button to start the stew mode with delay (temp/timer indicator stays turned on). Display will reduce the number of hours before switching to last 59 minutes before starting manual mode automatically.
4. After elapsed cooking time the device will automatically switch to temperature preservation time.

• PORRIDGE

1. While in standby state, press the “Menu” button to select porridge mode; porridge mode symbol starts to blink (8 minutes default cooking time is blinking on display).
2. Press the + or – button to set the cooking time between 5 minutes and 2 hours in one minute increments.
3. Press the power button to start the porridge mode. * If no delay start of steaming is needed.
 - **a.** *Press temp/timer button to set the delay start (1-hour default delay starts to flash on display).
 - **b.** Press the + or – button to set the delay start between 1 and 24 hours with one-hour increments.
 - **c.** Press power button to start the porridge mode with delay (temp/timer indicator stays turned on). Display will reduce the number of hours before switching to last 59 minutes before starting manual mode automatically.
4. After elapsed cooking time the device will automatically switch to temperature preservation time.

• YOGHURT

1. In a sauce pan, heat milk to 80 °C while stirring constantly.
2. Allow milk to cool to 45 °C. Add yoghurt culture. Stir mixture thoroughly.
3. Pour milk mixture into the clean and dry inner pot. Before placing it in the main unit.
4. While in standby state, press the “Menu” button to enter yogurt mode; yoghurt mode symbol starts to blink (6 hours default cooking time is blinking on display).
5. Press the + or – button to set the cooking time between 1 and 12 hours in ten minute increments.
6. Press the power button to start the yoghurt mode. The device enters standby state automatically after elapsed time.
7. Once done, store the yogurt in an air tight container placed in refrigerator.

NOTE:

Do not leave yogurt in the inner pot after done.

• SOUS VIDE

1. While in standby state, press the “Menu” button to enter sous vide mode, sous vide mode symbol starts to blink (3 hours default cooking time is blinking on display).
2. Press the + or – button to set the cooking time between 10 minutes and 12 hours in one minute increments.
3. Press the temp/timer button to set the temperature (60 °C default cooking temperature is blinking on display)
4. Press the + or – button to set the cooking temperature between 30 and 99 °C in one °C increments.
5. Press the power button to start the sous vide mode. * If no delay start of steaming is needed.
 - **a.** *Press temp/timer button again to set the delay start (1 hour default delay starts to flash on display).
 - **b.** Press the + or – button to set the delay start between 1 and 24 hours with one hour increments.
 - **c.** Press power button to start the sous vide mode with delay (temp/timer indicator stays turned on). Display will reduce the number of hours before switching to last 59 minutes before starting manual mode automatically.
6. After elapsed time the device goes into standby state automatically.

• WHOLE GRAIN

1. While in standby state, press the “Menu” button to select whole grain mode; whole grain mode symbol starts to blink (15 minutes default cooking time is blinking on display).
2. Press the + or – button to set the cooking time between 10 minutes and 2 hours in one minute increments.

3. Press the power button to start the whole grain mode. * If no delay start of steaming is needed.
 - **a.** *Press temp/timer button to set the delay start (1 hour default delay starts to flash on display).
 - **b.** Press the + or – button to set the delay start between 1 and 24 hours with one hour increments.
 - **c.** Press power button to start the whole grain mode with delay (temp/timer indicator stays turned on). Display will reduce the number of hours before switching to last 59 minutes before starting manual mode automatically.
4. After elapsed cooking time the device will automatically switch to standby state.

• SOUP

1. While in standby state, press the “Menu” button to soup mode; soup mode symbol starts to blink (20 minutes default cooking time is blinking on display).
2. Press the + or – button to set the cooking time between 5 minutes and 4 hours in one minute increments.
3. Press the power button to start the soup mode. * If no delay start of steaming is needed.
 - **a.** *Press temp/timer button to set the delay start (1 hour default delay starts to flash on display).
 - **b.** Press the + or – button to set the delay start between 1 and 24 hours with one hour increments.
 - **c.** Press power button to start the soup mode with delay (temp/timer indicator stays turned on). Display will reduce the number of hours before switching to last 59 minutes before starting manual mode automatically.
4. After elapsed cooking time the device will automatically switch to standby state.

• BREAD

1. While in standby state, press the “Menu” button to select bread mode; bread mode symbol starts to blink (2h 30min minutes default cooking time is blinking on display).
2. Press the + or – button to set the cooking time between 10 minutes and 4 hours in one minute increments.
3. Press the power button to start the bread mode.
4. After elapsed cooking time the device will automatically switch to temperature preservation time.

NOTE:

Defrost frozen dough thoroughly before use. Don't use more than 500 g.

• BAKING

1. While in standby state, press the “Menu” button to select baking mode; baking mode symbol starts to blink (1 hour default cooking time is blinking on display).
2. Press the + or – button to set the cooking time between 10 minutes and 4 hours in one minute increments.
3. Press the power button to start the baking mode.
4. After elapsed cooking time the device will automatically switch to temperature preservation time.

• PASTA

1. While in standby state, press the “Menu” button to select pasta mode; pasta mode symbol starts to blink (10 minutes default cooking time is blinking on display).
2. Add water and salt.
3. Press the + or – button to set the cooking time between 5 and 35 minutes in one minute increments.
4. Press the power button to start the pasta mode.
5. When the water is boiled, the digital screen displays the countdown timer, open the cover, add the corresponding amount of pasta according to water level and start mixing, stir 1 to 2 minutes, close the cover and continue cooking.

6. After elapsed cooking time the device will automatically switch to standby state.

CLEANING AND MAINTENANCE

Always turn off and unplug the device from power supply before allowing it to cool down. Wash the inner pot and accessories before drying them thoroughly.

Wipe the main unit with damp cloth and dry thoroughly.

Store in dry place without direct sunlight.

TROUBLESHOOTING

If device is not working as supposed to, please contact your nearest dealer.

VISIT

WWW.DELIMANO.COM

- **Product name:** Delimano Multicooker Select
- **ID:** 110073730
- **Model no.:** MB-RS5010W3
- **Technical data:** 220-240 V~, 50/60 Hz, 860-1023 W
- **Country of origin:** P.R.C.

Production date and batch number can be found on the product.

Trademark owner, importer to EU and distributor: TOP SHOP INTERNATIONAL SA, VIA AL MULINO 22, CH-6814 CADEMPINO, SWITZERLAND

Manufacturer: FOSHAN SHUNDE MIDEA ELECTRICAL HEATING APPLIANCES MANUFACTURING CO., Ltd., No.19 Sanle Dong Road, Beijiao Town, Shunde District, Foshan City, Guangdong Province, P.R.C.

Documents / Resources

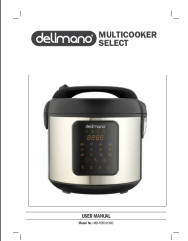
	delimano MB-RS5010W3 Multi Cooker Select [pdf] User Manual MB-RS5010W3, Multi Cooker Select
---	--

References

- [Refaccionaria Moderna ®](#)
- [Studio Moderna, multi-brand and direct-to-consumer electronic retailer](#)
- [Svorio Ir LieknĀjimĀ](#)
- [Топ Шоп - онлайн магазин Top Shop | Topshop](#)
- [TopShop.It | Topshop](#)

