

delimano
KF-R50 18
In 1 Multi
Cooker



delimano KF-R50 18 In 1 Multi Cooker Instruction Manual

[Home](#) » [delimano](#) » delimano KF-R50 18 In 1 Multi Cooker Instruction Manual 

Contents

- 1 delimano KF-R50 18 In 1 Multi Cooker
- 2 Product Usage Instructions
- 3 FAQs
- 4 PRODUCT INFORMATION
- 5 Important Safeguards
- 6 Parts
- 7 TECHNICAL DATA
- 8 Usage
- 9 Documents / Resources
 - 9.1 References

delimano

delimano KF-R50 18 In 1 Multi Cooker



Product Usage Instructions

Operation:

1. Connect the power cord and plug it in. The LED display will show standby mode.
2. Choose the desired function by pressing the MENU key. Press START to begin cooking.
3. Adjust cooking time:
 - Press the Temperature/Time button after selecting the function.
 - Use the Hour/+ or Min/- keys to adjust the cooking time.
 - Press START to confirm.
4. Adjust temperature (for FRY and Custom function):
 - Select FRY or Custom function.
 - Press the Temperature/Time button.
 - Use the Hour/+ or Min/- keys to set the temperature.
 - Press START to confirm.

Cancel/Keep Warm:

To cancel or activate the keep warm mode, press the Cancel/Keep Warm button. This will switch the cooker to keep warm mode with an indicator light.

FAQs

- **Q: How do I clean the multi-cooker?**
 - A: Ensure the cooker is unplugged and cooled down before cleaning. Use a damp cloth to wipe the exterior and inner parts. The inner pot and accessories are usually dishwasher-safe.
- **Q: Can I use the multi-cooker for baking?**
 - A: The multi-cooker is primarily designed for cooking various dishes through its preset functions. It may not be suitable for baking due to temperature limitations.

PRODUCT INFORMATION

Dear customer! Many thanks for selecting our Delimano 18in1 Multicooker! All Delimano products are perceived as very valuable, so counterfeiters like to copy us and thus abuse customers with worse quality with no warranty and service. Please, report any copied, counterfeited, similar product or unauthorised distributor to the brand. protection@studio-moderna.com to help us fight against illegal counterfeits. For the Delimano 18in1 Multicooker, you just bought we guarantee that by carefully following the instructions below and with appropriate care you will enjoy many confident years with the Delimano 18in1 Multicooker. Read this manual thoroughly before using it and save it for future reference.

Important Safeguards

1. Use of applicable container for cooking only – Use of an inapplicable container for cooking may lead to poor heat conduction affecting the food quality, and even resulting in failure or any other unforeseen accident.
2. Place of use (location) – This device is intended for household use only. It is not allowed to place this product on an unstable, gas oven or near any other high-temperature article to the avoidance of deformation which may result in functional failure. The inner pot is not allowed to be used with other heaters.

3. Children safety – This device can be used by children aged 8 years and above as well as by persons with reduced physical, sensory, or mental capabilities or lack of experience and knowledge if they have been given supervision or instruction concerning the use of the device in a safe way and understand the hazards involved. Children should not play with the device. Cleaning and user maintenance should not be done by children unless they are older than 8 and supervised.
4. Keep the inner pot and heater clean – Keep the inner pot, heater, and internal side of the cooker clean to avoid burning which may result in failure or other unforeseen accidents.
5. Storage and protection of power wire – For use and storage of power wires, it is not allowed to process, damage, pull, twist, lengthen, or allow any heavy object to press the power wires to avoid any failure or accident resulting from the damage of wire skin. In case the wire is damaged, please stop using the device immediately and contact support service for replacement.
6. No dishcloth or other item allowed to cover this product – During cooking or warm keeping, it is not allowed to cover the air outlet with any object because it may lead to functional failure caused by the deformation of the cooker body.
7. Switch operation or shutdown of power is not advised during cooking – Operation of switch or power shutdown may affect the food quality caused by uneven heating performance.
8. No washing with water – No washing with water is allowed to clean the cooker's body. It is not also allowed to immerse this entire cooker in the water for the avoidance of functional failure, electric shock, or any other unforeseen accident.
9. Do not turn the power on when the inner pot is not inside – It is not allowed to turn the power on when the cooker is not loaded or the inner pot hasn't been put inside to avoid the fuse being burnt or any accident.
10. This device should never operate empty, because such action could result in appliance failure and/or injuries to the user.
11. High-Temperature Steam When Cooking – When cooking, steam may come from the air outlet, so it is not allowed to close your face or hands to the outlet and the upper lid for avoidance of scald.
12. Make sure to use the device with the correct power source- If the voltage is less than 220V, the heater is unable to work normally leading to poor cooking performance; if the voltage is more than 220V, it may cause damage to the circuit resulting in fire or any other unforeseen accident.
13. Don't share one socket with other electric appliances – Sharing one socket with other electric appliances may lead to overheating of the socket causing fire or any other unforeseen accident.
14. Unauthorized disassembly, repair, or reconstruction is not allowed – Unauthorized disassembly or reconstruction may lead to unforeseen failure or accidents, causing a serious breach of customer's rights and interests.
15. Put Inner Pot into Electric Cooker – Dry the inner pot and confirm there are no impurities on the heater. Put the inner pot in the electric cooker and then turn the inner pot around to allow the pot to be in full contact with the heater. Don't fill water in the outer pot to avoid any failure or electric shock.
16. Although the device has been checked its usage and consequences are strictly user's responsibility.

Parts

Main parts of the product:

Pic. 1

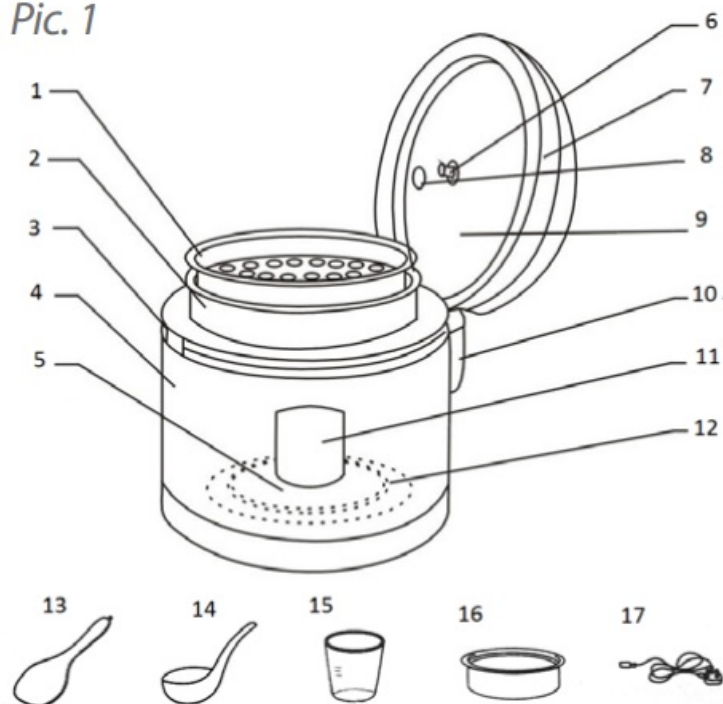

1. steamer
2. inner pot (capacity 5l)
3. outer pot
4. body
5. temperature control unit
6. pin
7. cover lid
8. steam hole
9. keep warm lid
10. excess water catcher
11. control panel
12. hot plate
13. spoon
14. ladle
15. measuring cup
16. steamer
17. power cord

TECHNICAL DATA

Rating

- Item Number KF-R1150 (touch panel)
- Voltage 220-240 V~, 50Hz
- Power 700 W
- Capacity 5L
- Number of persons served 5-10

Usage

Operation:

- **Connected the power cord. Plug in.**
 - The LED display and function names will be light on, the left LED will show you “00:00”, and the small LED display will show the bottom temperature. This is stand-by mode.
- **Choose the function you want:**
 - Press the MENU key, the big LED display will show the default cooking time, the function that has been chosen will spark, and press the “START” button to work. when working, the function indicator light will light, and other functions’ light will not light. You can also choose functions by press “+” and “-“, “+” is forward, and “-“ is backward.
 - 2a) You can adjust the cooking time After choosing the function you need, the big LED display will show you the default cooking time, press the “Temperature/time” button, then press the “Hour/+” or “Min/-” key (“+” is to increase the cooking time, “-“ is to reduce the cooking time.) to adjust the cooking time. And after setting, press ”START”.
 - 2b) You can adjust the temperature
 - For FRY and Custom functions, the user can set the temperature.
 - Choose FRY or Custom function, press the “Temperature/ Time” button, and the left LED display will spark, then press “Hour/+” or “Min/-”, to set the cooking time, and then press the “Temperature/ Time” button again, the right LED display will spark, use the “Hour/+” or “Min/-” key to set the temperature (“Hour/+” is to increase the cooking temperature, “Min/-“ is to reduce the cooking temperature.), after setting then press “Start”.
 - Remark: “Cooking time” and “cooking temperature” are the same key, press the key one time, it will be “Cooking time” adjust, and press this key again, it will be “Cooking temperature” adjust.
- **Cancel/keep warm**
 - When plug-in, the cooker is stood by, press “cancel/ keep warm”, and the cooker will turn into “keep warm” mode. The indicator will be on. And the display will show the keep warm time.
 - During your operations/ settings, if press this button, it will go back to standby mode

Documents / Resources

	<p>delimano KF-R50 18 In 1 Multi Cooker [pdf] Instruction Manual KF-R50 18 In 1 Multi Cooker, KF-R50, 18 In 1 Multi Cooker, Multi Cooker, Cooker</p>
---	--

References

- [Studio Moderna, multi-brand and direct-to-consumer electronic retailer](#)
- [User Manual](#)

Manuals+. Privacy Policy

This website is an independent publication and is neither affiliated with nor endorsed by any of the trademark owners. The "Bluetooth®" word mark and logos are registered trademarks owned by Bluetooth SIG, Inc. The "Wi-Fi®" word mark and logos are registered trademarks owned by the Wi-Fi Alliance. Any use of these marks on this website does not imply any affiliation with or endorsement.