



DEFA 715001 Power Up
with 4 Meter Cable Plus
Docking Unit



DEFA 715001 Power Up with 4 Meter Cable Plus Docking Unit Instruction Manual

[Home](#) » [DEFA](#) » DEFA 715001 Power Up with 4 Meter Cable Plus Docking Unit Instruction Manual

Contents

- [1 DEFA 715001 Power Up with 4 Meter Cable Plus Docking Unit](#)
- [2 Product Information](#)
- [3 Product Usage Instructions](#)
- [4 Optimized and reliable use of available power](#)
- [5 Easy installation](#)
- [6 Specification](#)
- [7 Warranty](#)
- [8 Documents / Resources](#)
 - [8.1 References](#)
- [9 Related Posts](#)



DEFA 715001 Power Up with 4 Meter Cable Plus Docking Unit



Product Information

Specification

- Item Number: 715001
- EAN: 7042287150019
- Dimensions: L: 350mm x W: 168mm x D: 85mm
- Weight Unit: 2.4 kg
- Weight Cable: 2.3 kg
- Operating Temperature: -40°C to +50°C
- Storage Temperature: -50°C to +85°C
- Material Charging Unit: Polycarbonate
- Charging Power: Up to 22kW
- Charging Current: 32A (adjustable)
- Voltage: 230/400 V (1/3-phase, 50-60Hz)
- Charging Mode: Mode 3
- Connection to Vehicle: Type 2
- Charging Cable: Included, 4m
- Integrated Display Size: 69mm x 69mm
- Brightness: Automatically adjusted

Safety & Protection

- RCD-DD: 6mA DC in acc. IEC62955

- IP Rating: IP55
- IK Rating: IK10
- Fire Classification: UL94 V0
- Isolation Class: I
- Overvoltage Category: III
- Overheat Protection: Internal sensor

Installation

- Grid Type: TN / IT / TT
- Fuse Size: 32A

Warranty

5 years warranty

Recycling Included

- EE-waste
- Charging Unit with 4m Charging Cable
- Locking Tool
- Lockable Docking Unit

*Specifications without wall bracket. For more information, visit defa.com

Product Usage Instructions

Installation Process

To install the DEFA Power Up charging unit, follow these steps:

1. Ensure you have a prepared wall bracket in the facility.
2. Remove the protective cover from the charging unit.
3. Click and connect the DEFA Power Up to the wall bracket securely.

Charging Process

To start charging your vehicle using DEFA Power Up, follow these instructions:

1. Plug the integrated Type 2 charging cable into your vehicle.
2. The display on the charging unit will guide you through the step-by-step charging process.
3. The DEFA Power S is designed to provide fast charging without derating, utilizing all available power in the facility.

Frequently Asked Questions (FAQ)

Q: Is a wall bracket included with the DEFA Power Up charging unit?

A: No, the wall bracket is not included with the DEFA Power Up charging unit. You need to have a prepared wall bracket in your facility for installation.

DEFA Power

- Item-no: 715001
- Item name: DEFA Power Up – 4m cable + docking unit
- Charging Unit ideal for system installations

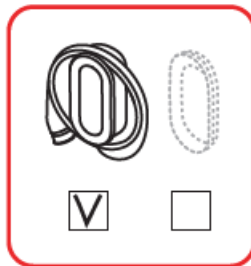

Charging unit with display, integrated cable and docking unit. Mobile network included. Click on the prepared wall bracket to complete DEFA Power S charge point.

The ideal solution for system installations, with the new generation EV charger. DEFA Power S offers the optimal user experience with the 4-meter integrated charging cable and display. The intuitive display is improving the user experience as well as giving the facility owner/operator the opportunity for secure payment. To complete your DEFA Power S charging station, remove the cover on the wall bracket and click and connect the DEFA Power Up charging unit to the prepared wall bracket. DEFA Power S – a new generation system charging.

User experience

Intuitive high-quality display with step-by-step charging experience. Robust integrated 4-meter Type 2 charging cable and docking unit for convenient handling and use. Mobile network included.

Optimized and reliable use of available power

DEFA Power S is designed to provide the fastest possible charging without derating, and utilizing all available power in the facility.

Smart charging with operator

Check with the (CPO) Charge point operator what opportunities there are for smart charging with app.



*A wall bracket is prepared for DEFA Power Up.
Remove the protective cover and click on the charging unit*

Easy installation

When you have a prepared wall bracket in the facility, it is easy to click and connect the DEFA Power Up to the wall bracket.

Compliance excellence.

Demands from government and certification bodies are increasing, so compliance is becoming more and more important. DEFA Power meets all international standards and regulations (AFIR, OCPP 2.0.1, ISO 15118, among others



DEFA Power Up charging unit is connected and DEFA Power S is ready to use – with the smart docking unit you can protect the connector and keep the cable tidy.

Specification

Dimension*:

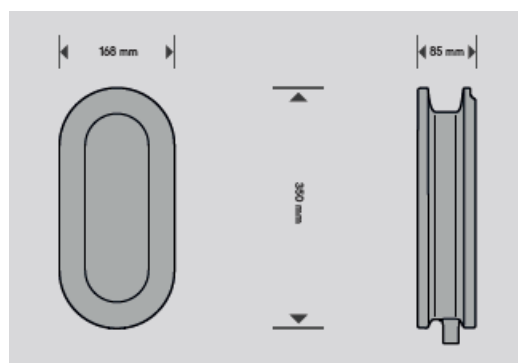

General*:

- Item number: 715002
- EAN: 7042287150026
- Dimension (mm): L: 350 x W: 168 x D: 85
- Weight unit: 2,4 kg
- Weight cable: 3,5 kg
- Operating temperature: -400C to +500C
- Storage temperature: -500C to +850C
- Material charging unit: Polycarbonate

Charging

- Charging power: Up to 22kW
- Charging current: 6—32A (adjustable)
- Voltage: 230/400 V (1/3-phase, 50-60Hz)
- Charging mode: Mode3
- Connection to vehicle: Type 2
- Charging cable: Included, 6 m

Interface

- Integrated display
- Size: 69 mm x 69 mm
- Brightness: Automatically adjusted
- Power setup: App to set DEFA Power



Safety & protection

- RCD-DD: 6mA DC in acc. IEC62955
- IP: 55
- IK: 10
- Fire classification: UL94 V0
- Isolation class: I
- Overvoltage category: III
- Overheat protection: Internal sensor

Standard & certification (with Power Ready S)

- CE
- IEC61851
- IEC62955
- IEC61439-7
- IEC60947-2 ACSEV

Installation

Grid: TN / IT / TT
Fuse size: 32A

Warranty

5 years

Recycling

EE-waste

Included*

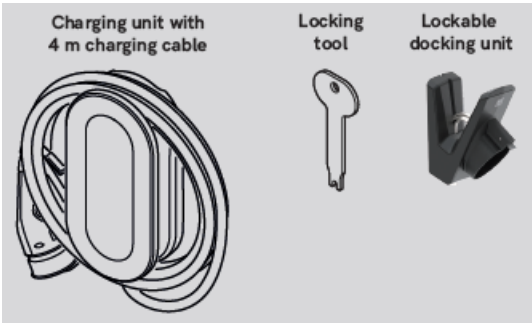

*Spesifications without wall bracket.

For more information, visit defa.com

Documents / Resources

	<p>DEFA 715001 Power Up with 4 Meter Cable Plus Docking Unit [pdf] Instruction Manual 715001 Power Up with 4 Meter Cable Plus Docking Unit, 715001, Power Up with 4 Meter Cable Plus Docking Unit, Meter Cable Plus Docking Unit, Docking Unit</p>
---	--

References

- [Forsiden | Item](#)
- [User Manual](#)

[Manuals+.](#) [Privacy Policy](#)

This website is an independent publication and is neither affiliated with nor endorsed by any of the trademark owners. The "Bluetooth®" word mark and logos are registered trademarks owned by Bluetooth SIG, Inc. The "Wi-Fi®" word mark and logos are registered trademarks owned by the Wi-Fi Alliance. Any use of these marks on this website does not imply any affiliation with or endorsement.