



## DEERC D10 Drone with Camera Instruction Manual

[Home](#) » [DEERC](#) » DEERC D10 Drone with Camera Instruction Manual 

# DEERC

---

### Contents

- 1 11.3 Trimmer Function
- 2 11.4 Take Photo / Video
- 3 11.5 Altitude-Hold Function
- 4 11.6 360° Flip
- 5 11.7 Circle Fly
- 6 11.8 Auto-Rotation
- 7 11.9 Headless Mode
- 8 12.0 SPECIFICATIONS
- 9 13.0 CONTACT US
- 10 14.0 GENERAL INFORMATION
- 11 Documents / Resources
- 12 Related Posts

### 11.3 Trimmer Function

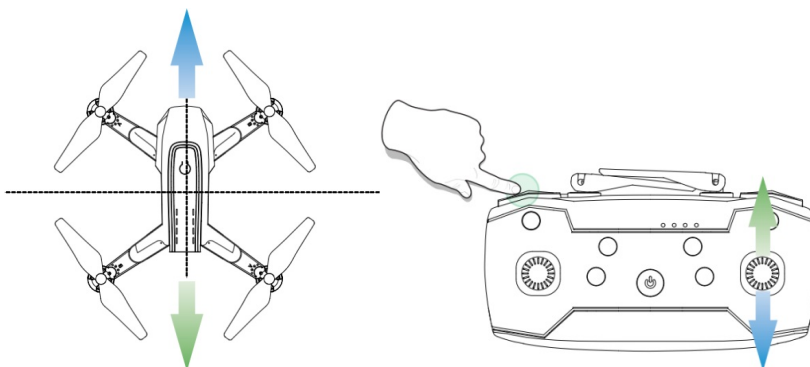

**F/B Sideways Drift Trim:** If the drone drifts forward, hold down the “Speed Switch” button and do not release it while pushing the direction joystick down to re-balance the drone. If the drone drifts backwards, hold down the “Speed Switch” button and do not release it while pushing the direction joystick up to re-balance the drone.

---

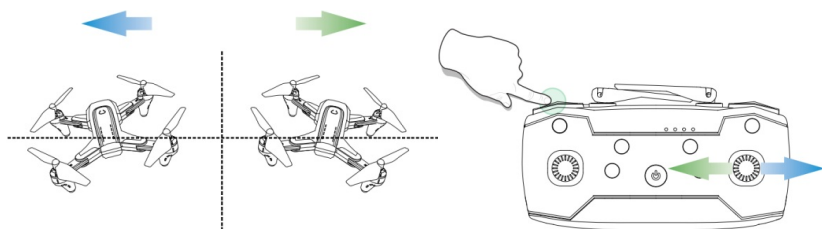

**L/R Sideways Dip Trim.** If the drone drifts left, hold down the “Speed Switch” button and do not release it while pushing the direction joystick right to re balance the drone. If the drone drifts right, hold down the ‘Speed Switch” button and do not release it while pushing the direction joystick left to re-balance the drone.

#### 11.4 Take Photo / Video

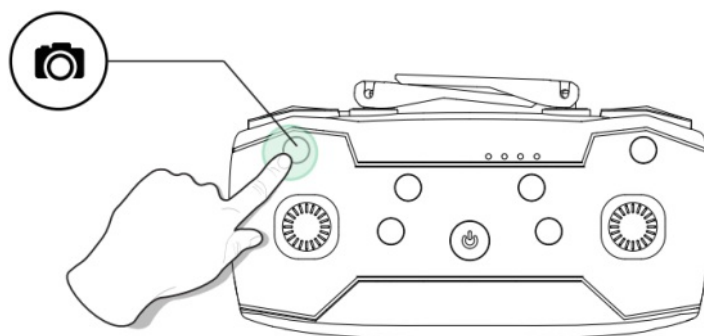

**Take Photo:** Short press the Photo button on the transmitter to take pictures. One beep can be heard from the transmitter, indicating the camera has successfully taken one photo.

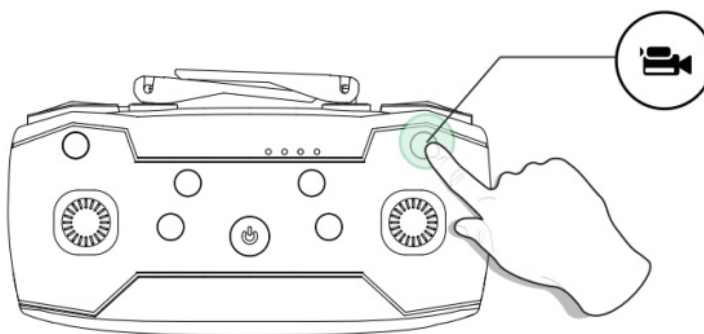

**Record Video:** Short press the Video button on the transmitter, two beeps from the transmitter will be heard. This tells you that the camera has started recording video. You can exit the recording by pressing the same button again.



**Do not take photos during the recording, which will interrupt the recording.**

### 11.5 Altitude-Hold Function

The drone is designed with altitude-hold function so the drone can maintain its altitude after you release the left joystick ( the left joystick will automatically spring back to the middle ).

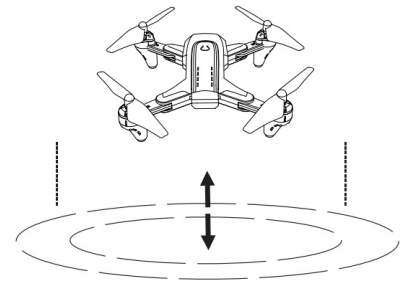

### 11.6 360° Flip

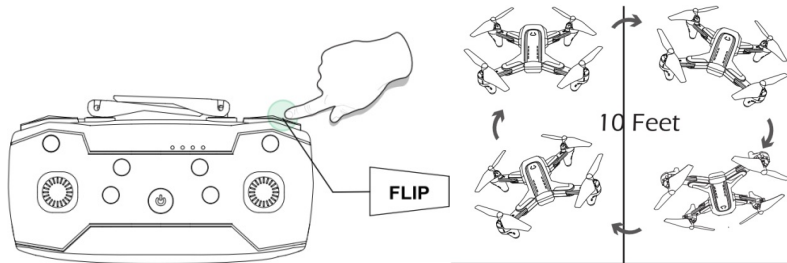

When you get familiar with all the functions of the drone, you can try this amazing flip mode. When you fly the drone at least 10 feet, press the 360° Flip button on the transmitter, then push the right joystick Forward/ Backward or Left/ Right, and the drone will do a flip towards the corresponding direction. If you are in MODE 1, push the right joystick Left/ Right or push the left joystick Forward/ Backward, and the drone will do a flip towards the corresponding direction.



**This function will perform better when the battery is fully charged.**

### 11.7 Circle Fly

Long press for 3 seconds

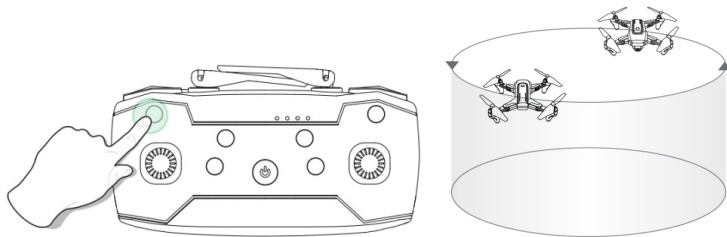

Press and hold the Photo button for about 3 seconds, the drone will enter the Circle Fly mode. Exit the Circle Fly mode by long pressing the same button again or pushing the direction joystick.

### 11.8 Auto-Rotation

Long press for 3 seconds

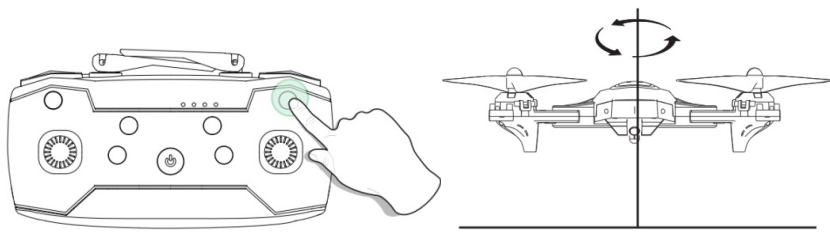

Press and hold the Video button for about 3 seconds, the drone will enter the Auto-Rotation mode. Exit the Auto-Rotation mode by long pressing the same button again or pushing the direction joystick.

### 11.9 Headless Mode

1. After pairing/ calibration, or during the flight of the drone, short press the Headless Mode button to enter Headless Mode. In Headless Mode, the indicator lights of the drone will flash continuously, and the transmitter will send out alarm sound continuously.
2. Short press the Headless Mode button again, and you will hear one beep, which indicates the drone exits the Headless Mode.

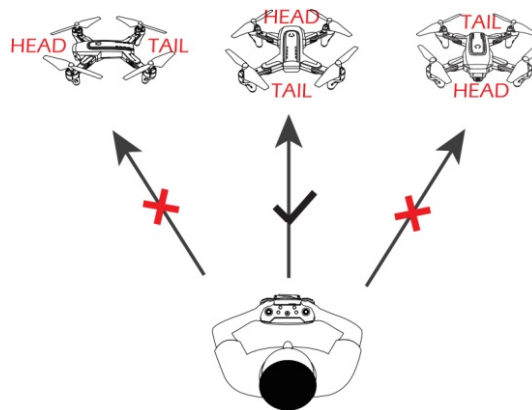

**Please make sure the pilot to stay in the same orientation as the drone head faces when the drone is pairing.**

Under Headless Mode, the forward direction is the direction that the head of drone faces when the drone is pairing. In order to make sure the pilot can tell drone's direction, we recommend that pilots to stay in the same orientation as the drone's head faces when the drone pairing. When the pilot pushes the direction joystick forward, the drone will fly forward. If the pilot pushes the direction joystick backward, the drone will fly towards him/her. If the pilot move the right stick left/right, the drone will move left/right relative to you.

### 12.0 SPECIFICATIONS

#### • DRONE

Model: D10

Weight: 158g/ 5.57oz

Max Flight Time. 12 minutes (per battery)

Operating Temperature Range: 32° to 104°F (0° to 40°C)

Size: 340\*340\*65 mm (Unfolded)

180\*142\*65mm (Folded)

- **DRONE BATTERY**

Capacity: 1000mAh

Voltage: 3.7V

Energy: 3.70 Wh

Battery Type: Li-Po Battery

Charging Temperature Range: 41° to 104°F (5° to 40°C)

Charging Time: 90 minutes (depends on charging power and remaining battery power)

---

- **TRANSMITTER**

Operating Frequency: 2.4 GHz

Max Flight Distance: 262 feet/ 80m (outdoors and unobstructed)

Operating Temperature Range: 32° to 104°F (0° to 40°C)

Battery Type: 1.5V AA Battery (not included)

---

- **CAMERA**

Photo Resolution: HD1280x 720P (stored on the phone)

Video Resolution: HD1280x 720P (stored on the phone)

Max Transmission Distance: 164 feet/ 50m (outdoors and unobstructed)

Transmission Frame Rate: 25 fps

Photo Formats: JPEG

Video Formats: AVI / MP4

Operating Temperature Range: 32° to 104°F (0° to 40°C)

---

- **USB CHARGING CABLE**

Voltage: 5 V

Rated Power: ≤ 10 W

### 13.0 CONTACT US

Please do not hesitate to contact us if you need further support.



[usa@deerc.com](mailto:usa@deerc.com) (USA)

[jp@deerc.com](mailto:jp@deerc.com) (JP)

[eu@deerc.com](mailto:eu@deerc.com) (EU)

### 14.0 GENERAL INFORMATION

#### FCC Statement:

Any Changes or modifications not expressly approved by the party responsible for compliance could void the user's authority to operate the equipment.

This device complies with part 15 of the FCC Rules. Operation is subject to the following two conditions:

- (1) This device may not cause harmful interference, and
- (2) This device must accept any interference received, including interference that may cause undesired operation.

NOTE: This equipment has been tested and found to comply with the limits for a Class B digital device, pursuant to Part 15 of the FCC Rules. These limits are designed to provide reasonable protection against harmful interference in a residential installation. This equipment generates uses and can radiate radio frequency energy and, if not installed and used in accordance with the instructions, may cause harmful interference to radio communications. However, there is no guarantee that interference will not occur in a particular installation. If this equipment does cause harmful interference to radio or television reception, which can be determined by turning the equipment off and on, the user is encouraged to try to correct the interference by one or more of the following measures:

- Reorient or relocate the receiving antenna.
- Increase the separation between the equipment and receiver.
- Connect the equipment into an outlet on a circuit different from that to which the receiver is connected.
- Consult the dealer or an experienced radio/TV technician for help.

WARNING: Changes or modifications not expressly approved by the party responsible for compliance could void the user's authority to operate the equipment.

#### RF Exposure

The equipment complies with FCC radiation exposure limits set forth for an uncontrolled environment. This device should be installed and operated with minimum distance 20cm between the radiator & your body. This part belongs to the drone.

RF warning for Portable device: The device has been evaluated to meet general RF exposure requirement. The device can be used in portable exposure condition without restriction. This part belongs to the transmitter.

#### IC Notice:

This device complies with Canada Industry licence-exempt RSS standard(s). Operation is subject to the following two conditions:

- (1) this device may not cause interference; and
- (2) this device must accept any interference. Including interference that may cause undesired operation of the device.

#### CAN NMB-3 (B)

##### RF Exposure

##### Radiation Exposure Statement:

This equipment complies with IC radiation exposure limits set forth for an uncontrolled environment. This equipment should be installed and operated with minimum distance 20cm between the radiator & your body.

#### **HOW TO RECYCLE THIS PRODUCT**

This symbol on the product or its documentation indicates that it must not be disposed of with household waste. Uncontrolled waste disposal may harm the environment or human health. Please separate your device from other types of waste to recycle it responsibly.

This will help to foster the sustainable re-use of material resources.

We invite you to contact your retailer or inquire at your local town hall to find out where and how the drone can be recycled.

#### **BATTERY WARNING:**

1. Failure to follow all the instructions may result in serious injury, irreparable damage to the battery and may cause a fire, smoke or explosion.
2. Always check the battery's condition before charging or using it
3. Replace the battery if it has been dropped, or in case of odor, overheating, discolouration, deformation or leakage.
4. Never use anything other than the approval LiPo charger the battery. Always use a balancing charger for LiPo cells or a LiPo cell balancer. It is recommended that you do not to use any other charger than the one provided with the product.
5. The battery temperature must never exceed 60°C (140°F) otherwise the battery could be damaged or ignite.
6. Never charge battery on a flammable surface, near flammable products or inside a vehicle (preferably place the battery in a non-flammable and nonconductive container).
7. Never leave the battery unattended during the charging process. Never disassemble or modify the housing's wiring, or puncture the cells. Always ensure that the charger output voltage corresponds to the voltage of the battery. Do not short circuit the batteries.
8. Never expose the LiPo battery to moisture or direct sunlight, or store it in a place where temperatures could exceed 60°C(car in the sun, for example).
9. Always keep it out of reach of children.
10. Improper battery use may result in a fire, explosion or other hazard.
11. Non-rechargeable batteries are not to be recharged. Rechargeable batteries are only to be charged under adult supervision.
12. Different types of batteries or new and used batteries are not to be mixed.
13. Batteries are to be inserted with the correct polarity.
14. The supply terminals are not to be short-circuited. Regular examination of transformer or battery charger for any damage to their cord, plug, enclosure and other parts and they must not be used until the damage has been repaired.
15. The packaging has to be kept since it contains important information.
16. The toy is only to be connected to Class II equipment bearing the symbol. 



EU RF Power(EIRP): <10 dBm (2413MHz ~ 2461 MHz)

#### Caution

1. The max operating of the EUT is 45°C. and shouldn't be lower than -10°C.
2. The device complies with RF specifications when the device used at 0mm from your body.
3. Declaration of Conformity.

We, Xiamen Huoshiquan Import & Export CO.,LTD

hereby, declare that the essential requirements compliance with the Directive 2014/53/EU, the RoHS Directive 2011/65/EU and Safety Directive 2009/48/EC have been fully fulfilled on our product with indication below:

Product Name: REMOTE CONTROL MODEL/RADIO CONTROLLED

Model/Mark : D10/DEERC

The Statement of compliance is available at the following address:

[http://www.holystone.com/Download/CE/D10\\_EU\\_DOC.pdf](http://www.holystone.com/Download/CE/D10_EU_DOC.pdf)

This product can be used across EU member states.

MANUFACTURER INFORMATION

Manufactured by  
Xiamen Huoshiquan Import & Export CO.,LTD  
Room 703, No. 813-2 Xiahe Road, Siming District XIAMEN, China  
+1(855) 888-6699



Made in China

Documents / Resources

	<p><a href="#">DEERC D10 Drone with Camera</a> [pdf] Instruction Manual HOLYSTONED1, 2AJ55HOLYSTONED1, D10 Drone with Camera, Drone with Camera</p>
	<p><a href="#">DEERC D10 Drone with Camera</a> [pdf] Instruction Manual HOLYSTONED1, 2AJ55HOLYSTONED1, D10 Drone with Camera, Drone with Camera</p>