



Ddpai Technology Z50 Dash Camera User Manual

[Home](#) » [Ddpai Technology](#) » Ddpai Technology Z50 Dash Camera User Manual 

Ddpai Technology Z50 Dash Camera









Contents

- 1 SPECIFICATIONS
- 2 PACKAGE CONTENTS
- 3 PRODUCT OVERVIEW
- 4 LED INDICATOR INSTRUCTION
- 5 INSTALLATION
- 6 APP INSTRUCTION
 - 6.1 Pair Smart Phone to Dash Cam
 - 6.2 Preview
 - 6.3 Playback
 - 6.4 Download Video Files
- 7 FCC statement
 - 7.1 WEEE Notice
 - 7.2 RoHS Compliance
 - 7.3 For Products That Include Batteries
- 8 CAUTION
- 9 CONTACT
- 10 Documents / Resources
- 11 Related Posts

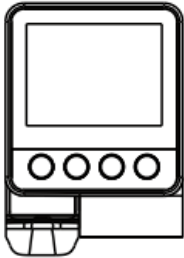
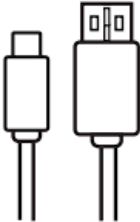
SPECIFICATIONS

- 1 SPECIFICATIONS
- Product Model: 250
- Size: 82*62*31.15mm
- Input: 5V=2A
- Storage: TF card storage, maximum support
- 128GB, cycle recording
- Wi-Fi: Wi-Fi/2.4GHz
- G-Sensor: Built-in 3 Gyro sensor, motion
- Locking, adjustable sensitivity via App

PACKAGE CONTENTS

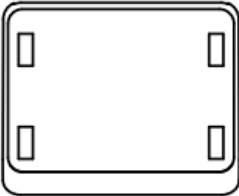
 <p>Dash Cam</p>	 <p>Power Cable</p>	 <p>USB Charger</p>
 <p>Installation Tool</p>	 <p>User Guide</p>	 <p>3M Adhesive</p>
 <p>Static Sticker</p>	 <p>Bracket</p>	

PRODUCT OVERVIEW

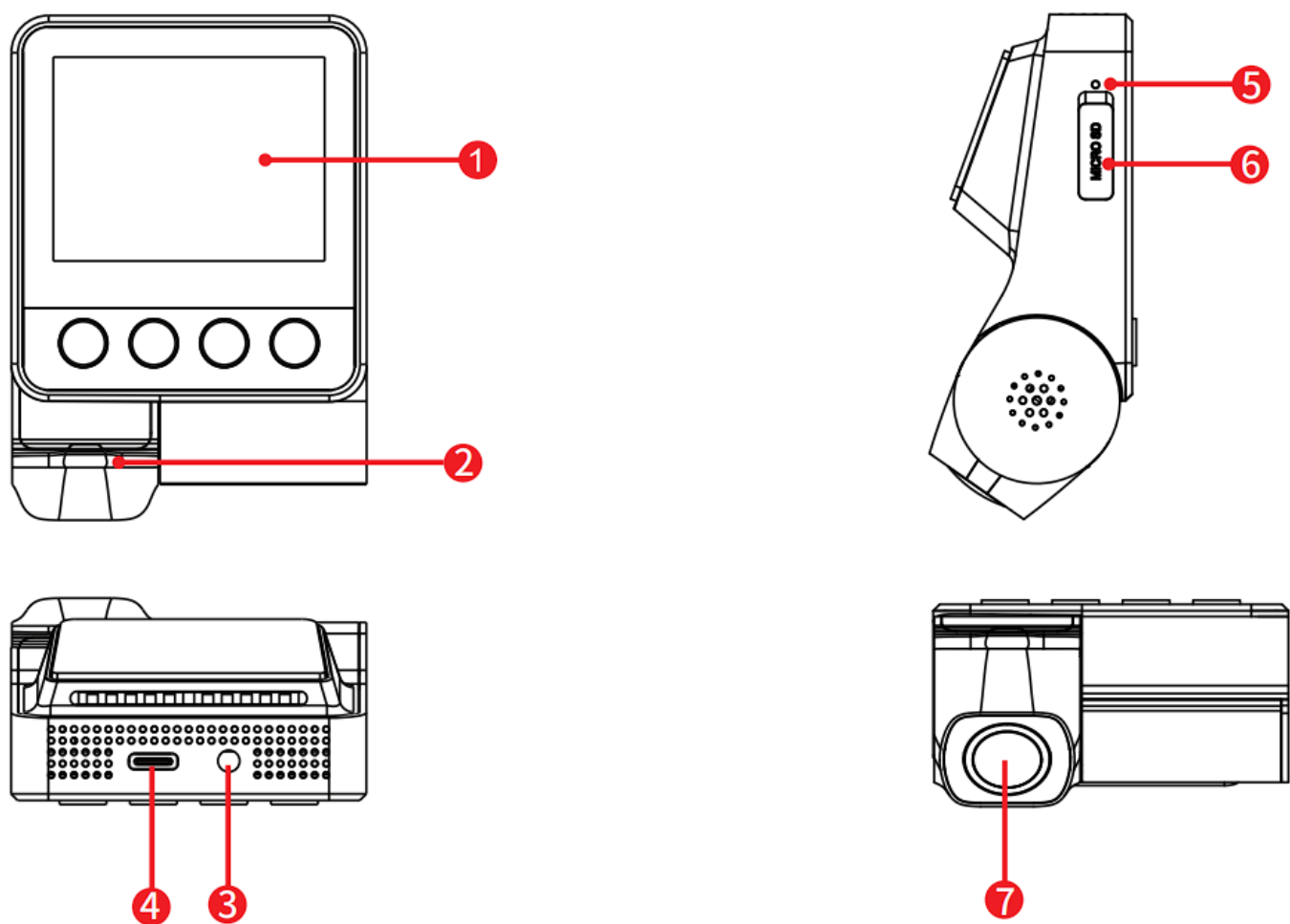

1	Dash Cam Screen
2	Working Indicator
3	AV Interface
4	Type-C Power Interface
5	MIC
6	TF Card Slot
7	Lens

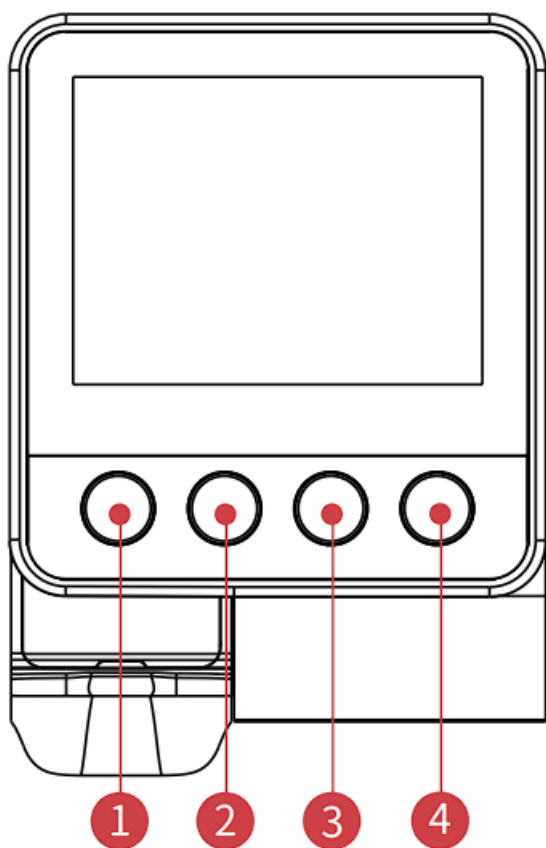

Button Description		Function description
1	Set	Click the button to enter the settings selection.
2	Sound Recording	Click the button to turn on/off recording.
3	Album	Click the button to open the album.
4	Lock	Click the button to turn on/off the screen.
		Reset: Long press 6s to reset.

LED INDICATOR INSTRUCTION

Product status	Indicator status
Working fine	Blue light is always on
Incident video/emergency video/photo video	Purple light flashes quickly
Abnormal status/upgrading	Red light flashes quickly
USB data transmission mode	Green light is always on
Test pattern	White light is always on
Parking monitoring	Red light is always on

INSTALLATION

1. Clean an area on the windshield where you wish the Dash Cam to be installed, this assists in adhesion.
2. Open the protection cover of TF card slot, insert the memory card into the slot, pay attention to the front and back sides, and close the protection cover after completion.

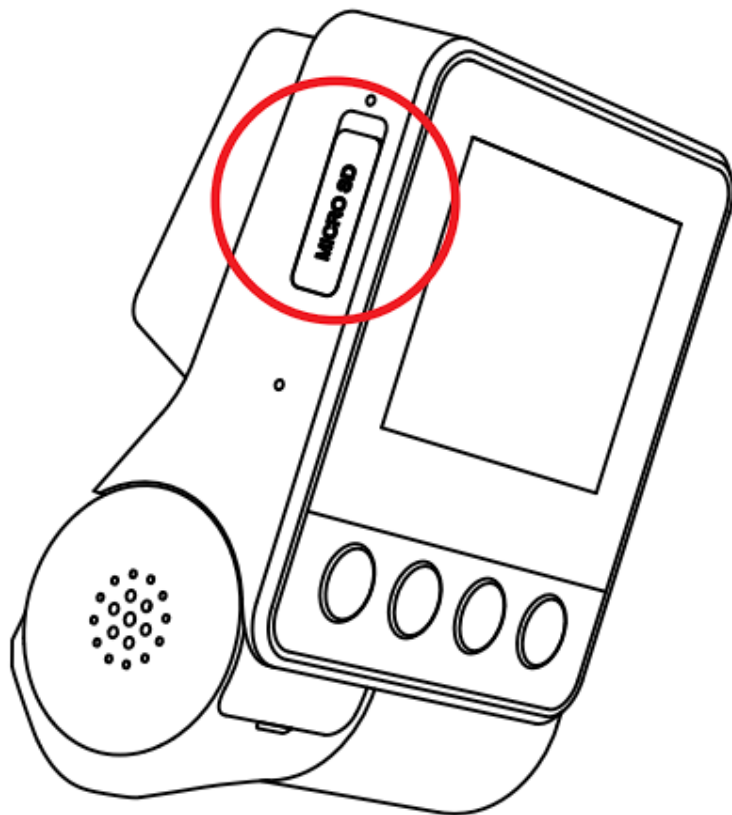

3. Remove the protective film from the back of the bracket, attach the adhesive side of the mount on the windshield where it has an unobstructed view of the road but does not interfere with the driver's view. As shown below.

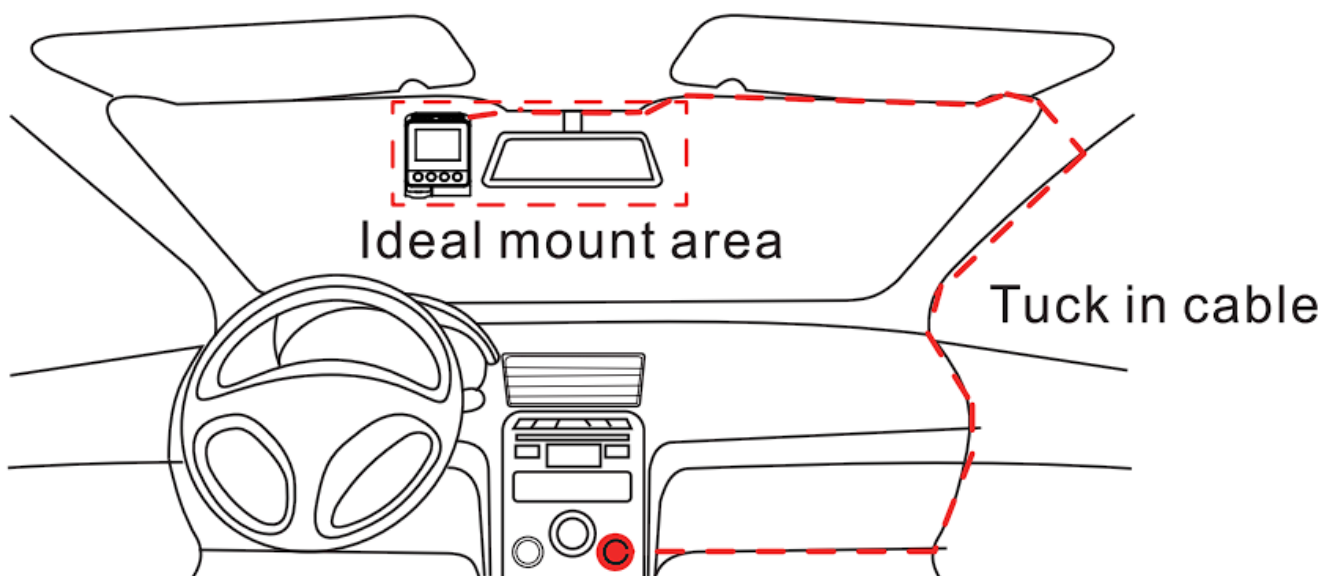

4. Use the installation tool to lift the edges of the windshield/molding and tuck in the power cable. Connect the Dash Cam to the car charger (plugged into cigarette lighter socket) and power cable.

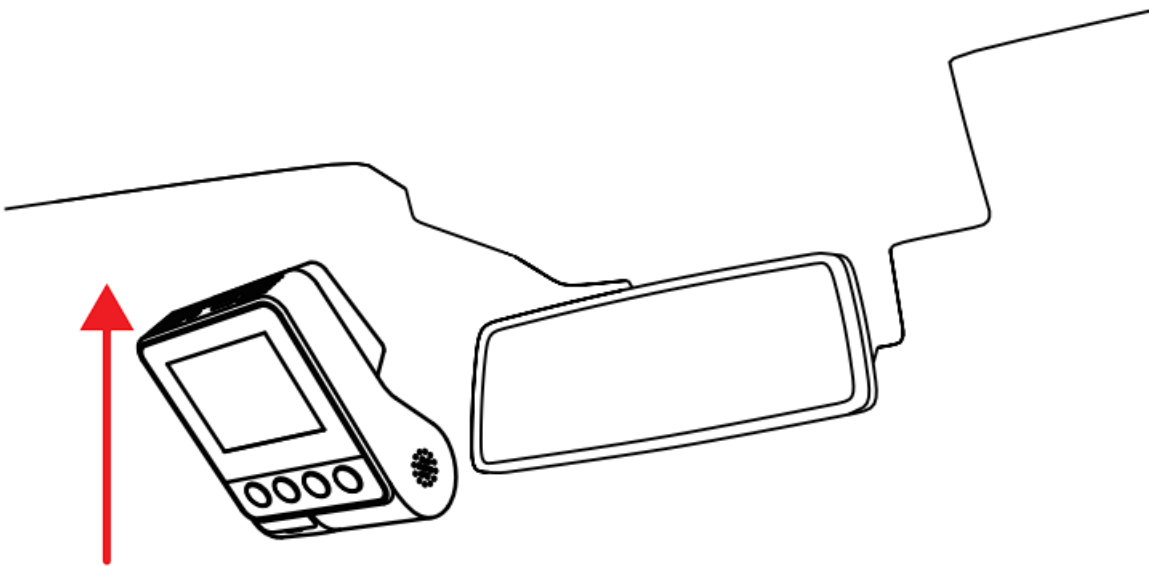

5. After the car starts, the Dash Cam powers up and starts recording.

APP INSTRUCTION

Install DDPAI App

Scan the QR code to download the “DDPAI” App.



iOS



Android

Pair Smart Phone to Dash Cam

1. Keep the Dash Cam and mobile phone within 2.5meters.
2. Launch DDPAI App, tap on “Device> Connect new devices”.
3. Choose your DDPAI Dash Cam from the network list (For Android system, App will start to search Dash Cam network automatically. For iOS phone: turn on WLAN from “Settings ->WLAN”). The Dash Cam’s default SSID (or Wi-Fi name) is DDP-AI_ZSO_XXXX.
4. Enter the password (the default password is ‘1234567890’).
5. Enter DDPAI App, wait a few seconds until the preview screen show.

Preview

1. Open the DDPAI App, and .add your Dash Cam.

2. Select “Device> Entering” tab, this will bring you to the preview page.

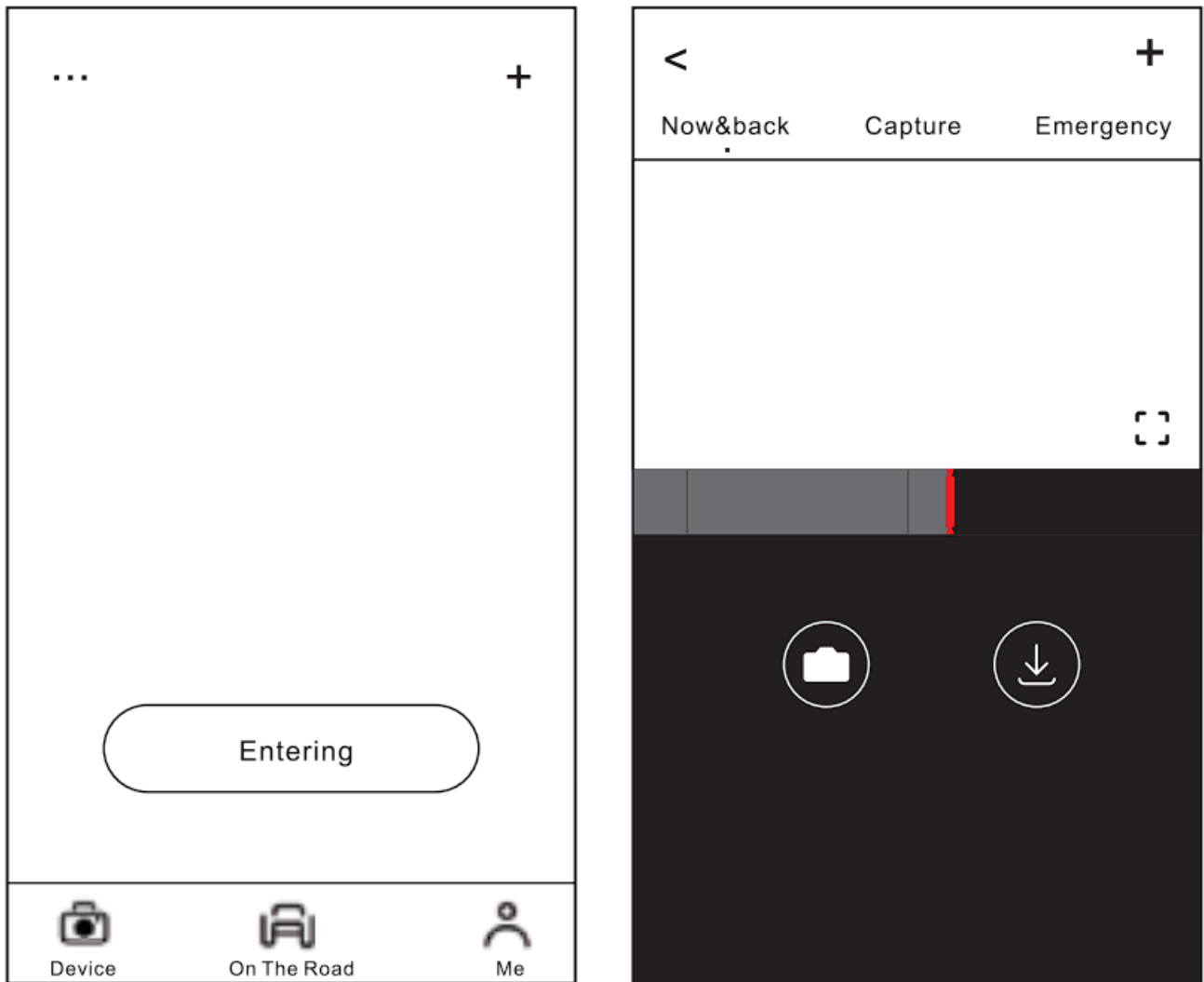

Rotate your smart phone or press expand  icon, turn the preview screen to landscape mode.

Playback

Tap and left/right drag timeline bar at the screen bottom to create the starting point of the recording you wish to preview, then tap on thumbnail when you have made your selection, or wait for 5 sec for buffering, now you can watch the history recording.

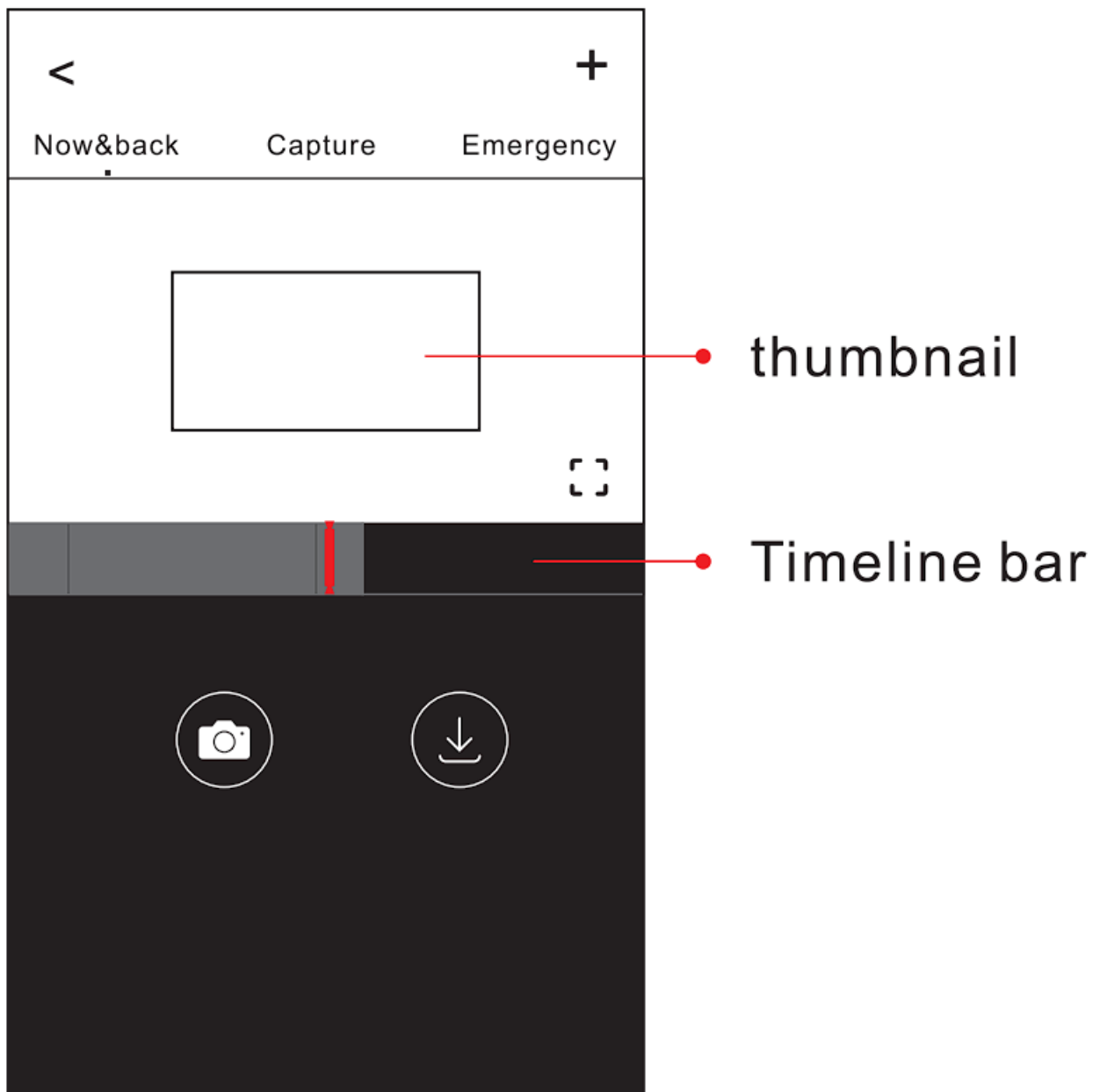

Download Video Files

1. Tap and left/right drag timeline bar at the screen bottom to create the starting point of the recording you wish to download, then tap on thumbnail when you have made your selection, or wait for 5 sec for buffering, to enter the download start screen.
2. Tap on  from preview screen to enter the download interface.

FCC statement

This device complies with Part 15 of the FCC Rules. operation must meet the following two conditions: (1) This device may not cause harmful interference. (2) This device must accept any interference received, including interference that may cause undesired operation.

Warning: Changes or modifications not expressly approved by the party responsible for compliance could void the user's authority to operate the equipment.

Note: This equipment has been tested and found to comply with the limits for a Class B digital device, pursuant to

Part 15 of the FCC Rules. These limits are designed to provide reasonable protection against harmful interference in a residential installation. This equipment generates uses and can radiate radio frequency energy and, if not installed and used in accordance with the instructions, may cause harmful interference to radio communications. However, there is no guarantee that interference will not occur in a particular installation. If this equipment does cause harmful interference to radio or television reception, which can be determined by turning the equipment off and on, the user is encouraged to try to correct the interference by one or more of the following measures:

- Relocate or relocate the receiving antenna.
- Increase the separation between the equipment and receiver.
- Connect the equipment to an outlet on a circuit different from that to which the receiver is connected.
- Consult the dealer or an experienced radio/TV technician for help.

FCC Radiation Exposure Statement:

This equipment complies with FCC radiation exposure limits set forth for an uncontrolled environment. This equipment should be installed and operated with minimum distance 20cm between the radiator & your body.

WEEE Notice

The Directive on Waste Electrical and Electronic Equipment (WEEE) , which entered into force as European law on 14/02/2014, resulted in a major change in the treatment of electrical equipment at end-of-life. The purpose of this Directive is, as a first priority, the prevention of WEEE, and in addition, to promote the reuse, recycling and other forms of recovery of such wastes so as to reduce disposal. The WEEE logo on the product or on its box indicating collection for electrical and electronic equipment consists of the crossed-out wheeled bin, as shown below.



This product must not be disposed of or dumped with your other household waste. You are liable to dispose of all your electronic or electrical waste equipment by relocating over to the specified collection point for recycling of such hazardous waste. Isolated collection and proper recovery of your electronic and electrical waste equipment at the time of disposal will allow us to help conserving natural resources. Moreover, proper recycling of the electronic and electrical waste equipment will ensure safety of human health and environment. For more information about electronic and electrical waste equipment disposal, recovery, and collection points, please contact your local city center, household waste disposal service, shop from where you purchased the equipment, or manufacturer of the equipment.

RoHS Compliance

This product is in compliance with Directive 2011/65/EU of the European Parliament and of the Council of 8 June 2011 on the restriction of the use of certain hazardous substances in electrical and electronic equipment.

For Products That Include Batteries

EU Batteries Directive 2013/56/EU

A new battery directive 2013/56/EU on Battery and Accumulator replacing directive entered into force on the 1/07/2015. The directive applies to all types of batteries and accumulators (AA, AAA, button cells, lead acid, rechargeable packs) including those incorporated into appliances except for military, medical and power tool applications. The directive sets out rules for collection, treatment, recycling and disposal of batteries, and aims to prohibit certain hazardous substances and to improve environmental performance of batteries and all operators in the supply chain.

Instructions for Users on Removal, Recycling and Disposal of Used Batteries

To remove the batteries from your equipment or remote control, reverse the procedure described in the owner's

manual for inserting batteries.

For products with a built-in battery that lasts for the lifetime of the product, removal may not be possible for the user. In this case, recycling or recovery centers handle the dismantling of the product and the removal of the battery. If, for any reason, it becomes necessary to replace such a battery, this procedure must be performed by authorized service centers. In the European Union and other locations, it is illegal to dispose of any battery with household trash. All batteries must be disposed of in an environmentally sound manner. Contact your local waste-management officials for information regarding the environmentally sound collection, recycling and disposal of used batteries.

WARNING: IDanger of explosion if battery is incorrectly replaced. To reduce risk of fire or burns, don't disassemble, crush, puncture, short external contacts, expose to temperature above 60°C (140°F), or dispose of in fire or water. Replace only with specified batteries. The symbol indicating 'separate collection' for all batteries and accumulators shall be the crossed-out wheeled bin shown below:



In case of batteries, accumulators and button cells containing more than 0.0005 % mercury, more than 0.002 % cadmium or more than 0.004 % lead, shall be marked with the chemical symbol for the metal concerned: Hg, Cd or Pb respectively. Please Refer to the below symbol:



Hg



Cd



Pb

CAUTION

- The product's optimal temperature range is -20°C — 70°C.
- Install the device near the rear-view mirror to obtain the best open-field view. Do NOT install the Dash Cam in a location that will obstruct your required driving view.
- **Dash Cam with built-in eMMC card:** Featuring high efficiency, stability and durable. The dash cam should be formatted via App or PC regularly to extend its lifespan.
- **Dash Cam with external memory card:** Support brand Class 10 micro SD card up to 128GB Max. The dash cam should be formatted before using and it can be formatted via App or PC regularly to extend its lifespan.
- Do not use any cardboard, paper towel, or napkins to clean the lens.
- Do not attempt to repair, dismantle, or modify the Dash Camera hardware by yourself.
- Do not install the product in an environment with high humidity, or combustible gases or liquids.
- Drawings for illustration purpose only. Actual product may vary due to product enhancement.

CONTACT



www.ddpai.com



feedback@ddpai.com



DDPAI Technology Co., Ltd



Floor 12, Yihua finance building, Software Park, Yuehai Sub district, Nanshan district, Shenzhen

For more information and FAQs, Please scan the QR code:



Documents / Resources

	Ddpai Technology Z50 Dash Camera [pdf] User Manual Z50, 2AJFX-Z50, 2AJFXZ50, Z50 Dash Camera, Dash Camera
---	--