

DCT FB-A01 Smart Bird Feeder Camera



# DCT FB-A01 Smart Bird Feeder Camera User Manual

[Home](#) » [DCT](#) » DCT FB-A01 Smart Bird Feeder Camera User Manual 

## Contents

- 1 DCT FB-A01 Smart Bird Feeder Camera
- 2 Product Information
- 3 Product Usage Instructions
- 4 Packing List
- 5 Product Appearance
- 6 Bird Feeder Parts Name
- 7 Quick Start
- 8 Set up the camera
- 9 Install Bird Feeder
- 10 Share the camera
- 11 Indicator light status
- 12 Product specification
- 13 Firmware upgrade
- 14 FCC
- 15 FAQ
- 16 Documents / Resources
  - 16.1 References
- 17 Related Posts



**DCT FB-A01 Smart Bird Feeder Camera**



## Product Information

### Specifications

- Model: FB-A01

Power Source: Battery or AC

- Compatibility: Android and iOS
- Wi-Fi: 2.4GHz with strong wall penetration capability
- App Download: [VicoHome App](#)

### Product Usage Instructions

#### Quick Start

**Step 1:** Download and install the VicoHome App on your mobile device.

**Step 2:** Add the device to the app by signing in, connecting to Wi-Fi, and following the setup prompts.

#### Set up the Camera

- **Step 1:** Open the VicoHome App and click on “Add Camera Now”. Enter your Wi-Fi network name and password.
- **Step 2:** Ensure your Wi-Fi network is 2.4GHz with strong wall penetration capability. Generate a QR code for pairing the camera.
- **Step 3:** Turn on the camera, face the lens towards the QR code on the app, and wait for a successful

connection prompt.

### Install Bird Feeder

Assemble the bird feeder parts including the feeder, bird camera, material tray, antenna, bird feeder bracket, fixed strap, and solar panel. Follow the provided instructions for installation.

### Share the Camera

You can share access to the camera with others through the VicoHome App. Follow the in-app instructions to set up sharing permissions.

### Charge the Camera

The camera can be charged using the power cord provided or through the solar panel. Ensure proper charging for uninterrupted operation.

### Frequently Asked Questions (FAQ)

- Q: What should I do if I encounter a Wi-Fi Password Error during camera setup?  
A: Verify that the password entered in the app matches your Wi-Fi network password.
- Q: How can I ensure successful camera pairing?  
A: Make sure your Wi-Fi network is 2.4GHz with strong wall penetration capability and follow the pairing instructions carefully.
- Q: Can I use the camera without connecting it to Wi-Fi?  
A: The camera requires a Wi-Fi connection for live streaming and remote access features.

**Model:** FB-A01

### Packing List

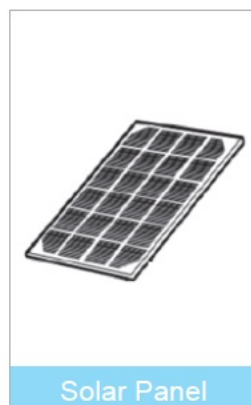
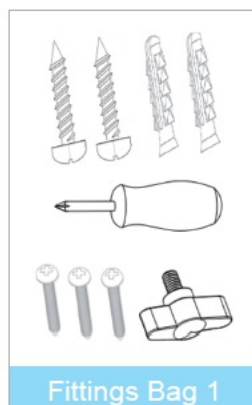
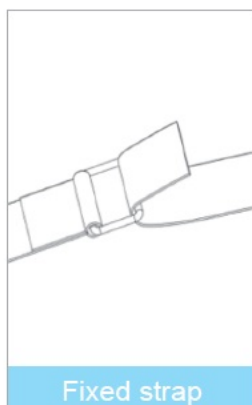
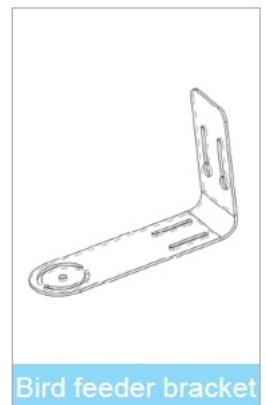
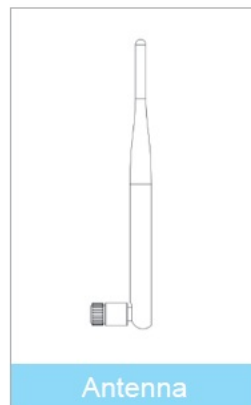
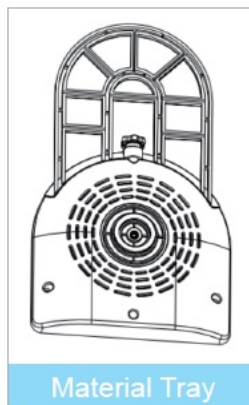
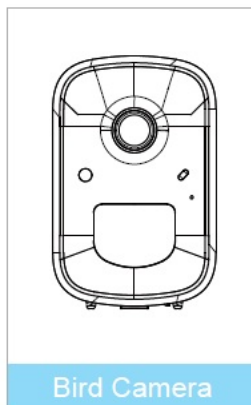
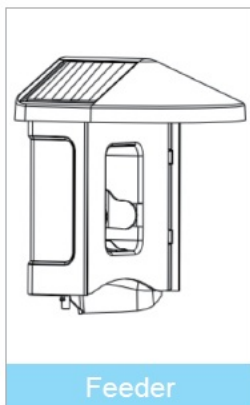

## Product Appearance

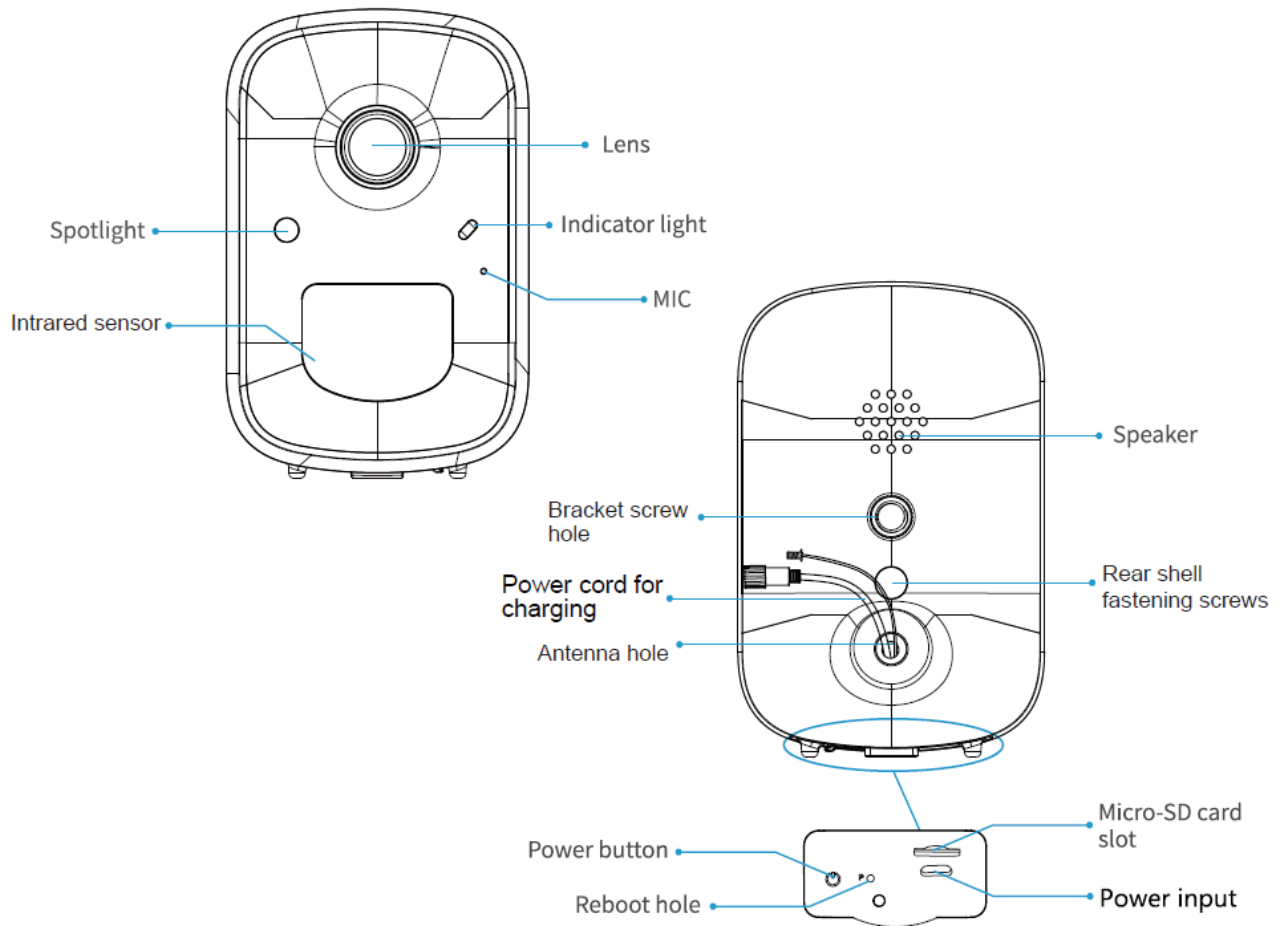

## Bied Feeder Parts Name

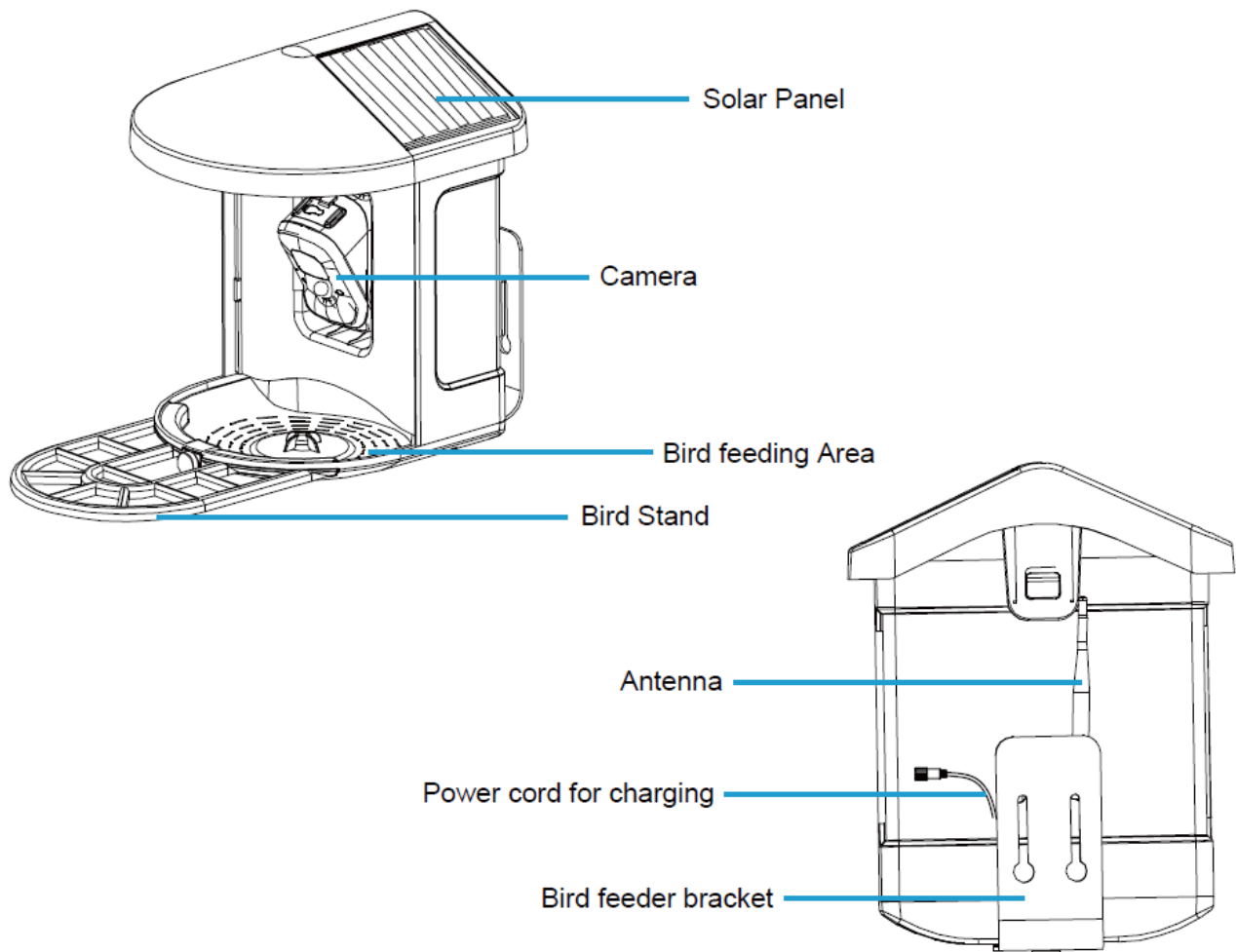

## Quick Start

The wireless smart battery camera can be powered by either batteries or by an AC power source

### Download and install the App

The wireless smart battery camera is compatible with Android as well as iOS applications. To receive optimal results, kindly scan the QR code provided below using your mobile phone, download the application, and follow the given instructions to register as a user.

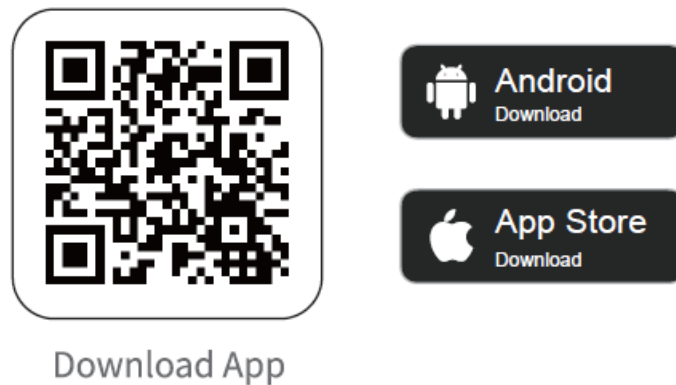

Scan QR code or go to the link to download and install the App: <https://www.vicohome.io/download/>

### Add the device

To set up the device, please sign in to the app, connect to Wi-Fi, and follow the prompts to add the device (make sure to place the device near the router during configuration).

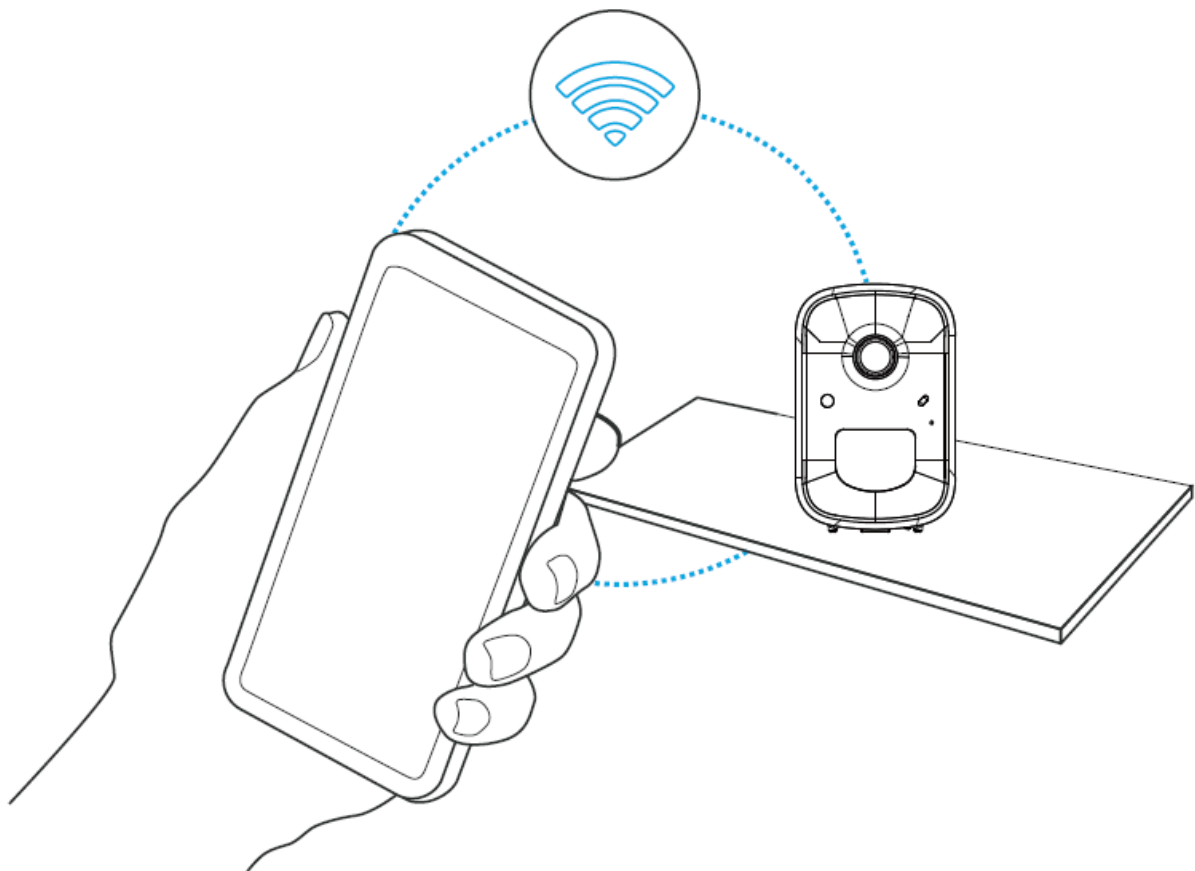

### Set up the camera

To connect the camera, open the App and click on “Add Camera Now”. Then, enter the name and password of the

Wi-Fi network to which you want to connect the camera.

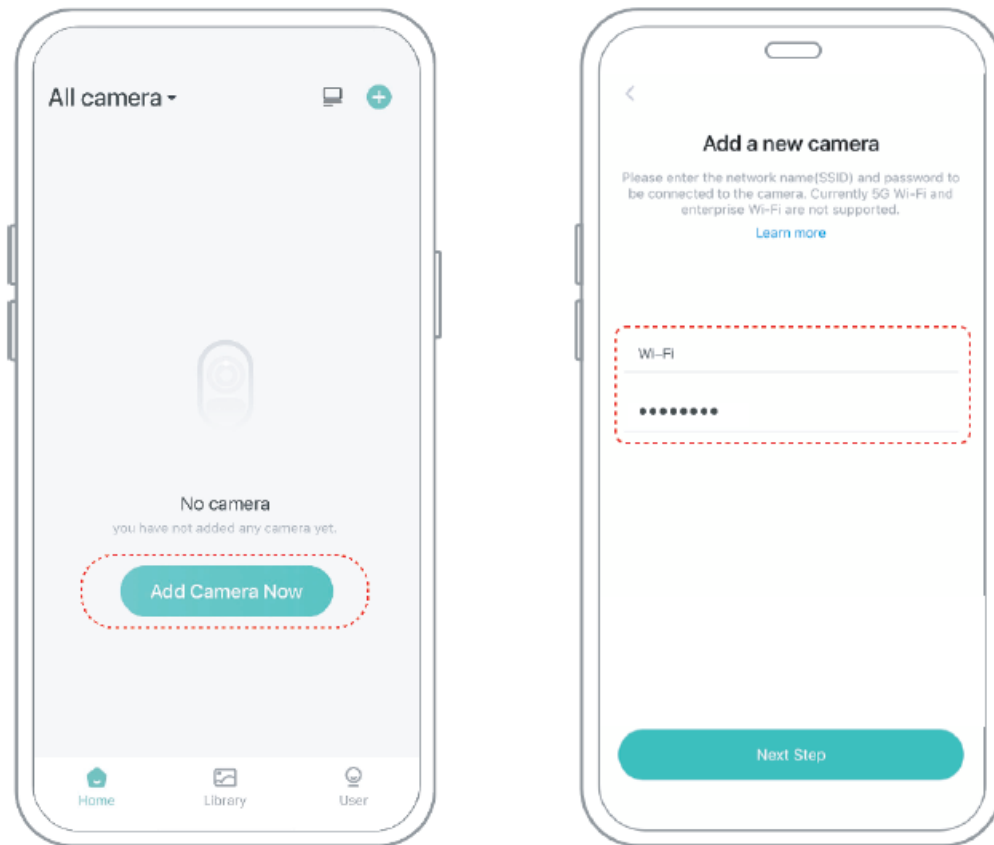

1. In order to maintain a stable connection over a long distance, the camera is designed to work exclusively with 2.4Ghz Wi-Fi networks that have strong wall penetration capability. Currently, it does not support Wi-Fi networks that require enterprise-level authentication. Please make sure that the Wi-Fi network you are trying to connect to meets the requirements. Once done, click on "Continue" to generate the QR code for pairing the camera.



2. After pressing the camera switch for 3 seconds, the camera will turn on. The camera will emit the scanning sound “Ding Dong Ding Dong” after it is turned on (if you do not hear it, please double click the power button).

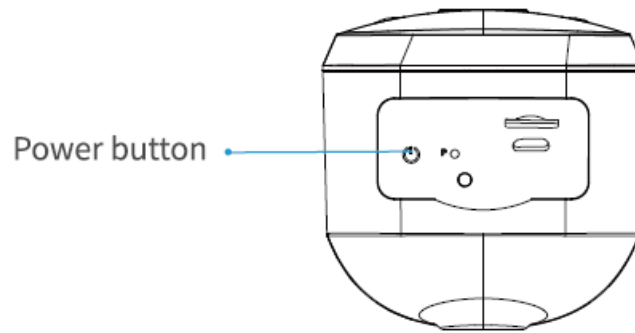

3. Take the lens of the camera facing the QR code generated on VicoHome about 20 cm (7 inches) until you hear a “Ding” sound.

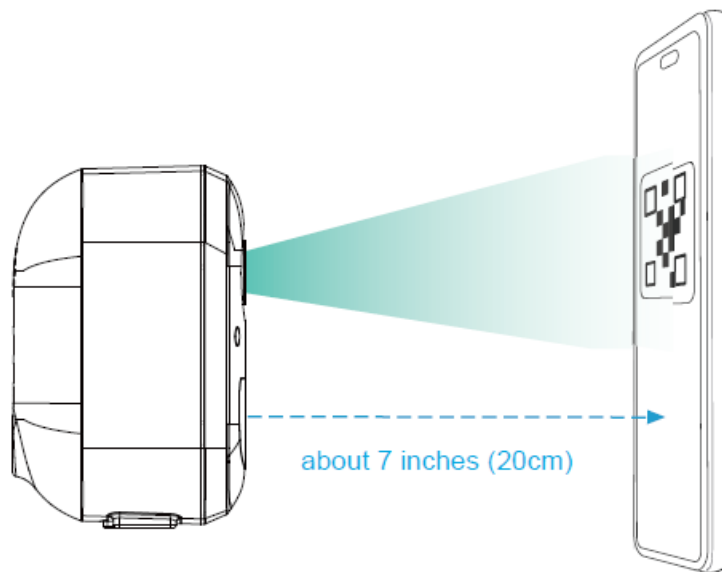

4. After a period of time, a prompt sound indicating a successful connection will be emitted from the camera. At this point, please name the device on the App and select a location for it to be placed. Click “Continue” to finalize the pairing process

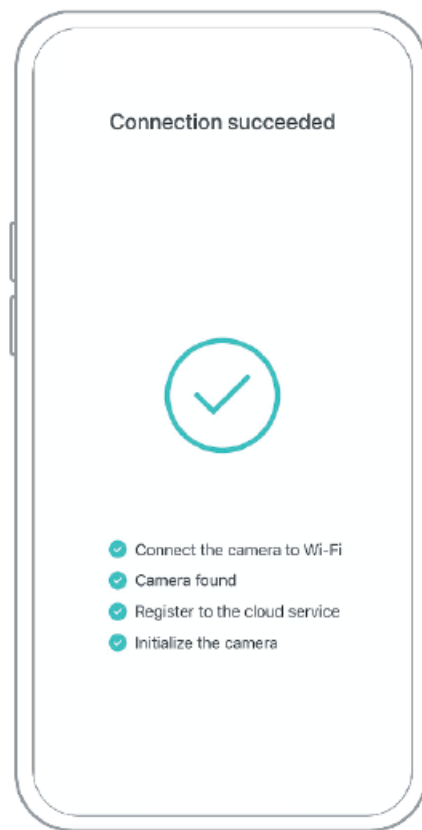

### **Possible problems with binding:**

- If you encounter a “Wi-Fi Password Error”, please verify that the password you entered in the app is correct;
- If you encounter an “Authentication Error”, ensure that your Wi-Fi network is not an enterpriselevel network and that the device only supports networks with security levels below WPA-2; When you hear the “Wi-Fi not found”, please check whether you select or enter the correct Wi-Fi name, and place the device near the Wi-Fi router and ensure that the router is powered on. Please note that 5Ghz Wi-Fi cannot be searched by the device;
- If you hear “Wi-Fi not found”, verify that you have selected or entered the correct Wi-Fi name, and ensure that the device is near the Wi-Fi router and that the router is powered on. Note that the device cannot search for 5Ghz Wi-Fi. If you hear “Retrieving IP Timeout”, it means that there are too many devices connected to your router, and you need to remove some unused connected devices or restart the router to clear the unconnected devices. You may need to contact the router administrator;
- If you hear “Cloud Service Connection Fail”, please verify that your router is properly connected to the external network. If you encounter this error prompt, it is usually due to a network disconnection or the use of a local area network server as your selected router at home. Please ensure that your network connection is stable and try restarting your device as a temporary fix;

### **Install Bird Feeder**

The bird feeder can be installed either on a wall or on a tree.

#### **Select a good spot for your bird feeder:**

Please select an appropriate location to install your bird feeding device. It is ideal to choose a spot that is frequently visited by birds, while also ensuring that the Wi-Fi network coverage is adequate. Adjust the camera angle to cover the maximum possible area of the bird-watching stand



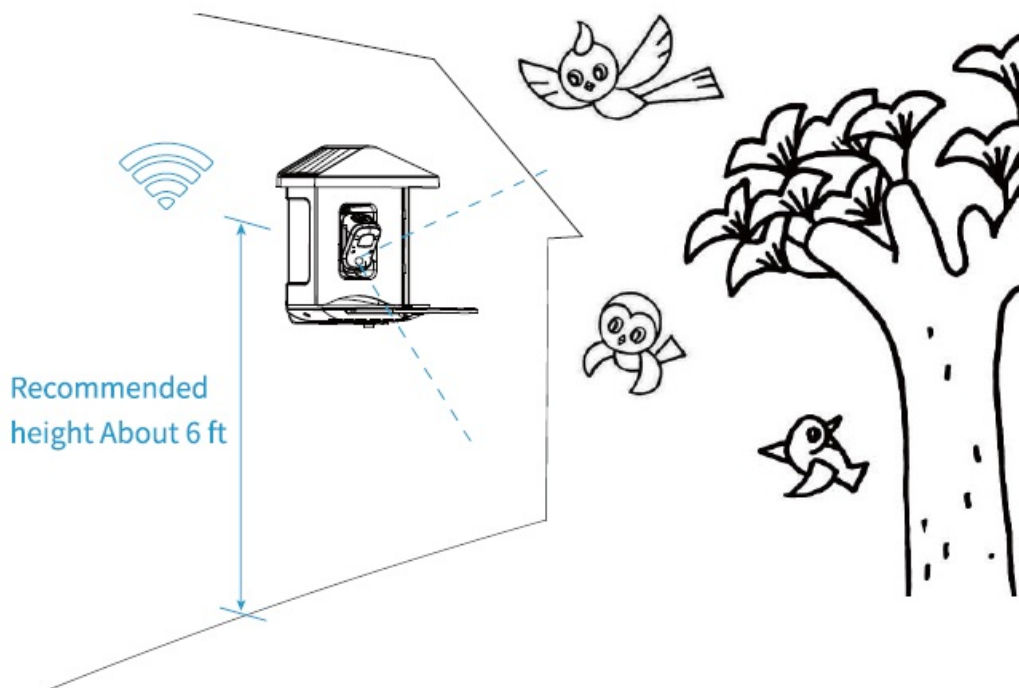

## Install the host

### 1. Assemble the upper cover :

Flip the top cover upside down and attach it to the middle part.

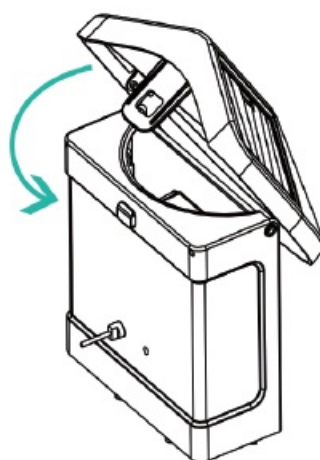

### 2. Install the tray:

Fasten the material tray to the equipment's main body by using a clamp, inserting three screws, and tightening them using a Phillips screwdriver

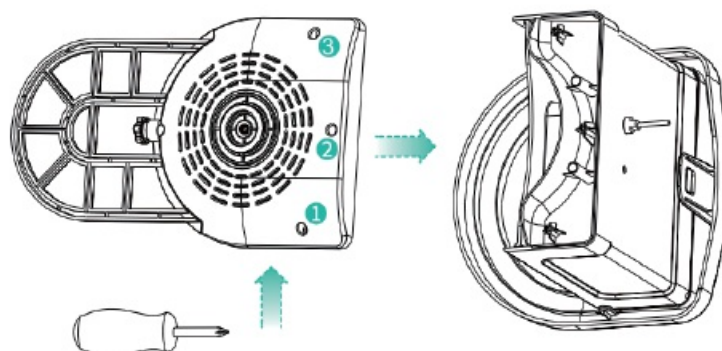

### 3. Install an external antenna

Place the outdoor antenna into the rear antenna orifice of the bird feeder and secure the swiveling antenna

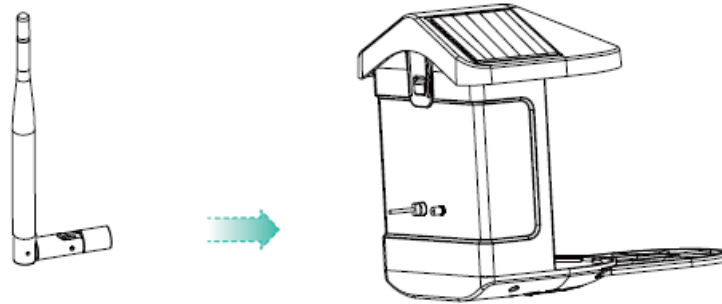

### Install the bracket

#### 1. Screw fixing:

Drill the holes in the wall using a drill tool according to the spacing of the brackets. It's advisable to mark the holes on the wall with a pencil before drilling. Insert the expansion nut into the holes on the wall and then attach the bracket to the expansion nut with screws to complete the installation process



#### 2. Installation of bracket and Bird Feeder:

Fasten the hand screw on the bottom of the bird feeder into the iron bracket using the screw hole provided.

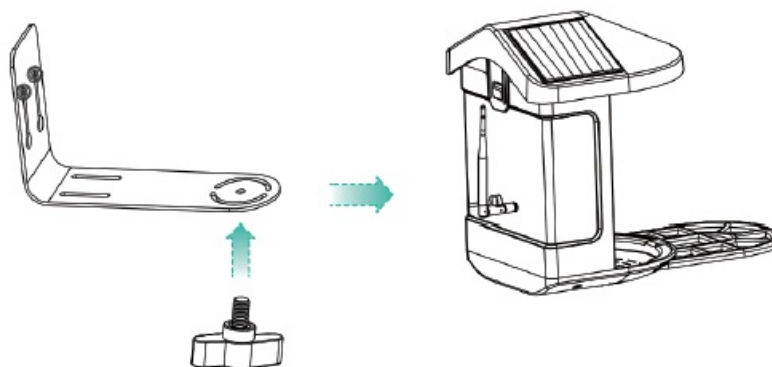

### 3. Install solar panels

1. Attach the bracket to the wall.
2. Mount the solar panel onto the bracket and secure it with a nut.
3. Position the solar panel at an angle that allows for maximum sunlight exposure.

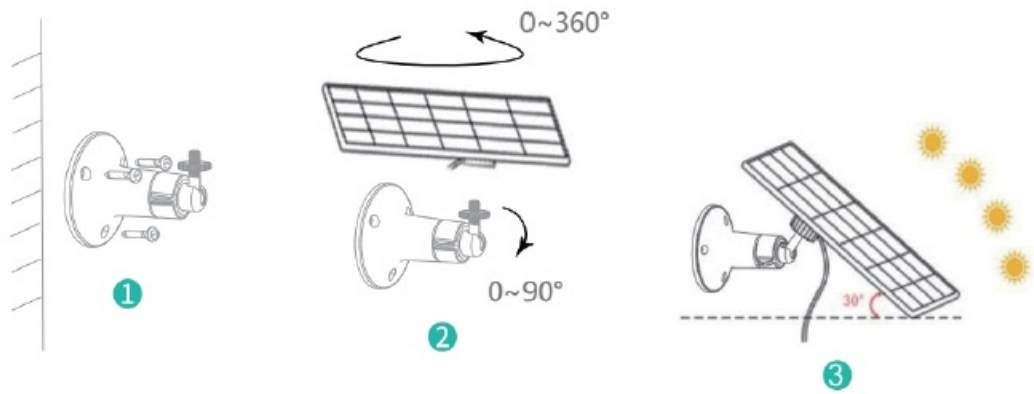

## Share the camera

If you need to access the camera with your friends or family members, there is a function to help you. However, only the administrator who has bound the camera to their account for the first time is allowed to share and set up the device. Other members are only permitted to view the live footage or recorded videos. Here are the steps to follow:

1. Locate the camera you wish to share on the App's homepage or camera settings page. Click on the share button and enter the sharing page.
2. Click on "Invite" to generate a QR code for sharing.
3. For the members you want to share, find "Add Friend's Camera" on the "User" page and enter the scanning page.

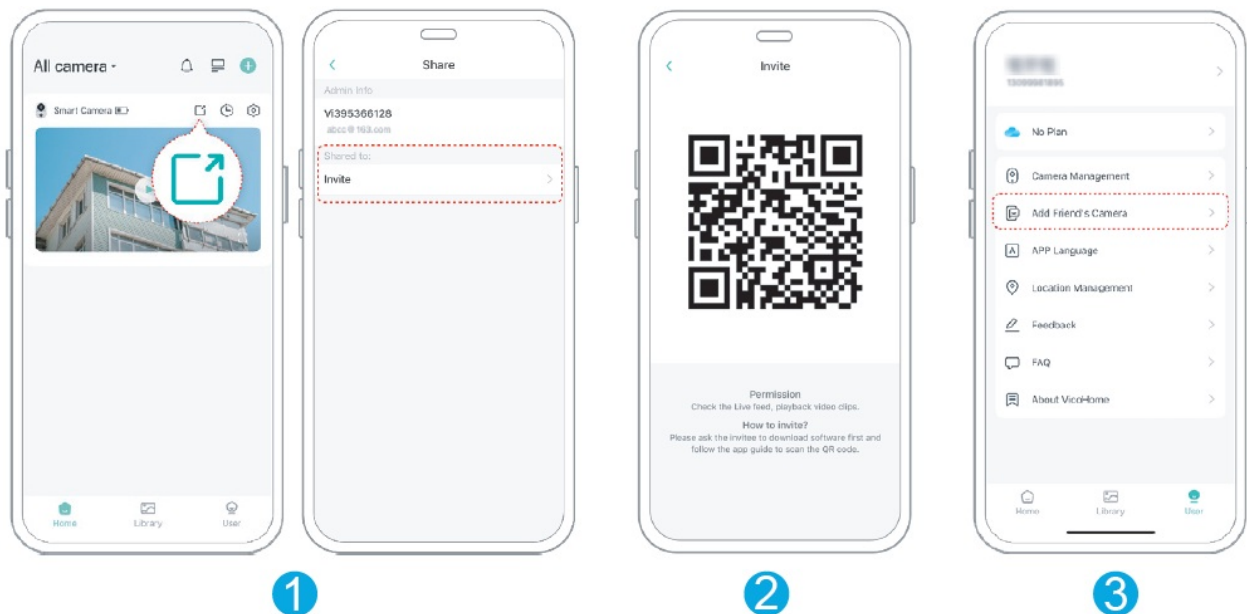

4. After generating the QR code on your mobile phone, scanning it will result in receiving a confirmation notification upon success. The sharing process will be finalized only after you consent to it.

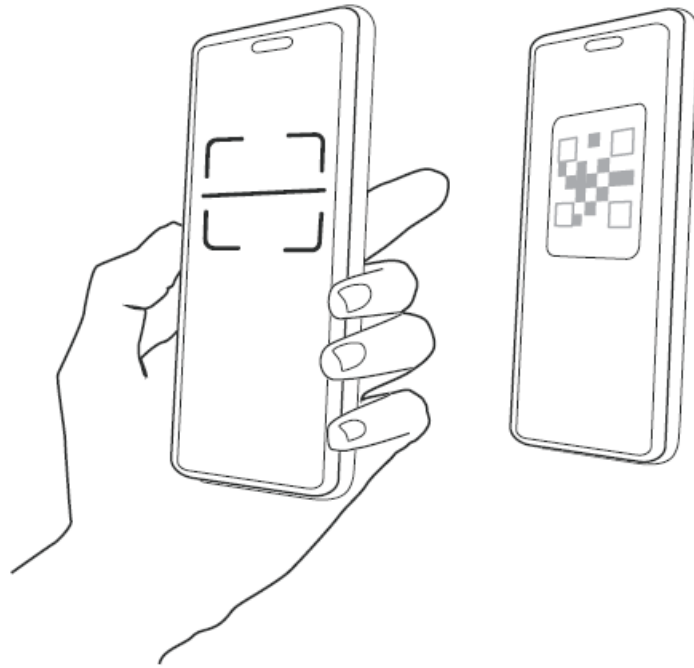

### Charge the camera

When the camera battery is low, the App will send reminders to charge it. To charge the camera, please use the Micro USB cable and plug it into the 5V/1.5A charging adapter. While charging, the camera's indicator light will remain solid yellow, but when the camera is fully charged, the indicator light will turn solid green. It will take approximately 14 hours to fully charge the camera

### Indicator light status

Mode	Status
Working mode	Blue
Sleep mode	Off
Charging mode	Yellow
Fully charged mode	Green

## Product specification

Item	Specification
Camera lens	Field of view: H145°;V85°;D185°
Image resolution	Max. 1920×1080
Video bit rate	Adaptive
Storage media	Cloud Storage, Micro SD Card
Battery capacity	5000mAH
Adapter requirement	DV 5V+-5%/1.5A
Size	220mm*220mm*275mm

## Firmware upgrade

If you connect your camera via the application, you will receive a notification if there is a newer firmware version available. Alternatively, you can check the firmware version manually in the application settings.

Before upgrading the firmware, ensure that your camera is fully charged or connected to the power adapter. Do not cut off the power supply during the upgrading process

## FCC

This equipment adheres to the regulations outlined in Part 15 of the FCC Rules. It is subject to the following two conditions:

1. It should not cause harmful interference.
2. It must accept any interference received, including interference that may cause undesired operation.

Any adjustments or changes not expressly approved by the party responsible for compliance may result in the revocation of the user's authorization to operate this equipment.

**NOTE:** This equipment has undergone testing to comply with the limits for a Class B digital device under Part 15 of the FCC Rules. These limits are designed to provide reasonable protection against harmful interference in a residential installation. This equipment generates, uses and can emit radio frequency energy and, if not installed and used by instructions, may cause harmful interference to radio communications. However, there is no guarantee that interference will not take place in a particular installation. If this equipment does cause harmful interference to radio or television reception, which can be If interference is encountered, the user can try to fix it by turning the equipment off and on and taking one or more of the following steps: reorient or relocate the receiving antenna, increase the distance between the equipment and the receiver, or connect the equipment to a different circuit than the one to which the receiver is connected. If these steps do not resolve the issue, the user should seek assistance from the dealer or an experienced radio/TV technician. To comply with FCC RF Exposure guidelines, this equipment must be installed and used with a minimum distance of 20cm between the radiator and the user's body, and only the supplied antenna should be used.

## FAQ

1. Q: Camera permission management: How to invite family and friends to use my camera together?

A: To share your camera access with friends, first open the app and navigate to the home page. From there, select your camera and click on the share button. This will take you to the sharing page, where you can click on "Invite" to generate a QR code. Your friends can scan the code using their phones to gain access to your camera.

2. Q: Why doesn't the Wi-Fi name appear when I connect to Wi-Fi?

A: For Apple devices running iOS13 or higher, you must enable 'location permission' for the app in system settings and set it to 'allow when using'.

3. Q: Will the camera show red lights when night vision is activated?

A: The built-in infrared lamp beads enable the camera to display dim red lights during night vision, ensuring clear image quality even in the absence of light.

4. Q: What are the requirements for Wi-Fi?

A: Please ensure that you use a 2.4GHz wireless network, as the device does not support 5GHz networks. Furthermore, set the Wi-Fi authentication method to WPA2-PSK or a lower level of security, and provide a password.

5. Q: How far should the camera be placed from the router?

A: In open areas, the Wi-Fi connection distance can reach up to 220 meters, but this may vary depending on the surrounding environment and Wi-Fi strength (thick walls, electromagnetic devices, and large metal objects can interfere with Wi-Fi signals). If the camera connection signal is weak or unstable, move the camera closer to the router.

6. Q: What is the maximum length of recording time?

A: If you set the duration to 'Auto', the camera will start recording a video for up to 3 minutes when someone enters its view.

7. Q: How to quickly view videos by category?

A: To filter videos by category on the "Library" page, click on the icon located in the upper left corner. After selecting the desired category, click on the "Save" button to view the video playbacks.

8. Q: What should I do when the device is malfunctioning?

A: To restart the camera, press and hold the power button for 3 seconds. If there is no response, remove the rubber plug located at the bottom of the camera and press the reboot hole with a pointed object.

## Technical after services

Email: [support@dctcam.com](mailto:support@dctcam.com)

[www.dctcam.com](http://www.dctcam.com)

(Operation guide and FAQ) [support.vicoo.tech/hc/en-us](https://support.vicoo.tech/hc/en-us)

Email: [support@dctcam.com](mailto:support@dctcam.com)

---

## Documents / Resources



## [DCT FB-A01 Smart Bird Feeder Camera](#) [pdf] User Manual

FB-A01 Smart Bird Feeder Camera, FB-A01, Smart Bird Feeder Camera, Bird Feeder Camera, Feeder Camera

## References

- [DCT Camera](#)
- [vicohome.io/download/](https://vicohome.io/download/)
- [User Manual](#)

### [Manuals+](#), [Privacy Policy](#)

This website is an independent publication and is neither affiliated with nor endorsed by any of the trademark owners. The "Bluetooth®" word mark and logos are registered trademarks owned by Bluetooth SIG, Inc. The "Wi-Fi®" word mark and logos are registered trademarks owned by the Wi-Fi Alliance. Any use of these marks on this website does not imply any affiliation with or endorsement.