

DBSOARS F29MAX Portable Bluetooth Speaker



DBSOARS F29MAX Portable Bluetooth Speaker User Manual

[Home](#) » [dbSOARS](#) » DBSOARS F29MAX Portable Bluetooth Speaker User Manual 

Contents

- 1 DBSOARS F29MAX Portable Bluetooth Speaker
- 2 IN THE BOX
- 3 PRODUCT OVERVIEW
- 4 BUTTONS & CONTROLS
- 5 POWER ON/OFF
- 6 BLUETOOTH INDICATOR
- 7 MAKING CONNECTIONS
- 8 CHARGING THE SPEAKER
- 9 TECH SPEC
- 10 WATER RESISTANCE
- 11 LIMITED ONE-YEAR WARRANTY
- 12 TROUBLESHOOTING
- 13 FCC STATEMENT
- 14 Documents / Resources
 - 14.1 References



DBSOARS F29MAX Portable Bluetooth Speaker



IN THE BOX

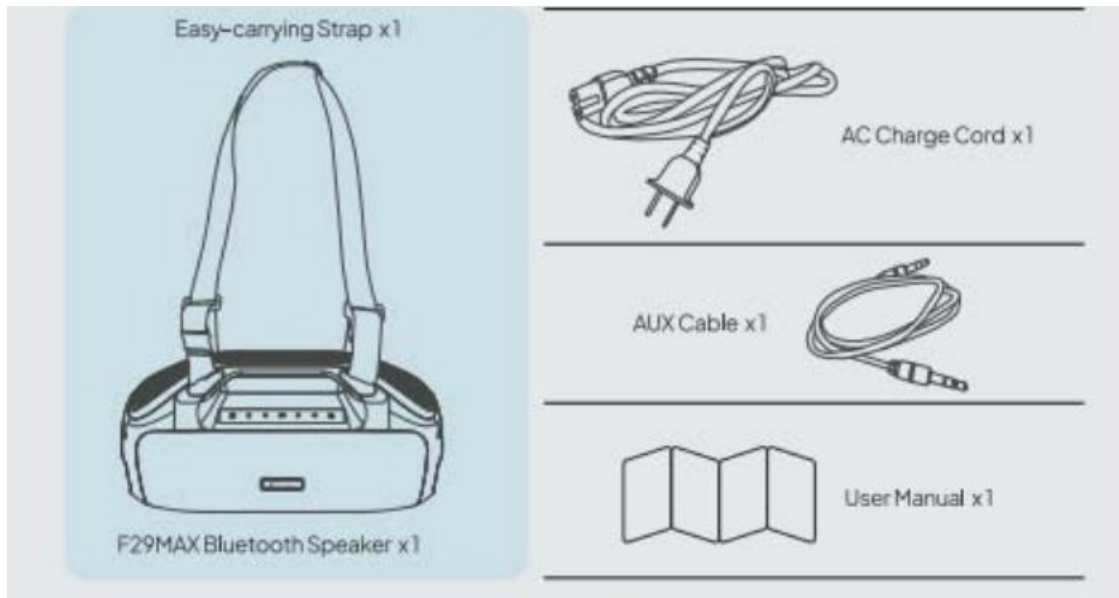



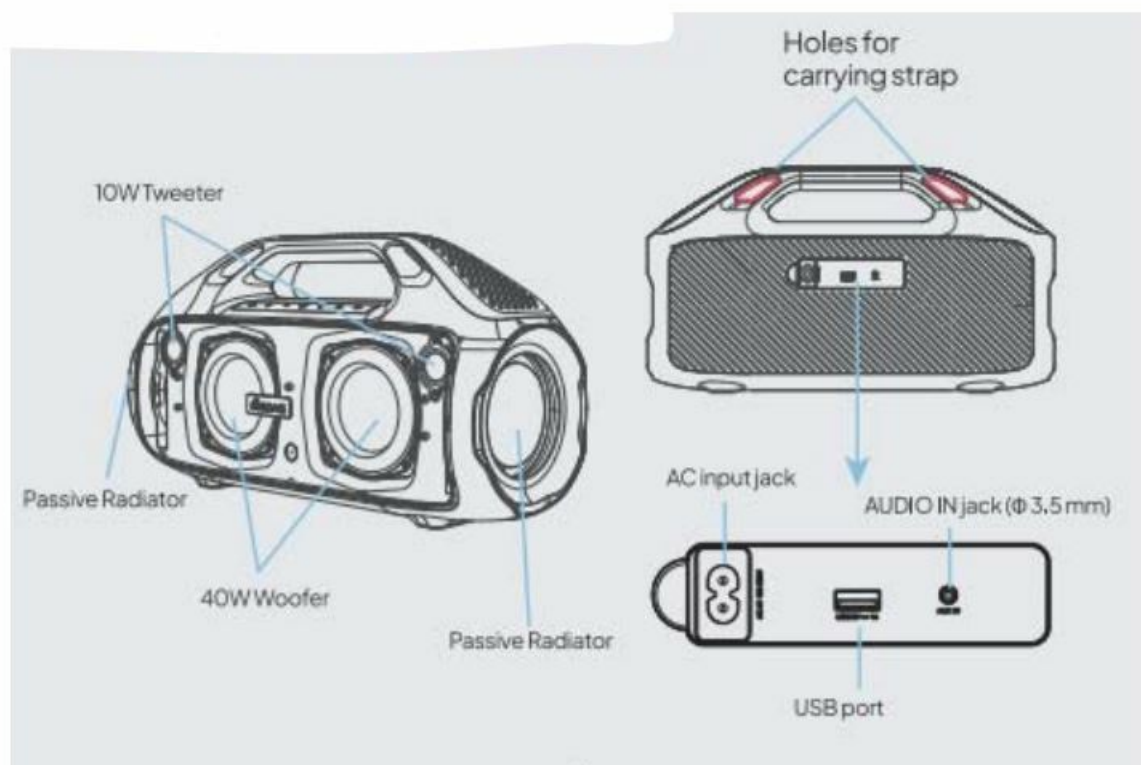

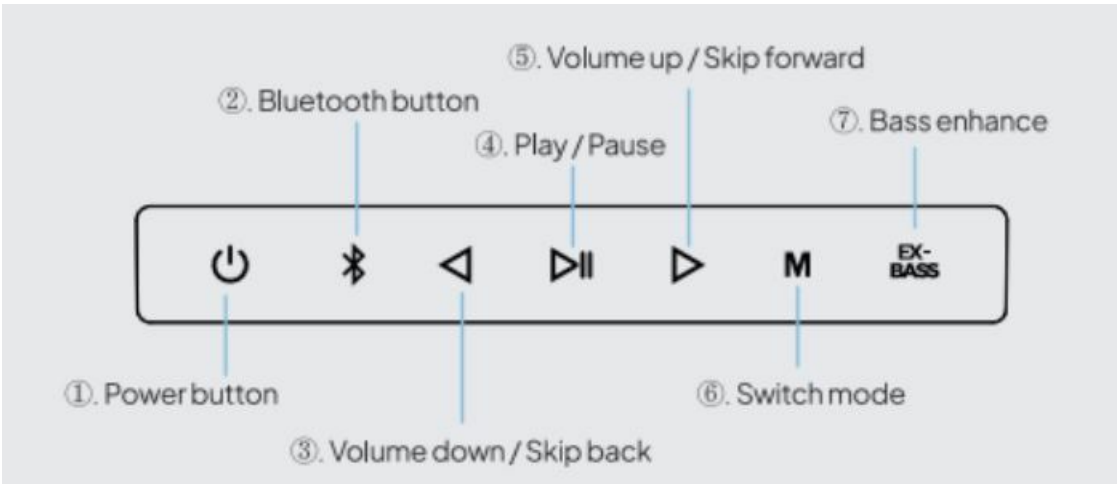

PRODUCT OVERVIEW



BUTTONS & CONTROLS

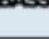

	What to do	Function
	Press and Hold	Power On / Off
	Press and Hold	Disconnect / Reconnect Bluetooth
	Short Press	Decrease the volume
	Press and Hold	Skip back
	Short Press	Play / Pause
	Short Press	Increase the volume
	Press and Hold	Skip forward
	Short Press	Switch modes among Bluetooth / USB / AUX
	Short Press	Turn on/off bass enhancement

POWER ON/OFF

Press and hold the Power button for 3 seconds

All the button indicators glow solid white except for the Bluetooth button,

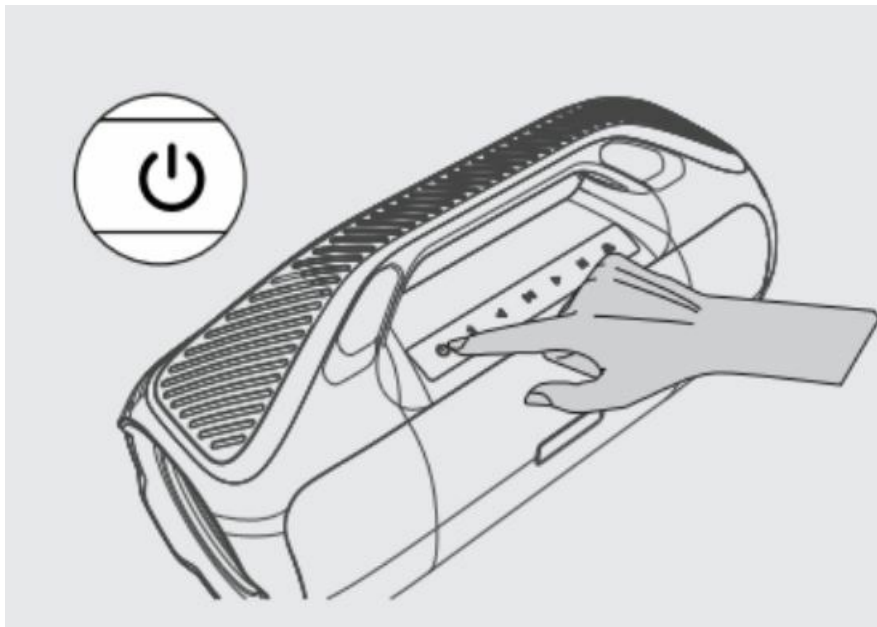

Hint

1. In the event such as the following, press and hold the (power) button for about 8 seconds to restart the speaker,
 - You cannot operate the speaker after you turn it on.
 - You cannot operate the speaker after you troubleshoot pairing issues.
2. When Bluetooth is disconnected for 15 minutes, the speaker will automatically turn off.

BLUETOOTH INDICATOR

BLUETOOTH	Status	Indication
	Slowly blinking blue	Ready to connect
	Solid blue	Connected
	Quickly blinking blue	Enter TWS mode
	Slowly blinking blue	Bluetooth disconnect

MAKING CONNECTIONS

F29MAX Bluetooth speakers support a variety of connection methods including Bluetooth, USB, AUX, TWS (True Wireless Stereo), there is always a way for you to easily reach your favorite playlist.

Connect using the Bluetooth menu on your mobile device

1. With your speaker powered on, the Bluetooth indicator blinks blue.
2. On your device, enable the Bluetooth feature.
3. Select D8 F29MAX from the device list.

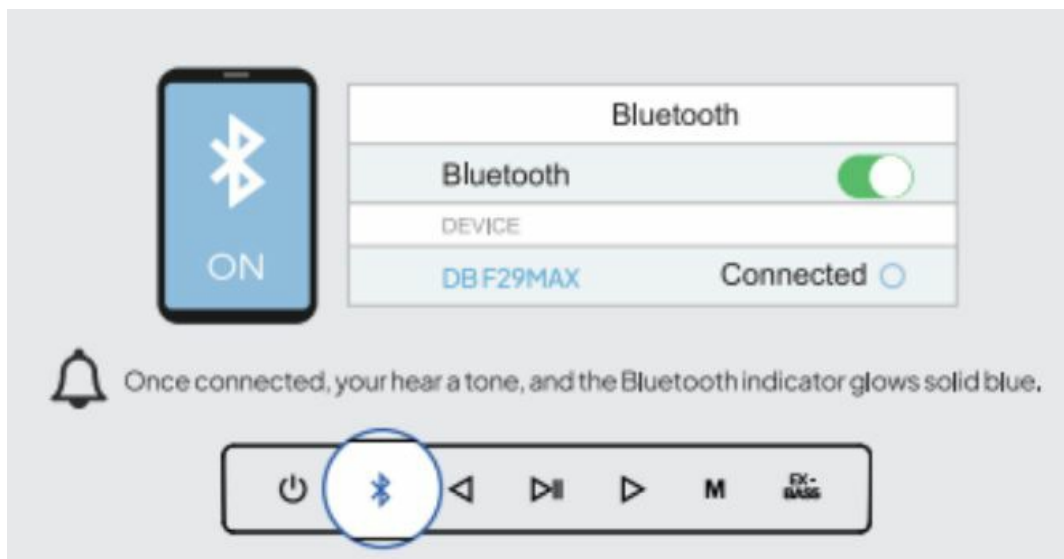

Share audio between another F29MAX (True Wireless Stereo)

To use the Stereo Pair function, 2 F29MAX speakers are required. By connecting 2 speakers via a BLUETOOTH connection, you can enjoy more powerful sound. 2 speakers connected via BLUETOOTH connections play sounds in stereo, where 1 speaker plays the sound on the right channel (right side) and the other plays the sound on the left channel (left side).

1. Configure your speakers for TWS mode by pressing and holding ◀ and ▶ simultaneously.
2. On one speaker press and hold ◀ and ▶ → simultaneously...
3. Release the buttons when you hear a tone."

You hear "Left" from the left speaker and "Right" from the right speaker. Stereo mode is enabled, and you are now able to play audio in stereo using your mobile device.

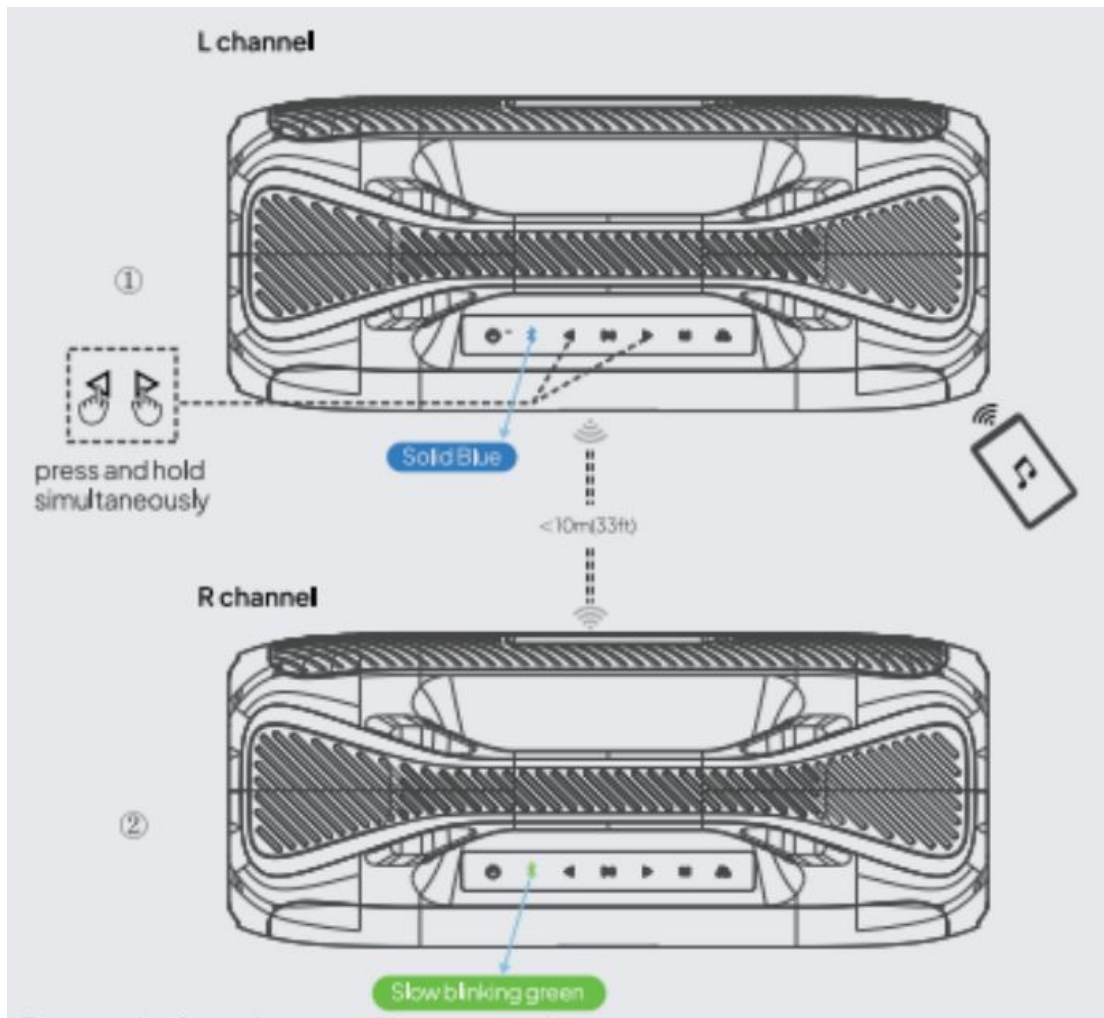

For an optimal experience, position your speakers:

- In the same room or outdoor area
- Within 10 feet of each other, free from obstructions
- So that your distance to each speaker is equal

Note: Performance may vary based on device, distance and environmental factors.

Connect using the USB Port

The speaker supports the following audio file formats.

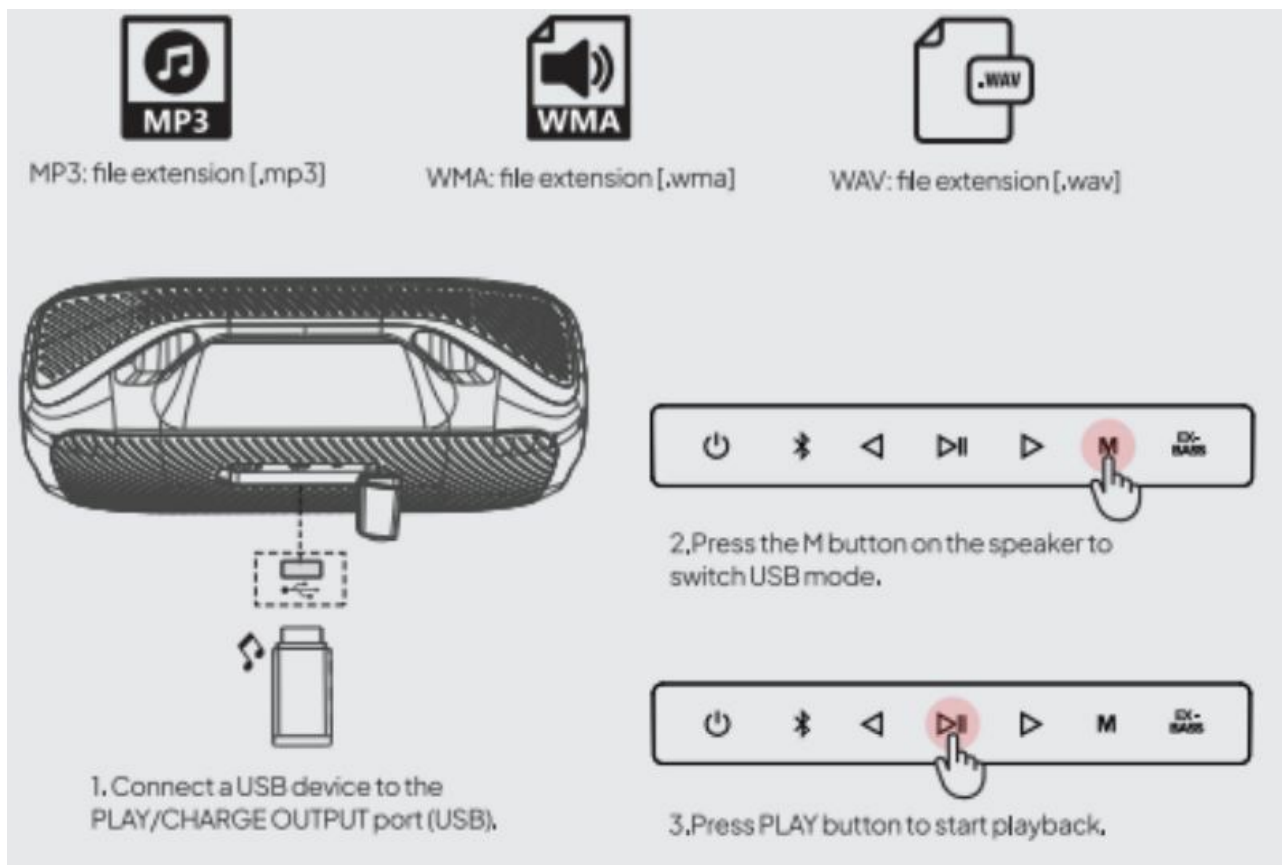

Connect using the AUX Jack

You can use the speaker by connecting a portable audio device, etc., to the speaker using an audio cable (commercially available),

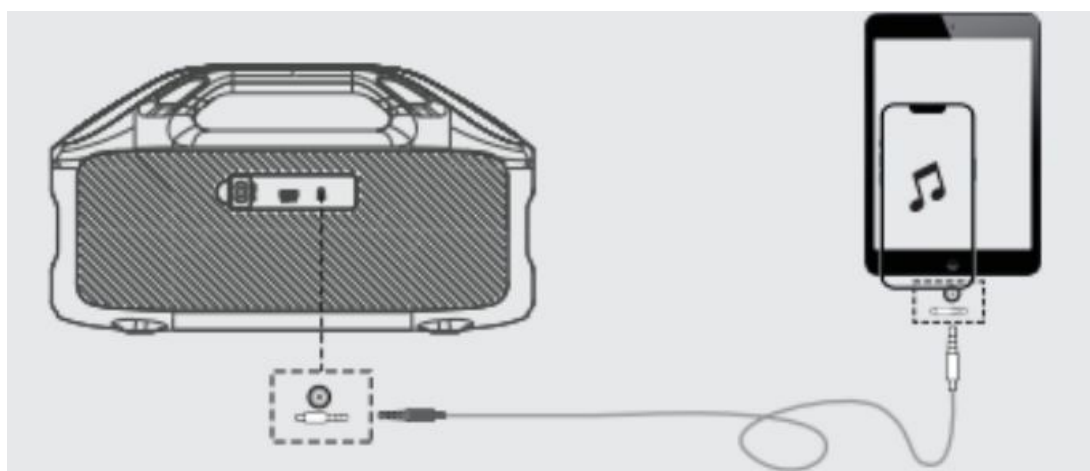

CHARGING THE SPEAKER

Connect the AC input jack on the speaker and an AC outlet with the supplied AC power cord (mains lead), While charging, the Power button indicator states solid red; when the battery is fully charged, the indicator goes out.

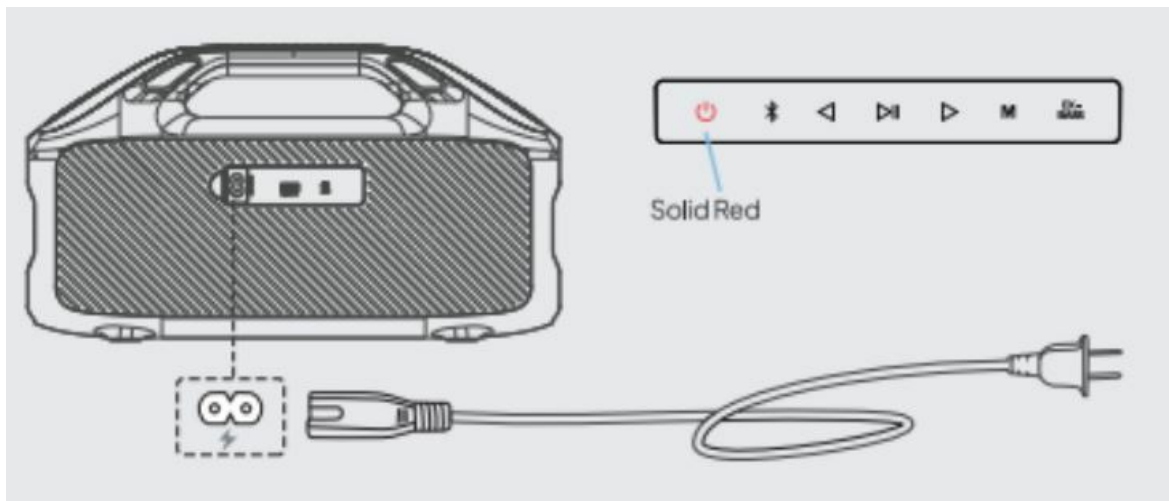

CAUTION: Always keep the charging port dry before connecting AC power.

Charging time

Allow up to five hours to fully charge the battery. A full charge powers the speaker for up to twenty hours. After you disconnect the AC power cord (mains lead) from the speaker upon completion of battery charging, be sure to close the cap securely. The cap plays a very important role in maintenance of the water resistant performance.

Battery protection mode

When your speaker battery is depleted (0%), or your speaker is unplugged and unused for more than three days (with a remaining charge of less than 10%), it enters battery protection mode. To reactivate your speaker, connect it to a wall charger. When not in use, store your speaker in a cool place.

CAUTION: Do not store your speaker for extended periods when fully charged or with a remaining charge of less than 10 per cent.

CHARGING YOUR DEVICES VIA USB PORT

You can charge a USB device, such as a smartphone or iPhone, by connecting it to the speaker via USB. Even if the speaker is not connected to an AC outlet, its built-in battery can supply power to a USB device.

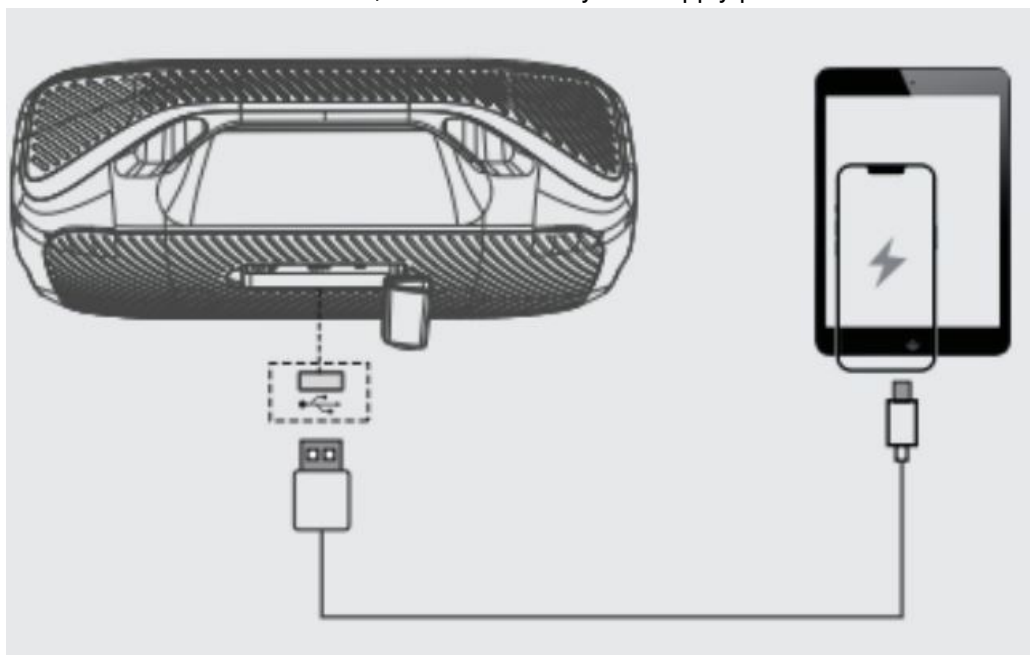

TECH SPEC

Power input: 100 – 250 V ~ 50/60 Hz	Transducer: woofer x2, tweeter x2
Total output power: 100 W RMS	Frequency response: 150 Hz – 20 kHz
Signal-to-noise ratio: > 80 dB	Battery type: Li-ion polymer 66.6Wh (equivalent to 11.1V / 6000 mAh)
Music play time: up to 20 hours (dependent on volume level and audio content)	
USB rating: 5 V / 1 A (maximum)	
Bluetooth® version: 5.3	
Bluetooth® transmitter power: ≤ 10 dBm (ERP)	
Bluetooth® profile: A2DP 1.3, AVRCP 1.6	
Dimensions (W x H x D): 403.6 x 166.3 x 223.3 mm / 15.88 x 6.55 x 8.79 inch	Weight: 5 kg / 11 lbs

WATER RESISTANCE

F29MAX speaker is waterproof, It is rated IPX7. You can immerse the speaker in water for up to 30 minutes at a depth of 3.2 ft. (1 m). It can also be used while showering and in the rain or snow.

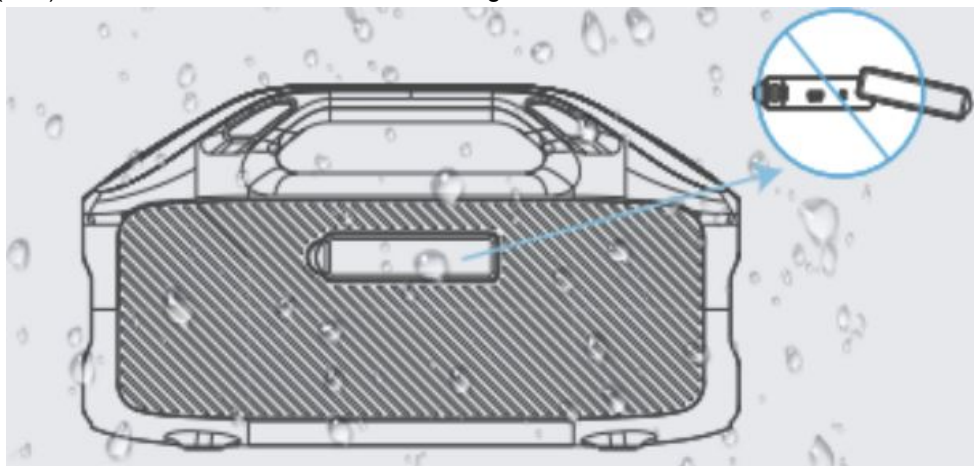

CAUTION: DO NOT submerge this speaker in any pool of water deeper than 3.2 ft. (1 m).

LIMITED ONE-YEAR WARRANTY

1. Our products are covered by a 12-month limited warranty, starting from the date of purchase. This warranty is not transferable and applies only to the original consumer purchaser.
2. For quality-related issues, we will, at its sole option, repair or replace any products that malfunction due to defective parts or workmanship at no charge to you.

Not Covered Under Warranty:

- Damage from outside sources
- Damage from misuse of products (including, but not limited to: falls, extreme temperatures, **water, operating devices improperly, incorrect connections, incorrect battery use**)
- Damage caused by accident, improper care, negligence, excessive wear and tear, or improper installation or assembly contrary to any written installation instruction

- Items that have expired their warranty period
- Non-quality-related issues (after 30 days of purchase)
- Repairs through 3rd parties

TROUBLESHOOTING

Common solutions

If you experience problems with your speaker:

- Power on the speaker.
- Check the state of the status indicators.
- Make sure your mobile device supports Bluetooth technology.
- Charge the battery.
- Increase the volume on your speaker, device and music app.
- Move your device closer to the speaker and away from any interference or obstruction.
- Try connecting another device.

If you could not resolve your issue, see the table below to identify symptoms and solutions to common problems,
If you are unable to resolve your issue, contact DBsoars customer service.

Symptom	Solution
No power (battery)	Battery may be in protection mode or discharged, Connect your speaker to an AC outlet.
Speaker does not connect with mobile device	On your device: – Disable and then enable the Bluetooth feature, – Delete your speaker from the Bluetooth list on your device, Connect again, • Connect a different device, • Clear the speaker pairing list, Connect again,
No sound	• Make sure voice prompts are on, • Use a different music source, • Connect a different mobile device, • If two devices are connected, pause audio on the first device and play audio on the other device, • If two devices are connected, move the devices within range of the speaker (30 ft. or 9 m),
Poor sound quality	• Use a different music source, • Connect a different device, • Disable any audio enhancement features on the device or music app,
Speaker does not charge	• Make sure the connector on the cable is correctly aligned with the connector on the speaker, • Try another charging source, • If your speaker has been exposed to high or low temperatures, let it return to room temperature and then try charging again, • Reset your speaker,

FCC STATEMENT

This device complies with Part 15 of the FCC Rules, Operation is subject to the following two conditions:

1. This device may not cause harmful interference.
2. This device must accept any interference received, including interference that may cause undesired operation.

Changes or modifications not expressly approved by the party responsible for compliance could void the user's authority to operate the equipment.

Note:

These limits are designed to provide reasonable protection against harmful interference in a residential installation. This equipment generates, uses, and can radiate radio frequency energy and, if not installed and used in accordance with the instructions, may cause harmful interference to radio communications. However, there is no guarantee that interference will not occur in a particular installation. If this equipment does cause harmful interference to radio or television reception, which can be determined by turning the equipment off and on, the user is encouraged to try to correct the interference by one or more of the following measures

- Reorient or relocate the receiving antenna.

- Increase the separation between the equipment and receiver,
- Connect the equipment to an outlet on a circuit different from that to which the receiver is connected.
- Consult the dealer or an experienced radio/TV technician for help.

This equipment should be installed and operated with a minimum distance of 20 cm between the radiator and your body

Documents / Resources

	<p>DBSOARS F29MAX Portable Bluetooth Speaker [pdf] User Manual F29MAX Portable Bluetooth Speaker, F29MAX, Portable Bluetooth Speaker, Bluetooth Speaker, Speaker</p>
---	--

References

- [User Manual](#)