

## DAYTECH DS16 Wireless Door/Window Sensor Instruction Manual

[Home](#) » [DAYTECH](#) » DAYTECH DS16 Wireless Door/Window Sensor Instruction Manual 

DAYTECH DS16 Wireless Door/Window Sensor

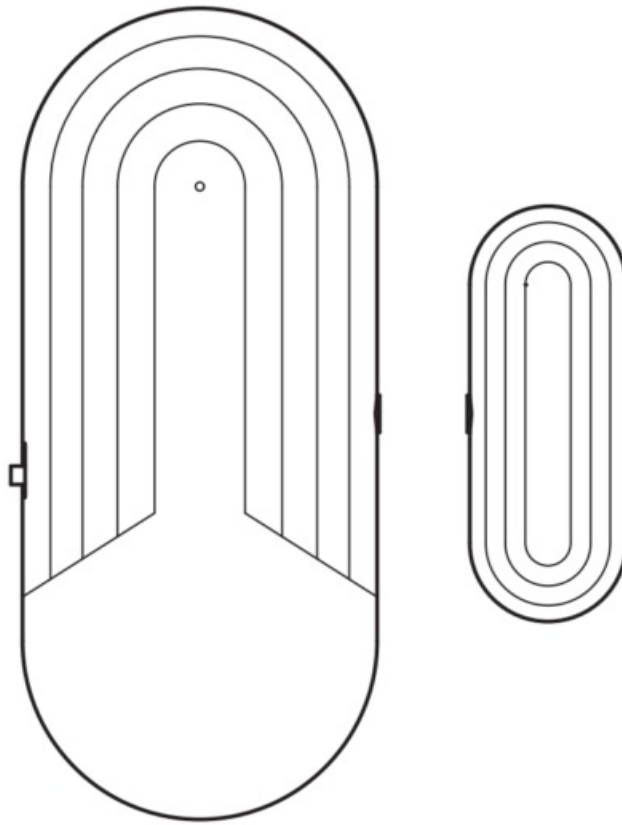

## Contents

- [1 Product diagram](#)
- [2 Technology Parameters](#)
- [3 How to pair with a receiver](#)
- [4 Installation](#)
- [5 Battery Replacement](#)
- [6 FCC Statement](#)
- [7 FCC Radiation Exposure Statement:](#)
- [8 ISED RSS Warning/ISED RF Exposure Statement](#)
- [9 ISED RF exposure statement:](#)
- [10 Documents / Resources](#)
  - [10.1 References](#)
- [11 Related Posts](#)

## Product diagram

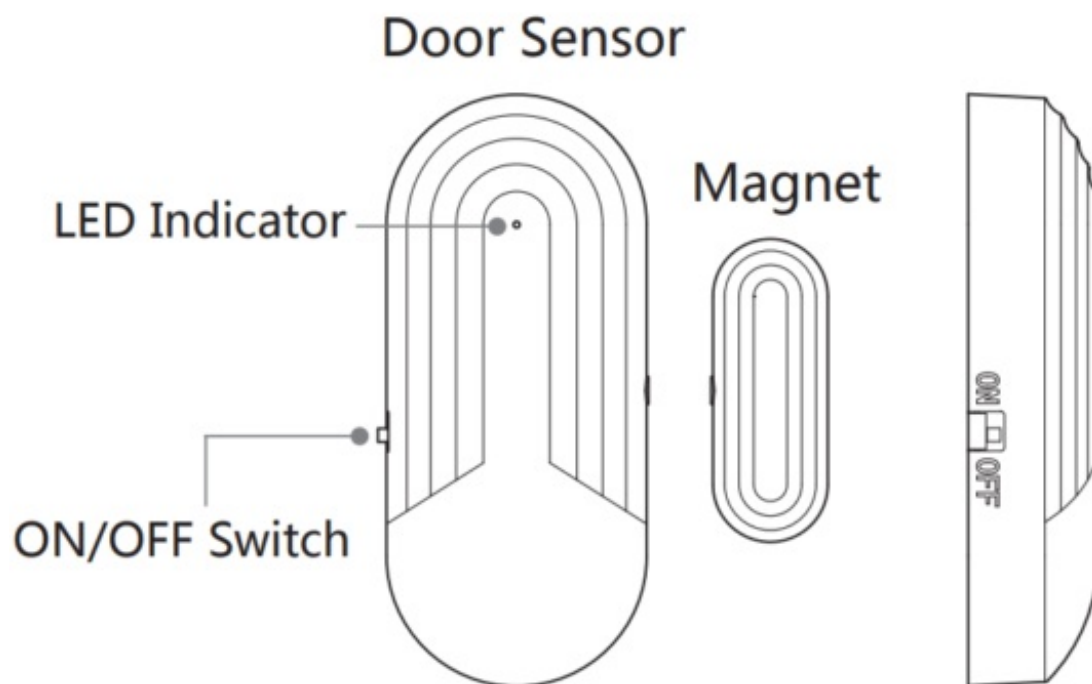

- ON/OFF Switch :  
Turn on or off the door/window sensor.  
Indicator flashes red when battery voltage is low.
- Low power design :
- Low power reminder :  
More than one year of service life.

### Technology Parameters

Operating voltage	1*CR2032 battery
Quiescent Current	10uA
Working Current	15mA
Transmission Distance	100m (open space)
Transmission Frequency	433.949MH

### How to pair with a receiver

1. Please read the receiver's operating instructions before pairing.

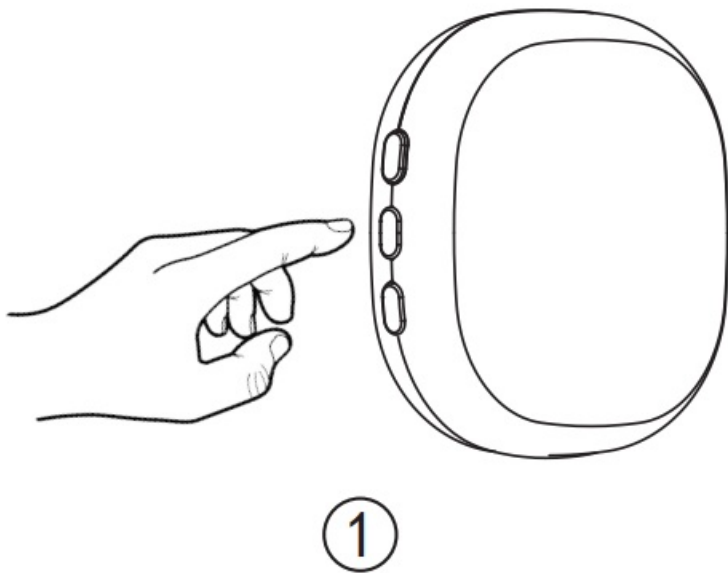

2. When the receiver enters the pairing state, it separates the door magnet host A from the magnetic strip B.

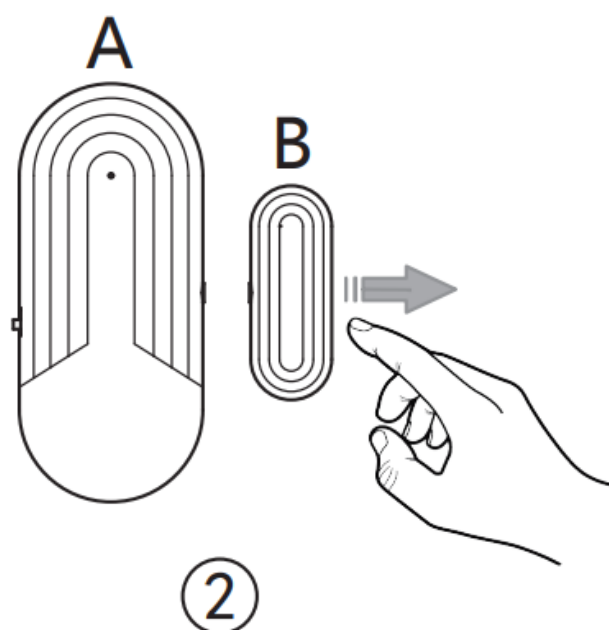

## Installation

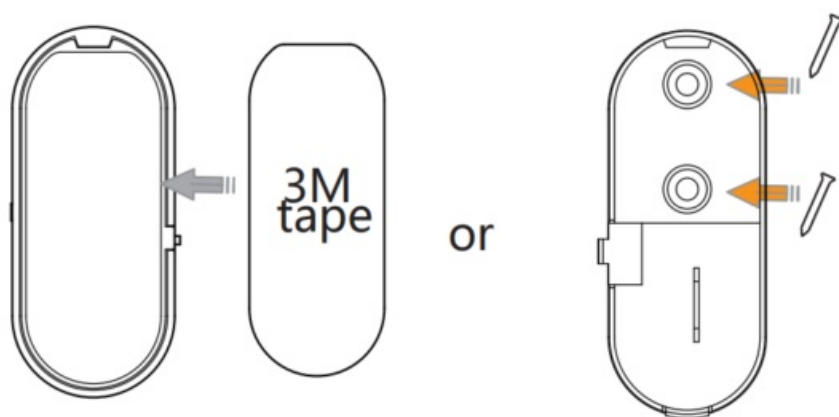

1. Use the double-side adhesive tape or the screws to fix the door sensor at the side of the door/window.

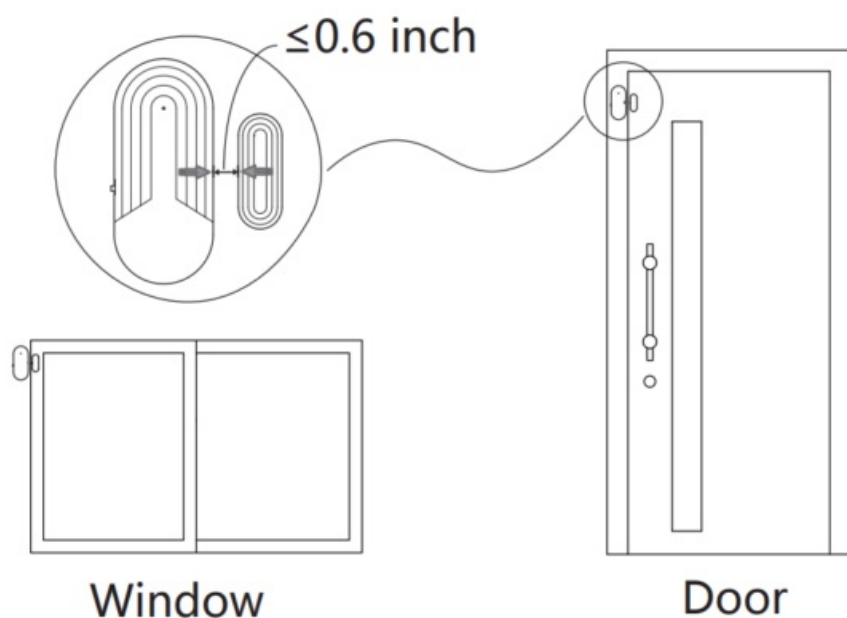

## Battery Replacement

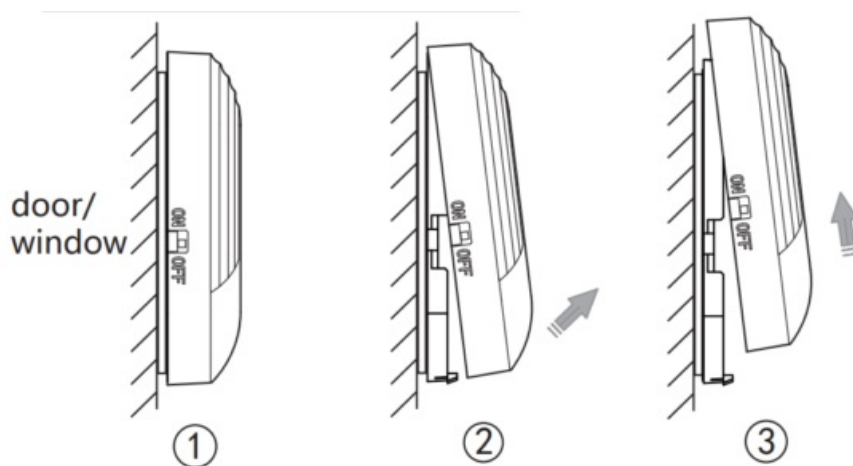

1. Push shell cover up until you can pull it off.

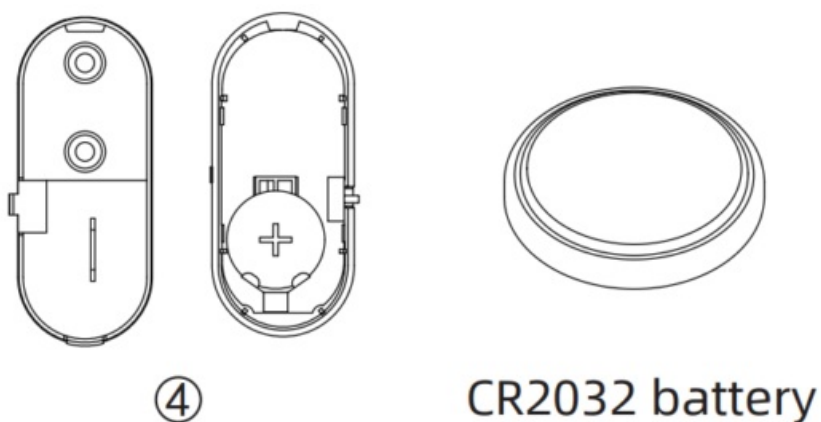

2. Please make sure the correct installation of positive and negative poles when you replace CR2032 battery.

## FCC Statement

Any Changes or modifications not expressly approved by the party responsible for compliance could void the user's authority to operate the equipment.

This device complies with part 15 of the FCC Rules. Operation is subject to the following two conditions:

1. This device may not cause harmful interference, and
2. This device must accept any interference received, including interference that may cause undesired operation.

### FCC Radiation Exposure Statement:

This equipment complies with FCC radiation exposure limits set forth for an uncontrolled environment. This transmitter must not be located or operating in conjunction with any other antenna or transmitter.

### ISED RSS Warning/ISED RF Exposure Statement

ISED RSS Warning:

This device complies with Innovation, Science and Economic Development Canada licence-exempt RSS standard(s). Operation is subject to the following two conditions: (1) this device may not cause interference, and (2) this device must accept any interference, including interference that may cause undesired operation of the device.

### ISED RF exposure statement:

This equipment complies with ISED radiation exposure limits set forth for an uncontrolled environment. This transmitter must not be co-located or operating in conjunction with any other antenna or transmitter.

### Documents / Resources

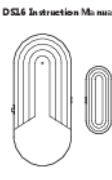
	<p><a href="#">DAYTECH DS16 Wireless Door/Window Sensor</a> [pdf] Instruction Manual 2AWYQ-DS16, 2AWYQDS16, DS16 Wireless Door Window Sensor, DS16, Wireless Door Window Sensor, Door Window Sensor, Window Sensor, Sensor</p>
---	--

### References

- [User Manual](#)

[Manuals+](#), [Privacy Policy](#)

This website is an independent publication and is neither affiliated with nor endorsed by any of the trademark owners. The "Bluetooth®" word mark and logos are registered trademarks owned by Bluetooth SIG, Inc. The "Wi-Fi®" word mark and logos are registered trademarks owned by the Wi-Fi Alliance. Any use of these marks on this website does not imply any affiliation with or endorsement.