



Daytech CC16 Caregiver Pager System User Manual

[Home](#) » [DAYTECH](#) » Daytech CC16 Caregiver Pager System User Manual 



Contents

- [1 CC16 Caregiver Pager System](#)
- [2 Product Introduction:](#)
- [3 Product Features:](#)
- [4 Product diagram:](#)
- [5 Operation instruction:](#)
- [6 Technical parameter](#)
- [7 Troubleshooting](#)
- [8 Documents / Resources](#)

CC16 Caregiver Pager System

Thank you very much for buying our number display receiver set, this is a very unique receiver, it has 1-6 numbers, it can be paired with many kinds of transmitters such as: call button, door magnet sensor, PIR sensor and other different accessories to form a system with different functions, it can display the corresponding number, so you can know and respond more quickly.

Note: This is a general manual, so you will see other different accessories, do not be surprised, their operating principles are the same, we believe that this should help you better use our products. Any questions you can contact us through the Amazon email!

Product Introduction:

CC16BL is composed of the receiver and the transmitter, the receiver is the indoor unit, and the transmitter maybe the call button/Door magnetic/PIR sensor. The installation is simple and flexible. this product is suitable for family housing, companies, hospitals, hotels, factories etc.

Product Features:

- 1-6 Number Display: 6 different transmitters correspond to 6 different numbers.
- When entering the code learning mode, you can select the number you want to be paired.
- 38 ringtones are optional: You can choose your favorite ringtone among 38 ringtones, and you can also set different ringtones for different transmitters for better differentiation.
- Learning code: you can flexibly add or decrease receivers and transmitters according to your needs, and the pairing method is simple and easy to operate.
- Memory function: the set ringtone can be locked by memory after the power is off, and the set ringtone can still be the same after the power is on.
- 5 level volume adjustable: 0-110 decibels, independent mute do not disturb mode, give you a better experience.
- The wireless range can be up to 150-300 meters (500-1000ft) in an open and barrier-free environment: the long range signal is stable and does not interfere with each other, but when there is many barriers, the range will be weaken.

Product diagram:

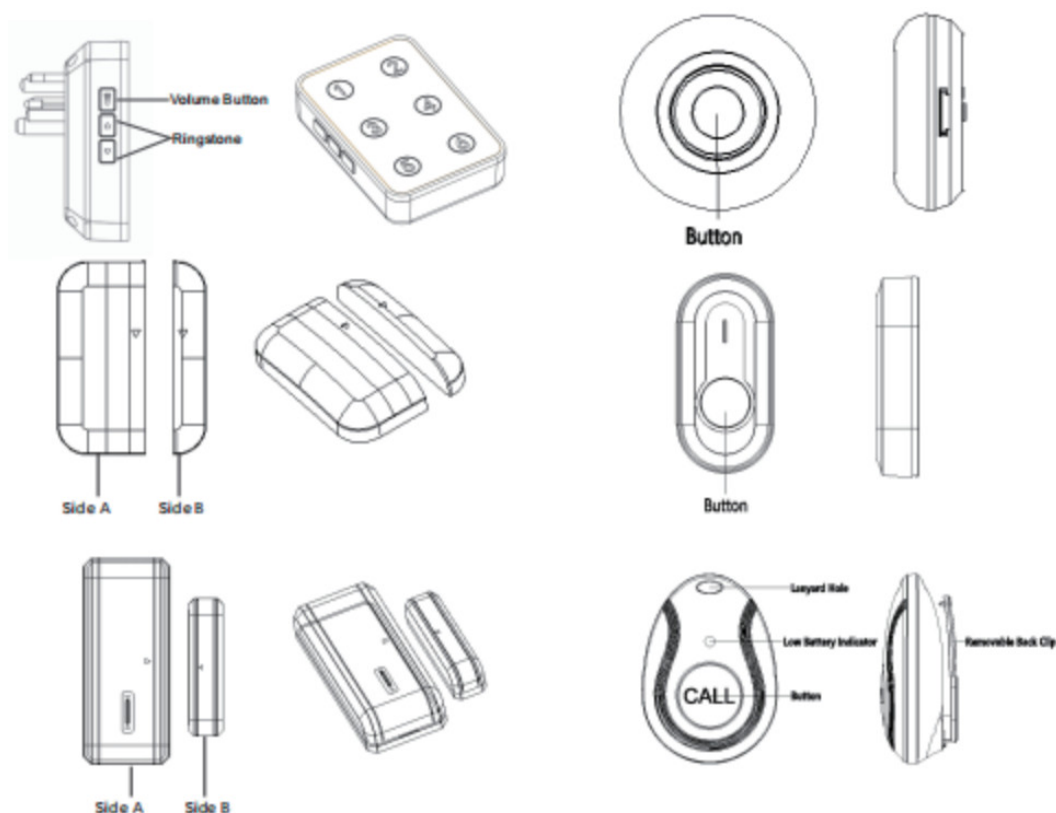

Operation instruction:

1. Volume adjustment:
Press the side volume button to adjust the volume level, from 1-5.
2. Change receiver ringtone /pair with transmitters

- A. Press the previous / next button on the receiver to choose the ringtone you want.
- B. Press and hold the volume button on the receiver for about 5 seconds until the receiver's number LED light flashes and emits a "Ding" prompt to enter the learning mode (the learning time last for about 10 seconds,after 10 seconds the receiver will exit the learning mode automatically).
- C. In the learning mode, press the call button/separate the door magnet sensor/trigger the PIR to send a signal to the receiver, the receiver will emit two beeps of "ding, ding", then the setting is finished.
- D.You just need to trigger the transmitter again to check whether the pairing is successful or not. If not,repeat the above steps!

How to choose the number to pair with the transmitter?

Press and hold the volume button for 5 seconds to enter learning mode, then a random number will light up, you select the number by pressing the volume button, then you just trigger the signal of the transmitter,the receiver will receive the signal and finish pairing, then you just need to check again if the pairing is successful.

3. Code clearing/Reset:

Long press and hold the next button of the receiver until the LED light of the receiver flashes and a "ding" beep sounds, all the pairing code between the all the transmitters and receivers is cleared.

4. Installation.

We have finished pairing before shipping, you don't need to re-pair again (unless you want to change the default configuration), you just need to plug in the socket, install the transmitter and it will work fine.

Call button Installation

There are two ways to install the call button, you can use double-sided tape to stick it or fix it by screws (screws and double-side tape are included)

Door Magnet Sensor Installation

Pull out the battery insulator, peel off the double-sided tape from the two parts of the door magnet and stick the two parts on a clean door and door frame or window, taking care to keep the two parts parallel in the same plane and the distance between them should not exceed 0.6 inch.

Technical parameter

Operating temperature	-30°C to +70°C
Working frequency	433.92MHz±280KHz
Transmitter battery	23A12V alkaline zinc manganese battery
Receiver voltage	AC 110-260V (wide voltage)

Precautions

- Please test the working distance between the receiver and the transmitter before install it!
- Do not install the transmitter on the security door, the metal will weaken the signal and affect working range!
- Do not install the receiver next to TV sets, induction cookers, microwave ovens and other appliances with electromagnetic waves!
- Do not set fire to receivers and transmitters to avoid unnecessary accidents!

Troubleshooting

Not working or not working after a period of use?

Maybe the reason below:

1. The distance between the receiver and the transmitter is too far or there are other obstacles affecting the signal distance, try to shorten the distance between the transmitter and the receiver.
2. The receiver and the transmitter are not paired successfully resulting in not working, need to re-pair (according to Change receiver ringtone /pair with transmitters)
3. The pairing information between the receiver and transmitter was cleared accidentally and needs to be re-paired (according to Change receiver ringtone /pair with transmitters)
4. The battery of the transmitter is too low to transmit the signal properly, and needs to be replaced with a new battery.

If the above methods still can not solve your problem, please contact us via Amazon email and we will provide a solution.

Change the Battery of the Call Button



Documents / Resources

	<p>Daytech CC16 Caregiver Pager System [pdf] User Manual CC16 Caregiver Pager System, CC16, Caregiver Pager System, Pager System</p>
--	--