



Daytech CC05 Wireless Chime or Pager User Manual

[Home](#) » [DAYTECH](#) » Daytech CC05 Wireless Chime or Pager User Manual 

Contents

- [1 Daytech CC05 Wireless Chime or Pager](#)
- [2 FEATURES](#)
- [3 SPECIFICATIONS](#)
- [4 PACKAGE LIST](#)
- [5 THE FIRST USE GUIDE](#)
- [6 CHANGINIG THE RINGTONE / PAIRING](#)
- [7 CLEAIRING THE SETTINGS:](#)
- [8 INSTALLAT'ION](#)
 - [8.1 ADJUSTMENTS](#)
- [9 CHANGING THE BATTERY](#)
- [10 PROBLEMS](#)
- [11 Documents / Resources](#)
- [12 Related Posts](#)



Daytech CC05 Wireless Chime or Pager



FEATURES

- Modern & Stylish design
- Easy installation
- Approx. 1000ft/300mtrs operation range (open air)
- 5 levels of volume
- IP55 Waterproof
- 5 Ringtones
- Low power consumption

SPECIFICATIONS

Working voltage	110-260V
I Battery inTransmitter/Receiver	12V/23A Alkaline battery
Working temperature	-30C-70C/-22F-158F

PACKAGE LIST

- Receiver

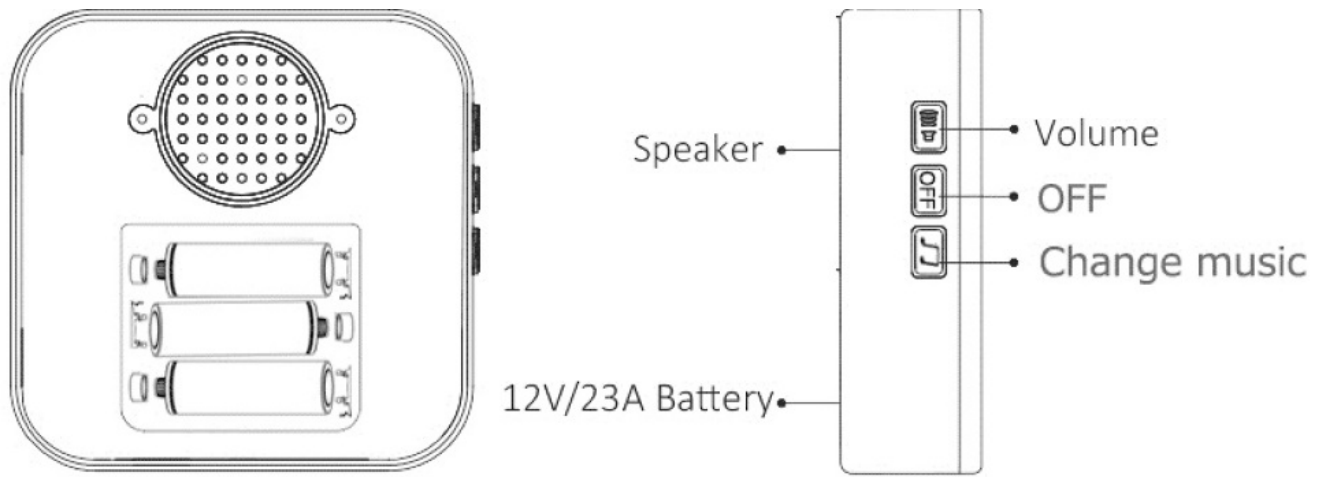

RECEIVER

- Transmitter (Optional)
- Double sided adhesive tape
- User manual
- 12V/23A Battery



TRANSMITTER 1: Call Button

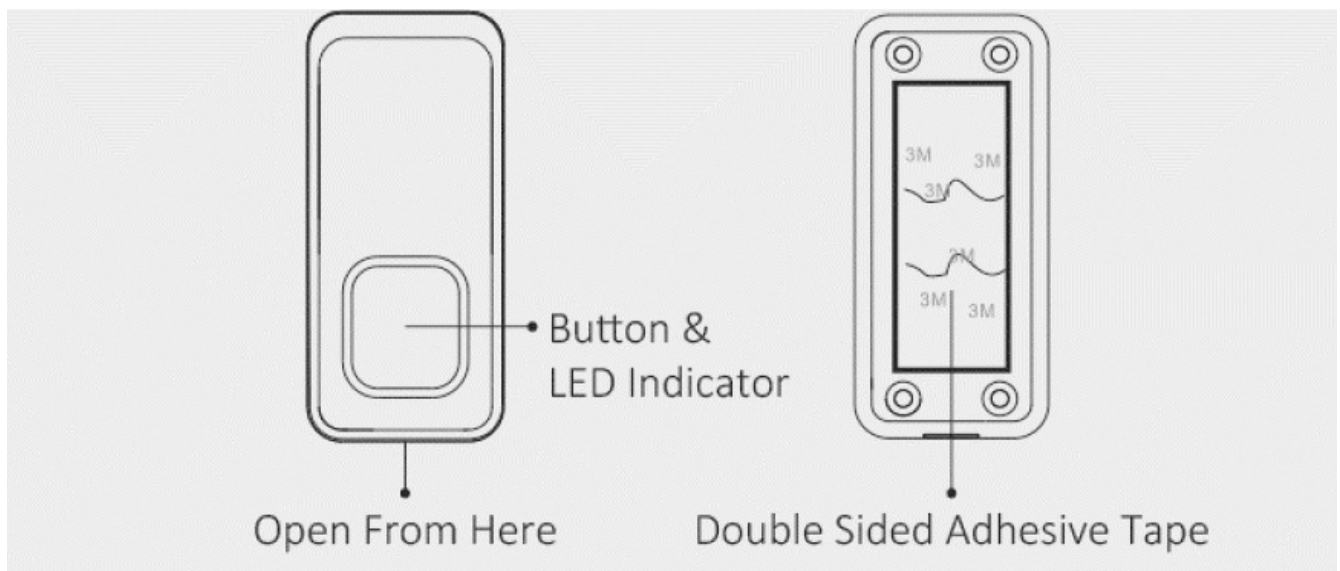

TRANSMITTER 2: Push Button of Doorbell

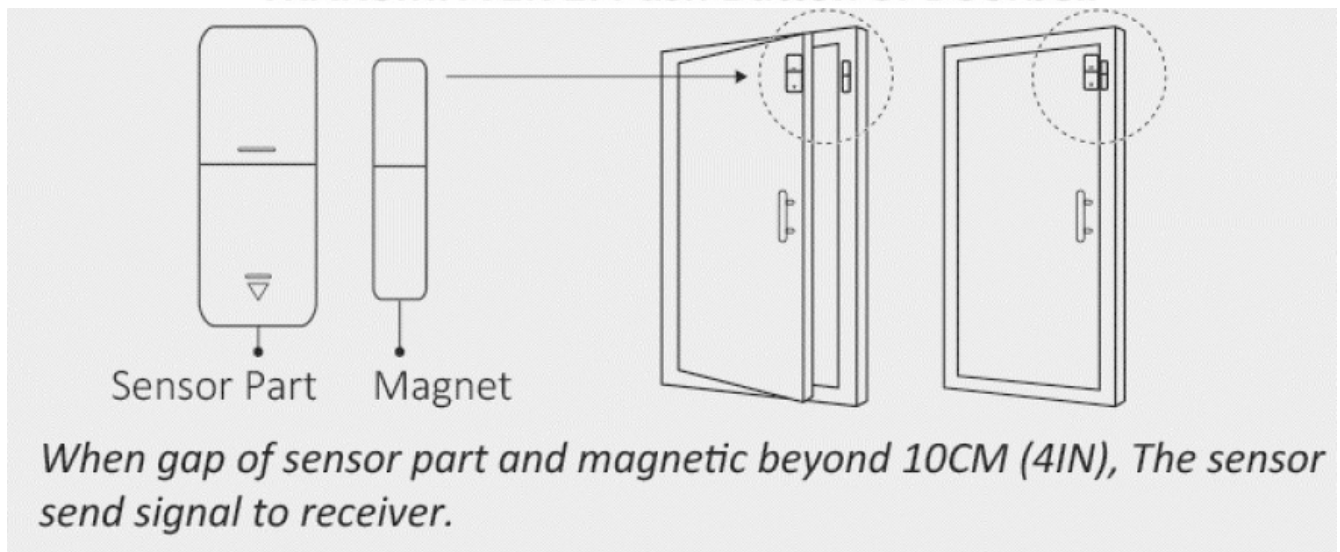

TRANSMITTER 3: Door Sensor

THE FIRST USE GUIDE

1. Put the AAA batteries into the receiver.
2. Press the transmitter push button and confirm that the transmitter indicator flashes, the doorbell receiver sounds "Ding-Ding" and the receiver indicator flashes. The doorbell is paired. The default ringtone is "Ding-Dong". Users can change the ringtone easily, just refer to the "CHANGING THE RINGTONE" steps.

CHANGING THE RINGTONE / PAIRING

- **Step 1:** Press the [M] (change music) button on the receiver to choose your favorite melody.
- **Step 2:** Press and hold down the [VOL] (Volume) button on the receiver for 5 seconds, until it makes a "Ding" sound and the receiver indicator flashes (that means the doorbell entered into the Pairing Mode, the pairing mode will only last 8 seconds, then it will automatically exit).
- **Step 3:** Press the button on the transmitter quickly, it will make a "Ding Ding" sound and the receiver indicator flashes.
- **Step 4:** Press the button on the transmitter again to confirm whether the current ringtone is the one you have set, if yes; the pairing is completed.

Remark:

1. This method is also suitable for adding/pairing additional Transmitters.
2. If Pairing door sensor, let Gap between sensor part and magnet beyond 10cm (to send out the signal) instead of Pressing the button

CLEARING THE SETTINGS:

Press and hold down the Forward button on the receiver for 5 seconds, until it makes a “O,ii1g” sound and the receiver indicator flashes, all the settings will be cleared, the doorbell will back to the factory default settings (it means that the ringtone you have set and the transmitters you have added/paired before will be cleared).

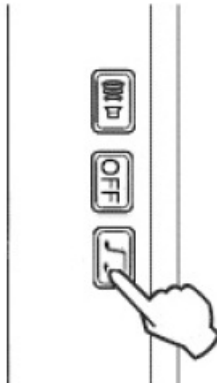
**INSTALLATION**

1. Put the AAA batteries into the
2. Place the transmitter exactly where you intend to fix and, with the doors closed, confirm that the doorbell receiver still sounds when you press the transmitter push button (If the doorbell receiver does not sound, this may be due to metal within the fixing surface and you may need to reposition the transmitter)”
3. Fix the transmitter in place with {supplied) double sided adhesive tape

ADJUSTMENTS

1. The volume of the doorbell can be adjusted to One Of five levels. Press the Volume button on the receiver to increase the volume by one level the receiver will sound to indicate the selected level. If the maximum level is already set, the doorbell will switch to the minimum level which is the Silent Mode.
2. The melody played by the doorbell may be set to any one of 5 different selections. Press the Backward or Forward button to select the next available melody, the receiver will sound to indicate the selected melody. To set the doorbell ringtone to, the selected melody, please refer to the “CHANGING, THE RINGTONE” steps

CHANGING THE BATTERY

1. Insert the (supplied) Mini Screwdriver in the cover slot at the bottom of the transmitter and twist to release the transmitter from the cover:
2. Remove the exhausted battery and dispose of properly.
3. Insert the new battery into the battery compartment. Observe correct battery polarity (+ve and -ve), or the unit will not function and may be damaged.
4. Refit the transmitter to the cover, with the push button at the bottom

PROBLEMS

If the doorbell does not sound, the following are possible causes:

1. The battery in the transmitter may be run down (the transmitter indicator will not flash). Replace the battery.
2. The battery may be inserted the wrong way round (polarity reversed). Insert the battery correctly, but be aware the reverse polarity may damage the unit.
3. The battery in the receiver may be run down (the receiver indicator will not flash). Replace the battery.
4. Check that neither the transmitter nor the receiver are near to possible sources of electrical interference, such as a power adaptor, or other wireless devices.
5. The range will be reduced by obstacles such as walls, although this will have been checked during setup. Check that nothing, particularly a metal object, has been placed between the transmitter and the receiver. You may need to reposition the doorbell.

CAUTIONS:

1. The receiver is for indoor use only. Do not use outside or allow to become wet.
2. There are no user-serviceable parts. Do not attempt to repair either the transmitter or the receiver by yourself.

Documents / Resources

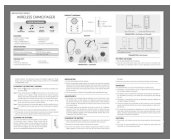

[Daytech CC05 Wireless Chime or Pager](#) [pdf] User Manual
CC05, CC05 Wireless Chime or Pager, Wireless Chime or Pager, Chime or Pager, Chime, Pager