



DAVIS 6803 EnviroMonitor Cellular Remote Field Monitoring System User Manual

[Home](#) » [DAVIS](#) » DAVIS 6803 EnviroMonitor Cellular Remote Field Monitoring System User Manual 

Contents

- [1 DAVIS 6803 EnviroMonitor Cellular Remote Field Monitoring System](#)
- [2 Contents of Kit](#)
- [3 Vantage Connect: Remove the Old Board](#)
- [4 EnviroMonitor Gateway: Remove the old Board](#)
- [5 Install the Replacement Board](#)
- [6 Replace the Old Device ID with the New](#)
- [7 Connect and Remount your Gateway](#)
- [8 Documents / Resources](#)
 - [8.1 References](#)
- [9 Related Posts](#)



DAVIS 6803 EnviroMonitor Cellular Remote Field Monitoring System



Contents of Kit

The 6803 EnviroMonitor Gateway Board Upgrade Kit comes with a new board with two cellular antennas and a mesh antenna attached, and a new gray plastic board cover. There is a sticker for the plastic cover with the new Device ID, as well as troubleshooting stickers for inside the door of your shelter. The hardware kit includes 3 #4 x 3/8" screws for attaching the board to the shelter and 2 #6 X 1/2" screws to secure the cover

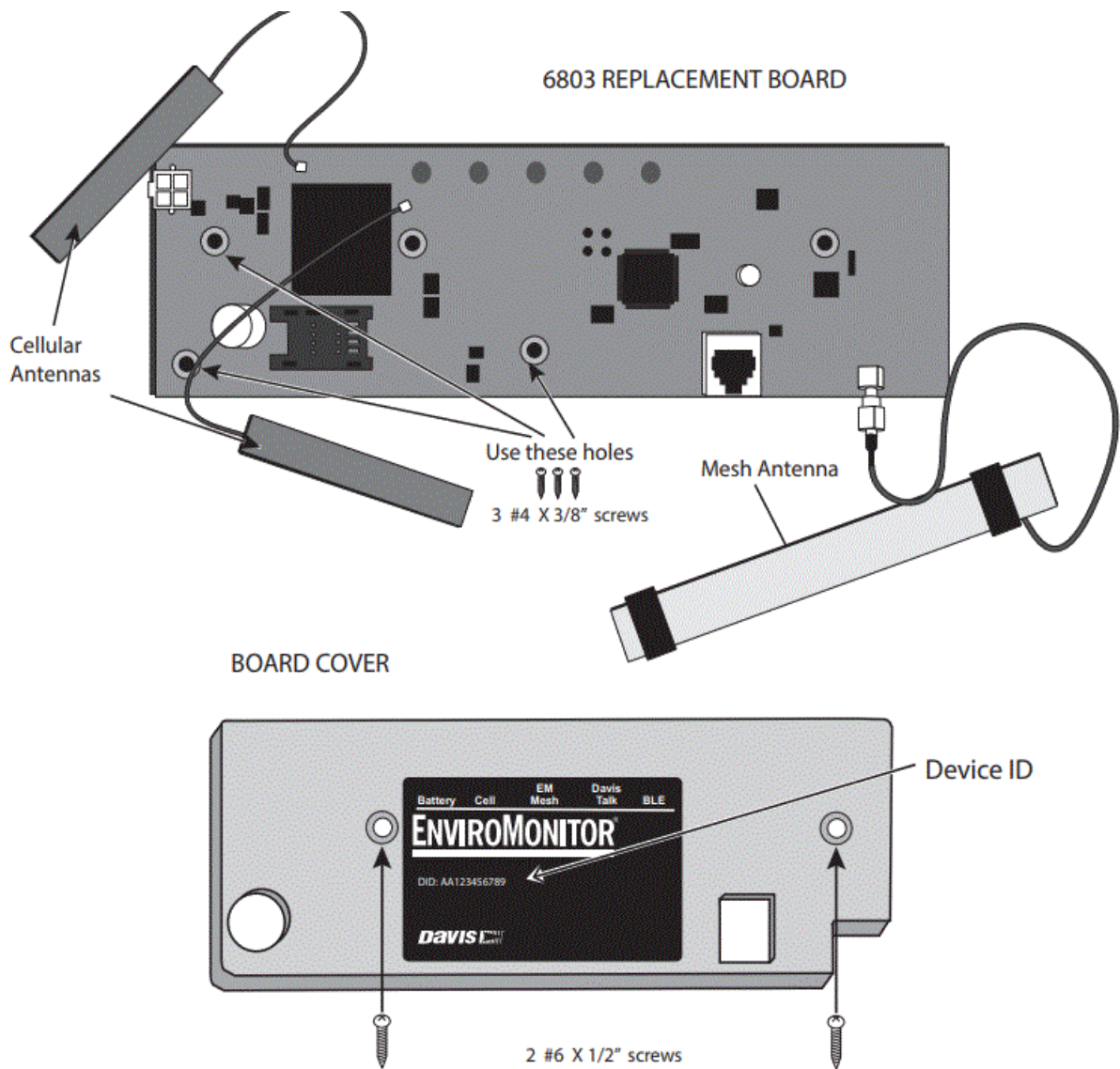

Note: Please handle the board and antennas with care, especially the connection between the cellular antennas and the board. The connections allows for turning but can be broken if pulled or handled roughly

Vantage Connect: Remove the Old Board

Tools Needed:

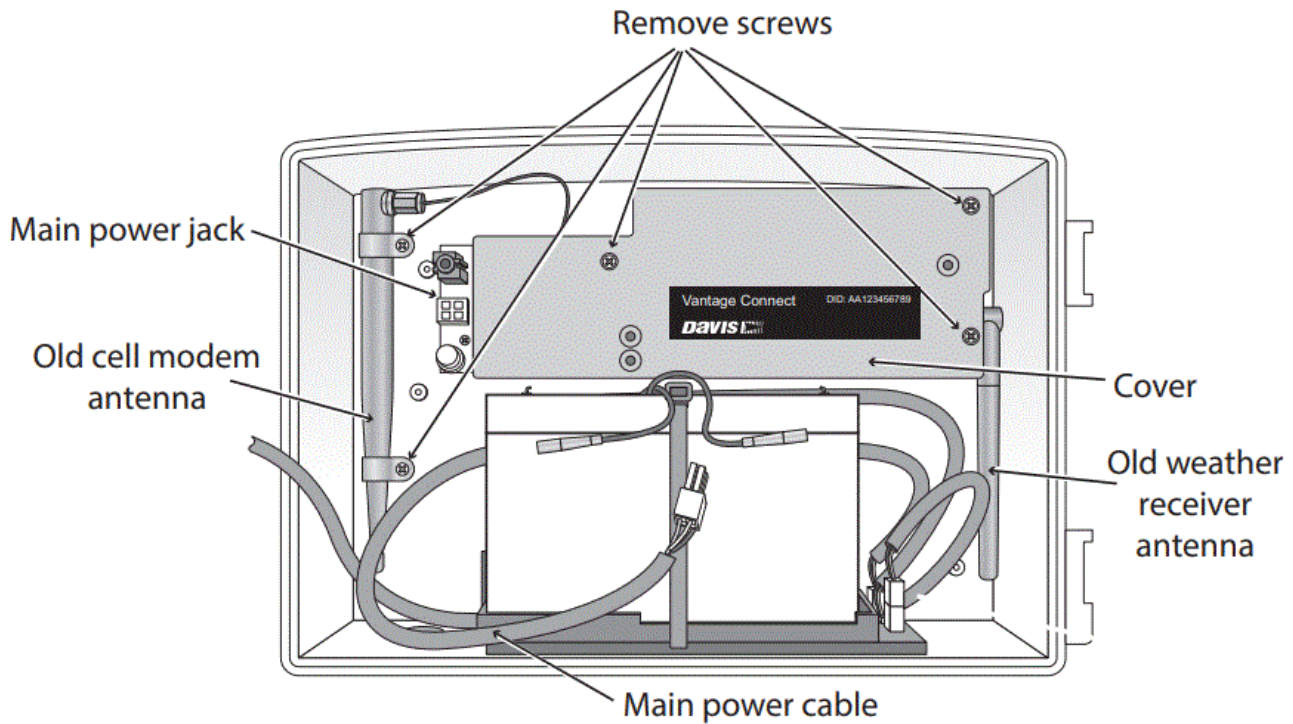

- Phillips head screwdrivers: #1 and #2.
 1. Open your Vantage Connect shelter.
 2. Unplug the main power cable from the main power jack and disconnect the battery cables to allow for easier access to the board.
 3. Unscrew the three screws holding the plastic cover over the board, and remove the cover. Unscrew the two screws securing the cellular antenna.
 4. Using a small Phillips head screwdriver, unscrew the two screws securing the board.

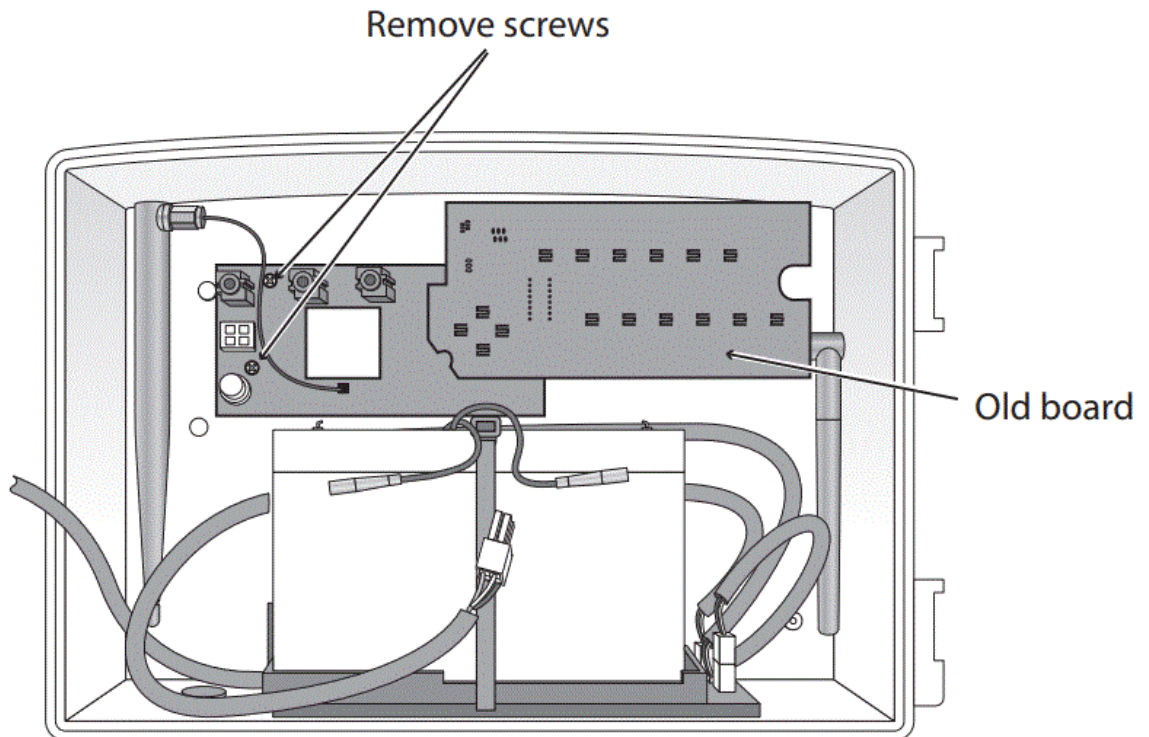

5. Lift out the board and antennas.
6. Install the new board. See page 4: Install the Replacement Board.

EnviroMonitor Gateway: Remove the old Board

Phillips head screwdrivers: #1 and #2

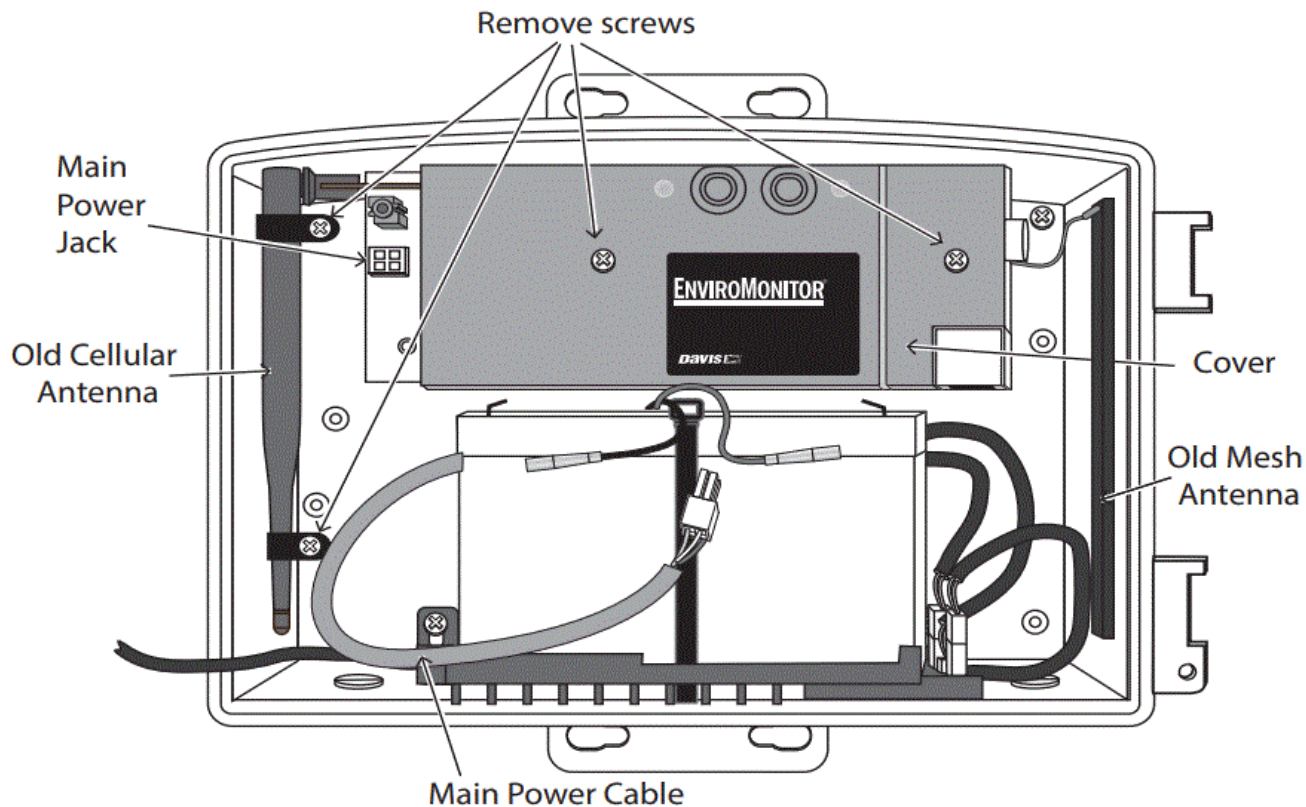

1. Open your Gateway shelter.
2. Unplug the main power cable from the main power jack and disconnect the battery cables to allow for easier access to the board.
3. Unscrew the two screws holding the plastic cover over the board, and remove the cover. Unscrew the two screws securing the cellular antenna.
4. Using a small Phillips head screwdriver, unscrew the three screws securing the board.

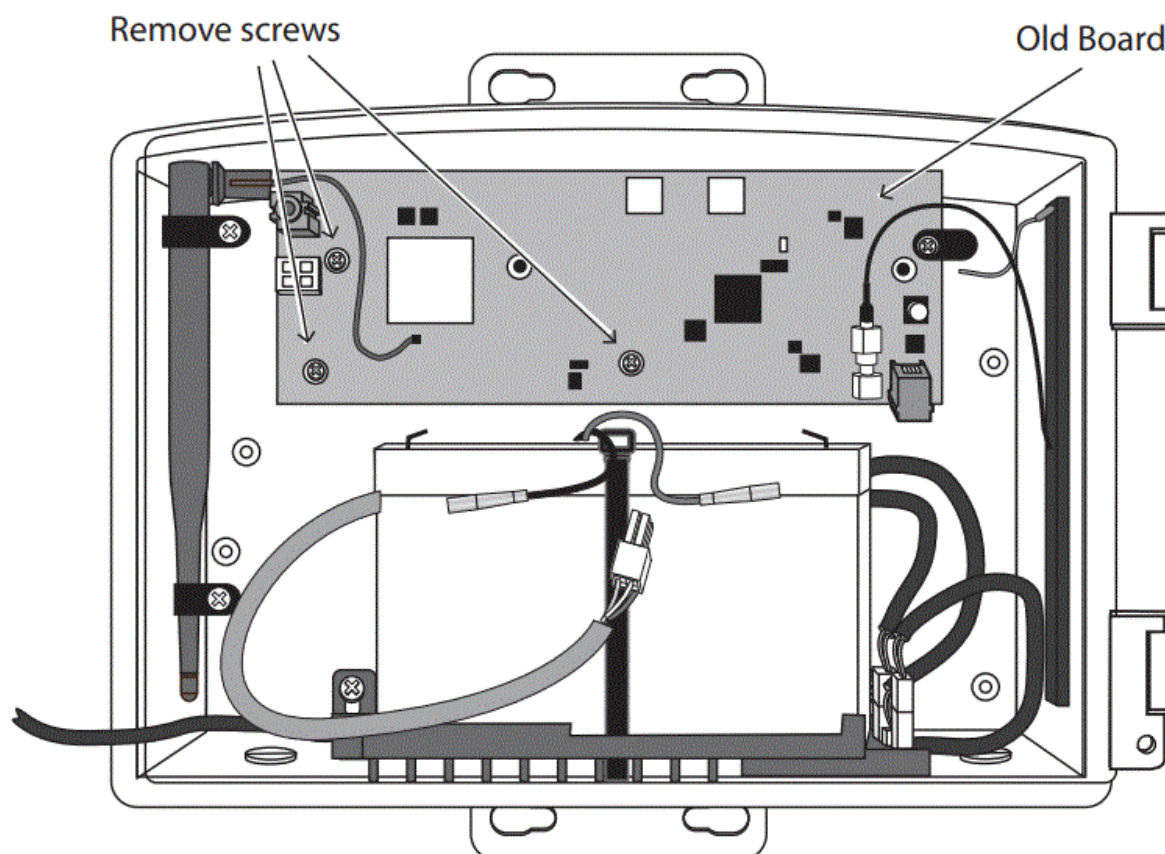

5. Lift out the board and antennas.
6. Install the new board. See page 4: Install the Replacement Board.

Install the Replacement Board

1. Being careful with the antenna cables, center the new board with the screw holes above the appropriate bosses in the shelter.
2. Using the three #4 x 3/8" screws, attach the board.

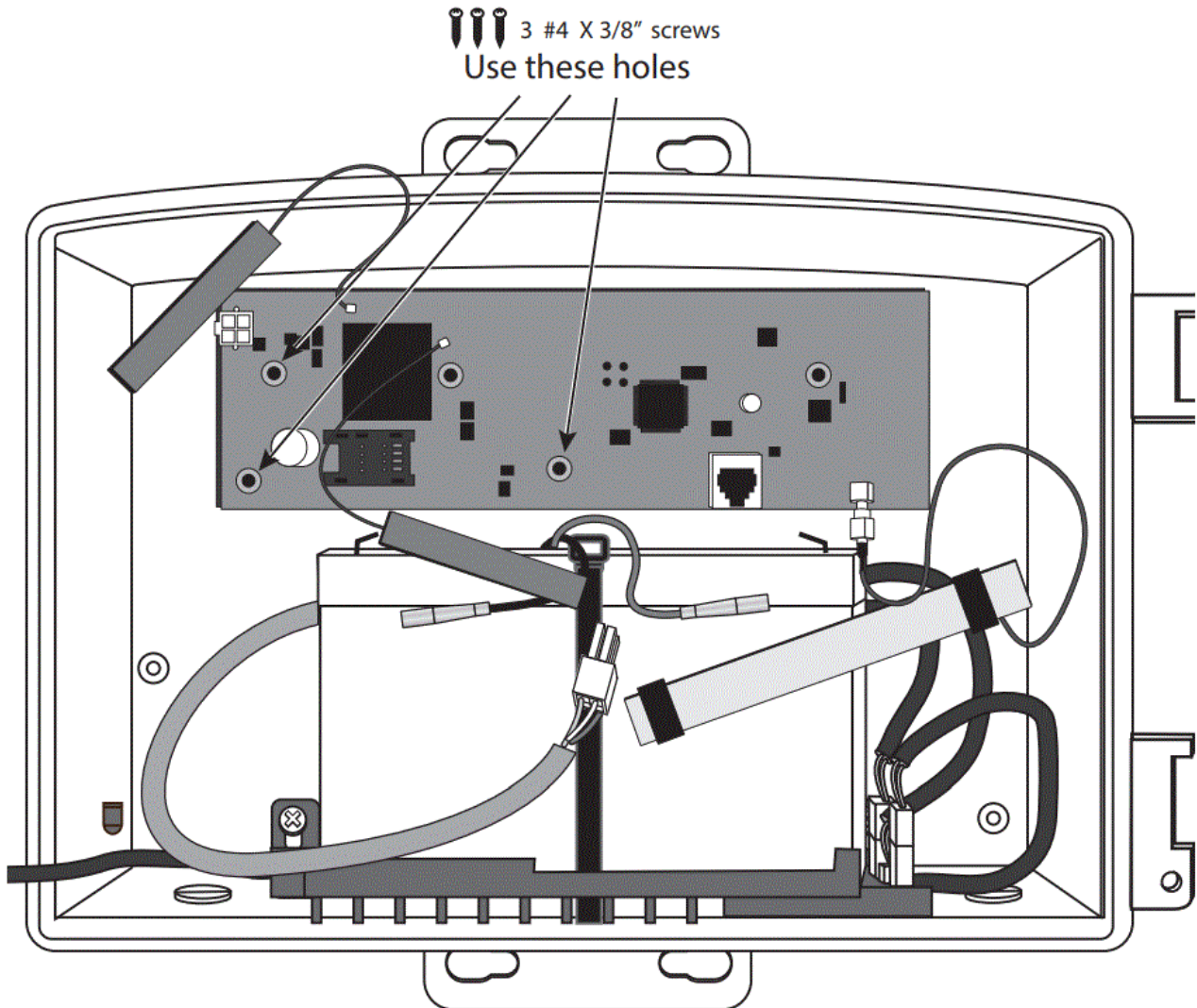

3. Install the new cover. Make sure the new cellular antennas cables exit through the openings on the upper left side and left top of the cover. Attach the cover using the two #6 x 1/2" screws.
4. Put the new black label with the new DID on the cover.
5. Peel the backing from the adhesive tape on the new antennas and adhere them to the inner walls of the shelter, as shown in the illustration below. The two cellular antennas should be placed at right angles to each other, rather than parallel. Reconnect the battery cables and main power cable.

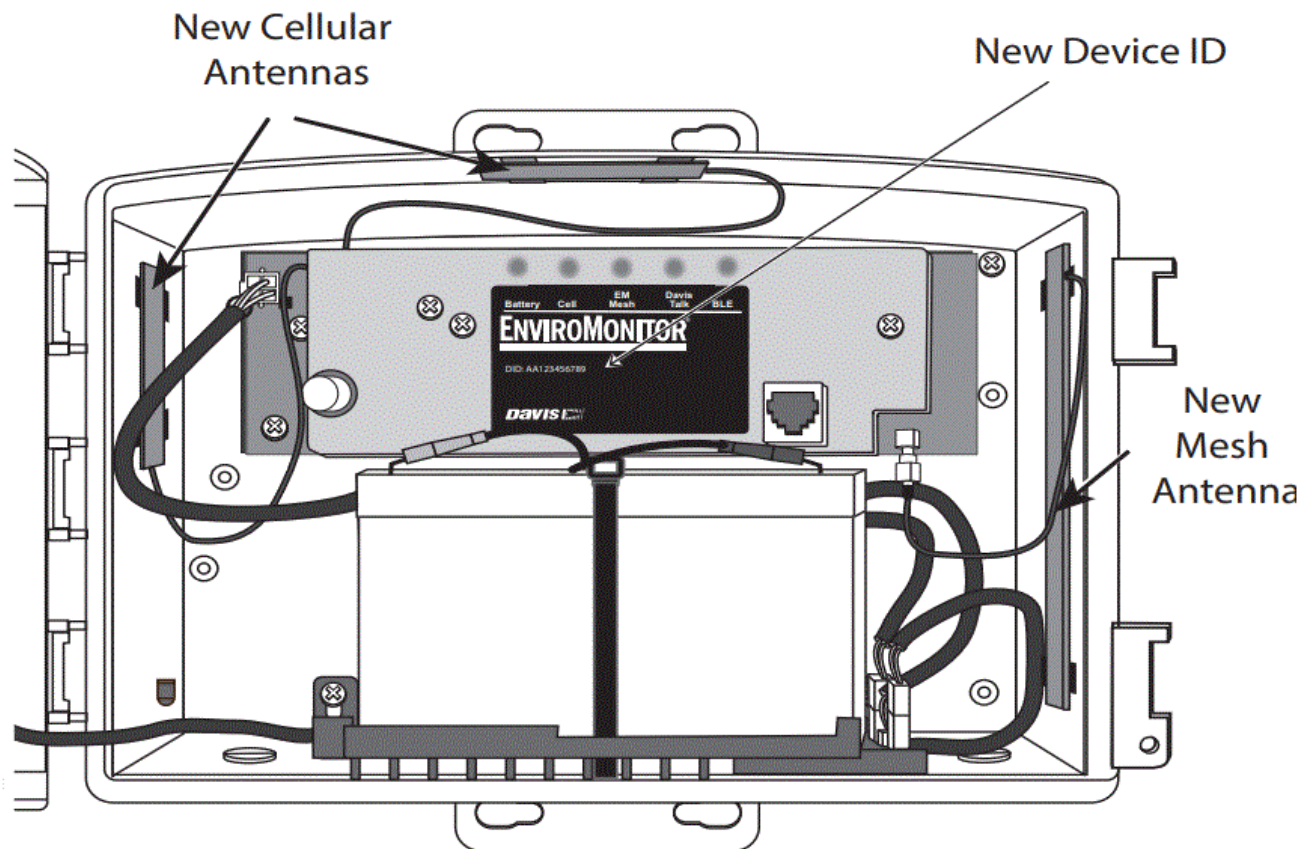

Replace the Old Device ID with the New

Your current data on WeatherLink.com is associated with your device through the Device ID or DID. For uninterrupted data, you must tell the system to replace or merge the old board's DID with the new board's DID. The new DID is on the label on the new board's cover.

Old EnviroMonitor Gateway to an 6803 EnviroMonitor Gateway:

1. Open the EnviroMonitor app on your smart phone.
2. Click on the old Gateway that will be upgraded.
3. Tap the Menu icon in the upper right corner. Scroll down to the Replace button.
4. Follow the prompts to complete the process.

Old Vantage Connect to 6803 EnviroMonitor Gateway:

1. Open the EnviroMonitor app on your smart phone.
2. Follow the prompts to set up your EnviroMonitor Gateway.

You will now have two stations on WeatherLink.com: your old Vantage Connect with all its data, and your new Gateway with any data it has collected since you powered it up. You can leave these two stations as is, or you can merge the old data into the new.

1. Log into your account on WeatherLink.com and select the new EnviroMonitor Gateway.
2. Click Tools icon (it looks like a wrench).
3. Select "device", then "Import." Follow the prompts to complete the merge.
4. If you want to delete the old station, please contact Technical Support.

Connect and Remount your Gateway

Now you are ready to connect and remount your Gateway and add Nodes as desired. For instructions on how to do this, please refer to the EnviroMonitor Gateway and Node User Guide. It can be found in the support section of www.davisinstruments.com.

Documents / Resources

	<p>DAVIS 6803 EnviroMonitor Cellular Remote Field Monitoring System [pdf] User Manual 6803, EnviroMonitor Cellular Remote Field Monitoring System, 6803 EnviroMonitor Cellular Remote Field Monitoring System, 6683</p>
---	---

References

- [WeatherLink Home](#)
- [Davis Instruments](#)

Manuals+