



DAVINCI M5926 MDB Bookcase in Espresso Instruction Manual

[Home](#) » [DaVinci](#) » DAVINCI M5926 MDB Bookcase in Espresso Instruction Manual 

Contents

- [1 DAVINCI M5926 MDB Bookcase in Espresso](#)
- [2 PARTS](#)
- [3 Hardware](#)
- [4 ASSEMBLY INSTRUCTIONS](#)
- [5 Installation](#)
- [6 DRAWER ASSEMBLY INSTRUCTIONS](#)
- [7 ONE YEAR LIMITED WARRANTY:](#)
- [8 Storage:](#)
- [9 Documents / Resources](#)
 - [9.1 References](#)
- [10 Related Posts](#)



DAVINCI M5926 MDB Bookcase in Espresso



Thank you for purchasing a DaVinci nursery product! To ensure safe use of your product, please follow these assembly instructions closely. If you are missing parts or have any questions, please visit our website at www.davincibaby.com/support. For assembly, use the Allen wrench if it is included in the hardware box. We also recommend using a Phillips head screwdriver (not included) to complete assembly. Please do not substitute parts or use power screwdrivers. Our pieces are made from natural woods. Due to the nature of wood, some variation in color, grain, or texture is to be expected. We hope you and your growing family enjoy our product. With thanks,

You will need two people to assemble this bookcase.



Tools Needed (not included Outils requis (non inclus))



Phillips screwdriver

PARTS

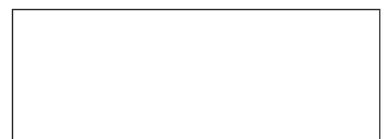
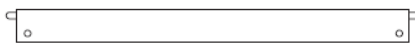
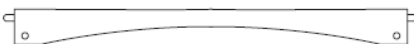

- Top & bottom front panel (2)
- Back Top / Bottom Rail (2)
- Adjustable shelves (3)



D. Stationary shelves (2)
D. Étagères fixes(2)

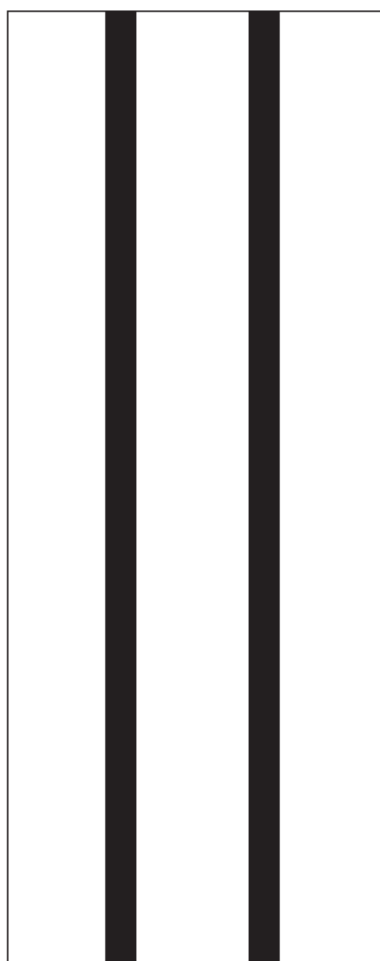

E Back panel
E. Panneau arrière

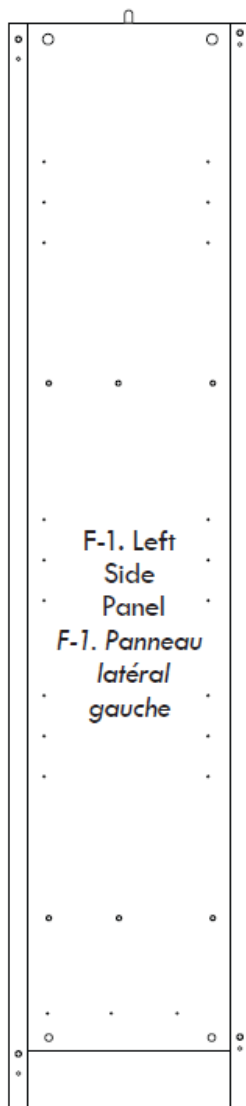

F-1. Left
Side
Panel
F-1. Panneau
latéral
gauche

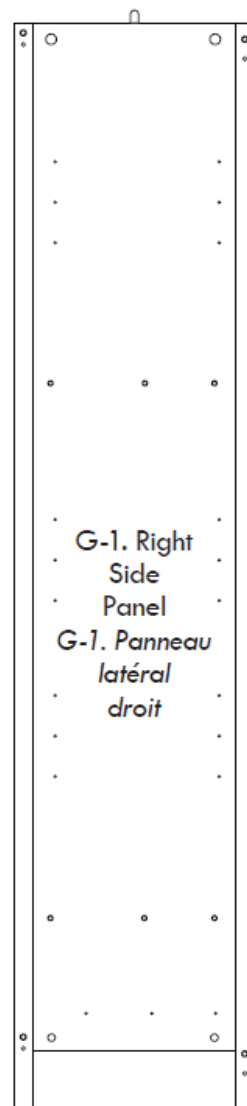

G-1. Right
Side
Panel
G-1. Panneau
latéral
droit



H-1. Finished Drawer
Front Panel
H-1. Façade de tiroir
de finition



I-3. Right drawer side
I-3. Côté droit de tiroir

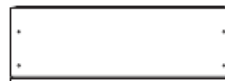

J-3. Left drawer side
J-3. Côté gauche de tiroir



K-3. Drawer front
K-3. Façade de tiroir



L-3. Drawer back
L-3. Arrière de tiroir

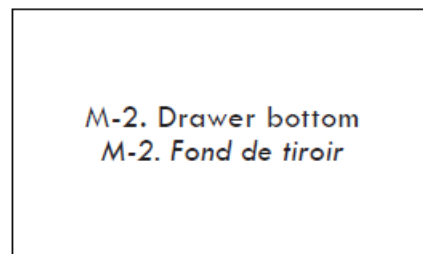

M-2. Drawer bottom
M-2. Fond de tiroir

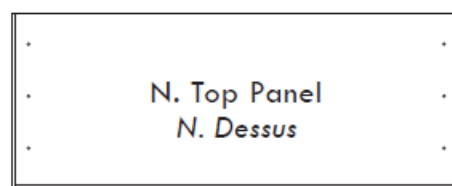

N. Top Panel
N. Dessus

Hardware



H1. Cam bolt (20)
H1. Boulon de came (20)



H2. Cam lock (20)
H2. Verrou de came (20)



H3. 1" Phillips head screw (8)
H3. Vis à tête cruciforme de
2,5 cm (1 po) (8)



H4. 3/4" Phillips head
screw (4)
H4. Vis à tête cruciforme de
1,9 cm (3/4 po) (4)



H5. 7/16" Phillips head
screw (46)
H5. Vis à tête cruciforme de
1,1 cm (7/16 po) (46)



H6. 1-1/2" Knob Screw (2)
H6. Vis de poignée de
3,8 cm (1-1/2 po) (2)



H7. Drawer knob (2)
H7. Poignée (2)



H8. Metal Shelf Peg (12)
H8. Cheville d'étagère
en métal (12)



H9. 0.8 x 2 cm
wood dowel (2)
H9. 0.8 x 2 cm
Goujon de bois (2)

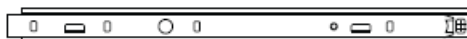

H10. Left panel glide
H10. Glissière côté gauche

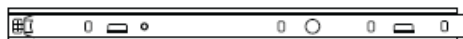

H11. Right panel glide
H11. Glissière côté droit

ASSEMBLY INSTRUCTIONS

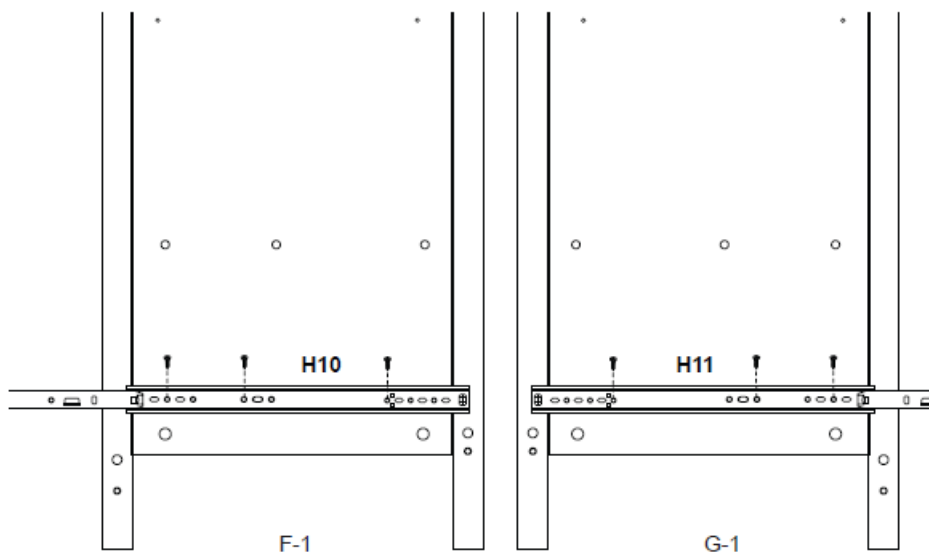

Do not overtighten.
Ne pas trop serrer.

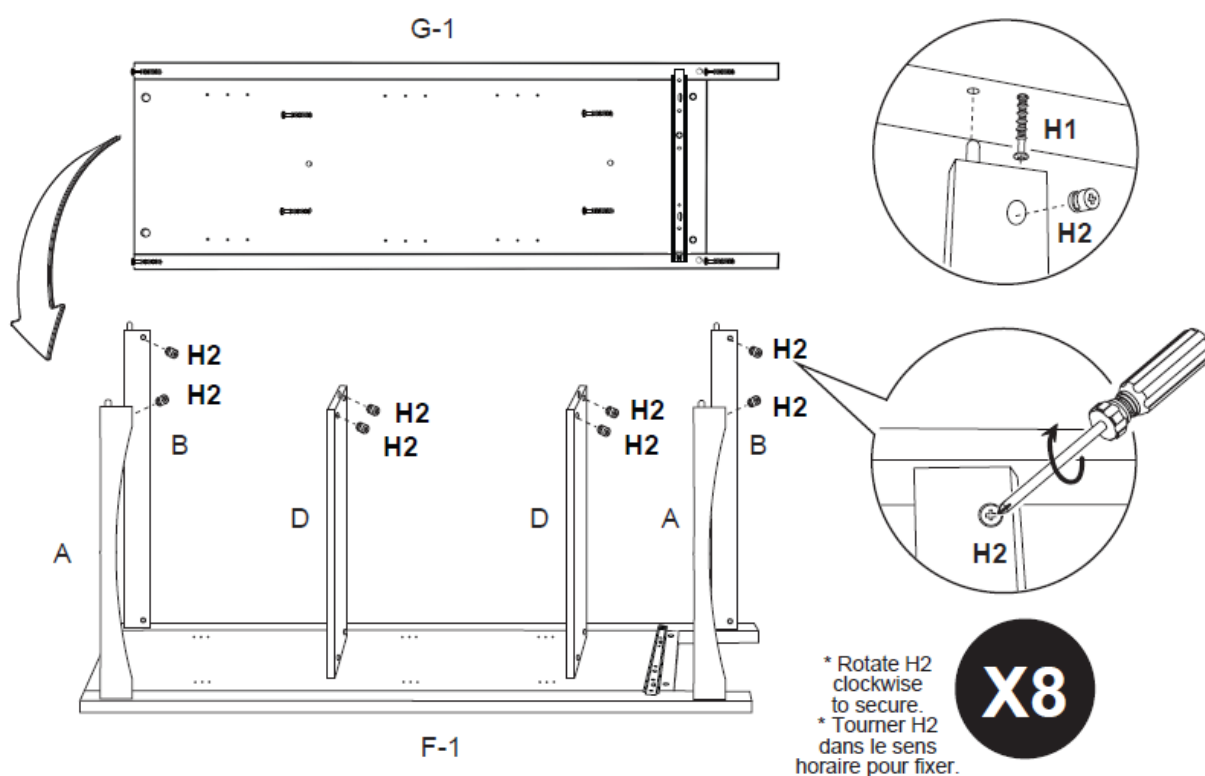
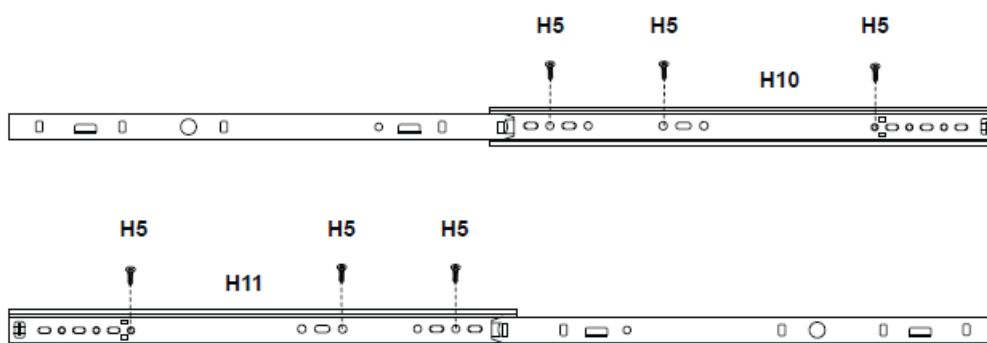

Installation

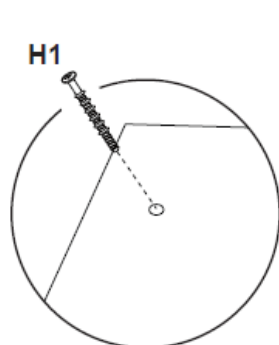
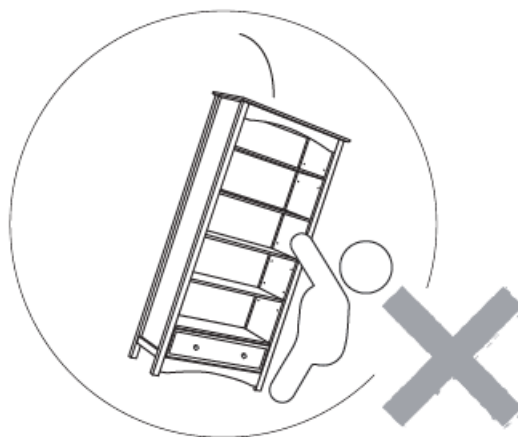

X4



N

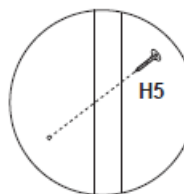
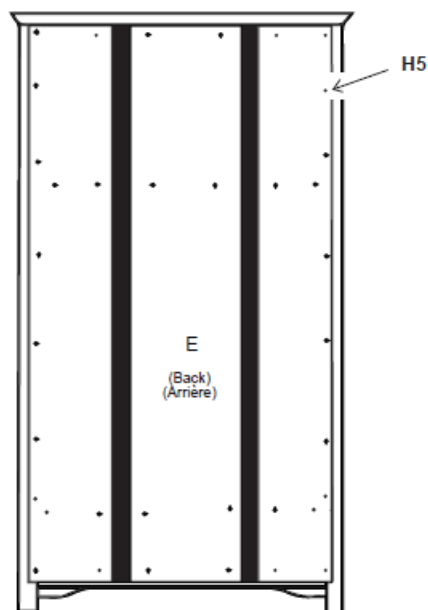
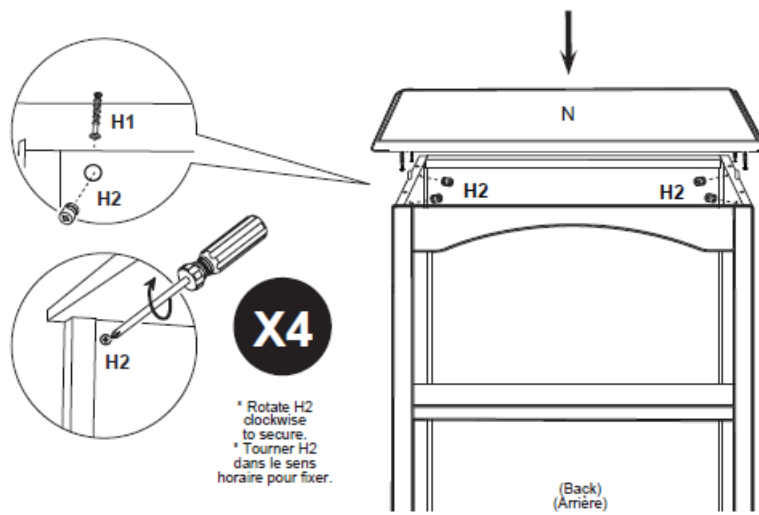

Do not overtighten.
Ne pas trop serrer.

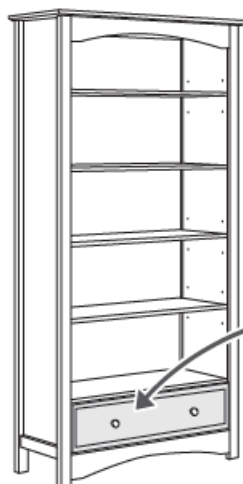

Children have died from furniture tipover. To reduce the risk of furniture tipover, ALWAYS install tip over restraint provided.



X 1

For wall
Para la pared
Pour le mur



X 1

For dresser
Para la cómoda
Pour la commode

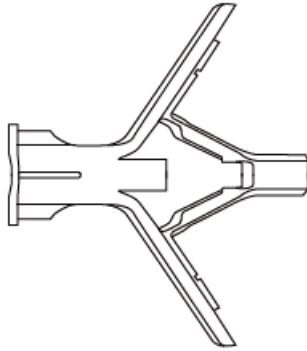

X2



X 1

X 1

For drywall
Para tablaroca
Pour une cloison en plâtre

Find your wall material and follow steps to attach the anti-tip kit to your wall. Drywall or plaster with available wood stud:

- Mark the attachment point with a pencil, 1" to 2" (25-50 mm) below top of dresser, positioned over a wood stud.
- Drill 1/8-inch (3 mm) diameter pilot hole into the wood stud, on the pencil mark.
- Following the appropriate pictogram instructions on the following pages, drive the screw with washer through the textile strap and tighten screw firmly into the wood.
- Drywall without available wood stud:
 - Mark the attachment point with a pencil, 1" to 2" (25-50 mm) below top of dresser.
 - Drill 3/8-inch (9 mm) diameter hole through the wall, on the pencil mark.
 - Drive the plastic anchor into the hole, using a hammer if needed.
 - Following the appropriate pictogram instructions on the following pages, drive the screw with washer through the textile strap and tighten screw firmly into the plastic anchor in the wall. Do not over-tighten.
- If your wall material is not listed here, or if you have any questions, consult your local hardware store.

Fasten strap to back of dresser.

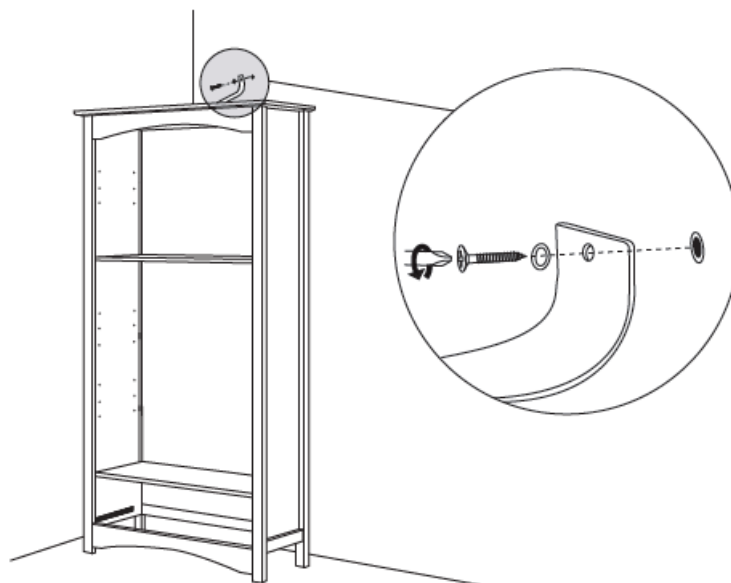

Mark spot on wall 1-2" (25-50mm) below the top of the dresser.

* Drywall without
available wood stud.

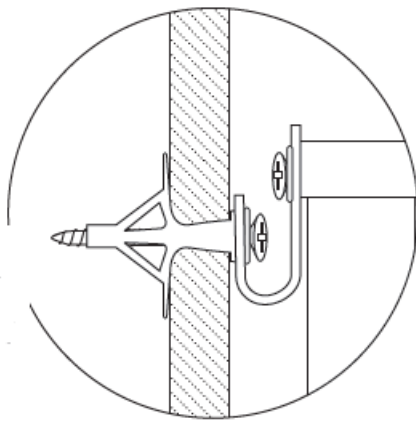

* Drywall or plaster with
available wood stud.

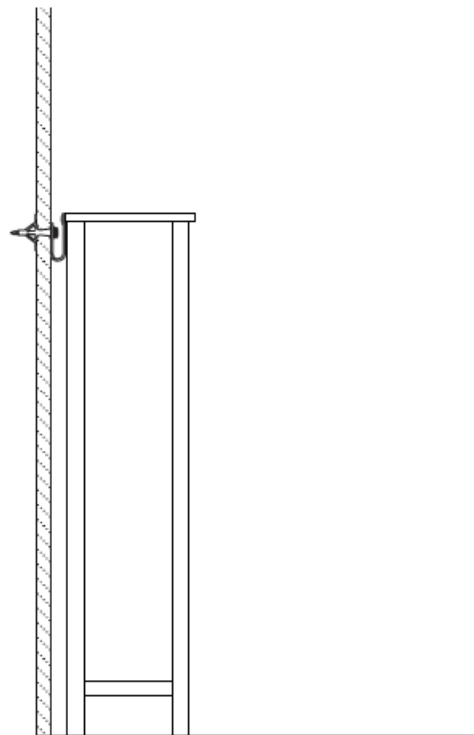
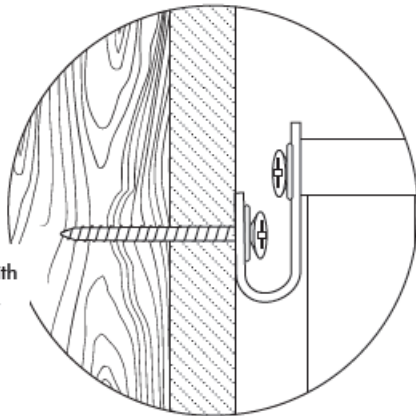

Follow the “Find Your Wall Material” instructions on the previous page. Drill a 3/8” (9 mm) hole and insert plastic anchor into hole (If needed). Fasten strap/bracket by screwing into plastic anchor or wood stud.

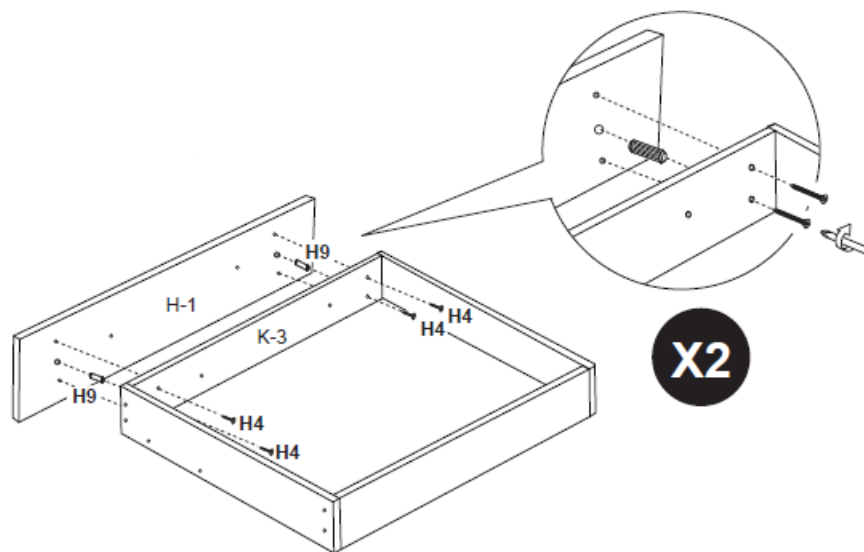
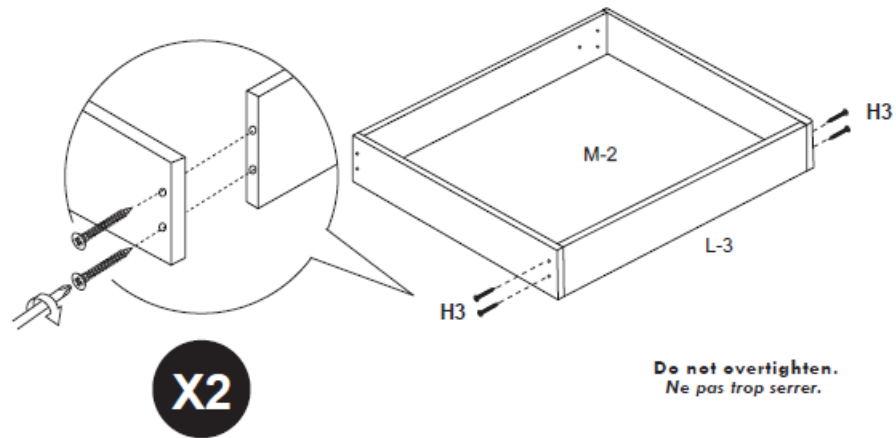

Complete! Drywall without available wood stud.

DRAWER ASSEMBLY INSTRUCTIONS

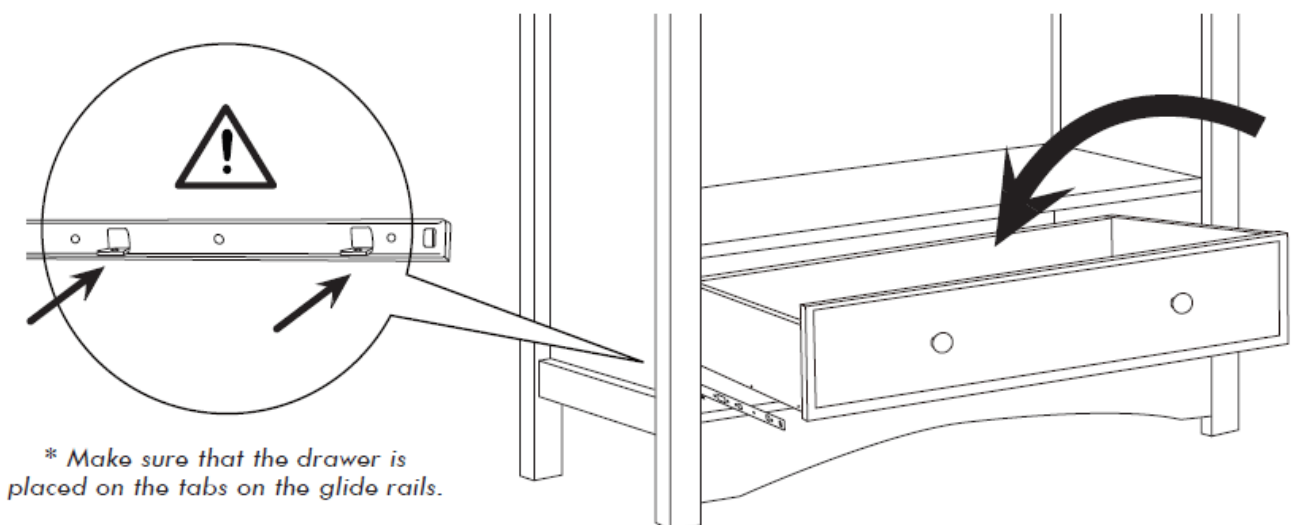

Do not overtighten. Ne pas trop serrer.

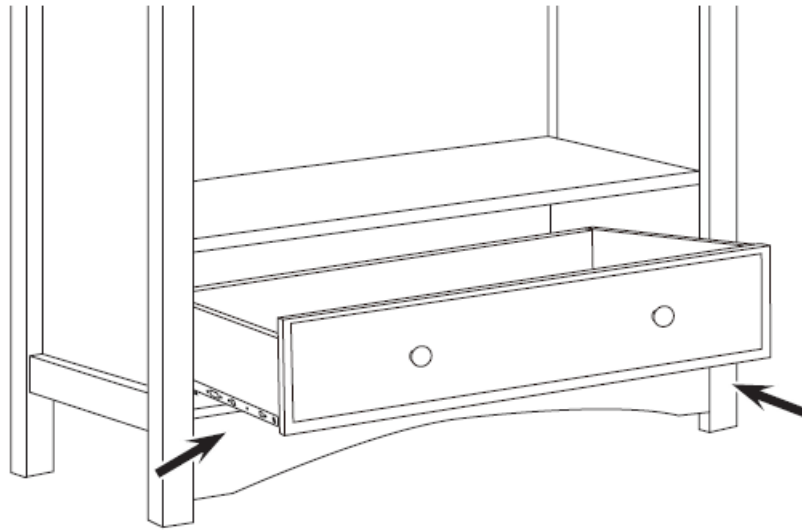

Make sure that the drawer is placed on the tabs on the glide rails. Screw the 7/16" wood screw (H5) in the pre-drilled holes on the drawer side panels. Make sure that the glide touch the drawer front panel.

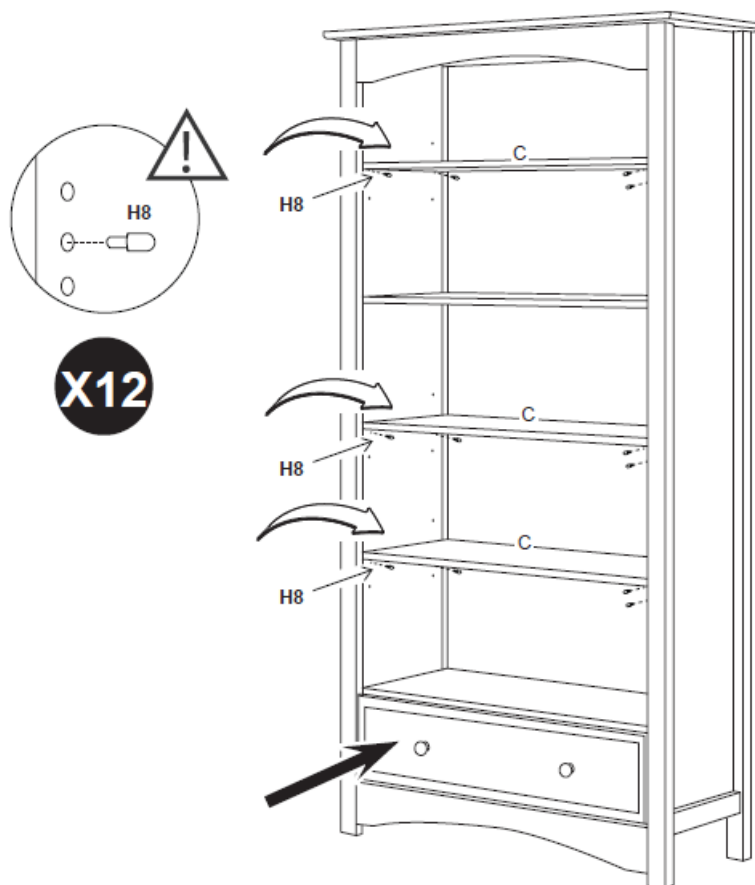

Weight Limit: 82.5 lbs per shelf.

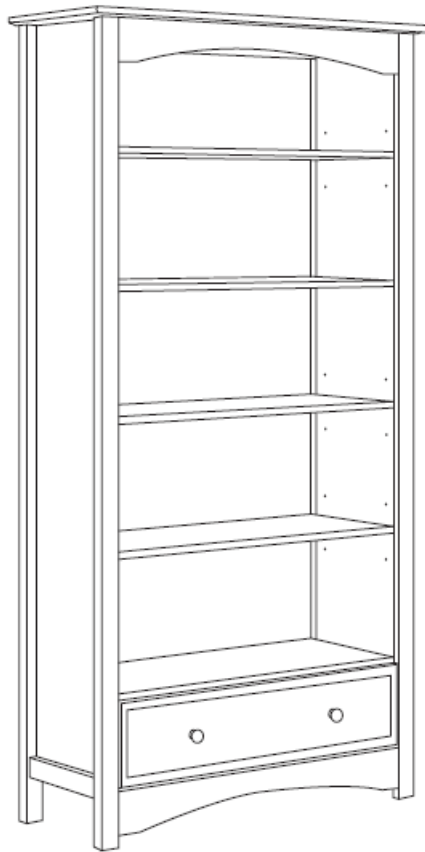

READ ALL INSTRUCTIONS BEFORE USING THE PRODUCT. KEEP THE INSTRUCTIONS FOR FUTURE USE
KEEP THIS MANUAL IN A SAFE PLACE FOR FUTURE REFERENCE.

IMPORTANT:

As with all infant and baby furniture, it is important to check fasteners, screws, and bolts periodically for tightness. Parents should ensure a safe environment for their children by checking the furniture regularly before placing a child in the product.

ONE YEAR LIMITED WARRANTY:

We will replace any missing parts at the time of purchase or any defective item within a one year period from the date of original purchase. Please keep your receipt so that we may process your warranty request. This warranty only covers new units with original packaging and ownership, and is not transferable. It does not cover any used, secondhand or demo models. This warranty does not cover any damaged or defective parts that result from installation and assembly, normal wear and tear, abuse, negligence, improper use or alteration to the finish, design, and hardware. The specific legal rights of this warranty may vary from state to state. Some states do not allow any exclusion or limitation of incidental damages. Some states do not allow limitation on how long an implied warranty lasts.

Storage:

- Pine woods exchange moisture with the air adjusting to major changes in room temperature and humidity. Therefore, it is best to place your furniture away from heating or air-conditioning vents.
- Sunlight is not friendly to solid wood furniture and prolonged direct exposure to harsh sunlight can discolor the finish. Be careful not to place your furniture in direct sunlight for extended periods of time. As with all your fine furniture, blot up spills immediately.

Care and Cleaning:

- Do not scratch or chip the finish. Do not use abrasive chemicals for cleaning. Clean with mild soap on a damp, soft rag. Rinse and dry thoroughly. If you ever refinish this furniture, be sure to use only a non-toxic finish specified for children's products. If you choose to refinish this furniture, the warranty will be voided.

Documents / Resources

	<p>DAVINCI M5926 MDB Bookcase in Espresso [pdf] Instruction Manual</p> <p>M5926 MDB Bookcase in Espresso, M5926, MDB Bookcase in Espresso, Bookcase in Espresso, Espresso</p>
---	---

References

- [📄 DaVinci Baby | Cribs, Classic Nursery Furniture](#)
- [📄 Replacement Parts – DaVinci Baby](#)
- [📄 Registrations – DaVinci Baby](#)