



datanet Barcode Manager Mobile Application User Guide

[Home](#) » [datanet](#) » datanet Barcode Manager Mobile Application User Guide 

datanet Barcode Manager Mobile Application



No part of this document may be reproduced or used in any form, or by any electrical or mechanical means, without permission in writing from Dataset Asia Pacific Pty Ltd. T/A Dataset. This includes electronic or mechanical means, such as photocopying, recording, or information storage and retrieval systems. The material in this document is subject to change without notice.

Dataset does not assume any product liability arising out of, or in connection with, the application or use of any product, circuit, or application described herein. No license is granted, either expressly or by implication, or otherwise under any Dataset Asia Pacific Pty Ltd. T/A Dataset, intellectual property rights. An implied license only exists for equipment, circuits, and subsystems contained in Dataset products.

Product names mentioned in this document may be trademarks or registered trademarks of their respective companies and are hereby acknowledged.

Contents

- 1 Introduction
- 2 Opening the App for the First Time
- 3 Barcode Compare Function
 - 3.1 Barcode Compare – Do Not Send Data
 - 3.2 Barcode Compare – Send Data
- 4 Barcode List Function
 - 4.1 Barcode List – Do Not Send Data
 - 4.2 Barcode List – Send Data
- 5 Sending Data in an Email
 - 5.1 SMTP Settings Screen
- 6 Settings File and Backup Data on the Computer
 - 6.1 Accessing Internal Storage
 - 6.2 Recovering Emails & Barcode Compare Log
 - 6.3 Copy Current App Settings
- 7 CUSTOMER SUPPORT
- 8 Documents / Resources
- 9 Related Posts

Introduction

The Barcode Manager™ mobile application has been developed to provide two distinct functions.

The Barcode Compare function allows a user to scan two barcodes in sequence and determine if they both match.

The Barcode List function allows a user to scan multiple barcodes and record the scans in either a .CSV or .TXT file.

Opening the App for the First Time

Locate the Barcode Manager logo (figure 2.0.0) and then open the application.



Figure 2.0.0

When the application is opened for the first time a popup will appear on the screen asking for permission to allow access to photos, media, and files on the device (Figure 2.0.1). For the application to work it must be granted this permission, if the user selects Deny the application will close and will need to be reopened and Allow will then have to be selected.

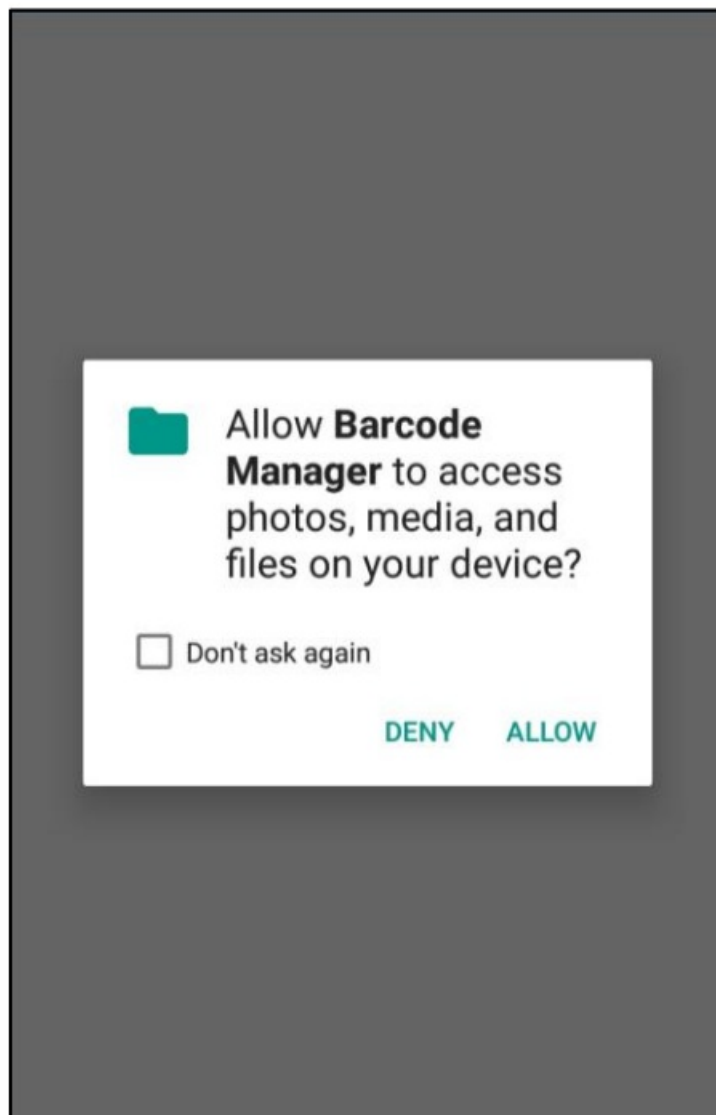

Figure 2.0.1

Barcode Compare Function

Barcode Compare – Do Not Send Data

To select the Barcode Compare Function (this may already be selected by default upon opening the application) click on the settings icon in the top right of the screen. The settings screen has two tabs- the App Settings tab and the SMTP Settings tab, On the App Settings Screen under the sub heading Application mode (figure 3.1.1) are two sliders- Barcode Compare and Barcode List, when one is turned on the other will automatically be turned off.

APP SETTINGS

SMTP SETTINGS

DEVICE ID

LOCATION

APPLICATION MODE

Barcode Compare

i

Barcode List

i

Allow Duplicates

Include header row in file

Figure 3.1.1

When Barcode Compare is turned on multiple settings will be greyed out (figure 3.1.2) and can be ignored until using the Barcode List function, scroll to the bottom of the settings and select the SAVE button. A popup will appear asking if “you are sure you wish to save your changes?” select OK. Settings will not change until they have been saved.

APP SETTINGS

SMTP SETTINGS

FILE NAME

Base File Name

Variable1

Variable2

Variable3

EXIT APP

CANCEL



SAVE

Barcode Manager Version 2.0.1

By Datanet Asia Pacific Pty Ltd

Figure 3.1.2

To use the Barcode Compare function, first scan a barcode and the barcode will populate in the first slot in the results table (figure 3.1.3).

Barcode Compare

SCAN BARCODE

HW10505

RESULTS

1	HW10505
2	

CLEAR

Barcode Manager Version 2.0.1
By Datanet Asia Pacific Pty Ltd

Figure 3.1.3

Once a second barcode is scanned its barcode will momentarily appear in the second slot in the results table before the screen is cleared and a dropdown will appear alerting you as to whether the barcodes matched (figure 3.1.4 & figure 3.1.5).

**NOTICE**
Barcodes Match!

SCAN BARCODE

RESULTS

1

2

CLEAR

Barcode Manager Version 2.0.1
By Datanet Asia Pacific Pty Ltd

Figure 3.1.4

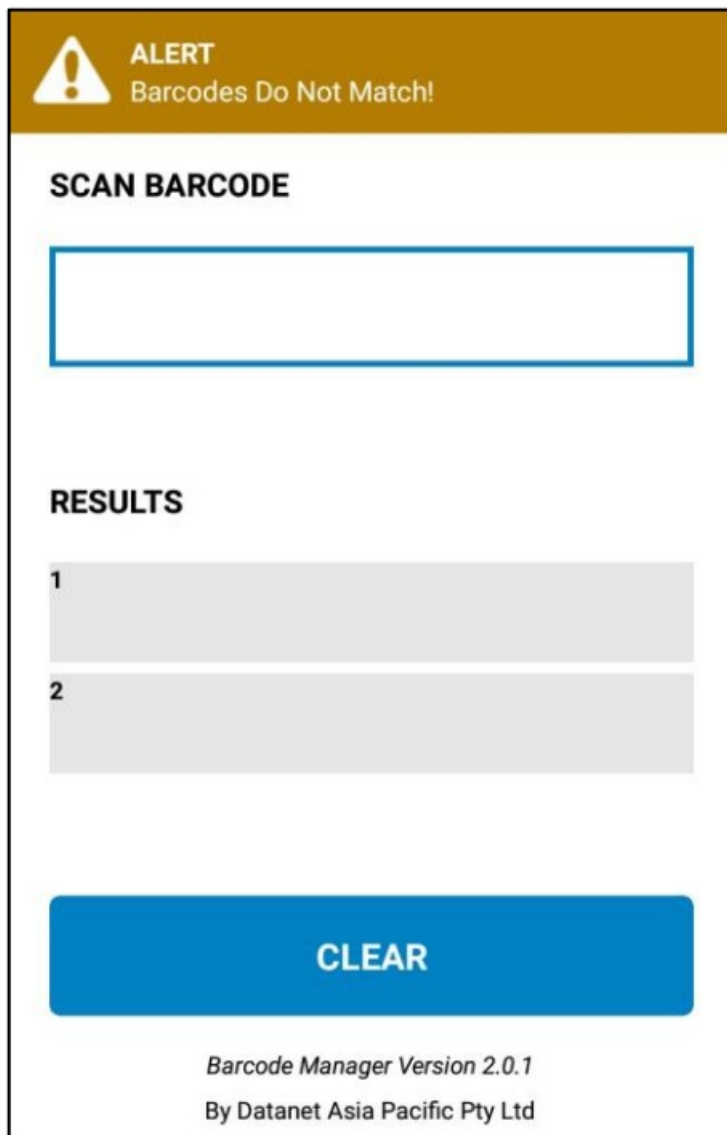

The image shows a mobile application screen with a yellow header bar. On the left of the header is a white triangle containing a black exclamation mark. To its right, the text 'ALERT' is in bold, and 'Barcodes Do Not Match!' is in a smaller font. Below the header, the screen has a white background. At the top of this section is the title 'SCAN BARCODE' in bold. Underneath is a large, empty rectangular box with a blue border. Further down is the title 'RESULTS' in bold. Below this are two rows, each consisting of a small number (1 and 2) followed by a wide, light gray rectangular area. At the bottom of the screen is a large blue button with the word 'CLEAR' in white. Below the button, the text 'Barcode Manager Version 2.0.1' and 'By Datanet Asia Pacific Pty Ltd' is displayed in a small font.

ALERT
Barcodes Do Not Match!

SCAN BARCODE

RESULTS

1

2

CLEAR

Barcode Manager Version 2.0.1
By Datanet Asia Pacific Pty Ltd

Figure 3.1.5

Barcode Compare – Send Data

To send data with Barcode Manager the SMTP settings will have to be set up – Section 5.1 – SMTP Settings.

To select the Barcode Compare Function (this may already be selected by default upon opening the application) click on the settings icon in the top right of the screen. The settings screen has two tabs- the App Settings tab and the SMTP Settings tab, On the App Settings Screen are the settings Device ID and Location (figure 3.2.0) which are optional extra pieces of data that tell the email recipient what device and location the scanning was done on, these can be put in the subject line or email body.

Under the sub heading Application mode (figure 3.2.0) are two sliders- Barcode Compare and Barcode List, when one is turned on the other will automatically be turned off.

APP SETTINGS

SMTP SETTINGS

DEVICE ID

TestDevice

LOCATION

TestLocation

APPLICATION MODE

Barcode Compare

☒

i

Barcode List

☐

i

Allow Duplicates



☐

Include header row in file

Figure 3.2.0

When Barcode Compare is turned on multiple settings will be greyed out and can be ignored until using the Barcode List function, scroll to the bottom of the settings and select the SAVE button. A popup will appear asking if “you are sure you wish to save your changes?” select OK. Settings will not change until they have been saved.

To use the Barcode Compare function, first scan a barcode and the barcode will populate in the first slot in the results table (figure 3.2.1). Once a second barcode is scanned its barcode will momentarily appear in the second slot in the results table before the screen is cleared and a dropdown will appear alerting you as to whether the barcodes matched (figure 3.2.2 & figure 3.2.3).

**Barcode Compare**

SCAN BARCODE

RESULTS

1

HW10505

2

CLEAR

Barcode Manager Version 2.0.1
By Datanet Asia Pacific Pty Ltd

Figure 3.2.1

**NOTICE**
Barcodes Match!

SCAN BARCODE

RESULTS

1

2

CLEAR

Barcode Manager Version 2.0.1
By Datanet Asia Pacific Pty Ltd

Figure 3.2.2

**ALERT**
Barcodes Do Not Match!

SCAN BARCODE

RESULTS

1

2

CLEAR

Barcode Manager Version 2.0.1
By Datanet Asia Pacific Pty Ltd

Figure 3.2.3

To send an email for Barcode Compare, select the icon in the top left of the screen when on the main Barcode Compare screen.

In the Send Log History screen (figure 3.2.4) the first field will be the Recipient field. If you made a default recipient this will already be filled out. If not, a recipient will need to be entered.

Send Log History

RECIPIENT

DATA TO SEND

FROM

TO

SEND ALL DATA

☒

BACK

SEND

DELETE LOG HISTORY

Barcode Manager Version 2.0.1

By Datanet Asia Pacific Pty Ltd

Figure 3.2.4

Data To Send shows the range of data that will be included in the file from a date to a date. By default it will be the current day. If Send All Data is checked, all the scanned data will be included in the file since the last deletion of log history.

To go back to the main Barcode Compare screen press the Back button, to send the email press the Send button. To delete the log history press the Delete Log History button. When the Send button is pressed a notice will come up saying if it sent successfully or if there was an issue sending.

Barcode List Function

Barcode List – Do Not Send Data

To select the Barcode List Function click on the settings icon in the top right of the screen. The settings screen has two tabs- the App Settings tab and the SMTP Settings tab. On the App Settings Screen under the sub heading Application mode (figure 4.1.0) are two sliders- Barcode Compare and Barcode List, when one is turned on the other will automatically be turned off.

APP SETTINGS

SMTP SETTINGS

DEVICE ID

LOCATION

APPLICATION MODE

Barcode Compare

i

Barcode List

i

Allow Duplicates

Include header row in file

Figure 4.1.0

Once Barcode List has been turned on, select the “Allow Duplicates” checkbox if you would like to scan barcodes multiple times. Scroll to the bottom of the settings and select the SAVE button (figure 4.1.1). A popup will appear asking if “you are sure you wish to save your changes?” select OK. Settings will not change until they have been saved.

APP SETTINGS

SMTP SETTINGS

FILE NAME

Base File Name

Variable1

None

Variable2

None

Variable3

None

EXIT APP

CANCEL

SAVE

Barcode Manager Version 2.0.1

By Datanet Asia Pacific Pty Ltd

Figure 4.1.1

To use the Barcode List function, scan the barcodes you will want to appear in the results table (figure 4.1.2). If you have not allowed for duplicate barcodes and one is scanned, you will receive an alert letting you know that the barcode has already been scanned in this session.



Barcode List

SCAN BARCODE

HW10507

RESULTS

HW10507
HW10505
HW10506
HW10504
HW10503
HW10502

Barcode Manager Version 2.0.1
By Datanet Asia Pacific Pty Ltd

Figure 4.1.2

If a barcode has been scanned by mistake and needs deleting from the table, tap the code in the table and once it is highlighted orange tap it again and a prompt will appear asking if you would like to remove the barcode from the table. Clicking “YES” will remove it from the table (figure 4.1.3).

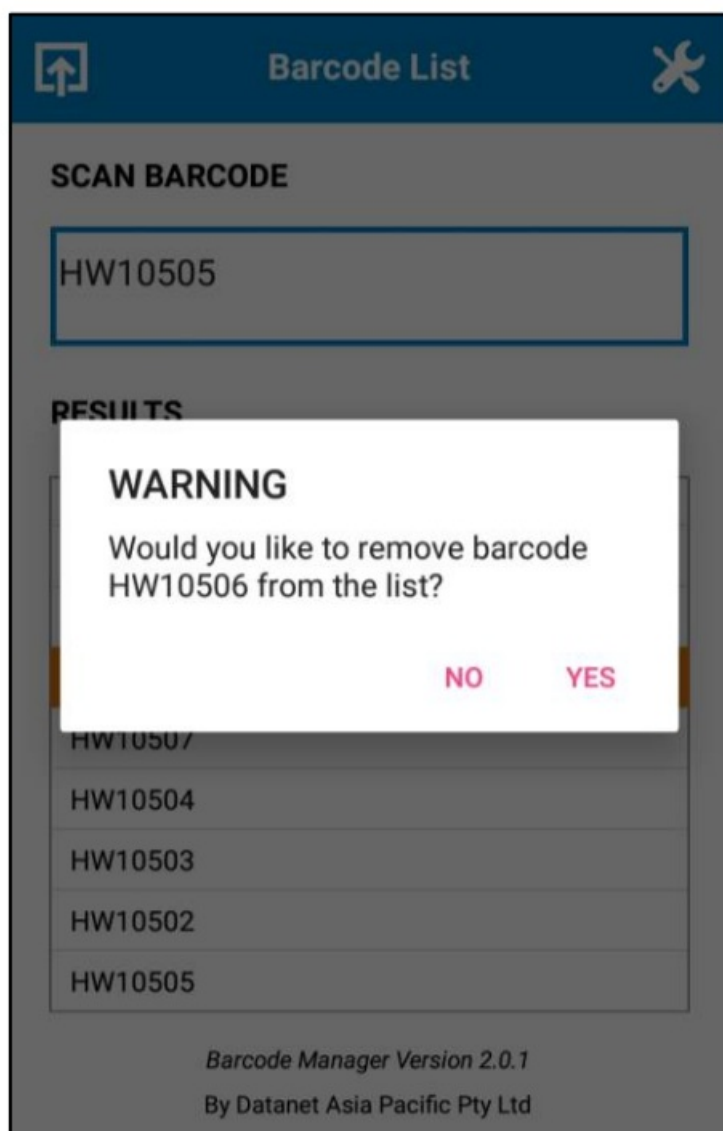

Figure 4.1.3

Note: if you have allowed duplicate barcodes, scanned duplicates and then turn off duplicate's barcodes; the duplicates you have already scanned will still appear in the table, but you will not be able to scan more duplicates until they are allowed again.

Barcode List – Send Data

To send data with Barcode Manager the SMTP settings will have to be set up – Section 5.1 – SMTP Settings.

To select the Barcode List Function click on the settings icon in the top right of the screen. The settings screen has two tabs- the App Settings tab and the SMTP Settings tab. On the App Settings Screen are the settings Device ID and Location which are optional extra pieces of data that tell the email recipient what device and location the scanning was done on, these can be put in the subject line or email body. Under the sub heading Application mode (figure 4.2.0) are two sliders- Barcode Compare and Barcode List, when one is turned on the other will automatically be turned off.

APP SETTINGS

SMTP SETTINGS

DEVICE ID

LOCATION

APPLICATION MODE

Barcode Compare

☐

i

Barcode List

☒

i

Allow Duplicates

☐

Include header row in file

Figure 4.2.0

Once Barcode List has been turned on, select the “Allow Duplicates” checkbox if you would like to scan barcodes multiple times. Include header row in file setting allows users to type in text that will appear as a header in the CSV or TXT file. If left blank, there will not be a header in the file (figure 4.2.1).

APP SETTINGS		SMTP SETTINGS	
Barcode List	<input checked="" type="checkbox"/>		
Allow Duplicates	<input type="checkbox"/>		
Include header row in file	<input type="text"/>		
File Type	<input type="text" value="CSV"/>		
FILE NAME			
Base File Name	<input type="text"/>		
Variable1	<input type="text" value="Location"/>		
Variable2	<input type="text" value="Device ID"/>		
Variable3	<input type="text" value="Date"/>		

Figure 4.2.1

If a barcode has been scanned by mistake and needs deleting from the table, tap the code in the table and once it is highlighted orange tap it again and a prompt will appear asking if you would like to remove the barcode from the table. Clicking “YES” will remove it from the table (figure 4.2.3).

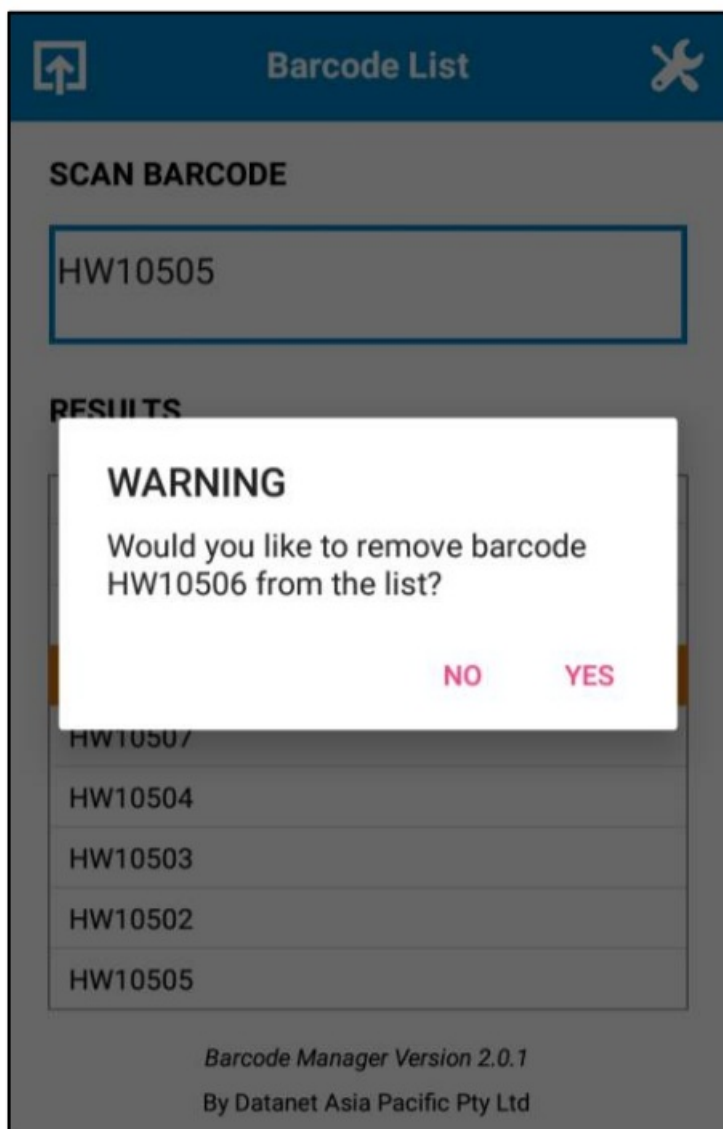



Figure 4.2.3

File type allows you to switch between CSV and TXT format for the file attached in the email. Base File Name lets the user change the name of the file attached in the emails.

Variable 1, Variable2 and Variable 3 allow the user to change the file name to contain a choice of 5 different variables, the choices are: None, Device ID, Location, Date and DateTime. Once settings are done select the SAVE button. A popup will appear asking if "you are sure you wish to save your changes?" select OK. Settings will not change until they have been saved.

To use the Barcode List function, scan the barcodes you will want to appear in the results table (figure 4.2.2). If you have not allowed for duplicate barcodes and one is scanned, you will receive an alert letting you know that the barcode has already been scanned in this session.

Barcode List

SCAN BARCODE

HW10507

RESULTS

HW10507
HW10505
HW10506
HW10504
HW10503
HW10502

Barcode Manager Version 2.0.1
By Datanet Asia Pacific Pty Ltd

Figure 4.2.2

Note: if you have allowed duplicate barcodes, scanned duplicates and then turn off duplicate's barcodes; the duplicates you have already scanned will still appear in the table, but you will not be able to scan more duplicates until they are allowed again

To send an email for Barcode List, select the icon in the top left of the screen when on the main Barcode List screen.

In the Send List screen (figure 4.2.4) the first field will be the Recipient field. If you made a default recipient this will already be filled out. If not, a recipient will need to be entered.

Send List

RECIPIENT

FILE PREVIEW

TestLocation_TestDevice_2022-05-02.csv

HW10506

HW10507

HW10503

HW10505

HW10505

HW10503

BACK

SEND

CLEAR SCAN HISTORY

Figure 4.2.4

File Preview shows a preview of the name of the file that will be attached to the email. This name will depend on the various file name settings that can be configured.

There is a list of all the barcodes that have been scanned, from this screen barcodes cannot be removed, that is only possible from the main screen.

To go back to the main Barcode List screen press the Back button, to send the email press the Send button. To clear the scan history press the Clear Scan History button. When the Send button is pressed a notice will come up saying if it sent successfully or if there was an issue sending.

Sending Data in an Email

SMTP Settings Screen

Sending an email with the Barcode Manager application is entirely optional for both Barcode Compare and Barcode List. To send an email through the application the SMTP Settings will need to be configured. The SMTP

Settings are accessed by first going into the settings screen and into the SMTP Settings tab. The following settings are required to send emails: SMTP Server, Sender, Port and SSL/TLS.

The Default Recipient field will autofill the recipient field when sending from either application mode (figure 5.1.0).

APP SETTINGS **SMTP SETTINGS**

DEFAULT RECIPIENT

PORT **SSL/TLS**

587 ☒

Include Device ID **Don't Include**

Include Location **Don't Include**

Include Date and Time **Don't Include**

DEFAULT SUBJECT LINE

Figure 5.1.0

The settings: Include Device ID, Include Location, Include Date and Time give the option to include their data in either the emails subject line or email body. The Device ID and Location are optional extra pieces of data that tell the email recipient what device and location the scanning was done on. Device ID and Location are found in the App Settings tab in the settings screen. Default Subject Line and Default Email Body allows you to enter any text you would like to appear in the subject line and email body of the email.

The Test Email button allows you to test whether or not email sending works with the currently configured settings. An alert will let you know if the test email successfully sent, and the default recipient will receive the email. The test email will also show how the Default Subject Line and Default Email Body look (figure 5.1.1).

When exiting the SMTP Settings screen the Save button must be pressed and confirmed or the configurations won't save (figure 5.1.1).

The screenshot displays the 'Barcode Manager' settings interface. At the top, a green notification banner with a white checkmark icon states 'NOTICE Test email successfully sent to'. Below this, there are two radio button options: 'Include Date and Time' (which is selected) and 'Don't Include'. The next section is 'DEFAULT SUBJECT LINE', followed by a text input field. Below that is the 'DEFAULT EMAIL BODY' section with another text input field. At the bottom of the form are three large blue buttons: 'TEST EMAIL', 'CANCEL', and 'SAVE'. The footer of the screen contains the text 'Barcode Manager Version 2.0.1' and 'By Datanet Asia Pacific Pty Ltd'.

Figure 5.1.1

Settings File and Backup Data on the Computer

Accessing Internal Storage

There are three uses for accessing the internal storage of the device in regard to Barcode Manager. They are recovering previously sent emails, a log of Barcode Compare and copying the current settings configuration.

On a Zebra android device, connect the device to the computer, swipe down on the device, select Android System, when pressed it will say "USB for file transfer" and "Tap for more options", when pressed there will be an option to transfer files (figure 6.1.0), this will enable the computer to open the devices files. When this option is selected a new folder will open on the computer with the name of the device. There will be a sub folder named "Internal Shared Storage" (figure 6.1.1). Once in this subfolder the files on the device will be visible. The folder "BarcodeManager" is what you will want to access.

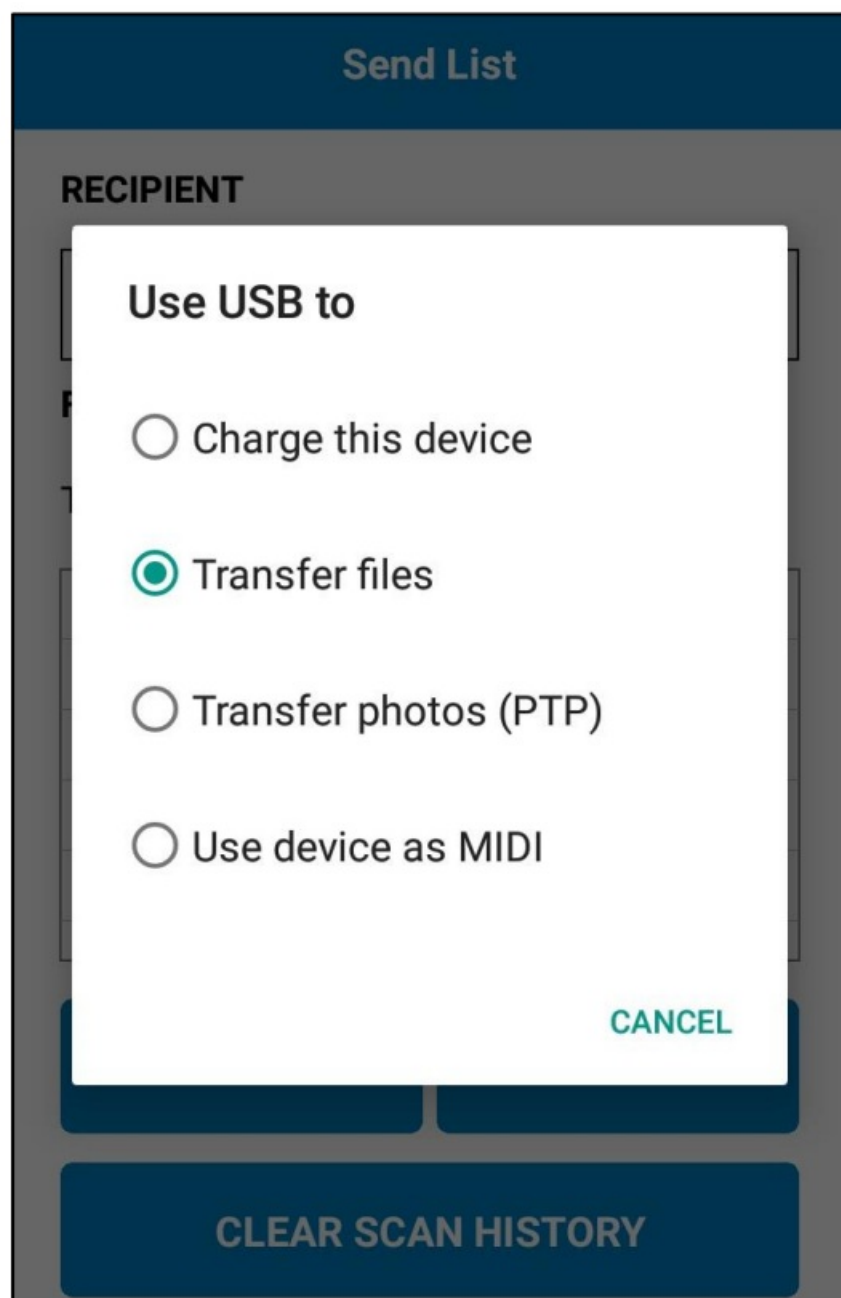

Figure 6.1.0

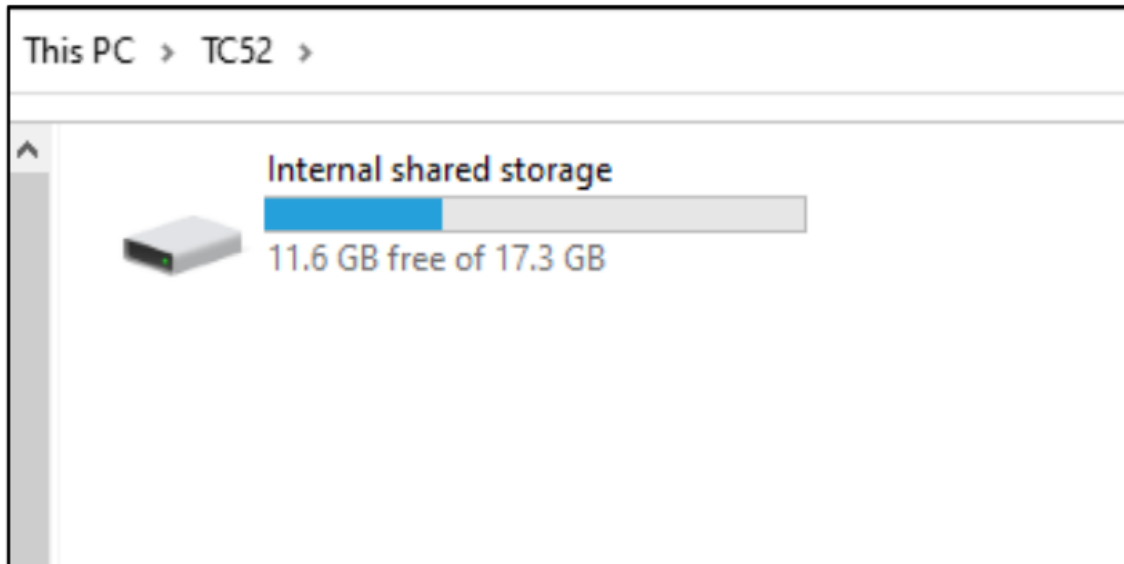

Figure 6.1.1

Recovering Emails & Barcode Compare Log

In the Barcode Manager folder is a subfolder named “Send Archive”. Contained in this folder is every CSV or TXT file attached in the emails that have been sent from the device.

In the Barcode Manager folder is a CSV file named “Scandata _Log”. This CSV file contains the log data for the Barcode Compare application.

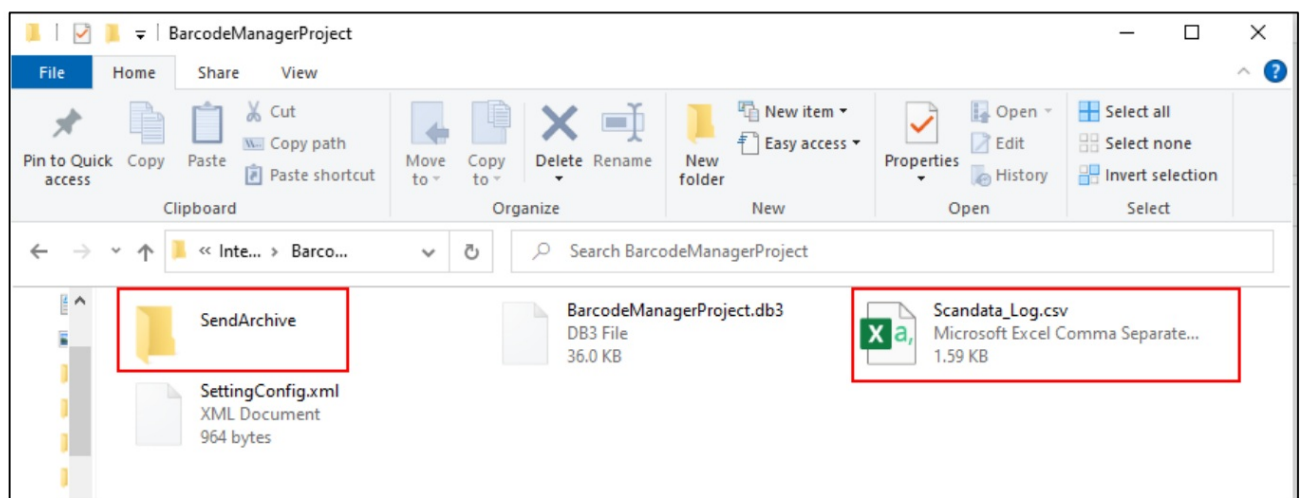

Figure 6.2.0

Copy Current App Settings

If you have many devices that will be using the Barcode Manager app, you may only want to configure the settings once and copy it to the rest of the devices.

NOTE: This can only be done on devices that have had no settings saved already on the device. If a device has settings already saved and then given a new “SettingConfig.xml” file, nothing will happen. The already configured settings on the device will overwrite the new config file.

This can be done by copying the “SettingConfig.xml” file in the “Barcode Manager” folder and pasting the file somewhere safe on your computer. Once the file is copied and stored you can unplug the device and plug in a new device. The new device will have to have opened the app at least once, so the “Barcode Manager” folder is created. Follow the instructions in 6.1 Accessing Internal Storage and then paste the “SettingConfig.xml” file in the “Barcode Manager” folder. The next time the application is opened the settings will be updated to the configuration in the backed-up file.

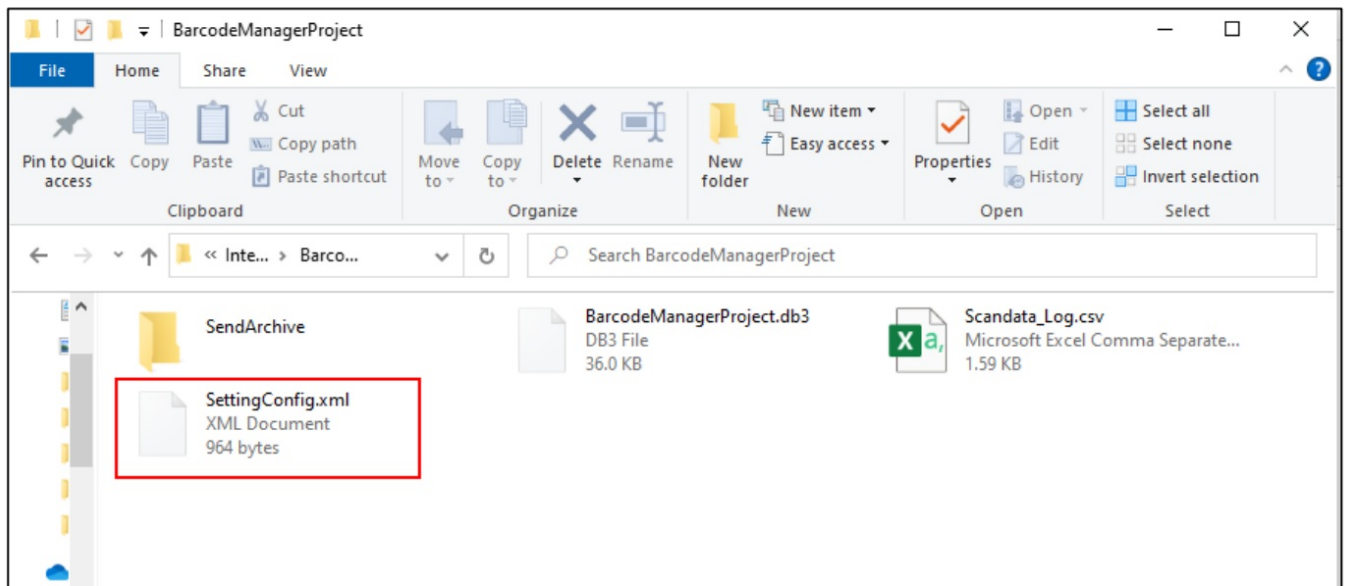

Figure 6.3.0

CUSTOMER SUPPORT

Weslern Australia
28 Stiles Av
Burswood, WA6100

South Australia
96 Gilbert St
Adelaide, SA 5000

New South wales
2.11/32 Delhi Road
North Ryde, NSW 2113

1300 328263
www.datanet.com.au

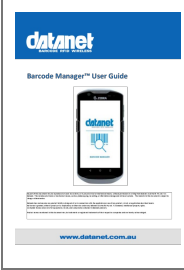

	<p>datanet Barcode Manager Mobile Application [pdf] User Guide</p> <p>Barcode Manager Mobile Application, Manager Mobile Application, Mobile Application, Application</p>
--	--