



Dash DEC005 RAPID EGG COOKER USER MANUAL

[Home](#) » [Dash](#) » Dash DEC005 RAPID EGG COOKER USER MANUAL 

Contents

- 1 Dash DEC005 RAPID EGG COOKER
- 2 IMPORTANT SAFEGUARDS
- 3 PARTS & FEATURES
- 4 USING YOUR rapid EGG COOKER
- 5 Boiling Eggs
- 6 POACHING EGGS
- 7 USING the omelette bowl
- 8 CLEANING & MAINTENANCE
- 9 TROUBLESHOOTING
- 10 RECIPE guide
 - 10.1 Deviled EGGS
 - 10.2 EGGS BENEDICT
 - 10.3 Egg SALAD
 - 10.4 Tomato & spinach FRITTATA
- 11 STOREBOUND, LLC – 1 YEAR LIMITED WARRANTY
- 12 TECHNICAL SPECIFICATIONS
- 13 Faqs
- 14 Related Posts



Dash DEC005 RAPID EGG COOKER



IMPORTANT SAFEGUARDS

**IMPORTANT SAFEGUARDS: PLEASE
READ AND SAVE THIS INSTRUCTION AND CARE MANUAL.**

When using electrical appliances, basic safety precautions should be followed, including:

- Please read and save instruction and care manual.
- Read all instructions carefully.
- Remove all packaging and labels from appliance prior to use.
- Never leave appliance unattended when in use.
- Make sure the appliance is cleaned thoroughly before using.
- Do not use appliance for other than its intended use. For household use only. Do not use outdoors.
- Do not operate this appliance with a damaged cord, damaged plug, after the appliance malfunctions, is dropped, or damaged in any manner. Return appliance to the nearest authorized service facility for examination, repair, or adjustment.
- For maintenance other than cleaning, please contact StoreBound directly at 1- 800-898-6970 from 7AM-7PM PST Monday-Friday or by email at support@storebound.com.
- Only use approved ingredients with this appliance. Other ingredients may damage the appliance.
- This appliance is not intended for use by persons (including children) with reduced physical, sensory, or mental capabilities, or lack of experience and knowledge unless they are provided with supervision and instruction concerning use of the appliance by a person responsible for their safety.
- Always be sure to unplug the appliance from outlet prior to moving, cleaning, storage, and when not in use.
- Refrain from using attachments that are not recommended by the appliance manufacturer, as this may result in fire, electric shock, or personal injury.
- Do not let the power cord touch hot surfaces or hang over the edges of tables or counters.
- Unplug the appliance from power outlet and allow to cool when not in use, during assembly/disassembly, and before cleaning the Rapid Egg Cooker.
- When cleaning the Body of the appliance, do not submerge in water or other liquids. The Rapid Egg Cooker is NOT dishwasher safe.

- Do not place this appliance on or near a hot gas burner, hot electric burner, or in a heated oven.
- Do not put your hands or other foreign objects into the Rapid Egg Cooker while it is operating. If food spills onto the Heating Plate, make sure the Rapid Egg Cooker is turned off and cooled before cleaning.
- DO NOT place the Lid in the locked position while using the Rapid Egg Cooker as this will increase the risk of injury when removing the Lid once eggs have cooked.
- **WARNING!** Hot steam! Never place your hands or arms over the Steam Hole while the appliance is in use.
- Keep hands and utensils away from Heating Plate while cooking eggs to reduce the risk of injury or damage to the Rapid Egg Cooker.
- Internal base and contents (water and eggs) of Rapid Egg Cooker are hot when in use. Let cool before handling and/or cleaning.
- Do not touch the Heating Plate when the Rapid Egg Cooker is hot. Use the handles.
- If using a longer power-supply cord or extension cord, make sure that the electrical rating of the wire is compatible with the appliance. If the appliance is of the grounded type, the extension cord should be a grounding-type 3-wire cord.
- Use extreme caution when handling the Measuring Cup as it contains a sharp Pin on the bottom of the cup which may cause injury.
- **Warning!** The Lid becomes hot. When eggs are done, carefully remove the Lid by the Cover Handle. Allow the Lid to cool completely before touching or cleaning.
- NEVER place the Poaching Tray or Omelette Bowl directly on the Heating Plate.
Always place on top of the Boiling Tray.
- Make sure the Rapid Egg Cooker is off before removing the eggs.
- A short power cord should be used to reduce the risk of tripping and entanglement.
- This appliance has a polarized plug (one blade is wider than the other). To reduce the risk of electric shock, this plug will fit in a polarized outlet only one way. If the plug does not completely fit in the outlet, reverse the plug. If it still does not fit, contact a qualified electrician. Do not attempt to modify the plug in any way.

PARTS & FEATURES



USING YOUR rapid EGG COOKER

SOFT, MEDIUM, AND HARD-BOILED EGGS:

The times listed below are guidelines so that you will know how long it will take to cook your eggs. The thermostat in the Rapid Egg Cooker will shut off automatically when the eggs are done – no additional timer is necessary. The following time guidelines are for medium to large eggs. Extra large or jumbo eggs may require additional time/water in the appliance to achieve the desired results.

If you like medium eggs firm: let the eggs sit covered in the Rapid Egg Cooker for a few extra minutes before removing them.

If you like completely hard-boiled eggs: let the eggs sit for an extra minute in the Rapid Egg Cooker after the buzzer sounds.

Soft BOILED		Medium BOILED		Hard BOILED	
1-3 eggs	7 minutes	1-3 eggs	9 minutes	1-3 eggs	12 minutes
4-6 eggs	10 minutes	4-6 eggs	12 minutes	4-6 eggs	16 minutes

TIP: If you live at a higher altitude, add up to 25% more water to your Egg Cooker to ensure best results!

Timer Auto-Off

This Rapid Egg Cooker is equipped with a precision thermal sensor and will turn off automatically when the water has fully evaporated from the Heating Plate and when the buzzer sounds.

ATTENTION: Do not unplug the unit while cooking. If you unplug the unit while cooking, it will still be turned on when you plug it back in. If the unit does not detect water on the Heating Plate, it will automatically shut off and reset itself in a few seconds.

Boiling Eggs



1. Make sure the Rapid Egg Cooker is unplugged before starting. Pierce the larger end of each egg with the attached Pin at the bottom of the Measuring Cup (photo A).
2. Use the Measuring Cup to pour the appropriate corresponding amount of cold water into the Heating Plate (photo B).
3. Attach the Boiling Tray Handle to the Boiling Tray (photo C), and place the Boiling Tray on the Heating Plate. Place an egg in each designated spot in the Boiling Tray. Make sure that the holes in the larger end of the eggs are pointed upwards.

WARNING: Do not lock the Lid when using your Rapid Egg Cooker as this may cause injury when removing the Lid once the buzzer sounds.



4. Cover with the Lid and plug in the Rapid Egg Cooker. Press the Power Button to start cooking (photo D). The

Indicator Light will turn on.

- When the eggs are finished cooking (photo E), a buzzer will sound. Press the power switch to silence the buzzer. Actual cooking time will depend on number of eggs and desired style. Uncover Lid by using the Lid Handle and remove eggs with heat-resistant tongs. Do not touch the parts with bare hands as they will be hot!
- Press the Power Button to silence the buzzer and remove your eggs (photo F).
Be careful when handling eggs. They will be hot!

Soak the eggs in ice water or run them under cold water immediately after removing them from the Rapid Egg Cooker to stop the cooking process, and to make peeling easier.

POACHING EGGS

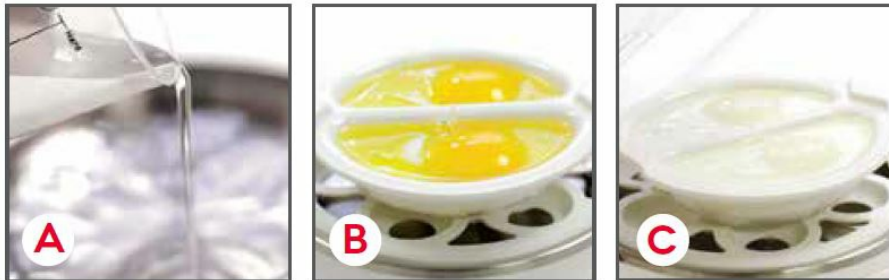

- Fill the Measuring Cup with cold water until it reaches the "Omelette/Poached" marking. Pour the water into the Heating Plate (photo A). Place the Boiling Tray on top of the Heating Plate.
- Use cooking spray to lightly grease the Poaching Tray. Always place the Omelette Bowl or Poaching Tray on top of the Boiling Tray and never directly on the Heating Plate.
- Break an egg into each section of the Poaching Tray (photo B). Cover with the Lid and plug in the Rapid Egg Cooker. Press the Power Button. When the buzzer sounds, your eggs will be ready to eat (photo C)!
WARNING: Do not lock the Lid when using your Rapid Egg Cooker as this may cause injury when removing the Lid once the buzzer sounds.

USING the omelette bowl

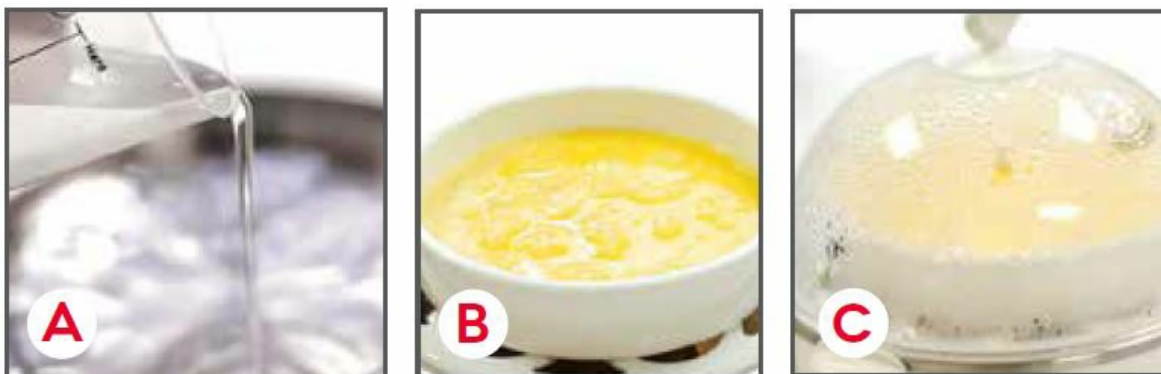

- Fill the Measuring Cup with cold water to the Poached / Omelette Line. Pour cold water onto the Heating Plate (photo A).
- Use cooking spray to lightly grease the Omelette Bowl. Always place the Omelette Bowl on top of the Boiling Tray and never directly on the Heating Plate. Pour your eggs into the Omelette Bowl (photo B).
- Cover with the Lid and plug in the Rapid Egg Cooker. Press the Power Button. When the buzzer sounds, your

eggs will be ready to eat (photo C)! It is normal for the eggs to expand while cooking. They will contract once the Lid has been opened. Remove your omelette with a spatula.

For a drier omelette, leave the eggs in the Rapid Egg Cooker for an extra two minutes.

CLEANING & MAINTENANCE

Cleaning the Heating Plate:

1. Before cleaning or moving the appliance, make sure to unplug the Rapid Egg Cooker.
2. Wash the Rapid Egg Cooker Accessories and Lid with warm, soapy water.
3. Wipe down the Body and Heating Plate with a wet cloth.
4. Dry all parts thoroughly. When storing, place the accessories on the Heating Plate, cover with the Lid, and turn clockwise until the tabs on the Lid slide completely underneath the handles on the base of the Rapid Egg Cooker.

Cleaning the Heating Plate:

Your Rapid Egg Cooker will not rust. Over time, the Rapid Egg Cooker may begin to develop some mineral deposits on the Heating Plate. While this may look like rust, it is merely the residue of natural minerals present in your water.

1. Two different ways to clean the Heating Plate: Clean the Heating Plate with a mild solution of water and vinegar (10 parts water: 1 part vinegar) from time to time.
2. Gently scrub the Heating Plate in a circular motion with a "magic eraser"- type sponge and a little warm water.

CAUTION: During and after use the appliance will be hot.

Do not attempt to clean your Egg Cooker until the appliance has cooled.

Do not submerge the Body in water or other liquids.

The Body of the appliance is NOT dishwasher safe.

TROUBLESHOOTING

Although your Rapid Egg Cooker is simple to use and durable, please refer to the following list if problems occur:

ISSUE	SOLUTION
The Indicator Light does not turn on.	<ol style="list-style-type: none"> 1. Ensure that the power cord is plugged into the power outlet. 2. Check to make sure the power outlet is operating correctly. 3. Press the Power Button (located on the front of your Rapid Egg Cooker). 4. Determine if a power failure has occurred in your home, apartment, or building.
The eggs are over or undercooked.	<ol style="list-style-type: none"> 1. Use the Measuring Cup to determine the appropriate amount of water needed to make your eggs. 2. Observe the recommended cooking times for soft/runny, medium, and hard-boiled eggs. 3. If the eggs are overcooked, make sure to remove the eggs from the Rapid Egg Cooker immediately after the buzzer sounds. 4. Make sure that the Heating Plate, Lid, and Accessories are completely dry before adding the appropriate amount of water to the Heating Plate and cooking the eggs.

RECIPE guide

Follow us @unprocessyourfood for recipes, videos, & daily inspiration

Deviled EGGS

Ingredients:

- 6 hard-boiled eggs, cooled
- 3 tbsp mayonnaise
- 1 tbsp Dijon-style mustard tsp salt paprika, chives, plus dill to garnish

Directions:

1. Peel the eggs and cut in half lengthwise.
2. Remove the yolks, place them in a large bowl, and cream them into a paste with a fork or spoon.
3. Mix in the mayonnaise, mustard, and salt.
4. Spoon or pipe the mixture into the egg white halves.
5. Place the eggs in the refrigerator until they are ready to be served. Just before serving, garnish with a dash of paprika and freshly cut chives or dill.

EGGS BENEDICT

Ingredients:

For Hollandaise Sauce

- 4 eggs
- 3 ½ tbsp lemon juice
- 1 pinch ground white pepper
- 1 cup butter, melted salt, to taste

For Eggs Benedict

- 4 eggs
- ½ bunch asparagus, trimmed and boiled
- 4 strips of Canadian-style bacon
- 2 English muffins, toasted
- 2 tbsp butter, softened chives or cayenne pepper, to garnish

Directions for the hollandaise sauce:

1. On the stovetop, fill the bottom of a double boiler part-way with water.
Make sure that water does not touch the bottom of the bowl. Bring water to a gentle simmer.
2. In the top of the double boiler, whisk together egg yolks, lemon juice, white pepper, Worcestershire sauce, and 1 tablespoon water.
3. Add the melted butter to the egg yolk mixture, 1 tablespoon at a time, while whisking yolks constantly. If the sauce becomes too thick, stir in a little hot water.
4. Add salt and continue whisking until fully incorporated. Remove from heat and cover with a lid to keep the sauce warm.

Directions for the eggs benedict:

1. Fill the Measuring Cup with water to the Omelette/Poached marking. Pour water into the Heating Plate.
2. Place the Boiling Tray, then place the lightly greased Poaching Tray on top.
Break an egg into each poaching section.
3. Replace the Lid and plug in the Express Egg Cooker. Press the Power Lever.
4. When the buzzer sounds, the eggs will be poached. Remove the eggs immediately to prevent overcooking. To make two servings of Eggs Benedict, repeat the poaching process with the other two eggs, starting at Step 1.
5. Butter the toasted English muffin halves.
Place a slice of Canadian-style bacon, a few asparagus spears, a poached egg, and a spoonful of hollandaise sauce on each half.
6. Garnish with chives or cayenne pepper and serve immediately.

Egg SALAD

Ingredients:

- 6 hard-boiled eggs, cooled and peeled
- ½ stalk celery
- 1 / 8 cup mayonnaise
- 2 tbsp Dijon-style mustard
- ¼ tbsp salt
- 1 / 8 tsp black pepper

Directions:

1. Remove shells from fully cooked eggs. Cut the eggs into quarters.
2. Finely dice the eggs and celery and mix together.
3. Add the mayonnaise, mustard, salt, and pepper. Mix until desired texture is reached.
4. Serve on multigrain bread with sliced cucumber.

Tomato & spinach FRITTATA**Ingredients:**

- 2 egg whites
- 1 whole egg
- 2 tbsp spinach, chopped
- 2 tbsp mozzarella
- 2 basil leaves, cut into thin strips
- salt & pepper, to taste
- lettuce & tomato, to garnish

Directions:

1. Fill the Measuring Cup with water to the Omelette / Poached Line and pour onto the Heating Plate.
2. Place the Boiling Tray on the Heating Plate and then sit the lightly greased Omelette Bowl on top.
3. Beat eggs and pour into the Omelette Bowl.
4. Sprinkle the basil, spinach, mozzarella, and tomatoes over the whisked egg.
5. Cover with the Lid and turn on the Rapid Egg Cooker. When buzzer sounds, remove eggs immediately to prevent overcooking.
6. Add salt and pepper to taste.

Chef Tip!

Soak the eggs in ice water or run them under cold water immediately after removing them from the Rapid Egg Cooker to stop the cooking process, and to make peeling easier.

MORE RECIPE IDEAS

RAW BROCCOLI FLORETS	ASPARAGUS, HALVED	SALMON	RAW SHRIMP
			
1 cup	4 stalks	4oz fillet	½ cup

Raw broccoli florets

Pour 1.5 oz of water onto Heating Plate. Cook broccoli in Omelette Bowl 7 minutes until tender.

Asparagus, halved

Pour 1.5 oz of water onto Heating Plate. Spread asparagus in Omelette Bowl & cook 7 minutes.

salmon

Fill Measuring Cup to the top or measure 2.7 oz of water and pour onto Heating Plate. Cook fillet 13 minutes in Omelette Bowl.

Raw shrimp

Fill Measuring Cup to Soft Line and pour onto Heating Plate. Cook shrimp side by side in Omelette Bowl for 5 minutes.

DUMPLINGS	FROZEN EDAMAME	FROZEN CORN
		
4 medium size	½ cup	½ cup

Dumplings

Add 1.75 oz water to Heating Plate. Cook dumplings side by side in Omelette Bowl for 9 minutes.

Frozen edamame

Fill Measuring Cup to Soft Line and pour onto Heating Plate.
Spread edamame in Omelette Bowl & cook 6 minutes.

Frozen corn

Pour 1.5 oz of water onto Heating Plate.
Cook corn 8 minutes in Omelette Bowl.

customer support

feel good guarantee

Dash values quality and workmanship and stands behind this product with our Feel Good Guarantee™. To learn more about our commitment to quality, visit bydash.com/feelgood.

Our US-based customer support team is at your service
Monday – Friday during the times below.
Reach us at 1 (800) 898-6970 or support@bydash.com

Hey Hawaii! You can reach our customer service team from 5AM to 5PM.
And also, Alaska, feel free to reach out from 6AM – 6PM.

STOREBOUND, LLC – 1 YEAR LIMITED WARRANTY

Your StoreBound product is warranted to be free from defects in material and workmanship for a period of one (1) year from the date of the original purchase when utilized for normal and intended household use. Should any defect covered by the terms of the limited warranty be discovered within one (1) year, StoreBound, LLC will repair or replace the defective part. To process a warranty claim, contact Customer Support at 1-800-898-6970 for further assistance and instruction. A Customer Support agent will assist you by troubleshooting minor problems. If troubleshooting fails to fix the problem, a return authorization will be issued. Proof of purchase indicating the date and place of purchase is required and should accompany the return. You must also include your full name, shipping address, and telephone number. We are unable to ship returns to a PO box. StoreBound will not be responsible for delays or unprocessed claims resulting from a purchaser's failure to provide any or all of the necessary information. Freight costs must be prepaid by the purchaser.

Send all inquiries to support@storebound.com.

There are no express warranties except as listed above.

REPAIR OR REPLACEMENT AS PROVIDED UNDER THIS WARRANTY IS THE EXCLUSIVE REMEDY OF THE CUSTOMER. STOREBOUND SHALL NOT BE LIABLE FOR ANY INCIDENTAL OR CONSEQUENTIAL DAMAGES OR FOR BREACH OF ANY EXPRESS OR IMPLIED WARRANTY ON THIS PRODUCT EXCEPT TO THE EXTENT REQUIRED BY APPLICABLE LAW. ANY IMPLIED WARRANTY OF MERCHANTABILITY OR FITNESS FOR A PARTICULAR PURPOSE ON THIS PRODUCT IS LIMITED IN DURATION TO THE DURATION OF THIS WARRANTY.

Some states do not allow the exclusion or limitation of incidental or consequential damages, or limitations on how long an implied warranty lasts. Therefore, the above exclusions or limitations may not apply to you. This warranty gives you specific legal rights and you may also have other rights, which vary from state to state.

REPAIRS

DANGER! Risk of electric shock! The Dash Rapid Egg Cooker is an electrical appliance.
Do not attempt to repair the appliance yourself under any circumstances.
Contact Customer Support regarding repairs to the appliance.

TECHNICAL SPECIFICATIONS

- Voltage 120V ~ 60Hz
- Power Rating 360W
- Stock#: DEC005_20181120_V10

1-800-898-6970
@unprocessyourfood
bydash.com

Faqs

What is the Dash DEC005 Rapid Egg Cooker?

The Dash DEC005 Rapid Egg Cooker is a kitchen appliance designed to cook eggs quickly and conveniently. It can cook various types of eggs, including hard-boiled eggs, soft-boiled eggs, poached eggs, scrambled eggs, and omelets.

How does the Dash DEC005 Rapid Egg Cooker work?

The Dash DEC005 Rapid Egg Cooker uses steam to cook the eggs. It consists of a heating plate, water reservoir, and an egg tray or holder. You add water to the reservoir, place the eggs in the tray or holder, and select the desired cooking method and time. The cooker will then steam the eggs until they are cooked to your preference.

How many eggs can the Dash DEC005 Rapid Egg Cooker cook at once?

The Dash DEC005 Rapid Egg Cooker has a capacity to cook up to 6 eggs at a time. However, this capacity may vary depending on the size of the eggs and the cooking method chosen.

Can I adjust the cooking time for different levels of egg doneness?

Yes, the Dash DEC005 Rapid Egg Cooker allows you to adjust the cooking time based on your desired level of doneness. The user manual typically provides guidelines on cooking times for various levels of egg doneness.

Can I cook other foods besides eggs in the Dash DEC005 Rapid Egg Cooker?

While the primary purpose of the Dash DEC005 Rapid Egg Cooker is to cook eggs, some models may come with additional trays or accessories that allow you to cook other foods such as vegetables or seafood. However, it's recommended to consult the user manual or product specifications to determine the specific capabilities of your model.

Is the Dash DEC005 Rapid Egg Cooker easy to clean?

Yes, the Dash DEC005 Rapid Egg Cooker is generally easy to clean. Most of its components, such as the egg tray, water reservoir, and lid, are dishwasher safe. It's important to follow the manufacturer's instructions for cleaning and maintenance.

Can I use the Dash DEC005 Rapid Egg Cooker for boiling eggs without the shell?

Yes, the Dash DEC005 Rapid Egg Cooker can be used to cook eggs without the shell, such as poached eggs. Some models may come with specific trays or inserts for poaching eggs or cooking other styles like scrambled eggs or omelets.

Does the Dash DEC005 Rapid Egg Cooker have a timer or auto-shutoff feature?

Yes, the Dash DEC005 Rapid Egg Cooker typically has a built-in timer and an auto-shutoff feature. The timer allows you to set the cooking time, and once the eggs are cooked, the cooker will automatically shut off to prevent overcooking or overheating.

What should I do if the appliance malfunctions or is damaged in any way?

A turn the appliance to the nearest authorized service facility for examination, repair, or adjustment.

Can I use the Rapid Egg Cooker for anything other than its intended use?A: No, the appliance is only intended for household use and should not be used outdoors or for anything other than cooking eggs.

Is the Rapid Egg Cooker dishwasher safe?

No, only the accessories and lid are dishwasher safe. The body of the appliance should not be submerged in water or other liquids.

Can I use ingredients other than those approved for use with the appliance?

No, using unapproved ingredients may damage the appliance.

Can children use the Rapid Egg Cooker?

The appliance is not intended for use by persons (including children) with reduced physical, sensory, or mental capabilities, or lack of experience and knowledge unless they are provided with supervision and instruction concerning use of the appliance by a person responsible for their safety.

How do I clean the Heating Plate?

Clean the Heating Plate with a mild solution of water and vinegar (10 parts water: 1 part vinegar) from time to time. Gently scrub the Heating Plate in a circular motion with a "magic eraser"- type sponge and a little warm water.

What should I do if the Indicator Light does not turn on?

Ensure that the power cord is plugged into the power outlet.

Can I use an extension cord with the Rapid Egg Cooker?

If using a longer power-supply cord or extension cord, make sure that the electrical rating of the wire is compatible with the appliance. If the appliance is of the grounded type, the extension cord should be a grounding-type 3-wire cord.

How do I poach eggs using the Rapid Egg Cooke

Fill the Measuring Cup with cold water until it reaches the "Omelette/Poached" marking. Pour the water into the Heating Plate. Place the Boiling Tray on top of the Heating Plate. Use cooking spray to lightly grease the Poaching Tray. Always place the Omelette Bowl or Poaching Tray on top of the Boiling Tray and never directly on the Heating Plate. Break an egg into each section of the Poaching Tray. Cover with the Lid and plug in the Rapid Egg Cooker. Press the Power Button. When the buzzer sounds, your eggs will be ready to eat!

[**DASH DEC005 RAPID EGG COOKER**](#)